

Register your product and get support at
www.philips.com/welcome

Multimedia Speakers
SPA7210

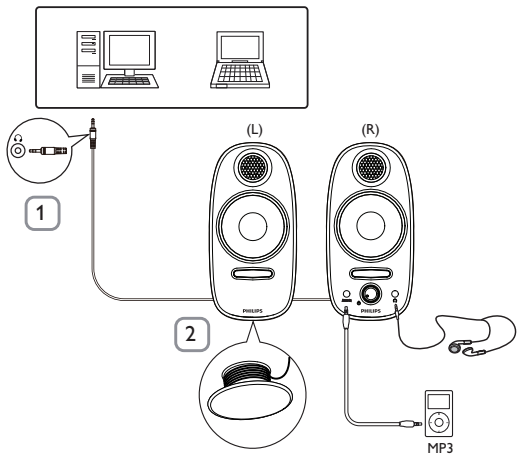

EN User manual



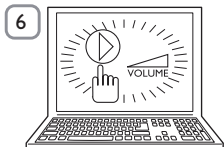
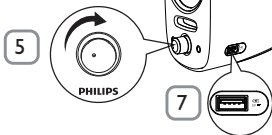

Multimedia Speakers

Warning: 1. The product shall not be exposed to dripping or splashing and that no objects filled with liquids, such as vases, shall be placed on the product. 2. To completely disconnect the power input, the mains plug of the product shall be disconnected from the mains. 3. The mains plug of the product should not be obstructed OR should be easily accessed during intended use. 4. No naked flame sources, such as lighted candles, should be placed on the products.

Note: 1. Ensure that the multimedia speaker is installed properly before using. 2. The maximum output voltage of headphone jack is equal or less than 150mV. 3. The USB socket is for charging 5V devices only.

Installation:

- 1 Connect the audio cable to the audio output of your computer (Fig. 1).
- 2 Adjust the length of speaker cable by the cable winder at the bottom of the left speaker (Fig. 2).
- 3 Connect the power cable to the power adaptor (Fig. 3).
- 4 Connect the power adaptor cable to the 12V DC socket at the back of the right speaker and a AC power socket (Fig. 4).
- 5 Turn the volume knob clockwise to switch on the Multimedia Speakers (Fig. 5).
 - ↳ The indicator on the right speaker lights up.
- 6 Adjust the volume either by the volume knob or by the computer application or multimedia application software (Fig. 6).
 - To listen through a headphone, connect it to the  socket on the right speaker.
 - To play sound from a MP3, connect it to the **AUX IN** socket on the right speaker.
 - The USB socket on the right speaker can be used to recharge a USB rechargeable device (e.g. MP3, mobile phone, ect.) (Fig. 7).

- 7 After use, exit the multimedia application software and switch off the speakers.

Your product is designed and manufactured with high quality materials and components, which can be recycled and reused. Please inform yourself about the local separate collection system for electrical and electronic products, including those marked by the crossed-out wheely bin symbol. Please act according to your local rules and do not dispose of your old products with your normal household waste.



FCC - Notice of compliance

This device complies with Part 15 of the FCC Rules. Operation is subject to the following two conditions:

1. this device may not cause harmful interference, and
2. this device must accept any interference received, including interference that may cause undesired operation.

Note:

This equipment has been tested and found to comply with the limits for a Class B digital device, pursuant to part 15 of the FCC Rules. These limits are designed to provide reasonable protection against harmful interference in a residential installation. This equipment generates, uses, and can radiate radio frequency energy and, if not installed and used in accordance with the instruction manual, may cause harmful interference to radio communications. However, there is no guarantee that interference will not occur in a particular installation. If this equipment does cause harmful interference to radio or television reception, which can be determined by turning the equipment off and on, the user is encouraged to try to correct the interference by one or more of the following measures:

- Relocate the receiving antenna.
- Increase the separation between the equipment and receiver.
- Connect the equipment into an outlet on a circuit different from that to which the receiver is connected.
- Consult the dealer or an experienced radio/TV technician for help.

FCC - Remarques sur la conformité

L'appareil répond aux normes FCC, Part 15.

Fonctionnement soumis aux deux conditions suivantes:

1. Cet appareil ne doit pas provoquer d'interférences nuisibles, et
2. Cet appareil doit accepter toute interférence reçue, y compris les interférences susceptibles de provoquer un fonctionnement peu satisfaisant.

Remarque:

Cet équipement a été testé et a été certifié conforme aux limites imposées pour un appareil numérique de Classe B, conformément à la partie 15 des règlements FCC. Ces limites sont définies aux fins d'assurer une protection raisonnable contre les interférences nuisibles dans une installation résidentielle. Cet équipement génère, utilise et émet des fréquences radio qui, en cas d'une mauvaise installation ou d'une utilisation non-conforme aux instructions de ce manuel d'utilisation peuvent causer des interférences nuisibles aux communications radio. Il n'y a toutefois aucune garantie que des interférences nuisibles ne se produiront pas dans une installation donnée. Si cet équipement cause des interférences nuisibles avec votre poste radio ou de télévision, ce que vous pouvez déterminer en éteignant et en rallumant votre équipement, il est conseillé à l'utilisateur d'essayer de pallier à ces interférences nuisibles en prenant l'une ou l'autre des mesures suivantes:

- Changez la position de l'antenne de réception.
- Augmentez la séparation entre l'équipement et le récepteur.
- Branchez l'équipement sur une source d'alimentation différente de celle sur laquelle le récepteur est branché.
- Consultez votre distributeur ou un technicien qualifié en la matière pour assistance.

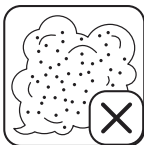
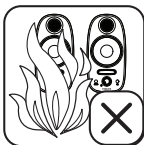
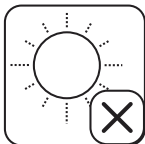



© Royal Philips Electronics N.V. 2009
All rights reserved.

Specifications are subject to change without notice. Trademarks are the property of Koninklijke Philips Electronics N.V. or their respective owners.

SPA7210_OSG_V1.0

Download from www.Somanuals.com. All Manuals Search And Download



Free Manuals Download Website

<http://myh66.com>

<http://usermanuals.us>

<http://www.somanuals.com>

<http://www.4manuals.cc>

<http://www.manual-lib.com>

<http://www.404manual.com>

<http://www.luxmanual.com>

<http://aubethermostatmanual.com>

Golf course search by state

<http://golfingnear.com>

Email search by domain

<http://emailbydomain.com>

Auto manuals search

<http://auto.somanuals.com>

TV manuals search

<http://tv.somanuals.com>