

# Unpack

Déballer

Assemble  
Lijstje  
Stabbe  
Draaivoer  
Pak  
Pak  
Pak

Parts  
Accessories  
Accessories  
Accessories  
Accessories  
Accessories



**PHILIPS**

## What's in the box

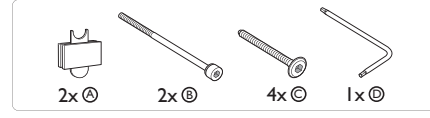
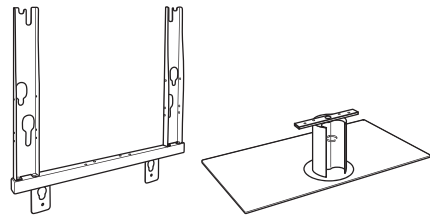

What else you'll need

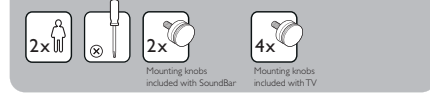

The tabletop stand is usable for the following TV sets



## STS8000 set-up guide

**Specification**  
Size: 480mm x 480mm  
6 x (160x235mm)  
Print: 1C x 1C (Black)  
Material: Maco White Matt

### Folding method

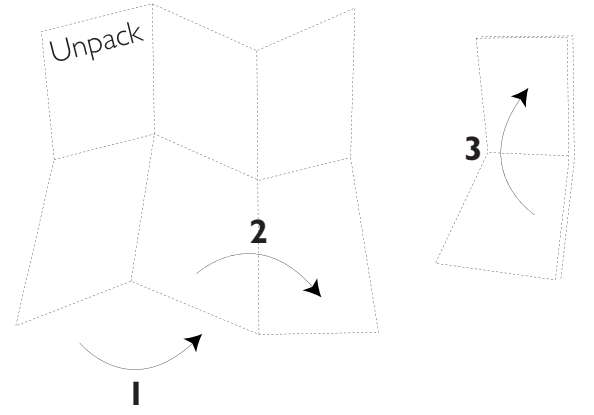

Printed in England  
www.philips.com  
© 2007 Philips Electronics N.V. All rights reserved.  
Tous droits réservés Philips Electronics N.V. Tous droits réservés.  
Specifications are subject to change without notice.

### 1 Unpack the stand

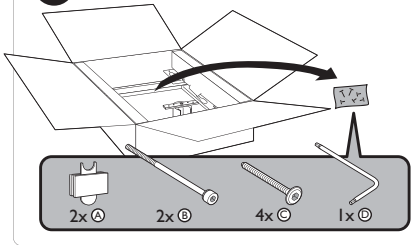

### 2

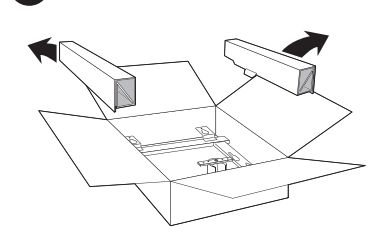

### 3

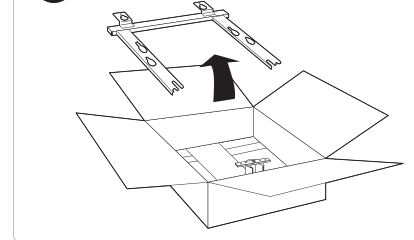

### 4

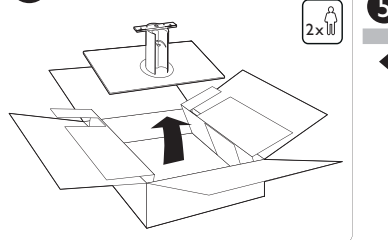

### 5 Assemble the stand

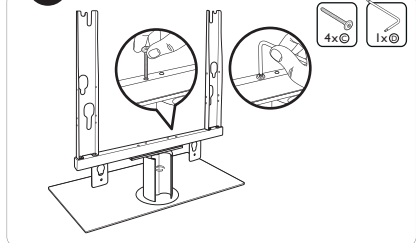

Detach your TV from its stand and attach mounting knobs

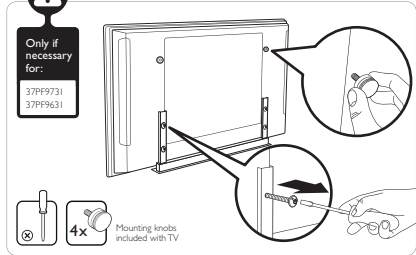

### 6 Connect cables and mounting knobs

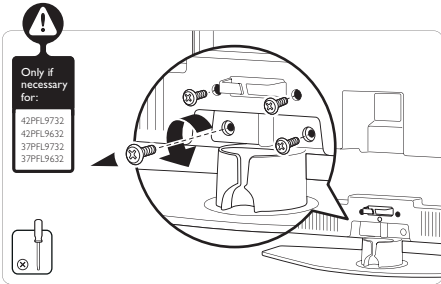
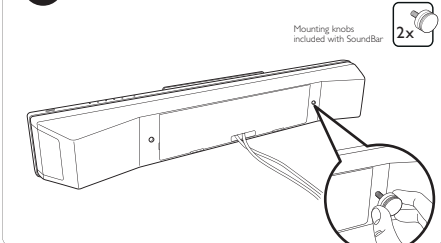

### 7 Mount your SoundBar

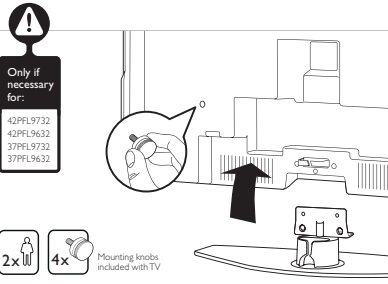
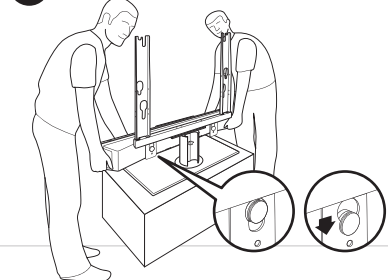

### 8

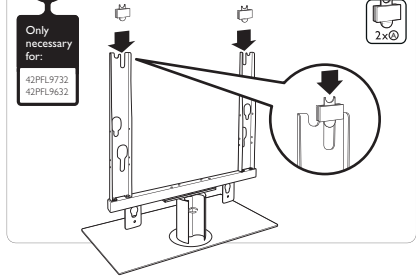

### 8 Mount your TV

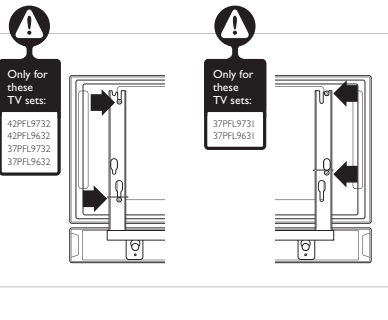
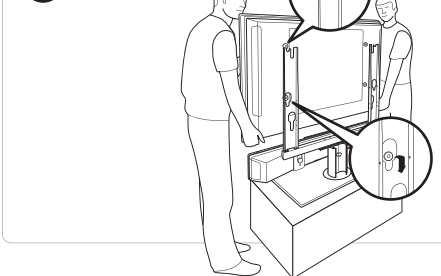

### 9



### 10 Connect SoundBar to TV

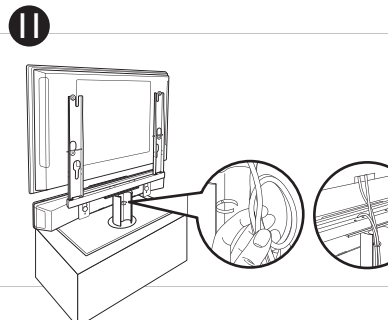
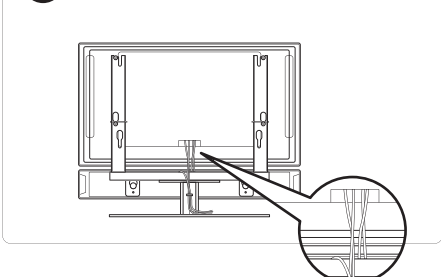

## Free Manuals Download Website

<http://myh66.com>

<http://usermanuals.us>

<http://www.somanuals.com>

<http://www.4manuals.cc>

<http://www.manual-lib.com>

<http://www.404manual.com>

<http://www.luxmanual.com>

<http://aubethermostatmanual.com>

Golf course search by state

<http://golfingnear.com>

Email search by domain

<http://emailbydomain.com>

Auto manuals search

<http://auto.somanuals.com>

TV manuals search

<http://tv.somanuals.com>