

User Manual



32PT6441/37
26PW6341/37
30PW6341/37



Thank you for choosing Philips.

Need help fast?

Read your User Manual first for quick tips that make using your Philips product more enjoyable. If you have read your instructions and still need assistance you may access our online help at
www.p4c.philips.com
or
call 1-888-PHILIPS (744-5477)
while with your product.

Model No.:	_____
Serial No.:	_____

PHILIPS

3121 235 22191

Return your Product Registration Card today to get the very most from your purchase.

Congratulations on your purchase, and welcome to the "family!"

Dear PHILIPS product owner:

Thank you for your confidence in PHILIPS. You've selected one of the best-built, best-backed products available today. We'll do everything in our power to keep you happy with your purchase for many years to come.

As a member of the PHILIPS "family," you're entitled to protection by one of the most comprehensive warranties and outstanding service networks in the industry. What's more, your purchase guarantees you'll receive all the information and special offers for which you qualify, plus easy access to accessories from our convenient home shopping network.

Most importantly, you can count on our uncompromising commitment to your total satisfaction.

All of this is our way of saying welcome - and thanks for investing in a PHILIPS product.

PS. To get the most from your PHILIPS purchase, be sure to complete and return your Product Registration Card at once.

Registering your model with PHILIPS makes you eligible for all of the valuable benefits listed below, so don't miss out. Complete and return your Product Registration Card at once to ensure:

***Proof of Purchase**

Returning the enclosed card guarantees that your date of purchase will be on file, so no additional paperwork will be required from you to obtain warranty service.

***Product Safety Notification**

By registering your product, you'll receive notification - directly from the manufacturer - in the rare case of a product recall or safety defect.

***Additional Benefits of Product Ownership**

Registering your product guarantees that you'll receive all of the privileges to which you're entitled, including special money-saving offers.

Know these safety symbols



This "bolt of lightning" indicates uninsulated material within your unit may cause an electrical shock. For the safety of everyone in your household, please do not remove product covering.



The "exclamation point" calls attention to features for which you should read the enclosed literature closely to prevent operating and maintenance problems.

WARNING: To reduce the risk of fire or electric shock, this apparatus should not be exposed to rain or moisture and objects filled with liquids, such as vases, should not be placed on this apparatus.

CAUTION: To prevent electric shock, match wide blade of plug to wide slot, fully insert.

ATTENTION: Pour éviter les choc électriques, introduire la lame la plus large de la fiche dans la borne correspondante de la prise et pousser jusqu'au fond.

PHILIPS

Visit our World Wide Web Site at <http://www.philips.com>

IMPORTANT SAFETY INSTRUCTIONS

Read before operating equipment

1. Read these instructions.
2. Keep these instructions.
3. Heed all warnings.
4. Follow all instructions.
5. Do not use this apparatus near water.
6. Clean only with a dry cloth.
7. Do not block any of the ventilation openings. Install in accordance with the manufacturers instructions.
8. Do not install near any heat sources such as radiators, heat registers, stoves, or other apparatus (including amplifiers) that produce heat.
9. Do not defeat the safety purpose of the polarized or grounding-type plug. A polarized plug has two blades with one wider than the other. A grounding type plug has two blades and third grounding prong. The wide blade or third prong are provided for your safety. If the provided plug does not fit into your outlet, consult an electrician for replacement of the obsolete outlet.
10. Protect the power cord from being walked on or pinched particularly at plugs, convenience receptacles, and the point where they exit from the apparatus.
11. Only use attachments/accessories specified by the manufacturer.
12.  Use only with a cart, stand, tripod, bracket, or table specified by the manufacturer, or sold with the apparatus. When a cart is used, use caution when moving the cart/apparatus combination to avoid injury from tip-over.
13. Unplug this apparatus during lightning storms or when unused for long periods of time.
14. Refer all servicing to qualified service personnel. Servicing is required when the apparatus has been damaged in any way, such as power-supply cord or plug is damaged, liquid has been spilled or objects have fallen into apparatus, the apparatus has been exposed to rain or moisture, does not operate normally, or has been dropped.
15. This product may contain lead and mercury. Disposal of these materials may be regulated due to environmental considerations. For disposal or recycling information, please contact your local authorities or the Electronic Industries Alliance: www.eiae.org
16. **Damage Requiring Service** - The appliance should be serviced by qualified service personnel when:
 - A. The power supply cord or the plug has been damaged; or
 - B. Objects have fallen, or liquid has been spilled into the appliance; or
 - C. The appliance has been exposed to rain; or
 - D. The appliance does not appear to operate normally or exhibits a marked change in performance; or
- E. The appliance has been dropped, or the enclosure damaged.
17. **Tilt/Stability** - All televisions must comply with recommended international global safety standards for tilt and stability properties of its cabinet design.
 - Do not compromise these design standards by applying excessive pull force to the front, or top, of the cabinet which could ultimately overturn the product.
 - Also, do not endanger yourself, or children, by placing electronic equipment/toys on the top of the cabinet. Such items could unsuspectingly fall from the top of the set and cause product damage and/or personal injury.
18. **Wall or Ceiling Mounting** - The appliance should be mounted to a wall or ceiling only as recommended by the manufacturer.
19. **Power Lines** - An outdoor antenna should be located away from power lines.
20. **Outdoor Antenna Grounding** - If an outside antenna is connected to the receiver, be sure the antenna system is grounded so as to provide some protection against voltage surges and built up static charges. Section 810 of the National Electric Code, ANSI/NFPA No. 70-1984, provides information with respect to proper grounding of the mast and supporting structure, grounding of the lead-in wire to an antenna discharge unit, size of grounding connectors, location of antenna-discharge unit, connection to grounding electrodes, and requirements for the grounding electrode. See Figure below.
21. **Object and Liquid Entry** - Care should be taken so that objects do not fall and liquids are not spilled into the enclosure through openings.
 - a) **Warning:** To reduce the risk of fire or electric shock, this apparatus should not be exposed to rain or moisture and objects filled with liquids, such as vases, should not be placed on this apparatus.
22. **Battery Usage CAUTION** - To prevent battery leakage that may result in bodily injury, property damage, or damage to the unit:
 - Install all batteries correctly, with + and - aligned as marked on the unit.
 - Do not mix batteries (old and new or carbon and alkaline, etc.).
 - Remove batteries when the unit is not used for a long time.

Note to the CATV system installer: This reminder is provided to call the CATV system installer's attention to Article 820-40 of the NEC that provides guidelines for proper grounding and, in particular, specifies that the cable ground shall be connected to the grounding system of the building, as close to the point of cable entry as practical.

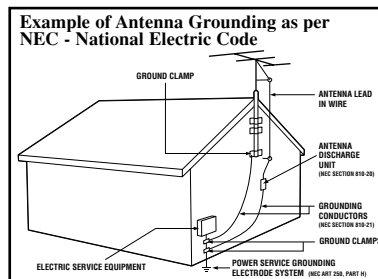

PANEL LAYOUT

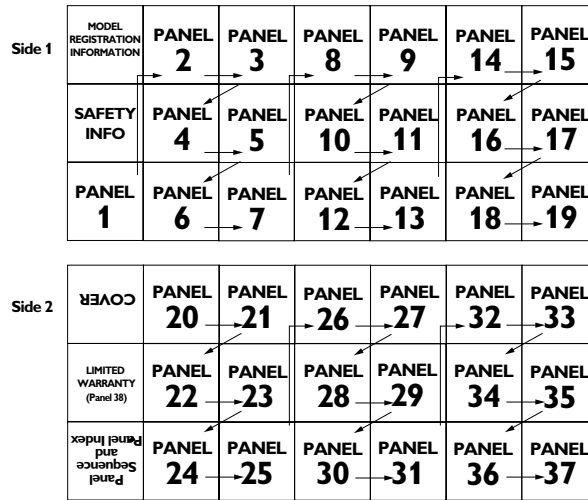

PANEL INDEX

Subject	Panel No.	Subject	Panel No.
Active Control	20	Timer Controls	
Antenna/Cable Basic Connection	1	Activate Control	18-19
Audio/Video Connections		Clock	18-19
AV Input Jacks	4	Display Control	18-19
Component Video Input Jacks	7	Specific Channel	18-19
Headphone Jack	5	Start or Stop Time	18-19
Monitor Output Jacks	8	Closed Caption Control	29
S-Video Input Jacks	6	Demo Mode	17
Side AV Input Jacks	5	Format Control	28
AutoLock™ Controls		Language Controls	11
Access Code	22	Limited Warranty	38
Block All Channels	24	Picture Menu Controls	15
Block Channels	23	QuadraSurf™	31-32
Clear All Blocked Channels	24	Remote Batteries	3
Movie Ratings	25	Remote Button Descriptions	9-10
Other Blocking Options	27	Remote Control Use	
TV Ratings	26	Code Entry Method	33
Understanding AutoLock™	21	Search Method	34
Automatically Programming TV	13	Code Entry List	35-37
AutoPicture™ Control	30	Rotation Controls	17
AutoSound™ Control	30	Sleeptimer	29
Basic Remote Operation	3	Sound Menu Controls	16
Basic Television Operation	3	Troubleshooting	37
Cable Box Connection	2	Tuner Mode	12
Channel Edit	14		

Active Control, AutoPicture, AutoSound, and Incredible Surround are trademarks of Philips Consumer Electronics Company. Copyright 2001 Philips Consumer Electronics.*Manufactured under license from Dolby Laboratories. "Dolby" and the double-D symbol are trademarks of Dolby Laboratories.

I BASIC ANTENNA AND CABLE CONNECTIONS

Your home's signal input might come from a single (75 ohm) round cable, a Converter Box, or from an antenna. In either case the connection to the TV is very easy.

- 1 If your Cable TV signal or Antenna signal is a round cable (75 ohm)** then you're ready to connect to the TV.

If your antenna has flat twin-lead wire (300 ohm), you first need to attach the antenna wires to the screws on a 300 to 75 ohm adapter.

If you have a Cable Converter Box: Connect the Cable TV signal to the Cable Signal IN(put) plug on the Converter.

Antenna Connection

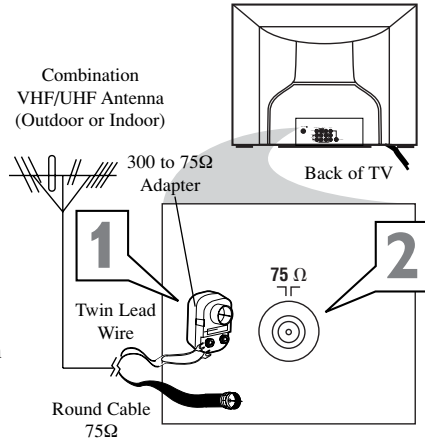

- 2 Connect the Cable TV cable or Antenna cable (or 300 to 75 ohm adapter)** to the 75Ω plug on the TV.

If you have a Cable Converter Box: Connect the OUT(put) plug from the Converter to the 75Ω plug on the TV.

Direct Cable Connection

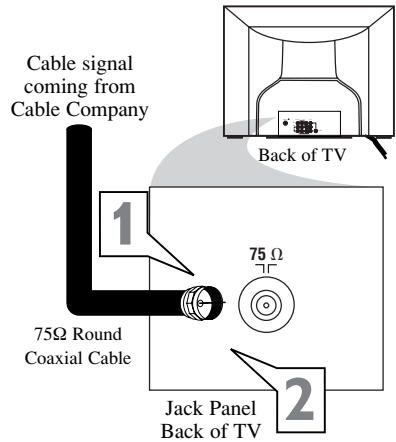

HELPFUL HINT
 After using the AutoProgram Control, press the CH + and – buttons to scroll through all the channels stored in the television's memory.

2

CABLE BOX CONNECTIONS

If your cable signal uses a cable box or decoder, follow the easy steps below to complete the connection.

Cable Box (w/RF In/Outputs):

This connection will be mono.

- 1 Connect the Cable Company supplied cable to the signal IN (put) plug on the back of the Cable Box.
- 2 Using a separate round coaxial cable, connect one end to the OUT (put) (TO TV) plug on the back of the Cable Box.
- 3 Connect the other end of the round coaxial cable to the 75Ω input on the back of the television. Screw it down finger tight.

NOTE: If applicable, set the OUTPUT CHANNEL SWITCH on the back of the cable box to CH 3 or 4. Tune the TV to the same channel and change channels at the cable box. In some cases, the cable box will automatically tune to either channel 3 or 4, change channels until the picture appears.

Cable Box (w/Audio/Video Outputs):

This connection will supply Stereo sound.

- 4 Connect the Cable Company supplied cable to the cable signal IN (put) plug on the back of the Cable Box.
- 5 Using a RCA type Video Cable, connect one end of the cable to the Video (or ANT, your cable box may be labeled differently) Out jack on the cable box and the other end to the AV1 Video Input on the TV.
- 6 Connect one end of the Audio Left and Right Cable to the left and right Audio Out L & R jacks on the cable box. Connect the other end to the AV1 Audio L & R Input jacks on the TV.

NOTE: Use the CH+ or CH- on the TV remote control to tune to the AV1 channel for the cable box signal. Once tuned, change channels at the cable box, not the television.

Cable Box (w/RF In/Outputs):

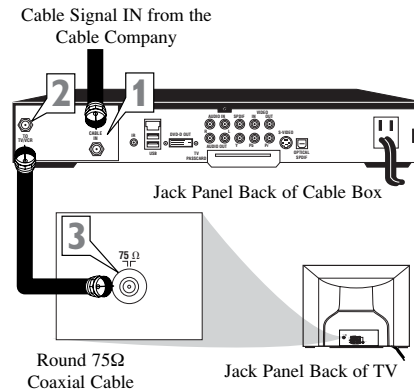

Cable Box (w/Audio/Video Outputs):

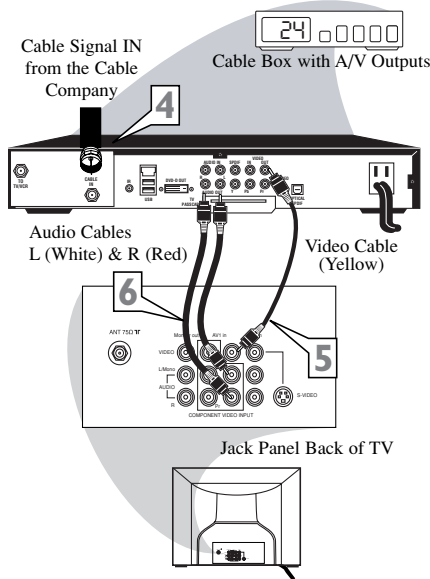

3 BASIC TV AND REMOTE CONTROL OPERATION

- 1 Press the **POWER** button to turn the TV ON.

Note: You can also press any button on the front of the TV to turn the TV ON.

- 2 Press the **VOLUME +** button to increase the sound level, or the **VOLUME -** button to lower the sound level.

Pressing both buttons at the same time will display the on-screen menu. Once in the menu, use these buttons to make adjustments or selections.

- 3 Press the **CHANNEL UP +** or **DOWN -** button to select TV channels.

- 4 Point the remote control toward the remote sensor window on the TV when operating the TV with the remote.

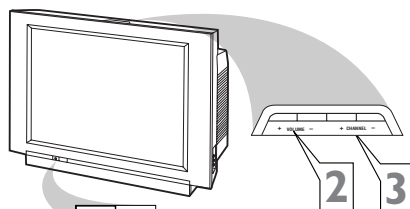

Remote Sensor - Sensor for activating remote control commands when the remote is used to control the TV.

Standby Light Indicator - Red light will show when in the Standby Mode. Press the Power button to return the TV to its active state.

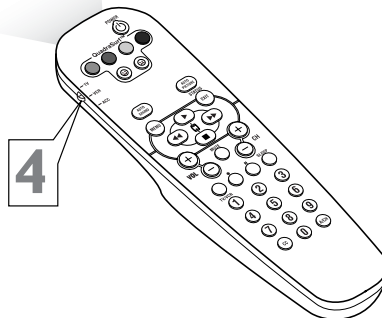

REMOTE CONTROL

To load the supplied batteries into the remote:

1. Remove the **battery compartment lid** on the back of the remote.
2. Place the **batteries (2-AA)** in the remote. Be sure the (+) and (-) ends of the batteries line up correctly (inside of case is marked.)
3. Reattach the **battery lid**.

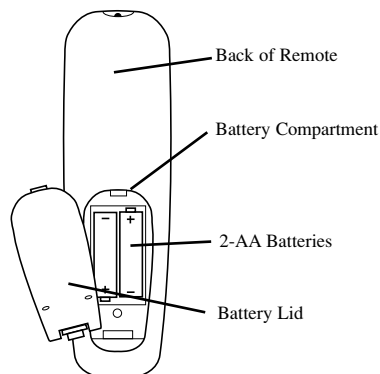

4

AV (AUDIO/VIDEO) INPUT CONNECTION

The TV's audio/video input jacks are for direct picture and sound connections between the TV and a VCR (or similar device) that has audio/video output jacks. Both the AV1 and AV2 Input Jack connections are shown on this page, but either one can be connected alone. Follow the easy steps below to connect your accessory device to the AV1 and AV2 IN Jacks located on the back of the TV.

- 1** Connect the VIDEO (yellow) cable to the VIDEO AV1 IN (or AV2 IN) jack on the back of the TV.
- 2** Connect the AUDIO (red and white) cables to the AUDIO (left and right) AV1 IN (or AV2 IN) jacks on the rear of the TV.
- 3** Connect the VIDEO (yellow) cable to the VIDEO OUT jack on the back of the VCR (either one or two) or accessory device being used.
- 4** Connect the AUDIO (red and white) cables to the AUDIO (left and right) OUT jacks on the rear of the VCR (either one or two) or accessory device being used.
- 5** Turn the VCR (either one or two) or accessory device and the TV ON.
- 6** Press the CH+ or CH- buttons set the TV to its AV1 or AV2 channel.
- 7** With either of the VCRs (or accessory devices) ON and a prerecorded tape (CD, DVD, etc.) inserted, press the PLAY button to view the tape on the television.

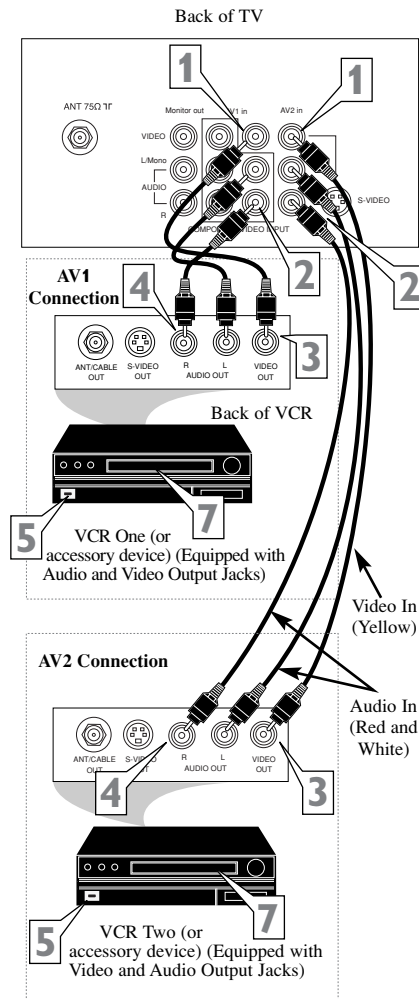

HELPFUL HINT

Audio and video cables are not supplied with the TV, but are available from Philips or electronics retailers.

5

SIDE AV CONNECTIONS

Audio and Video Side Inputs are available for a quick connection of a VCR, to playback video from a camera, or attach a gaming device. Use the AV button on the remote control to tune these inputs.

1 Connect the video (yellow) cable from the Video output on the Camera (or accessory device) to the Video (yellow) Input located on the SIDE of the TV.

2 For Stereo Devices: Connect the audio cable (red and white) from the Audio Left and Right Outputs on the Camera to the Audio In (white) jack on the SIDE of the television.

For Mono Devices: Connect one end of the audio cable from the Audio Out jack on the device to the Audio In (white) jack on the SIDE of the television.

3 Turn the TV and the accessory device ON.

4 Press the CH+ or CH- buttons on the remote control to tune the TV to the side input jacks. "Front" will appear on the TV screen.

5 Press the PLAY ► button on the accessory device to view playback, or to access the accessory device (camera, gaming unit, etc.).

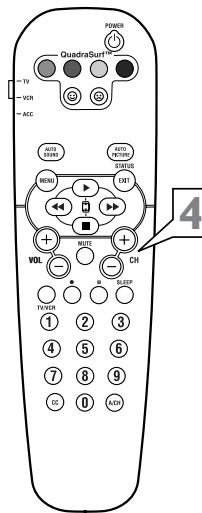
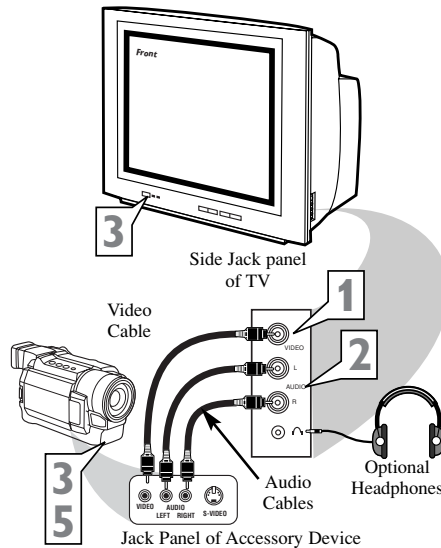

6

S-VIDEO (S-VHS) INPUT CONNECTIONS

The S(uper)-Video connection on the rear of the TV can provide you with better picture detail and clarity for the playback of accessory sources such as DBS (digital broadcast satellite), DVD (digital video discs), video games, and S-VHS VCR (video cassette recorder) tapes than the normal antenna picture connections.

NOTE: The accessory device must have an S-VIDEO OUT(put) jack in order for you to complete the connection on this page.

- 1** Connect one end of the S-VIDEO CABLE to the S-VIDEO jack on the back of the TV. Then connect one end the AUDIO (red and white) CABLES to the AV1 in AUDIO L and R (left and right) jacks on the rear of the TV.
- 2** Connect other end of the S-VIDEO CABLE to the S-VHS (S-Video) OUT jack on the back of the VCR. Then connect the other ends of the AUDIO (red and white) CABLES to the AUDIO (left and right) OUT jacks on the rear of the VCR.
- 3** Turn the VCR and the TV ON.
- 4** Press the CH + or CH - buttons on the remote to scroll the channels until SVHS appears in the upper left corner of the TV screen.
- 5** Now your ready to place a pre-recorded video tape in the VCR and press the PLAY ► button.

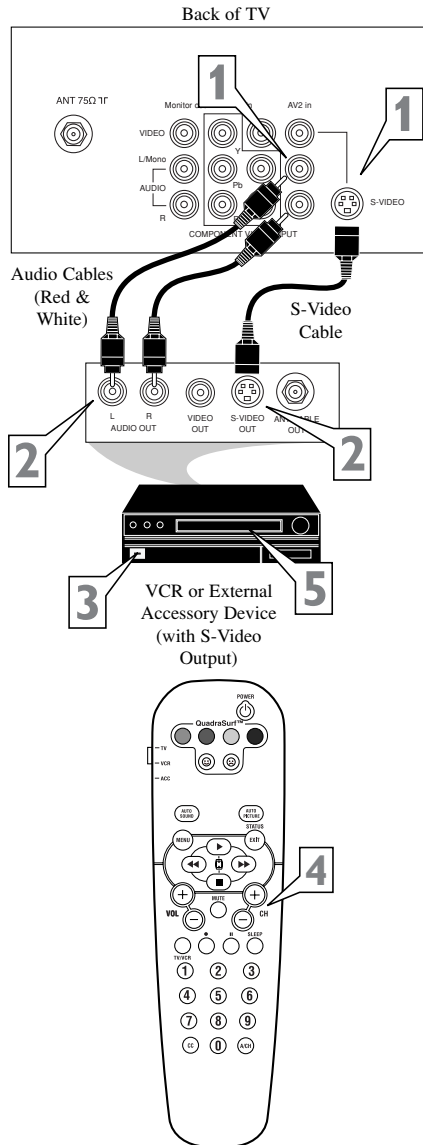

7 COMPONENT VIDEO (CVI) INPUT CONNECTIONS

Component Video inputs provide for the highest possible color and picture resolution in the playback of digital signal source material, such as with DVD players. The color difference signals (Pb, Pr) and the luminance (Y) signal are connected and received separately, which allows for improved color bandwidth information (not possible when using composite video or S-Video connections).

- 1** Connect the Component (Y, Pb, Pr) Video OUT jacks from the DVD player (or similar device) to the (Y, Pb, Pr) in(put) jack on the TV. When using the Component Video Inputs, it is best not to connect a signal to the AV in Video Jack.
- 2** Connect the red and white AUDIO CABLES to the Audio (left and right) output jacks on the rear of the accessory device to the Audio (L and R) AV1 in Input Jacks on the TV.
- 3** Turn the TV and the DVD (or digital accessory device) ON.
- 4** Press the CH + or CH - buttons to scroll the available channels until CVI appears in the upper left corner of the TV screen.
- 5** Insert a DVD disc into the DVD player and press the PLAY button on the DVD Player.

HELPFUL HINT

The description for the component video connectors may differ depending on the DVD player or accessory digital source equipment used (for example, Y, Pb, Pr; Y, B-Y, R-Y; Y, Cr, Cb). Although abbreviations and terms may vary, the letters *b* and *r* stand for the blue and red color component signal connectors, and *Y* indicates the luminance signal. Refer to your DVD or digital accessory owner's manual for definitions and connection details.

The CVI connection will dominate over the AV1 in Video Input. When a Component Video Device is connected as described, it is best not to have a video signal connected to the AV1 in Video Input jack.

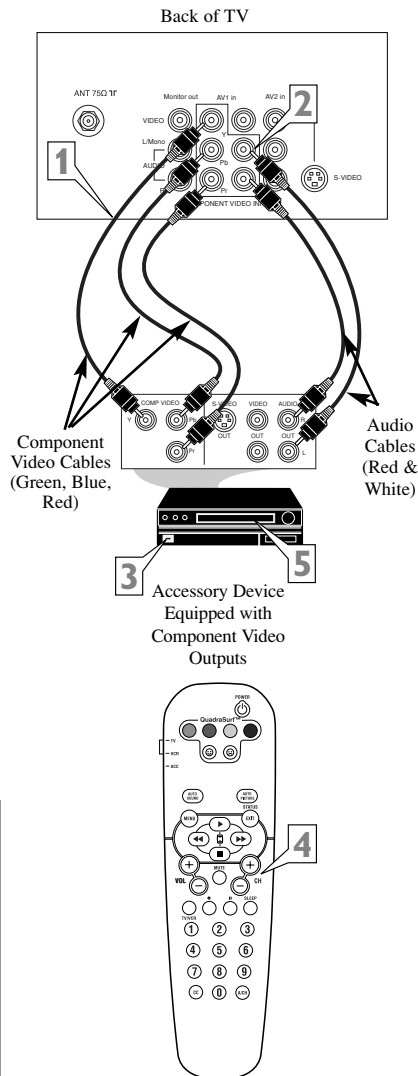

8

MONITOR OUT(PUT) CONNECTIONS

The Audio/Video (Monitor) Output jacks are great for recording with a VCR or used to connect an external audio system for better sound reproduction.

AUDIO SYSTEM CONNECTION:

- 1 Connect one end of the R(ight) and L(eft) AUDIO (Monitor Out) jacks on the TV to the R and L audio input jacks on your amplifier or sound system. Set the audio system's volume to a normal listening level.
- 2 Turn the TV and audio system ON. To adjust the volume on the audio system, you will need to change the volume at the external audio system, not the television.

SECOND VCR CONNECTION:

NOTE: Refer to panel number 4 for the proper hookup of the first VCR. Follow the instructions on how to tune to the AV1 channel to view a pre-recorded tape.

The following steps allow you to connect a second VCR to record the program while your watching it.

- 3 Connect one end of the yellow Video Cable to the Monitor Out VIDEO plug. Connect the other end to the VIDEO IN plug on the second VCR.
- 4 Connect one end of the red and white Audio cable from the Monitor Out AUDIO L and R plugs on the TV to the AUDIO IN plugs on the VCR.
- 5 Turn the Second VCR ON, insert a VHS tape and it's ready to record what's being viewed on the TV screen.

AUDIO SYSTEM CONNECTION:

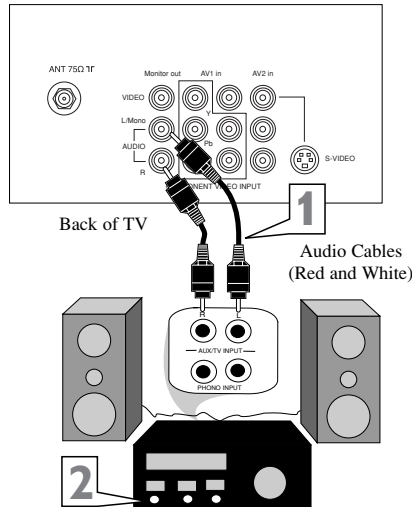

SECOND VCR CONNECTION:

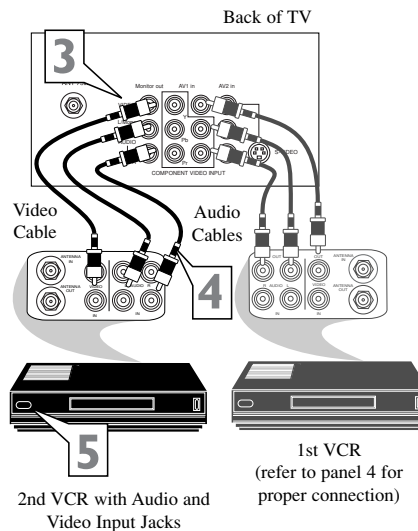

9

REMOTE CONTROL BUTTON DESCRIPTIONS

QUADRASURF Buttons (Red, Green, Yellow, Blue) Allows you to store and surf up to 10 channels you choose for each colored button.

SMILEY Button - Press to add channels to the "QuadraSurf" lists. Works with all colored buttons.

TV/VCR/ACC Mode Switch - Slide to position of TV to control TV functions, VCR to control VCR, and ACC for Cable Converter, DBS, DVD, etc., functions.

AUTO SOUND Button - Press repeatedly to choose from different factory pre-defined sound settings. Choose from Personal (how you set the Sound Menu options), Voice (for programming with speaking only), Music (for musical type programs such as concerts), or Theatre (used when watching movies).

MENU Button - Press to display the on-screen menu. Also can be used to back out of the on-screen menu until it disappears from the TV's screen.

VOL(ume) + or - Buttons - Press the VOL + button to increase the TV's sound level. Press the VOL - button to decrease the TV's sound level.

MUTE Button - Press the mute button to eliminate the sound being heard from the TV. "MUTE" will be displayed on the TV's screen. Press again to restore the TV's volume to it's previous level. pressing this button for 3-4 seconds will activate the Demo Mode.

CLOCK (TV/VCR) Button - Press to display the Timer menu when in TV mode.

● VCR Record Button - Press to start a VCR recording of a TV program.

CC Button - Press to activate the Closed Captioning options. Repeatedly pressing the CC button will scroll the available options on the TV screen.

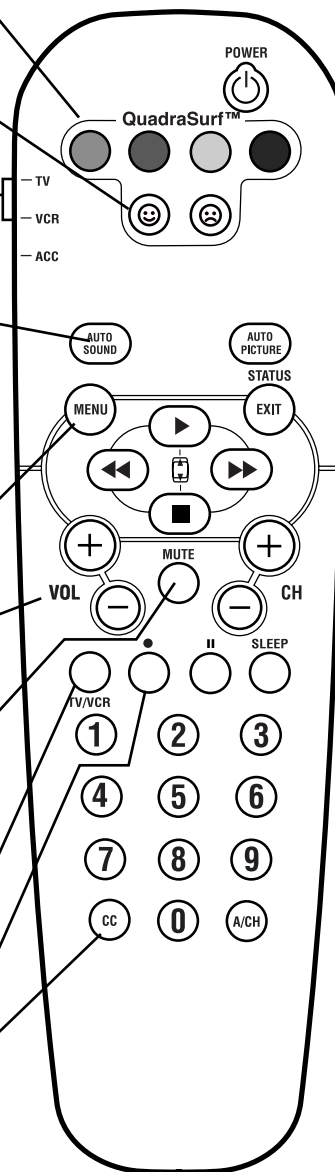

10 REMOTE CONTROL BUTTON DESCRIPTIONS

POWER Button - Press to turn the TV on or off.

FROWNIE Button - Allows you to delete channels from the "Quadra Surf" lists for the colored buttons. Works with all colored buttons.

AUTO PICTURE Button - Press repeatedly to choose from 5 different factory predefined picture settings. Choose from Personal (how you set the Picture Menu Adjustment controls), Movies (for movies), Sports (for any sporting event), Weak Signal (used when the signal being received is not great), or Multimedia (for video games).

STATUS/EXIT Button - Press to display the current channel number. If the on-screen menu is displayed, press the Status/Exit button of remove it from the TV's screen.

►, ■, ◀, and ▶ Buttons - Press to navigate, select, and adjust controls within the on-screen menu. These buttons can also be used with a VCR when the TV/VCR/ACC Switch is in the VCR position. Press Play ►, Stop ■, Rewind ◀, or Fast Forward ▶. Also, you can use the CURSOR UP ► or CURSOR DOWN ■ to activate or deactivate the screen formatting control.

CH(annel) + or CH(annel)- Buttons - Press to select channels in ascending or descending order.

SLEEP BUTTON - Press the SLEEP button to set the the TV to automatically turn itself off after a set period of time. Press repeatedly to select 15, 30, 45, 60, 90, 120, 180, or 240 minutes.

|| PAUSE Button - Press to pause the viewing of a prerecorded video. The picture will freeze on the screen until the Play or Pause buttons are pressed again.

NUMBERED (0-9) Buttons - Press the numbered buttons to select TV channels or to enter certain values within the on-screen menu. For single channel entries, press the numbered button for the channel you desire. The TV will pause for a second or two before changing to the chosen channel.

A/CH Button (Alternate Channel) - Press to toggle between the last viewed channel and the channel presently being viewed.

II HOW TO USE THE LANGUAGE CONTROL

For French and Spanish speaking TV owners an onscreen Language option is present. With the Language control you can set the TV's on-screen menu to be shown in English, French, or Spanish.

- 1** Press the **MENU** button on the remote control to show the onscreen menu.
- 2** Press the **CURSOR UP** ► or **DOWN** ■ buttons to scroll through the onscreen menu until the word **Install** is highlighted.
- 3** Press the **CURSOR RIGHT** ►► button to display the **Install** menu features.
- 4** Press the **CURSOR UP** ► or **DOWN** ■ buttons to scroll through the Install features until the word **Language** is highlighted.
- 5** Press the **CURSOR RIGHT** ►► button repeatedly to select English, Francais (French), or Español (Spanish).
- 6** When finished, press the **STATUS/EXIT** button to remove the menu from the TV's screen.

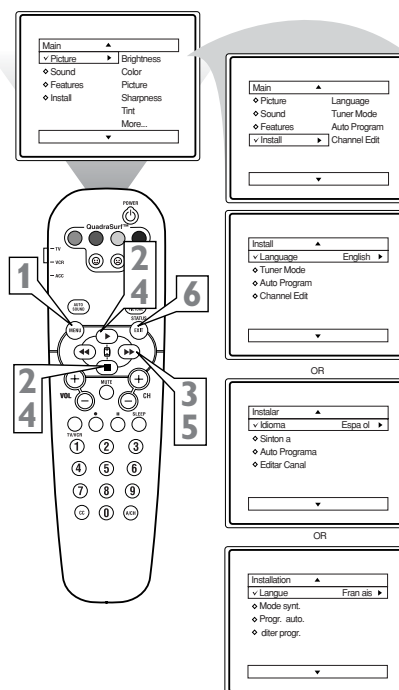

HELPFUL HINT

The Language control only makes the TV's on-screen Menu items appear in English, Spanish, or French text. It does not change the other on-screen text features such as Closed Caption (CC) TV shows.

12 HOW TO USE THE TUNER MODE CONTROL

The **TUNER MODE** control allows you to change the TV's input signal to either **ANTENNA**, **CABLE**, or **AUTO** mode. It's important for the TV to know what type of signal to look for (Cable TV or an Antenna). In the **AUTO** mode, when the **AUTO PROGRAM** feature is activated, the TV will automatically choose the correct mode.

- 1** Press the **MENU** button on the remote to show the onscreen menu.
- 2** Press the **CURSOR UP** or **DOWN** buttons to scroll through the onscreen menu until the word **Install** is highlighted.
- 3** Press the **CURSOR RIGHT** button to display the **Install** menu features.
- 4** Press **CURSOR UP** or **DOWN** buttons to scroll the **Install** features until the words **Tuner Mode** is highlighted.
- 5** Press the **CURSOR RIGHT** button to select either **Antenna**, **Cable**, or **Auto** mode.
- 6** When finished, press the **STATUS/EXIT** button to remove the onscreen menu from the TV's screen.

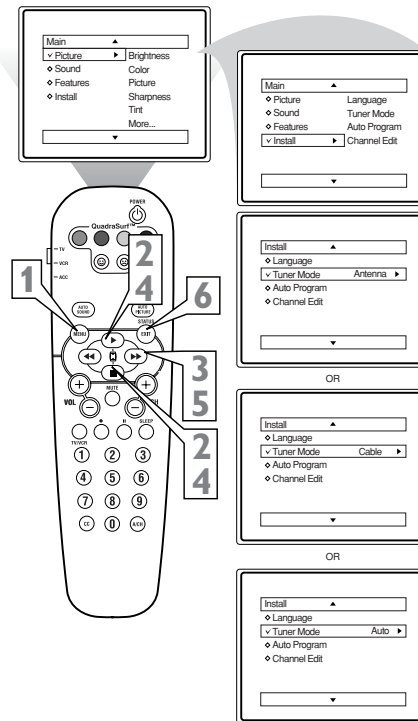

HELPFUL HINTS

When **CABLE** is selected, channels 1-125 are available.

When **ANTENNA** is selected, channels 2-69 are available.

When **AUTO** is selected, the TV will automatically set itself to the correct mode based on the type of signal it detects when the **AUTO PROGRAM** feature is activated.

Your TV can automatically set itself for local area (or Cable TV) channels. This makes it easy for you to select only the TV stations in your area when the CHANNEL (+), (-) buttons are pressed.

Note: Make sure the antenna or cable signal connection has been completed before AUTO PROGRAM is activated.

- 1 Press the MENU button on the remote to show the onscreen menu.
- 2 Press the CURSOR UP ► or DOWN ■ buttons to scroll through the onscreen menu until the word **Install** is highlighted.
- 3 Press the CURSOR RIGHT ►► button to display the **Install** menu features.
- 4 Press CURSOR UP ► or DOWN ■ buttons to scroll the Install features until the words **Auto Program** are highlighted.
- 5 Press the CURSOR RIGHT ►► button to start the Auto Program scanning of channels. Auto Programming will store all available channels in the TV's memory then tune to the lowest available channel when done.
- 6 When finished, press the STATUS /EXIT button to remove the menu from the TV's screen.

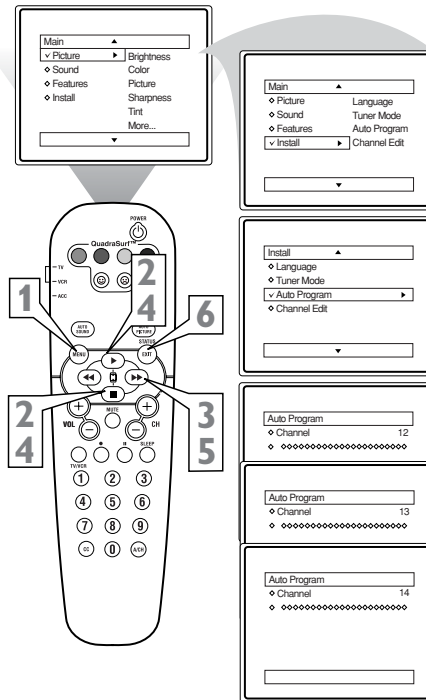

HELPFUL HINTS

When CABLE is selected, channels 1-125 are available.

When ANTENNA is selected, channels 2-69 are available.

When AUTO is selected, the TV will automatically set itself to the correct mode based on the type of signal it detects when the AUTO PROGRAM feature is activated.

14

CHANNEL EDIT

Channel Edit makes it easy for you to ADD or DELETE channels from the list of channels stored in the TV's memory.

- 1** Press the **MENU** button on the remote control to show the onscreen menu.
- 2** Press the **CURSOR UP** or **DOWN** buttons to scroll through the onscreen menu until the word **Install** is highlighted.
- 3** Press the **CURSOR RIGHT** button to display the **Install** menu features.
- 4** Press the **CURSOR UP** or **DOWN** buttons to scroll through the **Install** features until the words **Channel Edit** are highlighted.
- 5** Press the **CURSOR RIGHT** button to display the **Channel Edit** options.
- 6** With the **Channel Edit** options displayed, and **Channel** highlighted; you can use the cursor buttons to scroll through all available channels that you wish to add (skipped OFF) or delete (Skipped ON) from the TV's memory. You can also use the **NUMBERED** buttons to go directly to a specific numbered channel that you want to add or skip. Or, you can also use the **CH+** or **CH-** to quickly scan through the channels that have not been skipped.
- 7** Using the **CURSOR DOWN** button, scroll the menu to highlight the word **SKIPPED**.
- 8** Now use the **CURSOR RIGHT** button to toggle between **On** or **Off**. If **ON** is selected the channels is skipped when scrolling channels with the **CH+** or **CH-** buttons. If **OFF** is selected the channels is not skipped when scrolling channels with the **CH+** or **CH-** buttons.
- 9** When finished, press the **STATUS/EXIT** button to remove the menu from the screen.

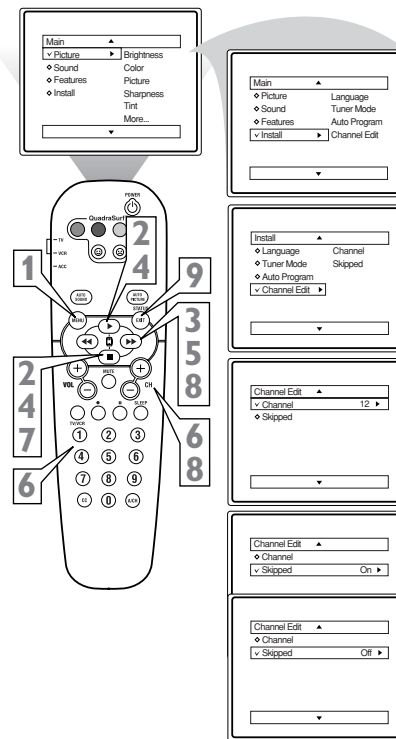

HELPFUL HINTS

An "X" appearing in front of any channel will indicate that channel has skip on. When the **CH +** or **CH -** buttons are used, those channels will be skipped.

15

PICTURE MENU CONTROLS

To adjust your TV picture controls, select a channel and use the Picture Menu Controls listed below:

- 1 Brightness Control** - Press the **CURSOR ►►** or **◄◄** buttons until the darkest parts of the picture are as bright as you prefer.
- 2 Color Control** - Press the **CURSOR ►►** or **◄◄** buttons to add or eliminate color.
- 3 Picture Control** - Press the **CURSOR ►►** or **◄◄** buttons until lightest parts of the picture show good detail.
- 4 Sharpness Control** - Press the **CURSOR ►►** or **◄◄** buttons to improve detail in the picture.
- 5 Tint Control** - Press the **CURSOR ►►** or **◄◄** buttons to obtain natural skin tones.
- 6 Color Temp Control** - Press the **CURSOR ►►** or **◄◄** buttons to select Normal, Cool, or Warm picture preferences. (Normal will keep the whites, white; Cool will make the whites, bluish; and Warm will make the whites, reddish.)
- 7 DNR Control** - Press the **CURSOR ►►** or **◄◄** buttons to turn DNR On or Off. Dynamic Noise Reduction helps to eliminate "noise" from the picture.
- 8 Contrast + Control** - Press the **CURSOR ►►** or **◄◄** buttons to toggle the control On or OFF. The Contrast + control helps to "sharpen" the picture quality. The black portions of the picture become richer in darkness and the whites become brighter.

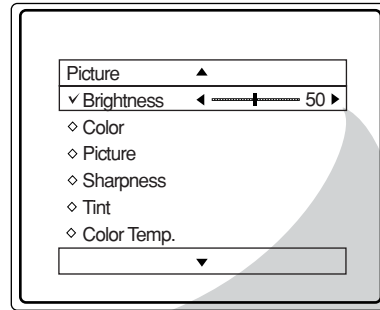

✓ Brightness	◄————— —————► 65
✓ Color	◄————— —————► 50
✓ Picture	◄————— —————► 50
✓ Sharpness	◄————— —————► 50
✓ Tint	◄————— —————► 0
✓ Color Temp.	Normal
	Warm or Cool
✓ DNR	On
	Off
✓ Contrast +	On
	Off

16

SOUND MENU CONTROLS

To adjust your TV sound, select and use the Sound Menu Controls listed below:

- 1 **Treble:** Press the CURSOR **▶▶** or **◀◀** buttons to adjust the control. The control will enhance the high frequency sounds.
- 2 **Bass:** Press the CURSOR **▶▶** or **◀◀** buttons to adjust the control. The control will enhance the low frequency sounds.
- 3 **Balance:** Press the CURSOR **▶▶** or **◀◀** buttons to adjust the level of sound coming from the left and right speakers.
- 4 **AVL:** (Auto Volume Leveler) Press the CURSOR **▶▶** or **◀◀** buttons to turn the control On or Off. When On, AVL will level out the sound being heard when sudden changes in volume occur during commercial breaks or channel changes.
- 5 **Incr. Surround:** Press the CURSOR **▶▶** or **◀◀** buttons to select between Dolby Virtual or Stereo settings (If Stereo), or select Spatial or Mono (If Mono).
- 6 **SAP:** Press the CURSOR **▶▶** or **◀◀** buttons to toggle this control to On or Off. SAP is short for Secondary Audio Programming and is sent as a third audio channel, a SAP signal can be heard apart from the current TV program sound. Note: If SAP is not present on a selected show No SAP will appear on the screen.
- 7 **Sound:** Press the CURSOR **▶▶** or **◀◀** buttons to select between Stereo or Mono settings. Note: If Stereo is not present on a selected show and the TV is placed in the Stereo mode, the sound coming from the TV will remain in the Mono mode.

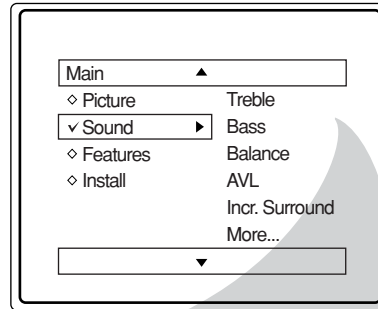

✓ Treble ◀ ———+——— 50 ▶

✓ Bass ◀ ———+——— 50 ▶

✓ Balance ◀ L ———+——— R ▶

✓ AVL On
or Off

✓ Incr. Surround Spatial
or Mono

✓ Incr. Surround Dolby Virtual
or Stereo

✓ SAP On
or Off

✓ Sound Mono
or Stereo

17 HOW TO USE THE ROTATION CONTROL

In rare cases the video supplied to the TV screen might show slightly tilted one way or another. The Tilt Adjust control will allow you to correct the problem by adjusting the screen in a clockwise or counterclockwise direction.

- 1** Press the **MENU** button on the remote control to show the onscreen menu.
- 2** Press the **CURSOR DOWN** buttons until Features is highlighted.
- 3** Press the **CURSOR RIGHT** button and the menu will shift to the left.
- 4** Press the **CURSOR DOWN** buttons repeatedly until the Rotation control is highlighted.
- 5** Press the **CURSOR RIGHT** or **CURSOR LEFT** buttons to rotate the picture on the screen clockwise or counter clockwise. Please note that the amount of rotation will be very minimal.
- 6** Press the **STATUS/EXIT** button to remove the menu from the screen.

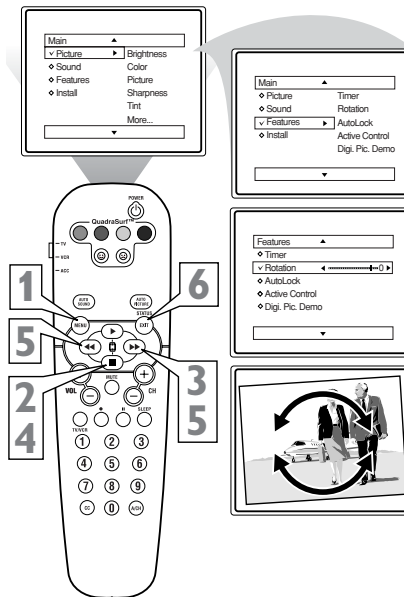

DEMO MODE

With Demo Mode On, a split screen demo will be shown on the screen. The Demo Mode will show the right side with show a sharper image with more natural motion.

- 1** Press the **DEMO/MUTE** button on the remote approximately 3-4 seconds. The split screen demo appears. After 20 seconds, the TV will automatically return to normal operation.

Note: You can also turn the Digital Picture Demo On or Off by using onscreen menu.

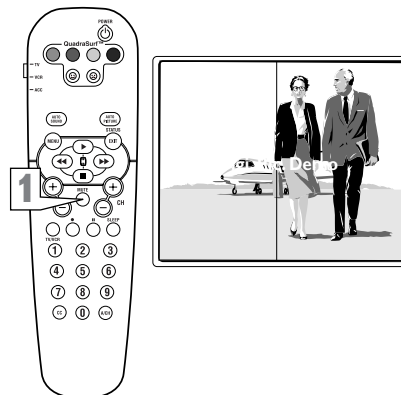

18

HOW TO USE THE TIMER MENU CONTROLS

Your television comes with an onscreen clock. The TV can also be set to turn on or off at a specific time and tune to a specific channel when it powers itself on.

- 1 Press the **MENU** button on the remote control to display the onscreen menu.
- 2 Press the **CURSOR DOWN** button until **Features** is highlighted.
- 3 Press the **CURSOR RIGHT** button to display the **Features** menu.
- 4 Press the **CURSOR RIGHT** button to display the **Timer** menu.
- 5 Press the **CURSOR UP** or **DOWN** buttons repeatedly to highlight one of the Timer controls. These controls are Time, Start Time, Stop Time, Channel, Activate, and Display.
- 6 Press the **CURSOR RIGHT** button to display the menu for the selected item.

Continue to Step 6 on the next page.

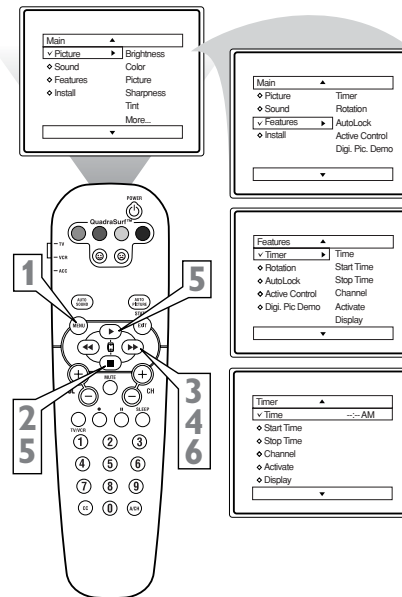

HELPFUL HINTS

Remember, be sure to press "0" and then the hour number for single digit entries.

You can get to the Clock setting by pressing the Clock button on the remote control.

The TV's clock settings may be lost when the TV is unplugged or when AC power to the set is interrupted.

19 HOW TO USE THE TIMER MENU CONTROLS (CONT'D)

6 Make adjustments to the selected items by following the steps below.

Time: Enter the current time using the Numbered buttons. Use the **CURSOR RIGHT** ►► or **CURSOR LEFT** ◄◄ buttons to toggle the AM and PM setting.

Start Time: Use the numbered buttons to enter the time you want the TV to turn itself On. Use the **CURSOR RIGHT** ►► or **CURSOR LEFT** ◄◄ buttons to toggle the AM and PM setting.

Stop Time: Use the numbered buttons to enter the time you want the TV to turn itself Off. Use the **CURSOR RIGHT** ►► or **CURSOR LEFT** ◄◄ buttons to toggle the AM and PM setting.

Channel: Use the NUMBERED buttons or the CH + or CH- buttons to enter the desired start-up channel.

Activate: Set the timer to turn itself On or Off Once or Daily. Press the **CURSOR RIGHT** ►► or **CURSOR LEFT** ◄◄ buttons to select Once, Daily, or Off.

Display: Press the **CURSOR RIGHT** ►► or **CURSOR LEFT** ◄◄ buttons to toggle between On or Off. If On is selected, the time will be displayed all the time when the TV is on. When Off is selected, the time will only appear when the STATUS/EXIT button is pressed.

7 Press the **STATUS/EXIT** button to remove the onscreen menu from the TV screen.

NOTE: You can also press the **CLOCK** button on the remote control to go directly to the Timer menu.

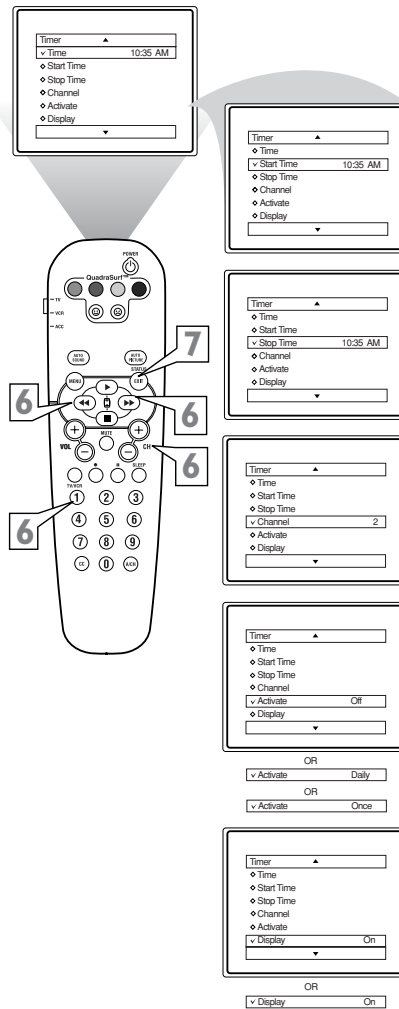

The Active Control monitors and adjusts incoming video signals to help provide the best picture quality. When you choose to turn the Active Control On, the picture sharpness and noise reduction are controlled automatically. Active Control adjusts these picture settings continuously and automatically.

- 1** Press the **MENU** button on the remote to show the onscreen menu.
- 2** Press the **CURSOR UP** or **DOWN** buttons to scroll through the onscreen menu until the word **Features** is highlighted.
- 3** Press the **CURSOR RIGHT** button to display the **Features** menu.
- 4** Press the **CURSOR UP** or **DOWN** buttons to repeatedly until **Active Control** is highlighted.
- 5** Press the **CURSOR RIGHT** or **CURSOR LEFT** buttons to toggle the Active Control to On, Off, or Light Sensor (models 26PW6341/37 or 30PW6341/37 only).
- 6** When finished, press the **STATUS /EXIT** button to remove the onscreen menu from the TV's screen.

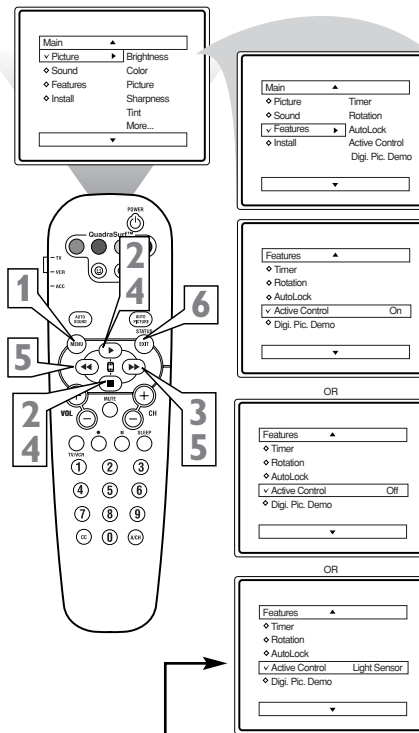

NOTE: This screen is only available in models 26PW6341/37 and 30PW6341/37. Model 32PT6441/37 will not show this screen.

The AutoLock™ feature is an integrated circuit that receives and processes data sent by broadcasters, or other program providers, that contain program content advisories. When programmed by the viewer, a TV with AutoLock™ can respond to the content advisories and block program content that may be found objectionable (such as offensive language, violence, sexual situations, etc.). This is a great feature to censor the type of viewing children may watch.

AutoLock™ offers various BLOCKING controls from which to choose:

Access Code - An Access Code must be set to prevent children from unblocking questionable or censored programming set by their parents.

Channel Block - After an access code has been programmed, you can block individual channels including the A/V inputs.

Clear All - Allows you clear all channels being blocked from your viewing set with the Channel Block Control.

Block All - Allows you to block ALL channels and A/V inputs at one time.

Movie Ratings - Certain blocking options exist which will block programming based on ratings patterned by the Motion Pictures Association of America.

TV Ratings - Just like the Movie Ratings, programs can be blocked from viewing using standard TV ratings set by TV broadcasters.

MOVIE RATINGS

G: General Audience - All ages admitted. Most parents would find this program suitable for all ages.

PG: Parental Guidance Suggested - This programming contains material that parents may find unsuitable for younger children.

PG-13: Parents Strongly Cautioned - This programming contains material that parents may find unsuitable for children under the age of 13.

MOVIE RATINGS Continued

R: Restricted - This is programming is specifically designed for adults. Anyone under the age of 17 should only view this programming with an accompanying parent or adult guardian.

NC-17: No one under the age of 17 will be admitted. - This type of programming should be viewed by adults only.

X: Adults Only - This type of programming contains one or more of the following: very graphic violence, very graphic and explicit or indecent sexual acts, very coarse and intensely suggestive language.

TV RATINGS

TV-Y -- Designed for a very young audience, including children ages 2-6.

TV-Y7 -- It may be appropriate for children age 7 and above who have acquired the development skills needed to distinguish between make-believe and reality.

TV-G -- Suitable for most audiences, this type of programming contains little or no violence, no strong language, and little or no sexual dialogue or situations.

TV-PG -- This program contains material that parents may find unsuitable for younger children. Could contain Moderate violence (V), some sexual situations (S), infrequent coarse language (L), or some suggestive dialogue (D).

TV-14 -- This program contains some material that many parents would find unsuitable for children under 14 years of age. This type of programming contains one or more of the following: intense violence (V), intense sexual situations (S), strong coarse language (L), or intensely suggestive dialogue (D).

TV-MA -- This program is specifically designed to be viewed by adults and therefore may be unsuitable for children under 17. This type of programming contains one or more of the following: graphic violence (V), explicit sexual situations (S), or crude indecent language (L).

22

SETTING UP AN ACCESS CODE

Over the next few panels you'll learn how to block channels and get a better understanding of the rating terms for certain programming.

First, let's start by learning how to set a personal access code:

- 1** Press the **MENU** button on the remote to display the onscreen menu.
- 2** Press the **CURSOR UP** or **DOWN** buttons until the word **Features** is highlighted.
- 3** Press the **CURSOR RIGHT** button to display the Features menu options.
- 4** Press the **CURSOR UP** or **DOWN** buttons until the words **Auto Lock™** are highlighted.
- 5** Press the **CURSOR RIGHT** button. The screen will read, "Access Code - - - -."
- 6** Using the **NUMBERED** buttons, enter 0, 7, 1, 1. "XXXX" appears on the Access Code screen as you press the numbered buttons. "Incorrect Code" will appear on the screen, and you will need to enter 0, 7, 1, 1 again.
- 7** The screen will ask you to enter a "New Code." Enter a "new" 4 digit code using the **NUMBERED** buttons. The screen will then ask you to **CONFIRM** the code you just entered. Enter your new code again. "XXXX" will appear when you enter your new code and then display the AutoLock™ menu options.

Proceed to the next panel to learn more...

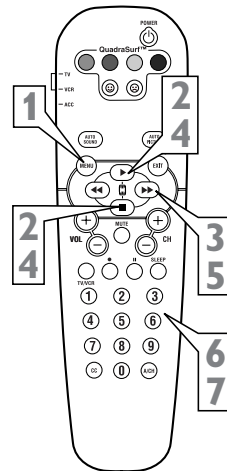
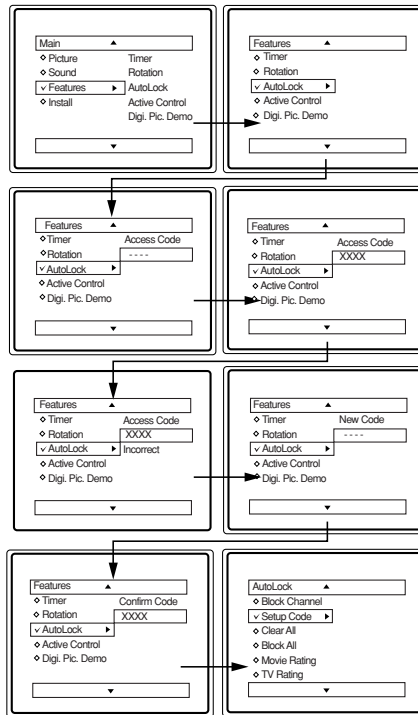

23

BLOCK CHANNELS

After your personal access code has been set (see previous page), you are now ready to select the channels or the A/V Inputs you want to block out or censor. Once you've entered your access code and the AutoLock™ features are displayed on the screen:

1 Press the **CURSOR UP** or **DOWN** buttons until the words **Block Channel** are highlighted.

2 Press the **CURSOR RIGHT** button to turn blocking ON or OFF for that channel. When ON is selected the channel will be blocked.

3 Press the **CH +** or **CH -** button to select other channels you wish to block. Repeat steps 2-3 to block the new channel.

4 When finished, press the **STATUS/EXIT** button to remove the menu from the screen.

NOTE: If you ever forget your code, the 0, 7, 1, 1 code is the factory default and can be used to enter and create a new access code.

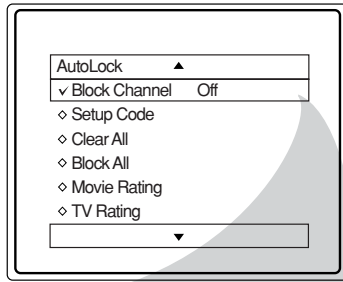

✓ Block Channel On

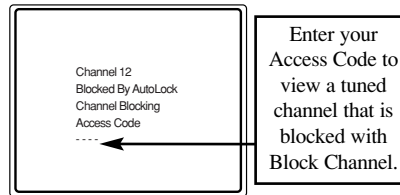

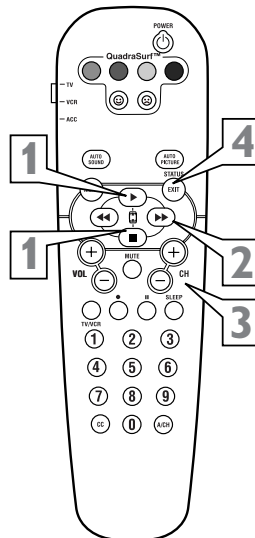

Enter your Access Code to view a tuned channel that is blocked with Block Channel.



24 BLOCK/CLEAR ALL CHANNELS AT THE SAME TIME

After blocking specific channels there may come a time when you want to block or clear all the channels at the same time. Once you've entered your access code and the AutoLock™ features are displayed on the screen:

1 Press the **CURSOR UP**  or **DOWN**  buttons to select either Clear All or Block All.

2 If **Clear All** is selected, press the **CURSOR RIGHT**  button to clear all blocked channels. All channels will be viewable.

If **Block All** is selected, press the **CURSOR RIGHT**  button to turn the control On or Off. When On is selected, ALL available channels will be blocked from viewing.

3 When finished, press the **STATUS/EXIT** button to remove the menu from the screen.

NOTE: If you ever forget your code, the 0, 7, 1, 1 code is the factory default and can be used to enter and create a new access code.

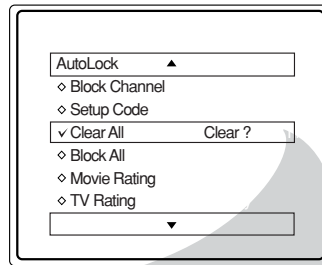

✓ Clear All Cleared

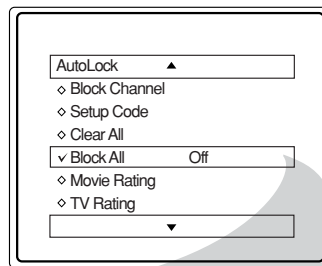

✓ Block All On

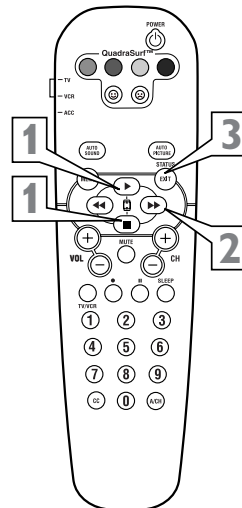

25

MOVIE RATINGS

The AutoLock™ feature can block programming based on the Movie Industry ratings. Once you've entered your access code and the AutoLock™ features are displayed on the screen:

- 1 Press the CURSOR UP ► or DOWN ▼ buttons** to highlight the words Movie Rating.
- 2 Press the CURSOR RIGHT ►► button** to display the Movie Rating options (G, PG, PG-13, R, NC17, or X).
- 3 Press the CURSOR UP ► or DOWN ▼ buttons** to highlight any of the Movie Rating options. When highlighted, all these options can be turned **On** (which will allow blocking) or **Off** (which will allow viewing).
- 4 Use the CURSOR RIGHT ►► button** on the remote to turn the rating option On or Off.



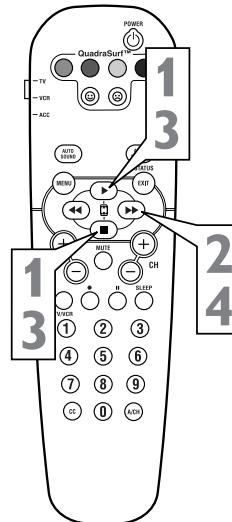
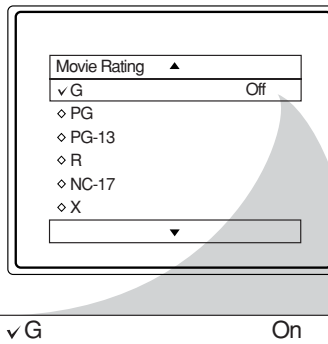
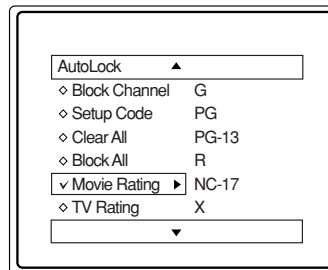

When a rating level is chosen to be blocked, any higher level rating will also be blocked from viewing. (i.e.: If "R" is selected to be blocked, NC-17 and X will automatically be blocked.)

NOTE: If you ever forget your code, the 0, 7, 1, 1 code is the factory default and can be used to enter and create a new access code.





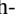

The AutoLock™ feature can block programming based on the TV Industry ratings.

Once you've entered your access code and the AutoLock™ features are displayed on the screen:

- 1 Press the **CURSOR UP**  or **DOWN**  buttons to highlight the words TV Rating.
- 2 Press the **CURSOR RIGHT**  button to display the TV Rating options (TV-Y, TV-Y7, TV-G, TV-PG, TV-14, or TV-MA).
- 3 Press the **CURSOR UP**  or **DOWN**  buttons to highlight any of the TV Rating options. When highlighted, all these options can be turned **On** (which will allow blocking) or **Off** (which will allow viewing).

NOTE: Some TV RATING options also have sub-ratings. The ratings of TV-Y7, TV-PG, TV-14, TV-MA can be customized to block V (violence), FV (fantasy violence), S (sexual situations), L (coarse language), or D (suggestive dialogue).

- 4 Press the **CURSOR RIGHT**  button on the remote to turn the TV-Y or TV-G rating On or Off. Or, press the **CURSOR RIGHT**  button to enter the sub-menus for the TV-Y7, TV-PG, TV-14 or TV-MA ratings.
- 5 If the TV-Y7, TV-PG, TV-14 or TV-MA sub-menu is accessed, press the **CURSOR UP**  or **DOWN**  buttons to select one of the options (Block All, V, S, L, D, or FV).
- 6 Press the **CURSOR RIGHT**  button on the remote to turn the option ON or OFF.

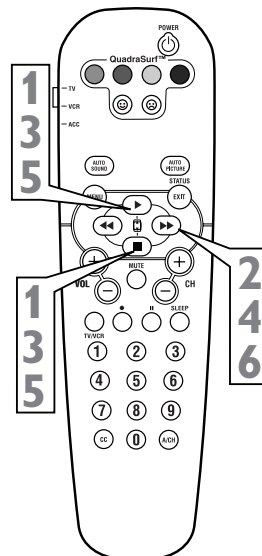
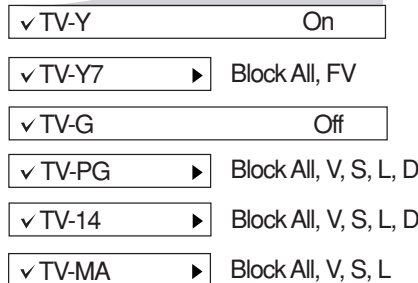
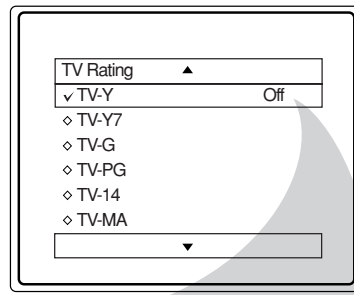

AutoLock™ offers the viewer other blocking features as well. With these Blocking Options, the censoring can be turned ON or OFF. Once you've entered your access code and the AutoLock™ features are displayed on the screen:

1 Press the CURSOR UP ► or DOWN ▾ buttons until the words **Block Options** are highlighted.

2 Press the CURSOR RIGHT ► button to display the **Blocking Options (Blocking, Unrated, or No Rating)** menu.

Blocking: Might be called the “master switch” for AutoLock™. When On, ALL blocking/censoring will take place. When Off, ALL blocking is disabled.

Unrated: ALL unrated programs based on the Movie Ratings or Parental (TV) Guidelines can be blocked if this feature is set to On and the Blocking feature is set to OFF.

No Rating: ALL programming with NO content advisory data can be blocked if set to On and the Blocking feature is set to OFF.

3 Press the CURSOR UP ► or DOWN ▾ buttons to highlight the desired feature.

4 When highlighted, each feature can be turned On or Off using the CURSOR RIGHT ► or CURSOR LEFT ◀ buttons on the remote.

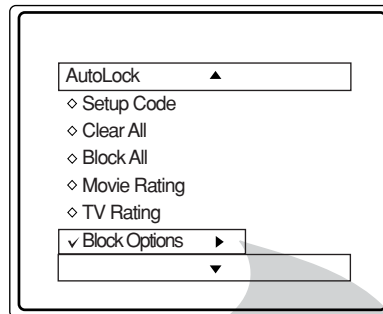

✓ Blocking On



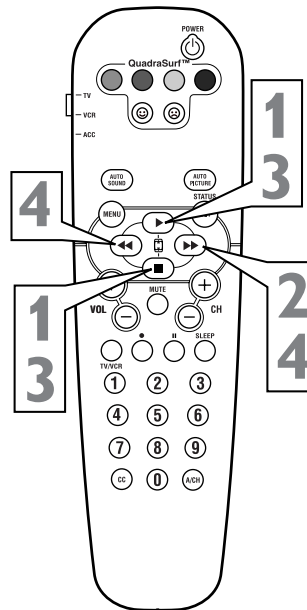

✓ Unrated On

✓ No Rating On



Format Options for models:
26PW6341/37 and 30PW6341/37

Many times while watching movies from a DVD player the image is shown in "letter box" format. This is the format that is shown in movie theaters. When shown on a TV screen, the image will have areas of black on top and bottom of the screen. After the desired format has been selected you can shift or "nudge" the picture by pressing the cursor to move the picture up or down.

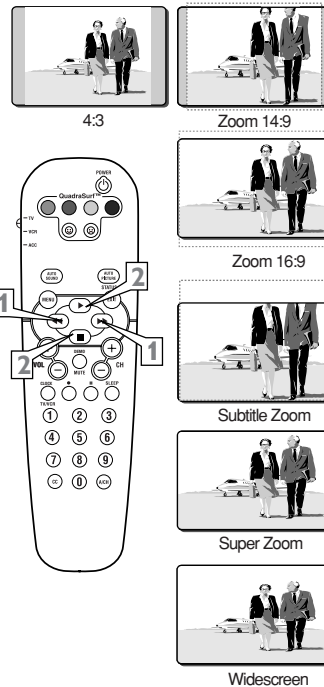

- 1** Press the **CURSOR RIGHT**  or **LEFT**  buttons to select one of the toggle the screen format options.
- 2** While in the format options, you can press the **CURSOR UP**  or **DOWN**  buttons to "nudge" the picture up or down.

NOTE: "Nudge" does not work in the Wide screen Picture Format.



Format options for model
32PT6441/37.

Many times while watching movies from a DVD player the image is shown in "letter box" format. This is the format that is shown in movie theaters. When shown on a TV screen, the image will have areas of black on top and bottom of the screen.

- 1** Press the **CURSOR UP**  or **DOWN**  buttons to select one of the two options 4:3 or Expand 4:3.
- 4:3** - Standard format for the TV.
- Expand 4:3** - Enlarges the picture to fill out the entire screen area, eliminating the "letter box" effect.

NOTE: "Nudge" is not functional in model 32PT6441/37.

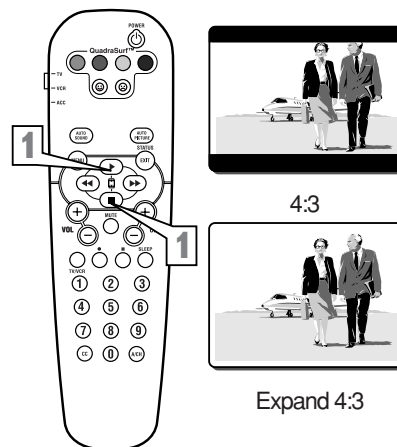

29

CLOSED CAPTIONING

Closed Captioning (CC) allows you to read the voice content of television programs on the TV screen. Designed to help the hearing impaired, this feature uses onscreen "text boxes" to show dialogue and conversations while the TV program is in progress.

- 1** Press the **CC** button on the remote to display the current Closed Caption setting.
- 2** Press the **CC** button repeatedly to choose from the four Closed Caption options (CC Off, CC1, CC2, CC Mute).
- 3** When finished, press the **STATUS /EXIT** button to remove the menu from the TV's screen.

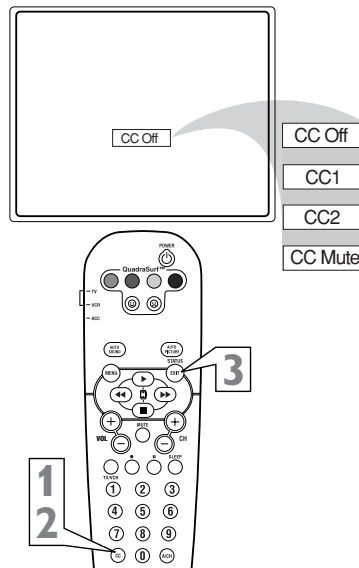

SLEEPTIMER

Your TV can be set to automatically turn itself off at a given amount of time.

- 1** Press the **SLEEP** button on the remote control and the SLEEP timer display will appear on the screen.
- 2** Press the **SLEEP** button repeatedly to pick the amount of time (15, 30, 45, 60, 90, 120, 180, or 240 minutes) before the TV will turn itself off.

NOTE: An onscreen count down will appear during the last minute before the TV shuts itself off. If any button is pressed during the last minute of the countdown, the Sleptimer setting will be cancelled.

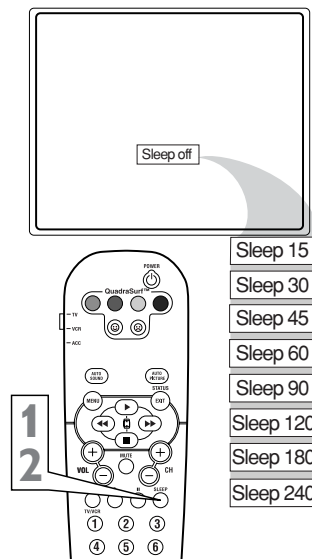

30

AUTO PICTURE

Whether you're watching a movie or a sporting event, your TV has automatic video control settings matched for your current program source or content.

- 1 Press the **AUTO PICTURE** button on the remote control. The current Auto Picture setting will be displayed on the screen.
- 2 Press the **AUTO PICTURE** button repeatedly to select either Personal, Movies, Sports, Weak Signal, or MULTIMEDIA picture settings.

NOTE: The way you choose to set the Picture Menu Controls will become your Personal setting.

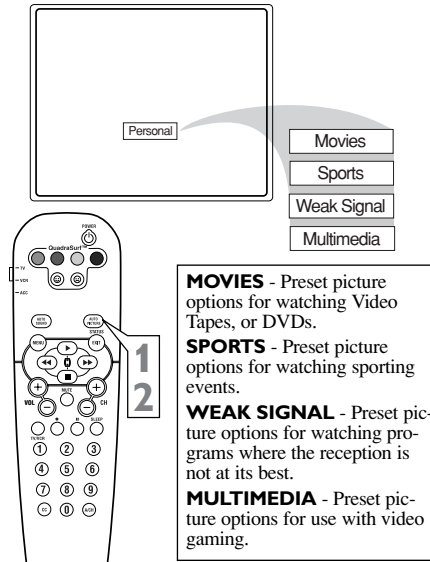

MOVIES - Preset picture options for watching Video Tapes, or DVDs.

SPORTS - Preset picture options for watching sporting events.

WEAK SIGNAL - Preset picture options for watching programs where the reception is not at its best.

MULTIMEDIA - Preset picture options for use with video gaming.

AUTO SOUND

The Auto Sound feature allows the listener to select between four different factory set sound options.

- 1 Press the **AUTO SOUND** button on the remote control. The current Auto Sound setting will appear in the middle of the screen.
- 2 Press the **AUTO SOUND** button repeatedly to toggle between the four settings. (Personal, Theatre, Music, or Voice)

NOTE: The way you choose to set the Sound Menu Controls will become your Personal setting.

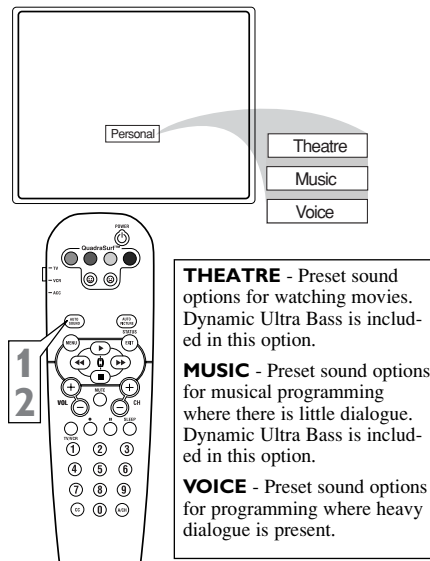

THEATRE - Preset sound options for watching movies. Dynamic Ultra Bass is included in this option.

MUSIC - Preset sound options for musical programming where there is little dialogue. Dynamic Ultra Bass is included in this option.

VOICE - Preset sound options for programming where heavy dialogue is present.

The QuadraSurf™ control allows you set up four different personal channel Surf lists using the colored buttons (on the remote control), each holding up to ten channels in its quick viewing "list."

- 1** Press the CHANNEL (+) or (-) buttons (or the NUMBER buttons) to select a channel to add to one of the SURF lists.
- 2** Press the SMILEY ☺ button on the remote control to ADD the channel to one of the SURF lists.
- 3** Press the corresponding COLORED (Red, Green, Yellow or Blue) button to add the channel to that button's Surf list. (Up to ten channels per button can be stored.)

Repeat steps 1 through 3 to add additional channels (up to 10) to each of the SURF lists.

To remove a channel from one of the SURF lists;

- 4** Press the COLORED Quadra Surf button until the desired channel appears. The screen will display the channel number with a colored "Smiley" face to indicate the Colored button it relates to.
- 5** While the "Smiley" face channel indicator is displayed, press the FROWNIE ☹ face button. The screen will read, "Remove item? - Press ☹."
- 6** Press the FROWNIE ☹ face button again to confirm your decision to remove the channel from the Surf list.

Repeat steps 4-6 to remove other channels from Surf lists.

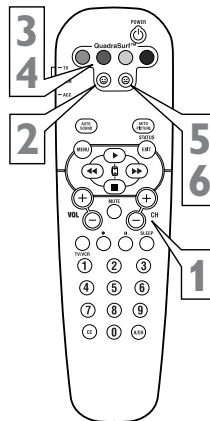
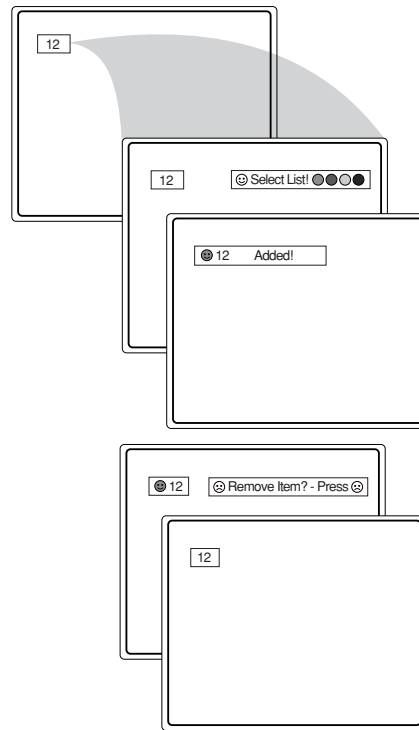

The Quadra Surf buttons on your remote control allow you to store up to 10 channels per button (40 total). You can even program the A/V Input channels for each button making them a "source" button.

Assuming channels have now been added to the four Quadra Surf lists (the four colored buttons, see the previous page), let's review how the feature works.

- 1** Press one of the pre-programmed COLORED buttons on the remote (Red, Green, Yellow or Blue). The screen will display a smiley face with the first programmed channel for that surf list.
- 2** While the colored "smiley" face still appears on the screen, press the same COLORED button on the remote to tune the second channel programmed for that specific surf list.
- 3** Repeatedly pressing the same COLORED button while the "smiley" face appears will tune all the programmed channels. Pressing the COLORED button again will return you to the first channel in the list.

If the "smiley" face disappears from the screen and the same COLORED button is pressed, the surf channels will be displayed starting with the FIRST programmed channel again.

- 4** Repeat steps 1-3 for the other three COLORED buttons (Surf lists) if desired.
- 5** Any time the "smiley" face appears with the channel number, pressing the "frownie" face button will allow you to remove it from the list (see the previous page for more details).

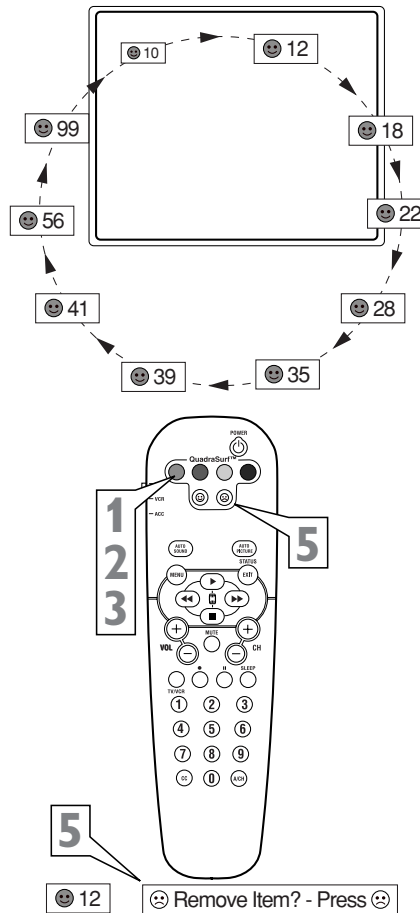

33 REMOTE USE - CODE ENTRY FOR ACCESSORIES

If your remote control will not operate your accessory devices, look up the four-digit code listed by your brand on panels 35-37.

Please read through steps 1-5 before beginning.

- 1** Place the TV/VCR/ACC Mode Switch in the proper position.
- 2** Press the VCR • RECORD button on the remote control and release.
- 3** Press the AUTO SOUND button on the remote within 30 seconds, then release.
- 4** Enter the FOUR-DIGIT REMOTE CODE NUMBER for your desired device. The remote is now ready to send commands to the unit.
- 5** Point the remote at the Device. Press the POWER button on the remote to turn the unit ON.

If this doesn't work the first time, repeat the steps using another remote code number.



VCR



Cable Box



DBS or other Accessory Device

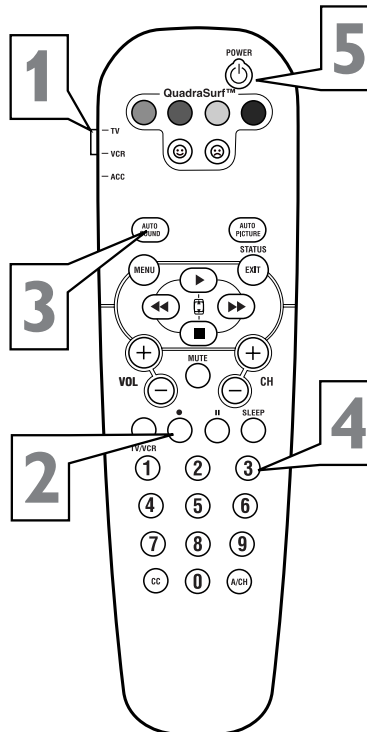

34 REMOTE USE - SEARCH METHOD FOR ACCESSORIES

The Search Method of programming your remote can take as long as 12 minutes to perform so we recommend you use it as a last resort.

Please read all the steps below before beginning.

- 1** Press the **POWER** button on the device you are attempting to program to turn it ON.
- 2** If programming a VCR or DVD type product that has a **STOP** play command, place a VCR Tape or DVD disc into the device. Press the **PLAY** button.
- 3** Place the **TV/VCR/ACC Mode Switch** in the proper position. VCR for programming Video Cassette Recorders or ACC for all other accessory devices.
- 4** Press the **VCR • RECORD** and the **AUTO SOUND** buttons simultaneously and hold them down.
As you continue to hold down buttons, the remote will run through its programmed code list with a command for the VCR or DVD to **STOP** play. Or, for Cable Boxes and Satellite Receivers the command will be to **CHANGE CHANNELS**.
- 5** When the **STOP** command happens release the two buttons.
Or for Cable Boxes and Satellite Receivers, as soon as the channel changes **ONCE, IMMEDIATELY** release the two buttons.

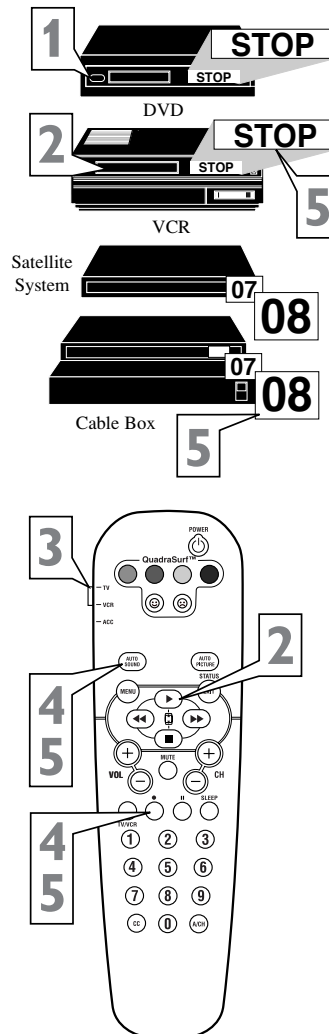

VCR CODES

Admiral2027, 2052
 Aiwa .2001, 2017, 2062, 2070, 2072
 Akai .2021, 2029, 2038, 2060, 2063
 Audiovox2017
 Blaupunkt .2003, 2005, 2010, 2014,
 .2041, 2042, 2048, 2054, 2055, 2075
 Broksonic2002, 2040,
2046, 2052, 2078
 Craig .2017, 2026, 2034, 2057, 2058
 Curtis Mathes 2015, 2021, 2032, 2042
 Daewoo 2011, 2024, 2025, 2059, 2083
 Denon2022
 Dumont2001, 2035, 2037
 Dynatech2001
 Electrohome2017
 Emerson 2001, 2002, 2017,
 2023, 2040, .2046, 2051, 2052, 2059,
 2078, 2083
 Fisher2025, 2026, 2030, 2037
 Funai2001
 GE2015, 2027, 2032, 2057
 Go Video2077, 2081
 Goldstar .2017, 2018, 2053, 2079
 Granada2025, 2035, 2037
 Grundig2003, 2005, 2007,
2010, 2034, 2035, 2048,
2050, 2054, 2069, 2071, 2075
 Harley Davidson2001
 Harman/Kardon2018, 2035
 Hitachi2001, 2004,
2021, 2022, 2043, 2057
 Hughes Network Systems2022
 Jensen2021
 JVC2008, 2021,
2033, 2049, 2050, 2074, 2080
 Kenwood2018, 2021, 2033
 KLH2034
 Kodak2015, 2017
 LG2079
 Lloyd's2001, 2051
 Loewe2004, 2005, 2017, 2035
 LXI2017
 Magnavox .2001, 2015, 2019, 2035

VCR CODES

Marantz2003, 2005, 2015, 2035
 Matsushita2015, 2042, 2055
 Memorex .2001, 2015, 2017, 2019,
2025, 2026, 2027, 2037, 2052,
2057, 2062, 2085, 2087, 2088
 MGA2023, 2057
 Minolta2022

Mitsubishi2023, 2027,
2033, 2035, 2045
 Motorola2015, 2027
 NEC .2018, 2020, 2021, 2033, 2037
 Nikon2014
 Nokia2025, 2037, 2038, 2057
 Nokia .2021, 2025, 2037, 2038, 2057
 Olympus2015, 2054
 Optimus .2017, 2027, 2031, 2037,
2042, 2077, 2086, 2087, 2088
 Orion2002, 2004, 2016, 2036,
2046, 2052, 2070, 2072, 2078
 Panasonic2015, 2042, 2053,
2054, 2055, 2087
 Philco2015, 2018, 2052, 2078
 Philips 2015, 2035 (DEFAULT VCR),
2074, 2075
 Pioneer2031, 2033, 2035
 Portland2011
 Proscan2032
 Protec2034
 Quasar2015, 2042, 2087
 Radio Shack2001, 2085
 RCA .2015, 2022, 2027, 2032, 2038,
2057
 Realistic2001, 2015, 2017,
2025, 2026, 2027, 2037
 Ricoh2014
 Runco2019
 Samsung .2024, 2057, 2076, 2077
 Sansui2001, 2021, 2033,
2052, 2058, 2078
 Sanyo2025, 2026, 2037, 2057
 Scott2023, 2024, 2040, 2046
 Sears2001, 2015, 2017,
2022, 2025, 2026, 2037
 Sharp2027, 2073
 Shintom2034, 2037
 Sony2001, 2012, 2013, 2014, 2015
 Sylvania2001, 2015, 2023, 2035
 Symphonic2001
 Teac2001, 2021
 Technics2015, 2042, 2054
 Teknika2001, 2015, 2007, 2017
 Thomson2021, 2064, 2074
 Toshiba 2021, 2023, 2024, 2035, 2074
 Victor2008, 2021, 2033
 Video Concepts2020, 2024
 Wards2001, 2015, 2022, 2026,
2027, 2032, 2034, 2035, 2057
 White Westinghouse2052, 2059
 Yamaha2018
 Zenith .2001, 2014, 2019, 2052, 2078

DIGITAL VIDEO DISC CODES

Akai	5316
Harman/Kardon	5314
JVC	5311, 5318
Kenwood	5307
Magnavox	5302
Mitsubishi	5303
Onkyo	5302, 5317, 5319
Panasonic	5301, 5322
Philips .5302, 5308 (DEFAULT DVD)	
Pioneer	5305, 5312, 5321
Proscan	5304
RCA	5304
Samsung	5313
Sharp	5320
Sony	5306
Technics	5301
Thomson	5310
Toshiba	5302
Yamaha	5301, 5309

CABLE CODES

ABC	3002, 3003, 3004, 3006, 3008
Bell & Howell	3006
Cabletime	3016, 3019, 3025, 3029
Decsat	3027
.....	3007
General Instrument	3004, 3020, 3031, 3046
Goldstar	3014, 3047
Grundig	3035
Hitachi	3004
Jasco	3007
Jerrold	3002, 3004, 3005, 3006, 3007, 3020, 3031, 3046
LG Alps	3044
Memorex	3001
Oak	3009
Pacific	3039
Panasonic	3001, 3013
Paragon	3001
Pioneer	3014, 3036
Pulsar	3001
Quasar	3001
Radio Shack	3007
Rembrandt	3004
Runco	3001
Samsung	3014, 3040
Satbox	3024
Scientific	3003, 3032, 3049
Scientific Atlanta	3003, 3008, 3021

Signal	3007
Signature	3004
Starcom	3002, 3007
Stargate	3007
Starquest	3007
STS	3015
Tusa	3007
United Cable	3002
Videoway	3017
Zenith	3001, 3034

SATELLITE CODES

Amstrad	4003, 4016, 4025, 4038, 4039, 4042
Armstrong	4015
AST	4027
Astro	4008, 4039, 4045
Avalon	4031
Axis	4030, 4046
Best	4030
Blaupunkt	4008
Brain Wave	4022
Bush	4002
Cambridge	4024
Channel Master	4029
Comlink	4019
Echostar	4031, 4036, 4061
Ferguson	4002, 4009, 4010, 4023
Fidelity	4016
General Instrument	4012
Grundig	4008, 4010, 4048
G-sat	4009
Hirschmann	4008, 4032, 4039, 4040, 4049
Hitachi	4037
Houston	4053
Intervision	4050
ITT	4005
JVC	4048
Lennox	4050
Luxor	4005, 4049
Manhattan	4037, 4045, 4050
Marantz	4011
Maspro	4004, 4023
Matsui	4024, 4048
Neusat	4057
Newhaus	4013
Nokia	4005, 4032, 4037, 4049, 4054, 4063
Pace	4002, 4009, 4014, 4023, 4037, 4055, 4058

37

REMOTE CONTROL CODE ENTRY LIST

SATELLITE CODES

Philips	4007, 4011, 4020,	Sony	4017, 4018
.....	4037, 4048, 4059	Sunstar	4043
Pioneer	4021, 4059	Telefunken	4034
Planet	4061	Telesat	4051
Promax	4037	Thomson	4037, 4059
Prosat	4019	Triad	4027
Quadral	4029, 4044	Triasat	4040
Sabre	4037	Universum	4008, 4049
SAT	4027, 4038	Ventana	4011
Satcom	4026, 4051	Vortec	4034
SEG	4030, 4034	Vtech	4027
Siemens	4008	Xcom Multimedia	4065
Skymaster	4019, 4044, 4051	Xsat	4006, 4065

TROUBLESHOOTING

No Power

- Check the TV power cord. Unplug the TV, wait 10 seconds, then reinsert the plug into the outlet and push the POWER button again.
- Check that the outlet is not on a wall switch.
- Be sure the fuse is not blown on the AC power strip, if one is being used.

No Picture

- Check antenna connections. Are they properly secured to the TV's ANT 75Ω plug?
- Check the TUNER MODE control for the correct tuner setting.
- Try running the Auto Program feature to find all available channels.
- Press the AV button on the remote to make sure the correct signal source is selected (FRONT or Current Channel).

No Sound

- Check the VOLUME buttons.
- Check the MUTE button on the remote control.
- If you're attempting to hook up auxiliary equipment, check the audio jack connections located on the front of the TV.

Remote Does Not Work

- Check the batteries. If necessary, replace them with AA Heavy Duty (Zinc Chloride) or Alkaline batteries.
- Clean the remote control and the remote control sensor window on the TV.
- Check the TV power cord. Unplug the TV, wait 10 seconds, then reinsert the plug into the outlet and push the POWER button again.
- Be sure the fuse is not blown on the AC power strip, if one is being used.
- Check to be sure the TV outlet is not on a wall switch.

TV Displays Wrong Channel or No Channels Above 13

- Repeat channel selection.
- Add the desired channel numbers (using the CHANNEL EDIT control) into the TV's memory.
- Check to be sure the TUNER MODES are set to the CABLE option and run the Auto Program feature to find all available channels.

**RENEWED
90 DAY
LIMITED WARRANTY**

Free Manuals Download Website

<http://myh66.com>

<http://usermanuals.us>

<http://www.somanuals.com>

<http://www.4manuals.cc>

<http://www.manual-lib.com>

<http://www.404manual.com>

<http://www.luxmanual.com>

<http://aubethermostatmanual.com>

Golf course search by state

<http://golfingnear.com>

Email search by domain

<http://emailbydomain.com>

Auto manuals search

<http://auto.somanuals.com>

TV manuals search

<http://tv.somanuals.com>