

6. Louver Shielding

Ordering Information

Family	Series	Type	Lamps	Color	Wattage	Voltage	Length	Options
F7	4 4 = Block w/ Lens	4 4 = Louver	2 2 = 2 Lamps	AL = Aluminum WH = White	1 = 28W 2 = 54W 3 = 28W Dimming 4 = 28W EM 5 = 54W Dimming 6 = 54W EM	1 = 120v 2 = 277v	4 = 4' (121.92cm) 8 = 8' (243.84cm)	X4 = 4 Through Wires X5 = 5 Through Wires DS = Dual Switch

Complete Ordering Instructions below.

Features for Suspended Modules

- Housing:** Single piece of high purity extruded aluminum, a portion from recycled material. Extruded acrylic lens reveal installed on the top of the housing, runs the length of the housing.
- Housing End:** Die-cast aluminum, welded in place.
- End Cap:** Die-cast aluminum. Encloses the suspension cable and power feed cord for the end of the run.
- Lamps:** F28T5 or F54T5HO as specified. By others. Installed from the ceiling side of the luminaire.
- Ballast:** Electronic. Meets ANSI starting, end-of-life protection and sound rating specifications. Low THD.
- Shielding:** Integral, regressed flat louver blades punched and formed from fixture housing, finished to match, no light leaks. Blades are .56" (1.42cm) high on .75" (1.91cm) centers.

Electrical

Connections: 18 gauge pre-wired with polarized cannon plug connectors for simultaneous mechanical/electrical connection.

Emergency Battery Pack: 90 minute operation, 700 lumens for 54W and 520 lumens for 28W.

Dimming: Advance Mark X standard (no additional wires required); use compatible dimmer. Dimming ballasts using additional control wires (eg Lutron Hi-Lume or ECO-10, Osram) can be used; consult factory and use X4 or X5 power feeds with additional leads, as appropriate. Ballast not to exceed 1.25" (3.18cm) wide by 1.20" (3.05cm) high.

iGEN: F7000 accepts iGEN (DALI) with supplemental 2-wire control technology. Use with X5 power feed.

Power Tray: Code-gauge, die-formed steel, pre-paint white enamel finish; secured by quarter-turn fasteners for easy access to wiring. Holds ballasts, sockets, and wiring. Accepts ballasts up to 1.25" (3.18cm) wide by 1.20" (3.05cm) high.

Power Feeds: Standard 18/3 power feed is rated for 10 amps. X4 power feed is 18/4 and is rated for 7 amps. Observe amperage limitations and provide additional Intermediate Power Cables, as required. When providing an additional power feed, the through wiring from the previous module must be disconnected from the cannon plug and capped.

Dual Switching: Use DS option for separate switching of the lamp rows. DS includes a 4th through wire. Use X4 power feed.

Factory installed ballast disconnect allows the ballast to be disconnected from and reconnected to incoming power under load without turning the entire circuit off.

Finish

Powder-coated, baked enamel, white or aluminum, as specified.

Mounting

Cable suspension is on 48" (121.92cm) and 96" (243.94cm) centers and consists of a 4 1/2" (11.43cm) diameter canopy finished white enamel and a 1/16" (0.16cm) diameter stainless steel aircraft cable adjustable up to 36" (91.44cm).

Labels

UL, cUL and I.B.E.W.

Ordering Instructions

Individual Fixtures:

- Order one MODULE.
- Order one POWER FEED END SET

Continuous Rows:

- Order the appropriate number of MODULES for the complete run.
- Order one POWER FEED END SET.
- Order one INTERMEDIATE CABLE SET per MODULE minus one.
- For runs that exceed amperage limits, order the appropriate number of CABLE/CORD SETS.

Job Information

Type:

Job Name:

Cat. No.:

Lamp(s):

Notes:

631 Airport Road, Fall River, MA 02720 • (508) 679-8131 • Fax (508) 674-4710
We reserve the right to change details of design, materials and finish.
www.lightolier.com © 2008 Philips Group • E0808

Performance

CANDLEPOWER CURVE

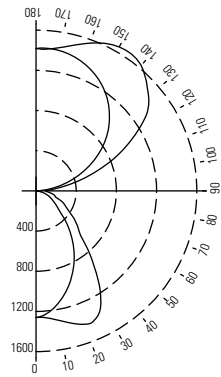

REPORT NO.: ITL54677.IES
 LAMPS: 2-F54T5
 LUMENS: 5000 each
 EFFICIENCY: 81.7%
 CAT. NO.: F7442WH214

CANDLEPOWER

ZONE DEG.	0	22	45	67	90
CANDELAS					
0	1260	1260	1260	1260	1260
5	1227	1246	1253	1262	1269
15	1074	1125	1211	1310	1363
25	871	961	1147	1331	1403
35	643	762	989	1055	1076
45	406	566	652	641	628
55	244	353	364	423	451
65	158	215	241	280	310
75	83	125	156	184	196
85	16	52	83	110	118
95	60	149	148	162	164
105	321	520	527	520	508
115	581	819	938	948	945
125	829	1046	1224	1322	1348
135	1033	1197	1427	1523	1551
145	1198	1301	1499	1618	1662
155	1317	1374	1486	1583	1620
165	1393	1413	1446	1483	1504
175	1424	1427	1418	1415	1418
180	1417	1417	1417	1417	1417

COEFFICIENTS OF UTILIZATION

% EFFECTIVE CEILING CAVITY REFLECTANCE

ROOM CAVITY RATIO	WALL REFLECTANCE								
	80%			70%			50%		
	50	30	10	50	30	10	50	30	10
0	85	85	85	76	76	76	61	61	61
1	74	70	67	67	64	62	53	51	49
2	65	60	56	59	54	51	47	44	42
3	57	51	47	51	47	43	42	38	35
4	50	45	40	46	41	36	37	33	30
5	46	39	34	41	35	31	33	29	27
6	41	34	29	37	31	28	30	26	23
7	36	30	26	33	28	24	28	23	20
8	33	27	23	30	25	21	25	21	18
9	30	25	20	28	23	19	23	19	16
10	28	22	18	26	20	17	21	17	14

20% FLOOR CAVITY REFLECTANCE

DISTRIBUTION

Zone	Lumens	% Lamp	% Luminaire
0 - 90	2701	26.6	33.0
90 - 180	5491	55.1	67.0
0 - 180	8191	81.7	100.0

Fixture Lengths & Mounting Reflected (Plan View)

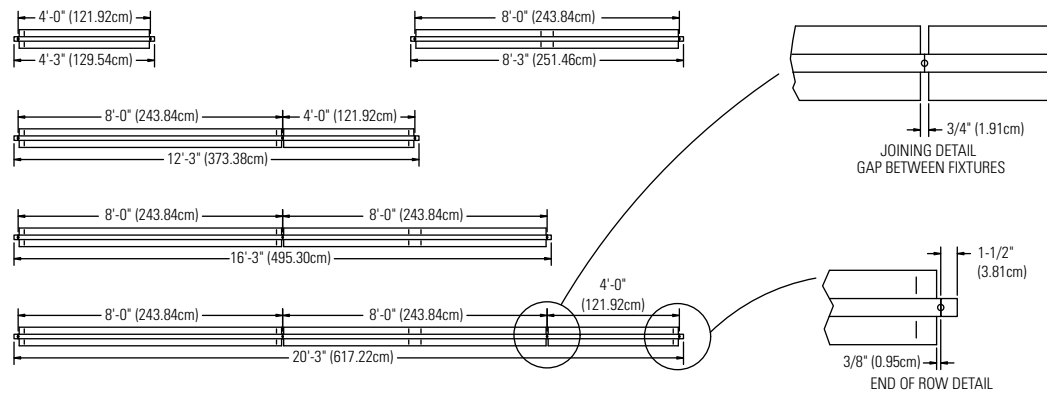

Mounting Accessories

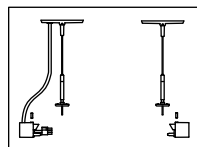

Power Feed End Set:
F7EC36WH = White
F7EC36AL = Aluminum
F7EC36WHX4 = White 4 Wire
F7EC36ALX4 = Aluminum 4 Wire
F7EC36WHX5 = White 5 Wire
F7EC36ALX5 = Aluminum 5 Wire

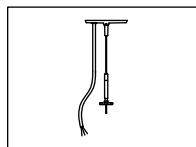

Intermediate Power Cable
F7CC36 = 3 Wire
F7CC36X4 = 4 Wire

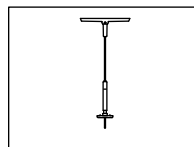

Intermediate Cable Set
F7C36

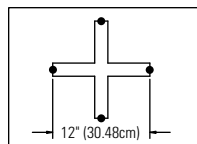

"X" Joiner Block
F7XWH = White
F7XAL = Aluminum

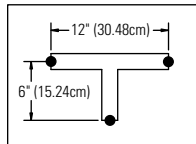

"T" Joiner Block
F7TWH = White
F7TAL = Aluminum

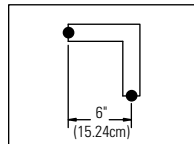

"L" Joiner Block
F7LWH = White
F7LAL = Aluminum

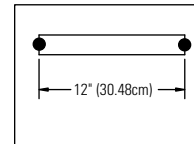

Inline Joiner Block
F7ILWH = White 1' (30.48cm) **F7IL4WH** = White 4' (121.92cm)
F7ILAL = Aluminum 1' (30.48cm) **F7IL4AL** = Aluminum 4' (121.92cm)
F7IL2WH = White 2' (60.96cm) **F7IL8WH** = White 8' (243.84cm)
F7ILZAL = Aluminum 2' (60.96cm) **F7IL8AL** = Aluminum 8' (243.84cm)

Job Information Type:

631 Airport Road, Fall River, MA 02720 • (508) 679-8131 • Fax (508) 674-4710
 We reserve the right to change details of design, materials and finish.
 www.lightolier.com © 2008 Philips Group • E0808

Free Manuals Download Website

<http://myh66.com>

<http://usermanuals.us>

<http://www.somanuals.com>

<http://www.4manuals.cc>

<http://www.manual-lib.com>

<http://www.404manual.com>

<http://www.luxmanual.com>

<http://aubethermostatmanual.com>

Golf course search by state

<http://golfingnear.com>

Email search by domain

<http://emailbydomain.com>

Auto manuals search

<http://auto.somanuals.com>

TV manuals search

<http://tv.somanuals.com>