

Pioneer *sound.vision.soul*

SX-315

Audio Multi-Channel Receiver

Discover the benefits of registering your product online at www.pioneer.co.uk
(www.pioneer-eur.com).

Operating Instructions

IMPORTANT



The lightning flash with arrowhead symbol, within an equilateral triangle, is intended to alert the user to the presence of uninsulated "dangerous voltage" within the product's enclosure that may be of sufficient magnitude to constitute a risk of electric shock to persons.

CAUTION

**RISK OF ELECTRIC SHOCK
DO NOT OPEN**

CAUTION:
TO PREVENT THE RISK OF ELECTRIC SHOCK, DO NOT REMOVE COVER (OR BACK). NO USER-SERVICEABLE PARTS INSIDE. REFER SERVICING TO QUALIFIED SERVICE PERSONNEL.





The exclamation point within an equilateral triangle is intended to alert the user to the presence of important operating and maintenance (servicing) instructions in the literature accompanying the appliance.

D3-4-2-1-1_En-A

Replacement and mounting of an AC plug on the power supply cord of this unit should be performed only by qualified service personnel.

IMPORTANT: THE MOULDED PLUG

This appliance is supplied with a moulded three pin mains plug for your safety and convenience. A 5 amp. Fuse is fitted in this plug. Shall the fuse need to be replaced, please ensure that the replacement fuse has a rating of 5 amps and that it is approved by ASTA or BSI to BS1362.

Check for the ASTA mark  or the BSI mark  body of the fuse.

If the plug contains a removable fuse cover, you must ensure that it is refitted when the fuse is replaced. If you lose the fuse cover the plug must not be used until a replacement cover is obtained. A replacement fuse covers can be obtained from your dealer.

If the fitted moulded plug is unsuitable for your socket outlet, then the fuse shall be removed and the plug cut off and disposed of safely. There is a danger of severe electrical shock if the cut off plug is inserted into 13 amp socket.

If a new plug is to be fitted, please observe the wiring code as shown below. If in any doubt, please consult a qualified electrician.

IMPORTANT: The wires in this mains lead are coloured in accordance with the following code:

Blue : Neutral

Brown : Live

As the colours of the wires in the mains lead of this appliance may not correspond with coloured markings identifying the terminals in your plug, proceed as follows :

- The wire which is coloured BLUE must be connected to the terminal which is marked with the letter **N** or coloured BLACK.
- The wire which is coloured BROWN must be connected to the terminal which is marked with the letter **L** or coloured RED.

D3-4-2-1-2_2_A_En

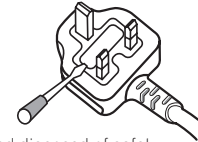

WARNING

This equipment is not waterproof. To prevent a fire or shock hazard, do not place any container filled with liquid near this equipment (such as a vase or flower pot) or expose it to dripping, splashing, rain or moisture.

D3-4-2-1-3_A_En

WARNING

To prevent a fire hazard, do not place any naked flame sources (such as a lighted candle) on the equipment.

D3-4-2-1-7a_A_En

WARNING

Before plugging in for the first time, read the following section carefully.

The voltage of the available power supply differs according to country or region. Be sure that the power supply voltage of the area where this unit will be used meets the required voltage (e.g., 230 V or 120 V) written on the rear panel.

D3-4-2-1-4_A_En

Operating Environment

Operating environment temperature and humidity:
+5 °C to +35 °C (+41 °F to +95 °F); less than 85 %RH
(cooling vents not blocked)

Do not install this unit in a poorly ventilated area, or in locations exposed to high humidity or direct sunlight (or strong artificial light)

D3-4-2-1-7c_A_En

VENTILATION CAUTION

When installing this unit, make sure to leave space around the unit for ventilation to improve heat radiation (at least 60 cm at top, 10 cm at rear, and 30 cm at each side).

WARNING

Slots and openings in the cabinet are provided for ventilation to ensure reliable operation of the product, and to protect it from overheating. To prevent fire hazard, the openings should never be blocked or covered with items (such as newspapers, table-cloths, curtains) or by operating the equipment on thick carpet or a bed.

D3-4-2-1-7b_A_En

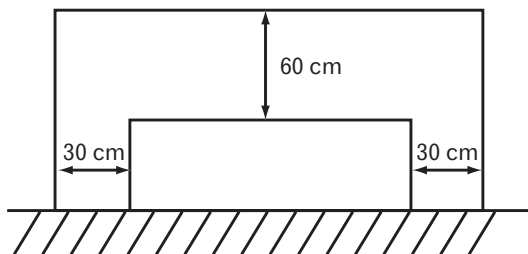
**CAUTION**

The \odot STANDBY/ON switch on this unit will not completely shut off all power from the AC outlet. Since the power cord serves as the main disconnect device for the unit, you will need to unplug it from the AC outlet to shut down all power. Therefore, make sure the unit has been installed so that the power cord can be easily unplugged from the AC outlet in case of an accident. To avoid fire hazard, the power cord should also be unplugged from the AC outlet when left unused for a long period of time (for example, when on vacation).

POWER-CORD CAUTION

Handle the power cord by the plug. Do not pull out the plug by tugging the cord and never touch the power cord when your hands are wet as this could cause a short circuit or electric shock. Do not place the unit, a piece of furniture, etc., on the power cord, or pinch the cord. Never make a knot in the cord or tie it with other cords. The power cords should be routed such that they are not likely to be stepped on. A damaged power cord can cause a fire or give you an electrical shock. Check the power cord once in a while. When you find it damaged, ask your nearest PIONEER authorized service center or your dealer for a replacement.

S002_En

If the AC plug of this unit does not match the AC outlet you want to use, the plug must be removed and appropriate one fitted. Replacement and mounting of an AC plug on the power supply cord of this unit should be performed only by qualified service personnel. If connected to an AC outlet, the cut-off plug can cause severe electrical shock. Make sure it is properly disposed of after removal. The equipment should be disconnected by removing the mains plug from the wall socket when left unused for a long period of time (for example, when on vacation).

D3-4-2-1a_A_En

This product is for general household purposes. Any failure due to use for other than household purposes (such as long-term use for business purposes in a restaurant or use in a car or ship) and which requires repair will be charged for even during the warranty period.

K041_En

This product complies with the Low Voltage Directive (73/23/EEC, amended by 93/68/EEC), EMC Directives (89/336/EEC, amended by 92/31/EEC and 93/68/EEC).

D3-4-2-1-9a_En



If you want to dispose this product, do not mix it with general household waste. There is a separate collection system for used electronic products in accordance with legislation that requires proper treatment, recovery and recycling.

Private households in the 25 member states of the EU, in Switzerland and Norway may return their used electronic products free of charge to designated collection facilities or to a retailer (if you purchase a similar new one).

For countries not mentioned above, please contact your local authorities for the correct method of disposal.

By doing so you will ensure that your disposed product undergoes the necessary treatment, recovery and recycling and thus prevent potential negative effects on the environment and human health.

K058_En

Contents

Contents

01 Before you start

Checking what's in the box.....	5
Loading the batteries	5
Operating range of remote control unit	5
Ventilation	5

02 Connecting up

Making cable connections	6
Connecting to a TV and DVD recorder or player	6
Connecting a satellite receiver or other digital set-top box	7
Connecting a tape deck or VCR	7
Connecting antennas	8
Connecting the speakers	9
Plugging in.....	10

03 Controls and displays

Front panel.....	11
Display.....	12
Remote control.....	13

04 Surround sound setup

Introduction to home theater	15
Switching on	15
Quick setup using the Room Setup	15
Setting speaker distances.....	16
Setting individual channel levels	16

05 Listening to your system

Selecting a source	18
Using the Auto listening mode.....	18
Listening in surround sound.....	19
Listening in stereo	19
Using the Sound modes.....	19
Using the tone controls	20
Listening through headphones.....	20
Dynamic Range Control setting	20
Dual Mono setting	21
Using the sleep timer	21

06 Using the tuner

Listening to the radio	22
Saving station presets	22
Listening to station presets.....	23

07 Additional information

Troubleshooting	24
Cleaning the unit	25
Input attenuator setting	25
Resetting the receiver.....	25
Specifications.....	26

Before you start

01

English

Chapter 01: Before you start

Checking what's in the box

Please check that you've received the following supplied accessories:

- AM loop antenna
- FM wire antenna
- Dry cell batteries (AA size IEC R6) x2
- Remote control
- Warranty card
- These operating instructions

Loading the batteries

- 1 Open the battery compartment on the rear of the remote control.

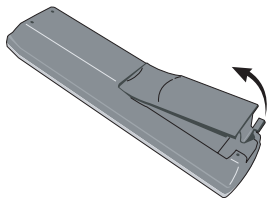

- 2 Insert the supplied batteries following the markings inside the battery compartment to align them correctly.

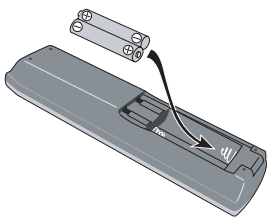

- 3 Replace the battery compartment cover.

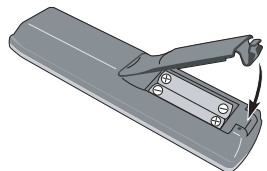

Important

Incorrect use of batteries may result in such hazards as leakage and bursting. Observe the following precautions:

- Never use new and old batteries together.
- Insert the plus and minus sides of the batteries properly according to the marks in the battery case.
- Batteries with the same shape may have different voltages. Do not use different batteries together.
- When disposing of used batteries, please comply with governmental regulations or environmental public instruction's rules that apply in your country or area.

WARNING

- Do not use or store batteries in direct sunlight or other excessively hot place, such as inside a car or near a heater. This can cause batteries to leak, overheat, explode or catch fire. It can also reduce the life or performance of batteries.

Operating range of remote control unit

The remote control may not work properly if:

- There are obstacles between the remote control and the receiver's remote sensor.
- Direct sunlight or fluorescent light is shining onto the remote sensor.
- The receiver is located near a device that is emitting infrared rays.
- The receiver is operated simultaneously with another infrared remote control unit.

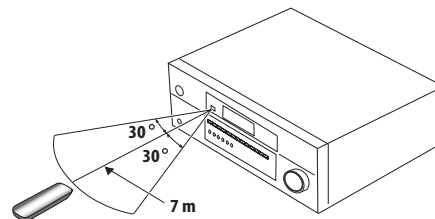

Ventilation

The receiver should be properly ventilated to prevent overheating.

- Do not place anything directly on top of the receiver.
- Do not use the receiver on a thick carpet or other soft surface.

5

En

Chapter 02: Connecting up

Making cable connections

Make sure not to bend the cables over the top of this unit (as shown in the illustration). If this happens, the magnetic field produced by the transformers in this unit may cause a humming noise from the speakers.

Important

- Before making or changing any connections, switch off the power and disconnect the power cable from the AC outlet.

Audio cables (analog)

Use audio cables (not supplied) to connect audio components.

Connect red plugs to **R** (right) jacks, white plugs to **L** (left).

Be sure to insert completely.

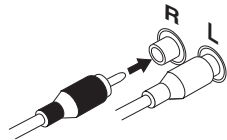

Coaxial and Optical digital audio cables

Coaxial digital audio cables (standard video cables can also be used) or optical cables are used to connect digital components to this receiver.

Be sure to insert completely.

Coaxial digital audio cable
(or standard video cable)

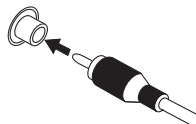

Optical cable

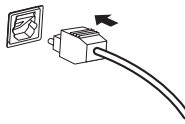

- When inserting the plug of an optical cable, be careful not to damage the shutter protecting the optical jack.
- Do not bend optical cables around sharp corners as they may be damaged. When storing, coil loosely.

Connecting to a TV and DVD recorder or player

The diagram below shows the connections for a basic home theater setup of a TV, DVD recorder (or player) and this receiver.

Audio is output from the DVD recorder's coaxial digital audio jack, while the video output goes to the TV. Also shown is a stereo analog audio connection from your TV to this receiver so you can enjoy sound from this receiver when watching TV programs.

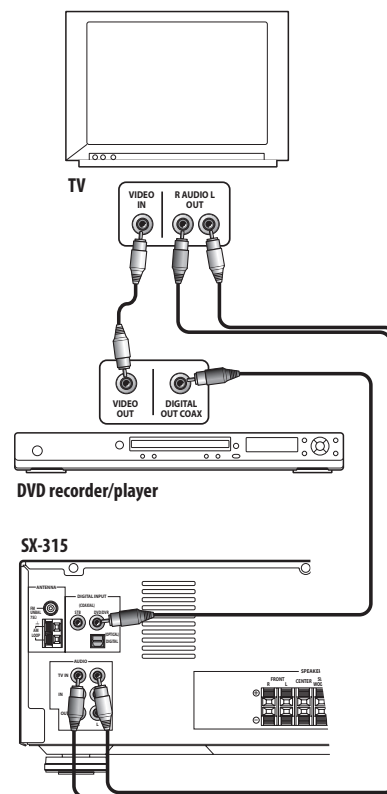

Note

- If your DVD recorder only has an optical digital output, you can still connect it to this receiver using the **OPTICAL DIGITAL** jack. In this case you will have to select the **DIGITAL** input function rather than **DVD**.

Connecting up

02

English

Connecting a satellite receiver or other digital set-top box

The diagram below shows the connections for a digital set-top box (digital satellite receiver, decoder, cable box, digital terrestrial receiver, etc.). Connect the digital audio output of the set-top box (STB) to the **STB** input on this receiver. Connect the video output from the STB directly to a spare video input on your TV.

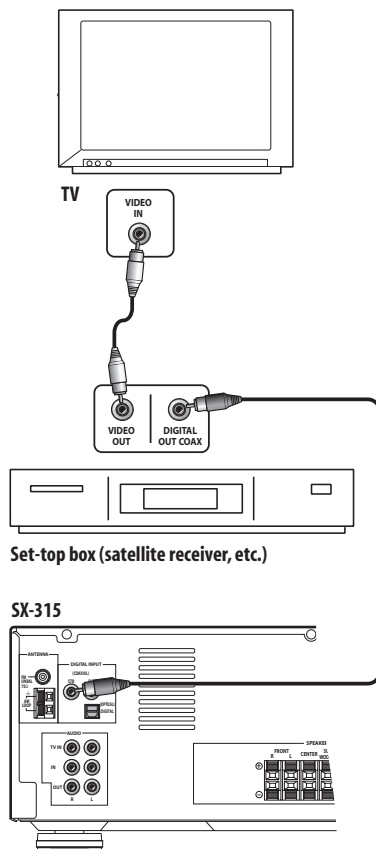

Note

- If your STB only has an optical digital output, you can still connect it to this receiver using the **OPTICAL DIGITAL** jack. In this case you will have to select the **DIGITAL** input function rather than **STB**.

Connecting a tape deck or VCR

The diagram below shows a tape deck or VCR connected to the receiver using two sets of stereo analog audio cables, one set for the audio input and one set for output from the receiver for recording.

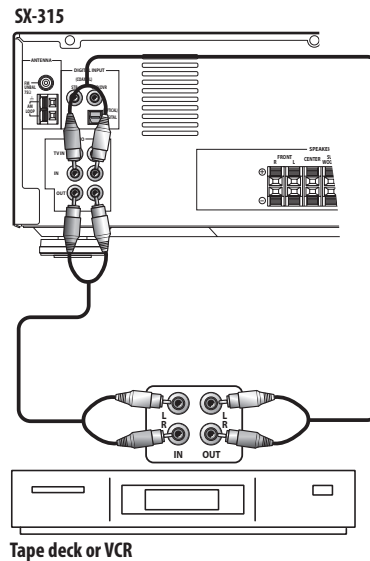

Note

- You can only record from analog audio sources (**TV** or **FM/AM** inputs). Audio from the digital inputs is not recordable from the analog outputs.

7

En

Connecting antennas

Connect the AM loop antenna and the FM wire antenna as shown below. To improve reception and sound quality, connect external antennas (see *Using external antennas* below). Always make sure that the receiver is switched off and unplugged from the wall outlet before making or changing any connections.

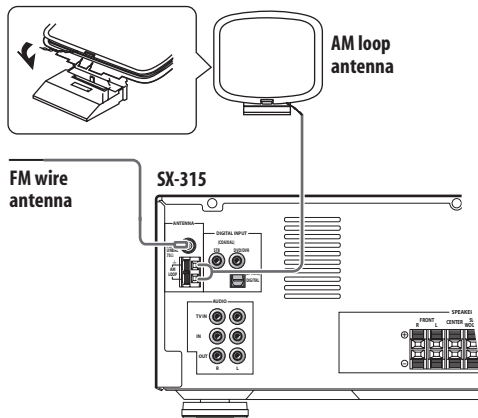

FM wire antenna

Connect the FM wire antenna and fully extend along a window frame or another suitable place that gives good reception.

AM loop antenna

Assemble the antenna and connect to the receiver. Attach (if necessary) and face in the direction that gives the best reception.

If you want to attach the loop antenna to a wall, assemble as shown below.

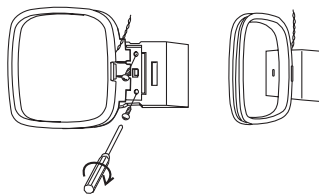

Antenna snap connectors

Twist the exposed wire strands together and insert into the hole, then snap the connector shut.



Using external antennas

To improve FM reception

Connect an external FM antenna.

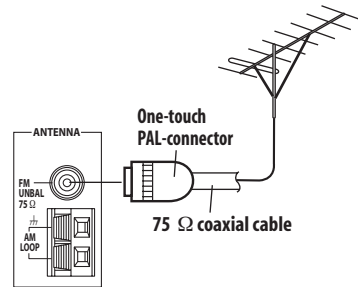

To improve AM reception

Connect a 5 m to 6 m length of vinyl-coated wire to the AM antenna terminal without disconnecting the supplied AM loop antenna.

For the best possible reception, suspend horizontally outdoors.

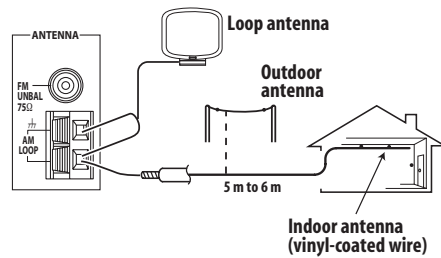

Connecting up

02

English

Connecting the speakers

The diagram below shows a complete surround sound setup of six speakers set up in a typical configuration. For the best sound, try to follow this setup in your room as closely as possible.

Make sure the positive (colored) and negative (black) terminals on the receiver match those on the speakers. You can use speakers with a nominal impedance between 6 Ω and 16 Ω .

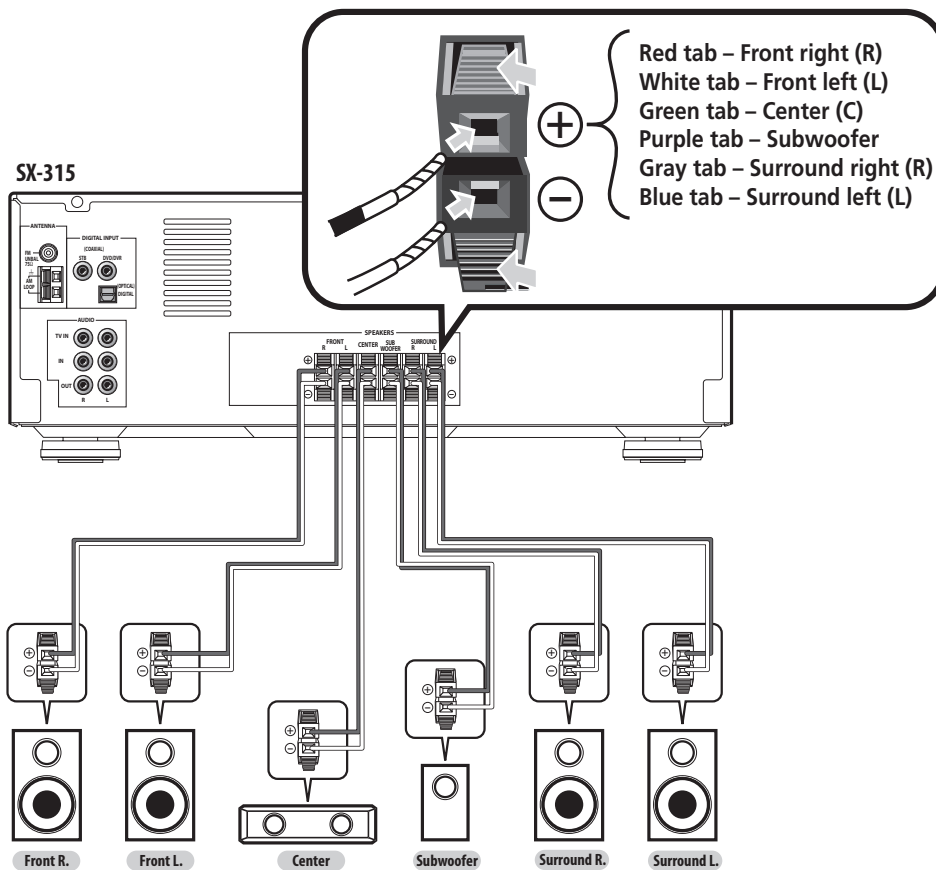

Hints on speaker placement

Speakers are usually designed with a particular placement in mind. Some are designed to be floorstanding, while others should be placed on stands to sound their best. Some should be placed near a wall; others should be placed away from walls. We have provided a few tips on getting the best sound from your speakers (following), but you should also follow the guidelines on placement that the speaker manufacturer provided with your particular speakers to get the most out of them.

- Place the front left and right speakers at equal distances from the TV.

- When placing speakers near the TV, we recommend using magnetically shielded speakers to prevent possible interference, such as discoloration of the picture when the TV is switched on. If you do not have magnetically shielded speakers and notice discoloration of the TV picture, move the speakers farther away from the TV.
- Place the center speaker above or below the TV so that the sound of the center channel is localized at the TV screen.
- If possible, place the surround speakers slightly above ear level.

9

En

- Try not to place the surround speakers further away from the listening position than the front and center speakers. Doing so can weaken the surround sound effect.

Caution

- If you choose to install the center speaker on top of the TV, be sure to secure it with putty, or by other suitable means, to reduce the risk of damage or injury resulting from the speaker falling from the TV in the event of external shocks such as earthquakes.
- Make sure no exposed speaker wire is touching the rear panel, this may cause the receiver to turn off automatically.
- These speaker terminals are hazardous when live. To prevent the risk of electric shock when connecting or disconnecting the speaker cables, disconnect the power cable.
- These speaker terminals carry **HAZARDOUS LIVE** voltage. To prevent the risk of electric shock when connecting or disconnecting the speaker cables, disconnect the power cord before touching any uninsulated parts.

Plugging in

After making sure that everything is connected properly, connect the attached power cable to a wall outlet.

Power cord caution

Handle the power cord by the plug. Do not pull out the plug by tugging the cord and never touch the power cord when your hands are wet as this could cause a short circuit or an electric shock. Do not place the unit, a piece of furniture, etc., on the power cord, or pinch the cord. Never make a knot in the cord or tie it with other cords. The power cords should be routed such that they are not likely to be stepped on. A damaged power cord can cause a fire or give you an electrical shock. Check the power cord once in a while. When you find it damaged, ask your nearest Pioneer authorized service center or your dealer for a replacement.

Chapter 03: Controls and displays

Front panel

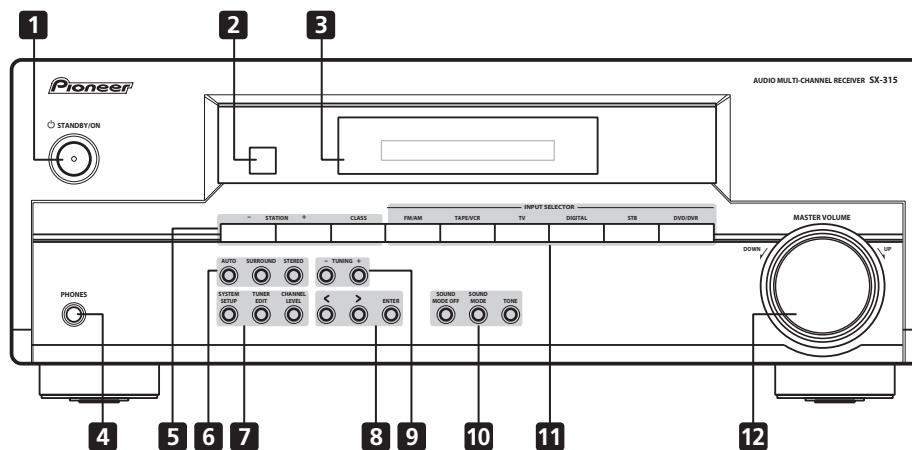

1 STANDBY/ON

Switches the receiver between on and standby (page 15).

2 Remote sensor

Receives the signals from the remote control (page 5).

3 Display

See *Display* on page 12 for details.

4 PHONES jack

Use to connect headphones. When the headphones are connected, there is no sound output from the speakers (page 20).

5 Tuner preset selection buttons

STATION +/-

Selects station presets when using the tuner (page 23).

CLASS

Switches between the three banks (classes) of station presets (page 22).

6 Listening mode buttons

AUTO

Press for automatic decoding (page 18).

SURROUND

Use to switch between the various surround modes (page 19).

STEREO

Switches to stereo playback (page 19).

7 SYSTEM SETUP

Press to access the System Setup menu (page 16, 20, 25).

TUNER EDIT

Use to memorize and name a station for recall using the **STATION +/-** buttons (page 22).

CHANNEL LEVEL

Press to set up the channel levels for surround sound (page 16).

8 < / > and ENTER

Use to navigate menus and change settings.

9 TUNING +/-

Use to tune to radio stations (page 22).

10 Listening mode buttons

SOUND MODE OFF

Press to turn off the current Sound mode (page 19).

SOUND MODE

Press to select a Sound mode (page 19).

TONE

Press to access the bass and treble controls, which you can then adjust with the remote's **BASS** and **TREBLE** buttons (page 20).

11 Input select buttons

Press to select an input source (page 18).

12 MASTER VOLUME

Display

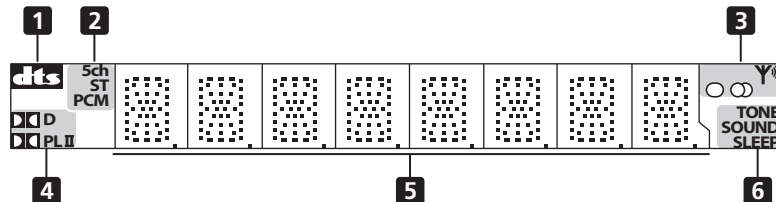

1 **dts**

Lights when the receiver is decoding a DTS¹ signal.

2 **5ch**

Lights when the receiver is in 5ch stereo mode.

ST

Lights when the receiver is in Stereo mode.

PCM

Lights when the digital input is Linear PCM format (CD Audio, etc.).

3 **TUNER indicators**



Lights when a stereo FM broadcast is being received in auto stereo mode.



Lights when the mono mode is set using the **MPX** button (page 22).



Lights when a broadcast is being received.

4 **D**

Lights when the receiver is decoding a Dolby Digital² signal.

PL II

Lights when the receiver is using Dolby Pro Logic II decoding.

5 **Character display**

6 **TONE**

Lights when the receiver is in tone mode.

SOUND

Lights when the receiver is in sound mode.

SLEEP

Lights when the receiver is in sleep mode.

Note

¹ "DTS" and "DTS Digital Surround" are trademarks of Digital Theater Systems, Inc.

² Manufactured under license from Dolby Laboratories. "Dolby", "Pro Logic", and the double-D symbol are trademarks of Dolby Laboratories.

Controls and displays

03

English

Remote control

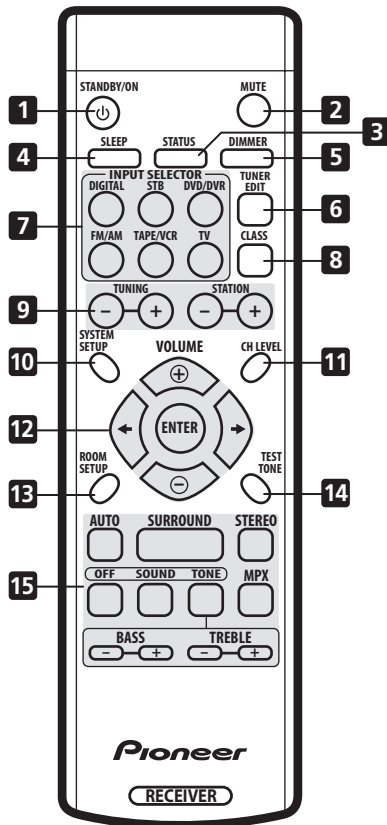

1 **STANDBY/ON**

This switches between standby and on for this receiver (page 15).

2 **MUTE**

Press to mute the sound (press again, or adjust the volume, to restore the sound).

3 **STATUS**

Press to display the current surround mode and sound mode.

4 **SLEEP**

Use to put the receiver in sleep mode and select the amount of time before the receiver turns off (page 21).

5 **DIMMER**

Press repeatedly to set the front panel display brightness.

6 **TUNER EDIT**

Use to memorize and name a station for recall using the **STATION +/-** buttons (page 22).

7 **INPUT SELECTOR buttons**

Press to select an input source (page 18).

DIGITAL

Press to select the optical digital input.

STB

Press to select the STB (set-top box) input (for cable/satellite receivers, etc.).

DVD/DVR

Press to select the DVD player/recorder input.

FM/AM

Press to select the FM or AM band for the built-in tuner.

TAPE/VCR

Press to select the analog tape/VCR input.

TV

Press to select the TV audio input.

8 **CLASS**

Switches between the three banks (classes) of radio station presets (page 22).

9 **Radio tuning controls**

TUNING +/-

Use to manually tune into radio stations (page 22).

STATION +/-

Use to tune to preset stations (page 23).

10 **SYSTEM SETUP**

Press to access the System Setup menu (page 16, 20, 25).

11 **CH LEVEL**

Press to set up the channel levels for surround sound (page 16).

13

En

12 ←/→ (cursor left/right), VOLUME +/- and ENTER

Use to navigate menus and adjust the volume.

13 ROOM SETUP

Press to set up surround sound using the Room Setup presets (page 15).

14 TEST TONE

Sounds the test tone when setting up the surround sound of the receiver (page 16).

15 Listening mode buttons**AUTO**

Press for automatic decoding based on the source material (page 18).

SURROUND

Press to switch between the various Pro Logic II and other listening mode options (page 19).

STEREO

Switches to stereo playback using only the front left and right speakers (page 19).

OFF

Switches off the Sound mode (page 19).

SOUND

Press to select a Sound mode (page 19).

TONE

Use in conjunction with the **BASS** and **TREBLE** buttons below (page 20).

MPX

Switches between stereo and mono reception of FM broadcasts. If the signal is weak then switching to mono will improve the sound quality (page 22).

BASS +/-

Use with the **TONE** button above to adjust the bass (page 20).

TREBLE +/-

Use with the **TONE** button above to adjust the treble (page 20).

Chapter 04: Surround sound setup

Introduction to home theater

You are probably used to using stereo equipment to listen to music, but may not be used to home theater systems that give you many more options (such as surround sound) when listening to soundtracks.

Home theater refers to the use of multiple audio tracks to create a surround sound effect, making you feel like you're in the middle of the action or concert. The surround sound you get from a home theater system depends not only on the speakers you have set up in your room, but also on the source and the sound settings of the receiver.

DVD-Video has become the basic source material for home theater due to its size, quality, and ease of use. Depending on the DVD, you can have up to seven different audio tracks coming from one disc, all of them being sent to different speakers in your system. This is what creates a surround sound effect and gives you the feeling of 'being there'.

This receiver will automatically decode Dolby Digital, DTS, or Dolby Surround DVD-Video discs, according to your speaker setup. In most cases, you won't have to make changes for realistic surround sound, but other possibilities (like listening to a CD with multichannel surround sound) are explained in *Listening to your system* on page 18.

Switching on

Use the **STANDBY/ON** button on the front panel or the remote control to switch the receiver on or into standby.

Remember that when the receiver is in standby it still uses a small amount of power (0.5 W). Unplug from the wall outlet to completely disconnect the power. The receiver will retain its settings for about four weeks when unplugged.

Quick setup using the Room Setup

The Room Setup feature gives you a very simple way to set up your receiver for good surround sound by setting the room size and your seating position in the room.

You can make more detailed settings for surround sound later if you want, setting individual channel levels and speaker distances. See below for more details.

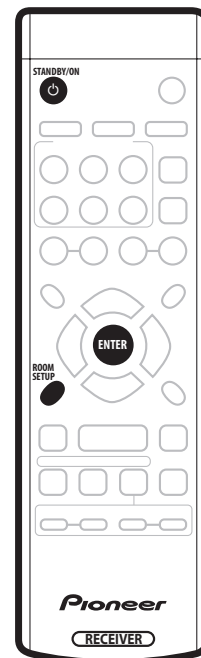

1 If the receiver isn't already on, press **STANDBY/ON (remote or front panel) to switch on.**

2 Press **ROOM SETUP then **ENTER**.**

The display shows the current Room Setup setting.

- If any of the speaker distance settings have been changed (see *Setting speaker distances* below) then the display blinks **ROOM SET**.

3 Use the **ROOM SETUP button to select a room size setting, then press **ENTER**.**

Select from:

- **Room S** – Smaller than average room (approx. 3.5 m x 4.5 m)
- **Room M** – Average room (approx. 5.5 m x 6.0 m)

Surround sound setup

- **Room L** – Larger than average room (approx. 7.5 m x 9.0 m)

4 Use the ROOM SETUP button to select a seating position setting, then press ENTER.

Select from:

- **Seat Fwd** – If you are nearer to the front speakers than the surround speakers
- **Seat Mid** – If you are equal distance from the front and surround speakers
- **Seat Back** – If you are nearer to the surround speakers than the front speakers

After selecting the seating position, the display shows the new settings for a couple of seconds.

Setting speaker distances

For more accurate surround sound settings you can set the distance from your listening position to each of the speakers.

See also *Setting individual channel levels* below for setting the relative levels of individual speakers.

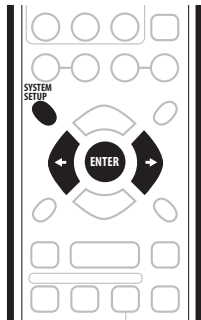

1 Press SYSTEM SETUP (front panel or remote).

The display shows: **F c h** : followed by a distance in meters. This is the receiver's current setting for the distance from your listening position to each of the front left and right speakers.

2 Use the ◀/▶ (cursor left/right) buttons to change the distance setting.

You can set the distance in increments of 30 cm.

- You can also use the < and > buttons on the front panel.

3 Press SYSTEM SETUP again to select the center speaker distance setting, then set using the ◀/▶ (cursor left/right) buttons.

The display shows: **C c h** : followed by the current distance setting.

4 Press SYSTEM SETUP again to select the surround speaker distance setting, then set using the ◀/▶ (cursor left/right) buttons.

The display shows: **S c h** : followed by the current distance setting.

5 Press SYSTEM SETUP again to select the subwoofer speaker distance setting, then set using the ◀/▶ (cursor left/right) buttons.

The display shows: **S W** : followed by the current distance setting.

6 Press ENTER to exit the System Setup menu.

Setting individual channel levels

In order to balance the sound from all the speakers in your system you can adjust the relative level of each speaker. Adjust so that the level of each speaker is similar from your listening position.

While setting the channel levels, you can either listen to a multichannel source (such as a DVD), or use the built-in test tone feature.

Setting the channel levels using the test tone

The test tone feature outputs a constant noise tone from each speaker, giving you a good reference to adjust the levels.

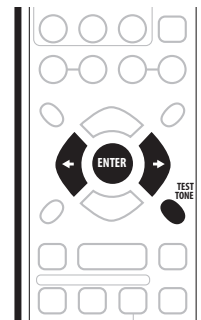

1 Press TEST TONE.

The test tone starts sounding from the left front speaker and continues around each speaker in turn.

2 While the test tone is sounding, use the ◀/▶ (cursor left/right) buttons to adjust the level of that speaker.

You can adjust each speaker from **-10** (quieter) to **+10** (louder).

- You can also use the front panel < and > buttons, although it's usually best to make this setting from your listening position using the remote.

3 When you're done, press ENTER to exit.

- Pressing any button (except **VOLUME +/-**) will also exit.

Surround sound setup

04

English

Setting the channel levels while playing a source

The following way of setting the channel levels is best done while playing a multichannel source, such as a DVD. See also the following chapter, *Listening to your system* on page 18 for more on playing sources.

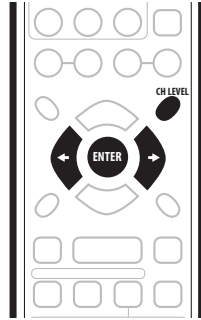

1 Press CH LEVEL on the remote or CHANNEL LEVEL on the front panel to select a speaker to adjust.

Each press changes the selected speaker:

- **L** – Left front speaker
- **C** – Center speaker
- **R** – Right front speaker
- **RS** – Right surround speaker
- **LS** – Left surround speaker
- **SW** – Subwoofer

On the right side of the display you can see the current channel level setting. Initially these are all set at zero.

2 Use the ←/→ (cursor left/right) buttons to change the setting for the displayed speaker.

You can adjust each speaker from **-10** (quieter) to **+10** (louder).

- You can also use the front panel < and > buttons, although it's usually best to make this setting from your listening position using the remote.

3 When you're done, press ENTER to exit.

If no button is pressed for ten seconds, channel setting is automatically exited.

17

En

Chapter 05: Listening to your system

Selecting a source

You can use either the front panel buttons or the remote control to select what you want to listen to; your DVD player, the sound from your TV, the built-in radio tuner, and so on.

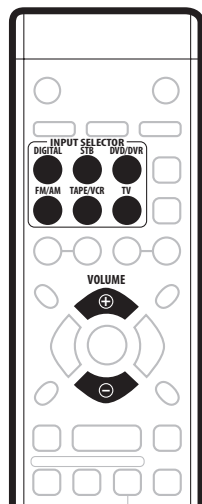

1 Use one of the INPUT SELECTOR buttons to select an input source.

- **DVD/DVR** – Coaxial digital input for a DVD player or recorder.
- **STB** – Coaxial digital input for a set-top box such as a satellite receiver or cable box.
- **DIGITAL** – Optical digital input for any kind of digital audio component (CD, DVD, MD player, etc.).
- **TV** – Analog inputs for your TV's stereo audio output.
- **TAPE/VCR** – Analog inputs for a tape deck or VCR.
- **FM/AM** – The built-in radio tuner. See the following chapter for how to use this.

2 Use the front panel MASTER VOLUME knob or the VOLUME +/- buttons on the remote to adjust the volume.

Note

- The input level for **TAPE/VCR** can be adjusted if it is too high. See *Input attenuator setting* on page 25.

- If the channel level has been raised using the channel level settings (see page 16), it's possible that the volume level will not go all the way up to **MAX** with a sound mode on. This is indicated by a blinking volume indicator in the display.

Using the Auto listening mode

The simplest way to listen to any source is using the Auto listening mode. This lets the receiver choose a default setting depending on the kind of source playing.

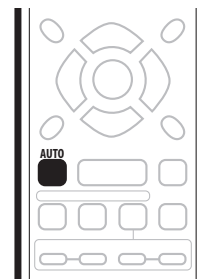

- **While listening to a source, press AUTO (front panel or remote) to select Auto listening mode.**

Depending on the kind of source you're listening to, **2 ch**, **Multich** or **1 ch** is automatically selected:

- **2 ch** – Sound plays through the front left and right speakers only (used for two-channel Dolby Digital, DTS, PCM or analog sources).
- **Multich** – Sound plays through all the speakers used in the multichannel source (used for multichannel Dolby Digital or DTS sources).
- **1 ch** – Sound plays through the center speaker only (used for dual mono Dolby Digital or single channel DTS sources).

Listening to your system

05

Listening in surround sound

Using the **SURROUND** button you can listen to any source in surround sound.



- **While listening to a source, press SURROUND.**

If the source is Dolby Digital, DTS, or Dolby Surround encoded, the proper decoding format will automatically be selected and shows in the display.

With two channel sources, press **SURROUND** repeatedly to select from:

- **MOVIE** – Up to 5.1 channel sound using Dolby Pro Logic II, especially suited to movie sources
- **MUSIC** – Up to 5.1 channel sound using Dolby Pro Logic II, especially suited to music sources
- **DOLBY PL** – 5.1 channel surround sound using Dolby Pro Logic
- **5 – STEREO** – Stereo sound but using all the speakers (for single channel sources, the one channel is output from all the speakers)

Note

- You can't use the surround mode with 96 kHz/88.2 kHz PCM.

Listening in stereo

Just as you can listen to any source in surround sound, you can also choose to listen to sources in stereo. In this case, all sound will be played through the front left and right speakers and the subwoofer.

Multichannel sources are mixed down to stereo so that you still hear the full soundtrack.

Note that single channel sources are played through the center speaker and subwoofer only in this mode.

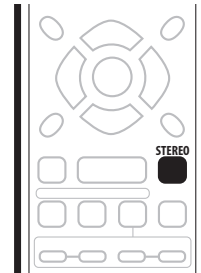

- **While listening to a source, press STEREO for stereo playback.**

Using the Sound modes

In addition to the above listening modes, you can also select a Sound mode.

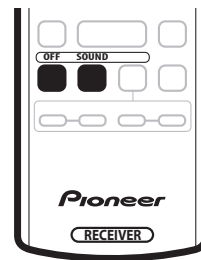

- **While listening to a source, press SOUND to select a Sound mode.**

Press repeatedly to select one of the following:

- **F.SURR.** – Front surround, recommended when the surround speakers are placed at the front, giving the impression of surround sound.
- **GAME** – Surround sound designed for video game sources
- **S. BASS** – Enhanced bass
- **QUIET** – Use when listening at low volume to hear the sound more clearly.
- **To switch off the Sound mode, press OFF on the remote or SOUND MODE OFF on the front panel.**

English

19

En

Using the tone controls

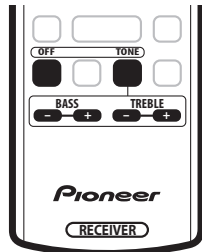

The tone controls include separate adjustments for bass and treble.

- 1 Press **TONE**.
- 2 use the **BASS +/-** and **TREBLE +/-** buttons to adjust the bass and treble as you like.
 - To switch off the tone, press **OFF** (remote) or **SOUND MODE OFF** (front panel).

Note

- If you use one of the Sound modes, the tone is automatically switched off.
- When Sound mode is off, you can start to adjust the tone directly from the **BASS +/-** and **TREBLE +/-** buttons (without pressing **TONE** first).
- If a Sound mode is active and you press **BASS +/-** or **TREBLE +/-** then **TONE OFF** is displayed.

Dynamic Range Control setting

- Default setting: **DRC: OFF**

Using this setting, you can compress the dynamic range of Dolby Digital or DTS sources so that low level sounds can be heard more easily (sounding relatively louder) yet louder sounds won't be too overbearing.

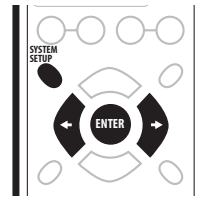

- 1 Press **SYSTEM SETUP** repeatedly until the **DRC setting is shown in the display**.

The display shows **DRC ON** or **DRC OFF**.

- 2 Use the **←/→** (cursor left/right) buttons to change the setting.

Switching on Dynamic Range Control is best used when listening at low volumes so that you can still hear dialog.

- You can also use the **<** and **>** buttons on the front panel.

- 3 Press **ENTER** to exit System Setup.

Listening through headphones

When you connect a pair of headphones for private listening the front panel display shows **PHONES IN** and sound from the speakers is muted.

Sound through the headphones is always stereo; multichannel sources are mixed down as necessary.

When headphones are connected, the **AUTO**, **SURROUND**, **STEREO** and **SOUND** buttons are all inoperative.

Listening to your system

05

English

Dual Mono setting

- Default setting: **CH1**

You may sometimes come across Dolby Digital or DTS discs that are in dual mono format. This is two-channel material, but the channels may be listened to separately or together depending on the situation. In this case you can use the Dual Mono setting to select the channel or channels to listen to.

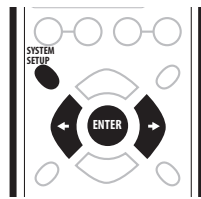

- 1 Press **SYSTEM SETUP** repeatedly until the **Dual Mono** setting is shown in the display.

The display shows **CH 1**, **CH 1/CH 2** or **CH 2**.

- 2 Use the **←/→** (cursor left/right) buttons to change the setting.

- You can also use the **<** and **>** buttons on the front panel.

- 3 Press **ENTER** to exit System Setup.

Using the sleep timer

The sleep timer switches the receiver into standby after a specified amount of time so you can fall asleep without worrying about the receiver being left on all night. Use the remote control to set the sleep timer.

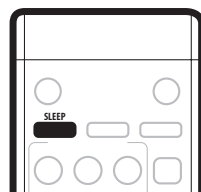

- Press **SLEEP** repeatedly to set the sleep time.

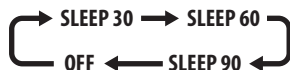

Tip

- You can check the remaining sleep time at any time by pressing **SLEEP** once. Pressing repeatedly will cycle through the sleep options again.
- You can also switch off the sleep timer simply by switching the receiver into standby.

21

En

Chapter 06: Using the tuner

Listening to the radio

The following steps show you how to tune in to FM and AM radio broadcasts using the automatic (search) and manual (step) tuning functions.

Once you are tuned to a station you can memorize the frequency for recall later—see *Saving station presets* below for more on how to do this.

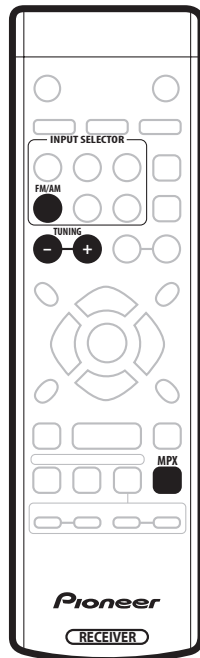

1 Press the FM/AM button to select the tuner.

The front panel display shows the band (FM or AM) and the frequency. If you want to change the band, press **FM/AM** again.

2 Tune to a station.

There are three ways to do this:

- **Manual (step) tuning**

To change the frequency one step at a time, press **TUNING +/-**.

- **Automatic tuning**

To search for stations in the currently selected band, press and hold **TUNING +/-** for about a second. The receiver will start searching for the next station, stopping when it has found one. Repeat to search for other stations.

- **High speed tuning**

Press and hold **TUNING +/-** for high speed tuning. Release the button at the frequency you want.

Improving FM stereo sound

If the tuning (Y) or FM stereo (D) indicators don't light when tuning to a stereo FM station because the signal is weak, press the **MPX** button to switch the receiver into mono reception mode. This should improve the sound quality and allow you to enjoy the broadcast.

Saving station presets

If you often listen to a particular radio station, it's convenient to have the receiver store the frequency for easy recall. This saves the effort of manually tuning in each time.

You can memorize up to 30 stations, stored in three banks, or classes, (A, B and C) of 10 stations each. When saving an FM frequency, the **MPX** setting (see above) is also stored.

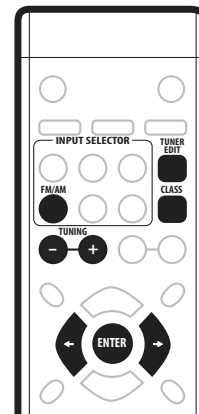

1 Tune to a station you want to memorize.

See *Listening to the radio* above for more on this.

2 Press TUNER EDIT.

The display shows a blinking memory class.

3 Press CLASS to select a class (A, B or C).

Press repeatedly to change the class displayed in the front panel display.

Using the tuner

06

English

4 Use the \leftarrow/\rightarrow (cursor left/right) buttons to select a preset number in which to store the station.

- You can also use the < and > buttons on the front panel.

5 Press ENTER.

After pressing **ENTER**, the preset class and number stop blinking and the receiver stores the station.

Naming station presets

You can name saved presets with four-character names.

1 Use the CLASS and STATION +/- buttons to find the station preset you want to name.

2 Press TUNER EDIT.

3 Use the \leftarrow/\rightarrow (cursor left/right) buttons to select a character, then press ENTER.

After pressing **ENTER**, the cursor moves to the next character space.

4 Repeat step 3 to enter the remaining three characters.

Pressing **ENTER** after the fourth character stores the station name.

Listening to station presets

You will need to have some presets stored to do this. See *Saving station presets* on page 22 if you haven't done this already.

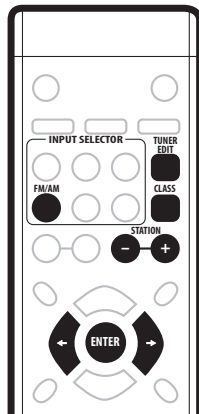

1 Press FM/AM to select the tuner.

2 Press CLASS to select a class (A, B or C).

Press repeatedly to change the class displayed in the front panel display.

3 Use the STATION +/- buttons to select the preset you want.

Note

- If the receiver is left disconnected from the AC power outlet for an extended period, the station memories will be lost and will have to be reprogrammed.

23

En

Chapter 07: Additional information

Troubleshooting

Incorrect operations are often mistaken for trouble and malfunctions. If you think that there is something wrong with this component, check the points below. Sometimes the trouble may lie in another component. Investigate the other components and electrical appliances being used. If the trouble cannot be rectified even after exercising the checks listed below, ask your nearest Pioneer authorized service center or your dealer to carry out repair work.

Problem	Remedy
The power does not turn on.	<ul style="list-style-type: none"> • Connect the power plug to the wall outlet. • Disconnect the power plug from the outlet, and insert again. • Make sure there are no loose strands of speaker wire touching the rear panel. This could cause the receiver to shut off automatically. • If the power shuts off automatically, take the unit to your nearest Pioneer authorized service center or your dealer for servicing.
No sound is output when a function is selected.	<ul style="list-style-type: none"> • Make sure the component is connected correctly (refer to <i>Connecting up</i> on page 6). • Press MUTE on the remote control to turn muting off. • Adjust the MASTER VOLUME.
Considerable noise in radio broadcasts.	<ul style="list-style-type: none"> • Tune in the correct frequency. • Connect the antenna (refer to page 8). • Route any loose cables away from the antenna terminals and wires. • Fully extend the FM wire antenna, position for best reception, and secure to a wall, etc. • Connect an outdoor FM antenna (refer to page 8). • Adjust the direction and position for best reception. • Connect an additional internal or external AM antenna (refer to page 8). • Turn off the equipment causing the noise or move it away from the receiver. • Move antennas farther away from equipment causing the noise.
Broadcast stations cannot be selected automatically.	<ul style="list-style-type: none"> • Connect an outdoor antenna (refer to page 8).
No sound from surround or center speakers.	<ul style="list-style-type: none"> • Connect the speakers properly (refer to page 9).
No sound from subwoofer.	<ul style="list-style-type: none"> • Make sure the subwoofer is switched on. • If the subwoofer has a volume knob, make sure it's turned up. • The Dolby Digital or DTS source you are listening to does not have an LFE channel.
Noise during playback of a cassette deck.	<ul style="list-style-type: none"> • Move the cassette deck further from your receiver, until the noise disappears.
When a search is performed by a DTS compatible CD player during playback, noise is output.	<ul style="list-style-type: none"> • This is not a malfunction, but be sure to turn the volume down to prevent the output of loud noise from your speakers.
Can't operate the remote control.	<ul style="list-style-type: none"> • Replace the batteries (refer to page 5). • Operate within 7 m, 30° of the remote sensor on the front panel (refer to page 5). • Remove obstacles or operate from another position. • Avoid exposing the remote sensor on the front panel to direct light.
The display is dark or off.	<ul style="list-style-type: none"> • Press DIMMER on the remote control repeatedly to return to the default.

Additional information

07

Note

- If the unit does not operate normally due to external effects such as static electricity, disconnect the power plug from the outlet and insert again to return to normal operating conditions.

Cleaning the unit

- Use a polishing cloth or dry cloth to wipe off dust and dirt.
- When the surface is dirty, wipe with a soft cloth dipped in some neutral cleanser diluted five or six times with water, and wrung out well, and then wipe again with a dry cloth. Do not use furniture wax or cleansers.
- Never use thinners, benzene, insecticide sprays or other chemicals on or near this unit, since these will corrode the surface.

Input attenuator setting

- Default setting: **ATT:OFF**

If you experience distortion when you select the **TAPE/VCR** input it may be that the input level is too high. Switching on the input attenuator lowers the input level, restoring the proper sound.

1 Press **SYSTEM SETUP** repeatedly until the input attenuator setting is shown in the display.

The display shows **ATT:ON** or **ATT:OFF** for Input attenuator on and off respectively.

2 Use the **←/→** (cursor left/right) buttons to change the setting.

- You can also use the **<** and **>** buttons on the front panel.

3 Press **ENTER** to exit System Setup.

Resetting the receiver

Use this procedure to reset all the receiver's settings to the factory default. Use the front panel controls to do this.

1 Switch the receiver into standby.

2 Press **TONE** and **SYSTEM SETUP** at the same time.

3 When you see **RESET?** appear in the display, press the **>** button.

OK? shows in the display.

4 Press **ENTER** to confirm.

OK appears in the display to indicate that the receiver has been reset to the factory default settings.

Note

- Steps **3** and **4** must be completed within five seconds, otherwise the receiver will exit the reset process.

English

25

En

Specifications

Amplifier section

DIN Power Output

Front	100 W per channel (DIN, 1 %, 6 Ω)
Center	100 W (DIN, 1 %, 6 Ω)
Surround	100 W per channel (DIN, 1 %, 6 Ω)
Subwoofer	100 W (DIN, 1 %, 6 Ω)

RMS Power Output

Front	125 W per channel (1 kHz, THD 10 %, 6 Ω)
Center	125 W (1 kHz, THD 10 %, 6 Ω)
Surround	125 W per channel (1 kHz, THD 10 %, 6 Ω)
Subwoofer	125 W (100 Hz, THD 10 %, 6 Ω)

Music Power Output

Front	167 W per channel (DIN MUSIC, 10%, 6 Ω)
Center	167 W (DIN MUSIC, 10%, 6 Ω)
Surround	167 W per channel (DIN MUSIC, 10%, 6 Ω)
Subwoofer	167 W (DIN MUSIC, 10%, 6 Ω)

FM Tuner Section

Frequency Range	87.5 MHz to 108 MHz
Antenna Input	75 Ω unbalanced

AM Tuner Section

Frequency Range	531 kHz to 1 602 kHz
Antenna	Loop antenna

Miscellaneous

Power requirements	AC 220 V to 230 V, 50 Hz / 60 Hz
Power consumption	200 W
In standby	0.5 W
Dimensions	420 mm(W) x 158 mm (H) x 400 mm(D)
Weight (without package)	9.5 kg

Furnished Parts

AM loop antenna	1
FM wire antenna	1
Dry cell batteries (AA size IEC R6)	2
Remote control	1
Warranty card	1
These operating instructions	

Note

- Specifications and the design are subject to possible modifications without notice, due to improvements.

Additional information



www.pioneer.co.uk



www.pioneer-eur.com

Published by Pioneer Corporation.
Copyright © 2006 Pioneer Corporation.
All rights reserved.

PIONEER CORPORATION

4-1, Meguro 1-Chome, Meguro-ku, Tokyo 153-8654, Japan

PIONEER ELECTRONICS (USA) INC.

P.O. BOX 1540, Long Beach, California 90810-1540, U.S.A. TEL: (800) 421-1404

PIONEER ELECTRONICS OF CANADA, INC.

300 Allstate Parkway, Markham, Ontario L3R 0P2, Canada TEL: 1-877-283-5901

PIONEER EUROPE NV

Haven 1087, Keetberglaan 1, B-9120 Melsele, Belgium TEL: 03/570.05.11

PIONEER ELECTRONICS ASIACENTRE PTE. LTD.

253 Alexandra Road, #04-01, Singapore 159936 TEL: 65-6472-7555

PIONEER ELECTRONICS AUSTRALIA PTY. LTD.

178-184 Boundary Road, Braeside, Victoria 3195, Australia, TEL: (03) 9586-6300

PIONEER ELECTRONICS DE MEXICO S.A. DE C.V.

Blvd.Manuel Avila Camacho 138 10 piso Col.Lomas de Chapultepec, Mexico,D.F. 11000 TEL: 55-9178-4270

K002_A_En

Printed in

Free Manuals Download Website

<http://myh66.com>

<http://usermanuals.us>

<http://www.somanuals.com>

<http://www.4manuals.cc>

<http://www.manual-lib.com>

<http://www.404manual.com>

<http://www.luxmanual.com>

<http://aubethermostatmanual.com>

Golf course search by state

<http://golfingnear.com>

Email search by domain

<http://emailbydomain.com>

Auto manuals search

<http://auto.somanuals.com>

TV manuals search

<http://tv.somanuals.com>