

Savi® W730-M

Multi-Device Wireless Headset System

OPTIMIZED FOR
Microsoft® Lync™

Guía de inicio rápido
Guide de démarrage rapide

QUICK START GUIDE



VIDEO GUIDE

<http://docs.plantronics.com/savi-700>

plantronics



1 Increase volume/flash button

Increase volume Short press +

Flash While on call, long press volume up + for 1.5 seconds, will put call on hold and answer another.

2 Decrease volume/mute button

Decrease volume Short press -

Mute Press volume down - for 1.5 seconds

3 Call control button

Answer/end call Short press

CAUTION For your safety, do not use headset at high volumes for extended periods of time. Doing so can cause hearing loss. Always listen at moderate levels. For more information on headsets and hearing visit plantronics.com/healthandsafety.

Please refer to the separate safety instructions for important product safety information prior to installation or use of the product. Savi W730 has a WO2 base and a WH210 headset.

86108-05 (04.11)

plantronics

1 Headset Customize and Charge

- 1 Attach charge cradle to base.



- 2 Plug one end of power supply into power jack on back of the base and other end into working power outlet.

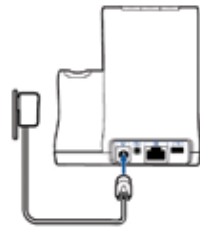

- 3 To charge, dock headset in base, minimum of 20 minutes.

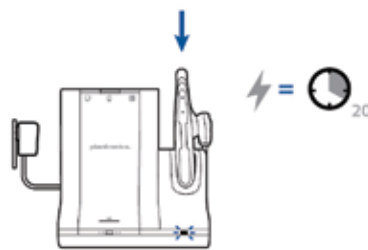

NOTE This product has a non-replaceable battery. Contact Plantronics for replacement information.

2 Desk Phone Connect and Call

- 1 Choose desk phone setup **A, B, or C** and connect cables.

A Desk phone (standard)



B Desk phone + HL10 lifter (sold separately)

See user guide at plantronics.com/accessories

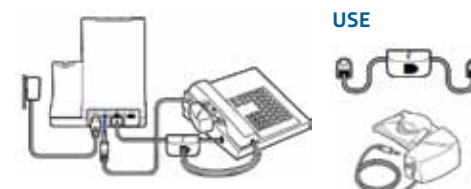

C Desk phone + EHS cable (sold separately)

See user guide at plantronics.com/accessories

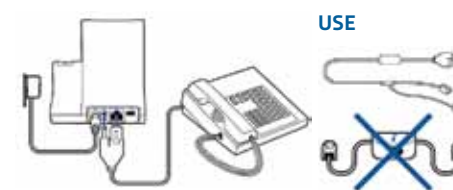

- 2 While wearing headset, short press base desk phone button.

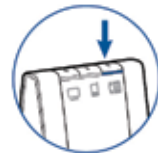

NOTE If you don't have remote call control through a lifter (HL10) or cable (EHS), manually remove desk phone handset before each call.

- 3 If you do not hear a dial tone, open side panel and adjust middle configuration switch (A-G) until you do. Default setting **A** works for majority of desk phones.

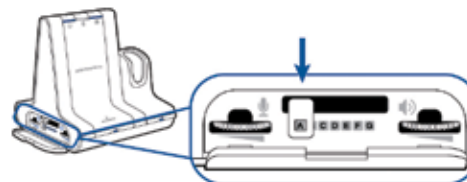

- 4 Dial test call from desk phone.
- 5 End call by pressing headset call control button.



3 Mobile Connect and Call

- 1 Press down and hold Bluetooth pairing button (4 seconds) on Savi base until indicator LED flashes red and blue.



- 2 Place Bluetooth mobile phone into search mode. Select **SAVI 7xx** from the list of found devices.



- 3 If prompted by mobile phone, type **0000** as passcode. Bluetooth indicator LED on base will turn solid blue when base has an active connection with mobile phone.



- 4 While wearing headset, short press base mobile button.



- 5 Dial test call from mobile phone.

- 6 End call by pressing headset call control button.



4 Computer Connect and Call

- 1 Connect USB cable.

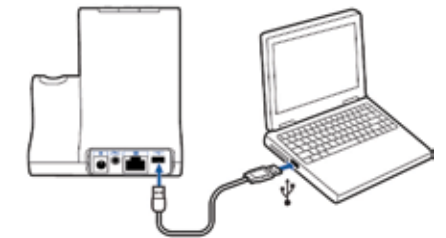

- 2 While wearing headset, short press base computer button.

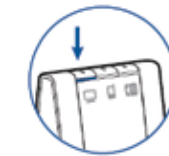

- 3 Dial test call from computer softphone.

- 4 End call by pressing headset call control button.



NEED MORE HELP?

Technical support
plantronics.com/support

Online user guide
<http://docs.plantronics.com/savi-700>

Free Manuals Download Website

<http://myh66.com>

<http://usermanuals.us>

<http://www.somanuals.com>

<http://www.4manuals.cc>

<http://www.manual-lib.com>

<http://www.404manual.com>

<http://www.luxmanual.com>

<http://aubethermostatmanual.com>

Golf course search by state

<http://golfingnear.com>

Email search by domain

<http://emailbydomain.com>

Auto manuals search

<http://auto.somanuals.com>

TV manuals search

<http://tv.somanuals.com>