



7" Internet Tablet

Camera + Capacitive Touch Screen
PMID702C, PMID703C, PTAB7XC



User Manual

Download from www.Somanuals.com. All Manuals Search And Download

In the box

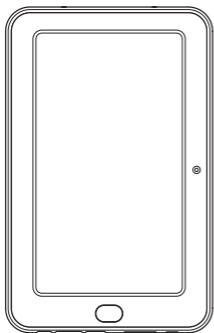

Tablet



User Manual

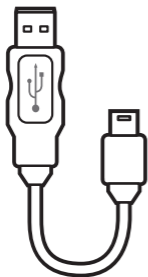

USB Cable

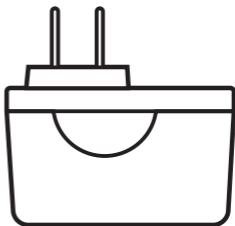

AC Adapter

Location of controls

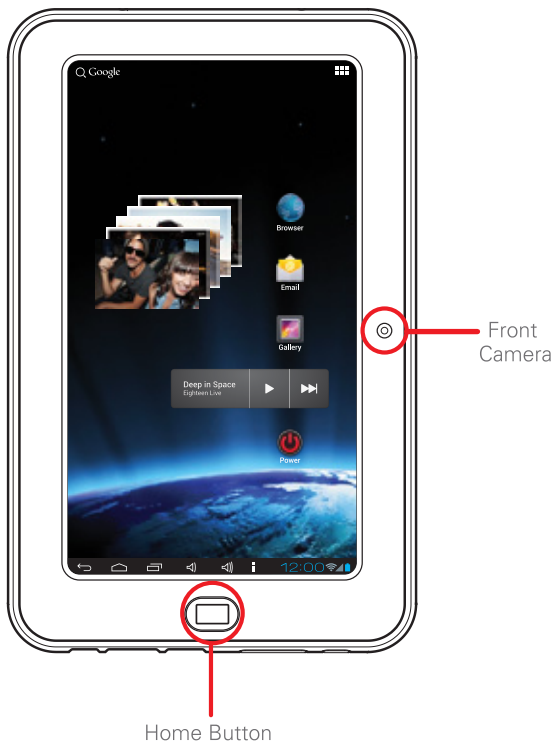

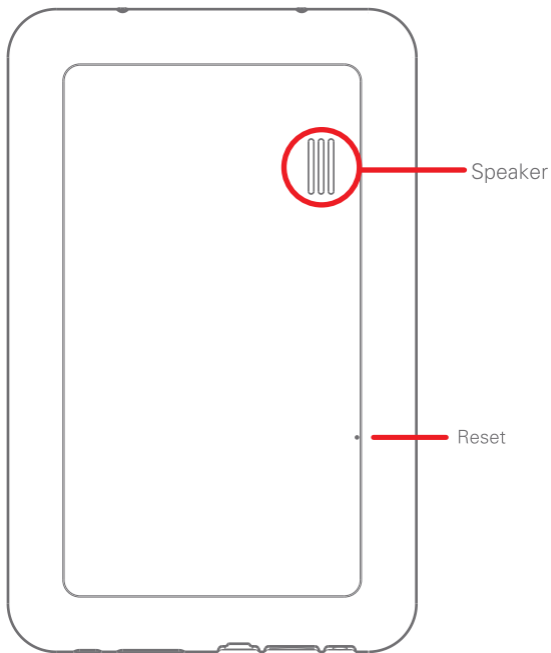

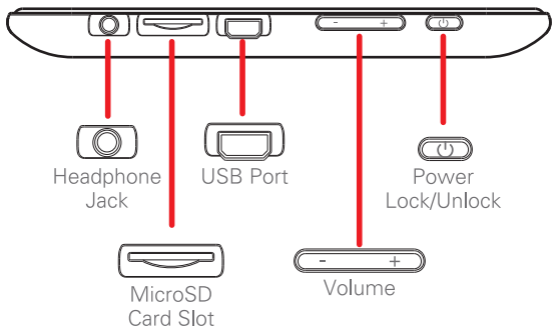

Specifications:

Operating System : Android 4.0, Ice Cream Sandwich

Processor: ARM CORTEX-A8

Processor Speed : 1 GHz

RAM : 512MB DDR3

Graphic accelerator : OpenGL ES 2.0 (3D game support)

Display :

- 7" capacitive multi-touch screen
- Display resolution : 800*480 (16:9)
- 4 way auto rotation

Network : WiFi (802.11 b/g/n)

Memory

- Internal Memory : 4GB

- External Memory : Micro SDHC card slot (max 32GB)

Basic operation

Charging the battery:

Connect the tablet to a wall outlet using the included AC adapter.

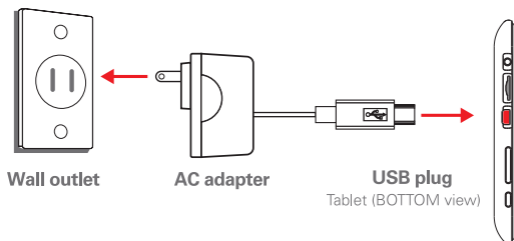

The tablet may also be charged by connecting it to a computer using the USB cable, however, it will take much longer to fully charge.

Approximate play times

(actual play times may vary depending on display and power settings)

- Music: up to 10 hours (Wi-Fi / backlight off)
- Video: 4.5 - 5 hours (Wi-Fi turned off)
- eBook: 6 - 7 hours (Wi-Fi turned off)
- Web browsing: 5 - 6 hours
- Standby time: 60 - 70 hours



Battery Tips:

- Turn off Wi-Fi when it's not in use.
- Lock the tablet (the display is off) to shorten charging time.
- To optimize battery time and performance, adjust the "Brightness" and "Screen timeout" options in the Settings

Turning on the tablet



Startup screen



Press and hold the  button until the startup screen appears.

Unlock (enter) the tablet

Slide the "Lock icon" to the right.

Lock icon

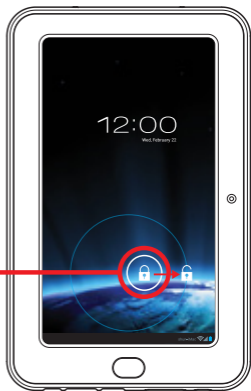

Lock screen

Lock (standby) the tablet

To lock or unlock the tablet, briefly press the  button (Lock the device to conserve the battery).

Turning off the tablet

Press and hold the  button until the Power off dialog appears.

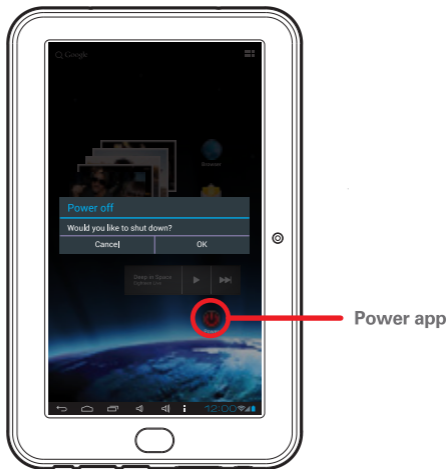

Power app

For quick power-off, you can select the "Power" app to turn off the tablet.

Home screen

On the Home screen, you can place app shortcuts and widgets.

Home screen (left)



Home screen (center)

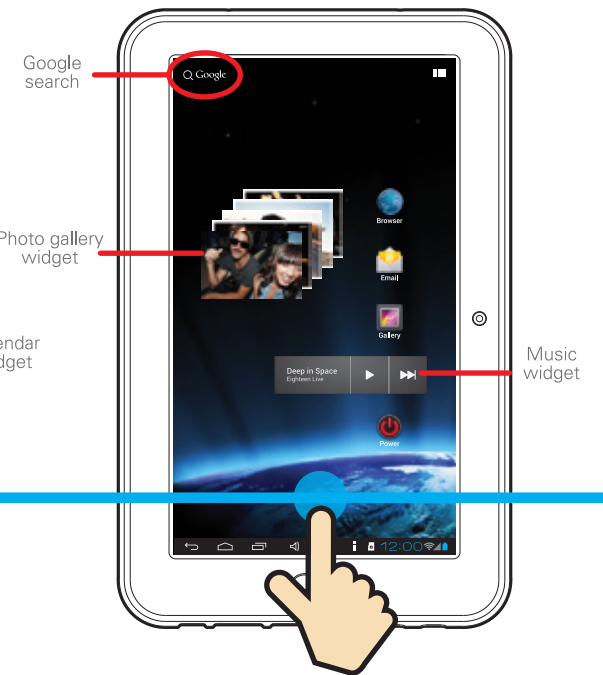

Download from www.Somanuals.com. All Manuals Search And Download
to access other Home screens

Home screen (right)

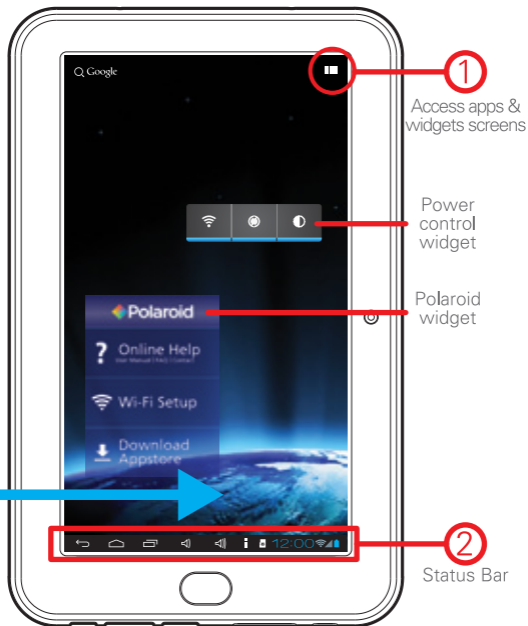

① Access apps & widgets screen

Press  to access the Apps & widgets screens.



Press the  icon to return to the Home screen

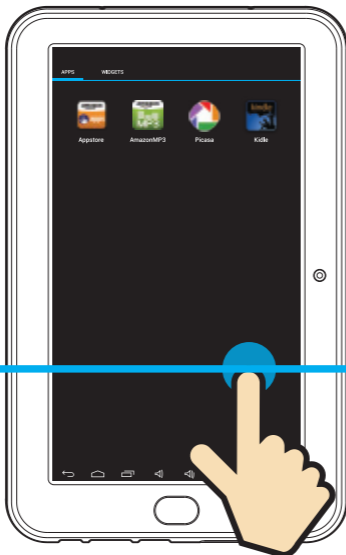

Apps screen

Swipe the Apps & Widgets screen left or right to access more apps and widgets.

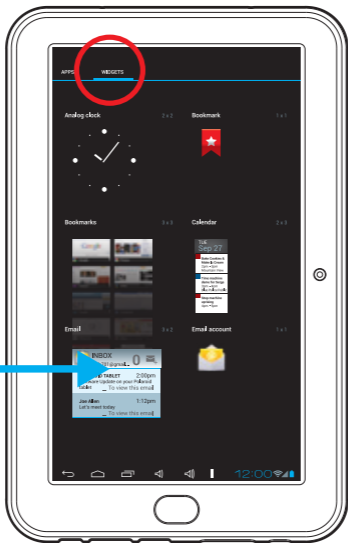

Widgets screen

Placing apps & widgets on the Home screen

Press & hold an app or widget to place it on one of the Home screens.



Apps screen

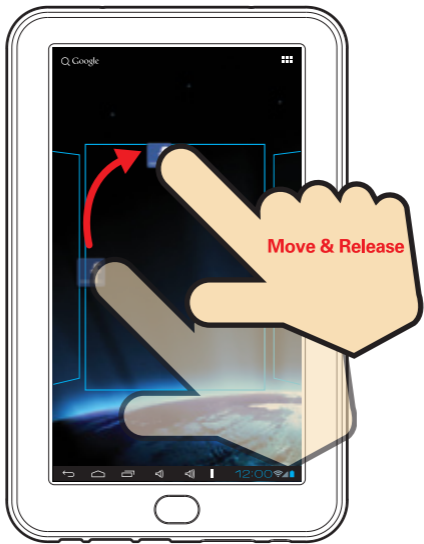

Place an app shortcut
on the Home screen



Home screen

Removing shortcuts or widgets

Press and hold the app or widget and slide it as shown below.

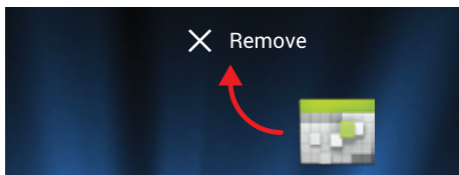

② Status Bar

The Status Bar is available on all screens and apps of the tablet.

Browser



Email

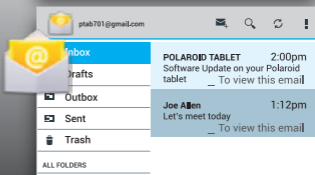

Previous



Home



Multi
tasking



Volume -

Tap here to expand the menu
and view more options

Menu

Wallpaper

Manage apps

System settings



Volume +

Menu

USB

SD

menu

Clock & Notifications

Tap the Clock to display Notifications & Settings shortcuts

Wednesday

February 22, 2012

12:00

 Home Wi-Fi  100% 



USB connected

Select copy files to/from your computer



12:00



SD card

**Clock &
Notifications**

Wi-Fi

Battery

Connecting to Wi-Fi & download

Setting up Wi-Fi

To browse web sites, use e-mail and download apps, you must first connect the tablet to the internet.

To set up Wi-Fi and download the Amazon Appstore on the tablet, use the "Polaroid widget" on the Home screen.

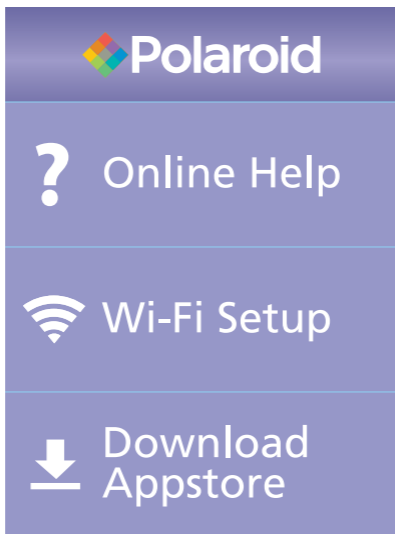

Polaroid widget

ding apps

1. Swipe the Home screen to the left to access the Polaroid widget.



Swipe the screen left

2. Select "Wi-Fi Setup" on the Polaroid widget.

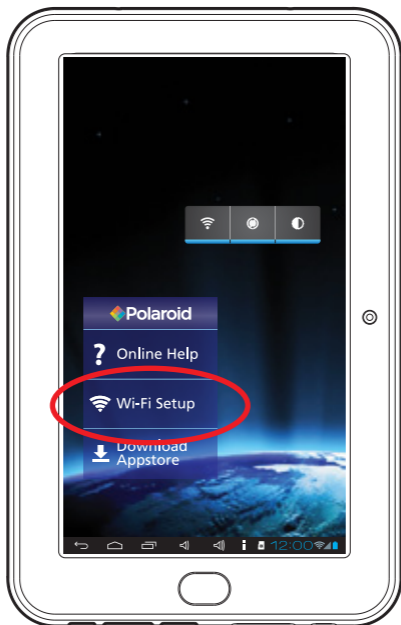

Home screen

3. Select a network.

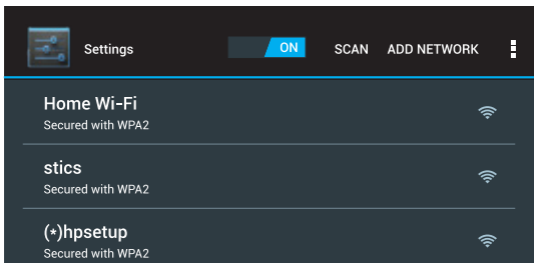

4. If required, enter the correct password and select "Connect".

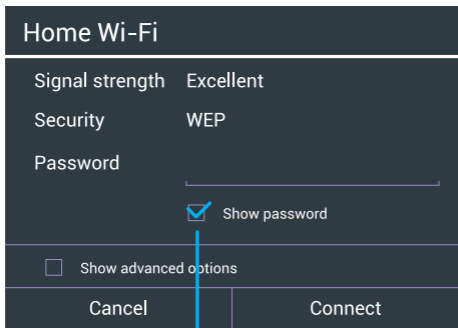

5. When the tablet is connected to a network, the Wi-Fi icon will appear on the Status Bar and “Connected” will appear under the selected network.



To conserve battery life, turn off Wi-Fi when not connected to a network.



Downloading the Amazon Appstore

To access a large library of free/paid apps and games, we recommend downloading the Amazon Appstore - follow the instructions below to download it directly to the Apps screen of the tablet.

1. After successfully connecting the tablet to Wi-Fi, select "Download Appstore" on the Polaroid widget.

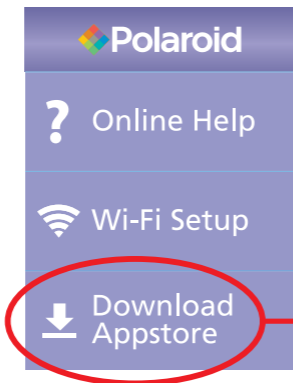

Polaroid widget



Note: It is also possible to download the appstore by going to www.amazon.com, and selecting "Appstore for Android", "<http://www.amazon.com/amazonappstoreapp>" or "<http://www.amazon.com/gp/mas/get-appstore/android>".

2. Select "Download now" to download the Amazon Appstore Installer to the tablet.

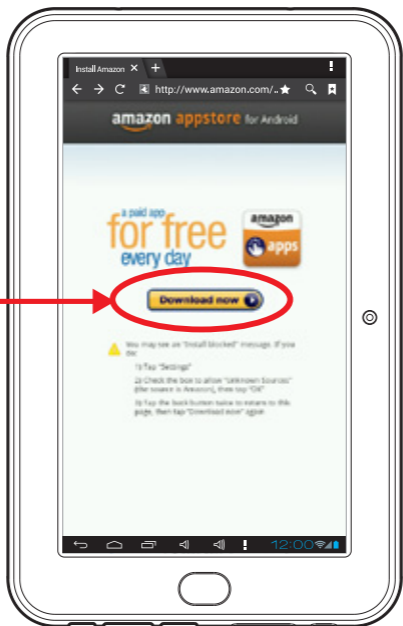

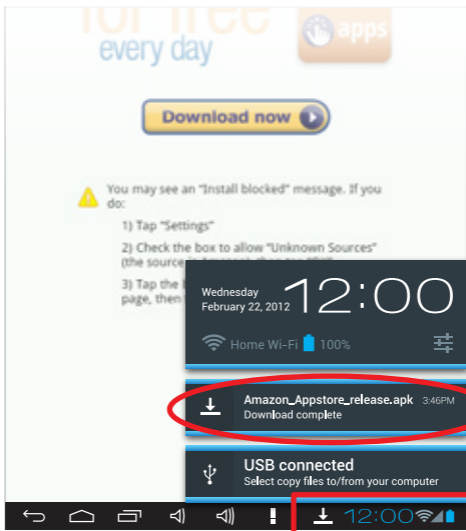

3. Click here.

4. Select "Amazon_Appstore_release.apk" from the Pop-up window.

5. Select "Install" to install the app.

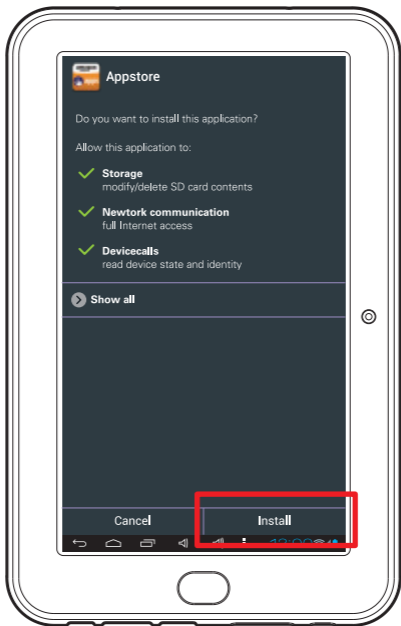

Install screen

6. The Amazon Appstore appears on the Apps screen.



Apps screen

Downloading and installing apps:

After downloading the Amazon Appstore, it is possible to download and install apps directly to the tablet - these apps will appear on the Apps screen.

Select  "Appstore" on the Apps screen and create an Amazon account (setting up the account is free). Once an account is created, it is easy to purchase, download and install apps directly to the tablet.



Note: Apps compatibility / games:

There are many apps available on the Amazon Appstore, but unfortunately not all will be compatible with the Tablet. This is because some of the apps are designed for mobile phones and require functions or specifications that are not supported by the Tablet. We recommend always searching for the free or "Lite" version of an app and testing it before purchasing the paid app.

**Avoid apps that require rear cameras or GPS as these apps will not be supported by the Tablet.*

The Tablet supports many game apps - although we recommend always testing the free version (if available) before purchasing.

Games

Sometimes, while playing games, the g-sensor on the tablet may not function correctly. This results in games not being controllable. To correct this problem, follow the steps below:

1. Open "Settings."
2. Select "Display."
3. Select "Accelerometer Coordinate System."
4. The default setting is "Default Coordinate System." This setting should work for most games.
5. In case your game is not functioning properly, select "Special coordinate system to support some other games".

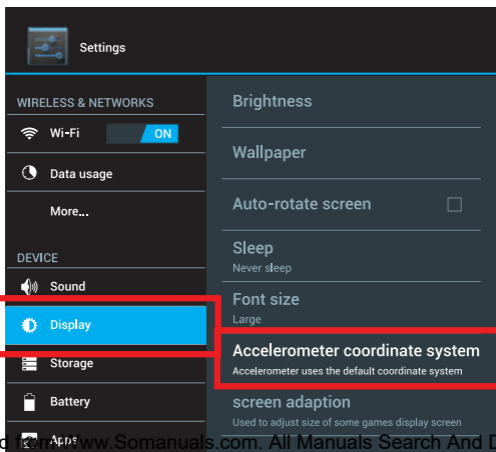

Recommended Apps

There are thousands of apps available on the Amazon app store, below are apps we recommend to download and install to the tablet.



Amazon MP3

Purchase and wirelessly download music directly to the tablet.



Netflix

Stream movies and TV shows.
(Subscription charges may apply)



Skype

Video chat, VOIP calls and more.

Searching for Apps

Type the name of the app you are looking for in the search box, and select the search icon.

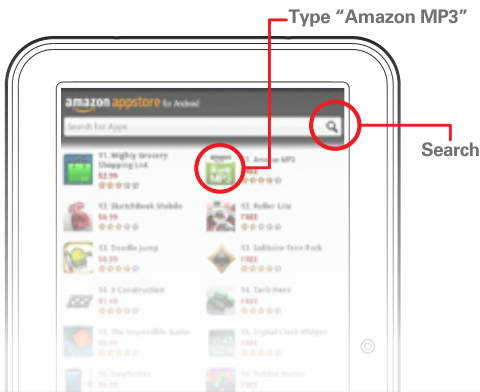

Note: Polaroid and the manufacturer of this tablet are not affiliated with, connected to, or sponsored by Amazon, Amazon appstore, Amazon MP3 app, Skype or Netflix.

We recommend the Amazon Appstore over the other available options because of the wide selection of available apps, user experience, and customer service.

Camera and video chat

Front facing camera

Select  on the apps screen to go to camera mode. It is possible to take pictures or videos with the built-in, front facing camera.



Apps screen



Camera mode

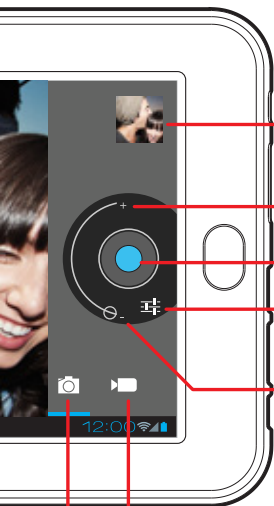

Access pictures & videos

Zoom +

Take picture / video

Settings

Zoom -

Camera Video

Select the picture to go to the pictures folder of the gallery app where all the pictures and videos are saved.



Sharing pictures

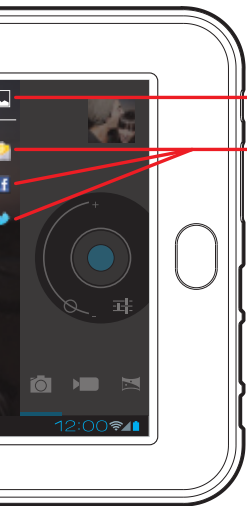

Return to camera mode

**Share pictures to
Email, Facebook or Twitter:**

To utilize this feature you must have a Facebook or Twitter account and be logged in, for Email, an account must be set up for this option to appear.

Video chat

Use the built-in, front facing camera to video chat with friends and family.

There are many different services that offer video chat however we recommend downloading the Skype app from the Amazon Appstore.



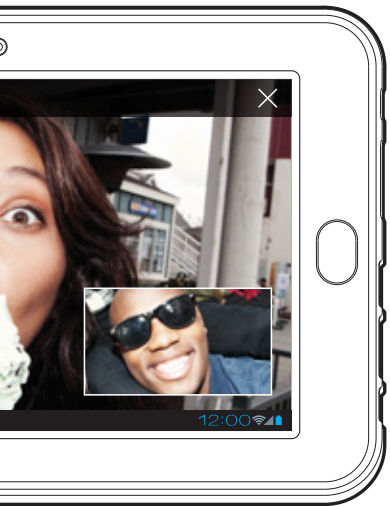

Web browsing



Select “Browser” on the Home or Apps screen (You must connect to Wi-Fi before accessing the web).

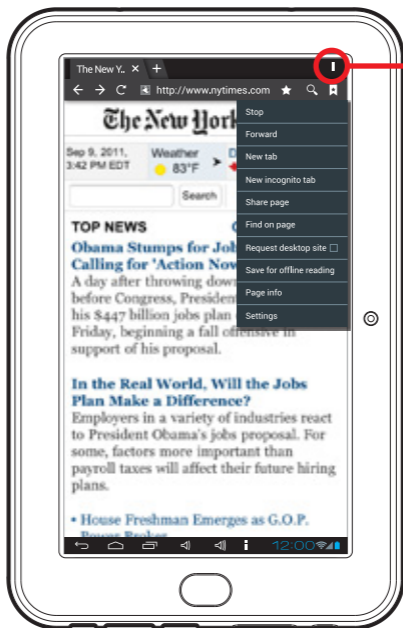

Select for Browser options

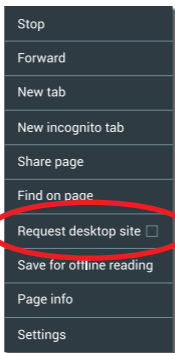

Request desktop site



Mobile browser mode

Request desktop site ✓



Desktop (Full view) browser mode

Setting up e-mail



Select  "Email" on the Home or Apps screen and follow the instructions to set up your email account on the tablet. (You must connect to Wi-Fi before accessing or setting up email accounts).

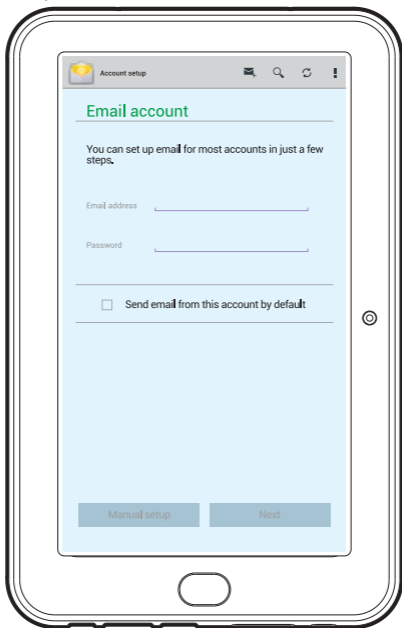

Email Setup screen

Click  to access Email settings

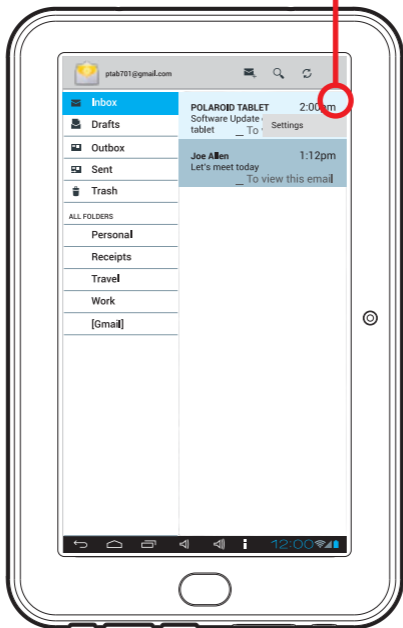

INBOX screen

Photo gallery



Access pictures and videos stored on the tablet.

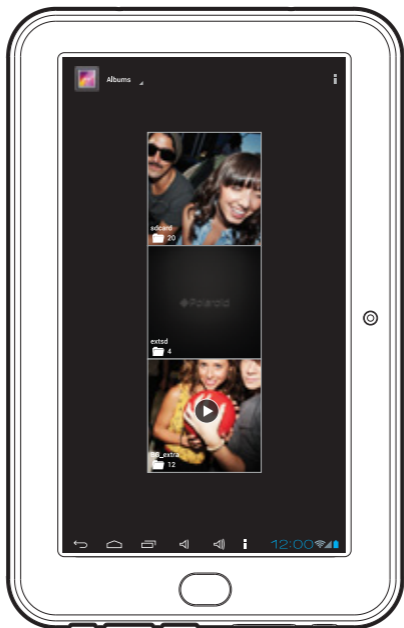

Viewing pictures:

Pinch to enlarge and swipe to go to previous or next pictures.



Share pictures to Email, Facebook or Twitter:

To utilize this feature you must have a Facebook or Twitter account and be logged in, for Email, an account must be set up for this option to appear.

 Share: Share the selected picture through Email, Facebook, or Twitter

 Trash: Delete the selected picture

 Menu: Slideshow, edit and more

Watching videos:

While playing a video, tap the display to access the video controller, tap the display again to hide the controller.



Transferring and managing files

It is possible to manage and transfer media files to the tablet by connecting it to your computer.

Conserve Internal Memory!

It is strongly recommended to purchase and install a Micro SD card before transferring or downloading media files.

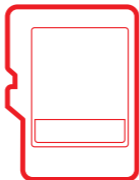

Micro SD card



Tips: Transfer and store media files such as music, pictures and video on to a Micro SD card and avoid placing these types of files in the internal memory of the tablet - this will conserve the internal memory, and allow you to download more apps.



Inserting Micro SD card

The tablet supports Micro SD cards up to 32GB (not included).

To install a Micro SD card into the tablet:

1. Insert the card face up into the card slot until it clicks and locks into place.



Face up

2. Once the card is mounted, the card icon appears on the Status Bar.

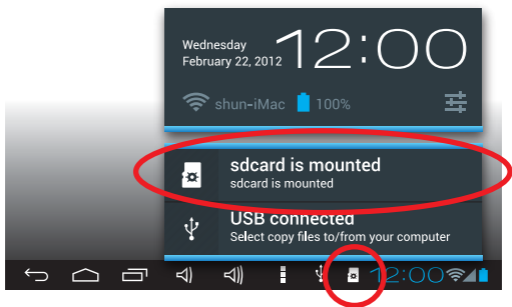

3. To access the Micro SD card, select "File Manager" from the Apps screen.



File Manager

Unmount & remove the Micro SD card:

1. Open "Settings"
2. Select "Storage"
3. Select "Unmount Micro SD card"
4. It is now safe to remove the card from the tablet.
5. To remove the card, gently push it in until it pops out.



Settings

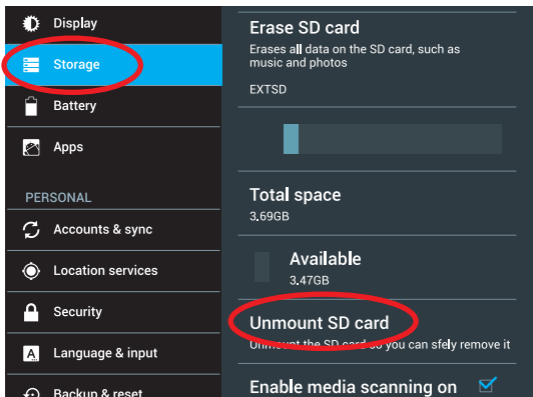

- A card can only be inserted one way; do not use force when inserting the card.
- Make sure to unmount the card before taking it out of the tablet.

Connecting the tablet to a PC or Mac:

1. Connect the included USB cable to the "USB port" of the tablet and USB port of the computer.

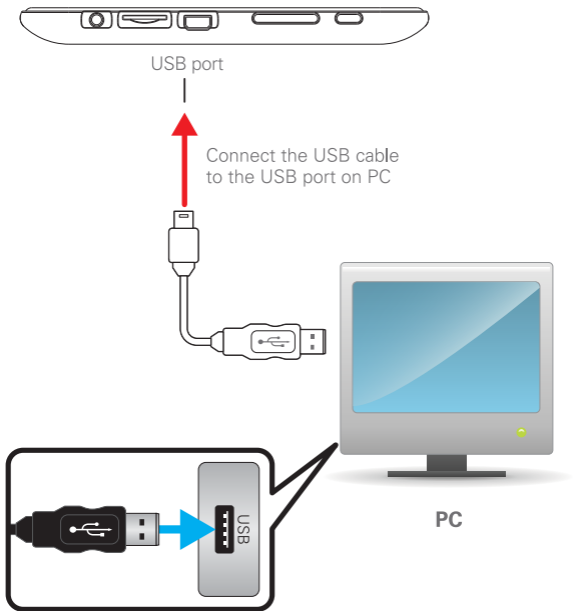

Minimum system requirements:

- Windows: 2000, XP, Vista, 7
- Mac OS X: 10.5 or later (with USB connection)

2. The "USB connected" screen appears, select "Turn on USB storage", then select "OK".

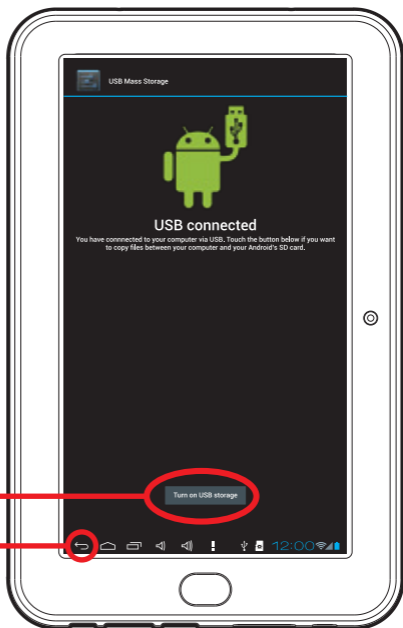

USB Connected screen



Note: While connected to the computer, you can also access the "USB connected" screen from the Status Bar as shown below.

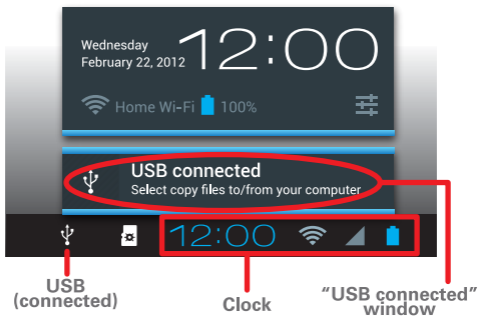

"Removable Disk" window appears if a Micro SD card is inserted

3. The "Autoplay" window appears on your computer's display - select "INTERNAL" to view and manage files on the tablet, or if a Micro SD card is inserted, select "Removable Disk" to manage files on the card.

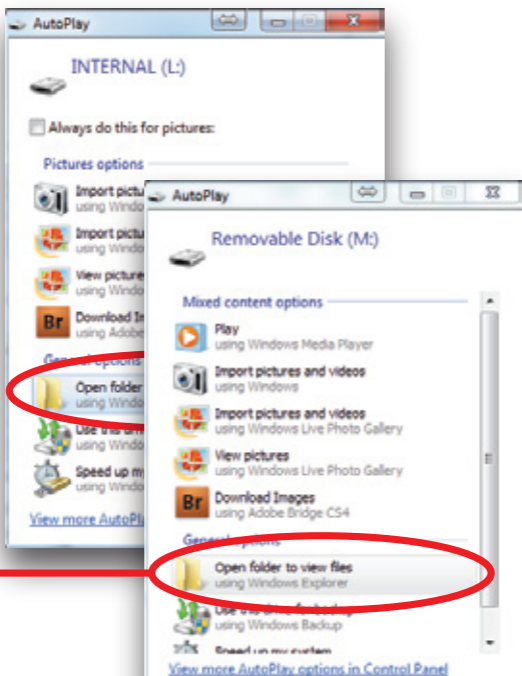

4. Copy media files from your computer to the Micro SD card.



Media files on your computer

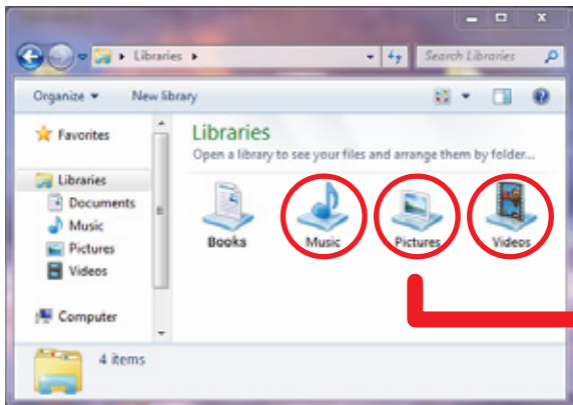

Conserve Internal Memory!

Transfer media files to "Removable Disk"
(Micro SD card)

i

Tips: Organize your media (pictures, videos and music) by creating folders such as "Pictures", Videos" and "Music" on the Micro SD card as shown below.



"Removable Disk"
access the Micro SD card

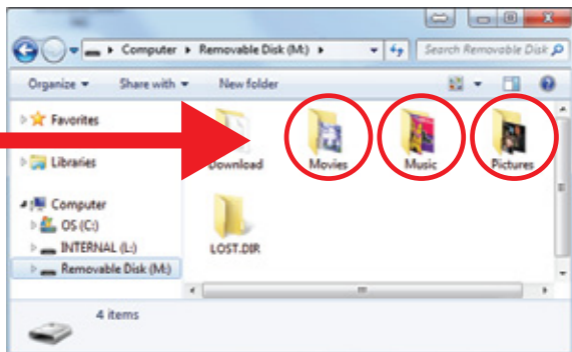

5. Select "Turn off USB storage" on the tablet to disconnect it from the computer.

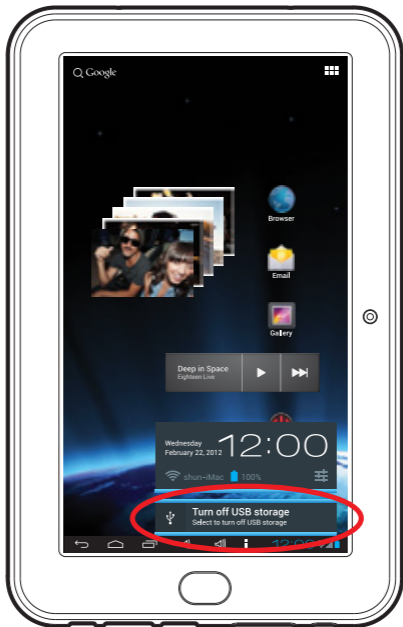

Browsing files



File Manager:

To view, open, copy or delete files on the internal memory of the tablet, inserted Micro SD card or USB stick, select "File Manager" on the Apps screen.



Go back to the previous folder



Go to internal memory



Go to microSD card



Go to USB



Go to pictures



Go to movies



Settings



Folder actions

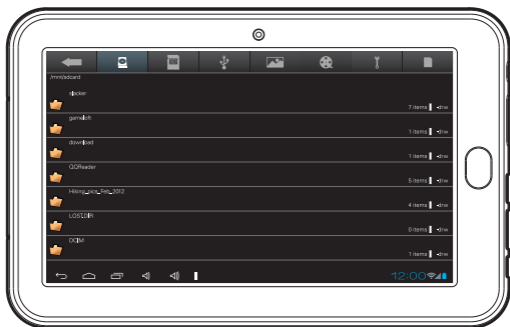

Briefly press a file or folder to open it.

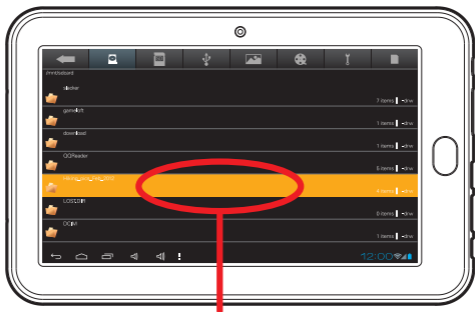

Press to open
Press & Hold for Options

Copy, move or delete a file or folder:

1. Press and hold a file or folder until the options window appears, then select an option from the options window.

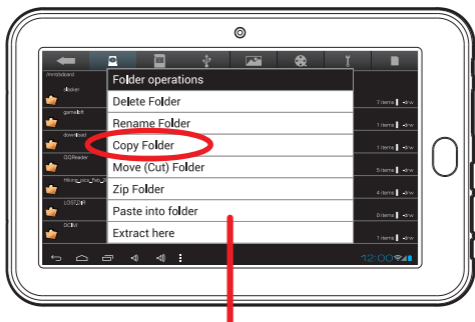

2. Select a file or folder.



3. If you select "Copy" or "Move", press and hold on a folder and select "Paste into folder" to copy the file there.

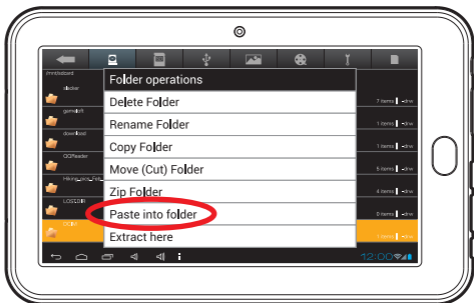

Multimedia

Use the tablet to store and play music, pictures and video files.



Music

Access music files stored on the tablet.

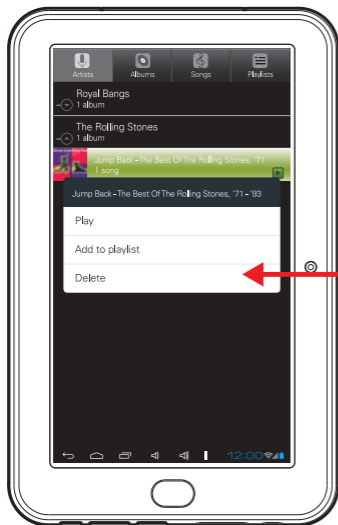

Press & hold a song title, and these options will appear

Music screen

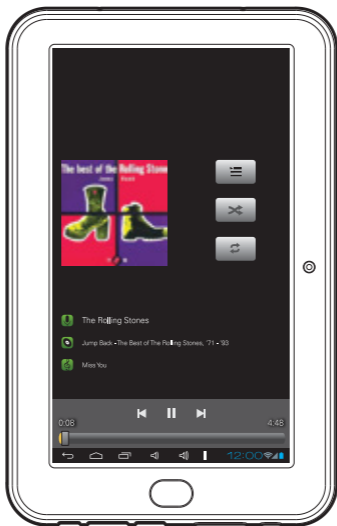

Music playback screen

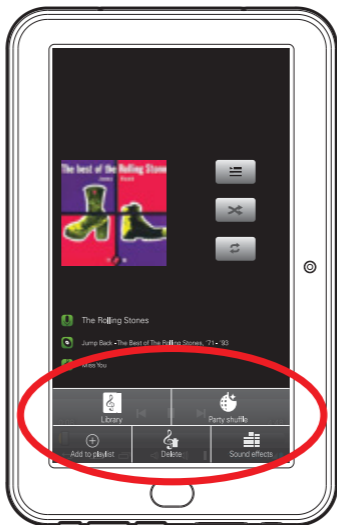

Music playback options

Download from [Www.Somanuals.com](http://www.Somanuals.com). All Manuals Search And Download

Settings



Settings app:

Customize and select options to increase battery performance, Wi-Fi options, manage apps and more.

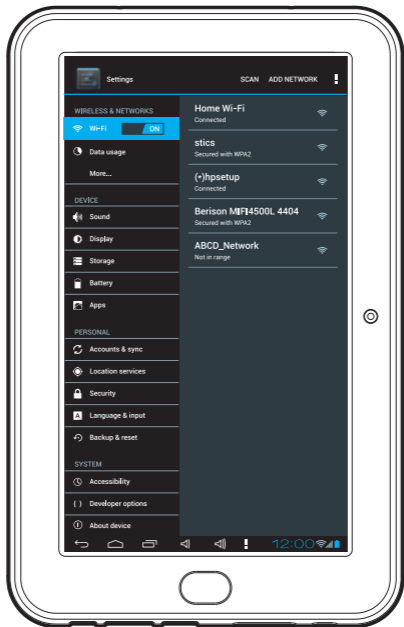

Settings screen

Online help



Select "Online Help" on the Apps screen to access:

- New apps and updates for current apps
- Firmware updates
- Technical support
- Product registration



Online Help screen

Resetting

In the event that the tablet freezes or does not function properly, try correcting the problem by pressing the RESET button located on the back panel (shown below).

Use a paper clip or the tip of a stylus to press the RESET button. Data stored on the tablet will not be affected by using the RESET button.

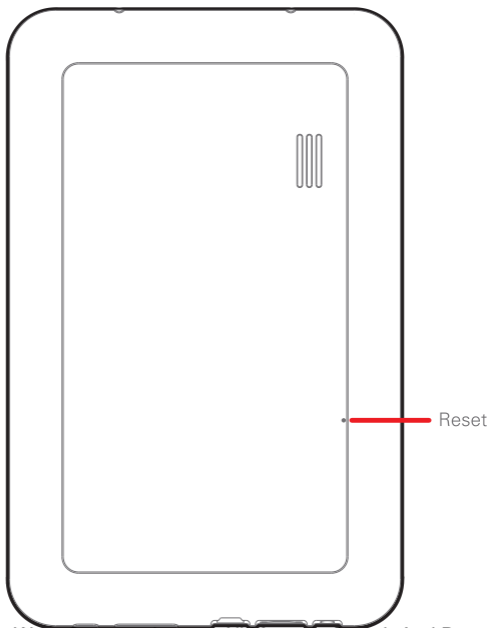

Restore

i

Note: If the problem persists it may be necessary to restore the tablet to the factory default settings:

- 1) Select  "Settings" from the Apps screen.
- 2) Select "Reset to factory default settings".
- 3) Select "Factory data reset" (this will erase data stored on the device so make sure to back up your data prior to using this option).

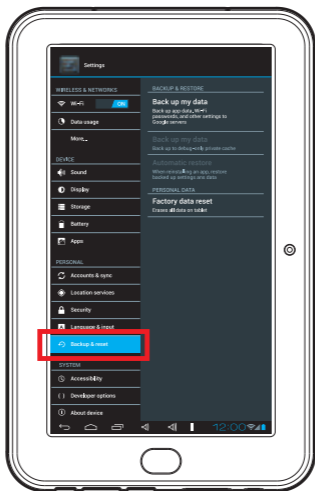

Legal information

FCC Part 15:

This equipment has been tested and found to comply with the requirements for a Class B digital device under Part 15 of the Federal Communications Commission (FCC) rules. These requirements are intended to provide reasonable protection against harmful interference in a residential installation. This equipment generates, uses and can radiate radio frequency energy and, if not installed and used in accordance with the instructions, may cause harmful interference to radio communications. However, there is no guarantee that interference will not occur in a particular installation. If this equipment does cause harmful interference to radio or television reception, which can be determined by turning the equipment off and on, the user is encouraged to try to correct the interference by one or more of the following measures:

- Re-orient or relocate the receiving antenna.
- Increase the separation between the equipment and receiver.
- Connect the equipment into an outlet on a circuit different from that to which the receiver is connected.
- Consult the dealer or an experienced radio/TV technician for help.

Do not attempt to repair or modify this equipment.

Warning: Changes or modifications to this equipment not expressly approved by the party responsible for compliance could void the user's authority to operate the equipment.

"This device complies with Part 15 of the FCC Rules.

Operation is subject to the following two conditions:

(2) this device must accept any interference received, including interference that may cause undesired operation.”

Shielded USB cables must be used with this unit to ensure compliance with the Class B FCC limits.

PLR IP Holdings, LLC, its licensees and affiliates, fully support all electronic waste initiatives. As responsible stewards of the environment, and to avoid violating established laws, you should properly dispose of this product in compliance with all applicable regulations, directives or other governances in the area where you reside. Please check with local authorities or the retailer where you purchased this product to determine a location where you can appropriately dispose of the product.

You may also go to HYPERLINK "<http://www.polaroid.com>" www.polaroid.com and reference About / Electronic Recycling to learn more about the specific laws in your area and to locate a collection facility near your home.

If your electronic device has internal memory on which personal or other confidential data may be stored, you may want to perform a data sanitization process before you dispose of your device to assure another party cannot access your personal data. Data sanitization varies by the type of product and its software, and you may want to research the best sanitization process for your device before disposal. You may also check with your local recycling facility to determine their data sanitization procedures during the recycling process.

Limited Warranty

This product as supplied and distributed new by AIT, Inc. ("AIT") to the original consumer purchaser is warranted by AIT against defects in material and workmanship for a period of one year from your date of purchase ("Warranty").

In the unlikely event that this product is defective, or does not perform properly, you may within one year from your original date of purchase return it to the authorized service center for repair or exchange.

TO OBTAIN WARRANTY SERVICE:

- Provide proof of the date of purchase within the package (Dated bill of sale).
- Prepay all shipping costs to the authorized service center, and remember to insure your return.
- Include a return shipping address (no P.O. Boxes), a telephone contact number, and the defective unit within the package.
- Describe the defect or reason you are returning the product.

Your product will be repaired or replaced, at our option, for the same or similar model of equal value if examination by the service center determines this product is defective. Products received damaged as a result of shipping, will require you to file a claim with the carrier.

The shipping address of the authorized service center is:

 AIT, Inc.
Attention: Customer Service (2nd Floor)
14-C 53rd Street
Brooklyn, NY 11232

IN NO EVENT WILL AIT, ITS MANUFACTURERS, DISTRIBUTORS OR PLR IP HOLDINGS, LLC BE LIABLE FOR ANY INCIDENTAL, DIRECT, INDIRECT, SPECIAL, PUNITIVE OR CONSEQUENTIAL DAMAGES (SUCH AS, BUT NOT LIMITED TO, DAMAGES FOR LOSS OF PROFITS, BUSINESS, SAVINGS, DATA OR RECORDS) RELATED TO THIS PRODUCT. EXCEPT AS STATED HEREIN, NO OTHER WARRANTIES SHALL APPLY.

Should you have any questions or problems concerning this product, please contact our customer service department at:

Customer Support:

 1-877-768-8481 (Toll Free)

 polaroidtabletsupport@southerntelecom.com

Monday - Thursday: 9AM - 5PM (EST)

Friday: 9AM - 3PM (EST)

Free Manuals Download Website

<http://myh66.com>

<http://usermanuals.us>

<http://www.somanuals.com>

<http://www.4manuals.cc>

<http://www.manual-lib.com>

<http://www.404manual.com>

<http://www.luxmanual.com>

<http://aubethermostatmanual.com>

Golf course search by state

<http://golfingnear.com>

Email search by domain

<http://emailbydomain.com>

Auto manuals search

<http://auto.somanuals.com>

TV manuals search

<http://tv.somanuals.com>