

Instruction manual

ESPAÑOL: PÁGINA 13
FRANÇAISE : PAGE 27

Rotary Level

Self-Leveling, Remote-Controlled
Laser Level

Model LR1100



U. S. Patents 5680208, 5903345. Engineered
in USA. Manufactured in China.

IMPORTANT

*Please make certain that the person who is
to use this equipment carefully reads and
understands these instructions before
starting operations.*

The Model and Serial No. plate is located on the main
housing of the tool. Record these numbers in the
spaces below and retain for future reference.

Model No. _____

Type _____

Serial No. _____

PORTER CABLE
PROFESSIONAL POWER TOOLS

GENERAL SAFETY RULES

ELECTRICAL SAFETY

1. **Use battery operated rotary level with alkaline batteries only.** Use of any other batteries may permanently damage the rotary level.

PERSONAL SAFETY

1. **Stay alert, watch what you are doing, and use common sense when operating a laser. Do not use rotary level while tired or under the influence of drugs, alcohol, or medication.** A moment of inattention while operating a laser may result in personal injury.

2. **Use safety equipment.** Eye protection, dust mask, non-skid safety shoes, hard hat, or hearing protection must be used for appropriate conditions.

3. **Prolonged eye contact with laser beams can cause eye irritation and injury to the eye.** Never stare directly into beam or view with optical instruments. Avoid prolonged eye contact with laser beams. Laser beam contact with the eyes can also cause temporary flash blindness, which can cause the user to be distracted, which can lead to accidents.

4. **Do not aim the laser beams at others.**

TOOL USE AND CARE

1. **Do not use rotary level if switch does not turn it on or off.** A laser that cannot be controlled with the switch is dangerous and must be repaired.

2. **Store idle rotary level out of reach of children and other untrained persons.** Rotary level should only be used by trained users.

3. **Use only accessories that are recommended by the manufacturer for your model.** Accessories that may be suitable for one rotary level may create a risk of injury when used on another rotary level.

SERVICE

1. **Rotary Level service must be performed only by qualified repair personnel.** Service or maintenance performed by unqualified personnel may result in a risk of injury.

2. **When servicing a rotary level, use only identical replacement parts. Follow instructions in the Maintenance Section of this manual.** Use of unauthorized parts or failure to follow Maintenance Instructions may create a risk of shock or injury.

SPECIFIC SAFETY RULES

1. **Be aware that the rotary level is always in an operating condition, because it does not have to be plugged into an electrical outlet.** Always set the switch to the "OFF" position when installing or removing the batteries.

2. **IMPORTANT: These labels are attached to every rotary level. They are not to be removed or defaced.**

3. **CAUTION: Use of controls, adjustments or procedures other than those specified herein may result in laser radiation exposure.**

4.  **AVOID EXPOSURE: Laser radiation is emitted from this aperture.**

5.  **WARNING: There are certain applications for which this rotary level was designed.** Porter-Cable strongly recommends that this rotary level NOT be modified and/or used for any application other than for which it was designed. If you have any questions relative to its application DO NOT use the rotary level until you have written Porter-Cable and we have advised you.

Technical Service Manager
Porter-Cable Corporation
4825 Highway 45 North
Jackson, TN 38305

FUNCTIONAL DESCRIPTION

FOREWORD

Porter-Cable Model LR 1100 Rotary Level is a self-leveling, remote-controlled, precision laser level of superior quality that is time-saving and easy to use. Place it on any surface and the perfectly balanced, self-leveling pendulum inside the device takes care of the rest.

ASSEMBLY

Rotary Level Features

Base Unit

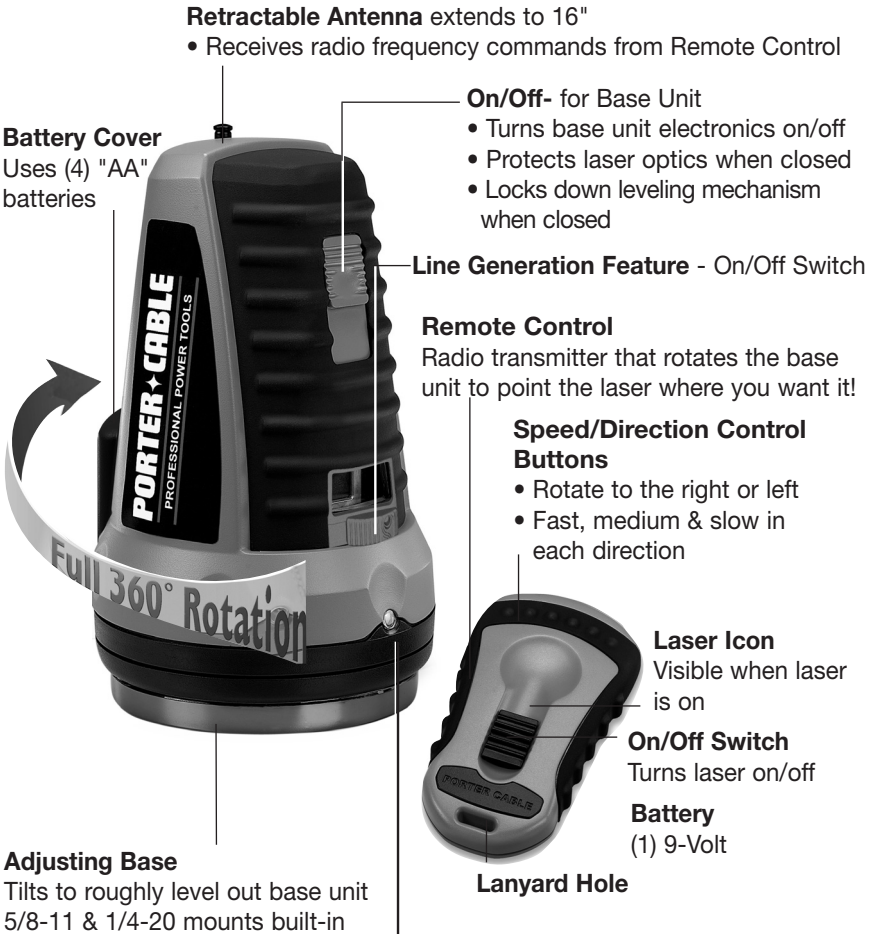

LED Light

- Indicates when laser is on/off
- Flashes when out of level



AVOID EXPOSURE: Laser radiation is emitted from this aperture.

OPERATION

Quick Guide to Using Rotary Level

The One Minute Set-Up

1. Set the Base Unit up on a tripod or any surface that is within 10° of level.

There are two tripod mounts built into the bottom of the Adjusting Base - a 5/8" x 11 (standard transit level tripod) and 1/4" x 20 (camera-type tripod).

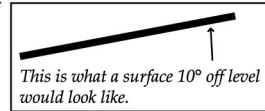

2. Extend the Antenna on the base unit by pulling up gently. *The Antenna extends 16".*
3. Slide the On/Off switch on the Base Unit up. The LED will light up for two seconds to let you know the Base Unit is on. (The laser will not come on until you turn the Remote Control on) *If the LED does not light, check to make sure the Lens Cover is all the way up. If the LED is still not lit, you need to change the batteries in the Base Unit.*

4. Turn the laser on by sliding the On/Off switch on the Remote Control down so that the laser symbol is exposed.



5. The laser and LED will blink on and off if the Base Unit is out-of-level. If this occurs, roughly level out the Base Unit by moving it on the Adjusting Base until the laser stops blinking. *Rotary Level is self-leveling within a +/-10° range.*

6. Using the Remote Control, rotate the base unit a full 360° (preferably on medium speed - the second arrow in from either side of the Remote Control). If the laser or LED blinks at any time during this rotation stop and adjust the Base Unit on its Adjusting Base until the laser stops blinking, then repeat your 360° rotation from that point.

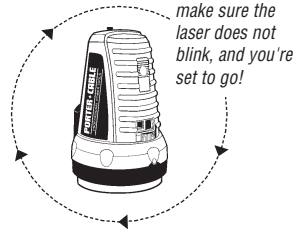

Laser Auto Shutdown Feature

The laser in the Base Unit has an auto-shutdown feature to extend battery life. **THE LASER WILL SHUT OFF AFTER FIVE MINUTES OF INACTIVITY.** Prior to shutdown, the laser and LED will blink quickly twice, pause, then blink quickly twice again. To turn the laser back on, you must turn the Remote Control off and then on again (slide the On/Off switch up and then down again).

Turning Rotary Level Off

8. Slide the On/Off switch on the Remote Control up so that the laser symbol is no longer visible.
9. On the Base Unit, slide the On/Off switch down. Unless the On/Off switch is down, the Base Unit is not completely shut off and will continue to drain battery power. The On/Off switch also locks down the (pendulum) self-leveling mechanism for stability during transport.

Using the Remote Control

The Remote Control is one of the features that makes Rotary Level unique in the field of laser leveling systems. Using the Remote Control, you can control the rotation of the Base Unit from up to 100 feet away! You don't even have to be "in sight" of the Base Unit because the Remote Control operates on radio frequency.

The speed / direction buttons control the rotation of the precision step motor inside the Base Unit - which simply means that you put the laser dot right where you need it for marking or measurement.

By pressing the speed / direction buttons, you can rotate the Base Unit 360° clockwise (right) or counterclockwise (left).

There are three speeds of rotation - Fast, Medium, and Slow (very slow). The slowest speed is most helpful when you want the laser dot to hit a specific spot.

Finding The Laser Dot

Using the speed / direction buttons on the Remote Control, rotate the Base Unit until you see the LED on the Base Unit straight on (at its brightest). It is easiest to sweep the laser dot across walls or other flat surfaces. Your body can also be used as a target if operating the unit in an open field.

⚠ DANGER: Never look directly into the laser source as this may cause eye damage.

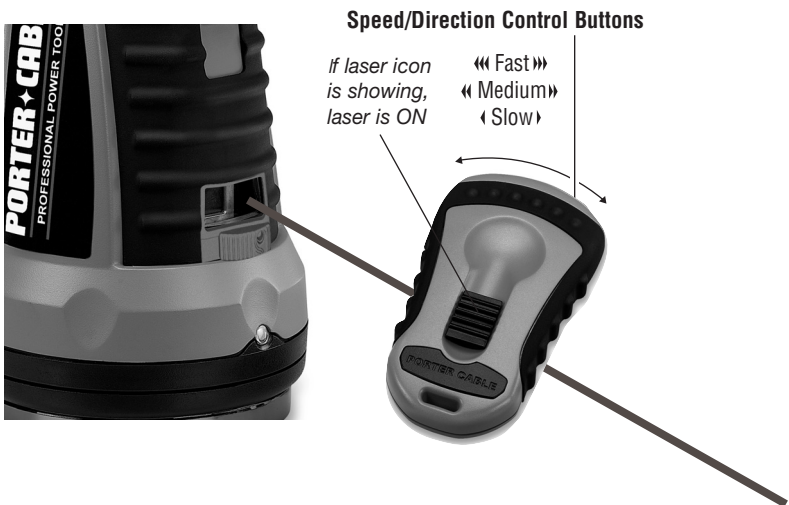

NOTE: Multiple Remote Controls - can be used with one Base Unit. Additional / Replacement Remote Control can be purchased separately.

Battery replacement

Base Unit - 4 "AA" Alkaline Batteries

1. Unscrew the battery housing cover using either your fingers or a coin.
Lift the cover off.
2. Insert the new batteries according to the illustrations on the battery slots.
3. Replace the battery housing cover and tighten the screw securely.

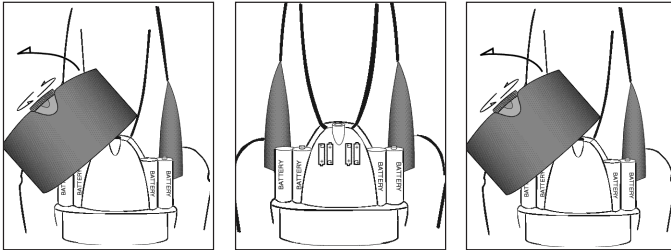

Remote Control - 1 9-Volt Battery

1. Unscrew the battery door on the back of the Remote Control using a slotted screwdriver. Remove the battery door by pushing down on the bottom half of the battery door.
2. Pop the battery out by lifting from the bottom of the battery.
3. Place the new battery into the battery slot and press upwards towards the contacts firmly until the battery snaps into place.
4. Replace the battery door. Tighten the screw securely.

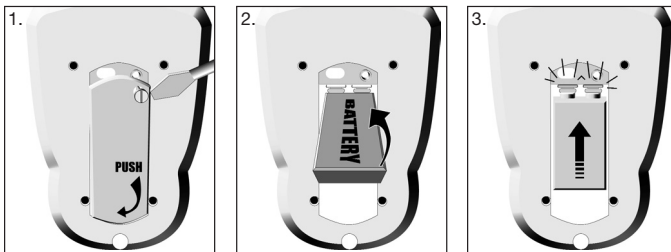

⚠ DANGER: - use of controls or adjustments or performance of procedures other than those specified herein may result in hazardous radiation exposure.

Recalibration

Rotary Level can be recalibrated by you, in the field. If Rotary Level is dropped, you should recalibrate.

1. Choose your recalibration site. To get the most accurate calibration possible, it is best to use two vertical (plumb) surfaces directly opposite each other, 100' apart (50' minimum).

The recalibration process should be done on a level surface so that the Base Unit does not have to be re-adjusted on its base during calibration.

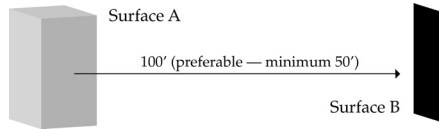

2. Make sure the laser is off (Remote Control switch is in the off position - no laser icon showing).
3. Slide the Base Unit On/Off switch to the "on" position. Slide the line generation switch "Off". Remove the Recalibration Plug, located at the bottom of the laser opening. Take care not to lose the recalibration plug as you pop it out.

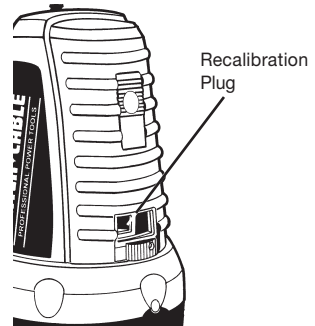

4. Place the Base Unit about 5' from one of your two vertical surfaces. This will be Surface A. Turn the Base Unit and Remote Control on.
5. Rotate the Base Unit 360°, making sure the laser and LED don't blink at any time during the rotation. If they blink at any point, simply adjust the Base Unit on the Adjusting Base and continue.
6. Using the Remote Control, position the laser dot on Surface A and mark the dot location.
7. Using the Remote Control, rotate the Base Unit 180° so that the laser dot is now visible on your opposing surface, Surface B. Mark the laser dot position on Surface B.

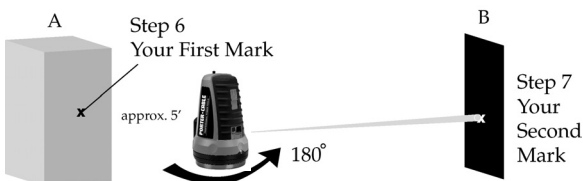

8. Move the base unit to about 5' from Surface B (the location you just marked). Raise or lower the Base Unit so that the laser dot hits the spot you have already marked.



9. Using the Remote Control, rotate the Base Unit until the laser dot is exactly on, directly above, or directly below the point marked on Surface A. Mark this new spot. *You should now have two spots marked on Surface A. Any difference in height between the two marks is equal to twice the error in calibration. If the two marks are at the same point, the unit does not need to be calibrated.*

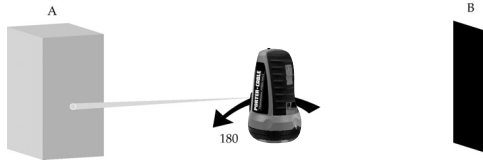

10. Insert the Allen wrench (provided with your Carrying Case) into the recalibration port on the Base Unit (where you removed the plug from). Press in firmly until you engage the socket headed screw.

11. Turn the Allen wrench 45°, then pull it out and note the position of the laser dot.

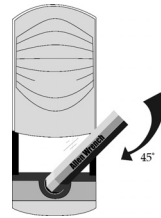

Repeat this process until the dot is 1/2 way in between your first and second markings on Surface A (where you started this whole thing from). To raise the laser dot, turn the Allen wrench clockwise. To lower the dot, turn the Allen wrench counterclockwise.

12. Once the recalibration is complete, turn the laser off (Remote Control switch in the off position). Replace the Recalibration Plug by pressing it back in firmly.



Specifications

Accuracy: +/- 1/8" @ 100' (radius)

Self-leveling: Level range +/- 10°; flashing out-of-level indicator

Remote Control: 3 speeds (low, medium & high); range – 100' radius and 200' diameter

Range: Laser visibility up to 100' (indoor & outdoor – no detector required); full 360° rotation

Pendulum Lock: Protects pendulum during transportation and storage for added durability

Line Generation Feature: Converts laser beam to line of bright dots

Recalibration: On the jobsite

Environmental: Dust, dirt and water resistant

Laser Diode: Class IIIA 635nm

Tripod Mount: 1/4" x 20 & 5/8" x 11, (can be used without tripod; tripod not included)

Warranty: 1 year limited

Power Supply: Base unit – 4 “AA” batteries; remote control – 9 volt battery (not included)

Made In China

Troubleshooting

When the...

LED does not come on when Lens Cover is up.

The batteries in the Base Unit may need to be changed. Change the batteries, then turn the Base Unit on again.

LED and Laser blink continuously.

Laser is out-of-level, or has been knocked out-of-level. Move the Base Unit on the Adjusting Base until both the LED and Laser quit blinking. Use the Remote Control to rotate the Base Unit 360°, making sure the Laser/LED do not blink at any time during the rotation.

Remote Control will not drive the Base Unit.

Change the battery in the Remote Control. If the problem persists, change the batteries in the Base Unit.

Laser & LED shut off without warning blinks.

Check batteries in the Base Unit. Prolonged exposure to extremely high temperatures (120° F +) may cause the laser to overheat. This will cause the self-protection circuit in the Base Unit to shut down.

Base Unit will not move on Adjusting Base.

The Base Unit has been mounted to a screw longer than 5/8". This could cause damage to the Adjusting Base.

Line Generating Feature

You have just purchased your Self-Leveling, Remote Controlled Laser, Rotary Level with the new line-generating feature. The following outlines the operation of the feature with your Rotary Level.

The line-generating feature converts Rotary Level's single laser dot into a line of bright dots, designed specifically for interior leveling applications. Turn the line generation feature switch "ON". A horizontal, stationary line of bright laser dots will appear if the Rotary Level is level and a horizontal, flashing line of bright laser dots will appear if the Rotary Level is not level. Reposition the Rotary Level within its self-leveling range of +/- 10 degrees to achieve a stationary, horizontal level line of laser dots. The line can then be positioned around the worksite with the Rotary Level remote control.

Note: The center section of the line yields the brightest dots. Dots at the far extreme will appear fainter.

Note: Be sure to turn the Rotary Level off during storage and transportation. Failure to do so will affect the battery life.



User Safety



Important: These labels are attached to every Rotary Level. They are not to be removed or defaced.

FCC Statement

This equipment has been tested and found to comply with the limits for a Class B digital device, pursuant to Part 15 of the FCC Rules. These limits are designed to provide reasonable protection against harmful interference in a residential installation. This equipment generates, uses and can radiate radio frequency energy and, if not installed and used in accordance with the instructions, may cause harmful interference to radio communication. However, there is no guarantee that interference will not occur in a particular installation. If this equipment does cause harmful interference to radio or television reception, which can be determined by turning the equipment off and on, the user is encouraged to try to correct the interference by one or more of the following measures:

- Reorient or relocate the receiving antenna
- Increase the separation between the equipment and receiver
- Consult the dealer or an experienced radio/TV technician for help.

This device complies with Part 15 of the FCC Rules. Operation is subject to the following two conditions:

- (1) This device may not cause harmful interference, and
- (2) This device must accept any interference received, including interference that may cause undesired operation.

IMPORTANT: Changes or modifications to this product not authorized by Porter-Cable Corporation, could void the FCC Certification and negate your right to operate the product.

Porter-Cable Corporation
4825 Highway 45 North
Jackson, TN 38305
Copyright © 2002, All rights reserved.

GENERAL MAINTENANCE

KEEP TOOL CLEAN

All plastic parts should be cleaned with a soft damp cloth. NEVER use solvents to clean plastic parts. They could very possibly dissolve or otherwise damage the material.

FAILURE TO OPERATE

Should your laser square fail to operate, make sure batteries are charged and properly installed.

BATTERY

The batteries will discharge if stored for long periods of time, and may require replacement before use.

SERVICE AND REPAIRS

All quality tools will eventually require servicing or replacement of parts due to wear from normal use. These operations, should ONLY be performed by either an AUTHORIZED PORTER-CABLE SERVICE STATION or a PORTER-CABLE • DELTA FACTORY SERVICE CENTER. All repairs made by these agencies are fully guaranteed against defective material and workmanship. We cannot guarantee repairs made or attempted by anyone other than these agencies.

Should you have any questions about your laser square, feel free to write us at any time. In any communications, please give all information shown on the nameplate of your laser square (model number, type, serial number, etc.).

ACCESSORIES

A complete line of accessories is available from your Porter-Cable Supplier, Porter-Cable • Delta Factory Service Centers, and Porter-Cable Authorized Service Stations. Please visit our Web Site www.porter-cable.com for a catalog or for the name of your nearest supplier.



WARNING: Since accessories other than those offered by Porter-Cable have not been tested with this product use of such accessories could be hazardous. For safest operation, only Porter-Cable recommended accessories should be used with this product.

REPLACEMENT PARTS LIST

- 905898 ANTENNA**
- 905899 REMOTE CONTROL**
- 905900 REMOTE CONTROL BATTERY COVER**
- 905901 BATTERY COVER SCREW**
- 905907 BATTERY COVER**
- 905972 CALIBRATION PORT PLUG**

PORTER-CABLE LIMITED ONE YEAR WARRANTY

Porter-Cable warrants its Professional Power Tools for a period of one year from the date of original purchase. We will repair or replace at our option, any part or parts of the product and accessories covered under this warranty which, after examination, proves to be defective in workmanship or material during the warranty period. For repair or replacement return the complete tool or accessory, transportation prepaid, to your nearest Porter-Cable Service Center or Authorized Service Station. Proof of purchase may be required. This warranty does not apply to repair or replacement required due to misuse, abuse, normal wear and tear or repairs attempted or made by other than our Service Centers or Authorized Service Stations.

ANY IMPLIED WARRANTY, INCLUDING THE IMPLIED WARRANTIES OF MERCHANTABILITY AND FITNESS FOR A PARTICULAR PURPOSE, WILL LAST ONLY FOR ONE (1) YEAR FROM THE DATE OF PURCHASE.

To obtain information on warranty performance please write to: PORTER-CABLE CORPORATION, 4825 Highway 45 North, Jackson, Tennessee 38305; Attention: Product Service. THE FOREGOING OBLIGATION IS PORTER-CABLE'S SOLE LIABILITY UNDER THIS OR ANY IMPLIED WARRANTY AND UNDER NO CIRCUMSTANCES SHALL PORTER-CABLE BE LIABLE FOR ANY INCIDENTAL OR CONSEQUENTIAL DAMAGES. Some states do not allow limitations on how long an implied warranty lasts or the exclusion or limitation of incidental or consequential damages, so the above limitation or exclusion may not apply to you.

This warranty gives you specific legal rights and you may also have other legal rights which vary from state to state.

PORTER-CABLE • DELTA SERVICE CENTERS (CENTROS DE SERVICIO DE PORTER-CABLE • DELTA) (CENTRE DE SERVICE PORTER-CABLE • DELTA)

**Parts and Repair Service for Porter-Cable • Delta Power Tools are Available at These Locations
(Obtenga Refaccion de Partes o Servicio para su Herramienta en los Sigüientes Centros de Porter-Cable • Delta)
(Locations où vous trouverez les pièces de rechange nécessaires ainsi qu'un service d'entretien)**

ARIZONA

Tempe 85282 (Phoenix)
2400 West Southern Avenue
Suite 105
Phone: (602) 437-1200
Fax: (602) 437-2200

CALIFORNIA

Ontario 91761 (Los Angeles)
3949A East Guasti Road
Phone: (909) 390-5555
Fax: (909) 390-5554
San Leandro 94577 (Oakland)
3039 Teagarden Street
Phone: (510) 357-9762
Fax: (510) 357-7939

COLORADO

Arvada 80003 (Denver)
8175 Sheridan Boulevard, Unit S
Phone: (303) 487-1809
Fax: (303) 487-1868

FLORIDA

Davie 33314 (Miami)
4343 South State Rd. 7 (441)
Unit #107
Phone: (954) 321-6635
Fax: (954) 321-6638
Tampa 33609
4538 W. Kennedy Boulevard
Phone: (813) 877-9585
Fax: (813) 289-7948

GEORGIA

Forest Park 30297 (Atlanta)
5442 Frontage Road, Suite 112
Phone: (404) 608-0006
Fax: (404) 608-1123

ILLINOIS

Addison 60101 (Chicago)
400 South Rohlfing Road
Phone: (630) 424-8805
Fax: (630) 424-8895
Woodridge 60517 (Chicago)
2033 West 75th Street
Phone: (630) 910-9200
Fax: (630) 910-0360

MARYLAND

Elkridge 21075 (Baltimore)
7397-102 Washington Blvd.
Phone: (410) 799-9394
Fax: (410) 799-9398

MASSACHUSETTS

Braintree 02185 (Boston)
719 Granite Street
Phone: (781) 848-9810
Fax: (781) 848-8759
Franklin 02038 (Boston)
Franklin Industrial Park
101E Constitution Blvd.
Phone: (508) 520-8802
Fax: (508) 528-8089

MICHIGAN

Madison Heights 48071 (Detroit)
30475 Stephenson Highway
Phone: (248) 597-5000
Fax: (248) 597-5004

MINNESOTA

Minneapolis 55429
5522 Lakeland Avenue North
Phone: (763) 561-9080
Fax: (763) 561-0653

MISSOURI

North Kansas City 64116
1141 Swift Avenue
P.O. Box 12393
Phone: (816) 221-2070
Fax: (816) 221-2897
St. Louis 63119
7574 Watson Road
Phone: (314) 968-8950
Fax: (314) 968-2790

NEW YORK

Flushing 11365-1595 (N.Y.C.)
175-25 Horace Harding Expwy.
Phone: (718) 225-2040
Fax: (718) 423-9619

NORTH CAROLINA

Charlotte 28270
9129 Monroe Road, Suite 115
Phone: (704) 841-1176
Fax: (704) 708-4625

OHIO

Columbus 43214
4560 Indianola Avenue
Phone: (614) 263-0929
Fax: (614) 263-1238
Cleveland 44125
8001 Sweet Valley Drive Unit #19
Phone: (216) 447-9030
Fax: (216) 447-3097

OREGON

Portland 97230
4916 NE 122 nd Ave.
Phone: (503) 252-0107
Fax: (503) 252-2123

PENNSYLVANIA

Willow Grove 19090
520 North York Road
Phone: (215) 658-1430
Fax: (215) 658-1433

Texas

Carrollton 75006 (Dallas)
1300 Interstate 35 N, Suite 112
Phone: (972) 446-2996
Fax: (972) 446-8157
Houston 77055
West 10 Business Center
1008 Wirt Road, Suite 120
Phone: (713) 682-0334
Fax: (713) 682-4867

WASHINGTON

Auburn 98001 (Seattle)
3320 West Valley HWY, North
Building D, Suite 111
Phone: (253) 333-8353
Fax: (253) 333-9613

Authorized Service Stations are located in many large cities. Telephone **800-487-8665** or **731-541-6042** for assistance locating one. Parts and accessories for Porter-Cable • Delta products should be obtained by contacting any Porter-Cable • Delta Distributor, Authorized Service Center, or Porter-Cable • Delta Factory Service Center. If you do not have access to any of these, call **888-848-5175** and you will be directed to the nearest Porter-Cable • Delta Factory Service Center. Las Estaciones de Servicio Autorizadas están ubicadas en muchas grandes ciudades. Llame al **800-487-8665** ó al **731-541-6042** para obtener asistencia a fin de localizar una. Las piezas y los accesorios para los productos Porter-Cable • Delta deben obtenerse poniéndose en contacto con cualquier distribuidor Porter-Cable • Delta, Centro de Servicio Autorizado o Centro de Servicio de Fábrica Porter-Cable • Delta. Si no tiene acceso a ninguna de estas opciones, llame al **888-848-5175** y le dirán al Centro de Servicio de Fábrica Porter-Cable • Delta más cercano. Des centres de service agréés sont situés dans beaucoup de grandes villes. Appelez au **800-487-8665** ou au **731-541-6042** pour obtenir de l'aide pour en repérer un. Pour obtenir des pièces et accessoires pour les produits Porter-Cable • Delta, s'adresser à tout distributeur Porter-Cable • Delta, centre de service agréé ou centre de service d'usine Porter-Cable • Delta. Si vous n'avez accès à aucun de ces centres, appelez le **888-848-5175** et on vous dirigera vers le centre de service d'usine Porter-Cable • Delta le plus proche.

CANADIAN PORTER-CABLE • DELTA SERVICE CENTERS

ALBERTA

Bay 6, 2520-23rd St. N.E.
Calgary, Alberta
T2E 8L2
Phone: (403) 735-6166
Fax: (403) 735-6144

BRITISH COLUMBIA

8520 Baxter Place
Burnaby, B.C.
V5A 4T8
Phone: (604) 420-0102
Fax: (604) 420-3522

MANITOBA

1699 Dublin Avenue
Winnipeg, Manitoba
R3H 0H2
Phone: (204) 633-9259
Fax: (204) 632-1976

ONTARIO

505 Southgate Drive
Guelph, Ontario
N1H 6M7
Phone: (519) 836-2840
Fax: (519) 767-4131

QUÉBEC

1515 Ave.
St-Jean Baptiste,
Québec, Québec
G2E 5E2
Phone: (418) 877-7112
Fax: (418) 877-7123
1447, Begin
St-Laurent, (Montréal), Québec
H4R 1V8
Phone: (514) 336-8772
Fax: (514) 336-3505

The following are trademarks of PORTER-CABLE • DELTA (Las sigüientes son marcas registradas de PORTER-CABLE • DELTA S.A.) (Les marques suivantes sont des marques de fabricant de la PORTER-CABLE • DELTA): BANNER®, LASERLOC®, OMNJI®, POCKET CUTTER®, PORTA-BAND®, PORTA-PLANE®, PORTER-CABLE®, QUICKSAND®, SANDTRAP®, SAW BOSS®, SPEED-BLOC®, SPEEDMATIC®, SPEEDTRONIC®, STAIR-EASE®, THE PROFESSIONAL EDGE®, THE PROFESSIONAL SELECT®, TIGER CUB®, TIGER SAW®, TORQ-BUSTER®, VERSA-PLANE®, WHISPER SERIES®, DURATRONIC™, FRAME SAW™, INNOVATION THAT WORKS™, JETSTREAM™, MICRO-SET™, MORTEN™, NETWORK™, RIPTIDE™, TRU-MATCH™, WOODWORKER'S CHOICE™, THE AMERICAN WOOD SHOP™ (design) , AUTO-SET™, B.O.S.S.™, BUILDER'S SAW™, CONTRACTOR'S SAW™, DELTA™, DELTACRAFT™, HOMECRAFT™, JET-LOCK™, KICKSTAND™, THE LUMBER COMPANY™ (design), MICRO-SET™, Q3™, QUICKSET II™, QUICKSET PLUS™, SAFEGUARD II™, SANDING CENTER™, SIDEKICK™, UNIFENCE™, UNIGUARD™, UNIRIP™, UNISAW™, VERSA-FEEDER™, THIN-LINE™, TPS™, Emc2™.

Trademarks noted with ™ and ® are registered in the United States Patent and Trademark Office and may also be registered in other countries. Las Marcas Registradas con el signo de ™ y ® son registradas por la Oficina de Registros y Patentes de los Estados Unidos y también pueden estar registradas en otros países. Marques déposées, indiquées par la lettre ™ et ®, sont déposées au Bureau des brevets d'invention et marques déposées aux Etats-Unis et pourraient être déposées aux autres pays.

Free Manuals Download Website

<http://myh66.com>

<http://usermanuals.us>

<http://www.somanuals.com>

<http://www.4manuals.cc>

<http://www.manual-lib.com>

<http://www.404manual.com>

<http://www.luxmanual.com>

<http://aubethermostatmanual.com>

Golf course search by state

<http://golfingnear.com>

Email search by domain

<http://emailbydomain.com>

Auto manuals search

<http://auto.somanuals.com>

TV manuals search

<http://tv.somanuals.com>