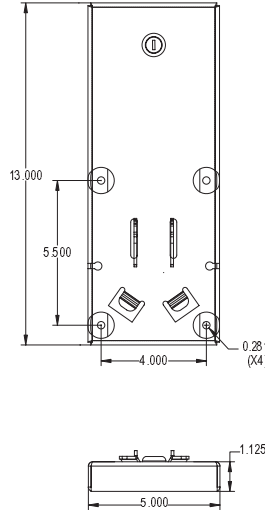



Table Safe

Designed for locations where projectors are on public display for demonstration only, this security device is perfect for retail use and tradeshow. Spring-loaded locking mechanism prevents removal of projector. Projector is held securely in upright position for easy viewing. Unit can rotate 360° to show all projector features. Unique design prevents access to mounting points - both on the counter and on the projector. Includes universal projector mount assembly that works with any projector you wish to display. Available in dark gray.



PP-TBL
Suggested List: \$199.99

Chassis Sleeve Security System

18" steel cable. Includes:
(1) cable looper guide,
(1) steel chassis sleeve,
(1) key cylinder lock.

PCB-CSL1
Suggested List: \$39.99

SECURITY DEVICES

Dual-Cable Security Device

This security device's unique design secures the mounting points on the chassis as well as two of the mounting points at the ceiling or wall. Includes: (2) steel chassis sleeves, (2) aircraft-grade plastic-sheathed braided-steel cables, keyed steel lock box. Cables are routed through the steel chassis sleeves. Works with PBL projector mounts.

Adapter	Cable	Suggested List
PP-SEC	16"	\$59.99
PP-SEC50	50"	\$74.99



Additional Steel Cables

For PP-SEC and PP-SEC50. Choose from 16" and 50" lengths of steel security cable. Or call inside sales at 800.368.9700 for a custom length for \$1.50 per foot.

Accessory	Suggested List
CBL-16	\$ 5.99
CBL-50	\$14.99



Free Manuals Download Website

<http://myh66.com>

<http://usermanuals.us>

<http://www.somanuals.com>

<http://www.4manuals.cc>

<http://www.manual-lib.com>

<http://www.404manual.com>

<http://www.luxmanual.com>

<http://aubethermostatmanual.com>

Golf course search by state

<http://golfingnear.com>

Email search by domain

<http://emailbydomain.com>

Auto manuals search

<http://auto.somanuals.com>

TV manuals search

<http://tv.somanuals.com>