

User's Manual

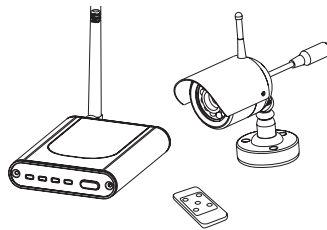

MODEL: **QSWLOC**
QSWLOCR
QSWOC2R



NIGHTVISION COLOR
OUTDOOR CAMERA

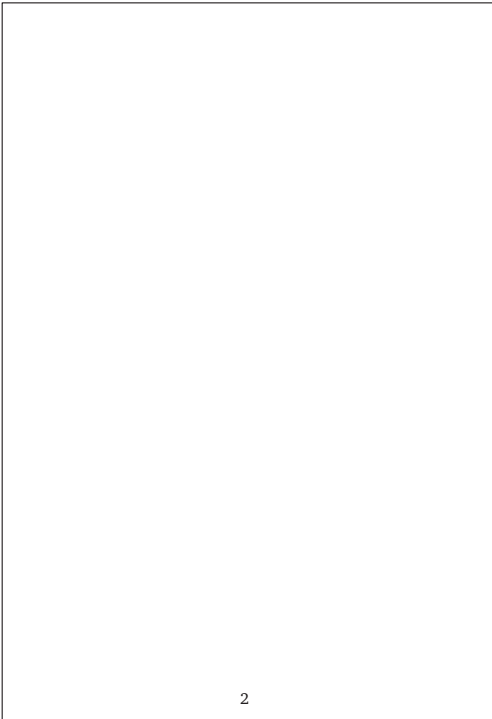

PACKING LIST

QSWLOC

- ① 2.4GHz wireless Camera × 1
- ② Adapter for Camera × 1

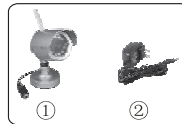

QSWLOC2R

- ① 2.4GHz wireless Camera × 1
- ② 2.4GHz wireless Receiver × 1
- ③ Antenna for Receiver × 1
- ④ Adapter for Camera × 1
- ⑤ Adapter for Receiver × 1
- ⑥ AV Cable for Receiver × 1

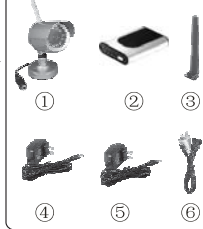

QSWOC2R

- ① 2.4GHz wireless Camera × 2
- ② 2.4GHz wireless Receiver × 1
- ③ Antenna for Receiver × 1
- ④ Adapter for Camera × 2
- ⑤ Adapter for Receiver × 1
- ⑥ AV Cable for Receiver × 1
- ⑦ Remote Controller × 1

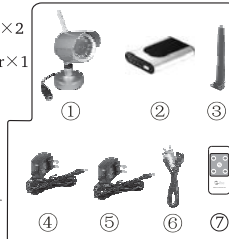

DIAGRAM

QSWLOC

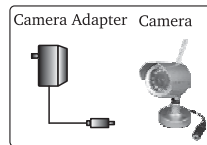

QSWLOC R

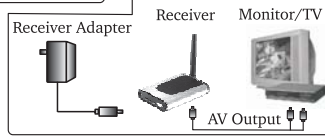
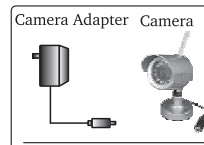

QSWOC2R

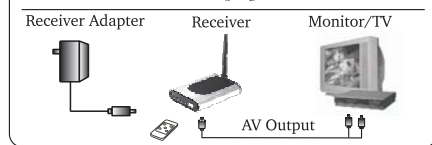
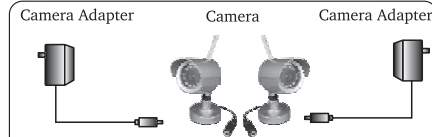

STRUCTURE

CAMERA

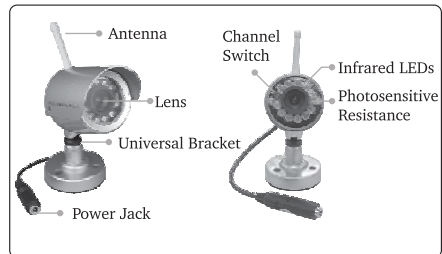

RECEIVER

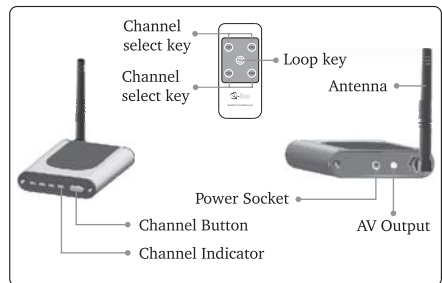

INSTALLATION

1. Locate the camera to a specific position and then adjust it to a suitable angle.

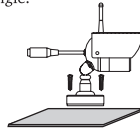

2. Connect the adapter to the camera.

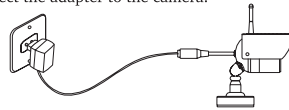

3. Connect the antenna to the receiver (Suitable for QSWLOCR and QSWOC2R).

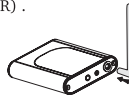

4. Connect the receiver to a monitor/TV with AV cable (yellow for video and red for audio) (Suitable for QSWLOCR and QSWOC2R).



5. Connect the adapter to the receiver(Suitable for QSWLOCR and QSWOC2R).



6. Power on the monitor/TV and select AV mode(Suitable for QSWLOCR and QSWOC2R).

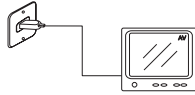

7. Set the channel of receiver same as that of camera by pressing the channel button continuously, and the pictures are displayed on the monitor/TV(Suitable for QSWLOCR and QSWOC2R)..



8. Adjust the brightness, contrast and color of the monitor/TV for the perfect effect.

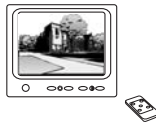

9. Remove the battery installation space from the Remote Controller. You can operate the receiver by the remote Control.



10. If the picture are affected by the interference and couldn't display, just rotate widdershins and screw Off the anti-water shell of camera;and adjust the channel switch besides the lens; select a channel without interference.

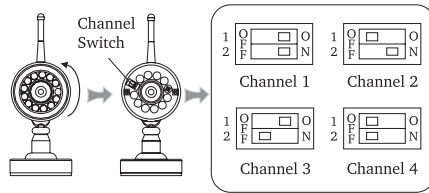

Note: Please push the cover horizontally off the camera before selecting.

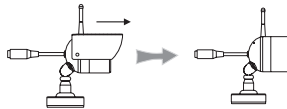

MAINTENANCE

HOW TO CHANGE THE BATTERY

1. Push the clasp as the symbol 1.
2. Pull out the battery tray as the symbol 2.
3. Load one button cell(CR2025) correctly.
4. Close the box.

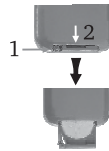

FCC INFORMATION

This device complies with part15 of the FCC Rules. Operation is subject to the following two conditions:

- (1) this device may not cause harmful interference,
- (2) this device must accept any interference received, including interference that may cause undesired operation.

Changes or modifications not expressly approved by the party responsible for compliance could void the user' s authority to operate the equipment.

CAUTIONS

1. The apparatus shall not be exposed to dripping or splashing and that no objects filled with liquides, such as vases,shall be placed on the apparatus.
2. Turn off the Camera/Receiver if the system is not in use.
3. The adapter is used to disconnect device from the power source.
4. Do not cut the DC power cable of the apparatus to fit with another power source.

SPECIFICATIONS

Items	Specifications
Imaging Sensor	CMOS
Total Pixels	510×492(NTSC)
Minimum Illumination	0Lux (IR ON)
Transmission Frequency	ISM 2,400MHz~2,483MHz
Transmission Power	10mW/CE; 2mW/FCC
Modulation Type	FM
Bandwidth	18MHz
Power Supply	+8V _{cc}
Consumption Current(Max.)	85mA(IR OFF)& 160mA(IR ON)
Unobstructed Effective Range(Min.)	100m
Night Vision Range	7m
Dimensions(W×D×H)	45×78×83(mm) (Including Bracket)
Weight(about)	217g
Receiving Frequency	ISM 2,400MHz~2,483MHz
Demodulation Type	FM
Antenna	50 ohm SMA
Receiving Sensitivity	≤ -85dBm
Video Output Signal Level	0.9V _{p-p} ~1.35V _{p-p} @75 ohm
Audio Output Signal Level	2V _{p-p} ~4V _{p-p} @600 ohm
Unobstructed Effective Range(Min.)	100m
Power Supply Voltage	+8V _{cc}
Consumption Current(Max.)	200mA
IR remote Range(Min.)	6m
Dimensions(W×D×H)	89×67×17(mm) (Excluding antenna)
Weight(about)	115g
Operating Temperature	-10°C~+50°C/+14°F~+122°F
Operating Humidity (Max.)	85%RH

* Channel Frequency: CH1=2,414MHz; CH2=2,432MHz;
CH3=2,450MHz; CH4=2,468MHz.

* Actual transmission range may vary according to the weather;
location, interference and building construction.

* All the specifications are subject to minor change without
prior notice.

EU Environmental Protection

Waste electrical products should not
be disposed of with household waste.
please recycle where facilities exist.
Check with your Local Authority or
retailer for recycling advice.



TRADEMARKS

All brand names and products are Registered Trademarks of their respective Companies.

LEGAL DISCLAIMER

See warning on rear cover.

DISCLAIMER

The information in the document is subject to change without notice. The manufacturer makes no representations or warranties with respect to the contents hereof and specifically disclaims any implied warranties of selling or functionality for any particular purpose.

Warning: Your security camera is quality digital product. You have to take utmost care while handling this product, In order to ensure its reliability & durability.

Digital Peripheral Solutions Inc.
S015 E Crystal drive,
Anaheim, CA 92807,
1-877-998-3440.

Q-See tech support in U.S.A.

Mon-Fri: 9 am 6 pm PST.
TEL: 1-877-998-3440
E-mail: ts@dpsi-usa.com
Website: www.q-see.com

Free Manuals Download Website

<http://myh66.com>

<http://usermanuals.us>

<http://www.somanuals.com>

<http://www.4manuals.cc>

<http://www.manual-lib.com>

<http://www.404manual.com>

<http://www.luxmanual.com>

<http://aubethermostatmanual.com>

Golf course search by state

<http://golfingnear.com>

Email search by domain

<http://emailbydomain.com>

Auto manuals search

<http://auto.somanuals.com>

TV manuals search

<http://tv.somanuals.com>