

# OPTIMUS®

*Professional Series*

# 101-Disc Compact Disc Changer

## CD-8400

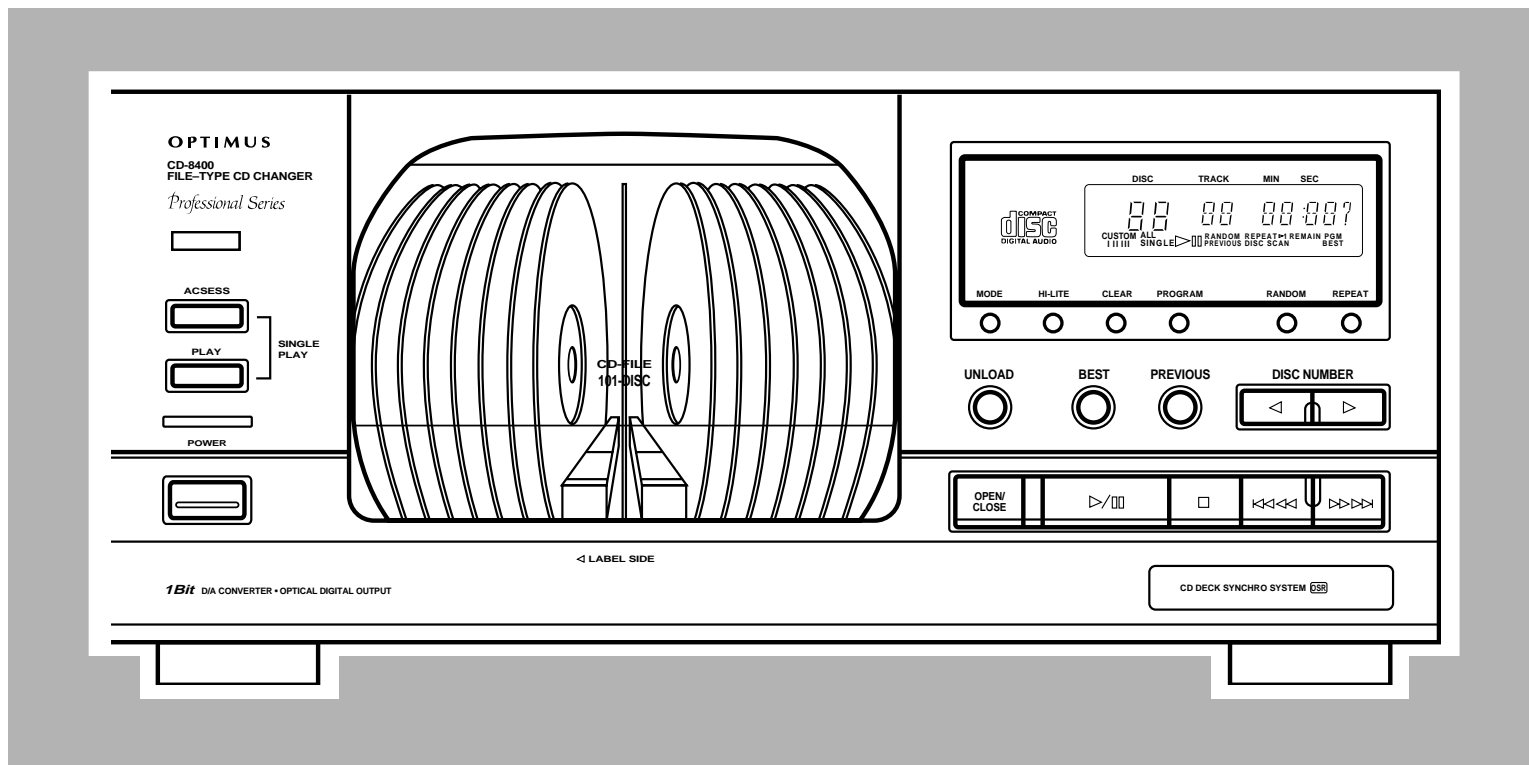

**Owner's Manual**

**Please read before using this equipment.**

# Features

Your Optimus CD-8400 101-Disc Compact Disc Automatic Changer is the next step in CD changer technology. It lets you load up to 101 CDs. This lets you select up to 100 CDs for continuous play and gives you more musical variety without your having to continually remove and load CDs. You can also load a single CD for easy, one-time play.

The CD-8400's advanced design makes the CD changer simple to operate. Be sure to pay attention to the "Special Features" section of this manual so you can understand and take advantage of everything the CD-8400 can do.

Your CD-8400's features include:

- Multiple Compact Disc Racks Plus Single Play** Let you load up to 100 CDs for continuous or programmed play, plus a single CD for easy, one-time play.
- Sequence Programming** Lets you program up to 36 selections (a single track or an entire CD) to play in any order you choose.
- Remote Control** Lets you control the CD changer from a distance.
- Custom Playback** Lets you assign loaded CDs into any of three custom CD groups, and play only the CDs assigned to the group.
- Random Play** Randomly selects and plays all tracks on a single CD, on CDs in a custom CD group, or on all CDs.
- Repeat Play** Automatically repeats a single track, all tracks on a single CD, all tracks in a custom CD group, all tracks on all loaded CDs, or a programmed sequence.
- Digital Output** Lets you connect your CD changer to another digital device.
- Best Selection Memory** Lets you save up to 20 of your favorite tracks for one-touch playback.
- Previous Playback** Plays 10 seconds from each of the 20 most recently played CDs to help you locate a CD you want to listen to again.
- Hi-Lite Scan** Helps you locate a CD or track by playing 10 seconds from the first track of each CD, or 10 seconds from each track on all CDs.
- Audible Search** Helps you locate a particular section of the music by playing the CD rapidly in either direction.
- Automatic Search Music System** Lets you easily locate and play any track on a CD.
- Memory-Hold Function** Remembers which CD is playing when you turn off the CD-8400 and begins playing from the first track of that CD when you turn it back on.
- Synchro Record** Lets you synchronize recording when you connect the CD changer to a compatible cassette deck.
- 1-Bit DAC** Uses the latest in digital-to-analog conversion circuitry to accurately reproduce all sound levels with virtually no distortion.

We recommend you record the CD-8400's serial number here. The serial number is on the CD-8400's back panel.

Serial Number: \_\_\_\_\_

© 1998 Tandy Corporation.  
All Rights Reserved.

Optimus and RadioShack are registered trademarks used by Tandy Corporation.

# IMPORTANT SAFETY INSTRUCTIONS



**Caution:** Do not load anything other than 3- or 5-inch CDs into the CD changer.

The CD-8400 is made and tested to meet exacting safety standards. It meets UL and FCC requirements and complies with the safety performance standards of the U.S. Department of Health and Human Services.

## Warnings:

- This system employs a laser light beam. Only a qualified service person should remove the cover or attempt to service this device, due to possible eye injury.
- The use of controls, adjustments, or procedures other than those specified herein might result in hazardous radiation exposure.
- Most material on compact discs and prerecorded tape is copyrighted. The unauthorized duplication of copyrighted material is a violation of the copyright laws of most countries and such duplication may result in fines and/or imprisonment. Note, however, in the United States, it is not a violation of U.S. copyright laws for a consumer to use an audio recording device to duplicate musical recordings for noncommercial (personal) use.

**WARNING:** To reduce the risk of fire or shock hazard, do not expose this product to rain or moisture.

	<b>CAUTION</b> RISK OF ELECTRIC SHOCK. DO NOT OPEN.	
<b>CAUTION:</b> TO REDUCE THE RISK OF ELECTRIC SHOCK, DO NOT REMOVE COVER OR BACK. NO USER-SERVICEABLE PARTS INSIDE. REFER SERVICING TO QUALIFIED PERSONNEL.		



This symbol is intended to alert you to the presence of uninsulated dangerous voltage within the product's enclosure that might be of sufficient magnitude to constitute a risk of electric shock. Do not open the product's case.



This symbol is intended to inform you that important operating and maintenance instructions are included in the literature accompanying this product.

This equipment complies with the limits for a Class B digital device as specified in Part 15 of *FCC Rules*. These limits provide reasonable protection against radio and TV interference in a residential area. However, your equipment might cause TV or radio interference even when it is operating properly. To eliminate interference, you can try one or more of the following corrective measures:

- Reorient or relocate the receiving antenna.
- Increase the distance between the equipment and the radio or TV.
- Use outlets on different electrical circuits for the equipment and the radio or TV.

Consult your local RadioShack store or an experienced radio/TV technician if the problem still exists.

You must use shielded interface cables with this equipment.

Careful attention is devoted to quality standards in the manufacture of your CD changer, and safety is a major factor in its design. However, safety is also your responsibility.

This section lists important information that will help you properly use and enjoy your CD changer and accessories. Read all the included safety and operating instructions before using your CD changer. Follow them closely, and retain them for future reference.

**Heed Warnings** — Follow all warnings on the product and in the operating instructions.

**Cleaning** — Unplug this product from the wall outlet before cleaning. Use only a damp cloth for cleaning. Do not use liquid or aerosol cleaners.

**Attachments** — Do not use attachments/accessories not recommended by the product manufacturer, as they might create a hazard.

**Water and Moisture** — Do not use this product near water (for example, near a bathtub, wash-bowl, kitchen sink, or laundry tub; in a wet basement; or near a swimming pool).

**Accessories** — Do not place this product on an unstable cart, stand, tripod, bracket, or table. The product may fall, causing serious injury to a child or adult, and serious damage to the product. Use only with a cart, stand, tripod, bracket, or table recommended by the manufacturer or sold with the product. Follow the manufacturer's instructions for mounting, and use a recommended mounting accessory.



**Carts** — Move the product on a cart carefully. Quick stops, excessive force, and uneven surfaces may cause the product/cart to overturn.

**Ventilation** — Slots and openings in the cabinet provide ventilation, ensure reliable operation, and protect from overheating. Do not block or cover these openings, and do not place the product on a bed, sofa, rug, or other similar surface. Do not place the product in a built-in bookcase or rack unless it provides proper ventilation as specified by the manufacturer.

**Power Sources** — Operate this product using only the power source indicated on its marking label. If you are not sure of your home's power type, consult your product dealer or local power company.

**Polarization** — This product is equipped with a polarized AC line plug (a plug having one blade wider than the other). This plug will fit in the power outlet only one way. This is a safety feature. If you cannot insert the plug fully into the outlet, try reversing the plug. If the plug still doesn't fit, contact your electrician to replace your obsolete outlet. Do not defeat the safety purpose of the polarized plug. If you need an extension, use a polarized cord.

**Power-Cord Protection** — Route power-supply cords so they are not likely to be walked on or pinched by items placed on or against them, paying particular attention to cords at plugs, convenience receptacles, and the point where they exit from the product.

**Nonuse Periods** — Unplug the CD changer's power cord when you will not use it for extended periods.

**Lightning** — For added protection for this product during a lightning storm, or when it is left unattended and unused for long periods of time, unplug it from the wall outlet and disconnect the antenna or cable system. This will prevent damage to the product due to lightning and power-line surges.

**Overloading** — Do not overload wall outlets, extension cords, or integral convenience receptacles, as this can result in a risk of fire or electric shock.

**Objects and Liquids** — Never push objects of any kind into this product through openings, as they may touch dangerous voltage points or short out parts that could result in a fire or electric shock. Never spill liquid of any kind on the product.

**Servicing** — Do not attempt to service this product yourself, as opening or removing covers may expose you to dangerous voltage or other hazards. Refer all servicing to qualified service personnel.

**Damage Requiring Service** — Unplug this product from the wall outlet and refer servicing to qualified service personnel under the following conditions:

- When the power-supply cord or plug is damaged.
- If liquid has been spilled or objects have fallen into the product.
- If the product has been exposed to rain or water.
- If the product does not operate normally by following the operating instructions. Adjust only those controls that are covered by the operating instructions, as an improper adjustment of other controls may result in damage and will often require extensive work by a qualified technician to restore the product to normal operation.
- If the product has been dropped or damaged in any way.
- When the product exhibits a distinct change in performance.

**Replacement Parts** — When replacement parts are required, be sure the service technician uses replacement parts specified by the manufacturer or having the same characteristics as the original part. Unauthorized substitutions may result in fire, electric shock, or other hazards.

**Safety Check** — Upon completion of service or repairs to this product, ask the service technician to perform safety checks to determine that the product is in proper operating condition.

**Wall or Ceiling Mount** — The product should be mounted to a wall or ceiling only as recommended by the manufacturer.

**Heat** — The product should be situated away from heat sources such as radiators, heat registers, stoves, or other products (including amplifiers) that produce heat.

# Contents

<b>Preparation</b> .....	<b>5</b>
Connecting the CD Changer to Your Receiver or Amplifier .....	5
Connecting to Another Digital Audio Product .....	5
Connecting Power .....	5
Connecting to a Cassette Deck's Synchro Jack .....	5
Installing the Remote Control's Batteries .....	6
Using a Receiver's Remote Control with the CD Changer .....	6
<b>Basic Operation</b> .....	<b>7</b>
Using the Remote Control .....	7
Loading CDs in the Rack .....	7
Loading a CD in the Single Play Slot .....	8
Using the Demo .....	8
Playing CDs .....	9
Checking the Time Remaining and Elapsed on a CD .....	10
<b>Special Features</b> .....	<b>11</b>
Quickly Selecting Tracks .....	11
Searching for a Section of a Track .....	11
Assigning CDs to a Custom CD Group .....	11
Storing Your Best Tracks .....	12
Scanning Previous CDs .....	12
Using Hi-Lite Scan .....	12
Repeating Tracks, CDs, and Sequences .....	13
Playing Tracks in Random Order .....	13
Programming a Sequence .....	14
<b>Troubleshooting</b> .....	<b>16</b>
Self-Diagnostics .....	17
<b>Care and Maintenance</b> .....	<b>18</b>
CD Care Tips .....	18
<b>Specifications</b> .....	<b>19</b>

# Preparation

## Connecting the CD Changer to Your Receiver or Amplifier

**Note:** If you place the CD changer too near other audio components or their wires, you might hear a hum when you play a CD. Move the components or their wires to eliminate the hum.

**Caution:** Do not connect the CD changer to AC power until you complete all other connections.

1. Select a location for your CD changer that is near your receiver or amplifier and a standard AC outlet.

**Caution:** Do not place the CD changer on top of the receiver or amplifier or on any other component that gets hot.

2. Plug one end of the supplied audio cable into the CD changer's **L** (left) and **R** (right) **LINE OUT** jacks, matching the red plug to the red **R LINE OUT** jack and the white plug to the white **L LINE OUT** jack.

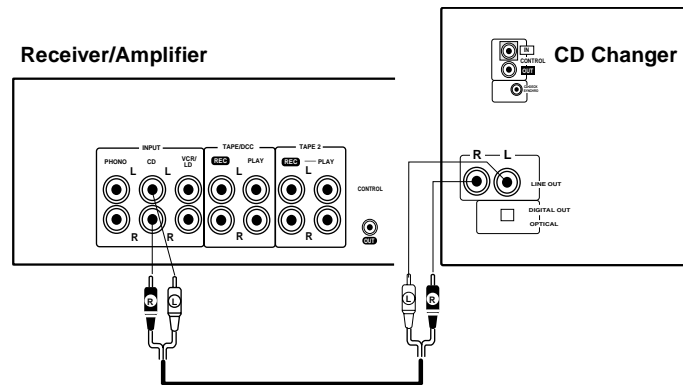

3. Plug the other end of the audio cable into the receiver's or amplifier's left and right CD, AUX, or TAPE input jacks.

**Caution:** Do not connect the CD changer to the receiver's or amplifier's PHONO inputs.

## Connecting to Another Digital Audio Product

**Note:** Be sure to leave the dust cap in place when you are not using the jack.

You can connect the CD changer to another digital audio product such as a digital recorder. You need an optical cable (Cat. No. 42-2466, available by special order through your local RadioShack store) for this connection. To make the connection, remove the protective dust cap from the digital jacks, and connect the optical cable to the jacks.

## Connecting Power

**Note:** Do not connect the CD changer's power cord to an amplifier or other switched outlet. The CD changer loses memorized settings when power is removed.

After you have connected the CD changer to your receiver or amplifier, plug the CD changer's power cord into a standard AC outlet.

**Caution:** To prevent electric shock, the plug's blades are polarized and fit only one way. If the plug does not fit easily, turn it over and try again. Do not force the plug into any AC outlet.

## Connecting to a Cassette Deck's Synchro Jack

The Synchro-Record feature lets you easily copy CDs to cassette tapes. If you have a cassette deck that has a CD-DECK SYNCHRO jack (such as many Optimus Professional Series cassette decks), the CD changer can automatically start and stop with the cassette deck. Connect the CD-deck synchro-cord, supplied with the cassette deck, to the CD changer's and cassette deck's **CD-DECK SYNCHRO** jacks.

For details on connection and operation, refer to the cassette deck's owner's manual.

### Installing the Remote Control's Batteries

Your CD changer's remote control requires two AA batteries (not supplied) for power. We recommend alkaline batteries (RadioShack Cat. No. 23-552).

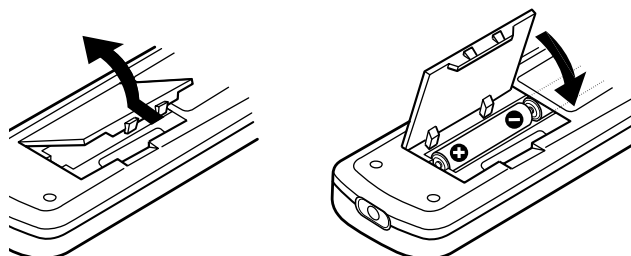

1. Press in the battery compartment cover's latch and lift off the cover.
2. Put two fresh AA batteries into the compartment as indicated by the polarity symbols (+ and -) marked inside.
3. Replace the cover.

#### Cautions:

- Use only fresh batteries of the required size and recommended type.
- Do not mix old and new batteries, different types of batteries (standard, alkaline, or rechargeable), or rechargeable batteries of different capacities.
- Always remove old or weak batteries. Batteries can leak chemicals that can damage electronic circuits.
- If you do not plan to use the remote control for a month or more, remove and store the batteries.

**Note:** If the remote's range is reduced, replace the batteries immediately.

---

### Using a Receiver's Remote Control with the CD Changer

If your receiver/amplifier (such as most Optimus Professional Series receiver/amplifiers) has an OSR mark, the receiver/amplifier's remote can control some of the CD changer's functions.

Plug one end of the supplied control cable into the CD changer's **CONTROL IN** jack. Plug the other end of the cable into the receiver/amplifier's **CONTROL OUT** jack.

#### Notes:

- This connection disables the CD changer's infrared sensor. Aim the remote control at the receiver/amplifier's infrared sensor.
- You must also connect audio cables to your receiver for the receiver's remote control to operate your CD changer.

For details on connection and operation, refer to the receiver/amplifier's owner's manual.

# Basic Operation

**Warning:** To protect your hearing, set the volume on your receiver or amplifier to its lowest level before you load and play a CD.

**Caution:** Do not set the volume on your receiver or amplifier too high while playing soft or quiet portions of a music program. Due to the CD changer's wide dynamic range, the speakers might be damaged if the music program includes a sudden loud passage.

## Using the Remote Control

**Note:** The remote operates the CD changer from up to 23 feet away and within 30° of the front of the CD changer.

Many of the CD changer's buttons also have a corresponding button on the remote control, and you can use either the CD changer or the remote control to control the function.

To use the remote control, point it at the infrared sensor on the left side of the front panel and press the control button.

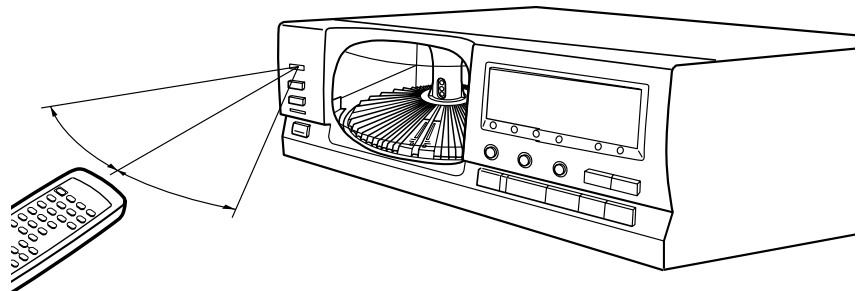

When the remote control's operating distance reduces or if the remote control stops working, replace the batteries.

## Loading CDs in the Rack

**Note:** Always handle CDs by their edges. Fingerprints and scratches on a CD's surface can prevent the laser beam from correctly reading the digital information. For more information, see "CD Care Tips" on Page 18.

The multi-disc rack holds 100 CDs. The disc slots are numbered in clockwise order, from 1 to 100, and can hold either 3-inch or 5-inch CDs.

Follow these steps to load up to 100 CDs in the slots.

1. Press **POWER** to turn on the CD changer. If necessary, repeatedly press **◀ DISC NUMBER ▶** (or **◀ DISC ▶** on the remote) so the slot number you want appears on the display.

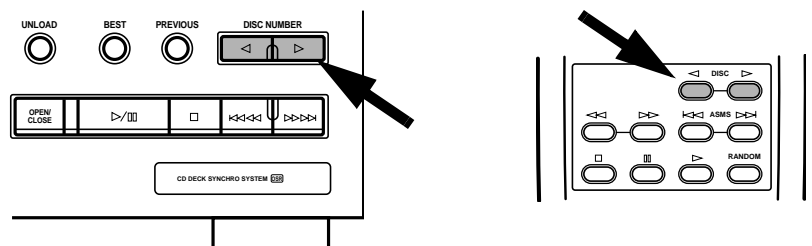

2. Press **UNLOAD** to open the rack cover.

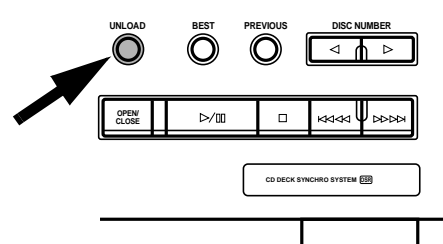

3. Hold the CD vertically and insert it into the CD slot, label side to the left.

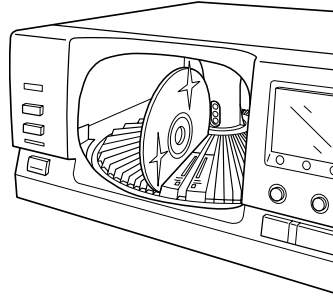

4. To load more CDs, repeatedly press ◀ **DISC NUMBER** ▶ (or ◀ **DISC** ▶ on the remote) so the desired rack number appears on the display. Then repeat Step 3.
5. When you finish loading the desired CDs, press **OPEN/CLOSE** to close the rack cover.

To remove a CD, select the slot number of the disc you want to remove, then press **UNLOAD**. The rack rotates the selected disc slot to the front. When the rack cover opens, remove the selected CD. Press **OPEN/CLOSE** to close the rack cover.

### Cautions:

- Do not try to manually open the rack cover; only use **OPEN/CLOSE**.
- Do not load anything other than 5-inch or 3-inch CDs into the slots. This could damage the CD changer.
- Do not use an adapter for 3-inch CDs. Also, avoid placing 3-inch CDs between 5-inch CDs as this makes it hard to remove the 3-inch CDs.
- The CD changer does not play with the rack cover open.

### Notes:

- You can use **OPEN/CLOSE** to open the rack cover and remove the disc if the disc to remove is already at the front of the rack. The display shows **HOLD** while the rack cover is open.
- You can open the rack cover even while a disc is playing. Hold down **OPEN/CLOSE** until the display shows **OPEN**. The rack cover opens and the display shows **HOLD**. In this case, the rack does not rotate and you cannot use **UNLOAD**, **SINGLE PLAY/ACCESS**, or ◀ **DISC NUMBER** ▶.

## Loading a CD in the Single Play Slot

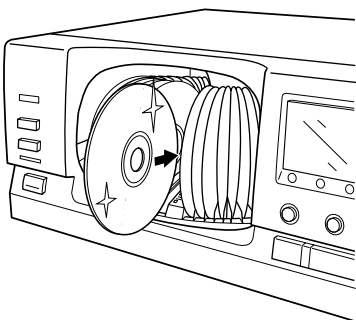

The single play slot lets you easily load a single CD. To load a CD in the single play slot, press **SINGLE PLAY/ACCESS**. The CD changer turns on if it was turned off, and rotates the rack so the single play slot comes to the loading position. Insert the CD with its label to the left. Then press **SINGLE PLAY/PLAY** to start playing.

To remove a CD from the single play slot, press **SINGLE PLAY/ACCESS**. The rack rotates the single play slot to the front. When the rack cover opens, remove the CD.

The single play slot is numbered as "0" and is located between discs 100 and 1. You can access this slot by pressing **DISC NUMBER** ▶ when the display shows **100**, or **DISC NUMBER** ◀ when the display shows **1**. You can also reach to the single play slot by pressing **0** on the remote control. The display shows the disc number as **P0**.

## Using the Demo

The demo showcases the features of your CD-8400 and its display. To turn on the demo, press ◀◀◀◀ within 1 second of turning on the CD changer. To turn off the demo, press any button.



## Playing CDs

To select a CD, enter its number on the remote control, then press **DISC SET** within 5 seconds. You can also use **◀ DISC NUMBER ▶** (or **◀ DISC ▶** on the remote) to step through the disc numbers until you reach the desired CD. (Hold down either button for a rapid search.)

If the position you select does not have a CD, the CD changer displays **no dISC** and plays the next CD.

To select a disc in the single play slot, repeatedly press **◀ DISC NUMBER ▶** until the changer displays **P0**.

Follow these steps to play CDs.

**Note:** Be sure the CD changer's rack cover is closed — playback does not begin if the rack cover is open.

1. Turn on your receiver/amplifier and select the audio input (CD, AUX, or TAPE) to which you connected your CD changer.
2. Press **POWER** to turn on the CD changer. The CD changer returns to the first track of the last CD you played.
3. While the CD changer is stopped, repeatedly press **MODE** until the play mode you want appears on the display.

**ALL** — Plays all the loaded CDs.

**SINGLE** — Plays only the selected CD.

**CUSTOM I, II, or III** — Plays only the CDs that belong to the custom CD group (see "Assigning CDs to a Custom CD Group" on Page 11).

You can switch between **ALL** and **SINGLE** during play, but you can select custom play only when the CD changer is stopped.

**Note:** You can also select and play a CD in the single play slot by pressing **0** then **DISC SET** on the remote control.

4. Press **▶▶** (▶ on the remote control) to begin play from Track 1 on Disc 1 (or the last CD you played) and have all tracks and CDs play in order. The CD changer stops after it plays the highest-numbered CD you loaded.

The changer displays the disc, track number, and the currently playing track's elapsed play time.

If a slot does not contain a CD, the CD changer displays **no dISC** next to the disc number as it skips to the next slot.

The CD changer memorizes which slots contain CDs, then it skips empty slots on subsequent play passes. Opening the rack cover (to load/unload CDs, for example) resets this memory.

5. To temporarily stop play, press **▶▶▶** (▶▶ on the remote control). The display shows **▶▶▶**. Press **▶▶▶** again (or press **▶** or **▶▶** on the remote control) to resume play.
6. The CD changer automatically stops play at the end of the last track on the highest numbered CD. To stop play sooner, press **■**. The CD changer returns to the first track on the last-played CD.

**Note:** A sudden shock or jolt while a CD is playing might suddenly change the CD's rotation speed or make the CD changer skip the current track. This might momentarily mute or distort the sound. This is not a malfunction.

**Notes:** With a custom CD group selected:

- When you press **◀ DISC NUMBER ▶** during play, the changer scans only through the CD slots within the custom CD group.
- If you select a slot that is not in the custom CD group using the remote control's number buttons, **no dISC** appears for about 3 seconds. (See "Assigning CDs to a Custom CD Group" on Page 11.)
- If a CD in the custom CD group is not loaded, **no dISC** appears on the display for about 3 seconds, the disc number is erased from memory, and play continues from the next CD.

### Checking the Time Remaining and Elapsed on a CD

The display normally shows the current CD and track numbers, and the current track's elapsed play time.

Press **TIME** on the remote control once during play to display the current track's remaining time. Press **TIME** again to display the current CD's remaining time. Press **TIME** again to display the current CD's total elapsed time.

During programmed play, pressing **TIME** twice displays the total programmed time and the number of the programmed track playing (see "Programming a Sequence" on Page 14). During best selection play, pressing **TIME** twice displays the number of tracks stored in the best selection memory (see "Storing Your Best Tracks" on Page 12).

#### Notes:

- The CD changer does not display the current CD's total remaining time during programmed, random, or best selection play.
- The CD changer might not display the remaining time for tracks numbered greater than 24 on a CD.

# Special Features

## Quickly Selecting Tracks

When the CD changer is stopped or paused, press **⏮⏮⏮** or **⏭⏭⏭** (or **⏮** or **⏭** on the remote control) until the CD changer displays the desired track's number. Or, enter the track number using the remote control's number buttons, then press **TRACK SET** within 5 seconds.

If you use this feature while a CD plays, the CD changer stops playing the current track and skips to the next or previous track.

## Searching for a Section of a Track

To rapidly search forward or backward for a track section while a CD plays, hold down **⏭⏭⏭** or **⏮⏮⏮** on the front panel (**⏭** or **⏮** on the remote control). The display shows the elapsed time to help you locate the desired section, and the CD plays at a lower volume and higher speed than normal. Release the button to resume normal play.

You can also search a track when a CD is paused. The searching speed is faster, the display shows only the minutes, and you do not hear the CD play.

**Note:** You cannot search past the end (**End** appears on the display) or the beginning of a CD.

## Assigning CDs to a Custom CD Group

**Note:** To change the CDs assigned to a custom CD group, you must clear all the entries and enter the desired CDs again.

You can assign any loaded CD into a custom CD group. This lets you group your favorite CDs together for more convenient playback.

Follow these steps to assign CDs to a group.

1. While the CD changer is stopped, repeatedly press **MODE** until **CUSTOM** and the number of the desired group light. (If any discs have been assigned to the group, the lowest disc number appears on the display. Press **CLEAR** to clear the group.)
2. Select a CD for storing into the group.
  - If you use **◀ DISC NUMBER ▶**, simply wait until the display blinks. The disc number is automatically stored in memory.
  - If you use the remote control's number buttons, press **DISC SET** to store the disc number in memory.
3. Repeat Step 2 to store all the CDs you want.

### Notes:

- The custom group memory is kept even after you turn off the CD changer.
- The changer keeps the CDs stored in custom group memory for up to 2 days in the event of a power loss.

## Checking the Custom Group Contents

With the CD changer stopped, repeatedly press **MODE** so **CUSTOM** and the number of the desired group light. Then repeatedly press **TIME** so **C** and the custom group number appear on the display. Then repeatedly press **DISC NUMBER ▶**. The programmed disc numbers appear in order as you press **DISC NUMBER ▶**.

### Erasing All the CDs from a Custom Group

With the CD changer stopped, repeatedly press **MODE** so **CUSTOM** and the number of the desired group light. Then press **CLEAR**. (You cannot partially erase a custom group memory.)

---

### Storing Your Best Tracks

You can save up to 20 of the tracks you like best in a special *best* memory, and then replay them at any time. To save a track in best memory, just press **BEST** while that track is playing. **BEST** flashes three times. To play the tracks you have saved in best memory, press **BEST** while the changer is stopped. The CD changer plays in the reverse order; the last track you saved plays first.

#### Notes:

- The changer only remembers the last 20 tracks you stored in best memory.
- You cannot store the same track twice in succession.
- You cannot save a track from a CD that is in the single play slot into best memory.
- To clear a track from best memory, press **CLEAR** while that track is playing.
- The best memory is kept even after you turn off the CD changer.
- The changer keeps the tracks in best memory for up to 2 days in the event of a power loss.

---

### Scanning Previous CDs

The CD changer remembers the 20 most recently played CDs and lets you review and replay them in reverse order.

To review the CDs, press **PREVIOUS**. **PREVIOUS SCAN** flashes and the changer plays 10 seconds of the first track of each of the last 20 CDs you played, starting at 1 minute into the first track on each CD. To listen to an entire CD and cancel the previous scan function, press **▶||**.

To stop the previous scan function, press **■**.

#### Notes:

- If a track is less than 1 minute long, previous scan starts at the beginning of the track.
- A CD in the single play slot is not included in the previous scan memory. Neither are any CDs played using random play, hi-lite scan, programmed play, and best selection.
- The previous scan memory remains stored even after you turn off the CD changer.
- The changer keeps the CDs stored in previous scan memory for up to 2 days in the event of a power loss.

---

### Using Hi-Lite Scan

**To listen to 10 seconds from each CD**, press **HI-LITE** while the changer is stopped or during normal play. **DISC SCAN** flashes and the changer plays 10 seconds from each CD, starting at 1 minute into the first track.

**To listen to 10 seconds from every track on all CDs**, press **HI-LITE** twice while the changer is stopped or during normal, programmed, or favorite track play. **SCAN** flashes and the changer plays 10 seconds from each track, starting at 1 minute into each track.

To stop scanning, either press ►■ to start play at the current track or press ■ to stop play.

**Notes:**

- If the track is less than 1 minute long, hi-lite scan starts at the beginning of the track.
- You can use ►►► and ◀◀◀ to skip forward and backward.
- You can use repeat during hi-lite scan (see “Repeating Tracks, CDs, and Sequences”).

---

## Repeating Tracks, CDs, and Sequences

Your CD changer can repeat a single track, a single CD, all loaded CDs, a custom CD group, or a programmed sequence.

**To repeat a single track**, before or during play of a track you want to repeat, press **REPEAT** on the remote control. **REPEAT ► 1** appears on the display. If the CD changer is stopped, press ►■. At the end of the track, the CD changer replays the track.

**To repeat a single CD**, before or during play, repeatedly press **MODE** until **SINGLE** appears on the display, then press **REPEAT** twice. **REPEAT** appears on the display. If the CD changer is stopped, press ►■. When the CD changer reaches the end of the CD, it replays the CD.

**To repeat all CDs**, before or during play, repeatedly press **MODE** until **ALL** appears on the display, then press **REPEAT** twice. **REPEAT** appears on the display. If the CD changer is stopped, press ►■. When the CD changer reaches the end of the last CD, it replays all loaded CDs in order.

**To repeat CDs in a custom group**, before play, repeatedly press **MODE** until **CUSTOM** and the number of the desired group appear on the display, then press **REPEAT** twice. **REPEAT** appears on the display. If the CD changer is stopped, press ►■. When the CD changer reaches the end of the last CD, it replays all CDs in the group in order.

**To cancel repeat play**, press **REPEAT** until neither **REPEAT 1** nor **REPEAT** appears on the display, or press ■.

---

## Playing Tracks in Random Order

With play stopped, press **RANDOM**. **RANDOM** appears on the display, and random play starts in the selected play mode.

**SINGLE** — randomly plays all of the current CD's tracks. Once all the CD's tracks have played, the CD changer stops.

**ALL** — selects a track from a CD and plays the track, then repeatedly selects another CD and plays another track. When the CD changer finishes playing 100 selections (or as many as possible from the CDs that are loaded), it stops.

**CUSTOM** — selects a track from a CD in a custom CD group and plays the track, then repeatedly selects another CD in the same group and plays another track. When the CD changer finishes playing 100 selections (or as many as possible from the CDs that are loaded), it stops.

To cancel random play and continue normal play, select a disc other than the one currently playing, either by pressing ◀ **DISC NUMBER** ▶ or by using the remote control's number buttons, then pressing **DISC SET**. To stop random play, press ■.

### Notes:

- During play, press **RANDOM** to skip the track currently playing and advance to the next random selection.
- You can switch between the **ALL** or **SINGLE** modes during random play.
- If the CD changer does not have 100 CDs loaded, the CD changer might select the same track or CD more than once.
- You can use repeat during random play.
- If you start random play during programmed play, the program's contents are erased and the CD changer starts ALL random play.

---

## Programming a Sequence

You can program up to 36 selections from all loaded CDs to play in any order you choose. A selection can be a single track or an entire CD.

Follow these steps to program a sequence.

1. Press ■ to cancel the current function.
2. Press **PGM** on the remote control (or **PROGRAM** on the front panel). **PGM** appears on the display.
3. Select the CD that contains the first track you want to program using the remote control's number buttons and **DISC SET**. The selected CD's number and **AL** appear.

You can also use ◀ **DISC NUMBER** ▶ (or ◀ **DISC** ▶ on the remote) and press **PGM** to select a CD. The disc number and **AL** appear. If you do not select a track within about 2 seconds, the entire CD is automatically stored.

If you program an entire CD, skip to Step 5.

4. Select the track you want to program using the remote control's number buttons and **TRACK SET**. The displayed track and disc numbers are stored in the first memory position.

You can also use ▶▶| or |◀◀ to move forward or backward through the programmed sequence while the sequence plays.

5. Repeat Steps 3 and 4 for each track or CD you want to program, up to 36 selections.
6. Press ▶|||. The CD changer plays the sequence.

### Notes:

- If you try to program a non-existent CD or track (for example track 10 when that CD has only nine tracks), the CD changer ignores the entry.
- Press ▶▶▶| or |◀◀◀ to move forward or backward through the programmed sequence while the sequence plays.

After the CD changer plays the last track in the programmed sequence, it stops, but the programmed sequence is still in memory. Press **PGM** then ▶ to restart programmed play.

To clear the sequence, see "Clearing a Programmed Sequence" on Page 15.

## Programming a Sequence While a CD is Playing

While the CD changer is playing, you can program a sequence of tracks, but not an entire CD. Press **PGM** during play, then select the CD and track using the remote control's number buttons and **DISC SET/TRACK SET**, and press **PGM**. When the current track finishes playing or you press **▶**, programmed play starts.

Or, you can store the track currently being played directly into memory. While the track is playing, press **PGM** once to enter the program mode, then press **PGM** again to store the current track. You might find this feature convenient to use along with hi-lite scan.

## Erasing a Programmed Selection

In the program mode (when **PGM** appears on the display), press **CLEAR** to erase the last-stored selection (track or CD). The new last-stored selection appears on the display until you press **▶/■** (or **▶** on the remote control).

**Note:** You cannot erase a selection that is currently playing or that has already played.

## Clearing a Programmed Sequence

Turning off the CD changer does not clear the programmed sequence. To clear the sequence, do any of the following:

- Press **■** when the CD is stopped.
- Start best selection play.
- Select **ALL**, **SINGLE**, **CUSTOM**, previous scan, or play the CD in the single play slot while programming a sequence.
- Press **RANDOM** while programming a sequence.

## Storing a Pause within a Programmed Sequence for Recording to Cassette

When you record a programmed sequence onto a cassette tape, you can program a pause to occur after the last selection you plan to record on the first side of the tape (so you can turn the tape over).

To store a pause, press **■** on the remote in Step 3 of "Programming a Sequence" on Page 14. **PA** appears on the display.

During play, when the CD changer pauses and displays **▶/■**, turn over the tape and press **■** to resume recording.

### Notes:

- You cannot program a pause as the first or last selection.
- You cannot program two pauses in a row.

# Troubleshooting

If your CD changer is not working as it should, these suggestions might help you solve the problem. If the CD changer still does not operate properly, take it to your local RadioShack store for assistance.

Symptom	Possible Cause	Suggestion
Playback stops abruptly, or the CD changer pauses or stops during playback.	A CD is loaded backwards.	Load the CD with the label side to the left.
	CD is dirty or scratched.	Clean the CD (see "CD Care Tips" on Page 18).
No sound.	The CD changer is not correctly connected.	Recheck all connections.
	The receiver/amplifier is not set to the correct input.	Check the receiver/amplifier's input setting.
	The receiver/amplifier's volume is set too low.	Turn up the receiver/amplifier's volume.
	A CD is loaded backwards.	Load the CD with the label side to the left.
Sound is noisy or distorted.	The CD changer is not correctly connected.	Recheck all connections.
	Interference from another electronic device.	Turn off nearby appliances, or use a different AC outlet for the appliance.
CD skips.	CD is dirty or damaged.	Clean or repair the CD (see "CD Care Tips" on Page 18) or try a different CD.
Remote control does not work.	Too far from the CD changer.	Move closer to the CD changer.
	Another device's cable is plugged into the <b>CONTROL IN</b> jack.	Use the other device's remote control.
	Weak batteries.	Replace the batteries.
Receiver remote control does not work.	The control cable is not plugged in.	Properly plug in the control cable.
	Audio cables are not plugged in.	Properly plug in audio cables.



**Self-Diagnostics**

The CD-8400 has a self-diagnostic function. When the CD changer detects an abnormal condition, it displays an error number on the display. If this happens, try the suggestion shown. If the error number still appears, take the CD changer to your local RadioShack store for assistance.

<b>Symptom</b>	<b>Possible Cause</b>	<b>Suggestion</b>
<b>U1</b>	The disc is not loaded properly.	Load the CD with the label side to the left.
		The CD might be dirty. Clean the CD.
		Check to see if there is a foreign object in the slot.
<b>U2</b>	Mechanism operation error.	Check to see if there is a foreign object in the slot.
		Unplug the power cord and plug it in again.
<b>U3</b>	Rack cover error.	Check to see if the rack cover is blocked by anything.
		Unplug the power cord and plug it in again.

# Care and Maintenance

Your Optimus CD-8400 101-Disc Compact Disc Changer is an example of superior design and craftsmanship. The following suggestions will help you care for the CD changer so you can enjoy it for years.



Keep the CD changer dry. If it gets wet, wipe it dry immediately. Liquids can contain minerals that can corrode electronic circuits.



Handle the CD changer gently and carefully. Dropping it can damage the circuit boards and case and can cause it to work improperly.



Use and store the CD changer only in normal temperature environments. Temperature extremes can shorten the life of electronic devices, damage batteries in the remote control, and distort or melt plastic parts.



Keep the CD changer away from dust and dirt, which can cause premature wear of parts.



Wipe the CD changer with a damp cloth occasionally to keep it looking new. Do not use harsh chemicals, cleaning solvents, or strong detergents to clean the CD changer.

Modifying or tampering with the CD changer's internal parts can cause a malfunction and might invalidate your CD changer's warranty. If your CD changer is not working as it should, take it to your local RadioShack store for assistance.

---

## CD Care Tips

Even though a CD is very durable, you should handle it with care.

- Keep the CD inside the CD changer or in its protective case or sleeve when you are not playing it.
- Handle a CD by its edges to avoid fingerprints which can prevent the CD changer's laser beam from accurately reading the CD. Your local RadioShack store sells a suitable CD cleaner kit.
- Do not write on either side of the CD, particularly the non-label side. (Signals are read from the non-label side.)
- Keep the CD dry. A water drop can act as a lens and affect the laser beam's focus.

If a CD skips or the CD changer displays **Y1** when you try to play it, it might be scratched. Your local RadioShack store sells a Scratch 'n Fix kit (Cat. No. 42-127) that might help remove the scratch and stop the skip. See also "Troubleshooting" on Page 16.

# Specifications

Audio Frequency Response .....	2–20,000 Hz
Wow and Flutter .....	Limit of Measurement (0.001% or less, EIAJ)
Disc Diameter .....	3- and 5-inch
Power Requirements .....	120 V AC, 60 Hz
Power Consumption .....	12 Watts
Size (HWD) .....	7 1/2 × 16 9/16 × 15 13/16 Inches (190 × 420 × 402 mm)
Weight .....	14 lbs 5oz (6.5 kg)

Specifications are typical; individual units might vary. Specifications are subject to change and improvement without notice.

### Limited One-Year Warranty

This product is warranted by RadioShack against manufacturing defects in material and workmanship under normal use for one (1) year from the date of purchase from RadioShack company-owned stores and authorized RadioShack franchisees and dealers. EXCEPT AS PROVIDED HEREIN, RadioShack MAKES NO EXPRESS WARRANTIES AND ANY IMPLIED WARRANTIES, INCLUDING THOSE OF MERCHANTABILITY AND FITNESS FOR A PARTICULAR PURPOSE, ARE LIMITED IN DURATION TO THE DURATION OF THE WRITTEN LIMITED WARRANTIES CONTAINED HEREIN. EXCEPT AS PROVIDED HEREIN, RadioShack SHALL HAVE NO LIABILITY OR RESPONSIBILITY TO CUSTOMER OR ANY OTHER PERSON OR ENTITY WITH RESPECT TO ANY LIABILITY, LOSS OR DAMAGE CAUSED DIRECTLY OR INDIRECTLY BY USE OR PERFORMANCE OF THE PRODUCT OR ARISING OUT OF ANY BREACH OF THIS WARRANTY, INCLUDING, BUT NOT LIMITED TO, ANY DAMAGES RESULTING FROM INCONVENIENCE, LOSS OF TIME, DATA, PROPERTY, REVENUE, OR PROFIT OR ANY INDIRECT, SPECIAL, INCIDENTAL, OR CONSEQUENTIAL DAMAGES, EVEN IF RadioShack HAS BEEN ADVISED OF THE POSSIBILITY OF SUCH DAMAGES.

Some states do not allow the limitations on how long an implied warranty lasts or the exclusion of incidental or consequential damages, so the above limitations or exclusions may not apply to you.

In the event of a product defect during the warranty period, take the product and the RadioShack sales receipt as proof of purchase date to any RadioShack store. RadioShack will, at its option, unless otherwise provided by law: (a) correct the defect by product repair without charge for parts and labor; (b) replace the product with one of the same or similar design; or (c) refund the purchase price. All replaced parts and products, and products on which a refund is made, become the property of RadioShack. New or reconditioned parts and products may be used in the performance of warranty service. Repaired or replaced parts and products are warranted for the remainder of the original warranty period. You will be charged for repair or replacement of the product made after the expiration of the warranty period.

This warranty does not cover: (a) damage or failure caused by or attributable to acts of God, abuse, accident, misuse, improper or abnormal usage, failure to follow instructions, improper installation or maintenance, alteration, lightning or other incidence of excess voltage or current; (b) any repairs other than those provided by a RadioShack Authorized Service Facility; (c) consumables such as fuses or batteries; (d) cosmetic damage; (e) transportation, shipping or insurance costs; or (f) costs of product removal, installation, set-up service adjustment or reinstallation.

This warranty gives you specific legal rights, and you may also have other rights which vary from state to state.

RadioShack Customer Relations, Dept. W, 100 Throckmorton St., Suite 600, Fort Worth, TX 76102

*We Service What We Sell*

3/97

**RadioShack**  
**A Division of Tandy Corporation**  
**Fort Worth, Texas 76102**

## Free Manuals Download Website

<http://myh66.com>

<http://usermanuals.us>

<http://www.somanuals.com>

<http://www.4manuals.cc>

<http://www.manual-lib.com>

<http://www.404manual.com>

<http://www.luxmanual.com>

<http://aubethermostatmanual.com>

Golf course search by state

<http://golfingnear.com>

Email search by domain

<http://emailbydomain.com>

Auto manuals search

<http://auto.somanuals.com>

TV manuals search

<http://tv.somanuals.com>