

# Talking Cash Register

60-1230

OWNER'S MANUAL — Please read before using this equipment.

## ! IMPORTANT !

If an icon appears at the end of a paragraph, go to the box on that page with the corresponding icon for pertinent information.

! — Important      💡 — Hint  
⚠️ — Caution      📄 — Note

Thank you for purchasing a RadioShack Talking Cash Register. Your cash register lets you be the cashier! With realistic sounds and action, the cash register includes a credit card reader and a cash drawer that holds play money. You can even use the microphone to call for a price check or request product information.

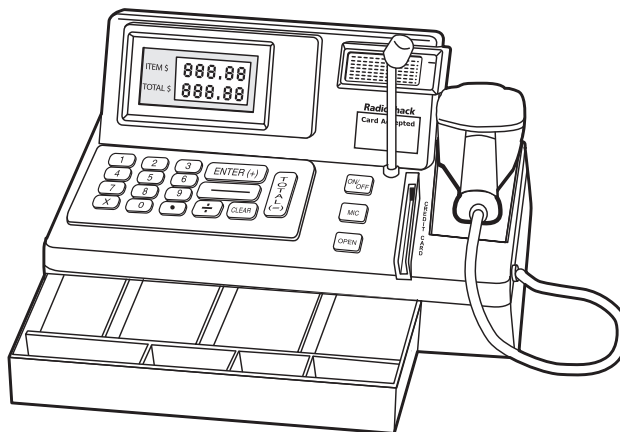

## ⚠️ CAUTION ⚠️

- Do not mix old and new batteries or different types of batteries. Do not mix alkaline, standard (carbon-zinc) or rechargeable (nickel-cadmium) batteries.
- Use only fresh batteries of the required size and recommended type.
- Dispose of old batteries promptly and properly. Do not burn or bury them.
- If you do not plan to use your talking cash register for several weeks, remove the batteries. Batteries can leak chemicals that can harm electronic parts.

## INSTALLING BATTERIES

Your cash register requires four AA batteries (not supplied) for power. For the best performance and longest life, we recommend RadioShack alkaline batteries.

1. Use a Phillips screwdriver to loosen the screw on the battery compartment cover at the back of the register, then lift up the cover.
2. Place the batteries in the compartment as indicated by the polarity (+ and -) marked inside.
3. Replace the cover and tighten the screw. ⚠️



**RadioShack**®

www.radioshack.com<sup>SM</sup>

© 2002 RadioShack Corporation.

All Rights Reserved.

RadioShack and RadioShack.com are trademarks used by RadioShack Corporation.

## USING YOUR CASH REGISTER

You can use your cash register to ring up sales for your customers, or as a calculator.

### TURNING THE CASH REGISTER ON AND OFF

1. Press **ON/OFF** to turn on the cash register. You hear 'Welcome' and the screen turns on.
2. If no button is pressed for 2 minutes, your register automatically turns off. The cash register says, "Thank you. Goodbye", and the screen turns off. To turn the cash register off sooner, press **ON/OFF**.

### SCANNING BAR CODES

1. Select one of the bar codes stickers from the supplied sticker sheet and place it on an item.
2. Point the scanner at the bar code, align the arrows on the scanner with the arrows on the bar code, and press the trigger. The cash register announces the price and it appears on the screen. ✓

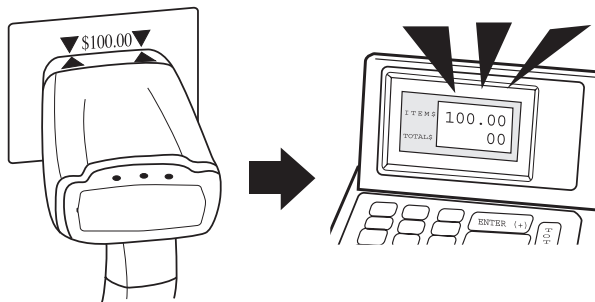

3. Press **TOTAL (=)** to add up all the items scanned. The cash register announces the total and it appears on the screen. ✓
4. Press **CLEAR** to start over.

#### NOTE

- If the total amount exceeds \$999.99 the cash register does not recognize the amount and **E** appears.
- Be sure the scanner is as close to the bar code label as possible and make sure that the arrows on the hand scanner align with those on the bar code label to avoid errors.

## USING YOUR CREDIT CARD

Slide the supplied card in the Credit Card slot. The cash register says "Credit approved" and Cards Accepted lights briefly.

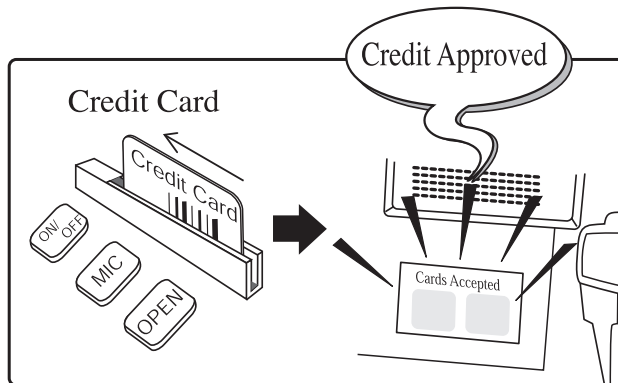

## USING THE MICROPHONE

1. To announce store specials or to page employees, hold down **MIC** and talk into the microphone. You hear your voice over the speaker.
2. Release **MIC** when you finish talking.

## OPENING THE CASH DRAWER

Your cash register comes with Play Bills and plastic coins so you can make change for your customers, just like cashiers at the store.

Bill Value	Number of Bills	Coin Value	Number of Coins
\$1	10	Penny	10
\$5	10	Nickel	10
\$10	10	Dime	10
\$20	10	Quarter	10
\$50	5		
\$100	5		

Press **OPEN**, the cash drawer opens and the cash register makes a "Cha-Ching" sound.

Push the drawer back in to close it.



### HINT

#### Equation Example

$$152.25 + 3.95 \times 2 = 312.40$$

YouPress	YouSee
152.25 ENTER (+)	152.25
3.95 ×	3.95
2	2
TOTAL (=)	312.40

- When you press a key, the cash register announces the corresponding number or function.
- When you press **.**, the cash register beeps.
- When you press **TOTAL (=)**, the cash register announces the total in dollars and cents.

## MAKING CALCULATIONS

You can use the cash register keypad to perform calculations.

Press the number keys to enter numbers and the function keys [**ENTER (+)**, **-**, **X**, **÷**, and **TOTAL (=)**] to solve equations.

## CARE

Keep the cash register dry; if it gets wet, wipe it dry immediately. Use and store the cash register only in normal temperature environments. Handle the cash register carefully; do not drop it. Keep the cash register away from dust and dirt, and wipe it with a damp cloth occasionally to keep it looking new.

If your cash register is not performing as it should, take it to your local RadioShack store for assistance. Modifying or tampering with the cash register's internal components can cause a malfunction and might invalidate its warranty.

### Limited Ninety-Day Warranty

This product is warranted by RadioShack against manufacturing defects in material and workmanship under normal use for ninety (90) days from the date of purchase from RadioShack company-owned stores and authorized RadioShack franchisees and dealers. EXCEPT AS PROVIDED HEREIN, RadioShack MAKES NO EXPRESS WARRANTIES AND ANY IMPLIED WARRANTIES, INCLUDING THOSE OF MERCHANTABILITY AND FITNESS FOR A PARTICULAR PURPOSE, ARE LIMITED IN DURATION TO THE DURATION OF THE WRITTEN LIMITED WARRANTIES CONTAINED HEREIN. EXCEPT AS PROVIDED HEREIN, RadioShack SHALL HAVE NO LIABILITY OR RESPONSIBILITY TO CUSTOMER OR ANY OTHER PERSON OR ENTITY WITH RESPECT TO ANY LIABILITY, LOSS OR DAMAGE CAUSED DIRECTLY OR INDIRECTLY BY USE OR PERFORMANCE OF THE PRODUCT OR ARISING OUT OF ANY BREACH OF THIS WARRANTY, INCLUDING, BUT NOT LIMITED TO, ANY DAMAGES RESULTING FROM INCONVENIENCE, LOSS OF TIME, DATA, PROPERTY, REVENUE, OR PROFIT OR ANY INDIRECT, SPECIAL, INCIDENTAL, OR CONSEQUENTIAL DAMAGES, EVEN IF RadioShack HAS BEEN ADVISED OF THE POSSIBILITY OF SUCH DAMAGES.

Some states do not allow limitations on how long an implied warranty lasts or the exclusion or limitation of incidental or consequential damages, so the above limitations or exclusions may not apply to you.

In the event of a product defect during the warranty period, take the product and the RadioShack sales receipt as proof of purchase date to any RadioShack store. RadioShack will, at its option, unless otherwise provided by law: (a) correct the defect by product repair without charge for parts and labor; (b) replace the product with one of the same or similar design; or (c) refund the purchase price. All replaced parts and products, and products on which a refund is made, become the property of RadioShack. New or reconditioned parts and products may be used in the performance of warranty service. Repaired or replaced parts and products are warranted for the remainder of the original warranty period. You will be charged for repair or replacement of the product made after the expiration of the warranty period.

This warranty does not cover: (a) damage or failure caused by or attributable to acts of God, abuse, accident, misuse, improper or abnormal usage, failure to follow instructions, improper installation or maintenance, alteration, lightning or other incidence of excess voltage or current; (b) any repairs other than those provided by a RadioShack Authorized Service Facility; (c) consumables such as fuses or batteries; (d) cosmetic damage; (e) transportation, shipping or insurance costs; or (f) costs of product removal, installation, set-up service adjustment or reinstallation.

This warranty gives you specific legal rights, and you may also have other rights which vary from state to state.

RadioShack Customer Relations, 200 Taylor Street, 6th Floor, Fort Worth, TX 76102

12/99

RadioShack Corporation  
Fort Worth, Texas 76102

60-1230  
05A02  
Printed in China

## Free Manuals Download Website

<http://myh66.com>

<http://usermanuals.us>

<http://www.somanuals.com>

<http://www.4manuals.cc>

<http://www.manual-lib.com>

<http://www.404manual.com>

<http://www.luxmanual.com>

<http://aubethermostatmanual.com>

Golf course search by state

<http://golfingnear.com>

Email search by domain

<http://emailbydomain.com>

Auto manuals search

<http://auto.somanuals.com>

TV manuals search

<http://tv.somanuals.com>