



Thank you for purchasing your AM/FM Clock Radio from RadioShack.

what's included

AM/FM Clock Radio

User's Guide

NOTE: Actual product may vary from the images found in this document.

Please read this user's guide before installing, setting up and using your new product

www.radioshack.com

contents

features	4
safety certification	5
important safety instructions	6
before you begin	9
connect power	9
install a back-up battery	9
operating your clock radio	10
setting the time	10
playing the radio	11
using the alarm	12
setting alarm time	12
silencing the alarm	13
using sleep	14
resetting your clock	15
caring for your clock radio	15
specifications	15

features

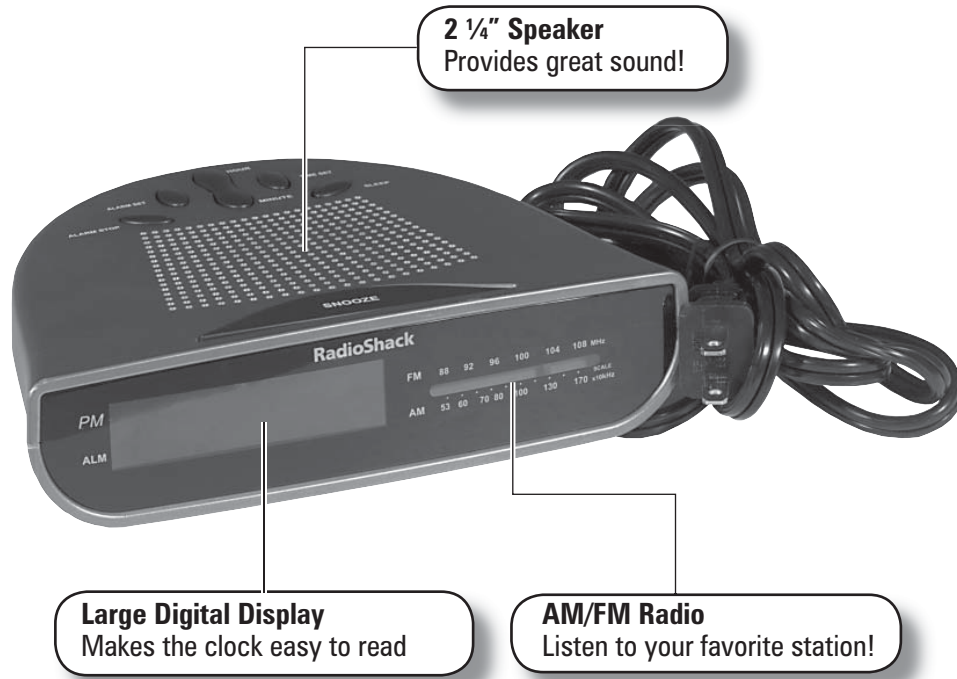





safety certification

This unit was made and tested to meet exacting safety standards. It meets ETL and FCC requirements and complies with safety performance standards of the U.S. Department of Health and Human Services.

CAUTION—THIS UNIT SHOULD NOT BE ADJUSTED OR REPAIRED BY ANYONE EXCEPT PROPERLY QUALIFIED SERVICE PERSONNEL.

The Caution Marking is located on the bottom enclosure of the product.

	CAUTION RISK OF ELECTRIC SHOCK DO NOT OPEN		WARNING: To reduce the risk of fire or shock hazard, do not expose this product to rain or moisture
CAUTION: TO REDUCE THE RISK OF ELECTRIC SHOCK, DO NOT REMOVE THE COVER OR BACK. NO USER-SERVICEABLE PARTS INSIDE. REFER SERVICING TO QUALIFIED PERSONNEL.			
	The lightning symbol is intended to alert you to the presence of uninsulated, dangerous voltage within this product's enclosure that might be of sufficient magnitude to constitute a risk of electric shock. Do not open the product's case.		
	The exclamation symbol is intended to inform you that important operating and maintenance instructions are included in the literature accompanying this product.		

important safety instructions

Read all the included safety and operating instructions before using your clock radio. Follow them closely, and retain them for future reference.

Heed Warnings—Follow all warnings on the product and in the operating instructions.

Cleaning—Unplug this product from the wall outlet before cleaning. Use only a damp cloth for cleaning. Do not use liquid or aerosol cleaners.

Attachments—Do not use attachments/accessories not recommended by the product manufacturer, as they might create a hazard.

Water and Moisture—Do not use this product near water (for example, near a bathtub, washbowl, kitchen sink, or laundry tub; in a wet basement; or near a swimming pool).

Accessories—Do not place this product on an unstable cart, stand, tripod, bracket, or table. The product may fall, causing serious injury to a child or adult, and serious damage to the product. Use only with a cart, stand, tripod, bracket, or table recommended by the manufacturer or sold with the product. Follow the manufacturer's instructions for mounting, and use a recommended mounting accessory.

Ventilation—Slots and openings in the cabinet provide ventilation, ensure reliable operation, and protect from overheating. Do not block or cover these openings, and do not place the product on a bed, sofa, rug, or other similar surface. Do not place the product in a built-in installation, such as a bookcase or rack, unless it provides proper ventilation as specified by the manufacturer.

Power Sources—Operate this product using only the power source indicated on its marking label. If you are not sure of your home's power type, consult your product dealer or local power company.

Polarization—This product is equipped with a polarized AC line plug (a plug having one blade wider than the other). This plug will fit in the power outlet only one way. This is a safety feature. If you cannot insert the plug fully into the outlet, try reversing the plug. If the plug still doesn't fit, contact your electrician to replace your obsolete outlet. Do not defeat the safety purpose of the polarized plug. If you need an extension, use a polarized cord.

CAUTION: To prevent electric shock, match the wide blade of the plug to the wide slot and fully insert.

Power Cord Protection—Route power cords so they are not likely to be walked on or pinched by items placed on or against them. Pay particular attention to cords at plugs, convenience receptacles, and the point where they exit from the product.

Lightning—For added protection for this product during a lightning storm, or when it will be left unattended or unused for long periods of time, unplug it from the wall outlet. This will prevent damage to the product due to lightning and power surges.

Overloading—Do not overload wall outlets, extension cords, or integral convenience receptacles, as this can result in a risk of fire or electric shock.

Object and Liquids—Never push objects of any kind into this product through openings, as they may touch dangerous voltage points or short out parts that could result in a fire or electric shock. Never spill liquid of any kind on the product.

Servicing—Do not attempt to service this product yourself, as opening or removing covers may expose you to dangerous voltage or other hazards. Refer all servicing to qualified service personnel.

Damage Requiring Service—Unplug this product from the wall outlet and refer servicing to qualified service personnel under the following conditions:

- When the power cord or plug is damaged.
- If liquid has been spilled on, or objects have fallen into the product.

- If the product has been exposed to rain or water.
- If the product does not operate normally by following the operating instructions, adjust only those controls that are covered by the operating instructions. Improper adjustment of other controls may result in damage and will often require extensive work by a qualified technician to restore the product to normal operation.
- If the product has been dropped or damaged in any way.
- When the product exhibits a distinct change in performance.

Replacement parts—When replacement parts are required, be sure the service technician uses replacement parts specified by the manufacturer or has the same characteristics as the original part. Unauthorized substitutions may result in fire, electric shock, or other hazards.

Safety Check—Upon completion of service or repairs to this product, ask the service technician to perform safety checks to determine that the product is in proper operating condition.

Wall or Ceiling Mount—The product should be mounted to a wall or ceiling only as recommended by the manufacturer.

Heat—The product should be situated away from heat sources such as radiators, heat registers, stoves, or other products (including amplifiers) that produce heat.

Power Lines—Locate an outdoor antenna away from power lines.

Non-use Periods—Unplug the product's power cord when you will not use it for extended periods.

before you begin

connect power

Plug the power cord into a standard AC outlet. All display segments briefly appear.

CAUTION: The power cord is equipped with a polarized plug to prevent electric shock. One blade on the plug is wider than the other and the plug only fits one way in the outlet. If you cannot insert the plug easily, turn it over and try again. Do not force it.

install a back-up battery

Your clock radio requires a 9V battery for back-up power (not supplied, available at RadioShack or online at www.radioshack.com).

1. Remove the battery compartment cover.

2. Snap the battery onto the connector.

3. Place the battery in the compartment and replace the cover.



NOTE

- *Dispose of old batteries promptly and properly. Do not bury or burn them.*
- *Use only fresh batteries of the required size and recommended type.*
- *Always remove an old or weak battery. Batteries can leak chemicals that can damage electronic parts.*

operating your clock radio

set the time

Hold down **TIME SET**. Then, press **HOUR** or **MINUTE**.

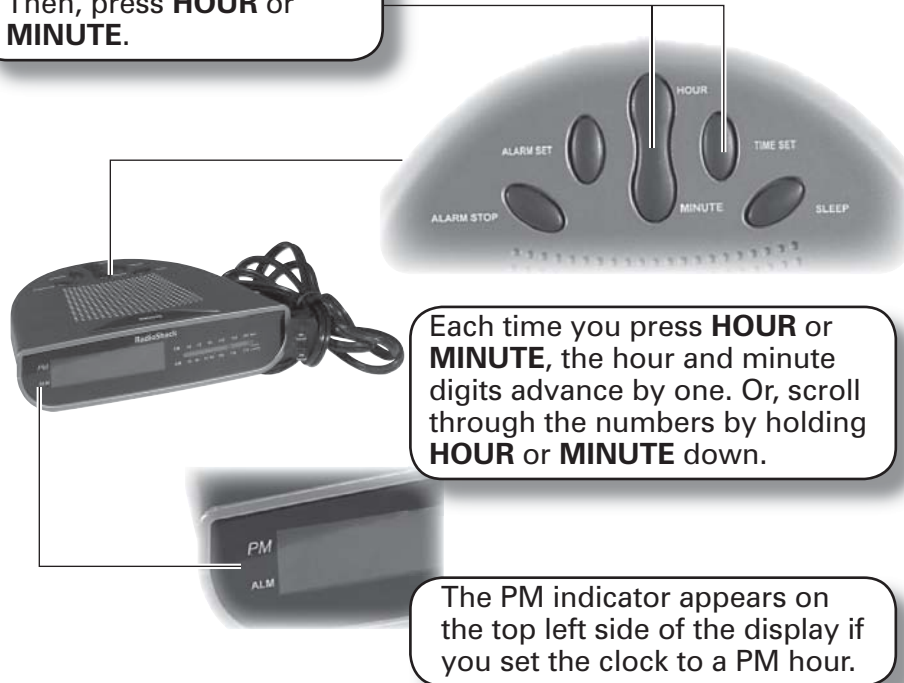

playing the radio

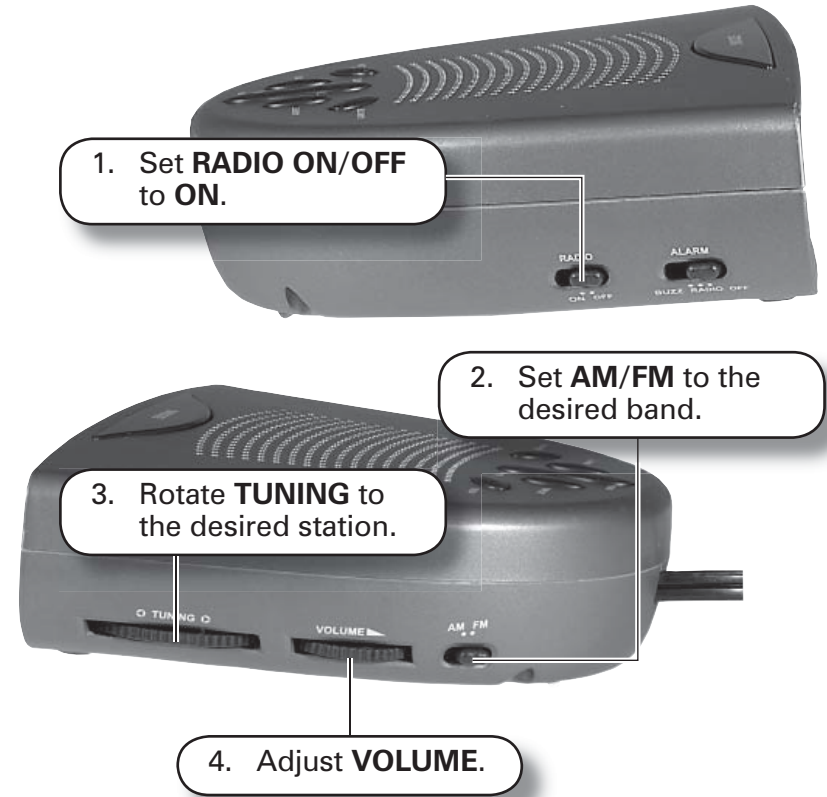

- NOTE**
- The clock radio has a built-in AM antenna. For the best AM reception, rotate your radio.
 - Your radio's power cord acts as the FM antenna. For the best FM reception, fully extend the power cord.

using the alarm

setting alarm time

Hold down **ALARM SET**. Then, press **HOUR** or **MINUTE**.

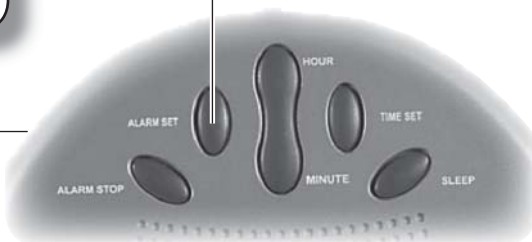

Each time you press **HOUR** or **MINUTE**, the hour and minute digits advance by one. To scroll through the numbers, press and hold **HOUR** or **MINUTE**.



The **PM** indicator appears on the top left side of the display if you set the clock to a PM hour.



To wake to the alarm buzzer or the radio, set **ALARM BUZZ/RADIO/OFF** to **BUZZ** or **RADIO**. The **ALM** indicator lights.



silencing the alarm

NOTE

At the preset alarm time, the alarm sounds. After 1 hour and 59 minutes, the alarm will stop.

To turn off the alarm immediately, press **ALARM STOP**. It will sound again after 24 hours.

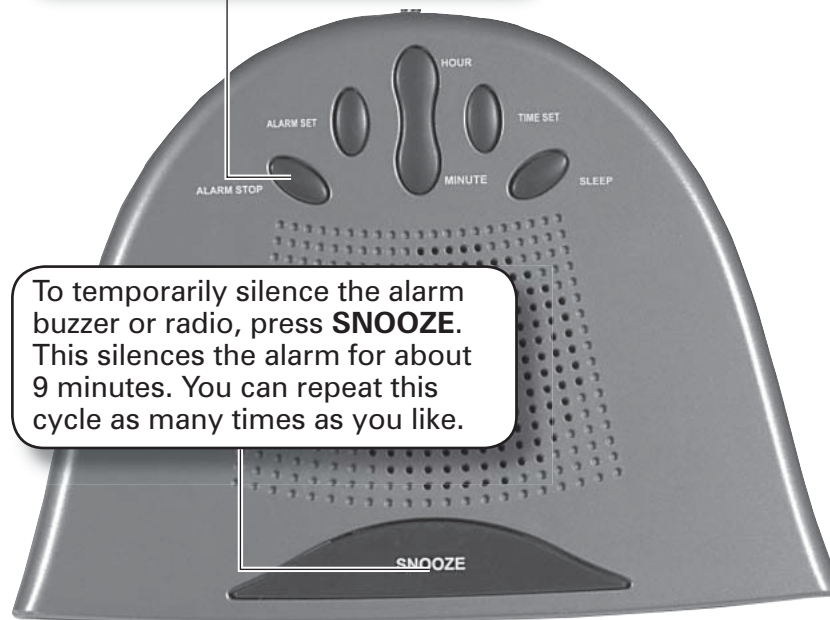

To temporarily silence the alarm buzzer or radio, press **SNOOZE**. This silences the alarm for about 9 minutes. You can repeat this cycle as many times as you like.

To turn off the alarm completely, set **ALARM BUZZ/RADIO/OFF** to **OFF**.



using sleep

You can set the radio to automatically turn off after up to one hour and 59 minutes.

To play the radio for less than 1 hour



1. Make sure the radio is off by setting **RADIO ON/OFF** to **OFF**.



2. While you hold **SLEEP**, press **MINUTE**. The minutes decrease by 1 each time you press minute.

To play the radio for more than 1 hour but less than 2 hours.

1. Hold down **SLEEP**, then press **HOUR** once. The time increases to 1 hour, 59 minutes.
2. While you hold **SLEEP**, press **MINUTE**. The minutes decrease by 1 each time you press **MINUTE**.
3. Release **SLEEP**.



To turn off the radio before it automatically turns off, press **SNOOZE**.

resetting the clock

On rare occasions, your clock might not work properly or it might lock up. If that happens, disconnect the AC power cord and remove the back-up battery. Then, reinstall the battery and plug the clock back in. If you still encounter difficulties, take it to your local RadioShack store for assistance.

caring for your clock radio

Keep your clock radio dry. If it gets wet, wipe it dry immediately. Use and store your clock radio only in room temperature environments. Handle your clock radio carefully. Do not drop it. Keep it away from dust and dirt, and wipe it with a damp cloth occasionally to keep it looking new.

specifications

Bands	AM 530-1710 kHz
	FM 88-108 MHz
Power Output.....	350mW (maximum)
Speaker	2 1/4 Inches
Power Requirement.....	120 V AC, 60 Hz, 37mA
	DC 9V (Backup Battery)
Dimensions (LWD).....	5 1/16 x 6 7/8 x 1 13/16 inches

Specifications are typical; individual units might vary. Specifications are subject to change and improvement without notice.

the fcc wants you to know

This equipment has been tested and found to comply with the limits for a Class B digital device, pursuant to Part 15 of the FCC Rules. These limits are designed to provide reasonable protection against harmful interference in a residential installation. This equipment generates, uses, and can radiate radio frequency energy and, if not installed and used in accordance with the instructions, may cause harmful interference to radio communications. However, there is no guarantee that interference will not occur in a particular installation. If this equipment does cause harmful interference to radio or television reception, which can be determined by turning the equipment off and on, the user is encouraged to try to correct the interference by one or more of the following measures:

- Reorient or relocate the receiving antenna.
- Increase the separation between the equipment and receiver.
- Connect the equipment into an outlet on a circuit different from that to which the receiver is connected.

Consult your local RadioShack store or an experienced radio/TV technician for help.

If you cannot eliminate the interference, the FCC requires that you stop using this product.

WARNING: Changes or modifications not expressly approved by RadioShack may cause interference and void the user's authority to operate the equipment. This device complies with Part 15 of the FCC Rules. Operation is subject to the following two conditions: (1) This device may not cause harmful interference, and (2) This device must accept any interference received, including interference that may cause undesired operation.

limited 90-day warranty

This product is warranted by RadioShack against manufacturing defects in material and workmanship under normal use for ninety (90) days from the date of purchase from RadioShack company-owned stores and authorized RadioShack franchisees and dealers. For complete warranty details and exclusions, check with your local RadioShack store.

RadioShack Customer Relations
200 Taylor Street, 6th Floor, Fort Worth, TX 76102

04/04

Printed in China
12-1655
02A05



©2004. RadioShack Corporation.
All rights reserved. RadioShack and RadioShack.com are
trademarks used by RadioShack Corporation.

Free Manuals Download Website

<http://myh66.com>

<http://usermanuals.us>

<http://www.somanuals.com>

<http://www.4manuals.cc>

<http://www.manual-lib.com>

<http://www.404manual.com>

<http://www.luxmanual.com>

<http://aubethermostatmanual.com>

Golf course search by state

<http://golfingnear.com>

Email search by domain

<http://emailbydomain.com>

Auto manuals search

<http://auto.somanuals.com>

TV manuals search

<http://tv.somanuals.com>