

GB **Instruction Manual**

RECOMMENDATIONS AND SUGGESTIONS

INSTALLATION

- The manufacturer will not be held liable for any damages resulting from incorrect or improper installation.
 - The minimum safety distance between the cooker top and the extractor hood is 650 mm.
 - Check that the mains voltage corresponds to that indicated on the rating plate fixed to the inside of the hood.
 - For Class I appliances, check that the domestic power supply guarantees adequate earthing.
- Connect the extractor to the exhaust flue through a pipe of minimum diameter 120 mm. The route of the flue must be as short as possible.
- Do not connect the extractor hood to exhaust ducts carrying combustion fumes (boilers, fireplaces, etc.).
 - If the extractor is used in conjunction with non-electrical appliances (e.g. gas burning appliances), a sufficient degree of aeration must be guaranteed in the room in order to prevent the backflow of exhaust gas. The kitchen must have an opening communicating directly with the open air in order to guarantee the entry of clean air.

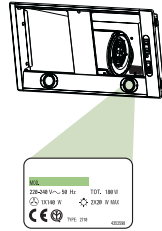

USE

- The extractor hood has been designed exclusively for domestic use to eliminate kitchen smells.
- Never use the hood for purposes other than for which it has been designed.
- Never leave high naked flames under the hood when it is in operation.
- Adjust the flame intensity to direct it onto the bottom of the pan only, making sure that it does not engulf the sides.
- Deep fat fryers must be continuously monitored during use: overheated oil can burst into flames.
- The hood should not be used by children or persons not instructed in its correct use.

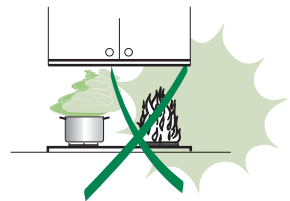
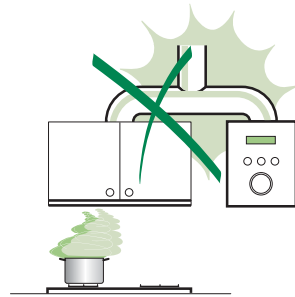

MAINTENANCE

- Switch off or unplug the appliance from the mains supply before carrying out any maintenance work.
- Clean and/or replace the Filters after the specified time period.
- Clean the hood using a damp cloth and a neutral liquid detergent.

CHARACTERISTICS

Dimensions

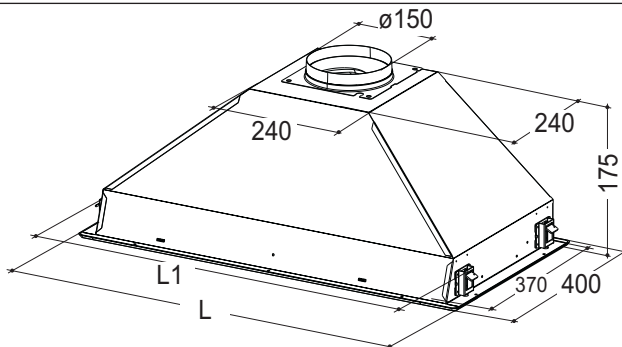

Hood Type	54	72
L	540	720
L1	512	692

Components

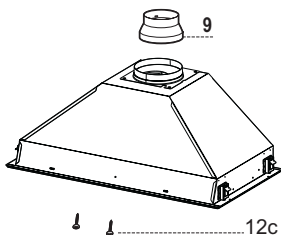

Ref.	Q.ty	Product Components
1	1	Hood Body, complete with: Controls, Light, Blower, Filters

9	1	Reducer Flange \varnothing 150-120 mm
---	---	---

Ref.	Q.ty	Installation Components
------	------	-------------------------

12c	2	Screws 2,9 x 6,5
-----	---	------------------

Q.ty	Documentation
------	---------------

1	Instruction Manual
---	--------------------

1	Electric Diagram
---	------------------

INSTALLATION

Drilling the Support surface and Fitting the Hood

The Hood can be fitted directly to the underside of the Wall units (min. 650 mm above the cooker top) with snap-on side supports, which are set up for a support panel thickness of between 15 mm and 30 mm.

- Cut a fitted opening in the bottom surface of the wall unit, as shown.
- Remove the metal grease filters (see par. on Maintenance).
- Disconnect the filter support by turning the internal handles provided.
- Insert the hood until the side supports snap into place.
- Lock in position by tightening the screws **Vf** from underneath the hood.

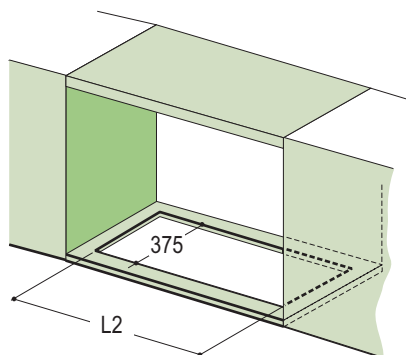
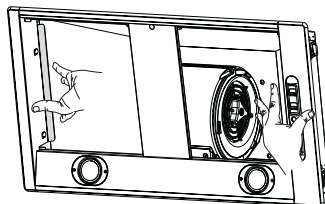

Hood Type	54	72
L2	515	695

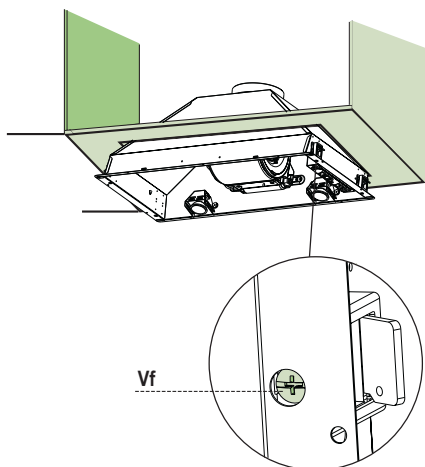

- Replace the filter support
- Screw the filter support using the 2 screws **12c** (2,9 x 6 ,5) provided.
- Replace the grease filters make sure that the handle is visible on the outside.

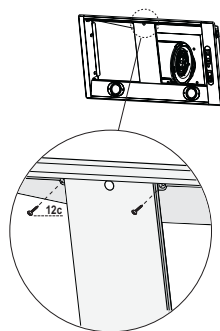

Connections

DUCTED VERSION AIR EXHAUST SYSTEM

When installing the ducted version, connect the hood to the chimney using either a flexible or rigid pipe \varnothing 150 or 120 mm, the choice of which is left to the installer.

- To install a \varnothing 120 mm air exhaust connection, insert the reducer flange **9** on the hood body outlet.
- Fix the pipe in position using sufficient pipe clamps (not supplied).
- Remove any activated charcoal filters.

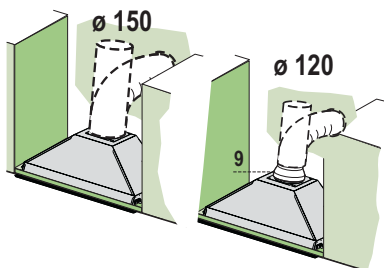

RECIRCULATION VERSION AIR OUTLET

- Drill a hole \varnothing 120 or 150 mm in the shelf above the hood and connect the hood canopy outlet to the top part of the wall unit by means of a rigid or flexible pipe of the same diameter, the choice of which is at the discretion of the installer.
- To install a \varnothing 120 mm air exhaust connection, insert the reducer flange **9** on the hood body outlet.
- Fix the pipe in position using sufficient pipe clamps (not supplied).
- Ensure that the activated charcoal filters have been inserted.

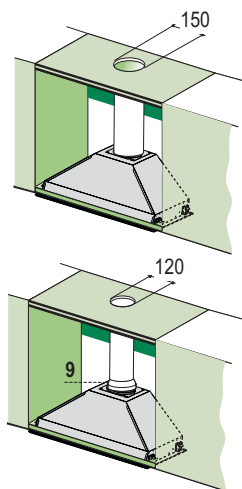

ELECTRICAL CONNECTION

- Connect the hood to the mains through a two-pole switch having a contact gap of at least 3 mm.

USE

Control Panel

The hood can be switched on pushing directly onto the requested speed without firstly having to select 0/1 button.



KEY	LED	FUNCTIONS
L	0/1 Light	Turns lighting on and off.
T1	0/1 Motor on	First speed. When pressed for about 2 seconds the motor is switched off.
T2	Speed on	Second speed.
T3	Speed on	Third speed.
T4	Speed Fixed	Max. speed
	Flashing	Intensive speed. Suitable for the strongest cooking vapours and odours. The function becomes active when the button is pushed for about 2 seconds. After 10 minutes of functioning it turns off automatically. This function can be interrupted by means of pressing any of the buttons.
S1	Led	Fixed
		Indicates that the Metal grease filters saturation alarm has been triggered, and the filters need to be washed. The alarm is triggered after 100 working hours. (<i>Reset; check the Maintenance-paragraph</i>)
		Flashing
		indicates that the activated charcoal odour filter saturation alarm has been triggered, and the filter has to be replaced; the metal grease filters must also be washed. The activated charcoal odour filter is triggered after 200 working hours. (<i>Activation and Reset; check the Maintenance-paragraph</i>)

REMOTE CONTROL (OPTIONAL)

The appliance can be controlled using a remote control powered by a 1.5 V carbon-zinc alkaline batteries of the standard LR03-AAA type.

- Do not place the remote control near to heat sources.
- Used batteries must be disposed of in the proper manner.

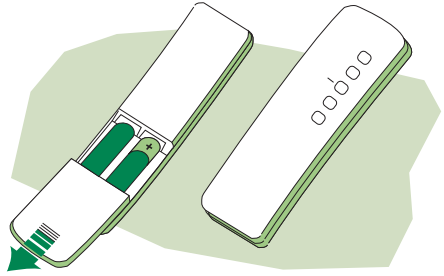

MAINTENANCE

Grease filters

CLEANING METAL GREASE FILTERS

Alarm signal reset

- Switch of the lights and extractor motor.
- Press button **T3** for at least 3 seconds, until the leds start to flash.

Cleaning the filters

- The filters are washable and must be cleaned when led **S1** flashes or at least every 2 months of operation, or more frequently for particularly heavy usage.
- Remove the filters one at a time, supporting them with one hand and turning the safety knobs (pull and turn).
- Wash the filters, taking care not to bend them. Allow them to dry before refitting.
- Replace them and fix them using the safety knobs provided (pull and turn).

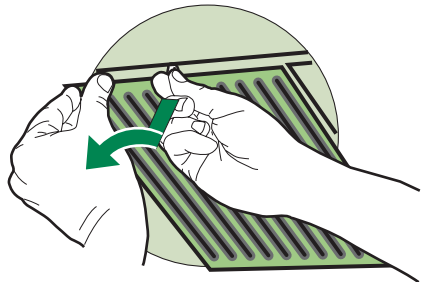

Activated charcoal filter (Recirculation version)

REPLACING THE ACTIVATED CHARCOAL FILTER

- The filter is not washable and cannot be regenerated. It must be replaced when led **S1** flashes or at least every 4 months. The alarm signal will only light up when the extractor motor is switched on.

Alarm signal reset

- Switch off the lights and extractor motor.
- Press button **T3** for at least 3 seconds, until the leds start to flash.

Replacing the Filter

- Remove the grease filters.
- Remove the saturated activated charcoal filters as shown (A).
- Fit new filters (B).
- Replace the grease filters.

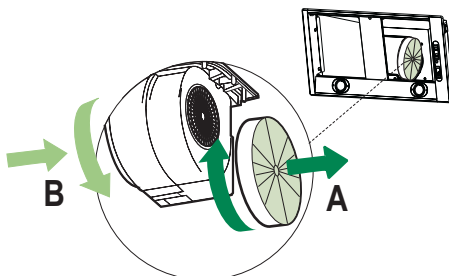

Alarm signal activation

- In Recirculation version Hoods, the Filter saturation alarm can be enabled on installation or at a later date.
- Turn the Lights and the suction Motor off.
- Disconnect the Hood using the Main switch or the double-pole switch on the mains power supply.
- Restore the connection by pressing and holding **T1**.
- Release the button. All five LEDs are turned on
- Within 3 seconds press **T1** until LEDs **T1** and **T4** flash in confirmation:
LED flashes twice - Activated charcoal filter saturation alarm ENABLED
LED flashes once - Activated charcoal filter saturation alarm DISABLED

Lighting

LIGHT REPLACEMENT

50 W halogen light.

- Remove the 2 screws fixing the light cover.
- Remove the lamp by gripping the protruding part and turning to the left.
- Replace with a new lamp with the same characteristics, making sure that you insert the two pins properly into their housings.
- Replace the cover and fix it in position using the two screws removed as above

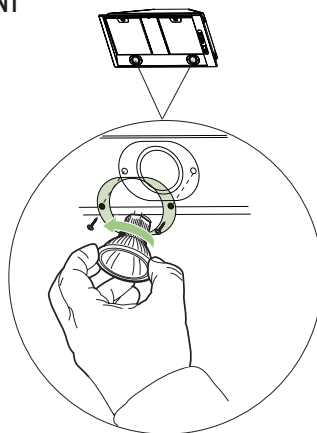

Free Manuals Download Website

<http://myh66.com>

<http://usermanuals.us>

<http://www.somanuals.com>

<http://www.4manuals.cc>

<http://www.manual-lib.com>

<http://www.404manual.com>

<http://www.luxmanual.com>

<http://aubethermostatmanual.com>

Golf course search by state

<http://golfingnear.com>

Email search by domain

<http://emailbydomain.com>

Auto manuals search

<http://auto.somanuals.com>

TV manuals search

<http://tv.somanuals.com>