



## FCC Information

This device complies with Part 15 of the FCC Rules. Operation is subject to the following two conditions: (1) This device may not cause harmful interference, and (2) this device must accept any interference received, including interference that may cause undesired operation.

In accordance with FCC requirements, changes or modifications not expressly approved by Thomson multimedia Inc. could void the user's authority to operate this product.

This device generates and uses radio frequency (RF) energy, and if not installed and used properly, this equipment may cause interference to radio and television reception.

If this equipment does cause interference to radio or television reception (which you can determine by unplugging the unit), try to correct the interference by one or more of the following measures:

- Re-orient the receiving antenna (that is, the antenna for the radio or television that is "receiving" the interference).
- Move the unit away from the equipment that is receiving interference.
- Plug the unit into a different wall outlet so that the unit and the equipment receiving interference are on different branch circuits.

If these measures do not eliminate the interference, please consult your dealer or an experienced radio/television technician for additional suggestions. Also, the Federal Communications Commission has prepared a helpful booklet, "How To Identify and Resolve Radio TV Interference Problems." This booklet is available from the U.S. Government Printing Office, Washington, DC 20402. Please specify stock number 004-000-00345-4 when ordering copies.

This product complies with DHHS Rules 21 CFR Subchapter J. Applicable at the date of manufacture.

**WARNING: TO PREVENT FIRE OR ELECTRICAL SHOCK HAZARD, DO NOT EXPOSE THIS PRODUCT TO RAIN OR MOISTURE.**

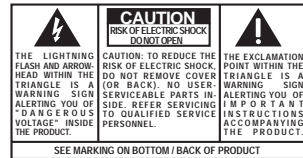

## Service

This product should be serviced only by those specially trained in appropriate servicing techniques. Attach your sales receipt to the booklet for future reference or jot down the date this product was purchased or received as a gift. This information will be valuable if service should be required during the warranty period.

Purchase Date \_\_\_\_\_

Name of Store \_\_\_\_\_

## Main Connections

AC OUTLET POWER SUPPLY: 120V ~60Hz

### Note:

Power is fed to the unit even when it is not functioning. To cut the power supply off, the power cable must be unplugged.

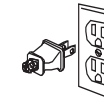

EN

## For Your Safety

The AC power plug is polarized (one blade is wider than the other) and only fits into AC power outlets one way. If the plug won't go into the outlet completely, turn the plug over and try to insert it the other way. If it still won't fit, contact a qualified electrician to change the outlet, or use a different one. Do not attempt to bypass this safety feature.

**CAUTION: TO PREVENT ELECTRIC SHOCK, MATCH WIDE BLADE OF PLUG TO WIDE SLOT, FULLY INSERT.**

## Battery Back-Up

This clock radio is equipped with a memory holding system that can be powered with a 9-volt battery (not included). The power failure protection circuit will not operate unless battery is installed.

When normal household power is interrupted, or AC line cord is unplugged, the back-up battery will power the clock radio to keep track of time and alarm settings programmed into memory. When the battery backup functions, the function of alarm still occurs during the power interruption if remaining battery power is adequate. Normal operation will resume after AC power is restored so you will not have to reset the time or the alarm. With battery back-up, if Wake to Radio or Wake to CD is activated during power interruption, Wake to Tone will operate instead. Wake mode will operate normally again once power is resumed.

When AC power is interrupted (disconnected) for a short period of time, both time and alarm settings will change (unless optional battery is installed). After AC power is restored (reconnected), the Digital Display will blink to indicate that power was interrupted and you should readjust the time and alarm settings.

## Caution



Have a Blast- Just Not in Your Eardrums!

Make sure you turn down the volume on the unit before you put on headphones. Increase the volume to the desired level only after headphone are in place.

The descriptions and characteristics in this owner's manual are for the purpose of general reference only and not as a guarantee. In order to provide you with the highest quality product, we may make changes or modifications without prior notice. The English version serves as the final reference on all product and operational details should any discrepancies arise in other languages.





## THE DIGITAL CD CLOCK RADIO

### Protection against main power failures:

1. Remove battery compartment door (located on the bottom of the radio) by applying thumb pressure to area indicated on battery door and then lift the door out and off the cabinet.
2. Connect a 9-volt battery connector plug. (6LR61 or NEDA 1604A)
3. Insert battery in the compartment and replace the compartment door.

**NOTE:** Alkaline (6LR61/NEDA 1604A) batteries are recommended. Carbon-zinc battery may be used but memory holding time will be substantially reduced. Memory holding time for a fresh alkaline battery is approximately 8 hours (if radio or alarm are not operated) which should take care of short, nuisance-type AC power failures. To preserve battery life, the unit should remain plugged into an AC outlet. As the battery gets older, its voltage drops and memory may be lost. Be sure to replace the battery periodically. Battery should be removed if the unit will be stored for more than one month. Leaky battery can badly damage the clock radio.

### The Display

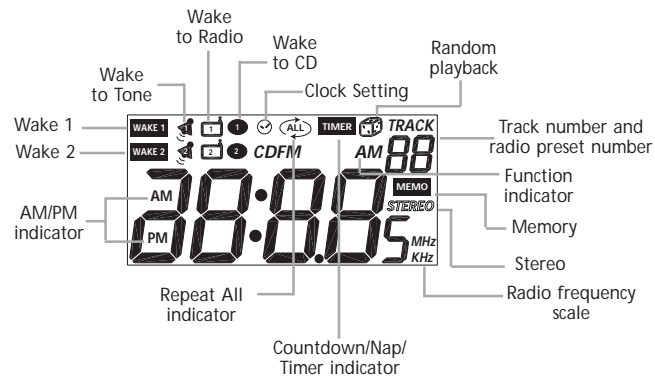

1



## THE DIGITAL CD CLOCK RADIO

Press **SET CLOCK/WAKE** repeatedly to scroll between SET CLOCK, SET WAKE1, SET WAKE2 and LOCK.

EN

### Setting time

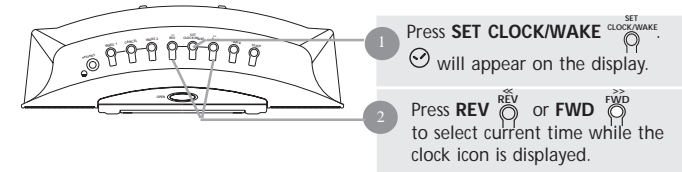

### NOTE:

1. Press and hold **REV** or **FWD** to skip fast
2. The time display has a 12-hour format. AM/PM indicator will light to show AM or PM time respectively.



### Setting Wake to Tone

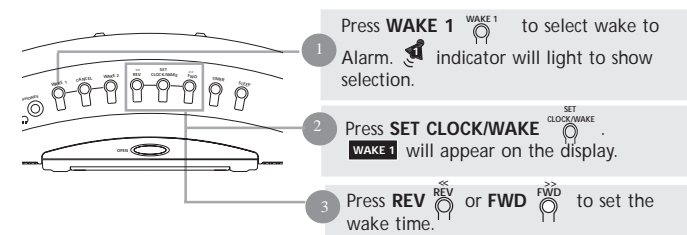

1. With the **GRADUWAKE** feature, the alarm tone volume will increase gradually to its maximum in about 30 to 45 seconds.
2. You cannot adjust the alarm tone with volume.

2





## THE DIGITAL CD CLOCK RADIO

### Setting Wake to Radio

- 1 Press **WAKE 1** to select wake to Radio . The related indicator will light to show selection.
- 2 Press **SET CLOCK/WAKE** until **WAKE 1** indicator lights on the display.
- 3 Press **REV** or **FWD** to select the time you want music to start playing.
- 4 **Setting Wake Station**
  - a. Press **RADIO ON/BAND** to select AM/FM and press **SKIP REV or FWD** to tune to your desired station.
  - b. Press **MEMO SET** to enter preset mode and
  - c. Press **MEMO RECALL** repeatedly to select Alarm Memo"AL MEMO" (11th preset station).
  - d. Press **MEMO SET** to confirm your selection.
- 5 Press **VOLUME - or +** to your desired wake-up volume.
- 6 Press **OFF** to turn off the unit.



- If no WAKE STATION is set, the wake station will stay at your last listening station.
- When setting WAKE 2, follow the same procedure described above.
- To change to another wake mode (e.g. from CD to radio), simply press WAKE 1 or WAKE 2 to scroll through wake options.

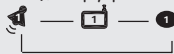

3



## THE DIGITAL CD CLOCK RADIO

### Setting Wake to CD

EN

- 1 Press **WAKE 1** to select wake to CD . The related indicator will light to show selection.
- 2 Press **SET CLOCK/WAKE** until **WAKE 1** indicator lights on the display.
- 3 Press **REV** or **FWD** to select the time you want music to start playing.
- 4 **Insert a disc in the compartment**  
To wake up to your preferred CD track: (default is track 1)
  - a. Press and hold **WAKE UP CD TRACK** while pressing **SKIP FWD or REV** to select track.
  - b. Press **PLAY** to listen to the Wake-up volume.
- 5 Press **VOLUME - or +** to your desired wake-up volume.
- 6 Press **OFF** to turn off the unit.



- If the CD compartment is empty, the alarm tone will sound instead when in fact WAKE TO CD mode is selected.
- When setting WAKE 2, same procedure is followed.
- To change to another wake mode (e.g. from CD to radio), simply press WAKE 1 or WAKE 2 to scroll through wake options.

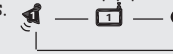

4





## THE DIGITAL CD CLOCK RADIO

### Adjusting snooze duration

The snooze-alarm control allows extra sleep time after the unit comes on in alarm mode. Press will turn off the alarm until the snooze period is over. You can use the SNOOZE feature repeatedly for up to about 2 hours, after which the unit will turn off until the next alarm conditions are met.

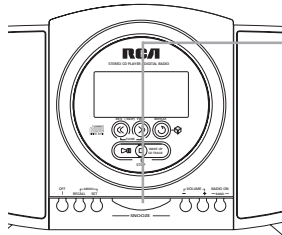

- 1 Press and hold **SNOOZE** .
- 2 Press **REV** or **FWD** on the top of the unit to set the "quiet" period (default is 9 minutes) from 1 minute to 30 minutes for which the alarm momentarily goes off.

### Stopping alarm

#### 1. To silence the alarm momentarily:

- Press **SNOOZE** and the alarm will sound again when the snooze period is over (see "Adjusting snooze duration" above)

#### 2. To stop alarm from sounding:

- Press **OFF** and the alarm will be on again the following day at the same time

#### 3. To cancel alarm completely:

- Press **CANCEL** then **WAKE 1** or **WAKE 2** and the corresponding alarm(s) won't sound again the following day. WAKE indicators will not be displayed.
- If you press **WAKE 1** or **WAKE 2** button again, the previous preset time remains unchanged.



- If uninterrupted, the alarms will stop sounding in 2 hours.

5



## THE DIGITAL CD CLOCK RADIO

### Setting COUNTDOWN Timer

EN

- 1 Select **COUNTDOWN** timer at the back of the unit .
- 2 Press **TIMER** and the **TIMER** indicator will appear on the display.
- 3 Press **REV** or **FWD** to set countdown time.
- 4 Press **TIMER** to activate countdown. **TIMER** indicator lights continuously. The display will show the countdown time as it counts down towards 0:00 (minute:second). Alarm will sound once the timer reaches 0:00.
- 5 Press **TIMER** again to cancel countdown timer.

### Setting NAP Duration

You may take a short nap and be woken up by the alarm.

- 1 Click the Timer selector at the back of the unit to **NAP** .
- 2 Press **TIMER** . The **TIMER** indicator and 0:20 (as default setting) will appear on the display. (i.e. alarm will be turned on in 20 minutes). Display will switch back to real clock time after about 3 seconds.
- 3 Press **REV** or **FWD** to set nap time. Nap time decrease or increase at 10 -minute intervals between 10 and 120 minutes.
- 4 Press **TIMER** to activate countdown. The display returns to the real clock time. **TIMER** indicator lights continuously. Alarm will sound once the timer reaches 0:00.
- 5 Press and hold **TIMER** until the **TIMER** indicator disappears to cancel NAP timer.

**TIP:** To check the remain NAP timer, press **TIMER**. The display will show the minutes left. After 3 seconds, the display will return to clock time.

6





## THE DIGITAL CD CLOCK RADIO

### Listening to radio

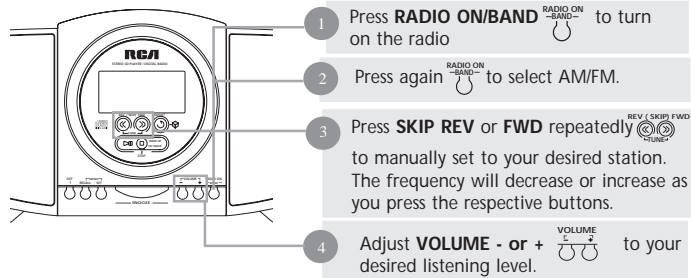

• To improve reception, you may try and:

1. move or rotate the unit for AM reception
2. slide on the back of the unit to **MONO** for FM reception

• To turn off the radio, press .

### Automatic Station Search

Press and hold either **SKIP REV** or **FWD** for more than 1 second and release. Automatic station search starts and stops when channel is found.



Press and hold **SKIP FWD** until "UP" is displayed to automatically search up the radio frequency.



Press and hold **SKIP REV** until "dn" is displayed to automatically search down the radio frequency.



## THE DIGITAL CD CLOCK RADIO

### Radio Frequency Memory

EN

- 1 Refer to "Listening to Radio" to tune to the desired station.
- 2 Set frequency into memory. Press **MEMO SET** . Preset station number will be automatically assigned (the next available number) and show on the display. Press **MEMO RECALL** to select another preset location.
- 3 Press **MEMO SET** to confirm your settings.



Example: FM 104.0 is stored in memory 2 location.

If memory is full, you will see "--" on the display.

Press and hold **MEMO SET** to cancel memory setting.

**TIPS:** Maximum 11 (10 preset locations and 1 alarm memory location) preset stations can be stored. You can also overwrite preset station numbers by pressing **MEMO SET** to enter setting mode. Press **RECALL** to select the number and **SET** again to confirm selection.

### Memory Recall

Press **RECALL** repeatedly to recall preset stations when radio is on.





## THE DIGITAL CD CLOCK RADIO

### Listening to compact disc

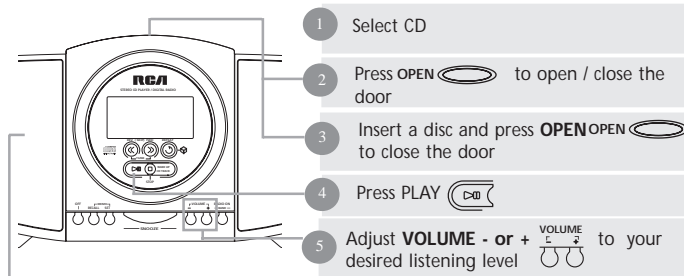

If the unit contains no CD, the display will show "nd" when you press **PLAY**. Press **PLAY** again and the CD compartment door will open.

Press **SKIP REV** or **FWD** to search reverse or forward to select track.

Press **REPEAT/SHUFFLE** to select any repeat and shuffle options.

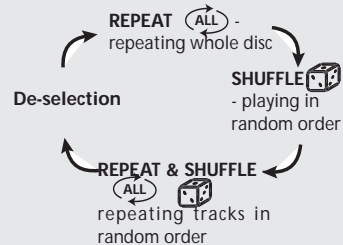

Press **PLAY/PAUSE** to pause playback.

Press **STOP** to stop playback.

9



## THE DIGITAL CD CLOCK RADIO

EN



- If the disc compartment is empty, or the disc cannot be played, "nd" lights continuously on the display.
- Do not store CDs in damp areas. Do not expose CDs to high temperatures.
- You should avoid leaving the CD door open. Dust is liable to impair performance of the laser optical unit.

### Sleep to CD/radio

You can drift off to sleep to CD/radio knowing that the unit will turn itself off automatically. If alarm is set, the unit will turn on again as programmed.

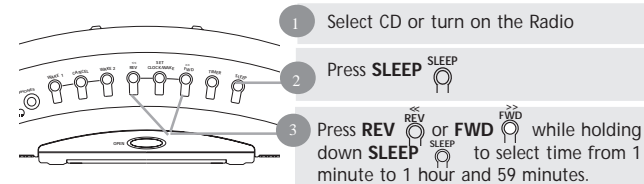

4 **CD**: Press **PLAY** . CD play mode will automatically be in Repeat All mode when using Sleep to CD setting. The unit will turn off automatically once sleep time is reached.

**Radio**: Sleep station will automatically switch to the last sleep station setting. You must reset to sleep to a different station.

- a. Press **RADIO ON/BAND**
- b. Press **SKIP REV** or **FWD** to tune to the station you want to sleep to.



- The next time you reactivate the sleep function by pressing **SLEEP**, settings will remain the same as the last time they were set.
- If you decide to turn off the unit sooner, press **SNOOZE** or **OFF** and this will shut off the sleep cycle.
- When sleep mode is active, subsequent press on **SLEEP** to show the remaining time before the unit goes off.

10





## CARE AND MAINTENANCE

### Handling Compact Discs

- Do not touch the signal surfaces. Hold by the edges, or by one edge and the hole.
- Do not affix labels or adhesive tape to the label surfaces. Also, do not scratch or damage the label.
- Discs rotate at high speeds inside the player. Do not use damaged (cracked or warped) discs.

### Cleaning Compact Discs

- Dirty discs can cause poor sound quality. Always keep discs clean by wiping them gently with a soft cloth from the inner edge toward the outer perimeter.
- If a disc becomes dirty, wet a soft cloth in water, wring it out well, wipe the dirt away gently, and then remove any water drops with a dry cloth.
- Do not use record cleaning sprays or anti-static agents on discs. Also, never clean discs with benzene, thinner, or other volatile solvents which may cause damage to the disc surface.

### CD Lens Care

When your CD lens gets dirty it can also cause the unit to output poor sound quality. To clean the lens you will need to purchase a CD lens cleaner which can maintain the output sound quality. For instructions on cleaning the CD lens, refer to the ones accompanying the lens care.

### Cleaning the Exterior

Prior to cleaning the exterior, be sure to unplug the power cord from the AC power outlet. Wipe the exterior with a soft, clean, and slightly water-dampened cloth.

### Precautions

- Never open the cabinet under any circumstances. Any repairs or internal adjustments should be made only by a trained technician.
- Warning: Never operate this product with the cabinet removed.
- The CD player of this unit uses a laser to read the music on the disc. The laser mechanism corresponds to the cartridge and stylus of a record player. Although this product incorporates a laser pick-up lens, it is completely safe when operated according to directions.
- Discs rotate at high speed inside the player. Do not use damaged, warped or cracked discs.
- Do not touch the pick-up lens which is located inside the disc compartment. Also, to keep dust from collecting on the pick-up lens, do not leave the compartment door open for an extended period of time.

11



## U.S. Warranty

### What your warranty covers:

- Any defect in materials or workmanship.

### For how long after your purchase:

- One year (The warranty period for rental units begins with the first rental or 45 days from date of shipment to the rental firm, whichever comes first.)

### What we will do:

- Provide you with a new, or at our option, a refurbished unit.
- The exchange unit is under warranty for the remainder of the original product's warranty period.

### How to make a warranty claim:

- Properly pack your unit. Include any cables, etc., which were originally provided with the product. We recommend using the original carton and packing materials.
- Include in the package evidence of purchase date such as the bill of sale. Also print your name and address and a description of the defect. Send standard UPS or its equivalent to:

Thomson multimedia Inc.  
Product Exchange Centre,  
11721 B Alameda Ave,  
Socorro, TX 79927

- Pay any charges billed to you by the Exchange Center for service not covered by the warranty.
- Insure your shipment in case of loss of damage. Thomson accepts no liability in case of damage or loss.
- A new or refurbished unit will be shipped to you prepaid freight.

### What your warranty does not cover:

- Customer instruction. (Your Owner's Manual provides information regarding operating instructions and user controls. For additional information, ask your dealer.)
- Installation and set-up service adjustments.
- Batteries.
- Damage from misuse or neglect.
- Products which have been modified or incorporated into other products.
- Products purchased or serviced outside the USA.
- Acts of God, such as but not limited to lightning damage.

### How state law relates to this warranty:

- This warranty gives you specific legal rights, and you may have other rights which vary from state to state.

### If you purchased your product outside the USA:

- This warranty does not apply. Contact your dealer for warranty information.

EN

12





# RCA

U  
S  
E  
R  
M  
A  
N  
U  
A  
L

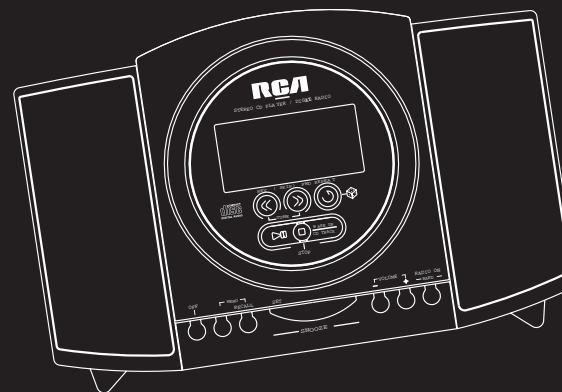

Thomson multimedia Inc.  
10330 North Meridian St.  
Indianapolis, IN 46290  
© 2001 Thomson multimedia Inc.  
Trademark(s) ® Registered  
Marca(s) ® Registrada(s)  
Marque(s) ® Déposée(s)  
55144260 Rev.2 (EN/E)  
[www.rca.com](http://www.rca.com)

## RP 3755



## Free Manuals Download Website

<http://myh66.com>

<http://usermanuals.us>

<http://www.somanuals.com>

<http://www.4manuals.cc>

<http://www.manual-lib.com>

<http://www.404manual.com>

<http://www.luxmanual.com>

<http://aubethermostatmanual.com>

Golf course search by state

<http://golfingnear.com>

Email search by domain

<http://emailbydomain.com>

Auto manuals search

<http://auto.somanuals.com>

TV manuals search

<http://tv.somanuals.com>