

REMINGTON®

TitaniumPRO
Shaving System



***Use and
Care Guide***

MS-700

IMPORTANT SAFETY INSTRUCTIONS

When using an electrical appliance, basic precautions should always be observed, including the following.

READ ALL INSTRUCTIONS BEFORE USING.

DANGER

To reduce the risk of electric shock:

- Do not reach for an appliance that has fallen into water. Unplug it immediately.
- Do not place or store this appliance where it can fall or be pulled into a tub or sink while it is plugged in.
- Except when charging, always unplug this appliance from the
- Electrical outlet immediately after using.
- Unplug this appliance before cleaning it.
- Use only when the shaver is in dry condition.
- Detach the appliance from the power supply cord before cleaning.
- Do not submerge shaver in water.

WARNING

To reduce the risk of burns, fire, electric shock or injury to persons:

- This appliance is for household use only.
- An appliance should never be left unattended when it's plugged in, except when charging a rechargeable appliance.
- Close supervision is necessary when this appliance is used by, on, or near children or invalids.
- Use this appliance only for its intended use as is described in this manual. Do not use attachments not recommended by manufacturer.
- Keep the cord away from heated surfaces.
- Never operate this appliance if it has a damaged cord or plug, if it is not working properly, if it has been dropped or damaged, or if it has been dropped into water.
- Never drop or insert any object into any of the appliance's openings.
- Do not use outdoors or operate where aerosol (spray) products are being used, or where oxygen is being administered.

- Always store this appliance and cord in a moisture-free area. Do not store it in temperatures exceeding 140°F (60°C).
- Do not plug or unplug this appliance when your hands are wet.
- Do not wrap the cord around the appliance.
- Do not use an extension cord or a voltage converter with this appliance.
- Always attach the plug to the appliance, then to the outlet. To disconnect, turn all controls to OFF, then remove plug from outlet. Detach removable power cords from appliances for storage.
- Do not use this appliance with a damaged or broken head or cutters, as facial injury may occur.
- Shavers, including the trimmer, are for use on facial hair only. Should not be used for shaving the hair on your head or any other part of your body.
- The power unit is intended to be correctly oriented in a vertical or floor mount position.

SAVE THESE INSTRUCTIONS

Contents

English	1
Spanish	17
French	33

Product Features

Shaver Parts

- (A) Screen & cutter assembly
- (B) 3-position trimmer
- (C) Trimmer push tab
- (D) On/off button
- (E) Head release button
(one on each side)
- (F) Charging/Low Battery LED
- (G) Headguard
- (H) Cleaning brush
- (I) Storage pouch
- (J) Charger

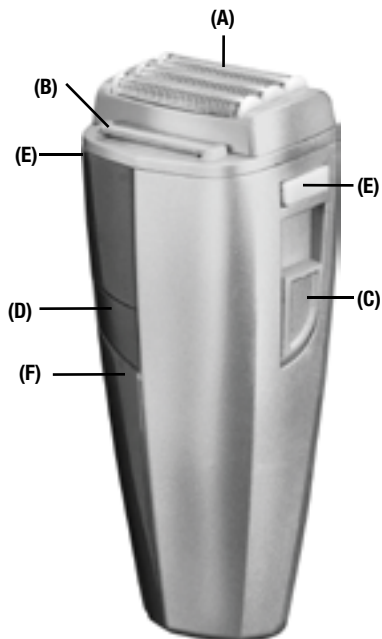

(G)



(I)



(H)



(J)

TitaniumPRO Shaving System

Congratulations on your purchase of a premium Remington® TitaniumPRO Shaving System with Revolutionary Titanium Shaving Technology.

	Power system	Washable	Run Time
MS700	Cordless only	X	60 min

Power System

- **Cordless** shavers can only be used without the cord.

Indicator Lights

Charging

The charging indicator is a green light that glows when the shaver is charging or fully charged.

Low-charge

The low-charge indicator is a red light that glows when the shaver needs recharging. You have approximately 5 minutes of shaving time left when the red indicator first comes on.

How To Use

To Charge Your Shaver

Prior to using your shaver for the first time, put it on charge for 24 hours.

- Use only the charging adapter supplied with the shaver.
- Make sure your shaver is turned off.
- Connect the cord to the shaver, then plug the charging adapter into the electrical outlet. A charging indicator light will come on.
- Your shaver cannot be overcharged, so you can leave it plugged in and charging between shaves.
- To preserve the life of the batteries, let them fully run out every six months, then recharge them for a full 24 hours.
- The MS-700 is designed for cordless operation only. Plugging in the cord will not power the shaver.

Removing the Headguard

Before operating your shaver, remove the headguard, which protects the screen and cutter assembly. Simply push up from the front or the back until it pops off.

CAUTION: Always keep the protective headguard on the shaver head and keep the trimmer in the OFF position when the shaver is not in use.

Operating the Trimmer

Your shaver is equipped with a 3-position trimmer. Use the trimmer button to extend or retract the trimmer.



1. Completely retracted (down), the trimmer is out of the way and off, for when you want to use the screens alone. Slide the trimmer button down with your thumb to get it into this position.
2. In the middle position, the trimmer works with the screens, cutting the longer, hard-to-shave hairs so the screens can get in extra close. Slide the trimmer button into the position level with the foils.
3. Fully extended (up), the trimmer can be used to trim your sideburns and mustache. Slide the trimmer into the top position, above the foils.

Usage Tips

Adjusting to your new shaver

As with every shaver, your shave will improve over time. Allow about three weeks to develop an effective shaving style and for your beard to adjust to the new shaver. The adaptation period may take a little longer if your skin is sensitive, or if you alternate between shaving methods.

To help smooth the transition to your new shaver, Remington has applied a special lubricant to the shaver's screens and cutters. The lubricant looks like fine, white or gray powder, and disappears with use.

Before you begin

- Wait at least 15 minutes after getting up before shaving, to ensure your face is free of puffiness that may be present from sleeping.
- Make sure your face is clean and dry before starting.
- Always use a clean, dry shaver.

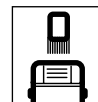
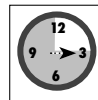

To shave

Push the ON/OFF button. Hold the shaver so all screens touch your face at the same time. This allows the shaver to work the way it was designed for the closest shave and minimum wear. Avoid holding the shaver at an angle so only one screen touches the skin at a time. This will distort the screen and could cause skin irritation.



Shave with short, circular strokes. Use your free hand to stretch your skin. This encourages your whiskers to stand out, making it easier for them to enter the cutting chamber.



Never press hard. Pressing only flattens your whiskers, making it harder for them to enter the cutting chamber. It will also wear out the cutting surface more quickly.



User Maintenance

The hand-held unit shall be detached from the power supply cord before cleaning. The shaver shall not be used until it has dried.

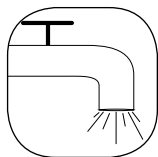

The shaver is a washable shaver, the hand-held part of which may be cleaned under water.

Replacing Cutters and Screens

To prevent inadvertent damage to the cutters and screens, do not attempt to remove them from the head assembly unless you are replacing them. Removal instructions are included with the cutter and screen replacement packages.

To replace a cutter assembly that is removed unintentionally:

1. Hold the cutter in the middle. The blades will not cut your fingers, so no special handling techniques are necessary.
2. Align the cutter so the bar on the bottom meets the opening in the clip.
3. Press down on the center of the cutter until it snaps into place. Do not push down on the ends of the cutter, as you may bend the cutter, reducing its ability to cut cleanly.

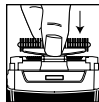

4. Do not separate the cutter's blades from the plastic pieces they are attached to, as this may damage the assembly.

When is it time to replace your screens and cutters?

Because they are subject to daily use, the cutters and screens of your shaver will wear and eventually require replacement to maintain a close, comfortable shave. It is very important to replace your screens and cutters when necessary to ensure a close, comfortable shave without irritation.

Depending on your shaving technique and habits, the screens will usually last 6 months; the cutters, 12 months. If you are replacing the cutters, it's a good idea to replace the screens at the same time.

Here are some signs that your screens and cutters need replacing:

Irritation: As screens get worn, you may notice that your skin feels more sensitive after a shave, particularly when you apply aftershave.

Pulling: As cutters wear, your shave may not feel as close and you may feel your shaver is pulling at your whiskers.

Wear-through: You may notice that the cutters have worn through the screens.

The replacement part for this shaver is model SP-100 (screens) and SP-101 (screens and cutters).

U.S. residents:

To order shaver accessories call 800-231-8793, visit www.remington-products.com, or visit your local retailer.

Canadian residents:

To order shaver accessories, please call 800-268-0425 or visit www.remington-products.com

Cleaning your shaver:

TO ASSURE SMOOTH, EFFICIENT PERFORMANCE, IT IS IMPORTANT TO CLEAN YOUR SHAVER. Cleaning your shaver is easy.

- After each shave, remove the shaver head by squeezing on both release buttons and pulling up from the body of the shaver. Blow out the stubble thoroughly.

Important: Never clean the foil with the enclosed brush because damage may occur to the holes in the foil.

- At least once a week, the cutters and the trimmer should be cleaned with the cleaning brush.

Attention: Never put the shaver completely into water. Do not use an aggressive cleansing agent as this may destroy the shaver coatings.

- Daily cleaning of the cutting system is recommended to ensure optimum shaving performance. To clean and lubricate your shaver's cutters and head assembly,

apply Remington® Shaver Saver® Lubricant (SP-4). The lubricant helps remove hair clippings while reducing wear. A quick spray after each shave keeps your shaver operating at peak performance.

Caution: Do not remove or replace the head assembly while shaver is running as it may cause damage to the unit's foils or cutters.

- Worn or damaged parts should be replaced with Remington® replacement parts only.

Trimmer Care

The trimmer on your shaver is easy to maintain.

- To clean the trimmer, you must first turn the shaver off, and extend the trimmer to its maximum height (trimmer setting #3). Then, just brush off any clippings that may accumulate around the trimmer assembly. Using the supplied brush will enable you to get into the area between the trimmer and the shaver.
- Every six months, lubricate the trimmer by applying a drop of light machine oil one-third and two-thirds of the way along the blade. Using your finger tip, spread the oil along the teeth, and run the trimmer for a few seconds.

Disposal

Battery Removal

When your rechargeable shaver reaches the end of its useful life, the batteries must be removed from the shaver and be recycled or disposed of properly in accordance with your state and local requirements. If this is not required by law, you may elect to dispose of the shaver without removing the batteries.

THE FOLLOWING PROCEDURE SHOULD BE FOLLOWED FOR BATTERY REMOVAL:

CAUTION: Make sure shaver is unplugged before you begin, to avoid a possible electric shock hazard.

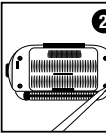
1. Press the two side buttons and pull off the shaver head assembly. 
2. Remove the 2 outer screws from inside the shaver head. Loosen the top assembly from the body. 
3. Pry off the back cover of the shaver, starting at the gap below the shaver socket.
4. Remove screws holding circuit board in place. Remove circuit board.

5. Pry both of the batteries loose from the foam adhesive tape on the PCB. 
6. Cut or break the wires connecting the batteries to the PC board.

CAUTION: DO NOT PUT IN FIRE OR MUTILATE YOUR BATTERIES WHEN DISPOSING AS THEY MAY BURST OR RELEASE TOXIC MATERIALS. DO NOT SHORT CIRCUIT AS IT MAY CAUSE BURNS. DISPOSE PROPERLY IN ACCORDANCE WITH YOUR LOCAL AND STATE REQUIREMENTS.

Performance Guarantee

Full Two-Year Warranty

Spectrum Brands, Inc. is a global consumer products company with a diverse portfolio of world-class brands, including Remington - branded electric shavers. Spectrum Brands, Inc. warrants this product against any defects that are due to faulty material or workmanship for a two-year period from the original date of consumer purchase. This warranty does not include damage to the product resulting from accident or misuse.

If the product should become defective within the warranty period, we will repair it or elect to replace it free of charge. Return your product and sales receipt with your name, address and day time phone number to: Spectrum Brands, Inc., Attention: Consumer Services, 601 Rayovac Drive, Madison, WI 53711. For more information call 800-736-4648 in the US or 800-268-0425 in Canada.

KEEP ORIGINAL SALES RECEIPT AS PROOF OF PURCHASE FOR WARRANTY PURPOSES.

This warranty does not cover products damaged by the following:

- Accident, misuse, abuse or alteration of the product
- Servicing by unauthorized persons
- Use with unauthorized accessories
- Connecting it to incorrect current and voltage
- Any other conditions beyond our control

No responsibility, obligation, or liability is assumed for the installation or maintenance of this product.

SPECTRUM BRANDS, INC. SHALL NOT BE RESPONSIBLE FOR ANY INCIDENTAL, SPECIAL OR CONSEQUENTIAL DAMAGES RESULTING FROM THE USE OF THIS PRODUCT. ALL IMPLIED WARRANTIES, INCLUDING BUT NOT LIMITED TO IMPLIED WARRANTIES OF FITNESS AND MERCHANTABILITY, ARE LIMITED IN DURATION TO TWO YEARS FROM DATE OF ORIGINAL PURCHASE.

This warranty gives you specific legal rights and you may also have other rights which vary from state to state or province to province. Some states do not allow the exclusion or limitation of incidental, special or consequential damages.

Free Manuals Download Website

<http://myh66.com>

<http://usermanuals.us>

<http://www.somanuals.com>

<http://www.4manuals.cc>

<http://www.manual-lib.com>

<http://www.404manual.com>

<http://www.luxmanual.com>

<http://aubethermostatmanual.com>

Golf course search by state

<http://golfingnear.com>

Email search by domain

<http://emailbydomain.com>

Auto manuals search

<http://auto.somanuals.com>

TV manuals search

<http://tv.somanuals.com>