

Owner's Manual

Model RSL1

RSL2

RSL2C

SupraLite™

Vacuum Cleaner

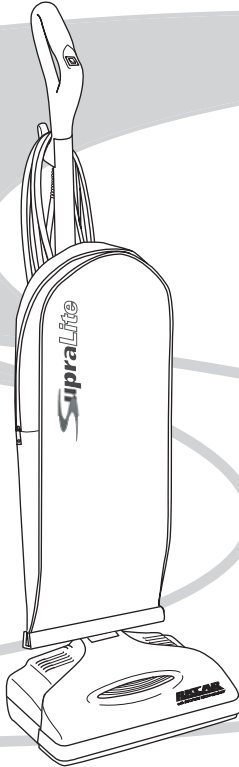

RICCAR
America

Thank you for purchasing our product. To ensure you get the best results from your SupraLite vacuum cleaner, please read this manual first. This manual should be kept for future reference.

**To locate your nearest Authorized Riccar Dealer for sales or service,
please visit our website at www.riccar.com
or call 877-302-4746**

KEY REPLACEMENT PARTS

Genuine Supralite Vacuum Filter Bags: **RSL-6**

Genuine Supralite Vacuum Agitator Belt: **B014-0814**

TABLE OF CONTENTS

Getting Started:

- Safety instructions 2
- Wire and grounding instructions 3
- Assembling the vacuum cleaner 4-5

Vacuum Features:

- On/off switch 6
- Edge cleaning 6
- Automatic carpet height adjustment 6

How To:

- Change the vacuum bag 7
- Remove/install the bottom plate 8
- Change the belt 9
- Replace the headlight bulb 10
- Reset the circuit breaker 11

For Best Performance 12

Warranty. 13

IMPORTANT SAFETY INSTRUCTIONS

READ ALL INSTRUCTIONS BEFORE USING THIS APPLIANCE

When using an electrical appliance, basic precautions should always be followed.

WARNING — To reduce the risk of fire, electric shock or injury:

1. Do not leave appliance when plugged in. Unplug from outlet when not in use and before servicing.
2. **WARNING: ELECTRIC SHOCK COULD OCCUR IF USED OUTDOORS OR ON WET SURFACES.**
3. Do not allow to be used as a toy. Close attention is necessary when used by or near children.
4. Use only as described in this manual. Use only manufacturer's recommended parts.
5. Do not use with damaged cord or plug. If appliance is not working as it should, has been dropped, damaged, left outdoors, or dropped into water, return it to your Authorized Vacuum Dealer.
6. Do not pull or carry by cord, use cord as a handle, close a door on cord, or pull cord around sharp edges or corners. Do not run appliance over cord. Keep cord away from heated surfaces.
7. Do not unplug by pulling on cord. To unplug, grasp the plug, not the cord.
8. Do not handle plug or appliance with wet hands.
9. Do not put any object into openings. Do not use with any opening blocked; keep free of dust, lint, hair and anything that may reduce air flow.
10. Keep hair, loose clothing, fingers and all parts of body away from openings and moving parts.
11. Do not pick up anything that is burning or smoking, such as cigarettes, matches or hot ashes.
12. Do not use without dust bag and/or filters in place.
13. Turn off all controls before unplugging.
14. Use extra care when cleaning on stairs.
15. Do not use to pick up flammable or combustible liquids such as gasoline or use in areas where they may be present.
16. Do not attempt to service the unit while appliance is plugged in.
17. Do not vacuum up water or any other liquid.
18. For grounded models: connect to a properly grounded outlet only. See Grounding Instructions.

SAVE THESE INSTRUCTIONS

POLARIZATION INSTRUCTIONS – HOUSEHOLD MODELS

Models RSL1 and RSL2

To reduce the risk of electric shock, this appliance is equipped with a polarized alternating current line plug (a plug having one blade wider than the other). This plug will fit into the power outlet only one way. This is a safety feature. If you are unable to insert the plug fully into the outlet, try reversing the plug. If the plug should still fail to fit, contact a qualified electrician to replace the obsolete outlet. Do not defeat the safety purpose of the polarized plug.

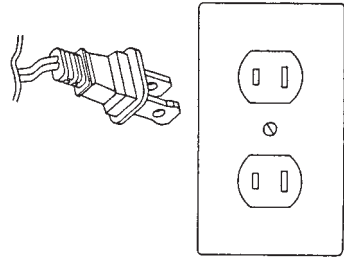

GROUNDING INSTRUCTIONS – COMMERCIAL MODELS

Model RSL2C

This appliance must be grounded. If it should malfunction or break down, grounding provides a path of least resistance for electric current to reduce the risk of electric shock. This appliance is equipped with a cord having an equipment-grounding conductor and grounding plug. The plug must be plugged into an appropriate outlet that is properly installed and grounded in accordance with all local codes and ordinances.

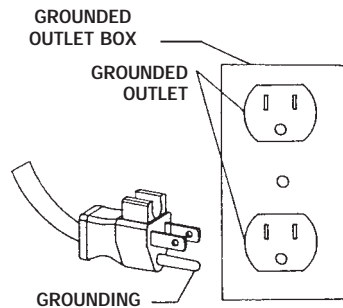

This appliance is for use on a nominal 120-volt circuit and has a grounding attachment plug that looks like the illustration above. Make sure that the appliance is connected to an outlet having the same configuration as the plug. No adapter should be used with this appliance.

WARNING: Improper connection of the equipment-grounding conductor can result in a risk of electric shock. Check with a qualified electrician or service person if you are in doubt as to whether the outlet is properly grounded. Do not modify the plug provided with the appliance. If it will not fit the outlet, have a proper outlet installed by a qualified electrician.

ASSEMBLING THE VACUUM

IMPORTANT NOTE: Under no circumstances should you plug in the vacuum cleaner prior to complete assembly.



The vacuum cleaner handle is packed as a separate component that requires assembly.

VACUUM ASSEMBLY PROCEDURE

Installing the handle:

1. Release the handle bracket from the handle tube by removing the two screws (diagram 1).
2. Place handle onto the handle tube, aligning holes with pegs (diagram 2).

ASSEMBLING THE VACUUM

3. Place the handle bracket back into position (diagram 3).
4. Secure with two screws removed in step 1.

Positioning the power cord:
(Models RSL1 only.)

1. Loosen, but do not remove, the screw holding the upper cord hook (diagram 4).
2. Position the cord between the cord hook and the vacuum tube (diagram 5). Re-tighten the screw.
3. Once the cord is secured by the cord hook, proceed with wrapping the cord.



ON / OFF SWITCH

6



6A



NOTE: Your vacuum cleaner will either have the on/off button on the base of the unit (see diagram 6) or on the vacuum handle (see diagram 6A). Please note the type of vacuum cleaner you are using when starting or stopping the machine.

On/Off switch on base: Locate the switch on the back side of the nozzle to the left of the handle tube. Simply press the switch with your foot to turn the machine on or off.

On/Off switch on handle: Locate the switch on the top of the vacuum handle. Using your thumb, push the switch forward to turn the machine on and pull the switch backward to turn the machine off.

Always turn the vacuum cleaner off before unplugging it from the electrical outlet.

EDGE CLEANER

The edge cleaning feature provides improved cleaning of carpets near walls and stationary furniture. For maximum edge cleaning, place the left side of the nozzle against the wall or stationary furniture.

AUTOMATIC CARPET HEIGHT ADJUSTMENT

Your upright vacuum cleaner is designed with an automatic, self-adjusting rug nozzle. No manual adjustments are required. The height of the nozzle is instantly and automatically adjusted to the carpet pile height. This self-adjusting feature allows the rug nozzle to float evenly over all carpet pile surfaces.

HOW TO CHANGE THE VACUUM BAG

1. Unzip outer cloth bag (diagram 7).
2. Remove used bag by pressing the bag holder tab and pulling bag off vacuum (diagram 8). Discard used bag.
3. To install new bag, position the bottom of the bag collar into the bag collar holder (diagram 9).
4. Push the top of the bag collar inward until the collar "snaps" into place (diagram 10).
4. Zip the outer cloth bag closed.

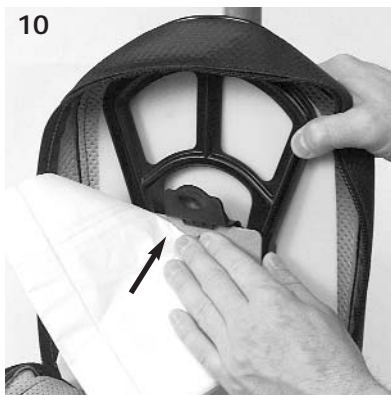
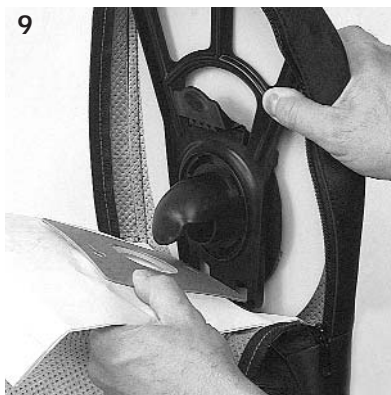

HOW TO REMOVE / INSTALL THE BOTTOM PLATE

11



CAUTION: First, disconnect the vacuum cleaner from the electrical outlet.

To remove bottom plate:

1. After unplugging the power cord, turn the vacuum cleaner over, exposing the underside.
2. Press the two holding tabs inward (diagram 11) releasing the bottom plate. Remove the bottom plate.

12



To install bottom plate:

1. Install bottom plate, making sure bottom plate hinges are in place before setting the plate (diagram 12).
2. Press plate into position until the plate "clicks" on both sides.

HOW TO CHANGE THE BELT

CAUTION: First, disconnect the vacuum cleaner from the electrical outlet.

1. Turn the unit over and remove the bottom plate (see "How to Remove Bottom Plate").
2. Remove the brush roll and the worn or broken belt from the brush roll pulley and the motor drive shaft (diagram 13).
3. Loop the new belt around the motor drive shaft and the brush roll (diagram 14).
4. Reinstall the brush roll back into the housing. Turn the brush roll by hand, making sure the belt is not twisted and all rotating parts move smoothly (diagram 15).
5. Reinstall the bottom plate (see "How to Install Bottom Plate").

NOTE: To ensure maximum cleaning efficiency, the belt should be checked regularly to be sure it is in good condition. Check to see if the belt is stretched, cracked, or if excessive slipping has occurred. Replace if needed.

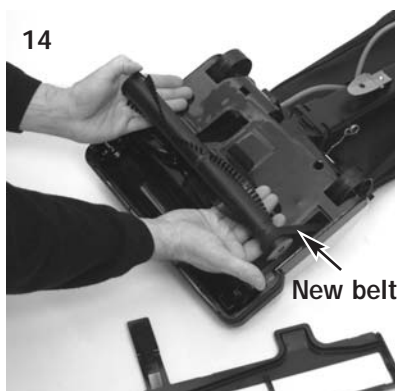

HOW TO REPLACE THE HEADLIGHT BULB

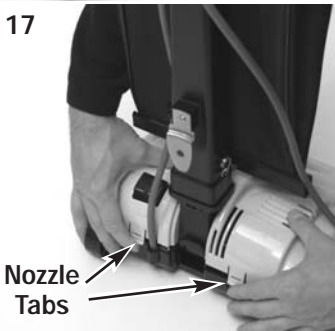
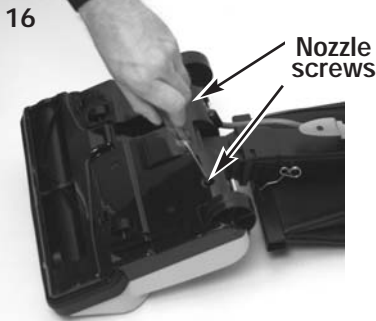

WARNING: To reduce the risk of electric shock and injury from moving parts, unplug vacuum before cleaning or servicing.

1. First remove the nozzle housing. Turn the unit over to expose the underside. Locate the two main nozzle screws (diagram 16) and remove both. Turn the unit right side up. Locate the two nozzle tabs on the back of the unit (diagram 17) and unlatch the nozzle housing. (Note: It is easier to remove the nozzle when the vacuum is lying flat on its back - see diagram 19). Lift the nozzle housing off the unit to expose the light bulb.
2. Remove bulb by pulling it straight out of the light socket (diagram 18).
3. To install new bulb, simply reinsert the bulb into the light socket.
4. Place nozzle housing back onto unit with the front side of the nozzle set into place first (diagram 19) then set the nozzle downward until nozzle "clicks" into place on both sides. Turn unit over and reinsert main nozzle screws.

HOW TO RESET THE CIRCUIT BREAKER

Your vacuum features a circuit breaker to protect the machine against damage due to a surge in the electrical current. Electrical surging can be a result of, though not limited to, a jammed brush roll (i.e. vacuuming up a sock or throw rug) or a jammed motor fan.

Should your vacuum cleaner experience a jammed brush roll with the circuit breaker tripping, first press the on/off button to the off position and unplug the unit. Inspect the brush roll by removing the bottom plate (see "How to Remove Bottom Plate") and remove any debris which may be causing the jam. Reinstall the bottom plate (see "How to Install Bottom Plate"), reset the circuit breaker (diagram 20), plug in power cord, and turn unit on. If the unit fails to turn on, return it to an authorized service center for service.

20

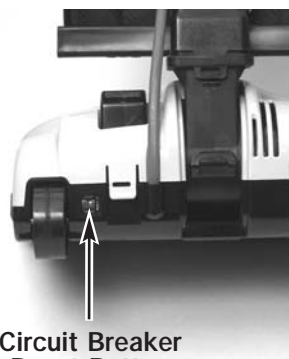

**Circuit Breaker
Reset Button**

FOR BEST PERFORMANCE

- Keep machine clean and in good operating condition.
- Change filter bags as recommended to maximize optimal cleaning efficiency.
- Always use genuine filter bags and replacement parts. Use of other products may result in poor cleaning performance and potential vacuum cleaner damage and may void vacuum warranty. Genuine filtration products are designed for maximum cleaning performance.
- Have machine checked periodically by your Authorized Dealer.
- Use only authorized service centers for parts or service.
- Store machine carefully in dry area.
- For optimum cleaning performance and safety, study and follow your owner's manual.

RICCAR VACUUM CLEANER LIMITED WARRANTY

Riccar's Limited Warranty



2-year limited HOUSEHOLD warranty – 1-year limited COMMERCIAL warranty

Riccar America will repair or exchange parts for your Riccar vacuum cleaner in the event of a manufacturing defect as follows:

PARTS:

HOUSEHOLD USE: New or comparable rebuilt parts are warranted for two years (fan for one year) after original purchase.

COMMERCIAL USE: New or comparable rebuilt parts are warranted for one year (fan for six months) after original purchase.

The following items that require normal replacement are excluded: disposable dust bags, belts, light bulbs, and agitator brushes.

LABOR:

Carry-in service can be obtained during the warranty period by taking your vacuum cleaner to an Authorized Riccar Warranty Service Center.

IMPORTANT WARRANTY CONDITIONS:

The warranty registration should be completed on the Riccar website (www.riccar.com) or the attached card must be filled out and returned to Riccar within

30 days of purchase in order to register warranty coverage. A purchase receipt or other proof of date of original consumer purchase also will be required before warranty service is rendered.

This warranty covers normal consumer use and does not cover damage which occurs in shipment or failure resulting from alteration, accident, misuse, abuse, neglect, or improper maintenance. 90-day warranty for commercial use.

STATEMENT: This warranty is not transferable and extends only to the original purchaser when a new Riccar Vacuum Cleaner is purchased from an Authorized Riccar Dealer. This warranty gives you specific legal rights, and you may have other rights that vary from state to state.

If a problem develops during or after the warranty period, first contact your Authorized Riccar Dealer or Service Center. If the problem is not handled to your satisfaction, write to: Riccar Consumer Affairs Division, 1800 E. Walnut Ave., Fullerton, CA 92831-4844

www.riccar.com

Free Manuals Download Website

<http://myh66.com>

<http://usermanuals.us>

<http://www.somanuals.com>

<http://www.4manuals.cc>

<http://www.manual-lib.com>

<http://www.404manual.com>

<http://www.luxmanual.com>

<http://aubethermostatmanual.com>

Golf course search by state

<http://golfingnear.com>

Email search by domain

<http://emailbydomain.com>

Auto manuals search

<http://auto.somanuals.com>

TV manuals search

<http://tv.somanuals.com>