

ROBERTS

R9941

FM Stereo/MW
Personal Radio



Operating Instructions

Download from [Www.Somanuals.com](http://www.Somanuals.com). All Manuals Search And Download.

Contents

<i>Contents</i>	1
<i>Controls</i>	2
<i>Battery</i>	3
<i>Aerials</i>	5
<i>Loudspeaker On/Off switch and earphones</i>	5
<i>Operating your radio - FM</i>	7
<i>Operating your radio - Medium wave</i>	9
<i>Belt clip and neck strap</i>	11
<i>General</i>	12
<i>Specification</i>	13
<i>Guarantee</i>	14

Controls

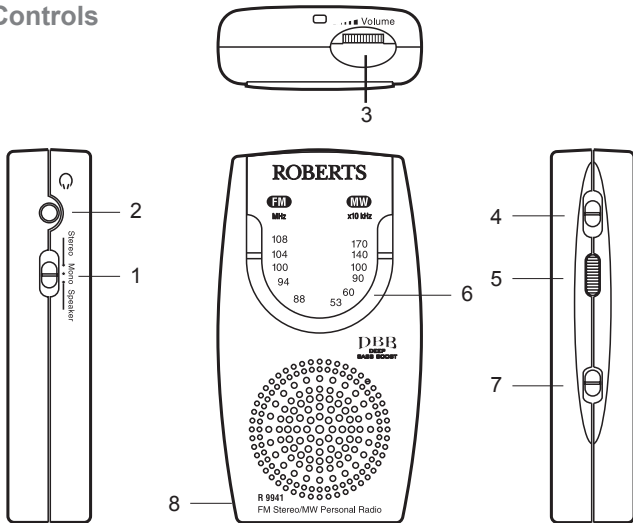

1. Stereo/Mono/Speaker switch
2. Earphone socket
3. Volume control
4. Waveband switch
5. Tuning control
6. Tuning scale
7. On/Off/DBB switch
8. Battery compartment (on rear)

Battery

1. Open the battery cover located on the rear of the your radio by sliding it in the direction shown by the arrow.
2. Insert one LR03 (AAA) size battery into the compartment. Ensure that battery is inserted in accordance with the diagram shown on the rear of your radio.
3. Close the battery cover
4. Reduced power, distortion and a 'stuttering' sound are all signs that the batteries may need replacing.
5. If the radio is not to be used for any extended period of time it is recommended that the battery is removed from the radio.

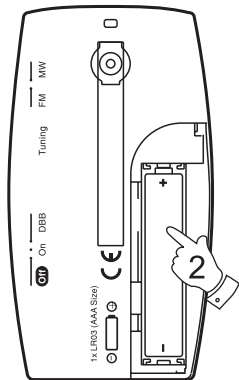
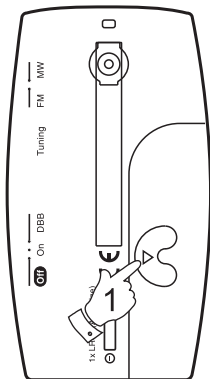

Aerials

The lead connecting earphones to your radio acts as an FM aerial when plugged into the earphone socket. The lead should be extended as much as possible to increase FM reception. There is a separate directional aerial built into the radio for AM reception. To achieve the best MW reception, it may be necessary to rotate the radio.

Loudspeaker On/Off switch & Earphones

Your radio may be operated using the built in loudspeaker or the earphones supplied.

1. The built in loudspeaker may be switched on by sliding the **Stereo/Mono/Speaker switch** to the 'Speaker' position.
2. When switched to FM and using the loudspeaker the enclosed pig tail aerial should be inserted into the earphone jack.
3. To operate your radio via earphones, plug the earphones into the earphone jack slide the **Stereo/Mono/Speaker** switch to the 'Stereo' position.

Note: Stereo is only available on FM and when using earphones.

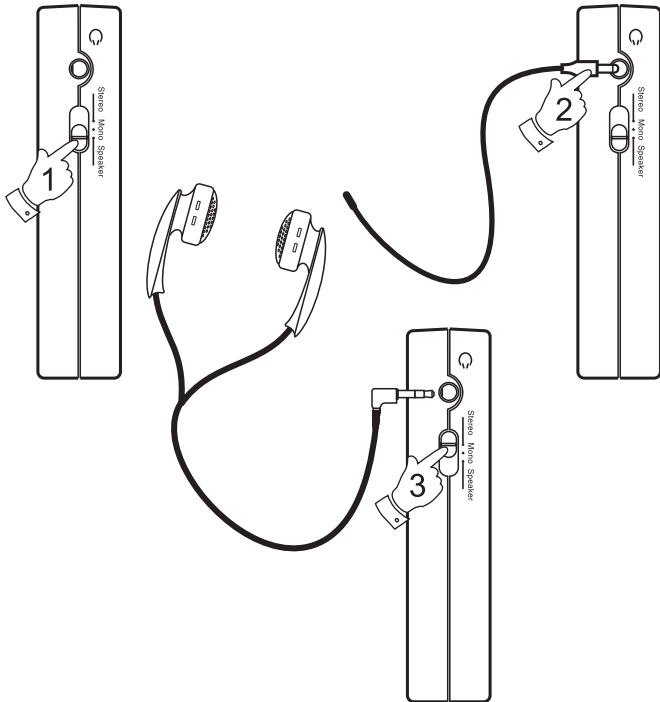

Operating your radio FM

1. Switch on your radio by sliding the **On/Off/DBB switch** to the 'On' position..
2. Slide the **Waveband switch** to the 'FM' position.
3. Adjust the **Volume control** until a sound is heard.
4. Rotate the **Tuning control** to select the desired station. On FM the **Tuning scale** is marked in Megahertz (MHz).
5. For FM reception fully extend the **Earphone lead** and position for best reception. When using the built in loudspeaker plug the **Pig tail aerial** into the headphone socket as described on page 5.
6. If the station being received is weak some hiss may be audible, to reduce the hiss slide the **Stereo/Mono/Speaker switch** to the 'Mono position'.

Note: FM stereo is only available when using earphone/headphones

7. To increase bass frequencies slide the **On/Off/DBB switch** to the 'DBB' position .
8. To switch off your radio slide the **On/Off/DBB switch** to the 'Off' position.

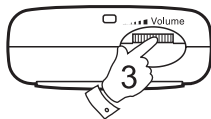
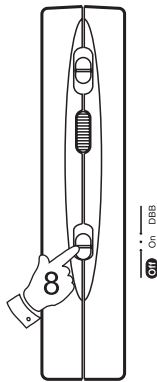
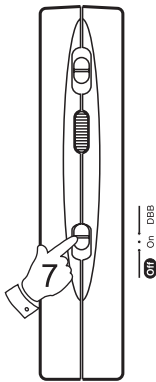
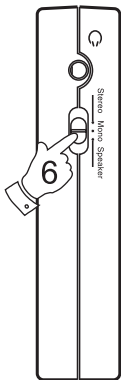
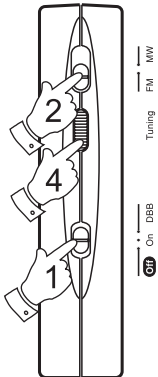

MW
FM
Tuning

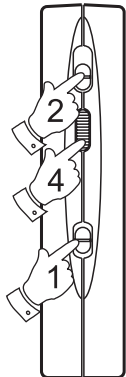

Off On DBB

Operating your radio MW

1. Switch on your radio by sliding the **On/Off/DBB switch** to the 'On' position..
2. Slide the **Waveband switch** to the 'MW' position.
3. Adjust the **Volume control** until a sound is heard.
4. Rotate the **Tuning control** to select the desired station. On FM the **Tuning scale** is marked in Kilohertz (kHz).
5. For MW operation rotate your radio for best reception.
6. To increase bass frequencies slide the **On/Off/DBB switch** to the 'DBB' position .
7. To switch off your radio slide the **On/Off/DBB switch** to the 'Off' position.

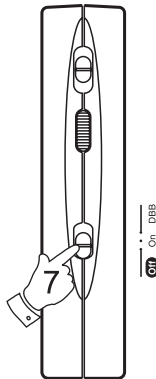
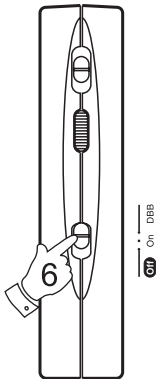
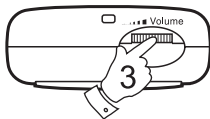
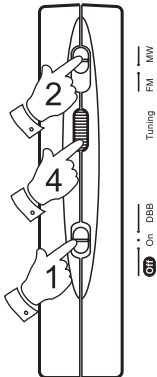

Belt clip and neck strap

1. A belt clip on the rear of your radio is provided to enable your radio to be clipped onto a belt
2. In addition to the belt clip a neck strap is also provided to enable your radio to be worn around your neck. Attach the neck strap by passing the small loop through the slot in cabinet top.
3. Pass the large loop through small loop to complete attachment of the neck strap.

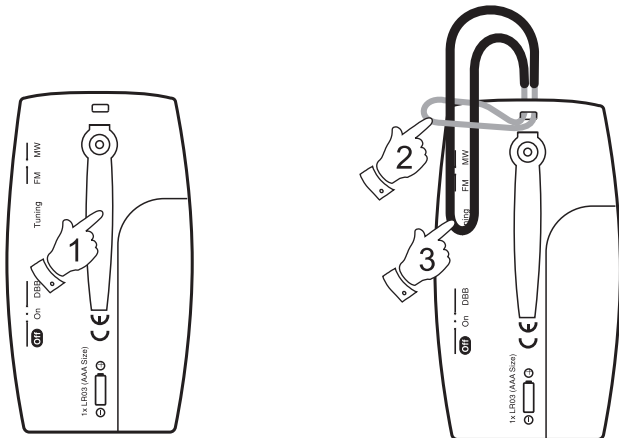

General

Do not allow this unit to be exposed to dripping or splashing. Do not leave your radio where excessive heat could cause damage such as in a parked car where the heat from the sun can build up even though the outside temperature may not seem too high. It is recommended that the FM band be used when ever possible as better results in terms of quality and freedom from interference will usually be obtained than on the MW band.



Specifications

Battery	1 x LR03 (AAA size)
Battery Life	Approx. 15hrs using alkaline battery
Frequency coverage	MW 530 - 1710kHz FM 87.5 - 108MHz
Semiconductors	3 Integrated circuits 1 FET
Output Power	2mW via earphones 40mW via loudspeaker
Earphone Jack	3.5mm dia (Stereo)

The company reserves the right to amend the specification without notice

Guarantee

This radio is guaranteed for twelve months from the date of delivery to the original owner against failure due to faulty workmanship or component breakdown, subject to the procedure stated below. Should any component or part fail during this guarantee period it will be repaired or replaced free of charge.

The guarantee does not cover:

1. Damage resulting from incorrect use.
2. Consequential damage.
3. Product with removed or defaced serial numbers.

Procedure: Any claim under this guarantee should be made through the dealer from whom the instrument was purchased. It is likely that your Roberts' dealer will be able to attend to any defect quickly and efficiently but should it be necessary the dealer will return the instrument to the company's service department for attention. In the event that it is not possible to return the instrument to the Roberts' dealer from whom it was purchased, please contact Roberts Radio Technical Services at the address shown on the rear of this manual before taking further action.

These statements do not affect the statutory rights of a consumer.

ROBERTS RADIO TECHNICAL SERVICES

97-99 WORTON ROAD
ISLEWORTH MIDDLESEX
TW7 6EG

Issue 1



Download from Www.Somanuals.com. All Manuals Search And Download.

Free Manuals Download Website

<http://myh66.com>

<http://usermanuals.us>

<http://www.somanuals.com>

<http://www.4manuals.cc>

<http://www.manual-lib.com>

<http://www.404manual.com>

<http://www.luxmanual.com>

<http://aubethermostatmanual.com>

Golf course search by state

<http://golfingnear.com>

Email search by domain

<http://emailbydomain.com>

Auto manuals search

<http://auto.somanuals.com>

TV manuals search

<http://tv.somanuals.com>