

Alkaline Battery Charger RGD-CT505

A) Brief Introduction

- ⊙ Welcome to join our environment protection project. Together, we can make a difference in reducing the volume of wasted batteries and helping our earth.
- ⊙ 『Alkaline Battery Charger』 is applicable to charge used **Alkaline / NiMH** batteries.
- ⊙ 『Alkaline Battery Charger』 has obtained the patent authorization in Taiwan, China, Japan, USA, Germany and Australia, with patent applications in other major markets in progress.
- ⊙ Please read through and follow the instructions before using the product. We offer one-year warranty under your normal use. Free repair service will be provided within the one year of warranty period.
- ⊙ Exceptional situations: the one-year warranty is **NOT** applicable to the following situations –
 - ✧ Mis-use of 『Alkaline Battery Charger』 : For example, the product is damaged by the leak of batteries chemical substances due to the use of the product to charge used batteries that are broken, damaged, rusted, or not active for a long period of time.
 - ✧ Damages to or malfunction of the product are caused by natural disasters, such as fire, earthquakes, typhoons or hurricanes, floods, lightening, abnormal voltage, and damages made by mice and insects, or storage in improper environment/surroundings.
 - ✧ Damages or malfunctioning is caused by the following situations, such as that the product is dropped, soaked, scratched after purchase.
 - ✧ Damages or malfunctioning is caused by the following situations, such as the product is disassembled, modified, maintained, or repaired by any unauthorized parties.

B) Functions and Features

- ⊙ Applicable to AA and AAA Alkaline / NiMH batteries (2700mAh max rated capacity of each battery that can be charged).
- ⊙ Individual charge circuit for each battery to be charged (Single Battery Charge is compatible), and it is able to charge up to Four Batteries at the same time.
- ⊙ Easy LED indicators.
- ⊙ Micro-processor chip controlled system to automatically detect charge process and temperature to prevent over charging.
- ⊙ Safety charging timer (4-hour automatic cut-off) .
- ⊙ Automatic cut-off system after charging completes.
- ⊙ Automatic cut-off system when batteries fall off.
- ⊙ Automatic cut-off system against overheat.
- ⊙ Fool-proof against misplacement of batteries in wrong poles.
- ⊙ Universal voltage range : AC100V-240V

How to Use

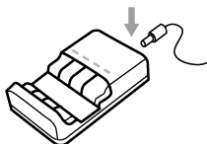

1. Plug adapter to wall outlet and insert tip to charger.

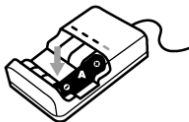

2. Insert the battery/batteries into the charging Channels, observing the correct polarity.

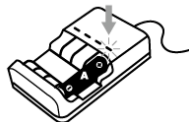

3. Charging complete: red, green LEDs flash alternately for 5 times before the LED light remains green

- ⊙ Plug in the adapter to the wall outlet(AC100V-240V).
- ⊙ Connect the adapter to the Alkaline Battery Charger, and the LED indicator will flash in red and green light once in turn.
- ⊙ Stow the batteries into the charger and connect them to the appropriate poles.
 - ✦ **Standby mode:** LED indicator shows steady green light which means this unit is ready.
 - ✦ Low voltage batteries below default setting or aged Batteries: LED indicator shows off
 - ✦ The LED indicator shows off or steady green when old or damaged batteries inserted to the charger. In this case the charger won't charge the damaged batteries, so please remove the batteries from the charger and dispose of at your nearest recycling point/center.
 - ✦ **New batteries and fully charged batteries:** LED indicator will flash in green light for five times and then enter the standby mode.
 - ✦ It is a normal phenomenon if the temperature of the batteries rises slightly during charging process.
- ⊙ LED Indicator Status: Red light, meaning it is in the charging mode.
 - ✦ **Charging time:** 4 hours
 - ✦ **Overheat warning indication:** charging circuit will cut off automatically. LED Indicator Status: Green and Red light flashes for 5 times by turns. The charger will return to charging mode only when its temperature is back to normal condition.
 - ✦ **Batteries fall off:** Charging circuit will cut off automatically. LED Indicator Status: Green light flashes once and goes off.
 - ✦ **Charging completes:** Charging circuit will cut off automatically. LED Indicator Status: Green and Red light flashes for five times by turns. Then the charger returns to the standby mode, the status of LED indicator is green.
 - ✦ The charged batteries are ready to be used.

D) The Definition of LED Indicator

- ⊙ **Power on** : LED indicator shows green light.
- ⊙ **Charging mode** : LED indicator shows red light.
- ⊙ **Charging completed mode** : LED indicator will flash Green and Rd light for five times by turns, then LED indicator status is green.
- ⊙ **New batteries and fully charged batteries** : LED indicator will flash in green light for five times and then enter the standby mode.
- ⊙ Low voltage batteries below default setting or aged Batteries : LED indicator shows off
- ⊙ The LED indicator shows off or steady green when old or damaged batteries inserted to the charger. In this case the charger won't charge the damaged batteries, so please remove the batteries from the charger and dispose of at your nearest recycling point/center.
- ⊙ Batteries fall off (insert incorrect) : LED light flashes one time and turns off.
- ⊙ **Overheat** : LED indicator Green and Red light flashes by turns.

E) Caution

- ⊙ Please read through and follow the instruction and caution.
- ⊙ Alkaline Battery Charger is applicable to charge used **Alkaline** and **NiMH** batteries
- ⊙ **DO NOT** charge used **Carbon-Zinc/NiCd** Batteries or **Old batteries** that are not in use for long time. This could result in overheat of batteries or leak of chemical substances and in turn damages to the charger. The one-year warranty is not applicable to the above situation.
- ⊙ It is recommended to use the charger with quality alkaline batteries which are newly produced and discharged. **DO NOT** charges the giveaway batteries of lower quality that usually comes along with electronic devices.
- ⊙ Alkaline battery doesn't have the memory function. So it's recommended for used alkaline batteries with a longer charging time than use time for a better effect.
- ⊙ It is recommended to charge used **NiMH** batteries twice consecutively (or around 8 hours) before use for a better effect.
- ⊙ **DO NOT** charge the deformed, damaged, rusted or leaked batteries with the charger.
- ⊙ Make sure the charger is in the standby mode before charging any used batteries to prevent insufficient charging time. Otherwise, the problem can be solved by turning on the power again.
- ⊙ Low voltage batteries below default setting or aged Batteries : LED indicator shows off or steady green when old or damaged batteries inserted to the charger. In this case the charger won't charge the damaged batteries, so please remove the batteries from the charger and dispose of at your nearest recycling point/center.
- ⊙ It's recommended to store used batteries in containers, to avoid mixing batteries altogether, and prevent contact between negative and positive poles of batteries.

- ⊙ The charger is applicable for charging indoors. Please keep it away from extreme temperatures and direct exposure to sunlight, rains and snows.
- ⊙ **DO NOT** smash the charger or place heavy objects on the charger.
- ⊙ **DO NOT** disassemble the charger for fear of a short circuit.
- ⊙ This appliance is not intended for use by persons (including children) with reduced physical, sensory or mental capabilities, or lack of experience and knowledge, unless they have been given supervision or instruction concerning use of the appliance by a person responsible for their safety.
- ⊙ Children should be supervised by an adult to ensure that they do not play with the appliance.
- ⊙ The color of product maybe differ from the picture of website, and it's subject to practical products.

F) Product Specification

Model No.	RGD-CT505
Input voltage	AC100-240V
Fuse Rating	T1A/250Vac
Output voltage	DC1.7V*4
Maximum output current	350mA*4
Dimension (L*W*H)	118*71*30 (mm)

Thank you for purchasing a quality Rosewill Product.

Please register your product at: www.rosewill.com for complete warranty information and future support for your product.

Free Manuals Download Website

<http://myh66.com>

<http://usermanuals.us>

<http://www.somanuals.com>

<http://www.4manuals.cc>

<http://www.manual-lib.com>

<http://www.404manual.com>

<http://www.luxmanual.com>

<http://aubethermostatmanual.com>

Golf course search by state

<http://golfingnear.com>

Email search by domain

<http://emailbydomain.com>

Auto manuals search

<http://auto.somanuals.com>

TV manuals search

<http://tv.somanuals.com>