

Rosewill[®]

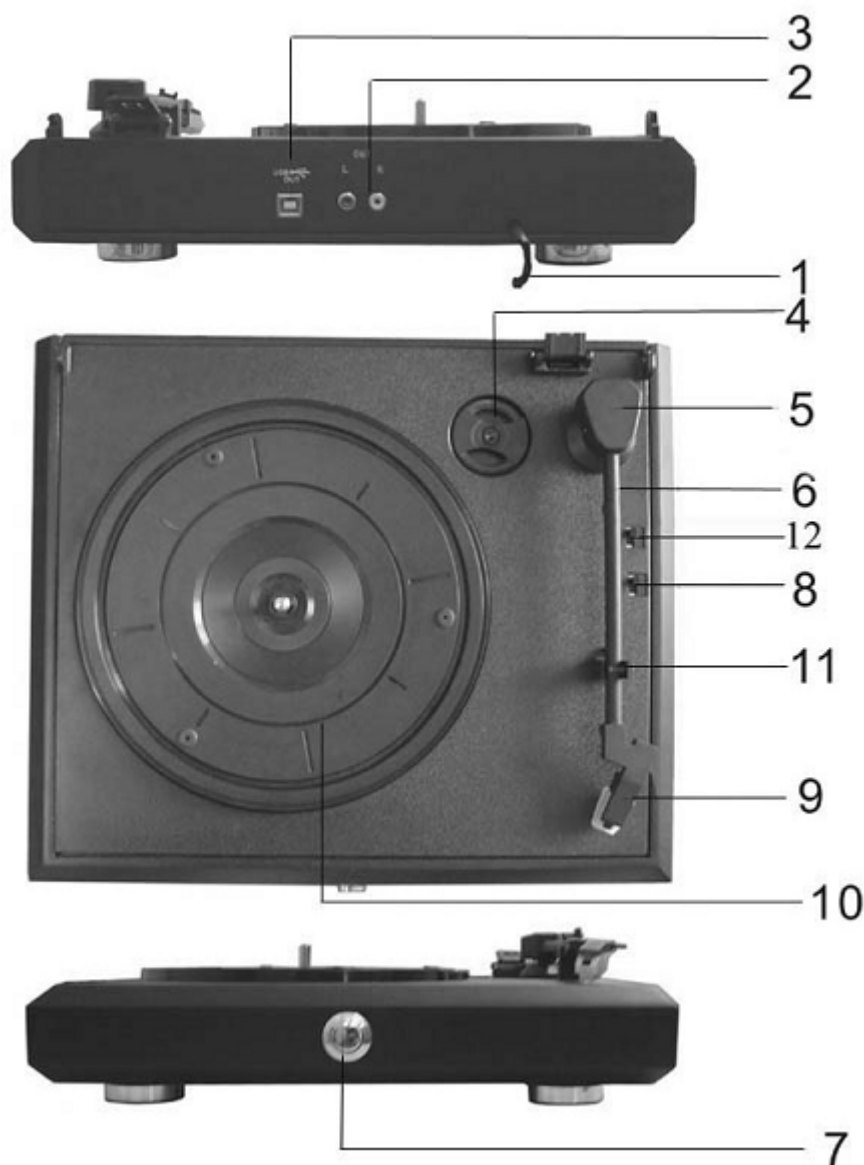

USB Turntable with built-in speaker RME-ULP01R User Manual

Thank you for purchasing a quality Rosewill Product.
Please register your product at : www.rosewill.com for
complete warranty information and future support for your product.



1. DC connection

Connect this DC adapter with AC outlet of the proper voltage.

2. Audio output

Connect this with the plugs to mixer or amplifier, red for R/H channel, white for L/H for channel.

3. USB slot

With full speed transceiver, fully compliant with USB1.1 specification.

4. Adapter

Use this adapter when playing 45RPM records.

5. Tonearm set

6. Tonearm

7. Power knob

8. Speed switch

Three speed for choice: 33.3, 45, 78 RPM.

9. Cartridge

10. Platter

11. Arm lock

To lock the tonearm with this device when the equipment is placed.

12. Auto-stop selector

INITIAL STARTING-UP

MAINS CONNECTION

Ensure that the mains voltage of your home corresponds to the operating voltage of the unit.

AMPLIFIER CONNECTION

Connect audio plugs to Alert input on your mixer or amplifier:

Red plug into R/H channel input.

White plug into L/H channel input.

Playing a record

- Remove dust cover from your turntable.
- Place the record of your choice on the turntable. If it is a 45 RPM, do not forget to place the adapter on the record spindle.
- Choose the desired playing speed using the Speed select switch between 33.3, 45 and 78RPM.
- Put down the power knob.
- Release the tonearm lock.
- Push in the arm with your hand lightly.
- Place the cartridge vertically over the first track of the record the turntable will start turning automatically.
- Put down the cartridge slowly to the record then the turntable will play.
- When records comes to the end, platter will stop automatically if the Auto-stop switch points to ON position.

When the switch locates to OFF it can help to read some long Recorded records.

NOTE:

- Lift up the tonearm and put it on the rest.
- Replace the protective cap on the stylus and close the tonearm lock.
- Turn off power at mains.

MAINTENANCE

REPLACING THE STYLUS

-Refer to the figures 1-8

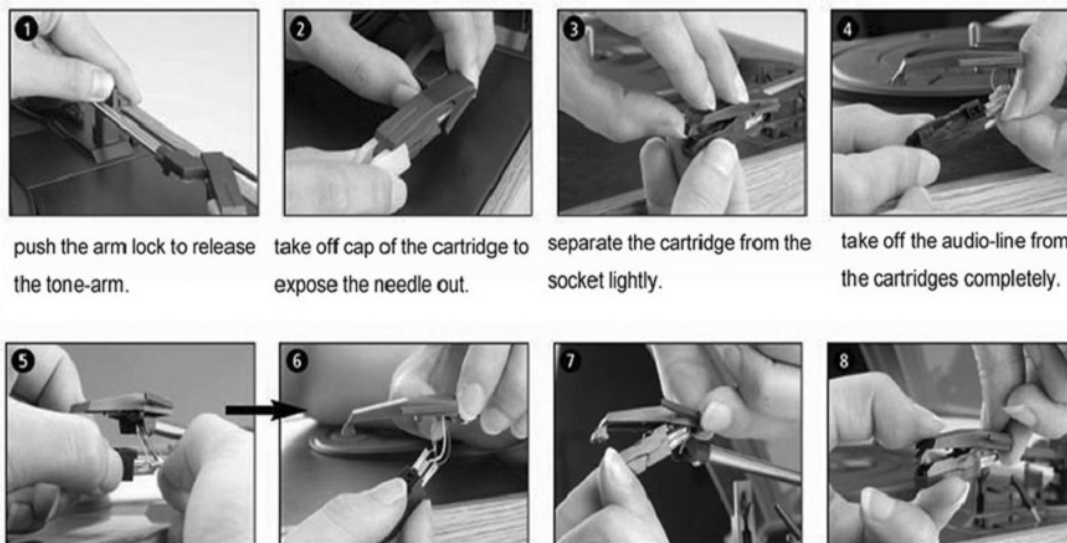

1 push the arm lock to release the tone-arm.

2 take off cap of the cartridge to expose the needle out.

3 separate the cartridge from the socket lightly.

4 take off the audio-line from the cartridges completely.

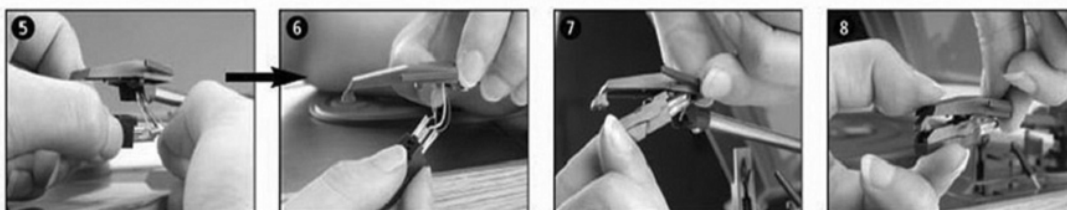

to fit a new one just in opposite deals. insert the audio-line accordingly, and install the cartridge to the socket lightly.

NOTE:

- Please exercise extreme care whilst performing this operation so as to avoid the tone arm and audio line wires from any damage.

INSTALLING A NEW CARTRIDGE

-Refer to the figures 5 & 6

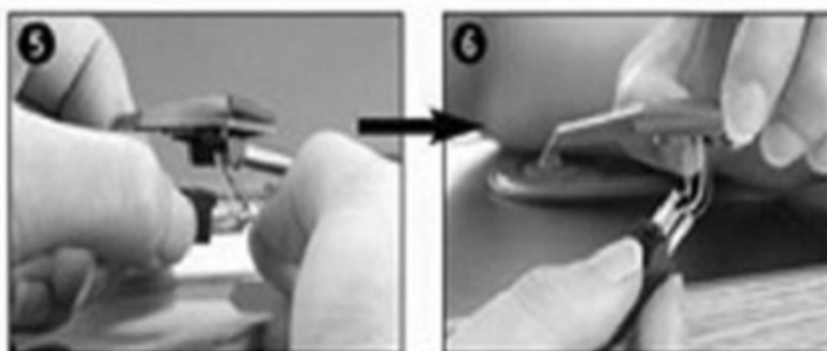

NOTES

We advise you to clean your records with an anti-static cloth to gain maximum enjoyment from them and to make them last.

We would also point out that for the same reason your stylus should be replaced periodically (approximately every 250 hours)

Dust the stylus from time to time using a very soft brush dipped in alcohol (brushing from back to front of the cartridge)

WHEN TRANSPORTING YOUR RECORD PLAYER DO NOT FORGET TO:

Replace the protective cap on the stylus.

Put the rest clip into the pick-up arm.

Free Manuals Download Website

<http://myh66.com>

<http://usermanuals.us>

<http://www.somanuals.com>

<http://www.4manuals.cc>

<http://www.manual-lib.com>

<http://www.404manual.com>

<http://www.luxmanual.com>

<http://aubethermostatmanual.com>

Golf course search by state

<http://golfingnear.com>

Email search by domain

<http://emailbydomain.com>

Auto manuals search

<http://auto.somanuals.com>

TV manuals search

<http://tv.somanuals.com>