

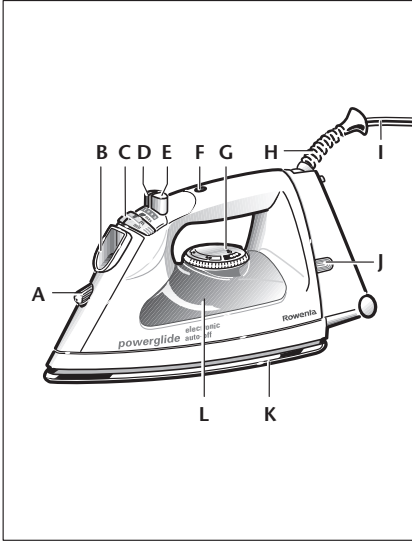

# Rowenta

## Powerglide

### Instructions for use

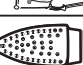

- Description
- A Spray nozzle
  - B Water filling inlet
  - C Variable steam control with Self clean (Depending on model)
  - D Spray button
  - E Burst of steam button
  - F Auto off indicator light (Depending on model)
  - G Temperature control dial
  - H Flexible cord protector
  - I Power cord
  - J Pilot light
  - K Stainless steel soleplate
  - L Transparent water tank

	30 sec.
	8 min.
	30 sec.

**3-way Auto-off**  
Auto off is not an on/off switch. Unplug the iron when it is not in use.



**1** (Depending on model.) If the iron is not moved while it is plugged in, an internal safety switch will turn it off. It will turn off in 8 minutes if left vertically or in 30 seconds if left on its soleplate or tipped over. A red flashing light indicates that the auto-off has been activated. To switch the iron on again, move the iron or gently shake it.

**Filling with water**  
**2** Slowly remove the protective label/cover from the soleplate. Holding the iron vertical, pour water into the water filling inlet, up to the "max." mark on the water tank. Plug the iron into the outlet.

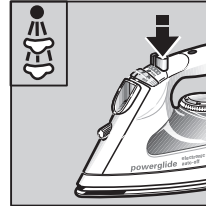

#### Burst of steam

**8** To remove stubborn wrinkles or press in a sharp crease, use the burst of steam button. Press the button firmly, a strong burst of steam penetrates deep into the fabric. Leave an interval of at least four seconds between pressing the burst of steam button. With water in the tank, the burst of steam button can be used as soon as the steam ironing temperature has been reached (●●●).



#### Vertical steaming

**9** (Depending on model.) Check packaging. This is especially useful for getting wrinkles out of hanging clothes, curtains etc.  
**Warning! Never iron clothes on the body or point your iron at anybody when steaming!**

### IMPORTANT SAFETY INSTRUCTIONS

When using your iron, basic safety precautions should always be followed, including the following:

Read all instructions before using the iron.

1. Use iron only for its intended use.
2. To protect against a risk of electric shock, **do not** immerse the iron in water or other liquids.
3. The iron should always be turned to Min. before plugging or unplugging from outlet. Never yank cord to disconnect from outlet, instead grasp plug and pull to disconnect.
4. Do not allow cord to touch hot surfaces. Let iron cool completely before putting away. Loop cord loosely around handle when storing.
5. Always disconnect iron from electrical outlet when filling iron with water or emptying and when not in use.
6. Do not operate iron with a damaged cord or if the iron has been dropped or damaged. To avoid the risk of electric shock, do not disassemble the iron. Ship it to the nearest Rowenta Appliance Service Center for examination and repair. Incorrect reassembly can cause a risk of electric shock when the iron is used.
7. Close supervision is necessary for any appliance being used by or near children. Do not leave iron unattended while connected or on an ironing board.
8. Burns can occur from touching hot metal parts, hot water or steam. Use caution when you turn a steam iron upside down – there may be hot water in the water tank.
9. The use of accessory attachments is not recommended by Rowenta and may result in fire, electric shock or personal injury.

### SPECIAL INSTRUCTIONS

1. This is a 1200 or 1400 watt appliance. To avoid a circuit overload, do not operate another high wattage appliance on the same circuit.
2. If an extension cord is absolutely necessary, a 12-ampere cord should be used. Cords rated for less amperage may overheat. Care should be taken to arrange the cord so that it can not be pulled or tripped over.
3. After the iron has cooled, wrap the cord loosely around the handle.
4. Your Rowenta appliance is intended for household use only.

### SAVE THESE INSTRUCTIONS

Download from [www.Somanuals.com](http://www.Somanuals.com). All Manuals Search And Download.

**Rowenta Inc.**  
196 Boston Avenue  
Medford, MA 02155 U.S.A.

Tel.: (781)396-0600  
[www.rowentausa.com](http://www.rowentausa.com)

#### OFFICE LOCATION ONLY.

If your appliance needs service, ship the product to your nearest regional service center. If in warranty, Rowenta will repair or replace the product at their discretion. If the product is out of warranty, you will be advised of the cost of repair before any work begins.

Our main service centers are listed below:

Turnpike Appliance  
3495A Lawson Blvd.  
Oceanside, NY 11572  
516-483-5596

Authorized Appliance  
1644 West Ogden Ave.  
Downers Grove, IL 60515  
630-852-1550

Service center information is subject to change. Please visit our website at [www.rowentausa.com](http://www.rowentausa.com) or call our **service center information line** at 781-306-4620. The information line provides current service center information and listings in California.

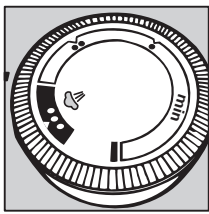

### Steam Ironing

**3** For steam ironing, turn the temperature control dial to the red setting (●●●). Delicate synthetics should be dry ironed.

- synthetics
- silk, wool
- cotton, linen (steam setting)

**4** The pilot light indicates that the iron is heating. When heated, the light will go off. It is normal for the indicator light to go on and off during use.

**5** Before using the iron for the first time or if the iron has not been used for a few weeks, allow it to steam for about 1 minute over an old towel or cloth.

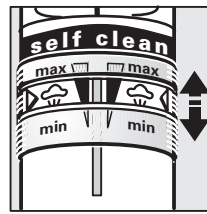

**6** Ensure that the iron is fully heated (light goes out) before using steam. Push the variable steam control to the desired steam setting. Temperature dial must be set to the ●●● setting for steam.

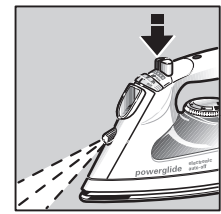

### Spray setting

**7** Ensure there is water in the tank. Moistening the fabric with the spray will make wrinkle removal easier. Press the spray button down slowly for a jet or quickly and strongly for a mist. Do not spray silk, etc.

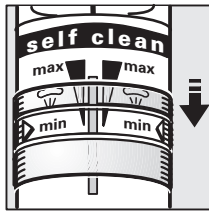

### Dry ironing

**10** Push the steam control to the minimum setting. When heated the temperature control light will go off. You may begin dry ironing

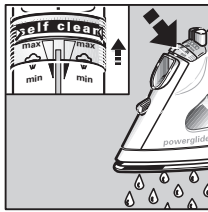

### Self Clean

**11** After ironing move the variable steam control from "min." to "max." several times. This ensures the Vapodur valve remains free of mineral build-up and the iron will continue to steam. See self cleaning section in instructions for additional cleaning feature.

### Cleaning the iron and soleplate

**12** When cold and unplugged, the iron can be cleaned with a damp cloth and wiped dry. Rowenta soleplates have excellent non-stick properties and can be simply wiped clean when cold. In normal use a draggy coating may build up on the soleplate (starch, detergent buildup, burnt synthetic fibers). This can be easily removed by using the Rowenta Soleplate Cleaning Kit or a quality hot iron soleplate cleaner available at most stores.

Do not use abrasive household cleaners or abrasive cleaning pads.

To prevent scratching of the soleplate, do not iron over sharp objects (zippers etc.). Do not place the iron on rough surfaces, e.g. metal iron support, which may scratch the soleplate.

## TROUBLESHOOTING

Problem	Possible cause	Solution
Iron is leaking.	DISTILLED WATER	DO NOT use 100% pure distilled water, use tap water. In very hard water areas mix half tap water with half distilled to reduce hardness; or use inexpensive bottled spring water.
	SOFTENED WATER	If you experience leaks or spitting, change to untreated tap water or inexpensive bottled spring water. DO NOT use 100% distilled water.
	Is iron hot enough?	Set thermostat to the (●●●) position. Allow iron to heat up (light goes out) before using steam.
Warm handle.	Is auto-off activated?	Move iron or gently shake.
	Overuse of burst of steam.	Allow more time between each burst.
Auto shut off is activated.		The shut off circuit in the handle produces a small amount of heat. This is normal and will stop when iron is switched on.
Iron won't heat.	Is iron plugged in?	Check plug is in socket.
	Thermostat set too low?	Turn thermostat to a higher setting.
	Is auto-off activated?	Move iron or gently shake.
Indicator light goes on and off.	This is normal.	The light goes on and off showing the thermostat is switching the heat on and off to maintain the correct temperature.
Iron does not steam.	Iron is not hot enough.	Set thermostat to the (●●●) position. Always allow iron sufficient time to heat up before activating the steam control.
	Steam valve is clogged.	Move steam control forward and back several times to clear blockage.

### AFTER IRONING

- Unplug the iron. The variable steam control must be at the "max." setting in order to empty the water from the tank.
- After emptying always push the variable steam control to the "min." setting and allow the iron to cool down before storing away.
- Always store the iron on its heel (protects the soleplate).
- You should never store your iron on its soleplate even when it is cold.

### SELF CLEANING

#### Vapodur Valve

The patented Vapodur valve ensures that the opening which allows the water to drip from the water tank into the steam chamber of your iron remains unaffected by hard water deposits. To ensure your iron continues to steam efficiently the valve MUST be opened and closed a few times. This is done by moving the variable steam control from "min." to "max." a few times each time you finish ironing.

#### Steam Chamber Cleaning Function (Depending on model)

This function allows loose mineral deposits and other impurities that build up inside the iron to be flushed out. This type of self cleaning only needs to be carried out occasionally and never more than once a month.

- Fill the iron with cold tap water and set variable steam to min.
  - Stand on heel and plug in.
  - Set thermostat dial to max. position.
  - When the iron reaches the correct temperature, indicator light will go out, unplug iron.
  - Hold iron horizontally over the sink with soleplate pointing away from body.
  - Slide variable steam control completely over and hold in the section marked SELF CLEAN.
- WARNING: Doing this will cause steam and hot water to be ejected from the soleplate. Take all proper precautions and hold iron away from body.**
- Move the iron gently back and forth and from side to side until all water has run through.
  - Carefully wipe all water and material from the soleplate with an old folded towel, as the water and minerals can stain the soleplate (although this has no effect on glide or performance).

#### WARNING: Iron and soleplate may still be hot, exercise care while wiping.

- Place iron on heel and leave to cool.
- IMPORTANT: Before using the iron after self cleaning, test steam and burst of steam on an old towel or cloth to ensure all loose material has been removed from the iron.

### WATER

Rowenta irons are designed to be used with REGULAR TAP WATER ( up to 12 grains of hardness). If your water is harder than this, Rowenta recommends mixing half tap water with half distilled water which reduces the hardness or using inexpensive spring water. Never use 100 % distilled water since this can cause the iron to spit and leak.

Softened water: There are many types of household water softeners and the water from many of them is perfectly acceptable for use in an iron. However, some types of softeners, particularly those that use chemicals such as salt, can cause the iron to spit and leak during use. If you experience this type of problem, we recommend that you try using inexpensive bottled spring water or untreated tap water. Never use 100 % distilled water.

## Free Manuals Download Website

<http://myh66.com>

<http://usermanuals.us>

<http://www.somanuals.com>

<http://www.4manuals.cc>

<http://www.manual-lib.com>

<http://www.404manual.com>

<http://www.luxmanual.com>

<http://aubethermostatmanual.com>

Golf course search by state

<http://golfingnear.com>

Email search by domain

<http://emailbydomain.com>

Auto manuals search

<http://auto.somanuals.com>

TV manuals search

<http://tv.somanuals.com>