

READ AND SAVE THESE INSTRUCTIONS

jv™

Pod Coffee Maker

**USE AND CARE GUIDE FOR
MODEL JVPM1B, JVPM1W**



IMPORTANT SAFEGUARDS

When using electrical appliances, basic safety precautions should always be followed, including the following:

- Read all instructions.
- Do not touch hot surfaces. Use handles or knobs.
- To protect against fire, electric shock, do not place cord, plugs, or appliance in water or other liquid.
- Close supervision is necessary when any appliance is used by or near children.
- Unplug from outlet when not in use and before cleaning. Allow to cool before putting on or taking off parts, and before cleaning the appliance.
- Do not operate any appliance with a damaged cord or plug or after the appliance malfunctions, or has been damaged in any manner. Contact Consumer Service for examination, repair or adjustment.
- The use of accessory attachments not recommended by the appliance manufacturer may result in fire, electric shock or injury to persons.
- Do not use outdoors.
- Do not let cord hang over edge of table or counter, or touch hot surfaces.
- Do not place on or near a hot gas or electric burner, or in a heated oven.
- To disconnect, turn any control to “off,” then remove plug from wall outlet.
- Do not use appliance for other than intended use.
- Be certain lid is securely in place before operating appliance.
- Scalding may occur if the lid is opened during the brewing cycles.

SAVE THESE INSTRUCTIONS

THIS PRODUCT IS FOR HOUSEHOLD USE ONLY.

ADDITIONAL IMPORTANT SAFEGUARDS

WARNING: This appliance generates heat and escaping steam during use. Use proper precautions to prevent the risk of burns, fires, or other injury to persons or damage to property.

- All users of this appliance must read and understand this Owner's Manual before operating or cleaning this appliance.
- The cord to this appliance should be plugged into a 120V AC electrical outlet only.
- Use **water only** in this appliance! Do not put any other liquids or food products in this appliance. Do not mix or add anything to the water placed in this appliance, except as instructed in the User Maintenance Instructions to clean the appliance.
- **DO NOT** attempt to move an appliance containing hot liquids. Allow appliance to cool completely before moving.
- Keep appliance at least 4 inches away from walls or other objects during operation. Do not place any objects on top of appliance while it is operating. Place the appliance on a surface that is resistant to heat.
- If this appliance begins to malfunction during use, immediately unplug the cord. Do not use or attempt to repair the malfunctioning appliance.
- If this appliance falls or accidentally becomes immersed in water or any other liquid, unplug immediately. **Do not reach into the water! Do not use this appliance after it has fallen into or has become immersed in water.** Contact Consumer Service for examination and repair.
- Do not leave this appliance unattended during use.
- Always use fresh, cool water in your coffee maker. Warm water or other liquids, except as listed in cleaning section, may cause damage to the appliance.

POLARIZED PLUG: This appliance has a polarized plug, (one blade is wider than the other). To reduce the risk of electric shock, this plug is intended to fit into a polarized outlet only one way. If the plug does not fit fully in the outlet, reverse the plug. If it still does not fit, contact a qualified electrician. Do not attempt to modify the plug in any way.

SHORT CORD INSTRUCTIONS: A short power supply cord is provided to reduce the risk resulting from becoming entangled in or tripping over a longer cord.

Do not use an extension cord with this product.

ELECTRIC POWER: If the electric circuit is overloaded with other appliances, your appliance may not operate properly. It should be operated on a separate electrical circuit from other appliances.

WARNING: TO REDUCE THE RISK OF FIRE OR ELECTRIC SHOCK, DO NOT REMOVE THE BOTTOM COVER. NO USER-SERVICEABLE PARTS INSIDE. REPAIR SHOULD BE DONE BY AUTHORIZED SERVICE PERSONNEL ONLY.

CAUTION: To prevent Plasticizers from migrating from the finish of the countertop or tabletop or other furniture, place **NON-PLASTIC** coasters or placemats between the appliance and the finish of the countertop or tabletop.

Failure to do so may cause the finish to darken, permanent blemishes may occur or stains can appear.

Your product may vary slightly from illustration.

Parts Identification

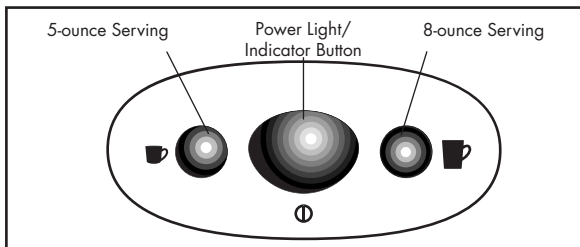
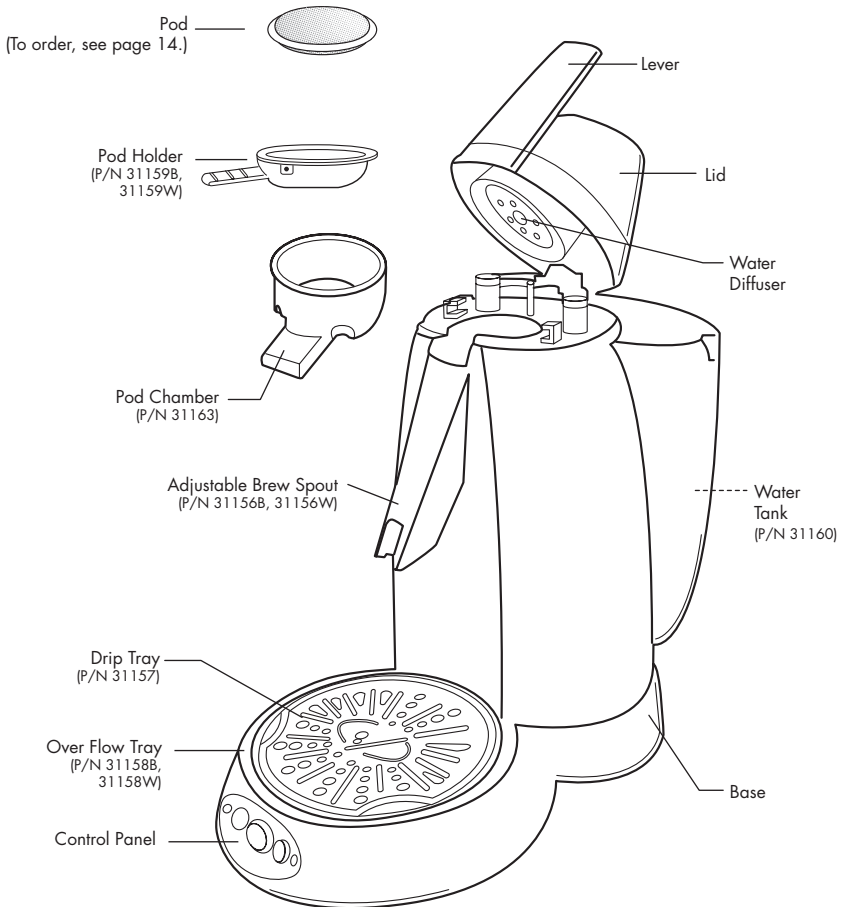

Before Using Your Pod Coffee Maker

Become familiar with all parts of the appliance.

Keep your Pod Coffee Maker clean

Clean and descale your Pod Coffee Maker on a regular basis. See “Cleaning and Descaling”, pages 11-12. We recommend cleaning the Water Tank and the Adjustable Brew Spout as well as the Pod Holder and Pod Chamber, before using for the first time. Turn on the machine for a full cycle using water only by following steps 1-9.

IMPORTANT: THE MACHINE WILL NOT FILTER COFFEE UNLESS THE PUMP HAS BEEN PRIMED.

1. Remove the Water Tank by pulling out and then up to remove from the Base, see Figure 3.

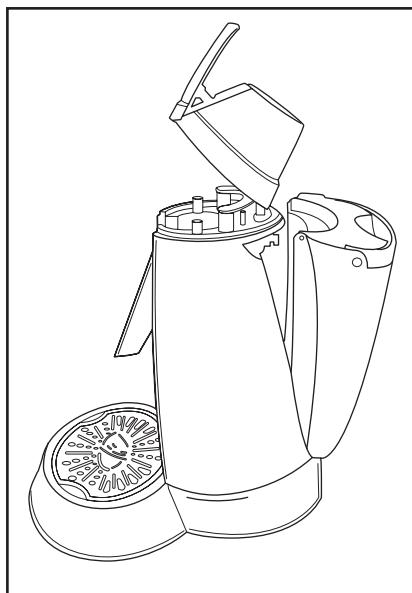

FIGURE 3

2. Fill the Water Tank with fresh water up to the 'Max' line, and fit back into the Base (down and in) until it "snaps" into place, see Figure 4.

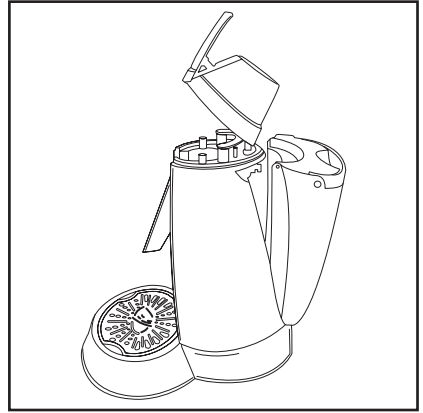

FIGURE 4

3. Lift Lid by pulling out on the Lever. Top will pop up. Push back so Lid is in fully raised position, see Figure 5.

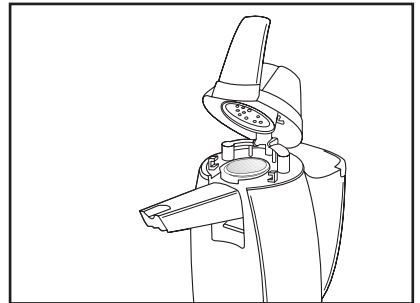

FIGURE 5

4. Place the Adjustable Brew Spout inside the coffee maker.

5. Make sure the mouth of the Pod Chamber is inside the Adjustable Brew Spout. Do not place a coffee pod in chamber. See Figure 6.

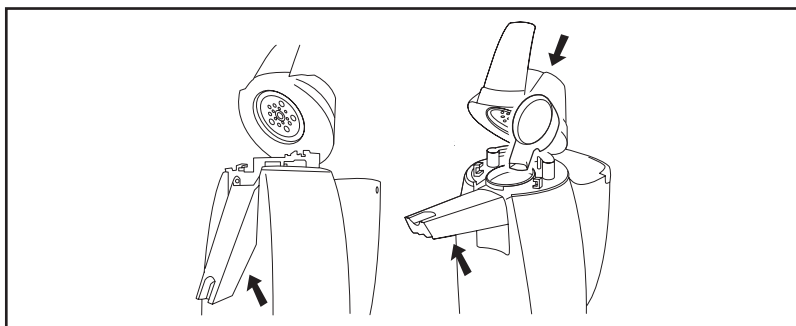

FIGURE 6

6. Place the Pod Holder so it sits securely on top of the Pod Chamber, see Figure 7.

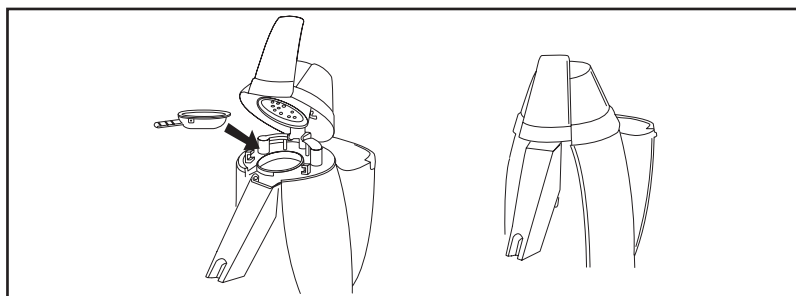

FIGURE 7

7. To close the Lid, press down firmly on the top of the Lid and hold in place while pushing the Lever back so it is flush with the Lid and locks into place, see Figure 7.
8. Place a cup or mug below the Adjustable Brew Spout to collect the water.
NOTE: Adjustable Brew Spout is always in “relaxed” position unless forced up by a tall mug.

9. Press the Power Light/Indicator Button to turn power on, then simultaneously press the 5-Ounce Serving and 8-Ounce Serving Buttons, see Figure 8.

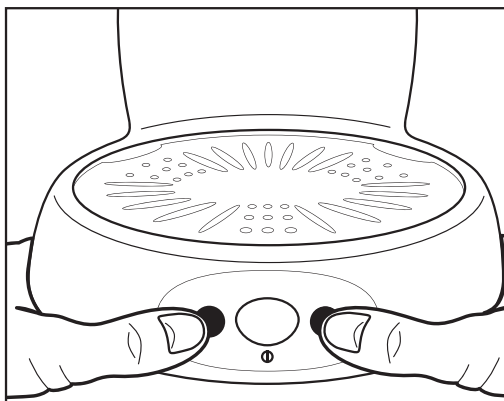

FIGURE 8

The water from the Water Tank will cycle through the coffee maker.

NOTE: If unit goes unused for 3 or more days, please repeat above process (steps 1-9).

CAUTION: Do not immerse cord, plug or machine in water or other liquid.

Brewing Coffee

CAUTION: Before Brewing in your coffee maker for the first time, complete the steps listed under “Before Using Your Pod Coffee Maker” on pages 6-9 to ensure your machine functions properly.

1. Fill the Water Tank with water up to the ‘MAX’ line. Never pour other liquids such as milk or hot water into the Water Tank. A full tank will yield about 7 5-oz. servings or 4 8-oz. servings of coffee.
2. Press the Power Light/Indicator Button. The indicator light will flash while the water heats up. Heating will take approximately 1½ minutes.
3. To open the Lid, place one finger behind Lever and pull out. Gently raise Lid to open position.
4. Place the Adjustable Brew Spout inside the coffee maker.
5. Place the empty Pod Holder inside the Pod Chamber, see Figure 7.

6. Place one coffee pod inside the Pod Holder. Press lightly on the coffee pod to make sure it sits evenly in the Pod Holder. See Figures 9 and 10 for correct pod insertion.

CAUTION: Use only pre-measured coffee pods in your Pod

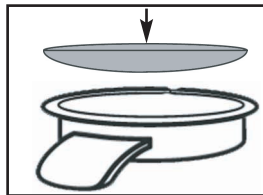

FIGURE 9

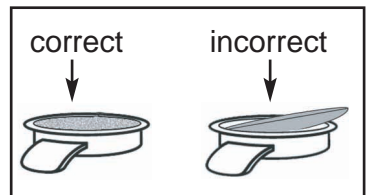

FIGURE 10

Coffee Maker. The use of loose ground coffee may result in inferior coffee, cause overflow and could possibly damage the machine.

CAUTION: Never use torn coffee pods as this could clog the machine and damage it. Each coffee pod is pre-portioned with the optimal amount of coffee required per cup.

7. To close the Lid, press down firmly on the top of the Lid and hold in place while pushing the Lever back so it is flush with the Lid and locks into place.
8. Place a mug or cup under the Adjustable Brew Spout. The cup should hold at least 7 to 10 ounces, depending on your selection.
9. When the indicator light stops flashing, the coffee maker is ready to use. If the indicator light flashes at rapid intervals, see Troubleshooting on page 13.
10. Select the amount of coffee you wish to brew: either a 5 ounce serving or an 8 ounce serving. The machine will begin the brewing process. At the beginning of the brewing cycle, a small amount of water is dispersed to pre-moisten the pod to ensure full extraction. Following a short pause, the machine will brew for about 50 seconds. You can manually stop the brewing process at any time by pressing the Power Button.

CAUTION: Dripping may occur between brewing cycles.

11. Dispose of the coffee pod after use by removing the Pod Holder from the Pod Chamber and emptying it. Do not use a pod more than once. Repeated use may cause the pod to burst and result in weak and inferior coffee.

Note: Regular rinsing of the Pod Holder will optimize the flavor of the beverage.

You may leave your coffee maker on if you intend to brew another cup of coffee. The coffee maker will turn off automatically after one hour.

Helpful Hints for Brewing

Fresh Water

For optimal results, use fresh water daily. If you haven't used your machine for a few days, follow steps 1-9 in section "Before Using Your Pod Coffee Maker" on pages 6-9.

Note: If Water Tank becomes dry for 3 or more days, you must re-prime the pump. See "Before Using Your Pod Coffee Maker," steps 1-9.

Coffee Pods

Remember to remove pods after use. If a pod is left inside the machine for some time, remove it and wash the Pod Holder before attempting to brew coffee.

Use only pre-measured coffee pods in your Pod Coffee Maker. The use of loose ground coffee may result in inferior coffee, cause overflow and could possibly damage the machine.

Never use torn coffee pods as this could clog the machine and damage it. Each coffee pod is pre-portioned with the optimal amount of coffee required per cup.

Care and Cleaning

CAUTION: Do not immerse cord, plug or machine in water or other liquid.

1. Always unplug the appliance before cleaning.
2. Clean the outer surface of the unit and the Water Diffuser with a damp cloth.
3. Remove the Pod Holder, Pod Chamber and Adjustable Brew Spout.

4. Remove the Drip Tray and Overflow Tray, see Figure 11.

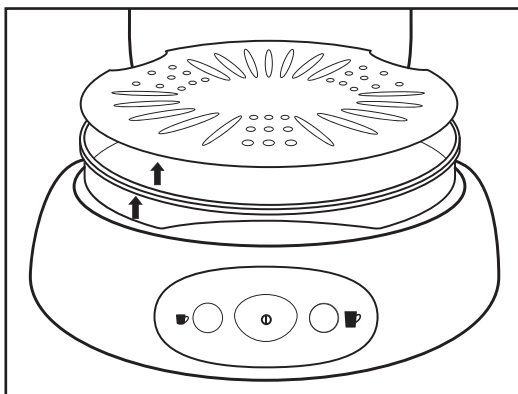

FIGURE 11

5. Clean the Water Tank, Pod Holder, Pod Chamber, Adjustable Brew Spout, Drip Tray and Overflow Tray with hot water. If necessary, use a little dish soap.
Note: The Pod Holder, the Drip Tray, Overflow Tray and the Adjustable Brew Spout may be washed in the dishwasher (top shelf only). The top part of the tank can be removed for thorough cleaning. Do not place the Water Tank in the dishwasher.
6. Rinse all parts with fresh water after cleaning.
Note: Do not try to dry the inside of the Removable Water Tank with a cloth because this could leave a residue of lint and may clog your coffee maker.

Descaling

Regular descaling will extend the service life of your machine and ensure optimal results over time.

1. Follow the instructions given in “Before Using Your Pod Coffee Maker,” pages 6-9, replacing one fourth of the water with white vinegar.
2. Brew 3, 8-oz. cups **using empty Pod Holder** (follow the Brewing Instructions on page 9.)
3. Remove Water Tank, Pod Holder, Pod Chamber and Adjustable Brew Spout and wash thoroughly.
4. Repeat instructions in step 2 up to four times in order to flush vinegar residue. Empty Water Tank and refill with fresh water after each cycle.
Note: You may also use a cleaner designed for automatic drip coffee makers. Simply follow the instructions as stated on the package.

Troubleshooting

Should a problem occur, you may be able to find an answer in the text below. If the text proves unhelpful or if you require further information, please contact Consumer Service.

1. The coffee is too weak.

Check the following:

- the pod is placed properly in the Pod Holder. You may need to lightly press it down into the holder.

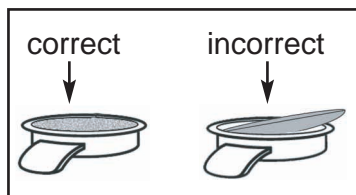

FIGURE 12

- you have selected the correct button according to the number of ounces and strength desired. Use one coffee pod for either one 5-ounce, bold European serving, or an 8-ounce serving of American-style coffee.
- you are using a fresh coffee pod.

2. The coffee is too strong.

Check that you have selected the correct button. Use the 8-ounce button for less robust coffee.

3. There is less water than normal used during brew cycle.

- Tank may be empty. Refill and brew again.
- Descale appliance. See "Descaling," page 12.

4. Water drips from the coffee maker.

Note: Some water may drip between cycles, this is normal.

If dripping seems excessive, check the following:

- the Pod Holder must be placed properly within the Pod Chamber and the Lever locked into position.
- the Water Tank must not be filled above the 'MAX' line.
- the Pod Holder may be clogged. Rinse under tap water to unclog the screen. If necessary, you may also use a scrubbing brush or a pin to unclog holes.
- the pod must be properly placed so it sits evenly in the holder. Lightly tap it down into the holder. See Figure 9.
- some water droplets on your countertop are normal and may be caused by the filling and replacing of the Water Tank.

5. The indicator light is flashing.

A flashing indicator light means the machine is heating. This normally lasts for 1½-2 minutes. If indicator light is flashing rapidly (more than a second apart), see #6 below.

If the indicator light flashes continually for more than 4 minutes, contact Consumer Service.

6. The indicator light keeps flashing at rapid intervals.

Check the following:

- the Water Tank must be inserted properly inside the coffee maker.
- there must be enough water in the Water Tank. Fill the Water Tank to the “Max” fill line.
- the appliance may require cleaning. See “Before Using Your Pod Coffee Maker”, pages 6-9.
- room temperature must be above 40°F.

7. The Lid will not open.

Turn coffee maker off. Unplug coffee maker. Wait for appliance to cool completely (about 30 minutes) and try opening Lid again. Clean all removable parts (Adjustable Brew Spout, Pod Holder, Pod Chamber) as described on pages 11-12.

For any other problem please contact Consumer Service, 1-800-577-1557 or email us at Salton@Saltonusa.com.

To Order Coffee Pods

It's easy to order pods. Just log onto our dedicated website, www.juanvaldezpods.com, and order online.

To order by phone, call toll-free, 1-800-577-1557.

Coffee pods are also available at Target and other retail outlets that carry the Pod Coffee Maker.

IMPORTANT NOTICE

*If any parts are missing or defective,
DO NOT return this product.*

Please call our Customer Service Department for assistance.

800-577-1557 Monday - Friday 9:00 am - 5:00 pm CST

Thank You

LIMITED ONE YEAR WARRANTY

Warranty: This product is warranted by Salton, Inc. to be free from defects in materials or workmanship for a period of (1) year from the original purchase date. This product warranty covers only the original consumer purchaser of the product.

Warranty Coverage: This warranty is void if the product has been damaged by accident in shipment, unreasonable use, misuse, neglect, improper service, commercial use, repairs by unauthorized personnel, normal wear and tear, improper assembly, installation or maintenance abuse or other causes not arising out of defects in materials or workmanship. This warranty is effective only if the product is purchased and operated in the USA, and does not extend to any unit which has been used in violation of written instructions furnished with the product, or to units which have been altered or modified, or to damage to products or parts thereof which have had the serial number removed, altered, defaced or rendered illegible.

Implied Warranties: ANY IMPLIED WARRANTIES WHICH THE PURCHASER MAY HAVE ARE LIMITED IN DURATION TO ONE (1) YEAR FROM THE DATE OF PURCHASE. Some states do not allow limitations on how long an implied warranty lasts, so the above limitation may not apply to you.

Warranty Performance: During the above one-year warranty period, a product with a defect will be either repaired or replaced with a reconditioned comparable model (at our option) when the product is returned to the Repair Center, or the purchase price refunded. The repaired or replacement product will be in warranty for the balance of the one-year warranty period and an additional one-month period. No charge will be made for such repair or replacement.

Service and Repair: Should the appliance malfunction, you should first call toll-free 1-800-577-1557 between the hours of 9:00 am and 5:00 pm Central Standard Time and ask for CONSUMER SERVICE stating that you are a consumer with a problem. Please refer to model number JVPM1B or JVPM1W when you call.

In-Warranty Service (USA): For an appliance covered under the warranty period, no charge is made for service or postage. Call for return authorization 1-800-577-1557.

Out-of-Warranty Service: A flat rate charge by model is made for out-of-warranty service. Include \$12.00 (U.S.) for return shipping and handling. We will notify you by mail of the amount of the charge for service and require you to pay in advance for the repair or replacement.

For products purchased in the USA, but used in Canada: You may return the product insured, packaged with sufficient protection, and postage and insurance prepaid to the USA address listed below. Please note that all customs duty / brokerage fees, if any, must be paid by you and we will require you to pay the cost of customs duty / brokerage fees to us in advance of our performing any service.

Risk During Shipment: We cannot assume responsibility for loss or damage during incoming shipment. For your protection, carefully package the product for shipment and insure it with the carrier. Be sure to enclose the following items with your appliance: any accessories related to your problem, your full return address and daytime phone number, a note describing the problem you experienced, a copy of your sales receipt or other proof of purchase to determine warranty status. C.O.D. shipments cannot be accepted.

To return appliance, ship to:

Attn: Repair Center
Salton, Inc.
708 South Missouri Street
Macon, MO 63552

To contact us, please write to, call or email:

Salton, Inc.
P.O. Box 6916
Columbia, MO 65205-6916
1-800-577-1557
Email: Salton@Saltonusa.com

Limitation of Remedies: No representative or person is authorized to assume for Salton, Inc. any other liability in connection with the sale of our products. There shall be no claims for defects or failure of performance or product failure under any theory of tort, contract or commercial law including, but not limited to negligence, gross negligence, strict liability, breach of warranty and breach of contract. Repair, replacement or refund shall be the sole remedy of the purchaser under this warranty, and in no event shall Salton, Inc. be liable for any incidental or consequential damages, losses or expenses. Some states do not allow the exclusion or limitation of incidental or consequential damages, so the above limitation or exclusion may not apply to you.

Legal Rights: This warranty gives you specific legal rights, and you may also have other rights which vary from state to state.

For more information on Salton products:
Visit our website: www.eSalton.com

© 2004 Salton, Inc.
All Rights Reserved

P/N 67601
Printed in China

Free Manuals Download Website

<http://myh66.com>

<http://usermanuals.us>

<http://www.somanuals.com>

<http://www.4manuals.cc>

<http://www.manual-lib.com>

<http://www.404manual.com>

<http://www.luxmanual.com>

<http://aubethermostatmanual.com>

Golf course search by state

<http://golfingnear.com>

Email search by domain

<http://emailbydomain.com>

Auto manuals search

<http://auto.somanuals.com>

TV manuals search

<http://tv.somanuals.com>