



HC-P4363W

PROJECTION TELEVISION



Owner's Instructions

This device is a Class B digital apparatus.

Important Warranty Information Regarding Television Format Viewing

Standard screen format televisions (4:3, the aspect ratio of the screen width to height) are primarily designed to view standard format full-motion video. The images displayed on them should primarily be in the standard 4:3 ratio format and constantly moving. Displaying stationary graphics and images on screen, such as the dark top and bottom letterbox bars (wide screen pictures), should be limited to no more than 15% of the total television viewing per week.

Wide screen format televisions (16:9, the aspect ratio of the screen width to height) are primarily designed to view wide screen format full-motion video. The images displayed on them should primarily be in the wide screen 16:9 ratio format, or expanded to fill the screen if your model offers this feature, and constantly moving. Displaying stationary graphics and images on screen, such as the dark side-bars on non-expanded standard format television video and programming, should be limited to no more than 15% of the total television viewing per week.

Additionally, viewing other stationary images and text such as stock market reports, video game displays, station logos, web sites or computer graphics and patterns, should be limited as described above for all televisions. ***Displaying any stationary images that exceed the above guidelines can cause uneven aging of picture tubes (CRTs) that leave subtle, but permanent burned-in ghost images in the television picture. To avoid this, vary the programming and images, and primarily display full screen moving images, not stationary patterns or dark bars.*** On television models that offer picture sizing features, use these controls to view the different formats as a full screen picture.

Be careful in the selection and duration of television formats used for viewing. Uneven CRT aging as a result of format selection and use, as well as other burned-in images, is not covered by your Samsung limited warranty.

CONTENTS

Chapter 1: Your New TV

List of Features.....	5
Accessories.....	5
Familiarizing Yourself with Your New TV	6
Control Buttons	6
Using a Display Deck.....	7
Connection Jacks (Side or Front)	7
Connection Jacks (Rear).....	8
Remote Control (TV Functions).....	9
Remote Control (DVD and Extra Functions)	10

Chapter 2: Installation

Connecting VHF and UHF Antennas.....	11
Antennas with 300-ohm Flat Twin Leads.....	11
Antennas with 75-ohm Round Leads	11
Separate VHF and UHF Antennas	11
Connecting Cable TV.....	12
Cable without a Cable Box.....	12
Cable with a Cable Box that Descrambles All Channels	12
Connecting to a Cable Box that Descrambles some Channels	13
Connecting a VCR	14
Connecting a Second VCR to Record from the TV	14
Connecting a DVD Player	15
Connecting to Y, P _B , P _R	15
Connecting to Regular Audio and Video Jacks	15
Connecting a Digital TV Set-Top Box.....	16
Connecting to Y, P _B , P _R	16
Connecting to DVI (Digital Visual Interface)	17
Connecting to HDMI (High Definition Multimedia Interface)	17
Connecting a Camcorder	18
Connecting to the Digital Audio Input.....	18
Connecting Additional Speakers	19
Installing Batteries in the Remote Control	19

Chapter 3: TV Operation

Turning the TV On and Off	20
Plug & Play Feature.....	20
Viewing the Menus and On-Screen Displays	22
Viewing the Menus.....	22
Viewing the Display	22
Selecting a Menu Language	23
Selecting the Antenna Input.....	23
Adjusting the Screen Automatically (Self Focus)	24
Deactivating the Automatic Execution of the Self Focus.....	25
Removing the "Self Focus" Message from the Display	25
Memorizing the Channels	26
Selecting the Video Signal Source.....	26
Storing Channels in Memory Automatically	27
Changing Channels	28
Using the Channel Buttons.....	28
Using the Number Buttons.....	28
Using the Previous Channel	28
Adding and Erasing Channels	29
Selecting Your Favorite Channels.....	30
To Store Your Favorite Channels	30
To View Your Favorite Channels.....	30
Labeling the Channels	31
Scanning the Channels.....	32
Fine Tuning Channels	33
Using Automatic Picture Settings.....	34
Customizing the Picture.....	35
Selecting the Color Tone	36
Changing the Picture Size	37
Digital Noise Reduction	38

CONTENTS

Chapter 3: TV Operation (continued)	
Viewing Picture-In-Picture	39
Activating the PIP.....	39
Selecting an External Source	40
Swapping the Sub picture and Main picture	40
Changing the Size of the Sub picture	40
Changing the Location of the Sub picture	41
Selecting a Signal Source for the Sub picture	41
Changing the Channel of the Sub picture	42
Freezing the Picture	42
Adjusting the Volume.....	43
Using the MUTE Button.....	43
Using Automatic Sound Settings	44
Customizing the Sound	45
Choosing a Multi-Channel Sound (MTS) track	46
Auto Volume	47
Setting the Dolby Digital	48
Enjoying Dolby Surround Sound	48
Setting the Dynamic Range.....	49
Adjusting Speaker Levels	49
Adjusting the Time Delay for Surround Sound Speakers	50
Selecting a Digital Audio Source	51
Setting the Clock Manually	52
Setting the Clock Automatically.....	53
Setting the Sleep Timer	55
Setting the On/Off Timer.....	56
Setting the Blue Screen Mode.....	57
Viewing Closed Caption Information.....	58
Setting the On/Off Melody.....	59
Using the V-Chip (USA).....	60
How to Change Your Password	60
How to Enable/Disable the Rating Controls	61
How to Set up Restrictions Using the “TV Parental Guidelines”	62
How to Set up Restrictions Using the “MPAA Rating”	63
Important Notes About Parental Locks.....	64
Viewing an External Signal Source.....	65
Setting the Signal Source	65
Assigning Names to External sources	66
Customizing Your Remote Control.....	67
Setting Up Your Remote Control to Operate Your VCR (Cable box or DVD player).....	67
Remote Control Codes	68
 Chapter 4: DVD Operation	
Playing a Disc	69
Using the Search and Skip Functions.....	71
Using the Play Function.....	72
Using the Disc Menu	76
Using the Title Menu	76
Displaying the Disc Information	77
Using the Zoom Function (DVD/VCD)	78
Changing the Camera Angle	78
Using the Bookmark Function (DVD/VCD)	79
Repeat Play	80
Program Play (CD).....	81
Setting up the Language for Player Menu.....	82
Setting up the Display Options	83
Setting up the Parental Control	84
 Chapter 5: Troubleshooting	
Identifying Problems	86
 Appendix	
Cleaning and Maintaining Your TV	88
Using Your TV in Another Country	88
Specifications	88

Chapter One

YOUR NEW TV

List of Features

Your TV was designed with the latest technology. This TV is a high-performance unit that includes the following special features:

- Easy-to-use remote control
- Easy-to-use on-screen menu system
- Automatic timer to turn the TV on and off
- Adjustable picture and sound settings that can be stored in the TV's memory
- Automatic channel tuning for up to 181 channels
- A special filter to reduce or eliminate reception problems
- Fine tuning control for the sharpest picture possible
- A built-in multi-channel sound decoder for stereo and bilingual listening
- Built-in, dual channel speakers
- A special sleep timer
- **Picture-In-Picture** capability that lets you watch two channels at once
- Component Video Input jacks to obtain a sharper image from external sources
- Self Focus
- Digital Inputs
 - **DVI - Digital Visual Interface**
 - **HDMI - High Definition Multimedia Interface**
- DTS digital output for DTS-enhanced DVDs.
- Playback MP3, JPG, WMA, MPG files from CD-ROM.
 - **Discs which cannot be played:** DVD-ROM, CD-ROM, CDI, HD layer of super Audio CD, CDGs play audio only, not graphics, CDV

Accessories

Once you have unpacked your TV, check to make sure that you have all the parts shown here. If any piece is missing or broken, call your dealer.

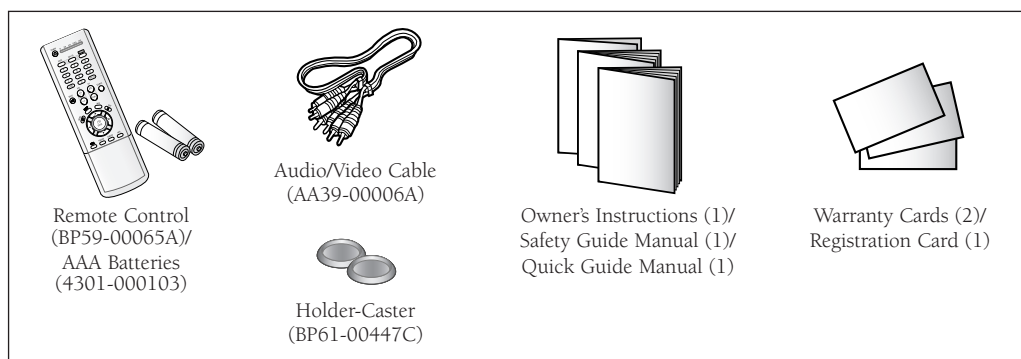

YOUR NEW TV

Familiarizing Yourself with Your New TV

Control Buttons

You can control your TV's basic features, including the on-screen menu. To use the more advanced features, you must use the remote control.

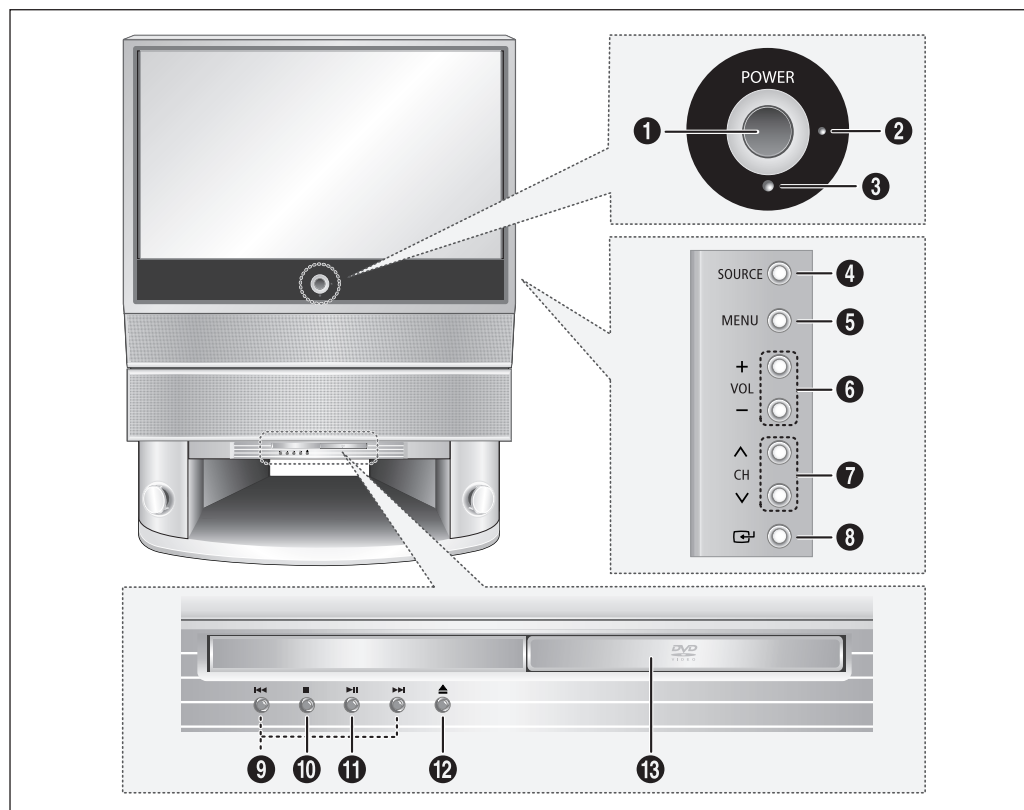

- | | |
|--|---|
| <p>1 POWER
Press to turn the TV on and off.</p> <p>2 Stand-By Indicator
Lights up when you turn the power off.
- Power Off ; Red
- Power On ; Off
- Timer On ; Green</p> <p>3 Remote Control Sensor
Aim the remote control towards this spot on the TV.</p> <p>4 SOURCE
Press to switch between viewing TV programs and signals from connected components.</p> <p>5 MENU
Press to see an on-screen menu of your TV's features.</p> <p>6 + VOL -
Press to lower or raise the volume and to select items when using the on-screen menu</p> | <p>7 ^ CH v
Press to change channels and move between items on the on-screen menu.</p> <p>8 [Enter]
While using the on-screen menus, press to activate (or change) a particular item.</p> <p>9 <<< >>>
Press to skip or search the title, chapter or track.</p> <p>10 ■
Press to stop the disc.</p> <p>11
Press to play or pause the disc.</p> <p>12 ▲
Press to open and close the disc tray.</p> <p>13 Disk Tray
Load the disc here.</p> |
|--|---|

YOUR NEW TV

Using a Display Deck

You can display a VCR or DVD Player, etc. by using the display deck.



Connection Jacks (Side or Front)

You can connect an A/V component that is used only occasionally, such as a camcorder or video game. For information on connecting equipment, see page 18.

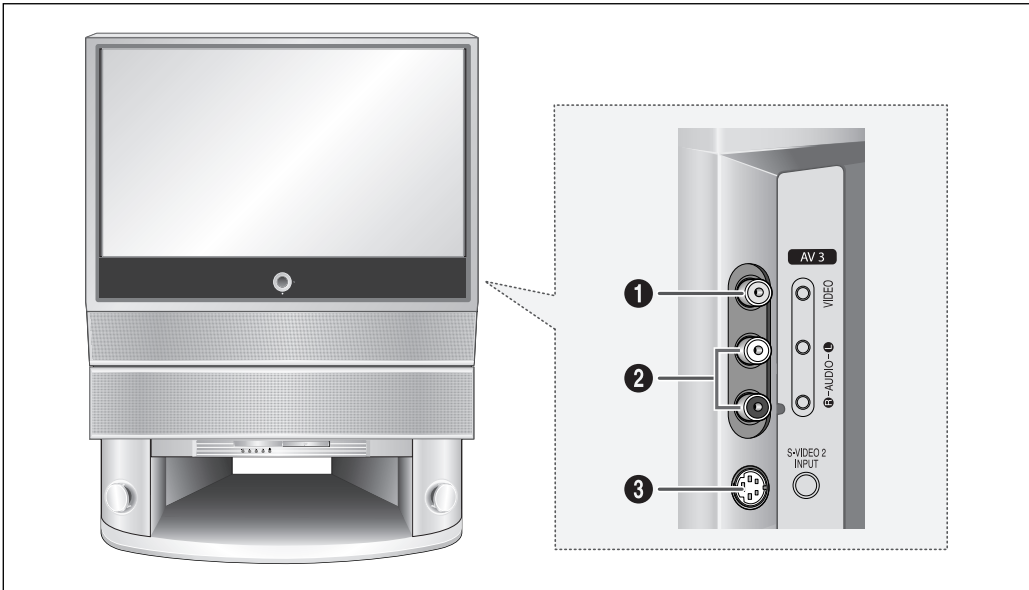

- 1 VIDEO Input**
Connect the video signal from a camcorder or video game.
- 2 AUDIO Inputs**
Connect the audio signals from a camcorder or video game.
- 3 S-VIDEO Input**
Connect an S-Video signal from a camcorder or video game.

YOUR NEW TV

Connection Jacks (Rear)

Use the rear panel jacks to connect an A/V component that will be connected continuously, such as a VCR or a DVD player. For more information on connecting equipment, see pages 14~19.

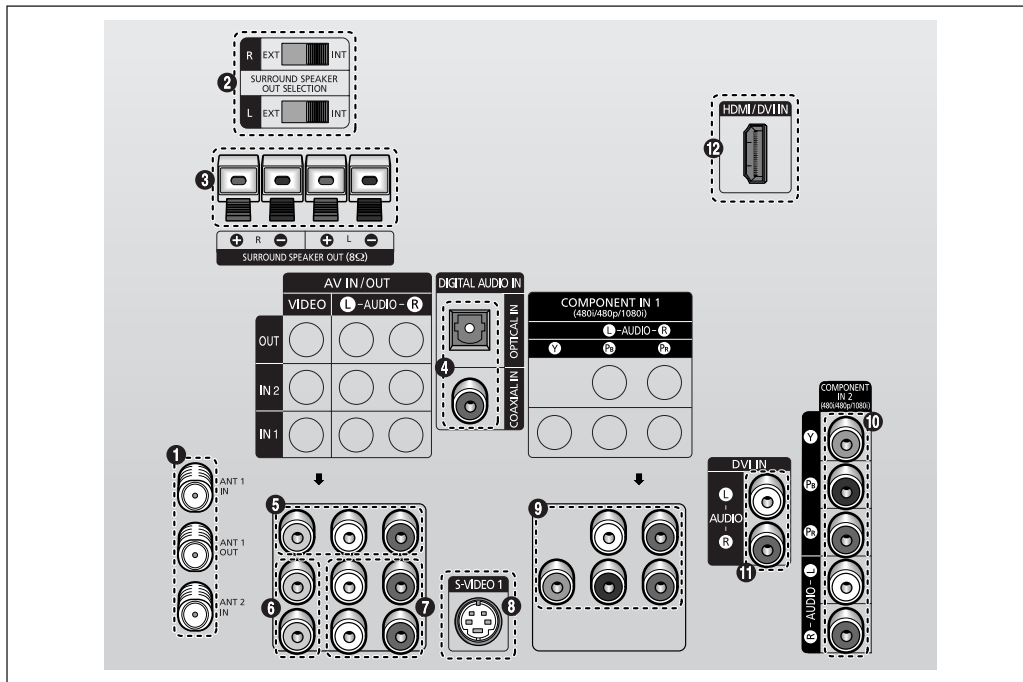
**1 Antenna terminals**

Two independent cables or antennas can be connected to these terminals. Use "ANT 1 IN" and "ANT 2 IN" terminals to receive a signal from VHF/UHF antennas or your cable system. Use the "ANT 1 OUT" terminal to send the signal being received by the "ANT 1 IN" terminal out to another component (such as a Cable Set-Top Box). The PIP channel can be received only when a signal source is connected to "ANT 1 IN".

2 Surround Speaker Output Selection

The factory default is set to INT (Internal). For sound output to external speakers, set to EXT (External), then sound to the internal speaker is off.

3 Surround Speaker Output

Connect to the external speakers. To improve the sound quality, connect the red wire to the red terminal and black wire to the black terminal.

4 Digital Audio Input jacks

Connect to the digital audio output jacks for device with digital audio output.

5 Audio/Video Output jacks

Connect to the audio/video input jacks of a recording VCR.

6 Video Input jacks

Connect to the video output jacks of VCRs, DVD players and similar devices.

7 Audio Input jacks

Connect to the audio output jacks of VCRs, DVD players and similar devices.

8 S-Video Input jack

Connect to S-VIDEO output jacks of an S-VHS VCR or DVD player.

9 10 COMPONENT Input jacks (Y, PB, PR, AUDIO-L/R)

Connect to the audio and video outputs of DVD or DTV Set-Top Box. 480i/480p/1080i Y,Pb and Pr video signal outputs are available.

11 DVI Audio Input jacks (Digital Visual Interface)

Connect to the digital audio output jacks for device with DVI output.

12 HDMI/DVI Video Input jack (High Definition Multimedia Interface)

Connect to the HDMI jack for device with HDMI or DVI output.

YOUR NEW TV

Remote Control (TV Functions)

You can use the remote control up to about 23 feet from the TV. When using the remote control, always point it directly at the TV. You can also use your remote control to operate your Set-Top box, VCR, Cable box or DVD player. See pages 67~68 for details.

1 POWER

Turns the TV on and off.

2 TV/DVD

Press to switch between TV and DVD mode.

3 Number buttons

Press to select channels directly on the TV.

4 +100

Press to select channels over 100. For example, to select channel 121, press the "+100," then press the "2" and "1."

5 MUTE

Press to temporarily cut off the sound.

6 VOL +, VOL -

Press to increase or decrease the volume.

7 FAV. CH (Favorite Channel)

Press to switch between your favorite channels.

8 MENU

Displays the main on-screen menu.

9 ADD/DEL

Press to add or erase channels in the TV's memory. Use to memorize or erase the fine tuning after fine tuning channels.

10 A. PROG

Press to store channels in Memory Automatically

11 CAPTION

Press to view closed caption information.

12 SELF FOCUS

Press to adjust for the optimum picture set in the factory.

13 P.SIZE

Press to change the picture size.

14 S.MODE

Adjust the TV sound by selecting one of the preset factory settings (or select your personal, customized sound settings.)

15 MODE

Selects a target device to be controlled by this remote control (i.e., TV, STB, VCR, CABLE or DVD).

16 PRE-CH

Tunes to the previous channel.

17 CH[^], CH^v

Press to change channels.

18 SOURCE

Each time the button is pressed, all the inputs connected to the external component jacks will be shown in regular sequence.

19 INFO

Press to display information on the TV screen.

20 EXIT

Press to exit the menu.

21 ◀/▶/▼/▲

Control the cursor in the menu.

22 ENTER

While using the on-screen menus, press ENTER to activate (or change) a particular item.

23 PIP

Activates PIP (Picture-In-Picture).

24 CH[^], CH^v

Displays the available channels in sequence. (These buttons change channels in the PIP window only.)

25 SWAP

Press to exchange the video signal that is currently displayed on the main screen with the signal in the PIP window.

26 MTS (Multichannel Television Sound)

Press to choose "Stereo", "Mono" or "SAP (Secondary Audio Program)".

27 STILL (Main picture)

Press to stop the action during a particular scene. Press again to resume normal video. The still function doesn't operate in "Component 1" and "Component 2" mode.

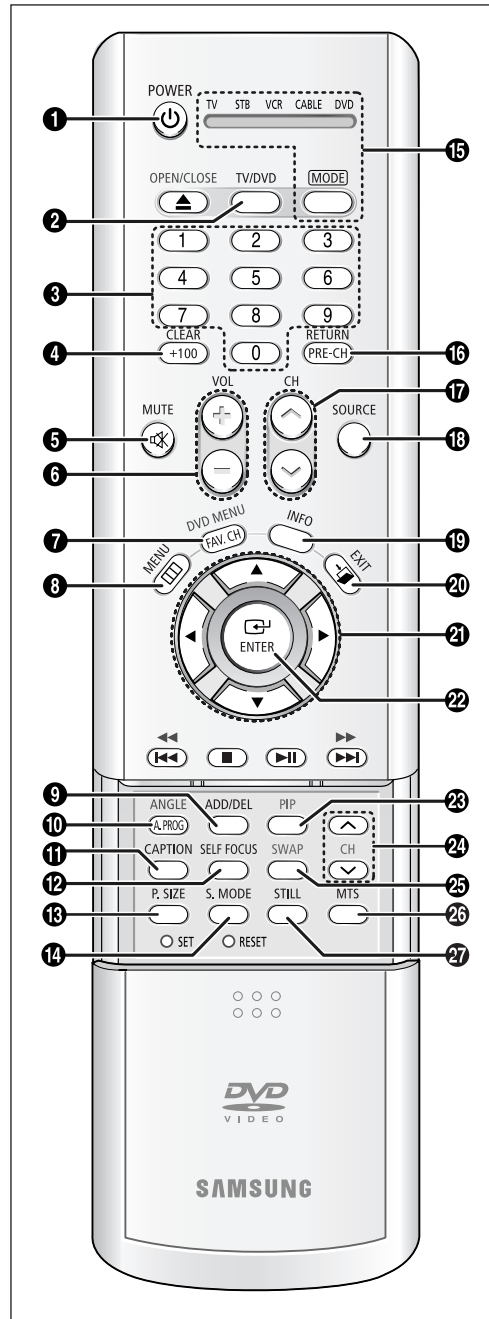

YOUR NEW TV

Remote Control (DVD and Extra Functions)

- 1 OPEN/CLOSE**
Press to open or close the disc tray.
- 2 CLEAR**
Press to delete a bookmark number and cancel the program play.
- 3 DVD MENU**
Displays the DVD play's Setup menu.
- 4** ◀◀
Press to search backward through a disc.

◀◀
Press to skip the back title, chapter, or track.
- 5** ■
Press to stop the disc
- 6 ANGLE**
Press to access various camera angles on a DVD.
- 7 SET**
Used during set up of this remote control, so that it will work compatibly with other devices (VCR, Cable Box, DVD, Set-Top Box etc.)

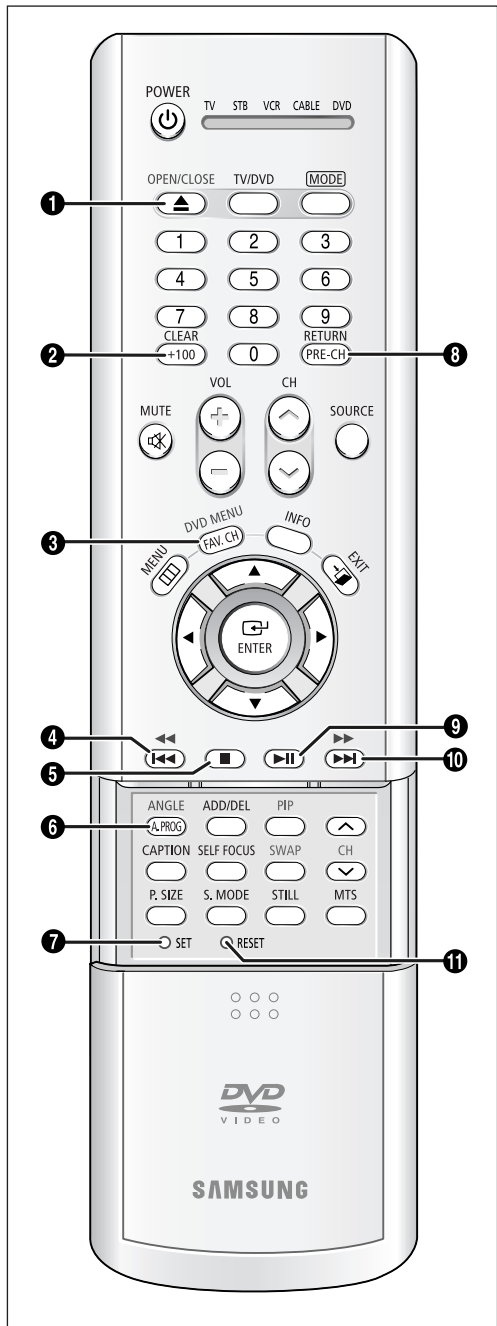

- 8 RETURN**
Press to return to a previous menu or exit.
- 9** ▶▶
Press to play or pause the disc.
- 10** ▶▶▶
Press to search forward through a disc.

▶▶▶
Press to skip the next title, chapter, or track.
- 11 RESET**
If your remote control is not functioning properly, take out the batteries and press the **RESET** button for about 2~3 seconds. Re-insert the batteries and try using the remote control again.

Chapter Two

INSTALLATION

Connecting VHF and UHF Antennas

Antennas with 300-ohm Flat Twin Leads

If you are using an off-air antenna (such as a roof antenna or “rabbit ears”) that has 300-ohm twin flat leads, follow the directions below.

1

Place the wires from the twin leads under the screws on the 300-75 ohm adaptor (not supplied). Use a screwdriver to tighten the screws.

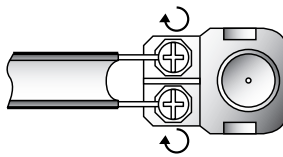

2

Plug the adaptor into the “ANT 1 IN” terminal on the rear panel.

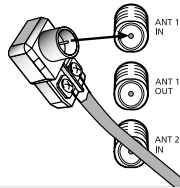

Antennas with 75-ohm Round Leads

Plug the antenna lead into the “ANT 1 IN” terminal on the rear panel.

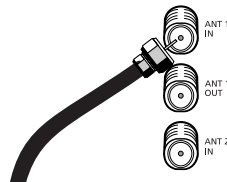

Separate VHF and UHF Antennas

If you have two separate antennas for your TV (one VHF and one UHF), you must combine the two antenna signals before connecting the antennas to the TV. This procedure requires an optional combiner-adaptor (available at most electronics shops).

1

Connect both antenna leads to the combiner.

2

Plug the combiner into the “ANT 1 IN” terminal on the rear panel.

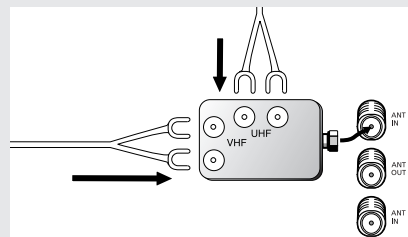

INSTALLATION

Connecting Cable TV

You can connect different cable systems to your TV, including cable without a cable box, and cable with a cable box that descrambles some or all channels.

Cable without a Cable Box

If you want to connect cable, and you do not need to use a cable box:

Plug the incoming cable into the "ANT 1 IN" terminal on the rear panel.

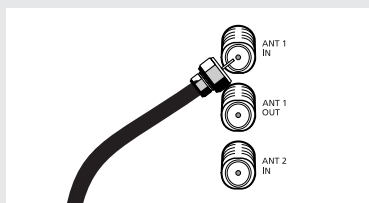

Cable with a Cable box that Descrambles All Channels

1

Find the cable that is connected to the ANTENNA OUT terminal on your cable box.



◀ This terminal might be labeled "ANT OUT", "VHF OUT", or simply "OUT".

2

Connect the other end of this cable to the "ANT 1 IN" terminal on the rear panel.

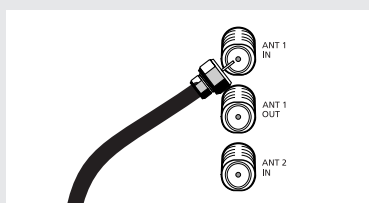



INSTALLATION

Connecting to a Cable Box that Descrambles Some Channels

If your cable box descrambles only some channels (such as premium channels), follow the instructions below. You will need a two-way splitter, an RF (A/B) switch, and four lengths of coaxial cable. (These items are available at most electronics stores.)

1
Find and disconnect the cable that is connected to the ANTENNA IN terminal on your cable box.

◀ This terminal might be labeled “ANT IN”, “VHF IN”, or simply “IN”.

2
Connect this cable to a two-way splitter. Connect a coaxial cable between an OUTPUT terminal on the splitter and the IN terminal on the cable box.

3
Connect a coaxial cable between the ANTENNA OUT terminal on the cable box and the B-IN terminal on the A/B switch.

4
Connect another cable between the other OUT terminal on the splitter and the A-IN terminal on the RF (A/B) switch.

5
Connect the last coaxial cable between the OUT terminal on the RF (A/B) switch and the “ANT 1 IN” terminal on the rear panel.

After you've made this connection, set the A/B switch to the “A” position for normal viewing. Set the A/B switch to the “B” position to view scrambled channels. (When you set the A/B switch to “B,” you will need to tune your TV to the cable box's output channel, which is usually channel 3 or 4.)

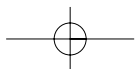

INSTALLATION

Connecting a VCR

These instructions assume that you have already connected your TV to an antenna or a cable TV system (according to the instructions on pages 11~13). Skip step **1** if you have not yet connected to an antenna or a cable system.

1

Connect a coaxial cable between the "ANT IN" (1 or 2) terminal on the TV and the ANTENNA OUT terminal on the VCR.

A coaxial cable is usually included with a VCR. (If not, check your local electronics store).

2

Connect a set of audio cables between the "AV IN 1 (L, R)" (or "AV IN 2 (L, R)") jacks on the TV and AUDIO OUT jacks on the VCR.

If you have a mono VCR, connect L(mono) to VCR audio out using only one audio cable.

3

Connect a video cable between the "AV IN 1 (VIDEO)" (or "AV IN 2 (VIDEO)") jack on the TV and the VIDEO OUT jack on the VCR.

Follow the instructions in "Viewing a VCR or Camcorder Tape" to view your VCR tape.

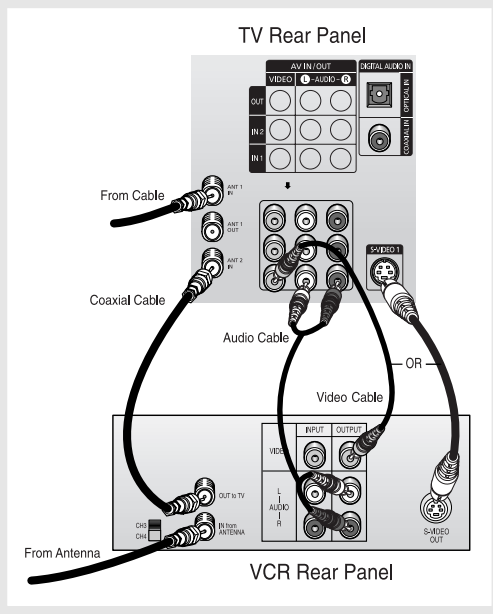

- Also, you can connect to "AV 3" on the side panel of TV.

Connecting a Second VCR to Record from the TV

Your TV can send out signals of its picture and sound to be recorded by a second VCR. To do this, connect your second VCR as follows:

1

Connect a set of audio cables between the "AV OUT (L, R)" jacks on the TV and the AUDIO IN jacks on the VCR.

(The VCR input jacks might be either on the front or rear of the VCR.)

2

Connect a video cable between the "AV OUT (VIDEO)" jack on the TV and the VIDEO IN jack on the VCR.

Refer to your VCR's instructions for more information about how to record using this kind of connection.

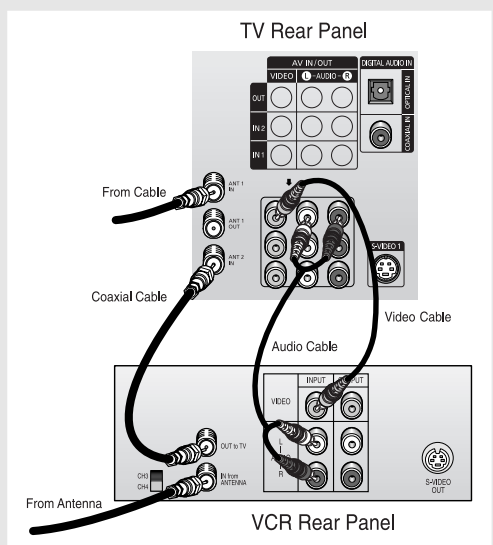

INSTALLATION

Connecting a DVD Player

The rear panel jacks on your TV make it easy to connect a DVD player to your TV.

Connecting to Y, PB, PR

1

Connect a set of audio cables between the "COMPONENT IN 1 (L, R)" (or "COMPONENT IN 2 (L, R)") jacks on the TV and the AUDIO OUT jacks on the DVD player.

2

Connect a set of video cables between the "COMPONENT IN 1 (Y, PB, PR)" (or "COMPONENT IN 2 (Y, PB, PR)") jacks on the TV and the VIDEO OUT (Y, PB, PR) jacks on the DVD player.

For an explanation of Component video, see your DVD player's owner's instruction.

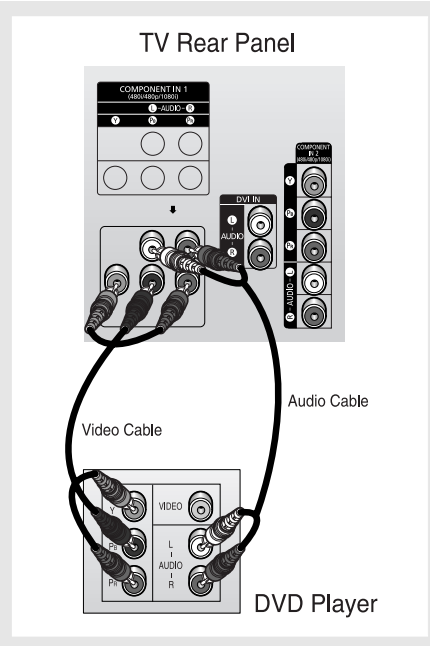

Connecting to Regular Audio and Video Jacks

1

Connect a set of audio cables between the "AV IN 1 (L, R)" (or "AV IN 2 (L, R)") jacks on the TV and the AUDIO OUT jacks on the DVD player.

2

Connect a video cable between the "AV IN 1 (VIDEO)" (or "AV IN 2 (VIDEO)") jack on the TV and the VIDEO OUT jack on the DVD player.

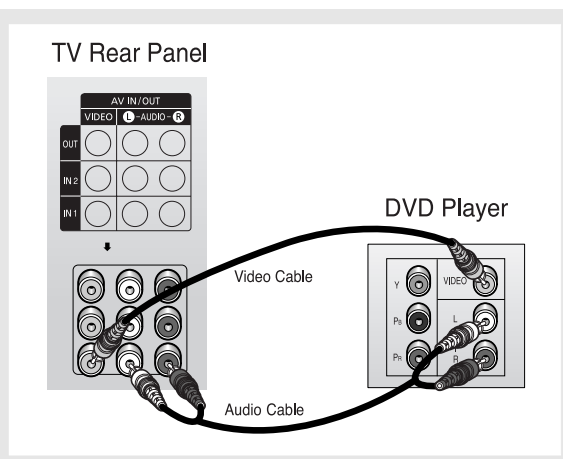

- Also, you can connect to "AV 3" on the side panel of TV.

INSTALLATION

Connecting a Digital TV Set-Top Box

The rear panel jacks on your TV make it easy to connect a Set-Top Box to your TV.

Connecting to Y, PB, PR

1

Connect a coaxial cable to the ANTENNA IN terminal on the Set-Top Box.

2

Connect a set of audio cables between the "COMPONENT IN 1 (L, R)" (or "COMPONENT IN 2 (L, R)") jacks on the TV and the AUDIO OUT jacks on the Set-Top Box.

3

Connect a set of video cables between the "COMPONENT IN 1 (Y, Pb, Pr)" (or "COMPONENT IN 2 (Y, Pb, Pr)") jacks on the TV and the VIDEO OUT (Y, Pb, Pr) jacks on the Set-Top Box.

The connections for a typical Set-Top Box are shown. For detailed information, refer to the Set-Top Box instruction manual.

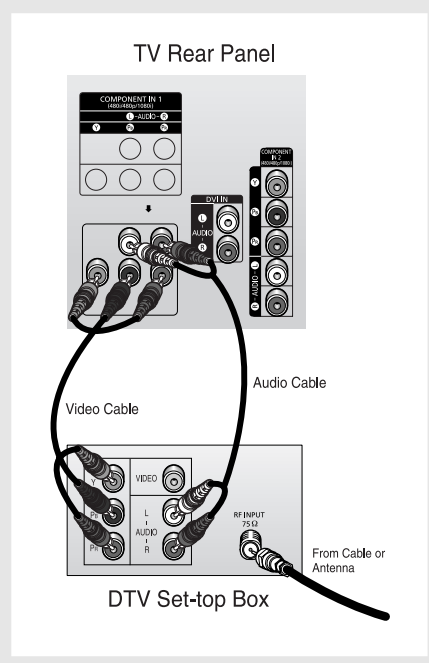

INSTALLATION

Connecting to DVI (Digital Visual Interface)

By inputting a high-bandwidth digital content protection high-definition picture source to the DIGITAL INPUT jack on the TV, high-definition pictures can be displayed on the screen in their digital forms. (This DIGITAL INPUT jack is for use in the future when high-bandwidth digital content protection DTV decoders, DVD players and D-VHS are put on the market.)

1

Connect a set of audio cables between the "DVI IN (AUDIO-L, R)" jacks on the TV and the AUDIO OUT jacks on the Set-Top Box.

2

Connect a video cable between the "HDMI/DVI IN" jack on the TV and the VIDEO OUT jack on the Set-Top Box.

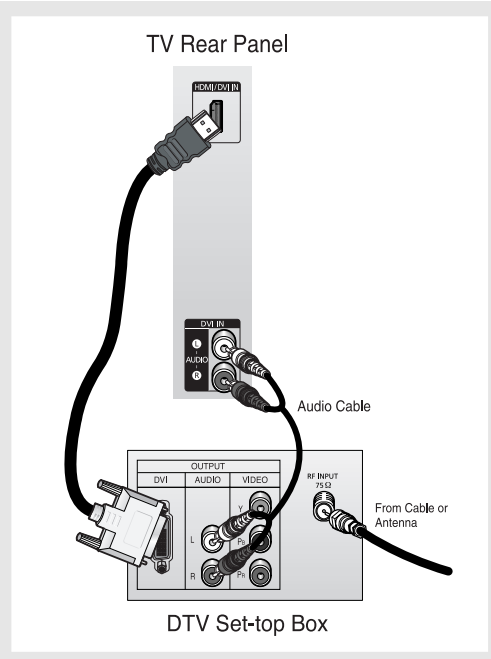

- The DIGITAL INPUT jack can only be used with 1080i and 480p picture signals. Set the DTV decoder DIGITAL OUTPUT jack output setting to 1080i or 480p. The DIGITAL INPUT jack is not compatible with the picture signal of a PC.

Connecting to HDMI (High Definition Multimedia Interface)

Connect a HDMI cable between the "HDMI/DVI IN" jacks on the TV and the HDMI OUT jacks on the Set-Top Box.

Please check that the HDMI source is powered on. If not, you can not select "HDMI" in the "Source List" on-screen menu.

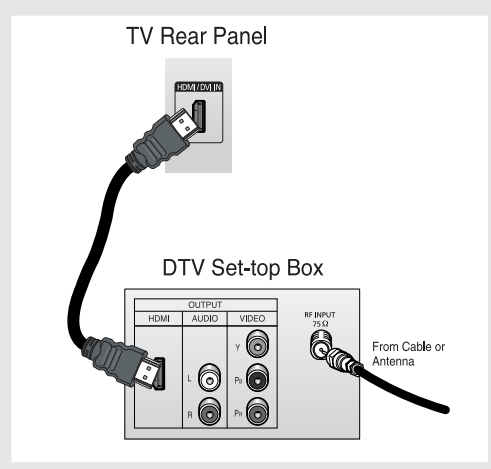

INSTALLATION

Connecting a Camcorder

The side panel jacks on your TV make it easy to connect a camcorder to your TV. They allow you to view the camcorder tapes without using a VCR.

1

Locate the A/V output jacks on the camcorder. They are usually found on the side or rear of the camcorder.

2

Connect a set of audio cables between the "AV 3 (L, R)" jacks on the TV and the AUDIO OUT jacks on the camcorder. If you have mono camcorder, connect L(mono) to camcorder audio out using only one audio cable.

3

Connect a video cable between the "AV 3 (VIDEO)" (or "S-VIDEO2 INPUT") jack on the TV and the VIDEO OUT jacks on the camcorder.

The audio-video cables shown here are usually included with a Camcorder. (If not, check your local electronics store.) If your camcorder is stereo, you need to connect a set of two cables.

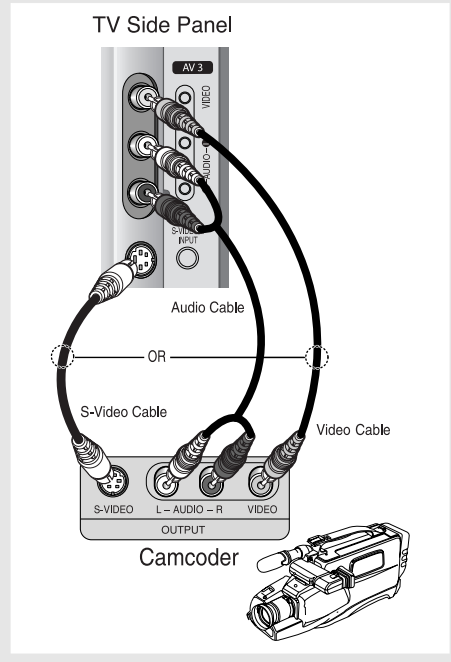

Connecting to the Digital Audio Input

The rear panel jacks on your TV make it easy to connect a device with digital audio output. After making a connection, set the audio input by reference to page 51.

Connect a audio (or optical) cable between the "COAXIAL IN" (or "OPTICAL IN") jack on the TV and the AUDIO OUT jack on a device with digital audio output.

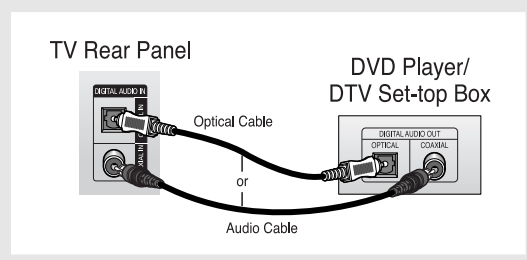

INSTALLATION

Connecting Additional Speakers

The rear panel jacks on your TV make it easy to take advantage of the surround sound system.

1

Connect speaker audio cables to "SURROUND SPEAKER OUT" terminals on the TV.

To improve the sound quality, connect the Red wire to the Red terminal and Black wire to the Black terminal.

2

The factory default of "SURROUND SPEAKER OUT SELECTION" is set to "INT" (Internal). For sound output to external speakers, set to "EXT" (External), then sound to the internal speaker is off.

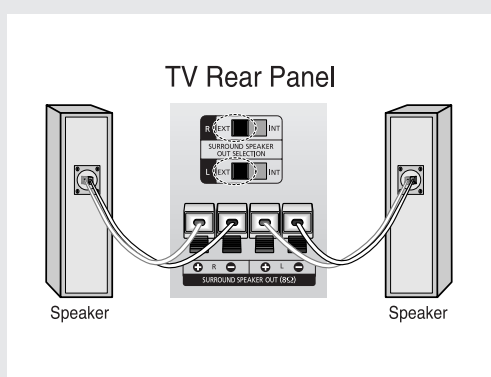

- The speakers MUST have to a power handling capability of 10 watts minimum (impedance 8 Ω).

Installing Batteries in the Remote Control

1

Slide the back cover all the way out to open the battery compartment of the remote control.

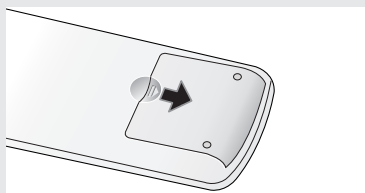

2

Install two AAA size batteries.

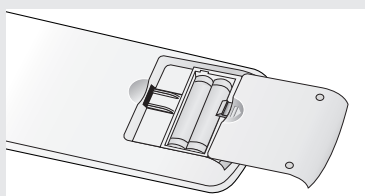

◀ Make sure to match the "+" and "-" ends of the batteries with the diagram inside the compartment.

3

Replace the cover.

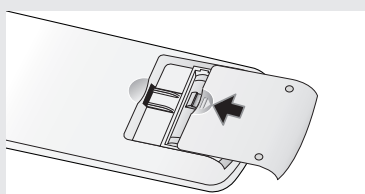

◀ Remove the batteries and store them in a cool, dry place if you won't be using the remote control for a long time. (Assuming typical TV usage, the batteries last for about one year.)

- The remote control can be used up to about 23 feet from the TV.

Chapter Three

TV OPERATION

Turning the TV On and Off

Press the **POWER** button on the remote control.
You can also use the **POWER** button on the front panel.

Plug & Play Feature

When the TV is initially powered On, basic customer settings proceed automatically and subsequently as below.

1

Press the **POWER** button on the remote control.
The "Start Plug & Play" is displayed.
Press the **ENTER** button to start.



◀ Plug & Play feature doesn't work when the V-Chip is activated or when in the A/V mode.

2

The "Language" menu is displayed.
Press the **▲** or **▼** button to select the appropriate language, then press the **ENTER** button.



3

The "Check antenna input" is displayed.
Make sure that the antenna is connected to the TV, then press the **ENTER** button.

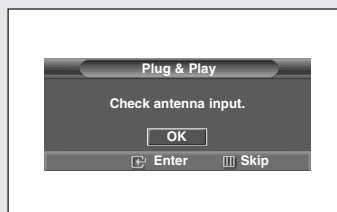

4

The "Air/CATV" menu is displayed.
Press the **▲** or **▼** button to select the video signal source, then press the **ENTER** button.

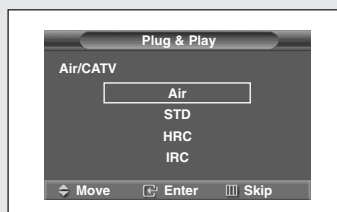

TV OPERATION

5

The "Auto Program" menu is displayed.
 Press the **ENTER** button to start the auto program.
 The TV begins memorizing all of the available stations.



◀ For details, see page 27.

6

When it has finished, the "Clock Set" menu is displayed.
 Set the clock.

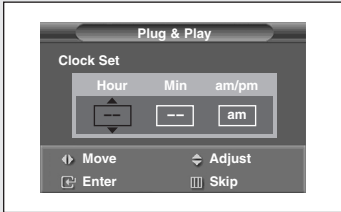

◀ For details, see page 52.

7

When you have finished, press the **ENTER** button.
 The message "Enjoy your watching" is displayed.



8

If you want to reset this feature:
 Press the **MENU** button.
 Press the **▲** or **▼** button to select "Setup", then press the **ENTER** button.
 Press the **▲** or **▼** button to select "Plug & Play", then press the **ENTER** button.
 The "Plug & Play" is displayed.



TV OPERATION

Viewing the Menu and On-Screen Displays

Viewing the Menus

1

Press the **MENU** button.
The main menu is displayed.
There are five menu groups:
"Input", "Picture", "Sound",
"Channel" and "Setup".



2

Press the **▲** or **▼** button to move to an item you want in the menu.
Press the **◀** or **▶** button to display, change or use the selected items.
Press the **ENTER** button to enter items in the menu.



◀ You can also use the **MENU**, **CH▲/▼**, **VOL+/-** and **ENTER** buttons on the control panel of the TV to make selections.

3

Press the **EXIT** button to exit.

Viewing the Display

Press the **INFO** button on the remote control.
The TV displays the current channel, the status of certain picture and sound settings and the current time.

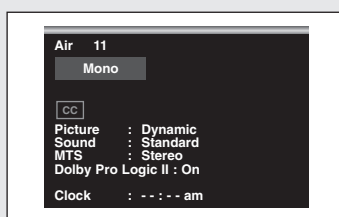

TV OPERATION

Selecting a Menu Language

1

Press the **MENU** button.
Press the **▲** or **▼** button to select "Setup", then press the **ENTER** button.



2

Press the **▲** or **▼** button to select "Language", then press the **ENTER** button.

Press the **▲** or **▼** button to select the appropriate language, then press the **ENTER** button.

Press the **EXIT** button to exit.



Selecting the Antenna Input

You can connect two different signal sources by choosing the antenna input ("Ant.1" or "Ant.2").

1

Press the **MENU** button.
Press the **▲** or **▼** button to select "Channel", then press the **ENTER** button.



2

Press the **ENTER** button to select "Antenna".

Press the **▲** or **▼** button to select "Ant.1" or "Ant.2", then press the **ENTER** button.

Press the **EXIT** button to exit.



TV OPERATION

Adjusting the Screen Automatically (Self Focus)

The “Self Focus” feature automatically finds the optimum picture quality when blurring, overlapping colors or incorrect focus occurs. These conditions may be caused by moving your TV.

1

Press the **MENU** button.
Press the **▲** or **▼** button to select “Setup”, then press the **ENTER** button.



2

Press the **▲** or **▼** button to select “Self Focus”, then press the **ENTER** button.
The “Self Focus” is selected.

Press the **ENTER** button again.
The self focus process begins with the message “Self Focus” and horizontal bar is displayed. When it is finished, all of things will disappear and the optimum picture quality can be enjoyed.

Press the **EXIT** button to exit.

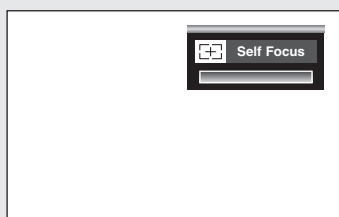
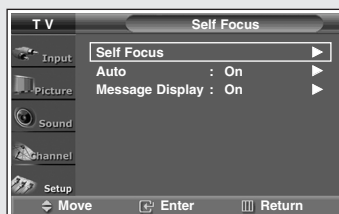

◀ During the process, minor distortions of the picture may occur. At this time, the colors may diffuse and a searching pattern will appear on the edges of the screen. This is a normal part of the adjustment.

Alternate method:

Simply press the **SELF FOCUS** button on the remote control to enjoy the optimum picture quality.



- Changing channels and any other signal changes will pause the self focus until a stable signal has returned. It resumes after the signal has been stabilised. This feature will not work without a signal
- Ambient light that is too bright may affect the self focus. If this occurs, darken the environment and try again.

TV OPERATION

Deactivating the Automatic Execution of the Self Focus

The “Self Focus” feature starts on default. It will automatically begin 10 minutes after switching on the power and the appearance of the screen image. To set the optimum picture quality, the “Self Focus” will automatically begin again after another 30 minutes, as the screen image is then fully stabilised.

1

Press the **MENU** button.
Press the **▲** or **▼** button to select “Setup”, then press the **ENTER** button.



2

Press the **▲** or **▼** button to select “Self Focus”, then press the **ENTER** button.

Press the **▲** or **▼** button to select “Auto”, then press the **ENTER** button.
To turn off the automatic execution of the self focus feature, select “Off” by pressing the **▲** or **▼** button, then press the **ENTER** button.



Removing the “Self Focus” Message from the Display

3

Press the **▲** or **▼** button to select “Message Display”, then press the **ENTER** button.
To remove the message “Self Focus” and horizontal bar on the screen during the self focus process, select “Off” by pressing the **▲** or **▼** button, then press the **ENTER** button.

Press the **EXIT** button to exit.



TV OPERATION

Memorizing the Channels

Your TV can memorize and store all of the available channels for both “off-air” (antenna) and cable channels. After the available channels are memorized, use the **CH▲** and **CH▼** buttons to scan through the channels. This eliminates the need to change channels by entering the channel digits.

Selecting the Video Signal Source

Before your TV can begin memorizing the available channels, you must specify the type of signal source that is connected to the TV (i.e., an antenna or a cable system).

1

Press the **MENU** button.
Press the **▲** or **▼** button to select “Channel”, then press the **ENTER** button.



2

Press the **▲** or **▼** button to select “Air/CATV”, then press the **ENTER** button.

Press the **▲** or **▼** button to select “Air”, “STD”, “HRC” or “IRC”, then press the **ENTER** button.

Press the **EXIT** button to exit.



◀ If you are connected to an antenna, press the **▲** or **▼** button to select “Air”.

◀ If you connected cable, press the **▲** or **▼** button to select the type of cable system: “STD”, “HRC” or “IRC”.

- “STD”, “HRC” and “IRC” identify various types of cable TV systems. Contact your local cable company to identify the type of cable system that exists in your particular area. At this point the signal source has been selected. Proceed to “Storing Channels in Memory Automatically”.
- Subscription cable services require service-specific requirement for viewing.

TV OPERATION

Storing Channels in Memory Automatically

First, select the correct signal source (“Air”, “STD”, “HRC” or “IRC”) as described on the previous page.

1

Press the **MENU** button.
Press the **▲** or **▼** button to select “Channel”, then press the **ENTER** button.



2

Press the **▲** or **▼** button to select “Auto Program”, then press the **ENTER** button.

Press the **ENTER** button to start the auto program.

The TV begins memorizing all of the available stations.

Press the **ENTER** button at any time to interrupt the memorization process.

Press the **EXIT** button to exit.

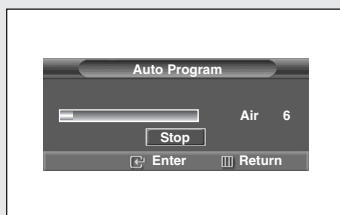
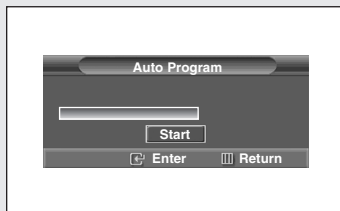

TV OPERATION

Changing Channels

Using the Channel Buttons

Press the **CH \wedge** or **CH \vee** button to change channel.

When you press the **CH \wedge** or **CH \vee** button, the TV changes channels in sequence. You will see all the channels that the TV has memorized. (The TV must have memorized at least three channels.) You will not see channels that were either erased or not memorized.

Using the Number Buttons

Use the number buttons to quickly tune to any channel.

Press the number buttons to go directly to a channel.
For example, to select channel "27", press the "2", then "7". The TV will change channels when you press the second number.

When you use the number buttons, you can directly select channels that were either erased or not memorized.

To select a channel over 100, press the **+100** button. (For channel "122", press the **+100** button, then "2", then "2".)

To change to single-digit channels (0-9) faster, press the "0" before the single digit. (For channel "4", press the "0", then "4".)

Using the Previous Channel

Press the **PRE-CH** button.
The TV changes to the last channel you were watching.



TV OPERATION

Adding and Erasing Channels

To add channels that were not memorized (or to delete unwanted channels from memory):

1

Press the **MENU** button.
Press the **▲** or **▼** button to select "Channel", then press the **ENTER** button.



2

Press the **▲** or **▼** button to select "Add/Delete", then press the **ENTER** button.

Repeatedly pressing the **ENTER** button will alternate between add channel and delete channel. Press the **CH▲** or **CH▼** button to switch to the appropriate channel, then repeat above.

Press the **EXIT** button to exit.

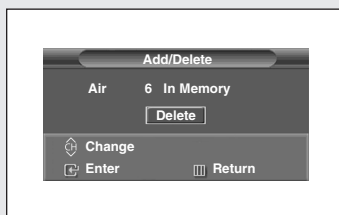
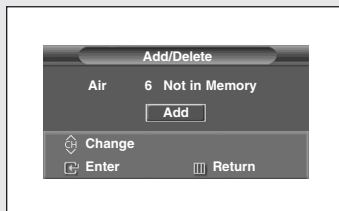

Alternate method:

Simply press the **ADD/DEL** button on the remote control to add channels that were not memorized or to delete unwanted channels from memory.

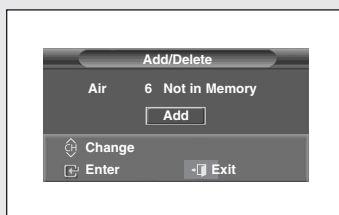

TV OPERATION

Selecting Your Favorite Channels

You can store your favorite channels for each available input source (such as TV and CATV). This allows you to quickly and easily find frequently watched channels by pressing the **FAV.CH** button on the remote control.

To Store Your Favorite Channels:

1

Press the **MENU** button.
Press the **▲** or **▼** button to select "Channel", then press the **ENTER** button.



2

Press the **▲** or **▼** button to select "Favorite Channels", then press the **ENTER** button.

Press the **▲** or **▼** button to select a channel, then press the **ENTER** button.
Press the **ENTER** button again to deselect the selected channel.

Press the **EXIT** button to exit.

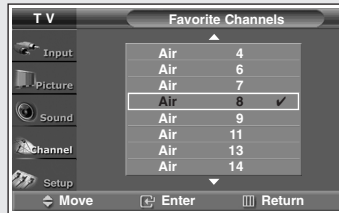

◀ Only memorized channels can be set as Favorite channels.

To View Your Favorite Channels:

Press the **FAV.CH** button repeatedly to jump from one favorite channel to another.

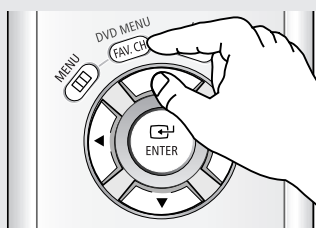

TV OPERATION

Labeling the Channels

Use this feature to assign an easy-to-remember label to any channel (i.e., “CBS”, “ESPN”, “PBS2”, CNN1”, etc.) A label consists of five fields, where each field is a letter, a number or a blank. When the **INFO** button is pressed, the channel label will appear next to the channel number.

1

Press the **CH**▲ or **CH**▼ button to tune to the channel that will be labeled.

2

Press the **MENU** button.
Press the ▲ or ▼ button to select “Channel”, then press the **ENTER** button.



3

Press the ▲ or ▼ button to select “Name”, then press the **ENTER** button.

Press the ▲ or ▼ button to select the channel to be assigned to a new name, then press the **ENTER** button.

Press the ▲ or ▼ button to select a letter, a number or a blank. (Results in this sequence: A...Z, -, 0...9, blank, *).

Press the ► button to switch to the next field, which will be selected.

Select a second letter or digit pressing ▲ or ▼ button, as above. Repeat the process to select the last two digits.

When you have finished, press the **ENTER** button.

Press the **EXIT** button to exit.

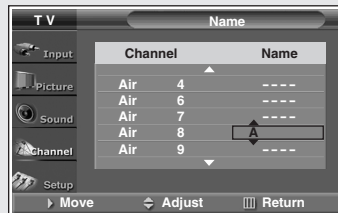

◀ If you add or delete the TV channel, the labeled channels list will also be added or deleted.

TV OPERATION

Scanning the Channels

The TV automatically scan all of the channels it has memorized.

- 1**
 Press the **MENU** button.
 Press the **▲** or **▼** button to select "Channel", then press the **ENTER** button.



- 2**
 Press the **▲** or **▼** button to select "Scan", then press the **ENTER** button.
 The TV scans all of the channels memorized.

Press the **EXIT** button to exit.

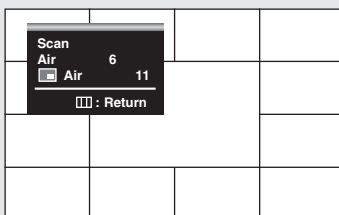

◀ When the "ANT 2 IN" mode is selected, the channel scan function works on the main picture only.

TV OPERATION

Fine Tuning Channels

The Fine Tuning function lets you manually adjust the TV's tuner if you have difficulty tuning channels.

1

Press the **MENU** button.
Press the **▲** or **▼** button to select "Channel", then press the **ENTER** button.



2

Press the **▲** or **▼** button to select "Fine Tune", then press the **ENTER** button.

Press the **◀** or **▶** button to adjust the fine tuning.

To store the fine tuning setting in the TV's memory, press the **ENTER** button. The symbol "*" is displayed.

To reset the fine tuning to "0", select "Reset" by pressing the **▲** or **▼** button, then press the **ENTER** button.

Press the **EXIT** button to exit.

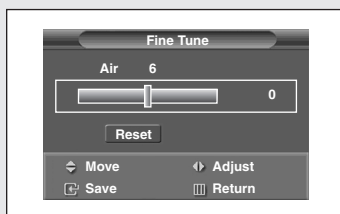

TV OPERATION

Using Automatic Picture Settings

Your TV has automatic picture settings (“Dynamic”, “Standard” and “Movie”) that are preset at the factory. You can activate either “Dynamic”, “Standard” or “Movie” by making a selection from the menu. Or, you can select “Custom” which automatically recalls your personalized picture settings.

1

Press the **MENU** button.
Press the **▲** or **▼** button to select “Picture”, then press the **ENTER** button.

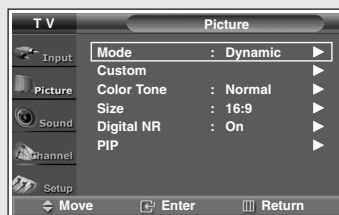

2

Press the **ENTER** button to select “Mode”.

Press the **▲** or **▼** button to select a particular item, then press the **ENTER** button.

Press the **EXIT** button to exit.

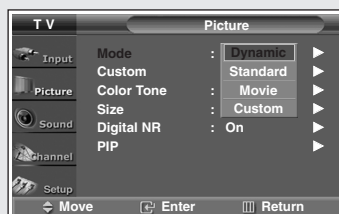

- Choose **Dynamic** for viewing the TV during the day or when there is a bright light in the room.
- Choose **Standard** for the standard factory settings.
- Choose **Movie** when viewing a movie.
- Choose **Custom** if you want to adjust the settings according to personal preference (see next page).

TV OPERATION

Customizing the Picture

You can use the on-screen menus to change the “Contrast”, “Brightness”, “Sharpness”, “Color” and “Tint” according to personal preference.

1

Press the **MENU** button.
Press the **▲** or **▼** button to select “Picture”, then press the **ENTER** button.

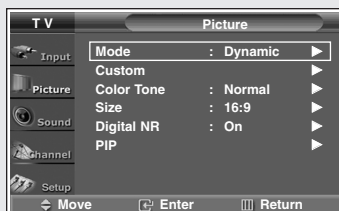

2

Press the **▲** or **▼** button to select “Custom”, then press the **ENTER** button.

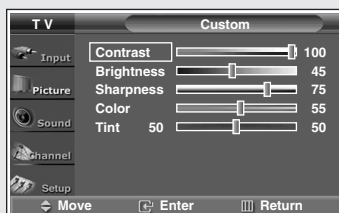

3

Press the **▲** or **▼** button to select a particular item, then press the **ENTER** button.

Press the **◀** or **▶** button to increase or decrease the value of a particular item.

Press the **EXIT** button to exit.



TV OPERATION

Selecting the Color Tone

1

Press the **MENU** button.
Press the **▲** or **▼** button to select "Picture", then press the **ENTER** button.

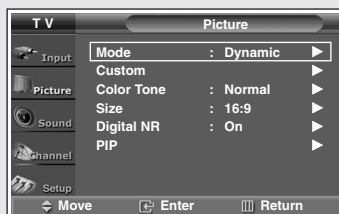

2

Press the **▲** or **▼** button to select "Color Tone", then press the **ENTER** button.

Press the **◀** or **▶** button to increase or decrease the value of the color tone ("Warm 10~1", "Normal" and "Cool 1~10").

Press the **EXIT** button to exit.

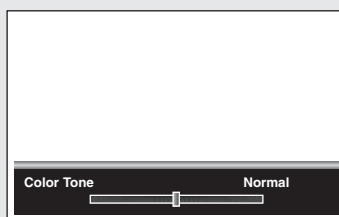

TV OPERATION

Changing the Picture Size

1

Press the **MENU** button.
Press the **▲** or **▼** button to select "Picture", then press the **ENTER** button.

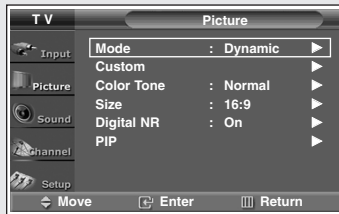

2

Press the **▲** or **▼** button to select "Size", then press the **ENTER** button.

Press the **▲** or **▼** button to select the screen format you want.

Press the **EXIT** button to exit.



◀ In the "Zoom 1" and "Zoom 2" modes, lifting is available by pressing the **▲** or **▼** button.

◀ Captions or subtitles might be interrupted in the "Cinematic" and "Cinema2" modes.

Alternate method:

Press the **P.SIZE** button on the remote control repeatedly to select one of the screen format you want.

Viewing with a 4:3 signal (When a 4:3 signal is received)

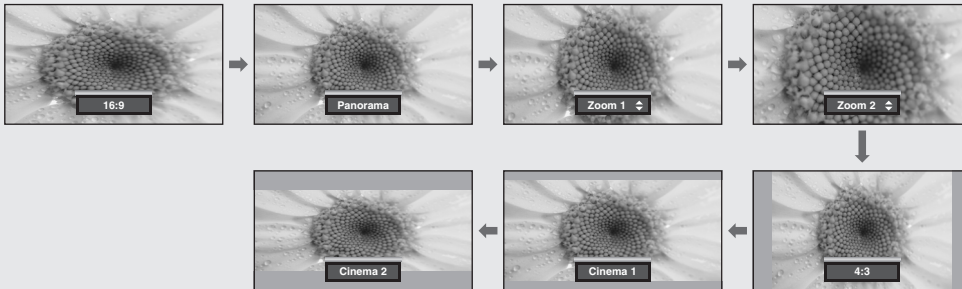

Viewing with a 16:9 signal (When a 16:9 signal is received)

The illustrations below show the change of picture while viewing a DVD title.

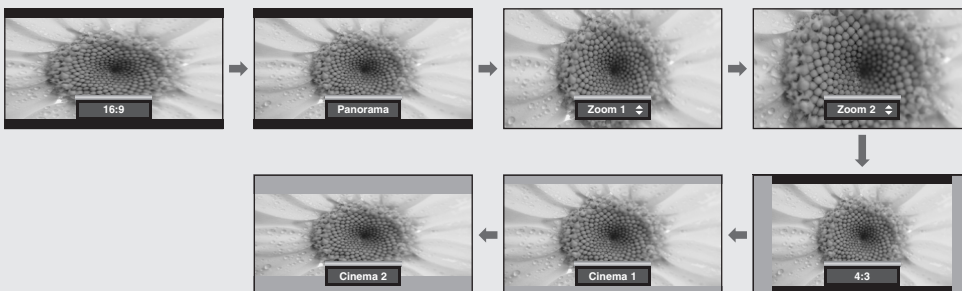

TV OPERATION

Digital Noise Reduction

If the broadcast signal received by your TV is weak, you can activate this feature to help reduce any static and ghosting that may appear on the screen.

1

Press the **MENU** button.
Press the **▲** or **▼** button to select "Picture", then press the **ENTER** button.

**2**

Press the **▲** or **▼** button to select "Digital NR", then press the **ENTER** button.
Press the **▲** or **▼** button to select "On" or "Off", then press the **ENTER** button.

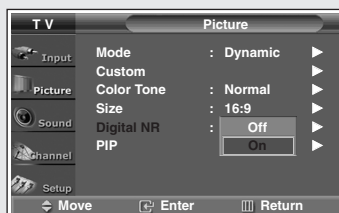

Press the **EXIT** button to exit.

TV OPERATION

Viewing Picture-In-Picture

One of the most best features of your TV is the **Picture-In-Picture (PIP)** feature. The advanced **PIP** system allows you to watch two different pictures at once, even if you don't have a VCR connected to your TV.

Activating the PIP

1

Press the **MENU** button.
Press the **▲** or **▼** button to select "Picture", then press the **ENTER** button.

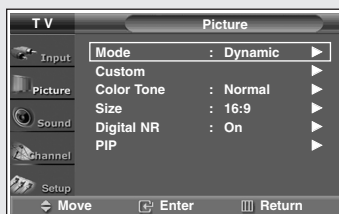

2

Press the **▲** or **▼** button to select "PIP", then press the **ENTER** button.

Press the **ENTER** button to select "PIP".

Press the **▲** or **▼** button to select "On", then press the **ENTER** button.

The sub picture appears in the corner of the screen.

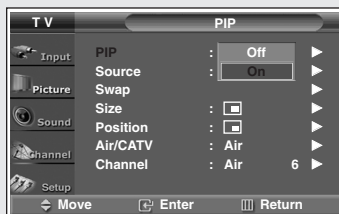

Alternate method:

Press the **PIP** button on the remote control repeatedly to activate or deactivate the PIP.

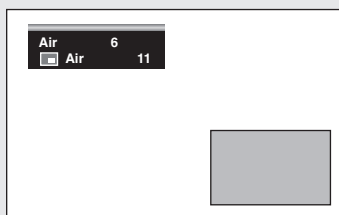

- This feature doesn't work when the "V-Chip" or "Caption" is active.
- If you turn the TV off while watching and turn it on again, then the mode will return to normal video.
- The picture size can't be changed when the "PIP" is active in the TV or AV mode.

TV OPERATION

Selecting an External Source

3

Press the ▲ or ▼ button to select "Source", then press the **ENTER** button.

If you have not connected any equipment to the TV's input jacks, the signal from these inputs will not appear.

Press the ▲ or ▼ button to select an external signal, then press the **ENTER** button.

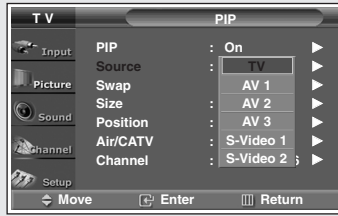

◀ For more information about external signals, see page 67). If you select "TV", the sub picture is the same as the main picture.

◀ The sub picture doesn't support "ANT 2 IN", "Component1", "Component2", "Component3" and "HDMI".

Swapping the Sub picture and Main picture

4

Press the ▲ or ▼ button to select "Swap", then press the **ENTER** button.

The sub picture appears in the main picture, and vice versa.

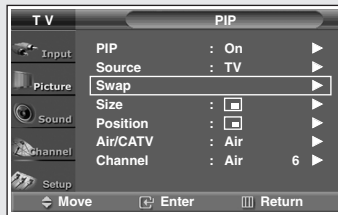

◀ The swapping doesn't support "ANT 2 IN", "Component1", "Component2", "Component3" and "HDMI".

◀ The swapping doesn't work in the "4PIP" and "13PIP" mode.

Changing the Size of the Sub picture

5

Press the ▲ or ▼ button to select "Size", then press the **ENTER** button.

Press the ▲ or ▼ button to select a size you want, then press the **ENTER** button.

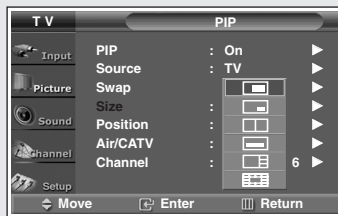

◀ "Double" function doesn't operate in the "HDMI" mode.

TV OPERATION

Changing the Location of the Sub picture

6

Press the ▲ or ▼ button to select "Position", then press the **ENTER** button.

Press the ▲ or ▼ button to select a position you want, then press the **ENTER** button.

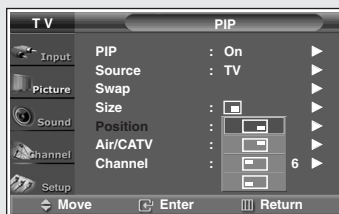

Selecting a Signal Source for the Sub picture

If the source of the sub picture is "TV" during PIP on, you can select a signal source of the sub picture separately from the main picture. (If the main picture is "ANT 2 IN" and the signal sources are different, making adjustments is necessary.)

7

Press the ▲ or ▼ button to select "Air/CATV", then press the **ENTER** button.

Press the ▲ or ▼ button to select "Air", "STD", "HRC" or "IRC", then press the **ENTER** button.

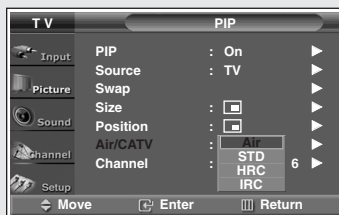

TV OPERATION

Changing the Channel of the Sub picture

After you set the signal source (antenna or cable) of sub picture, it is easy to change channels.

8

Press the ▲ or ▼ button to select "Channel", then press the **ENTER** button.

Press the ▲ or ▼ button to select a channel you want, then press the **ENTER** button.

Press the **EXIT** button to exit.

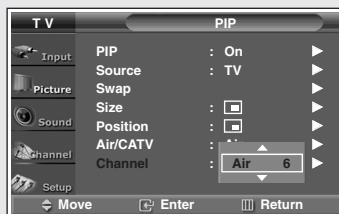

◀ The channels of sub picture are not available when antenna is set to "ANT 2 IN". It links to "ANT 1 IN".

Alternate method:

Press the **CH▲** or **CH▼** button to change channels of sub picture during PIP on.

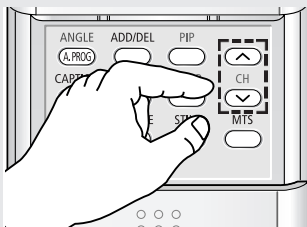

Freezing the Picture

Press the **STILL** button to freeze a moving picture. (Normal sound will still be heard.)

Press again to cancel.

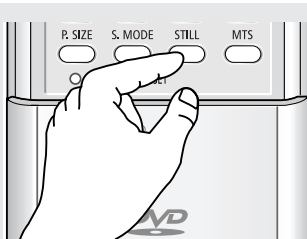

◀ The still function doesn't operate in "Component 1, 2" mode.

TV OPERATION

Adjusting the Volume

Press the **VOL +** or **VOL -** buttons to increase or decrease the volume.

Using the MUTE Button

At any time, you can temporarily cut off the sound by using the **MUTE** button.

1

Press the **MUTE** button on the remote control. The message "Mute" is displayed and the sound cuts off.

**2**

To turn mute off press the **MUTE** button again or, press either the **VOL-** or **VOL+** button.

TV OPERATION

Using Automatic Sound Settings

Your TV has automatic sound settings (“Standard”, “Music”, “Movie” and “Speech”) that are preset at the factory. You can activate these sound settings by pressing the **S.MODE** button (or by making a selection from the menu), or you can select “Custom”, which automatically recalls your personalized sound settings.

1

Press the **MENU** button.
Press the **▲** or **▼** button to select “Sound”, then press the **ENTER** button.

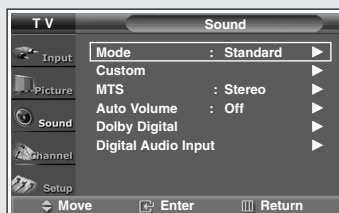

2

Press the **ENTER** button to select “Mode”.

Press the **▲** or **▼** button to select a particular item, then press the **ENTER** button.

Press the **EXIT** button to exit.



Alternate method:

Press the **S.MODE** button on the remote control repeatedly to select one of the standard sound settings.

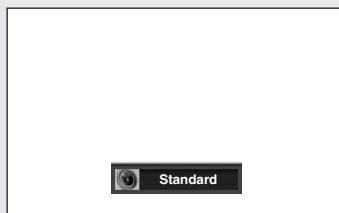

- Choose **Standard** for the standard factory settings.
- Choose **Music** when watching music videos or concerts.
- Choose **Movie** when watching movies.
- Choose **Speech** when watching a show that is mostly dialogue (i.e., news).
- Choose **Custom** to recall your personalized settings.

TV OPERATION

Customizing the Sound

The sound settings can be adjusted to suit your personal preference.

1

Press the **MENU** button.
Press the **▲** or **▼** button to select "Sound", then press the **ENTER** button.



2

Press the **▲** or **▼** button to select "Custom", then press the **ENTER** button.

Press the **▲** or **▼** button to select a particular item to be changed.

Press the **◀** or **▶** button to increase or decrease the value of a particular item.

Press the **EXIT** button to exit.

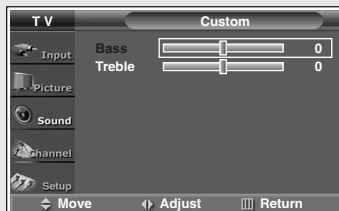

TV OPERATION

Choosing a Multi-Channel Sound (MTS) track

Depending on the particular program being broadcast, you can listen to “Mono”, “Stereo” or “SAP (Secondary Audio Program)”. “SAP” audio is usually a foreign-language translation. Sometimes “SAP” has unrelated information like news or weather.

1

Press the **MENU** button.
Press the **▲** or **▼** button to select “Sound”, then press the **ENTER** button.

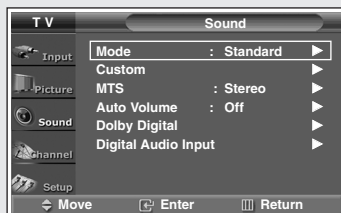

2

Press the **▲** or **▼** button to select “MTS”, then press the **ENTER** button.
Press the **▲** or **▼** button to select a setting you want, then press the **ENTER** button.

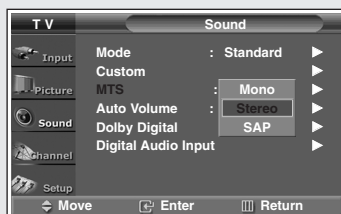

Press the **EXIT** button to exit.

Alternate method:

Press the **MTS** button on the remote control repeatedly to select one of the settings.

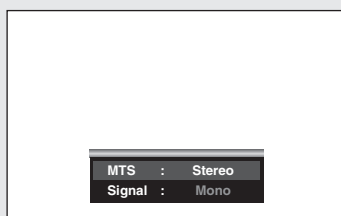

- Choose **Mono** for channels that are broadcasting in mono, or if you are having difficulty receiving a stereo signal.
- Choose **Stereo** for channels that are broadcasting in stereo.
- Choose **SAP** to listen to the Separate Audio Program, which is usually a foreign-language translation.

TV OPERATION

Auto Volume

Each broadcasting station has its own signal conditions, and it is inconvenient to adjust the volume every time the channel is changed. "Auto Volume" automatically adjusts the volume of the desired channel by lowering the sound output when the modulation signal is high or by raising the sound output when the modulation signal is low.

1

Press the **MENU** button.
Press the **▲** or **▼** button to select "Sound", then press the **ENTER** button.

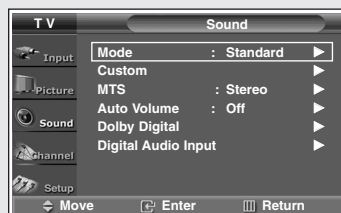

2

Press the **▲** or **▼** button to select "Auto Volume", then press the **ENTER** button.
Press the **▲** or **▼** button to select "On" or "Off", then press the **ENTER** button.



Press the **EXIT** button to exit.

TV OPERATION

Setting the Dolby Digital

The “Dolby Digital” mode allows you enjoy Dolby Digital sound effect fully with the speakers are connected to your TV.

This allows various modes for the main, center, surround and woofer speakers to be selected.

Enjoying Dolby Surround Sound

Converts and outputs mono and stereo audio signals into a 5.1 channel surround sound audio signal.

1

Press the **MENU** button.
Press the **▲** or **▼** button to select “Sound”, then press the **ENTER** button.

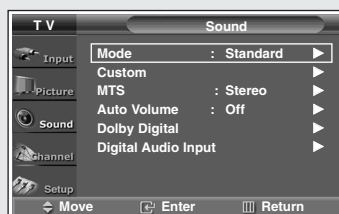

2

Press the **▲** or **▼** button to select “Dolby Digital”, then press the **ENTER** button.
The “Dolby Pro Logic II” is selected.

Press the **ENTER** button again.
Press the **▲** or **▼** button to select “On”, then press the **ENTER** button.

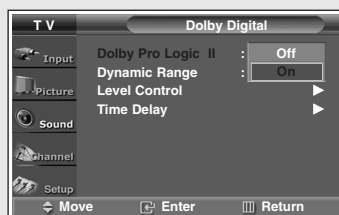

Manufactured under license from Dolby Laboratories. “Dolby”, “Pro Logic”, and the double-D symbol are trademarks of Dolby Laboratories.



Manufactured under license from Digital Theater Systems, Inc. US Pat. No. 5,451,942, 5,956,674, 5,974,380, 5,978,762 and other world-wide patents issued and pending. “DTS” and “DTS Digital Surround” are registered trademarks of Digital Theater Systems, Inc. Copyright 1996, 2000 Digital Theater Systems, Inc. All Rights Reserved.



TV OPERATION

Setting the Dynamic Range

Reduces the difference between low and high pitched tones to suitable output levels, recommended for night time use.

3

Press the ▲ or ▼ button to select "Dynamic Range", then press the **ENTER** button. Press the ▲ or ▼ button to select "On", then press the **ENTER** button.



◀ This function only works when Dolby Digital is activated.

Adjusting Speaker Levels

The Test Tone confirms the speaker connections and aligns the levels of the speaker outputs. The order of the Test Tone sounds is as follow: Front Left -> Center -> Front Right -> Rear Right -> Rear Left -> Sub Woofer

4

Press the ▲ or ▼ button to select "Level Control", then press the **ENTER** button.

Press the **ENTER** button to select "Test Tone".

Press the ▲ or ▼ button to select "On", then press the **ENTER** button.



◀ The Test Tone for the sub woofer is very low frequency. This is normal, not a malfunction.

5

Press the ▲ or ▼ button to select the speaker to be adjusted, then press the **ENTER** button.

Press the ◀ or ▶ button to increase or decrease the volume of selected speaker, then press the **ENTER** button.



TV OPERATION

Adjusting the Time Delay for Surround Sound Speakers

To maximize the surround effect, adjust the Time Delays for the left / right surround sound speakers according to the particular nuances of your listening room.

6

Press the **MENU** button to return to the "Dolby Digital" menu.

Press the **▲** or **▼** button to select "Time Delay", then press the **ENTER** button.

Press the **▲** or **▼** button to select the speaker to be adjusted, then press the **ENTER** button.

Press the **◀** or **▶** button to adjust the delay time of surround channel, then press the **ENTER** button.

Press the **EXIT** button to exit.

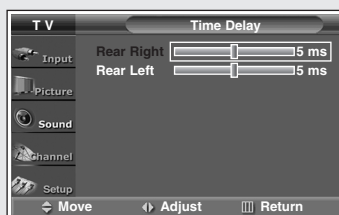

TV OPERATION

Selecting a Digital Audio Source

Before selecting an audio source, be sure that the OPTICAL or COAXIAL audio inputs on the rear of the TV are connected to the audio source.

The “Optical” and “Coaxial” options are for digital audio inputs, such as the Dolby Digital (5.1ch), Dolby Prologic (4ch), DTS or MPEG.

1

Press the **MENU** button.
Press the **▲** or **▼** button to select “Sound”, then press the **ENTER** button.

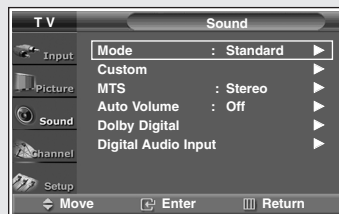

2

Press the **▲** or **▼** button to select “Digital Audio Input”, then press the **ENTER** button.

Press the **▲** or **▼** button to select “Optical” or “Coaxial”, then press the **ENTER** button.
Press the **▲** or **▼** button to select a audio source, then press the **ENTER** button.

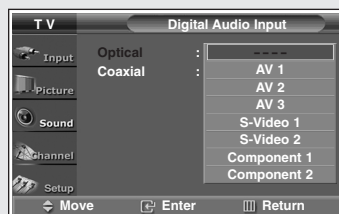

Press the **EXIT** button to exit.

- **OPTICAL:** converts the electric signal into an optical light signal, and transmits it through glass fibers. A transmission system of digital audio in the form of a light wave, S/PDIF format using a glass conductor.
- **COAXIAL:** The digital audio signal is received through a coaxial copper cable.

TV OPERATION

Setting the Clock Manually

Setting the clock is necessary in order to use the various timer features of the TV. Also, you can check the time while watching the TV. (Just press the **INFO** button.)

1

Press the **MENU** button.
Press the **▲** or **▼** button to select "Setup", then press the **ENTER** button.



2

Press the **ENTER** button to select "Time".

Press the **ENTER** button to select "Clock".

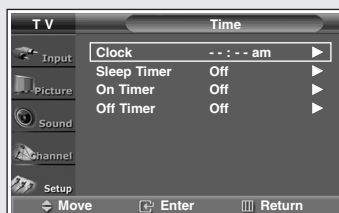

3

Press the **ENTER** button to select "Clock Mode".

Press the **▲** or **▼** button to select "Manual", then press the **ENTER** button.



4

Press the **▲** or **▼** button to select "Clock Set", then press the **ENTER** button.

Press the **◀** or **▶** button to move to "Hour", "Min" or "am/pm".
Set the clock you want by pressing the **▲** or **▼** button, then press the **ENTER** button.

Press the **EXIT** button to exit.

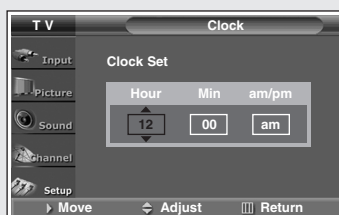

◀ The current time will appear every time you press the **INFO** button.

◀ You can set the hour and minute directly by pressing the number buttons on the remote control.

TV OPERATION

Setting the Clock Automatically

The Clock can be set automatically if you are receiving a digital signal.

1

Press the **MENU** button.
Press the **▲** or **▼** button to select "Setup", then press the **ENTER** button.



2

Press the **ENTER** button to select "Time".

Press the **ENTER** button to select "Clock".



3

Press the **ENTER** button to select "Clock Mode".

Press the **▲** or **▼** button to select "Auto", then press the **ENTER** button.



◀ Certain broadcasts may not transmit the correct time. In this case, set the time manually.

4

Press the **▲** or **▼** button to select "PBS Channel", then press the **ENTER** button.
Press the **▲** or **▼** button to select your local PBS channel, then press the **ENTER** button.



continued...

TV OPERATION

5

Press the ▲ or ▼ button to select "Time Zone", then press the **ENTER** button.
Press the ▲ or ▼ button to select the time zone for your local area, then press the **ENTER** button.

- ATL. : Atlantic
- EAST : Eastern
- CEN. : Central
- MTN. : Mountain
- PAC. : Pacific
- ALAS. : Alaska
- HAW. : Hawaii



◀ The set time can be changed according to the broadcasting station and signal when you set up auto time.
If there is a difference between the real time and set time, please set up manual time.

6

Press the ▲ or ▼ button to select "DST" (Daylight Saving Time), then press the **ENTER** button.
Press the ▲ or ▼ button to select "Yes" or "No", then press the **ENTER** button.

Press the **EXIT** button to exit.



TV OPERATION

Setting the Sleep Timer

The sleep timer automatically shuts off the TV after a preset time (from 30 to 180 minutes).

1

Press the **MENU** button.
Press the **▲** or **▼** button to select "Setup", then press the **ENTER** button.



2

Press the **ENTER** button to select "Time".
Press the **▲** or **▼** button to select "Sleep Timer", then press the **ENTER** button.
Press the **▲** or **▼** button to select the preset time you want, then press the **ENTER** button.

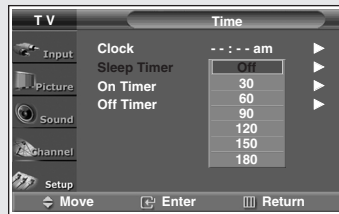

Press the **EXIT** button to exit.

TV OPERATION

Setting the On/Off Timer

1

Press the **MENU** button.
Press the **▲** or **▼** button to select "Setup", then press the **ENTER** button.



2

Press the **ENTER** button to select "Time".

Press the **▲** or **▼** button to select "On Timer", then press the **ENTER** button.

Press the **▲** or **▼** button to adjust "Hour", then press the **▶** button to move to the next step. Set other items using the same method as above.

When finished, press the **MENU** button to return.

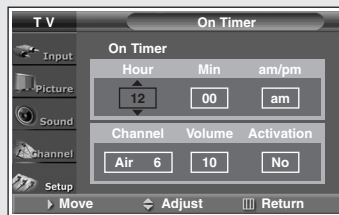

3

Press the **▲** or **▼** button to select "Off Timer", then press the **ENTER** button.

Press the **▲** or **▼** button to adjust "Hour", then press the **▶** button to move to the next step. Set other items using the same method as above.

Press the **EXIT** button to exit.

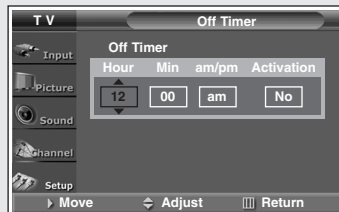

◀ The current time will appear every time you press the **INFO** button.

◀ You can set the hour and minute directly by pressing the number buttons on the remote control.

TV OPERATION

Setting the Blue Screen Mode

If no signal is being received or the signal is very weak, a blue screen automatically replaces the noisy picture background. If you wish to continue viewing the poor picture, you must set the "Blue Screen" mode to "Off".

1

Press the **MENU** button.
Press the **▲** or **▼** button to select "Setup", then press the **ENTER** button.



2

Press the **▲** or **▼** button to select "Blue Screen", then press the **ENTER** button.
Press the **▲** or **▼** button to select "On" or "Off", then press the **ENTER** button.



Press the **EXIT** button to exit.

TV OPERATION

Viewing Closed Caption Information

Your TV decodes and displays the closed captions information that is broadcast along with some television shows. These captions are usually subtitles for the hearing impaired or translations into other languages. All VCRs record the closed caption signal from television programs, so pre-recorded video tapes can also deliver closed-caption information. Check for the closed caption symbol (**CC**) on the tape's package or your TV program-schedule.

1

Press the **MENU** button.
Press the **▲** or **▼** button to select "Setup", then press the **ENTER** button.



◀ The Caption function doesn't operate when the PIP is active.

2

Press the **▲** or **▼** button to select "Caption", then press the **ENTER** button.

Press the **ENTER** button to select "Caption".
Press the **▲** or **▼** button to select "On", then press the **ENTER** button.

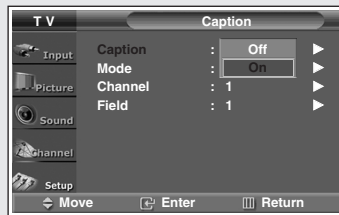

Alternate method:

Press the **CAPTION** button on the remote control repeatedly to select "On" or "Off".

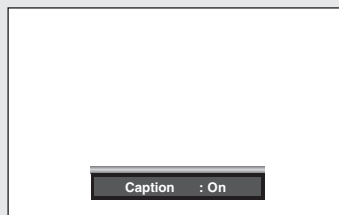

3

Press the **▲** or **▼** button to select "Mode", then press the **ENTER** button.

Press the **▲** or **▼** button to select "Caption" or "Text", then press the **ENTER** button.



◀ In "Caption" mode, caption appears at the bottom of the screen, and they usually cover only a small portion of the picture.

◀ In "Text" mode, information unrelated to the program, such as news or weather, is displayed. Text often covers a large portion of the screen.

TV OPERATION

4

Press the ▲ or ▼ button to select "Channel", then press the **ENTER** button.
Press the ▲ or ▼ button to select "1" or "2", then press the **ENTER** button.

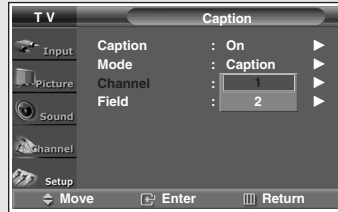

◀ Depending on the particular broadcast, it might be necessary to make changes to "Channel" and "Field".

◀ Different channels and fields display different information: "Field 2" carries additional information that supplements the information in "Field 1". (For example, "Channel 1" may have subtitles in English, while "Channel 2" has subtitles in Spanish.)

5

Press the ▲ or ▼ button to select "Field", then press the **ENTER** button.
Press the ▲ or ▼ button to select "1" or "2", then press the **ENTER** button.



Press the **EXIT** button to exit.

- Misspellings and unusual characters sometimes occur during closed caption transmissions, especially those of live events. There may be a small delay before captions appear when you change channels. These are not malfunctions of the TV.

Setting the On/Off Melody

A melody sound can be set to come on when the TV is powered On or Off.

1

Press the **MENU** button.
Press the ▲ or ▼ button to select "Setup", then press the **ENTER** button.



2

Press the ▲ or ▼ button to select "Melody", then press the **ENTER** button.
Press the ▲ or ▼ button to select "On" or "Off", then press the **ENTER** button.

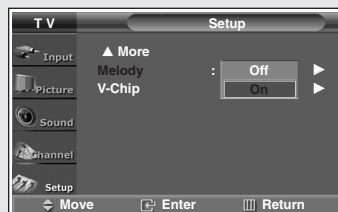

Press the **EXIT** button to exit.

TV OPERATION

Using the V-Chip (USA)

Access to channels and programs is controlled by a password (i.e., a 4-digit secret code that is defined by the user). The on-screen menu will instruct you to assign a password (and you can change it later, if necessary).

How to Change Your Password

1

Press the **MENU** button.
Press the **▲** or **▼** button to select "Setup", then press the **ENTER** button.



2

Press the **▲** or **▼** button to select "V-Chip", then press the **ENTER** button.

Press the number buttons to enter your current 4-digit pin number.

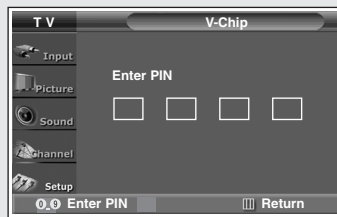

◀ The default pin number for a new TV set is "0 0 0 0".

◀ If you forget the pin number, press the remote control buttons in the following sequence, which resets the pin to 0-0-0-0:
POWER (Off), **MUTE**, **8**, **2**, **4**, **POWER (On)**.

3

The "V-Chip" menu is displayed.

Press the **▲** or **▼** button to select "Change PIN", then press the **ENTER** button.

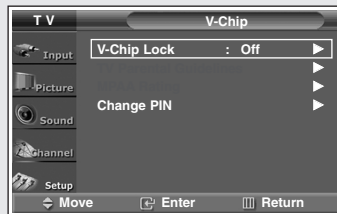

4

Press the number buttons to enter your new 4-digit pin number.
Re-enter your new pin number to confirm.

Press the **EXIT** button to exit.

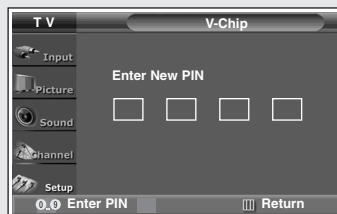

TV OPERATION

How to Enable/Disable the Rating Controls

1

Press the **MENU** button.
Press the **▲** or **▼** button to select "Setup", then press the **ENTER** button.



2

Press the **▲** or **▼** button to select "V-Chip", then press the **ENTER** button.

Press the number buttons to enter your current 4-digit pin number.

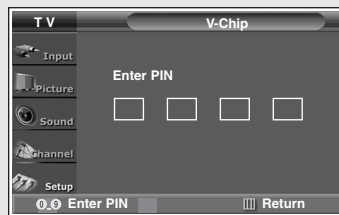

3

The "V-Chip" menu is displayed.

Press the **ENTER** button to select "V-Chip Lock".
Press the **▲** or **▼** button to select "On", then press the **ENTER** button.

Press the **EXIT** button to exit.

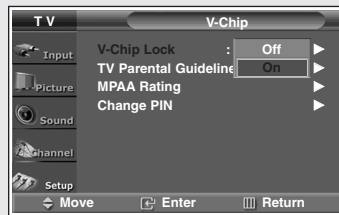

TV OPERATION

How to Set up Restrictions Using the “TV Parental Guidelines”

The parental restrictions can be set up using either of two methods: The “TV Parental Guidelines” or “MPAA Rating”.

- 1**
 Press the **MENU** button.
 Press the **▲** or **▼** button to select “Setup”, then press the **ENTER** button.



- 2**
 Press the **▲** or **▼** button to select “V-Chip”, then press the **ENTER** button.

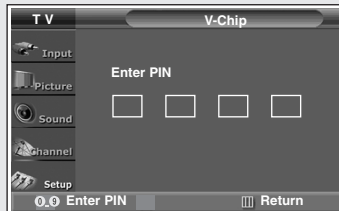

- Press the number buttons to enter your current 4-digit pin number.

- 3**
 The “V-Chip” menu is displayed.
 Press the **▲** or **▼** button to select “TV Parental Guidelines”, then press the **ENTER** button.

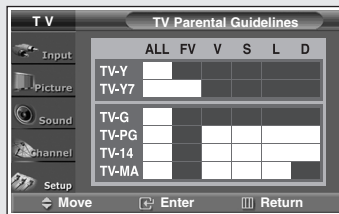

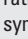
- 4**
 You can independently lock the TV ratings. The locked TV (FCC) ratings are indicated by the symbol “”.
 Press the **▲/▼/◀/▶** buttons and the **ENTER** button to activate the appropriate restrictions for TV (FCC) rating system.
 Press the **EXIT** button to exit.

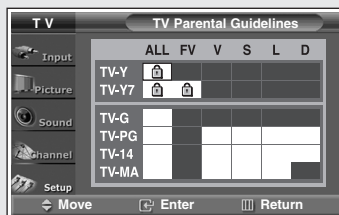

- ◀ **TV-Y** : Young children
- TV-Y7** : Children 7 and over
-
- TV-G** : General audience
- TV-PG** : Parent Guidance
- TV-14** : Viewers 14 and over
- TV-MA** : Mature Audience

- These categories consist of two separate groups: “TV-Y” and “TV-Y7” (young children through age 7), and “TV-G” through “TV-MA” (everybody else).
- The restrictions for these two groups work independently: If a household includes very young children as well as young adults, the TV parental guidelines must be set up separately for each age group. (See page 64.)

TV OPERATION

How to Set up Restrictions Using the “MPAA Rating”

The Movie rating system uses the “MPAA” (Motion Picture Association of America) system, and its main application is for movies.

When the rating controls is on, the TV will automatically block any programs that are coded with objectionable ratings (either “MPAA Rating” or “TV Parental Guidelines”).

1

Press the **MENU** button.
Press the **▲** or **▼** button to select “Setup”, then press the **ENTER** button.



2

Press the **▲** or **▼** button to select “V-Chip”, then press the **ENTER** button.

Press the number buttons to enter your current 4-digit pin number.

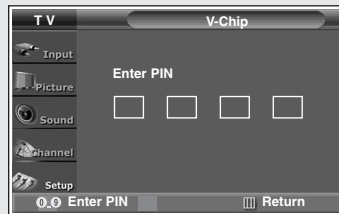

3

The “V-Chip” menu is displayed.

Press the **▲** or **▼** button to select “MPAA Rating”, then press the **ENTER** button.

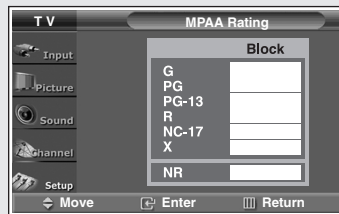

4

You can independently lock the movie ratings. The locked movie ratings are indicated by the symbol “”.

Press the **▲/▼/▶** buttons and the **ENTER** button to activate the appropriate restrictions for movie rating system.

Press the **EXIT** button to exit.

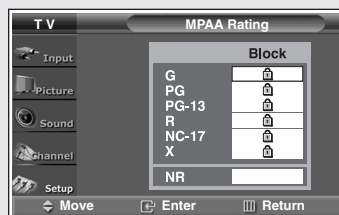

TV OPERATION

Important Notes About Parental Locks

Explanation of the MPAA and TV (FCC) Rating Systems:

TV (FCC) Age-Based Ratings

TV-MA

Mature audiences only. This program may contain mature themes, profane language, graphic violence and explicit sexual content.

TV-14

Parents strongly cautioned. This program may contain sophisticated themes, sexual content, strong language and more intense violence.

TV-PG

Parental guidance suggested. The program may contain infrequent coarse language, limited violence, some suggestive sexual dialogue and situations.

TV-G

General audience. It contains little or no violence, no strong language, and little or no sexual dialogue or situations.

TV-Y7

Directed to older children. Themes and elements in this program may include mild physical or comedic violence, or may frighten children under the age of seven.

TV-Y

All children. The themes and elements in this program are specifically designed for a very young audience, including children from ages two - six.

TV (FCC) Content Category

- V** Violence.
- S** Sexual content.
- L** Offensive language.
- D** Dialogue sexual innuendo.
- FV** Fantasy or cartoon violence.

MPAA Rating System (Movies)

- G** General audience. No restriction.
- PG** Children under 13 should be accompanied by an adult.
- PG-13** Parental guidance suggested. Children under 13 should be accompanied by an adult.
- R** Restricted. Viewers should be 17 or older.
- NC-17** Not classified. Viewers should be 17 or older.
- X** Adults only.
- NR** Not rated.

- TV (FCC) ratings : The particular rating that you have selected will be locked (and indicated as a red "L" on a blue background). Also, all of the age-based ratings will be locked within the particular group (i.e., "group 1" or "group 2"). Suppose that the TV-G rating and all of its contents (V, S, L, and D) are locked. In that case, more restrictive ratings (TV-PG, TV-14, and TV-MA) and all of their contents (V, S, L, and D) are automatically locked as well.
- MPAA ratings : The particular rating that you have selected will be locked. In addition, more restrictive ratings will be locked as well.
- Neither TV (FCC) ratings nor MPAA ratings apply to news programs.

TV OPERATION

Viewing an External Signal Source

Use the remote control to switch between viewing signals from connected equipment, such as VCR, DVD, Set-Top box and the TV source (broadcast or cable).

Setting the Signal Source

1

Press the **MENU** button.
Press the **ENTER** button to select
"Input".



2

Press the **ENTER** button to select
"Source List".

Press the **▲** or **▼** button to
select a signal source, then
press the **ENTER** button.

Press the **EXIT** button to exit.



◀ When you connect equipment to the TV, you can choose between the following sets of jacks : "AV3", "S-Video2" on the TV's side panel or "AV1", "AV2", "S-Video1", "Component1", "Component2", "DVD" or "HDMI" on the TV's rear panel.

Alternate method:

Press the **SOURCE** button on the remote control repeatedly to select an external signal source.

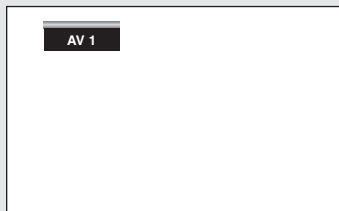

TV OPERATION

Assigning Names to External Sources

This feature enables you to name the input source you have connected.

1

Press the **MENU** button.
Press the **ENTER** button to select
"Input".



2

Press the **▲** or **▼** button to
select "Edit Name", then press
the **ENTER** button.

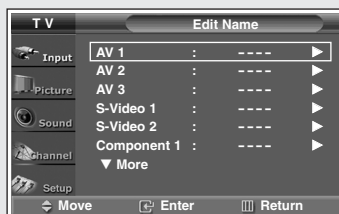

3

Press the **▲** or **▼** button to
select a signal source, then
press the **ENTER** button.
Press the **▲** or **▼** button to
select an external device, then
press the **ENTER** button.



Press the **EXIT** button to exit.

◀ The device names available are listed.

- VCR
- DVD
- Cable STB
- HD STB
- Satellite STB
- AV Receiver
- DVD Receiver
- Game
- Camcorder
- DVD Combo
- DHR (DVD HDD Recorder)
- PC

TV OPERATION

Customizing Your Remote Control

Your TV comes equipped with a universal remote control. In addition to controlling the TV, the universal remote control can also operate a VCR, Cable box, DVD and Set-Top Box made by Samsung (even if your VCR, Cable box and DVD are made by manufacturers other than Samsung).

- The remote control might not be compatible with all VCRs, DVD players and Cable boxes.

Setting Up Your Remote Control to Operate Your VCR (Cable box or DVD player)

1

Turn off your VCR (Cable box or DVD player).

2

Press the **MODE** button to switch the remote control to the **VCR (CABLE or DVD)** mode.

◀ The remote control has five modes: **TV**, **STB**, **VCR**, **CABLE** and **DVD**.

3

On your Samsung remote control, press the **SET** button.

4

Enter 3 digits of the VCR (Cable box or DVD player) code listed on next page for your brand of VCR (Cable box or DVD player).

◀ Make sure you enter 3 digits of the code, even if the first digit is a "0". (If more than one code listed, try the first one.)

5

Press the **POWER** button on the remote control. Your VCR (Cable box or DVD player) should turn on. If your VCR (Cable box or DVD player) turns on, your remote control is now set correctly.

◀ If your VCR (Cable box or DVD player) does not turn on, repeat steps 2, 3, and 4, but try one of the other codes listed for the brand of your particular VCR (Cable box or DVD player).

6

Once your remote control is set up, press the **MODE** button any time you want to use the remote to operate your VCR (Cable box or DVD player).

- When your remote is in the **TV** mode, the VCR (or DVD player) control buttons (**REW**, **STOP**, **PLAY/PAUSE** and **FF**) will still operate your VCR (or DVD player).
- When your remote control is in the **STB**, **VCR**, **CABLE** or **DVD** mode, the volume buttons still control your TV's volume.

TV OPERATION

Remote Control Codes

VCR Codes

Admiral	015,088	Hitachi	014,024,044,045	Quasar	017,053
Aiwa	024	Instant Replay	017	Radio Shack	011,015,017,018,021,024,028,036,052,062
Akai	026,031,032	JC Penny	011,014,016,017,023,025,039,044,060,062	RCA	009,014,016,017,037,044,046,063,078
Audio Dynamics	022,025	JCL	011,017,023,025,039,055	Realistic	011,015,017,018,021,024,028,036,052,062
Bell & Howell	011	Kenwood	011,023,025,039,055	Samsung	000,016,022,031,041,051
Broksonic	019	KLH	082	Sansui	025
Candle	016,018,022,054,055,061	LG(Goldstar)	001,002,007,018,023,055,069	Sanyo	011,021
Canon	017,062	Lloyd	024	Scott	022,050,058,077
Citizen	016,018,022,054,055,061	Logik	040	Sears	011,014,018,021,027,028,044,052,057
Colortyme	023	LXI	024	Sharp	015,036,048,054
Craig	016,021	Magnavox	017,038,062,065	Shintom	026,035,040,064
Curtis Mathes	009,016,017,023,024,055,062,073,076	Marantz	011,017,023,025,038,039,055,070	Signature	024
Daewoo	003,004,005,006,007,008,022,054,085	MTC	016,024	Sony	026,035,047
DB	023,025	Multitech	016,024,040,041	Sylvania	017,024,038,062,065
Dimensia	009	NEC	011,023,025,039,055,070,073	Symphonic	024
Dynatech	024	Optimus	015	Tandy	011,024
Electrohome	036	Panasonic	017,062,084,086	Tatung	039
Emerson	017,018,019,022,024,029,032,036,043,050,051,056,058,066,071,074,076,077,079	Pentax	014,044	Teac	024,039,078
Fisher	011,021,027,028,052,057,067	Pentax Research+	055	Technics	017
Funai	024	Philco	017,038,062,065	Teknika	017,018,024,030
General Electric	009,016,017,041,062	Philips	017,038	TMK	076
Go Video	016	Pioneer	014,025,042,059	Toshiba	014,022,028,057,058
Harman Kardon	023	Portland	053,054,061	Toshiko	018
		PROSCAN	009	Television	016,018
		Quartz	011		

Cable Box Codes

Anvision	015,016	Magnavox	015,016,027,029,034,036,037,040,041,048,049	Signature	054
Cable Star	015,016	Nawoo	001	Sprucer	035
DaeHan	005	NSC	017	Starcom	054
DeaRyung	003	Oak	024,046	Stargate2000	066
DongKuk	004	Osk Sigma	024	Sylvania	019,067
Eagle	015,016	Panasonic	011,035,047,069	TaePyungYang	002
Eastern International	020	Philips	015,016,027,029,034,036,037,040,041,048,049	Texscan	019,067
General Instrument	054	Pioneer	026,028,052	Tocom	025,029,057,058,063
GI	012,013,023,031,032,033,038,044,075,076,077	Randtek	015,016	Unika	039,040,049
Hamlin	011,012,020,021,042,056	RCA	008,035,074	Universal	059,060
Hitachi	045,051,054	Regal	011,020,021	Viewstar	015,016,027,029,034,036,037,040,041,048,049
Jerrold	012,013,023,031,032,033,038,044,054,070,073	Regency	010,041	Warner Amex	052
LG(Goldstar)	006	Saewoo	007	Zenith	022,050,065,069
Macom	045,051	Samsung	000,011,030,052,071,072		

DVD Codes

Curtis Mathes	009	Philips	007	Sharp	005
JVC	003	PROSCAN	008	Sony	004
LG(Goldstar)	001	RCA	008	Toshiba	002
Panasonic	006	Samsung	000		

Chapter Four

DVD OPERATION

Playing a Disc

Playback

1

Press the **TV/DVD** button to switch the DVD mode.

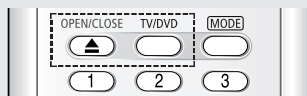

2

Press the **OPEN/CLOSE** (▲) button.



3

Place a disc gently into the tray with the disc's label facing up.

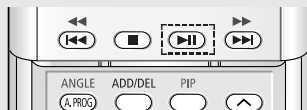

4

Press the **▶||** (Play/Pause) or **OPEN/CLOSE** (▲) button to close the disc tray.

Stopping Playback

Press the **■** (Stop) button during playback.

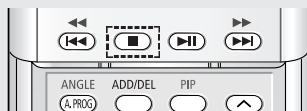

Removing Disc

Press the **OPEN/CLOSE** (▲) button.

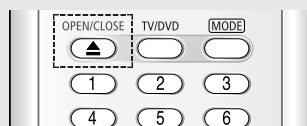

DVD OPERATION

Pausing Playback

Press the **▶||** (Play/Pause) button during playback, then screen stops and no sound.

To resume, press the **▶||** (Play/Pause) button again.

It will pick up where you left off (unless the disc is removed, the **■** (Stop) button is pressed twice or the set is unplugged.).

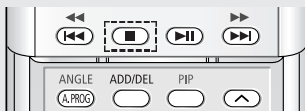

◀ If the player is left for 5 minutes in pause mode, it will stop.

◀ The “∅” icon indicates an invalid button press.

Slow Motion Play (Except CD)

Press the **▶▶** (Forward search) button during pause.

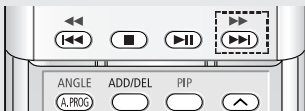

- By pressing the **▶▶** (Forward search) button for a second during pause, you can select slow motion playback for 1/2, 1/4, 1/8 or 1/16 of normal speed.
- No sound is heard during slow mode.
- Press the **▶||** (Play/Pause) button to resume normal playback.
- When playing a VCD, the reverse slow motion play will not work.

DVD OPERATION

Using the Search and Skip Functions

Searching through a Chapter or Track

Press the ►► (Forward search) or ◀◀ (Rewind search) button during playback.

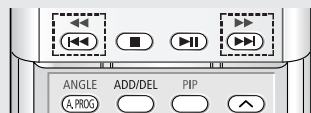

◀ When in search mode (2X/4X/8X/16X/32X) on a DVD or high-speed playback on a VCD, no sound will be heard.

- Press the ►► (Forward search) or ◀◀ (Rewind search) button and press again to search at a faster speed (2X/4X/8X/16X/32X) on the DVD, VCD, CD.
- To return to normal speed playback, press the ►|| (Play/Pause) button.

Skipping Tracks

Press the ►► (Next skip) or ◀◀ (Back skip) button during playback.

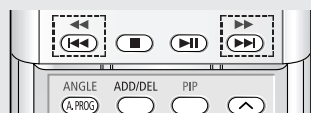

- Press the ►► (Next skip) or ◀◀ (Back skip) button and press again to search at a faster speed (2X/4X/8X/16X/32X) on the DVD, VCD, CD.
- When playing a DVD, if you press the ►► (Next skip) button, it moves to next chapter. If you press the ◀◀ (Back skip) button, it moves to the beginning of the chapter. One more press makes it move to the beginning of the previous chapter.
- When playing a CD, if you press the ►► (Next skip) button, it moves to next track. If you press the ◀◀ (Back skip) button, it moves to the beginning of the track. One more press makes it move to the beginning of the previous track.
- When playing a VCD 2.0 in MENU OFF mode, a VCD1.1 or a CD, if you press the ►► (Next skip) button, it moves to next track. If you press the ◀◀ (Back skip) button, it moves to the beginning of the track. One more press makes it move to the beginning of the previous track.
- If a track exceeds 15 minutes when playing a VCD and you press the ►► (Next skip) button, it moves forward 5 minutes. If you press the ◀◀ (Back skip) button, it moves backward 5 minutes.
- When playing a VCD 2.0 in the MENU MODE or Track View function, if you press the ►► (Next skip) button, it moves to the next menu or the next Track View display. If you press the ◀◀ (Back skip) button, it moves to the previous menu or the previous Track View display.

DVD OPERATION

Using the Play Function

When Playing a MP3/WMA

1
Press the **OPEN/CLOSE** (▲) button. Place a disc gently into the tray with the disc's label facing up. Press the **▶||** (Play/Pause) or **OPEN/CLOSE** (▲) button to close the disc tray.

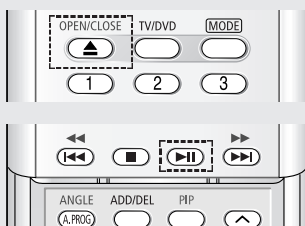

2
Press the ▲ or ▼ button to select the desired music folder, then press the **ENTER** or ▶ button.

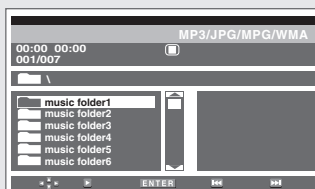

3
Press the ▲ or ▼ button again to select a song file. Press the **ENTER** or **▶||** (Play/Pause) button to begin play of the song file.

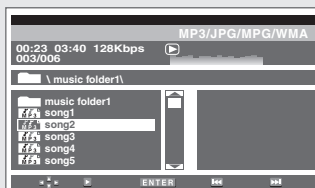

4
To play another song file of the same music folder, press the ■ (Stop) button and press the ▲ or ▼ button to select a song file. Press the **ENTER** or **▶||** (Play/Pause) button.
To play another song file of another folder, press the ◀ button to move the music folder lists. Repeat Steps 2 to 3.

Press the **EXIT** button to exit.

DVD OPERATION

When playing CD-R/MP3 discs, please follow the recommendations below:

- **Your MP3 files should be ISO 9660 or JOLIET format.**
ISO 9660 format and Joliet MP3 files are compatible with Microsoft's DOS and Windows, and with Apple's Mac. These two formats are the most widely used.
- **When naming your MP3 files do not exceed 8 characters, and place ".mp3" as the file extension.**
General name format of: Title.mp3. When composing your title, make sure that you use 8 characters or less, have no spaces in the name, and avoid the use of special characters including: (.,/, \, =, +).
- **Use a decompression transfer rate of at least 128 Kbps when recording MP3 files.**
Sound quality with MP3 files basically depends on the rate of compression/decompression you choose. Getting audio CD quality sound requires an analog/digital sampling rate (conversion to MP3 format) of at least 128 Kbps and up to 160 Kbps. However, choosing higher rates, like 192 Kbps or more, only rarely give better sound quality. Conversely, files with sampling rates below 128 Kbps will not be played properly.
- **Do not try recording copyright protected MP3 files.**
Certain "securized" files are encrypted and code protected to prevent illegal copying. These files are of the following types: Windows Media™ (registered trade mark of Microsoft Inc) and SDMITM (registered trademark of The SDMI Foundation). You cannot copy such files.
- **Your DVD player only accepts one level of file directory.**
Consequently you must choose:
 - either to save all your MP3 recording files at the root of the disc;
 - and/or create folders in the directory for each artist or music type (e.g.classical, rock, jazz, etc)
- **Important**
The above recommendations cannot be taken as a guarantee that the DVD player will play MP3 recordings, or as an assurance of sound quality. You should note that certain technologies and methods for MP3 file recording on CD-Rs prevent optimal playback of these files on your DVD player (degraded sound quality and in some cases, inability of the player to read the files).
- This unit can play a maximum of 500 files and 300 folders per disc.

DVD OPERATION

When Playing a MPG

1

Press the **OPEN/CLOSE** button. Place a disc gently into the tray with the disc's label facing up. Press the **▶II** (Play/Pause) or **OPEN/CLOSE** button to close the disc tray.

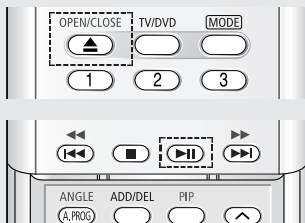

2

Press the **▲** or **▼** button to select the desired MPEG folder, then press the **ENTER** or **▶** button.

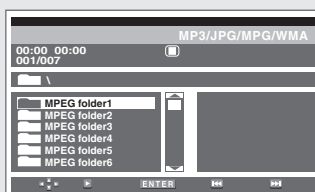

3

Press the **▲** or **▼** button again to select a MPEG file. Press the **ENTER** or **▶II** (Play/Pause) button to begin play of the MPEG file.

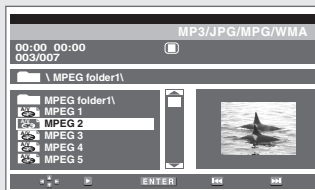

4

To play another MPEG file of the same MPEG folder, press the **■** (Stop) button and press the **▲** or **▼** button to select a MPEG folder. Press the **ENTER** or **▶II** (Play/Pause) button.



To play another MPEG folder of another folder, press the **◀** button to move the MPEG folder lists. Repeat Steps 2 to 3.

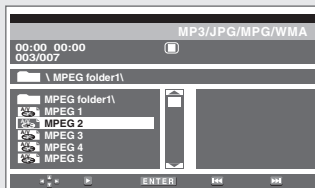

Press the **EXIT** button to exit.

DVD OPERATION

When Playing a JPEG

Press the **OPEN/CLOSE** button.
Place a disc gently into the tray with the disc's label facing up.
Press the **▶II** (Play/Pause) or **OPEN/CLOSE** button to close the disc tray.

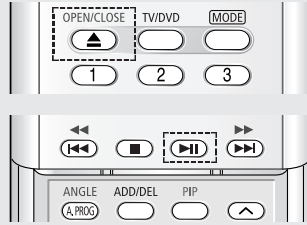

Rotating and Reversing the picture

Press the **▲** or **▼** button to select the desired picture file of the file list, then press the **ENTER** button. The selected picture is displayed.

Press the **◀** or **▶** button to rotate the picture.

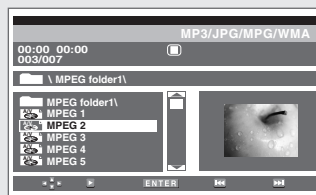

◀ Press the **▲** button repeatedly to reverse vertically.
Press the **▼** button repeatedly to reverse horizontally.

◀ If you want to return to the file list, press the **■** (Stop) button.

Slide Show

Press the **▲** or **▼** button to select the desired picture file of the file list, then press the **▶II** (Play/Pause) button. It enters slide show mode.

◀ If you want to return to the file list, press the **■** (Stop) button.

Viewing the Album Screen

Press the **DVD MENU** button during slide show. The DVD menu is displayed with the "Disc Menu" is selected.

Press the **ENTER** button to select "Disc Menu". It enters album screen mode.

To display the next or previous 12 pictures, press the **▶▶** (Next skip) or **◀◀** (Back skip) button.

Press the **▲/▼/◀/▶** button to select the desired picture, then press the **▶II** (Play/Pause) button. It enters slide show mode again. If you press the **ENTER** button after selecting the desired picture, the selected picture will be displayed only.

Press the **EXIT** button to exit.

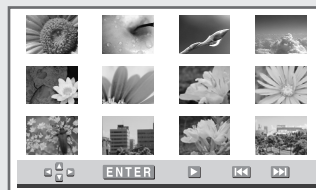
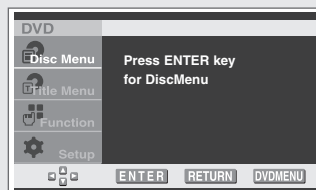

DVD OPERATION

Using the Disc Menu

- 1**
Press the **DVD MENU** button.
The DVD menu is displayed with
the "Disc Menu" is selected.

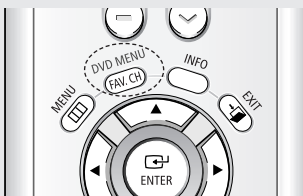

- 2**
Press the **ENTER** button to select
"Disc Menu".

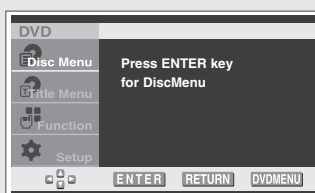

◀ Depending on the disc, the
"Disc Menu" may not work.

Using the Title Menu

- 1**
Press the **DVD MENU** button.
The DVD menu is displayed.

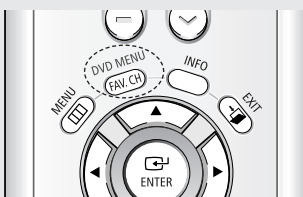

- 2**
Press the **▲** or **▼** button to select
"Title Menu", then press the
ENTER button.

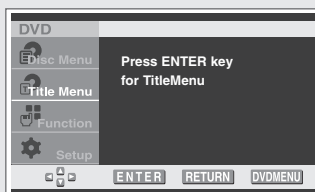

◀ The "Title Menu" will be
displayed if there are at least two
titles in the disc.
◀ Depending on the disc, the
"Title Menu" may not work.

DVD OPERATION

Displaying the Disc Information

1

Press the **DVD MENU** button.
Press the **▲** or **▼** button to select "Function", then press the **ENTER** button.
The "Info" is selected.

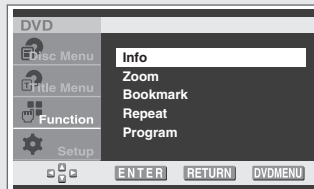

2

Press the **ENTER** button again.
Depending on the disc, the disc information will be displayed.
You can display by simply pressing the **INFO** button.

Press the **▲** or **▼** button to select the required item. Press the **◀** or **▶** button to make the required setup, then press the **ENTER** button.

To make the screen disappear, press the **INFO** button.

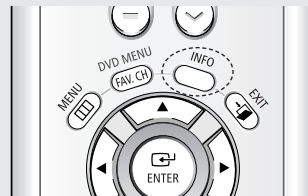
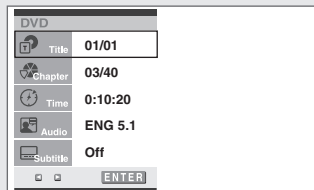

◀ You may use the number buttons of the remote control to start play from a desired time.

◀ What is a Title?

A DVD may contain several different titles. For example, if a disc contains four different movies, each might be considered a title.

◀ What is a Chapter?

Each Title on a DVD can be divided into chapters (similar to tracks on an audio CD).



Title

To access the desired title when there is more than one in the disc. For example, if there is more than one movie on a DVD, each movie will be identified.



Chapter

Most DVD discs are recorded in chapters so that you can quickly find a specific passage.



Time

Allows playback of the film from a desired time. You must enter the starting time as a reference.



Audio

Refers to the language of the film soundtrack. In the example, the soundtrack is played in English 5.1ch. A DVD can have up to eight different soundtracks.



Subtitle

Refers to the subtitle languages available in the disc. You will be able to choose the subtitles language or, if you prefer, turn them off from the screen. A DVD disc can have up to 32 different subtitles.

DVD OPERATION

Using the Zoom Function (DVD/VCD)

1

Press the **DVD MENU** button.
Press the **▲** or **▼** button to select
"Function", then press the **ENTER**
button.

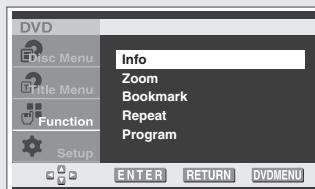

2

Press the **▲** or **▼** button to select
"Zoom", then press the **ENTER**
button.
The "🔍" mark is displayed.

Press the **ENTER** button repeatedly
to zoom in on (DVD or VCD: 2X, 3X,
4X, 1/2X, 1/3X, 1/4X in order).

Press the **▲/▼/◀/▶** button to
select the part of the screen you
want to zoom in on (2X/3X/4X).

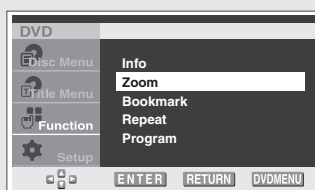

Changing the Camera Angle

When a DVD contains multiple angles of a particular scene, you can select the Angle function.

Press the **ANGLE** button.
Press the **◀** or **▶** button to select
the desired screen angle.

To turn off the display, press the
ANGLE button again.

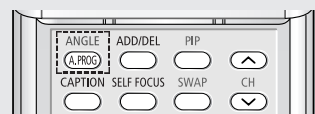

DVD OPERATION

Using the Bookmark Function (DVD/VCD)

This feature lets you bookmark sections of a DVD or VCD so you can quickly find them at a later time.

1

Press the **DVD MENU** button.
Press the **▲** or **▼** button to select "Function", then press the **ENTER** button.

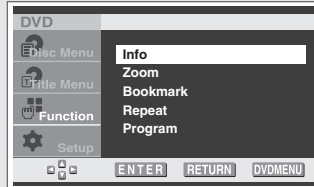

2

Press the **▲** or **▼** button to select "Bookmark", then press the **ENTER** button.

Press the **◀** or **▶** button to move to the desired bookmark icon.
When you reach the scene you want to mark, press the **ENTER** button.
The icon will change to a number (1, 2, or 3).

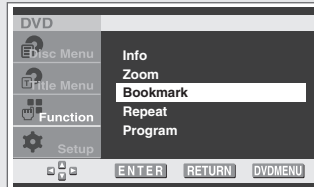

◀ Depending on the disc, this function may not work.

◀ Up to three scenes may be marked at the same time.

Recalling a Marked Scene

Press the **◀** or **▶** button to select a marked scene.
Press the **▶II** (Play/Pause) button to skip to the marked scene.

Clearing a Bookmark

Press the **◀** or **▶** button to select the bookmark number you want to delete.
Press the **CLEAR** button to delete a bookmark number.

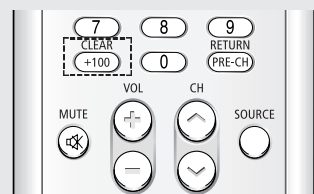

DVD OPERATION

Repeat Play

Repeat the current track, chapter, title, a chosen section (A-B), or all of the disc.

1

Press the **DVD MENU** button.
Press the **▲** or **▼** button to select "Function", then press the **ENTER** button.

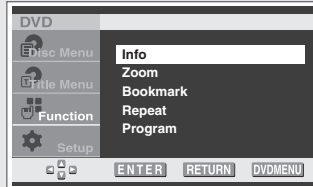

2

Press the **▲** or **▼** button to select "Repeat", then press the **ENTER** button.

Press the **◀** or **▶** button to select the chapter, title or A-B.
Press the **ENTER** button.
The DVD repeats playback by chapter or title, the VCR and CD repeat playback by track or disc.

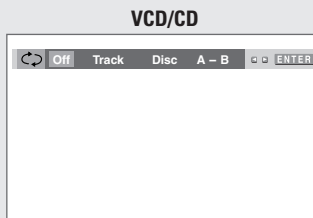
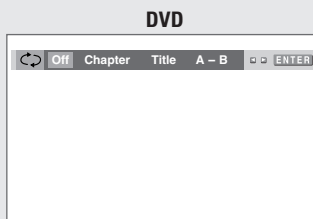
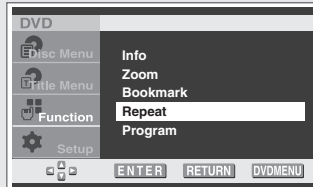

◀ Depending on the disc, this function may not work.

A-B Repeat

Press the **◀** or **▶** button to select "A -". Press the **ENTER** button at the point where you want the repeat play to start.
Press the **◀** or **▶** button to select "B". Press the **ENTER** button at the point where you want the repeat play to stop.
To return to normal play, press the **◀** or **▶** button to select "Off" and press the **ENTER** button.

◀ If the title or track is completed before marking the end (B), the end of title or track becomes "B" automatically.

DVD OPERATION

Program Play (CD)

1

Press the **DVD MENU** button.
Press the **▲** or **▼** button to select "Function", then press the **ENTER** button.

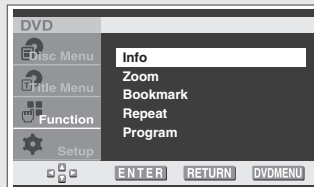

2

Press the **▲** or **▼** button to select "Program", then press the **ENTER** button.

Press the number buttons to select the first track to add to the program.

Selected numbers are displayed in the first track.

Press the **▲/▼/◀/▶** button to move the next tray. Follow the above instruction for programming.

Press the **▶||** (Play/Pause) button. The disc will be played in programmed order.

Press the **EXIT** button to exit.

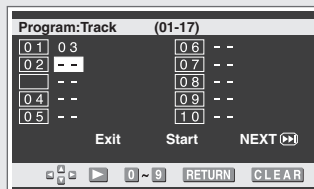
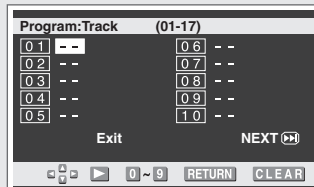
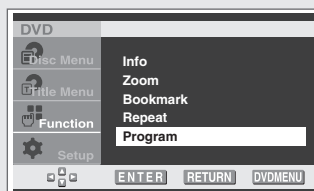

◀ Depending on the disc, this function may not work.

◀ Press the **■** (Stop) button twice to cancel the program play during playback.

◀ Opening the tray by pressing the **OPEN/CLOSE** button cancels the program play.

DVD OPERATION

Setting up the Language for Player Menu

If you select the language for the player's on-screen displays, it will come up automatically every time.

1

Press the **DVD MENU** button.
Press the **▲** or **▼** button to select "Setup", then press the **ENTER** button.
The "Language Setup" is selected.

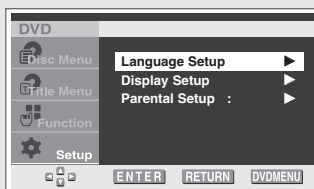

2

Press the **ENTER** button.
The "Player Menu" is selected.

Press the **ENTER** button again.
Press the **▲** or **▼** button to select the appropriate language, then press the **ENTER** button.

Press the **EXIT** button to exit.

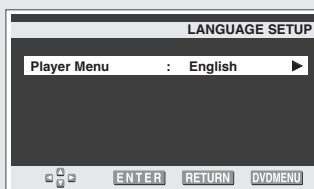

◀ This function depends on what languages are encoded on the disc and may not work with all DVDs.
◀ If the selected language is not recorded on the disc, the original pre-recorded language is selected.

DVD OPERATION

Setting up the Display Options

1

Press the **DVD MENU** button.
Press the **▲** or **▼** button to select "Setup", then press the **ENTER** button.

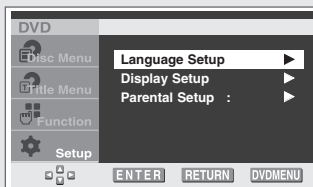

2

Press the **▲** or **▼** button to select "Display Setup", then press the **ENTER** button.

To turn on-screen messages on or off, press the **▲** or **▼** button to select "Screen Messages". Press the **ENTER** or **▶** button to select "On" or "Off".

To adjust the brightness of the screen, press the **▲** or **▼** button to select "Black Level". Press the **ENTER** or **▶** button to select "On" or "Off".

Press the **EXIT** button to exit.

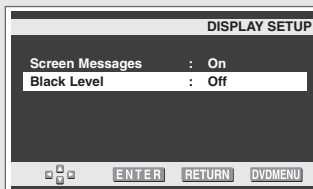
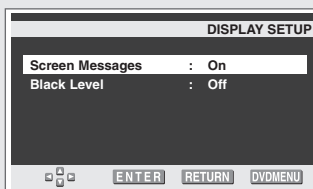
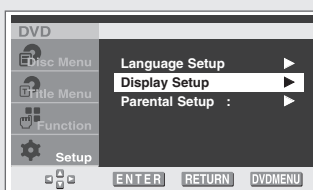

DVD OPERATION

Setting up the Parental Control

1
 Press the **DVD MENU** button.
 Press the **▲** or **▼** button to select
 "Setup", then press the **ENTER**
 button.

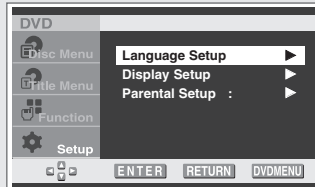

2
Using a Password

Press the **▲** or **▼** button to select
 "Parental Setup", then press the
ENTER button.

Enter the default password (**0000**)
 by using the number buttons.
 The "Parental Setup" menu is
 displayed with "Use Password" is
 selected.

To use a password, select "Yes"
 by pressing the **ENTER** or **▶**
 button.
 The "Rating Level" and "Change
 Password" are displayed.

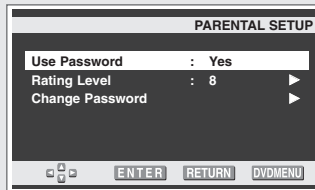
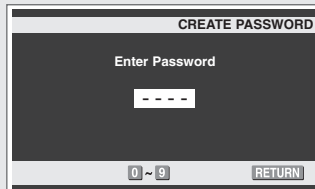
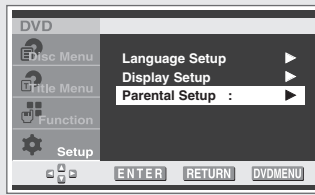

◀ If you have lost your
 password, enter the master
 password (**1369**).

3
Changing a Password

Press the **▲** or **▼** button to select
 "Change Password", then press
 the **ENTER** button.

Enter your new password.
 Re-enter your new password to
 confirm.

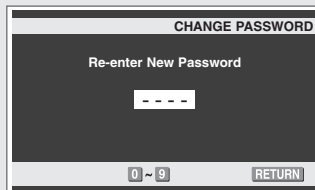
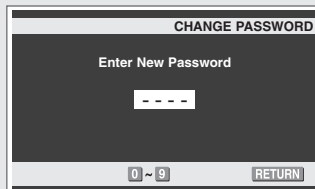
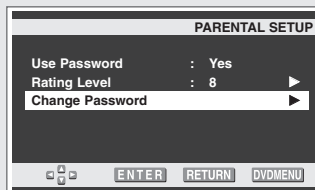

DVD OPERATION

4**Adjusting Rating Level**

Press the ▲ or ▼ button to select "Rating Level", then press the **ENTER** button.

Press the ▲ or ▼ button to select the level (e.g. Level 8) and press the **ENTER** button.
Discs that contain Level 7 will now not play.

Press the **EXIT** button to exit.

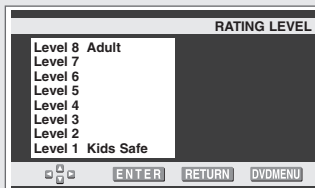
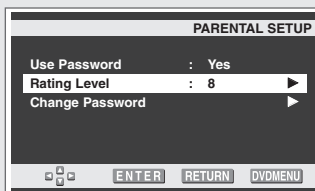

◀ To cancel the rating level, select "No" in the "Use Password" by pressing the ▶ button.

Chapter Five

TROUBLESHOOTING

If the TV seems to have a problem, first try this list of possible problems and solutions. If none of these troubleshooting tips apply, then call your nearest service center.

Identifying Problems

Problem	Possible Solution
Poor picture	Try another channel. Adjust the antenna. Check all wire connections.
Poor sound quality	Try another channel. Adjust the antenna.
No picture or sound	Try another channel. Press the SOURCE button. Make sure the TV is plugged in. Check the antenna connections.
No color, wrong colors or tints.	Make sure the program is broadcast in color. Adjust the picture settings. If the set is moved or turned in a different direction, the power should be OFF for at least 30 minutes.
Picture rolls vertically.	Adjust the antenna. Check all wire connections.
The TV operates erratically.	Unplug the TV for 30 seconds, then try operating it again.
The TV won't turn on.	Make sure the wall outlet is working.

TROUBLESHOOTING

Problem	Possible Solution
Disc does not play.	Ensure that the disc is installed with the label side facing up. Check the region number of the DVD. This player cannot play CD-ROMs, DVD-ROMs, CD-R, etc. Insert a DVD, a VIDEO-CD or a CD.
5.1 channel sound is not being reproduced.	5.1 channel sound is reproduced only when the following conditions are met. : 1) The DVD player is connected with the proper amplifier. 2) The disc is recorded with 5.1 channel sound. <ul style="list-style-type: none"> • Check whether the disc being played has the “Dolby 5.1 ch” mark on the outside. • Check if your audio system is connected and working properly.
The “⊘” icon appears on screen.	The features or action cannot be completed at this time because : 1) The DVD's software restricts it. 2) The DVD's software doesn't support the feature (e.g., angles). 3) The feature is not available at the moment. 4) You've requested a title or chapter number or search time that is out of range.
Disc Menu doesn't appear.	Check if the disc has a Menu.
Playback mode differs from the Setup Menu selection.	Some of the functions selected in the Setup Menu may not work properly if the disc is not encoded with the corresponding function.
If you experience other problems.	Go to the contents and find the section of the instruction book that contains the explanations regarding the current problem, and follow the procedure once again. If the problem still cannot be solved, please contact your nearest authorized service center.

APPENDIX

Cleaning and Maintaining Your TV

With proper care, your TV unit will give you many years of service. Please follow these guidelines to get the maximum performance from your TV.

Placement

- Do not place the TV near extremely hot, cold, humid or dusty places.
- Do not place the TV near appliances with electric motors that create magnetic fields, such as vacuum cleaners.
- Keep the ventilation openings clear; do not place the TV on a soft surface, such as cloth or paper.
- Place the TV in a vertical position only.

Liquids

- Do not handle liquids near or on the TV. Liquids that spill into it can cause serious damage.

Cabinet

- Never open the cabinet or touch the parts inside.
- Wipe your TV with a clean, dry cloth. Never use water, cleaning fluids, wax, or chemicals.
- Do not put heavy objects on top of the cabinet.

Temperature

- If your TV is suddenly moved from a cold to a warm place, unplug the power cord, and allow at least two hours for moisture that may have formed inside the unit to dry completely.

Using Your TV in Another Country

If you plan to take your TV with you to a foreign country, please be aware of the different television systems that are in use around the world. A TV designed for one system may not work properly with another system due to differences in the TV channel frequencies.

Specifications

Model	HC-P4363W
Voltage	AC 120V
Frequency of Operation	60Hz
Power Consumption	380 watts
Dimension (W x D x H)	1028 x 583 x 1352 mm 40.4 x 22.9 x 53.2 inches
Weight	73 Kg / 160.9 lbs



MEMO

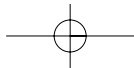
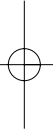



MEMO

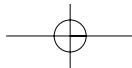
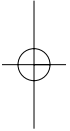



MEMO

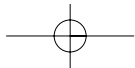
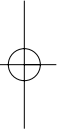



1-800-SAMSUNG (1-800-726-7864)

**Samsung Electronics America
Service Division**

400 Valley Road, Suite 201
Mount Arlington, NJ 07856
www.samsungusa.com

**Samsung Electronics Canada Inc.
Samsung Customer Care**

7037 Financial Drive
Mississauga, Ontario
L5N 6R3
www.samsung.ca

BP68-00342A-00

Free Manuals Download Website

<http://myh66.com>

<http://usermanuals.us>

<http://www.somanuals.com>

<http://www.4manuals.cc>

<http://www.manual-lib.com>

<http://www.404manual.com>

<http://www.luxmanual.com>

<http://aubethermostatmanual.com>

Golf course search by state

<http://golfingnear.com>

Email search by domain

<http://emailbydomain.com>

Auto manuals search

<http://auto.somanuals.com>

TV manuals search

<http://tv.somanuals.com>