



SAMSUNG

HW-H600

HW-H610

User manual

Wireless Audio - SoundStand

Imagine the possibilities

Thank you for purchasing this Samsung product.
To receive more complete service, please register your product at
www.samsung.com/register

FEATURES

TV SoundConnect

TV SoundConnect lets you listen to audio from your TV on your SoundStand via a Bluetooth connection and lets you control the sound.

HDMI

HDMI transmits video and audio signals simultaneously, and provides a clearer picture.

The unit is also equipped with the ARC function which lets you listen to sound from your TV through the SoundStand via an HDMI cable. This function is only available if you connect the unit to an ARC compliant TV.

Surround Sound Expansion

The Surround Sound Expansion feature adds depth and spaciousness to your listening experience. Surround Sound Expansion is powered by Sonic Emotion.

Special Sound Modes

You can select different sound modes - CINEMA / SPORTS / VOICE / MUSIC / STANDARD (OFF) - depending on the type of content you want to enjoy.

Multi-function Remote Control

You can use the supplied remote control to control various operations with the simple press of a button.

USB Host Support

You can connect and play music files from external USB storage devices such as MP3 players, USB flash memory, etc. using the SoundStand's USB HOST function.

Bluetooth Function

You can use connect a Bluetooth device to the SoundStand and enjoy music with high quality stereo sound, all without wires!



NFC (ONLY HW-H610 MODEL)

Connect your NFC compatible device via Bluetooth to the SoundStand using this simple set-up procedure and play music on the device through the SoundStand.

SAFETY INFORMATION

SAFETY WARNINGS

TO REDUCE THE RISK OF ELECTRIC SHOCK, DO NOT REMOVE THE COVER (OR BACK).
NO USER-SERVICEABLE PARTS ARE INSIDE. REFER SERVICING TO QUALIFIED SERVICE PERSONNEL.

<p style="text-align: center;">CAUTION</p> <p style="text-align: center;">RISK OF ELECTRIC SHOCK DO NOT OPEN</p>		<p>The lightning flash and arrowhead within the triangle indicates that there is dangerous voltage inside the product.</p>
<p>CAUTION: TO REDUCE THE RISK OF ELECTRIC SHOCK, DO NOT REMOVE THE COVER (OR BACK). NO USER SERVICEABLE PARTS INSIDE. REFER SERVICING TO QUALIFIED SERVICE PERSONNEL.</p>		<p>The explanation point within the triangle indicates that there are important instructions accompanying the product.</p>

WARNING

- To reduce the risk of fire or electric shock, do not expose this appliance to rain or moisture.
- To prevent injury, this apparatus must be securely attached to the floor/wall in accordance with the installation instructions.
- This product contains chemicals known to the State of California to cause cancer and reproductive toxicity.

CAUTION

- Do not expose this apparatus to dripping or splashing. Do not put objects filled with liquids, such as vases on the apparatus.
- To turn this apparatus off completely, you must pull the power plug out of the wall socket. Consequently, the power plug must be easily and readily accessible at all times.

This product satisfies FCC regulations when shielded cables and connectors are used to connect the unit to other equipment. To prevent electromagnetic interference with electric appliances, such as radios and televisions, use shielded cables and connectors for connections.

FCC NOTE (for U.S.A.):

This equipment has been tested and found to comply with the limits for a Class B digital device, pursuant to Part 15 of the FCC Rules. These limits are designed to provide reasonable protection against harmful interference in a residential installation.

This equipment generates, uses and can radiate radio frequency energy and, if not installed and used in accordance with the instructions, may cause harmful interference to radio communications. However, there is no guarantee that interference will not occur in a particular installation.

If this equipment does cause harmful interference to radio or television reception, which can be determined by turning the equipment off and on, the user is encouraged to try to correct the interference by one or more of the following measures:

- Reorient or relocate the receiving antenna.
- Increase the separation between the equipment and receiver.
- Connect the equipment to an outlet that is on a different circuit than the radio or TV.
- Consult the dealer or an experienced radio/TV technician for help.

Caution : FCC regulations state that any unauthorized changes or modifications to this equipment may void the user's authority to operate it.

Important Safety Instructions

Read these operating instructions carefully before using the unit. Follow all the safety instructions listed below. Keep these operating instructions handy for future reference.

- 1) Read these instructions.
- 2) Keep these Instructions.
- 3) Heed all warnings.
- 4) Follow all instructions.
- 5) Do not use this apparatus near water.
- 6) Clean only with dry cloth.
- 7) Do not block any ventilation openings. Install in accordance with the manufacturer's instructions.
- 8) Do not install near any heat sources such as radiators, heat registers, stoves, or other apparatus (including amplifiers) that produce heat.
- 9) Do not defeat the safety purpose of the polarized or grounding-type plug. A polarized plug has two blades with one wider than the other. A grounding type plug has two blades and a third grounding prong. The wide blade or the third prong are provided for your safety. If the provided plug does not fit into your outlet, consult an electrician for replacement of the obsolete outlet.
- 10) Protect the power cord from being walked on or pinched particularly at plugs, convenience receptacles, and the point where they exit from the apparatus.
- 11) Only use attachment/accessories specified by the manufacturer.
- 12) Use only with the cart, stand, tripod, bracket, or table specified by the manufacturer, or sold with the apparatus. When a cart is used, use caution when moving the cart/apparatus combination to avoid injury from tip-over.
- 13) Unplug this apparatus during lightning storms or when unused for long periods of time.
- 14) Refer all servicing to qualified service personnel. Servicing is required when the apparatus has been damaged in any way, such as power-supply cord or plug is damaged, liquid has been spilled or objects have fallen into the apparatus, the apparatus has been exposed to rain or moisture, does not operate normally, or has been dropped.



PRECAUTIONS

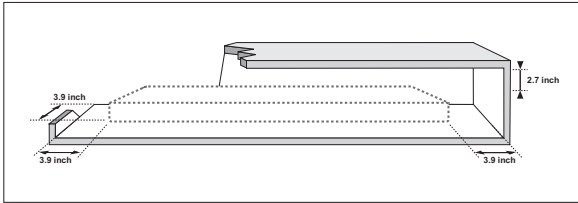

Ensure that the AC power supply in your house complies with the power requirements listed on the identification sticker located on the back of your product. Install your product horizontally, on a suitable base (furniture), with enough space around it for ventilation (3–4 inches). Make sure the ventilation slots are not covered. Do not place the unit on amplifiers or other equipment which may become hot. This unit is designed for continuous use. To fully turn off the unit, disconnect the AC plug from the wall outlet. Unplug the unit if you intend to leave it unused for a long period of time.

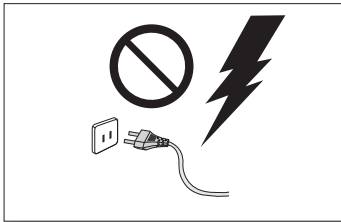

During thunderstorms, disconnect the AC plug from the wall outlet. Voltage peaks due to lightning could damage the unit.

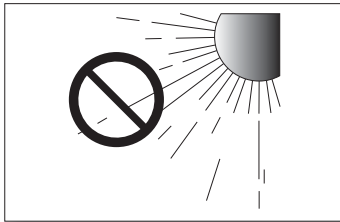

Do not expose the unit to direct sunlight or other heat sources. This could lead to overheating and cause the unit to malfunction.

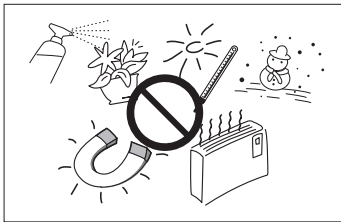

Protect the product from moisture (i.e. vases), and excess heat (e.g. a fireplace) or equipment creating strong magnetic or electric fields. Disconnect the power cable from the AC supply if the unit malfunctions. Your product is not intended for industrial use. It is for personal use only. Condensation may occur if your product has been stored in cold temperatures. If transporting the unit during the winter, wait approximately 2 hours until the unit has reached room temperature before using.

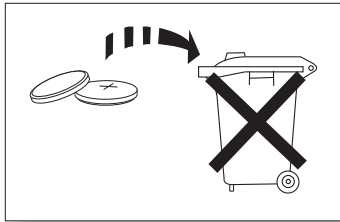

The batteries used with this product contain chemicals that are harmful to the environment. Do not dispose of batteries in the general household trash. Do not dispose of batteries in a fire. Do not short circuit, disassemble, or overheat the batteries. Danger of explosion if battery is incorrectly replaced. Replace only with the same or equivalent type.



WARNING, DO NOT INGEST BATTERY, CHEMICAL BURN HAZARD, The remote control supplied with this product contains a coin/button cell battery. If the coin/button cell battery is swallowed, it can cause severe internal burns in just 2 hours and can lead to death. Keep new and used batteries away from children. If the battery compartment does not close securely, stop using the product and keep it away from children. If you think batteries might have been swallowed or placed inside any part of the body, seek immediate medical attention.

CONTENTS

2 FEATURES

3 SAFETY INFORMATION

- 3 Safety warnings
- 4 Precautions

6 GETTING STARTED

- 6 Before reading the user's manual
- 6 What's included

7 DESCRIPTIONS

- 7 Top/front panel
- 8 Rear panel

9 REMOTE CONTROL

- 9 Tour and Using the remote control

11 INSTALLATION

- 11 SoundStand installation

12 CONNECTIONS

- 12 Connecting an external device using an HDMI cable
- 13 Connecting an external device using OPTICAL (DIGITAL) cable or AUDIO (ANALOG) cable

14 FUNCTIONS

- 14 Input mode
- 14 ARC (HDMI OUT)
- 15 Bluetooth
- 17 NFC (Only HW-H610 model)
- 18 TV SoundConnect
- 19 USB
- 20 Software upgrade

21 TROUBLESHOOTING

22 APPENDIX



- 22 Specifications
- 22 License

GETTING STARTED

BEFORE READING THE USER'S MANUAL

Note the following terms before reading the user manual.

► Icons used in this manual

Icon	Term	Definition
	Caution	Indicates a situation where a function does not operate or settings may be canceled.
	Note	Indicates tips or instructions on the page that help you operate a function.

► Safety Instructions and Troubleshooting

- 1) Be sure to familiarize yourself with the Safety Instructions before using this product. (See page 3)
- 2) If a problem occurs, check Troubleshooting. (See page 21)

► Copyright

©2014 Samsung Electronics Co.,Ltd.

All rights reserved; no part of this user's manual may be reproduced or copied without the prior written permission of Samsung Electronics Co.,Ltd.

WHAT'S INCLUDED

Check for the supplied accessories shown below.

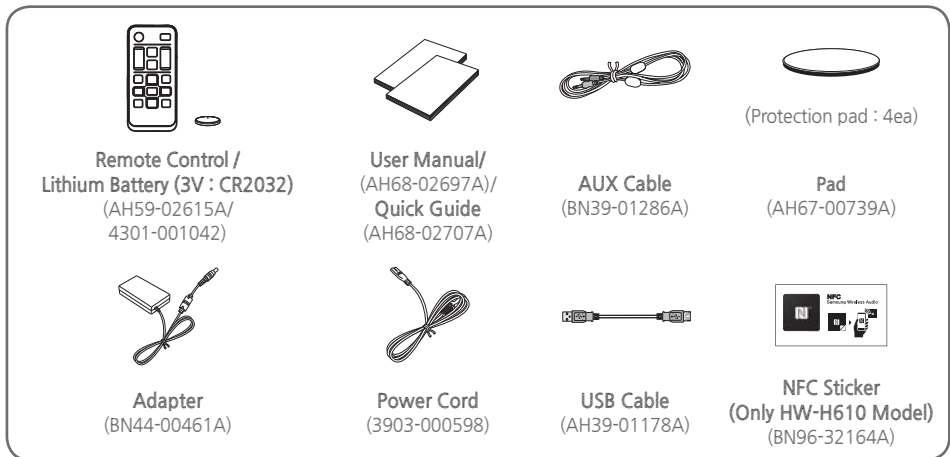

- The appearance of the accessories may differ slightly from the illustrations above.
- Use the dedicated USB cable to connect external USB devices to the unit.

DESCRIPTIONS

TOP/FRONT PANEL

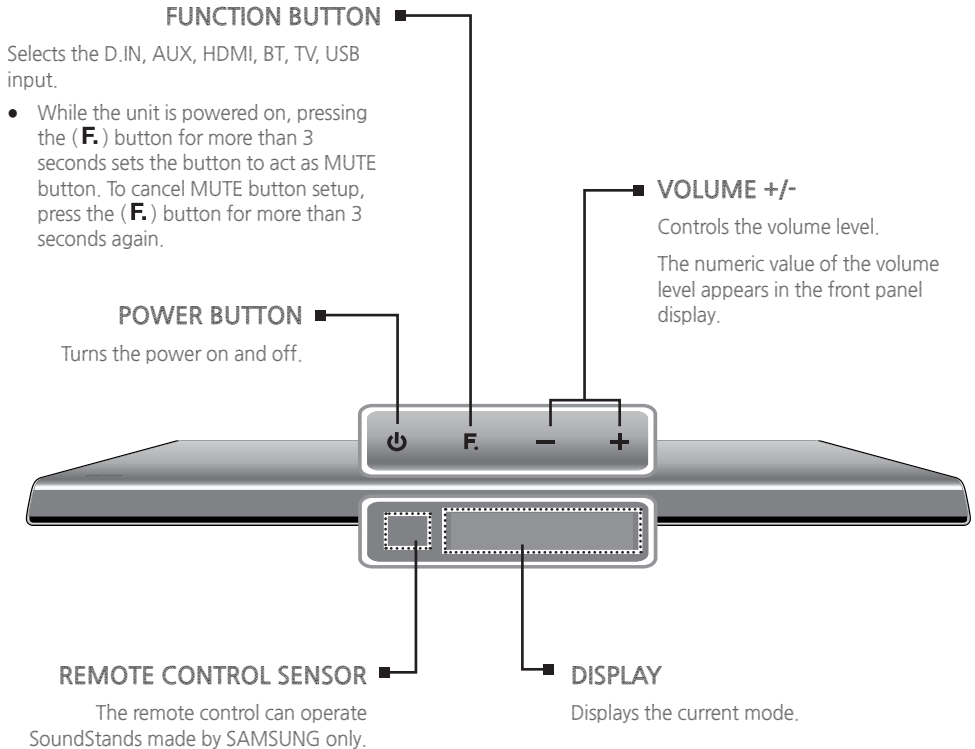

- When you turn on this unit, there will be a 4 to 5 second delay before it produces sound.
- If you want to enjoy the sound only from the SoundStand, you must turn off the TV's speakers in the Audio Setup menu of your TV. Refer to the owner's manual supplied with your TV.

REAR PANEL

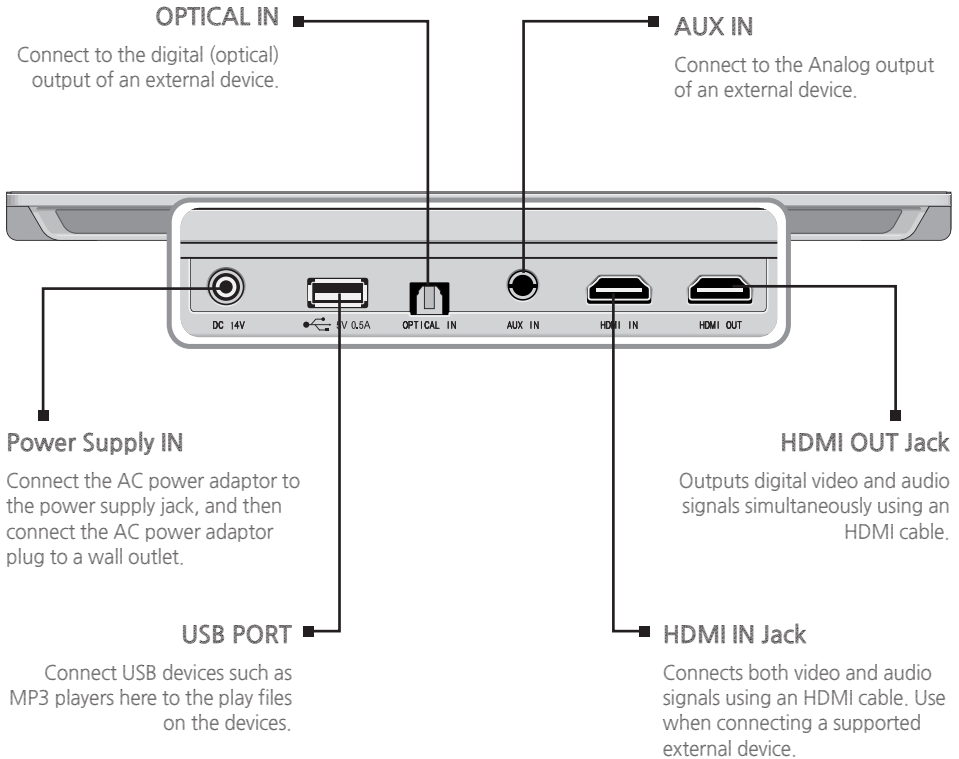

- When disconnecting the power cable of the AC power adaptor from the wall outlet, pull the plug. Do not pull the cable.
- Do not connect this unit or other components to an AC outlet until all connections between components are complete.

REMOTE CONTROL

TOUR AND USING THE REMOTE CONTROL

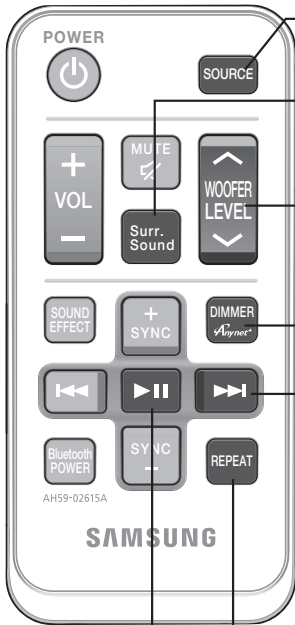

AH59-02615A

SAMSUNG

SOURCE

Press to select a source connected to the SoundStand.

Surr.Sound (Surround Sound Expansion)

Press the **Surr.Sound** button on the remote to control the adds depth and spaciousness to the sound.

SURROUND SOUND AUTO : If the sound source is more than 2 channels then SURROUND SOUND ON turns on automatically. On the other hand, if the sound source is less than 2 channels (STEREO), then mode is automatically set to SURROUND SOUND OFF.

WOOFER LEVEL

You can control the woofer volume.

Press **▲** or **▼** button on the **WOOFER LEVEL** button to increase or decrease the woofer volume. You can set it from SW -6 to SW +6.

DIMMER/ANYNET+

DIMMER : Press the **DIMMER/ANYNET+** button on the remote to control the brightness of the display.

ANYNET+ : Turns on the ANYNET+ function which lets the remote from your Anynet+ Samsung TV control the SoundStand. The ANYNET+ function toggles on and off each time the **DIMMER/ANYNET+** button is pressed and held for more than 5 seconds.

Skip Forward

If there is more than one file on the device you are playing, and you press the **▶▶** button, the next file is selected.

REPEAT

You can set the REPEAT function during music playback from a USB device.

REPEAT OFF : Cancels Repeat Playback.

REPEAT FILE : Repeatedly play a track.

REPEAT ALL : Repeatedly play all tracks.

REPEAT RANDOM : Plays tracks in random order. (A track that has already been played may be played again.)

Play/Pause

Press the **▶||** button again to pause playing the file temporarily.

Press the **▶▶** button again to play the selected file.



- SoundStand is a Samsung proprietary name.
- Operate the TV using the TV's remote control.

POWER
Turns the SoundStand on and off.

MUTE
You can turn the volume down to 0 with the push of a button.
Press again to restore the sound to the previous volume level.

VOLUME
Adjusts the volume level of the unit.

SOUND EFFECT
Press **SOUND EFFECT** on the remote control to select a sound mode. Select the **STANDARD** mode if you want to enjoy the original sound. We recommend that you select a Sound Effect mode based on the source material and your personal taste.

Skip Back
If there is more than one file on the device you are playing, and you press the **⏮** button, the previous file is selected.

Bluetooth POWER
Press the **Bluetooth POWER** button on the remote to turn the Bluetooth Power function on and off.
See pages 16 and 18 for details.

AUDIO SYNC
If the SoundStand is connected to a digital TV and the video appears out of sync with the audio, press the Audio Sync buttons to sync the audio with the video.
Press the **AUDIO SYNC +/-** buttons to set the audio delay from 0 to 300 ms. In USB mode, TV mode, or BT mode, the Audio Sync function may not work.

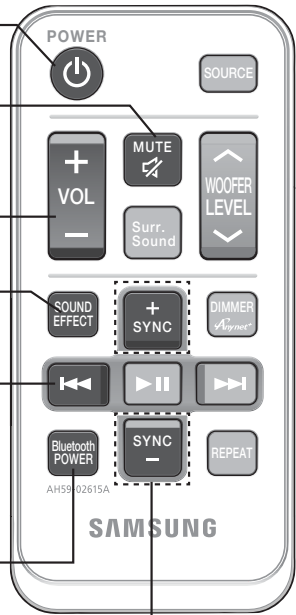

► Installing Batteries in the Remote Control

The diagram illustrates the process of installing batteries in three steps:

1. Use a coin to turn the remote control cover counterclockwise to remove it as shown in the figure above.
2. Insert a 3V lithium battery. Keep the positive (+) pole facing up when inserting the battery. Put the battery cover on and align the '●' marks side by side as shown in the figure above.
3. Use a coin to turn the cover clockwise as far as it will go to fix it in place.





INSTALLATION

SOUNDSTAND INSTALLATION

If you want to place your TV on top of the SoundStand, please make sure that your TV satisfies the two conditions below:

- Maximum TV weight : **77.2 lb (35 kg)**
- Maximum TV stand dimension : **Smaller than 28.4 inches (720 mm) X 12.6 inches (320 mm)**
- ※ Fits most TVs up to 60" and up to 77lbs (*TV screen size and stand type may vary)

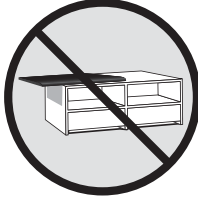
► How to install the SoundStand

	
<p>Correct installation</p>	<p>Do not place the TV to one side on the SoundStand</p>
	
<p>Do not place the SoundStand near the edge of a TV shelf, table, or entertainment center.</p>	<p>Do not place a TV whose base is bigger than the SoundStand's top surface on the SoundStand.</p>



- Do not place the TV to one side on the SoundStand. The TV may tip over and may cause physical injury.
- Make sure to place the SoundStand in the center of the shelf, table, etc., when you install it. Do not place it near an edge.
- If the TV is bigger than the SoundStand, consider a wall-mounted TV installation or place the SoundStand on a stable surface.
- Keep the SoundStand at least two inches (5 cm) away from the wall when you install it.

► Using the protection pads

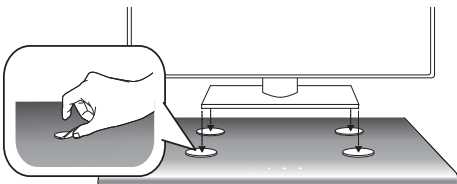
	<p>Place the included protective pads on top of the product and then place the TV stand on top of them to prevent scratches on the product's surface.</p>
---	---

CONNECTIONS

CONNECTING AN EXTERNAL DEVICE USING AN HDMI CABLE

HDMI is the standard digital interface for connecting to such devices as a TVs, projectors, DVD players, Blu-ray players, set top boxes, and more.

HDMI prevents any degradation to the signal due to conversion to analog and maintains the video and audio quality of the original digital source.

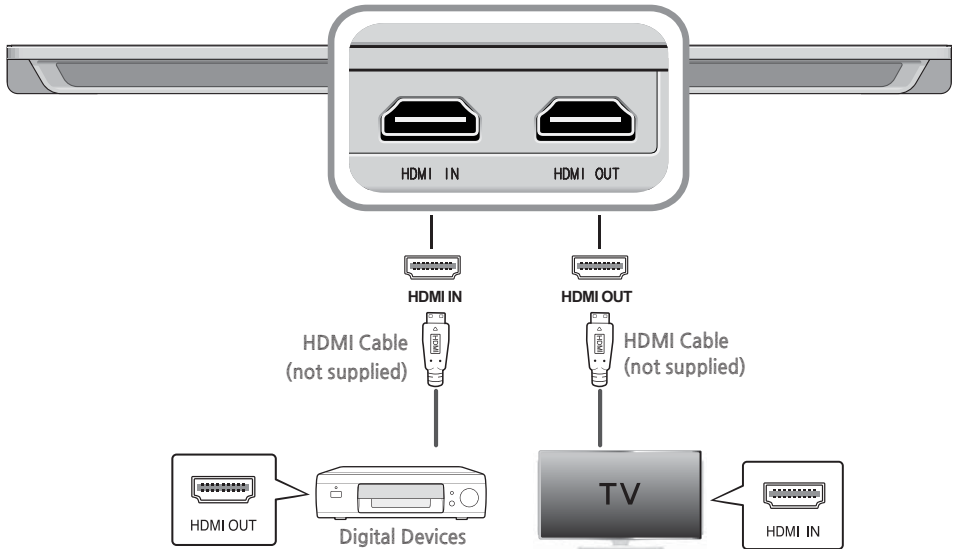

HDMI IN

Connect an HDMI cable (not supplied) from the **HDMI IN** jack on the back of the product to the HDMI OUT jack on your digital device.

and,

HDMI OUT (HDMI)

Connect an HDMI cable (not supplied) from the **HDMI OUT** jack on the back of the product to the HDMI IN jack on your TV.

HDMI OUT (ARC)

The ARC function allows digital audio to output via the **HDMI OUT**(ARC) port. It can be enabled only when the SoundStand is connected to a TV that supports the ARC function



- HDMI is an interface that enables the digital transmission of video and audio data with just a single connector.



- ANYNET+ must be turned on.
- This function is not available if the HDMI cable does not support ARC.

CONNECTING AN EXTERNAL DEVICE USING OPTICAL (DIGITAL) CABLE OR AUDIO (ANALOG) CABLE

This unit comes equipped with one optical in digital jack and one audio analog in jack, giving you two ways to connect it to a TV.

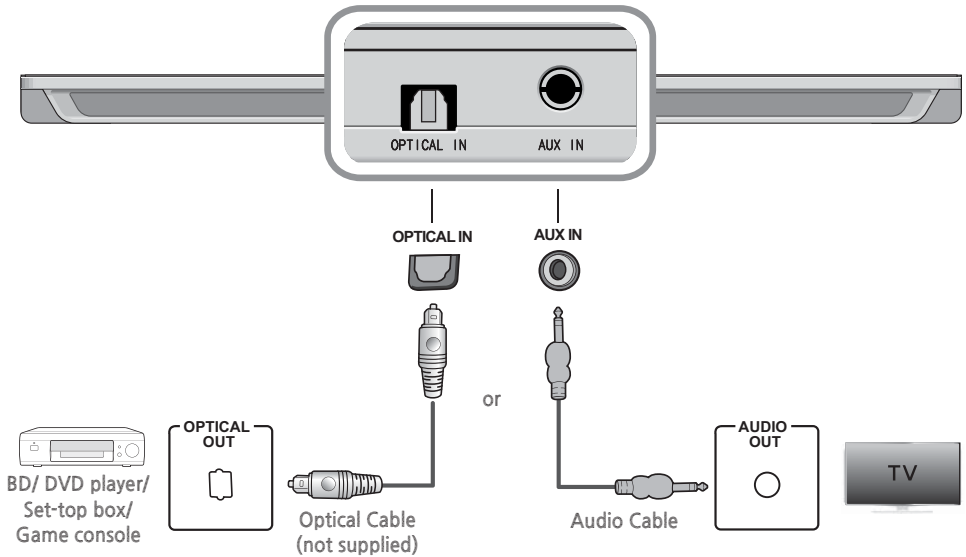

OPTICAL IN

Connect **OPTICAL IN** on the main unit to the **OPTICAL OUT** of the TV or Source Device.



- Do not connect the power cord of this product or your TV to the wall outlet until all connections between components are complete.
- Before moving or installing this product, be sure to turn off the power and disconnect the power cord

AUX IN

Connect **AUX IN** (Audio) on the main unit to the **AUDIO OUT** of the TV or Source Device. Be sure to match connector colors.

or,

FUNCTIONS

INPUT MODE

Press the **SOURCE** button on the remote control or the (**F.**) button on the product's top panel to select the mode you want.



Input mode	Display
Optical Digital input	D.IN
AUX input	AUX
HDMI input	HDMI
BLUETOOTH mode	BT
TV mode	TV
USB mode	USB

The unit turns off automatically in the following situations.

- D.IN/HDMI/BT/TV/USB/ARC Mode
 - If there is no audio signal for 25 minutes.
- AUX Mode
 - If the AUX cable is disconnected for 25 minutes.
 - If there is no KEY input for 8 hours when the AUX cable is connected. To turn this function ON or OFF, press and hold the ►|| button for 5 seconds. AUTO POWER DOWN ON / OFF appears on the display.

ARC (HDMI OUT)



- The ARC function allows digital audio to output via the HDMI OUT (ARC) port. It can be enabled only when the SoundStand is connected to a TV that supports the ARC function.
- ANYNET+ must be turned on.



- This function is not available if the HDMI cable does not support ARC.
- The ARC function is activated in D.IN mode if you have connected the unit to a TV that supports ARC.
- To turn off the ARC function, turn ANYNET+ off.

BLUETOOTH

You can use a Bluetooth device to enjoy music with high quality stereo sound, all without wires!

► To connect the SoundStand to a Bluetooth device

Check if the Bluetooth device supports the Bluetooth compliant stereo headset function.

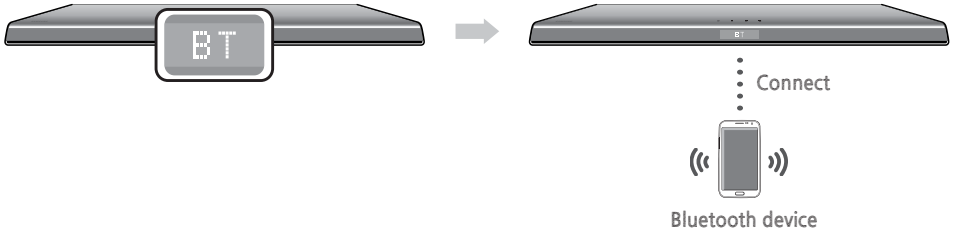

1. Press the **SOURCE** button on the remote control or the **(F.)** button on the product's top panel to display the **BT** message.
2. Select the Bluetooth menu on the Bluetooth device you want to connect. (Refer to the Bluetooth device's user manual.)
3. Select the Stereo headset menu on the Bluetooth device.
 - You will see a list of scanned devices.
4. Select "**[Samsung] SoundStand**" from the list.
 - When the SoundStand is connected to the Bluetooth device, it will display [Bluetooth device name] → **BT** on the front display.
 - The device name can only be displayed in English. An underline " _ " will be displayed if the name is not in English.
 - If the Bluetooth device has failed to pair with the SoundStand, delete the previous "**[Samsung] SoundStand**" found by the Bluetooth device and have it search for the SoundStand again.
5. Play music on the connected device.
 - You can listen to the music playing on the connected Bluetooth device over the SoundStand.
 - In BT mode, the Play/Pause/Next/Prev functions are not available. However, these functions are available in Bluetooth devices supporting AVRCP.



- If asked for PIN code when connecting a Bluetooth device, enter <0000>.
- Only one Bluetooth device can be paired at a time.
- Bluetooth connection will be terminated when you turn the SoundStand off.
- The SoundStand may not perform Bluetooth search or connection correctly under the following circumstances:
 - If there is a strong electrical field around the SoundStand.
 - If several Bluetooth devices are simultaneously paired with SoundStand.
 - If the Bluetooth device is turned off, not in place, or malfunctions.
 - Note that such devices as microwave ovens, wireless LAN adaptors, fluorescent lights, and gas stoves use the same frequency range as the Bluetooth device, which can cause electric interference.
- The SoundStand supports SBC data (44.1kHz, 48kHz).
- Connect only to a Bluetooth device that supports the A2DP (AV) function.
- You cannot connect the SoundStand to a Bluetooth device that supports only the HF (Hands Free) function.

▶ Bluetooth POWER on (Bluetooth POWER)

When the Bluetooth Power On function is on and the SoundStand is turned off, if a previously paired Bluetooth device tries to pair with the SoundStand, the SoundStand turns on automatically.

1. Press the **Bluetooth POWER** button on the SoundStand remote control.
2. Bluetooth POWER on appears on the SoundStand's display.



- Available only if the SoundStand is listed among the Bluetooth device's paired devices. (The Bluetooth device and the SoundStand must have been previously paired at least once.)
- SoundStand will appear in the Bluetooth device's searched devices list only when the SoundStand is displaying [BT READY].
- In the TV SoundConnect mode, the SoundStand cannot be paired to another Bluetooth device.
- If the SoundStand is connected to a TV through TV SoundConnect, and you turn the SoundStand off by turning off the TV, the Bluetooth Power function will not turn the SoundStand on.

▶ To disconnect the Bluetooth device from the SoundStand

You can disconnect the Bluetooth device from the SoundStand. For instructions, see the Bluetooth device's user manual.

- The SoundStand will be disconnected.
- When the SoundStand is disconnected from the Bluetooth device, the SoundStand will display **BT DISCONNECTED** on the front display.

▶ To disconnect the SoundStand from the Bluetooth device

Press the **SOURCE** button on the remote control or the **(F.)** button on the product's top panel to switch from **BT** to another mode or turn off the SoundStand.

- The connected Bluetooth device will wait a certain amount of time for a response from the SoundStand before terminating the connection. (Disconnection time may differ, depending on the Bluetooth device)



- In Bluetooth connection mode, the Bluetooth connection will be lost if the distance between the SoundStand and the Bluetooth device exceeds 16.25 ft. (5m).
- If the Bluetooth device comes back into the effective range after disconnecting, you can restart the SoundStand to restore the pairing with the Bluetooth device.
- The SoundStand automatically turns off after 25 minutes in the Ready state.

More About Bluetooth

Bluetooth is a technology that enables Bluetooth-compliant devices to interconnect easily with each other using a short wireless connection.

- A Bluetooth device may cause noise or malfunction, depending on usage, when:
 - A part of your body is in contact with the receiving/transmitting system of the Bluetooth device or the SoundStand.
 - It is subject to electrical variation from obstructions caused by a wall, corner, or office partition.
 - It is exposed to electrical interference from same frequency-band devices including medical equipment, microwave ovens, and wireless LANs.
- Pair the SoundStand with the Bluetooth device while they are close together.
- The further the distance between the SoundStand and Bluetooth device, the worse the quality is. If the distance exceeds the Bluetooth operational range, the connection is lost.
- In poor reception-sensitivity areas, the Bluetooth connection may not work properly.
- The Bluetooth connection only works when it is close to the unit. The connection will be automatically cut off if the Bluetooth device is out of range. Even within range, the sound quality may be degraded by obstacles such as walls or doors.
- This wireless device may cause electric interference during its operation.

NFC (ONLY HW-H610 MODEL)

You can connect your SoundStand to an NFC-enabled smart device through a Bluetooth connection with a simple setup. Once connected, you can enjoy music stored in your smart device through the SoundStand.

▶ Connecting with NFC and smart devices

Attach the NFC sticker label on a desired and then approach your smart device to the NFC label.

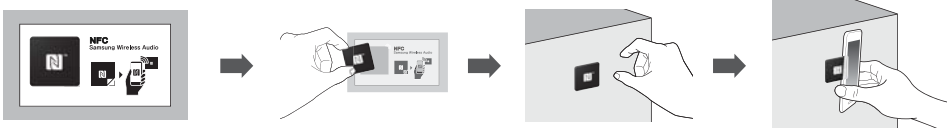

▶ Connecting with NFC

1. Detach the NFC sticker label and attach it to a desired spot.
 - Putting the NFC sticker within a 3m radius from the unit is recommended.
2. Enable the NFC function of your smart device.
3. Bring your smart device's NFC antenna close to the NFC label.
4. When the connection prompt appears on your smart device's display, select <Yes>.
 - Once the connection is established, the completion message appears.

▶ Disconnecting NFC

Bring your smart device's NFC antenna close to the NFC label on the SoundStand again. The disconnection message appears on the smart device's display.

▶ To connect another smart device to the SoundStand which is already connected to another NFC compatible device

After disconnecting from the previously connected device, bring the new smart device close to the NFC label of the SoundStand.



- The NFC function is implemented in Android v4.1.2 Jelly Bean and later operating systems.
 - To make NFC connections, your smart device needs both Android OS 4.1.2 Jelly Bean or later and the NFC tag for NFC function execution. You also need to download the "Samsung NFC Connection" application from the Google Playstore and install it on your smart device. For further details, please refer to the smart device's user manual.
- The location of the NFC antenna is different in different devices. Confirm the location of your smart device's antenna in the device's user manual before attempting to pair it with the SoundStand.
- If your smart device is in a thick housing or case, the NFC connection may not be stable.
- The N-mark is a trade mark or registered trade mark of the NFC Forum Inc. in the United States and other countries.
- If you have trouble with an NFC connection
 - Actually touching your smart device to the NFC label can cause NFC connection failure.
 - If the "Empty tag" error is displayed on the smart device, please try again.
 - Check whether your smart device's antenna is close enough to the NFC logo on the SoundStand.
- If you turn off the SoundStand when the Bluetooth Power On feature is ON, and then try to connect a Bluetooth device that has been previously connected using NFC, the SoundStand will turn on automatically when the device connects.
To set the Bluetooth Power On option, see page 16.

TV SOUNDCONNECT

You can enjoy TV sound through your SoundStand connected to a Samsung TV that supports the TV SoundConnect function.

► Connecting a TV to the SoundStand

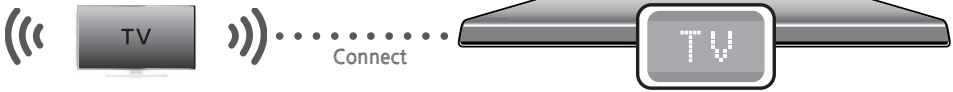

1. Turn on the TV and SoundStand.
 - Set the "Add New Device" menu of the TV to "On".
2. Press the **(F.)** button on the main unit's top panel or the **SOURCE** button on the remote control to select the TV mode.
3. On the TV, a message asking whether to enable the TV SoundConnect function. "[Samsung] SoundStand" is displayed on the TV screen.
4. Select **<Yes>** to finish connecting the TV and SoundStand.



- TV SoundConnect Operational Range
 - Recommended pairing range: within 20 inches (within 50cm)
 - Recommended operational range: within 16.25 ft. (5m)
- PLAY, NEXT, PREV and STOP buttons are not operable in TV SoundConnect mode.



- Switching the SoundStand's mode from TV to another automatically terminates TV SoundConnect.
- To connect the SoundStand to another TV, the existing connection must be terminated.
- Terminate the connection to the existing TV, then press the **▶||** button on the remote control for 5 seconds to connect to another TV.



- The TV SoundConnect (SoundShare) function is supported by some Samsung TVs released from 2012 on. Check whether your TV supports the TV SoundConnect(SoundShare) function before you begin. (For further information, refer to the TV's user manual.)
- If your Samsung TV is released before 2014, check the SoundShare setting menu.
- If the distance between the TV and SoundStand exceeds 16.25 ft. (5m), the connection may not be stable or the audio may stutter. If this occurs, relocate the TV or SoundStand so that they are within operational range, and then re-establish the TV SoundConnect connection.

► Using the Bluetooth POWER On function

After the TV and the SoundStand have been connected using TV SoundConnect, if you set the Bluetooth Power On function on, the SoundStand will turn on and off automatically when you turn the TV on or off.

1. Connect the TV with your SoundStand using the TV SoundConnect function.
2. Press the **Bluetooth POWER** button on the SoundStand remote. "BLUETOOTH POWER ON" appears on the SoundStand's display.
 - BLUETOOTH POWER ON : The SoundStand turns on and off when you turn the TV on or off.
 - BLUETOOTH POWER OFF : The SoundStand only turns off when you turn the TV off.



- This function is supported only by some Samsung TVs released from 2013 on.
- If the SoundStand is connected to a TV through TV SoundConnect, and you turn the SoundStand off by turning off the TV, the Bluetooth Power function will not turn the SoundStand on, even if you connect another Bluetooth device to it.

USB

You can play music files located on USB storage devices.

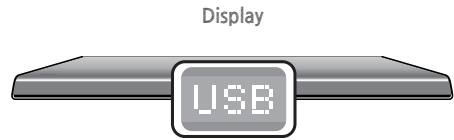
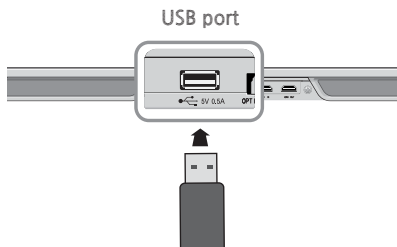

1. Connect the USB device to the USB port on the back of the product.
2. Press the **SOURCE** button on the remote control or the **(F.)** button on the product's top panel repeatedly until **USB** appears.
3. **USB** appears on the display screen.
 - The SoundStand connection to the USB device is complete.
 - The SoundStand automatically turns off (Auto Power Off) if no USB device has been connected for more than 25 minutes.

- Mobile phone devices are not supported.
- File Format Type Compatibility list:

Format	Codec
*.mp3	MPEG 1 Layer2
	MPEG 1 Layer3
	MPEG 2 Layer3
	MPEG 2.5 Layer3
*.wma	Wave_Format_MSAudio1
	Wave_Format_MSAudio2
*.aac	AAC
	AAC-LC
	HE-AAC
*.wav	-
*.ogg	OGG 1.1.0
*.flac	FLAC 1.1.0, FLAC 1.2.1

※ Supported Sampling Rate above 16KHz.

► Before you connect a USB device

Be aware of the following:

- If the file name of a file or folder on a USB device exceeds 10 characters, it is not displayed on the SoundStand's display.
- This product may not be compatible with certain types of USB storage media.
- The SoundStand supports the FAT16 and FAT32 file systems.
 - The NTFS file system is not supported.
- Connect USB devices directly to the USB port of the product. Otherwise, you may encounter a USB compatibility problem.
- Do not connect multiple storage devices to the product via a multi-card reader. It may not operate properly.
- Digital camera PTP protocols are not supported.
- Do not remove the USB device while it is being read.
- DRM-protected music files (MP3, WMA) from a commercial web site cannot be played.
- External HDDs are not supported.

SOFTWARE UPGRADE

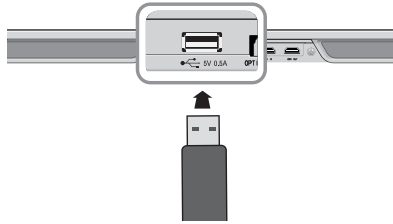

Samsung may offer upgrades for the SoundStand's system firmware in the future.

If an upgrade is offered, you can upgrade the firmware by connecting a USB device with the firmware upgrade stored on it to the USB port on your SoundStand.

Note that if there are multiple upgrade files, you must load them onto the USB device singly and use them to upgrade the firmware one at a time.

Please visit samsung.com or contact the Samsung call center to receive more information about downloading upgrades files.



- Insert a USB device containing the firmware upgrade into the USB port on the main unit.
- Do not disconnect the power or remove the USB device while upgrades are being applied. The main unit will turn off automatically after completing the firmware upgrade. When software is upgraded, all settings are reset to their factory default settings. We recommend you write down your settings so that you can easily reset them after the upgrade.
- Once the software upgrade is completed, turn off the product and then press and hold the (▶||) button for a while to reset the product.
- If the firmware fails to upgrade, we recommend formatting the USB device in FAT16 and trying again.
- Do not format the USB device in the NTFS format. The SoundStand does not support the NTFS file system.
- Depending on the manufacturer, some USB devices may not be supported.

TROUBLESHOOTING

Before requesting service, please check the following.

The unit will not turn on.

- | | |
|--|---|
| • Is the power cord plugged into the outlet? | → Connect the power plug to the outlet. |
|--|---|

A function does not work when the button is pressed.

- | | |
|---|---|
| • Is there static electricity in the air? | → Disconnect the power plug and connect it again. |
|---|---|

Sound is not produced.

- | | |
|---------------------------------|---|
| • Is the Mute function on? | → Press the Mute button to cancel the function. |
| • Is the volume set to minimum? | → Adjust the volume. |

The remote control does not work.

- | | |
|---|-------------------------------|
| • Are the batteries drained? | → Replace with new batteries. |
| • Is the distance between the remote control and main unit too far? | → Move closer to the unit. |

The TV SoundConnect (TV pairing) failed.

- | | |
|---|--|
| • Does your TV support TV SoundConnect? | → TV SoundConnect is supported by some Samsung TVs released after 2012. Check your TV to see if it supports TV SoundConnect. |
| • Is your TV firmware the latest version? | → Update your TV with the latest firmware. |
| • Does an error occur when connecting? | → Contact the Samsung call center. |
| • Reset the TV MODE and connect again. | → Press and hold the ► button for 5 seconds to reset the TV SoundConnect connection. |

APPENDIX

SPECIFICATIONS

Model name	HW-H600, HW-H610	
GENERAL	Power supply	DC 14V
	Standby power consumption	0.45 W
	Power consumption	20 W
	USB	5V/0.5A
	Weight	11.02 lbs
	Dimensions (W x H x D)	28.94 x 1.43 x 14.17 inches
	Operating temperature range	+41°F to +95°F
	Operating humidity range	10 % to 75 %
AMPLIFIER	Rated output power	80 W(MID/TWT = 8 OHM, SW = 4 OHM) THD = 10 %, 1 kHz
	S/N ratio (analog input)	65 dB
	Separation (1kHz)	65 dB

- * S/N ratio, distortion, separation, and usable sensitivity are based on measurements using AES (Audio Engineering Society) guidelines.
- * Nominal specification
 - Samsung Electronics Co., Ltd reserves the right to change the specifications without notice.
 - Weight and dimensions are approximate.

LICENSE



Manufactured under license from Dolby Laboratories. Dolby and the double-D symbol are trademarks of Dolby Laboratories.



For DTS patents, see <http://patents.dts.com>. Manufactured under license from DTS Licensing Limited. DTS, the Symbol, & DTS and the Symbol together are registered trademarks, and DTS 2.0 Channel is a trademark of DTS, Inc. © DTS, Inc. All Rights Reserved.

HDMI

The terms HDMI and HDMI High-Definition Multimedia Interface, and the HDMI Logo are trademarks or registered trademarks of HDMI Licensing LLC in the United States and other countries.

- To send inquiries and requests regarding open sources, contact Samsung via Email (oss.request@samsung.com).



As an ENERGY STAR Partner, Samsung has determined that this product or product models meets the ENERGY STAR guidelines for energy efficiency.

WARRANTY

LIMITED WARRANTY TO ORIGINAL PURCHASER

This SAMSUNG brand product, as supplied and distributed by Samsung Electronics America, Inc. (SAMSUNG) and delivered new, in the original carton to the original consumer purchaser, is warranted by SAMSUNG against manufacturing defects in materials and workmanship for a limited warranty period of:

One (1) Year Parts and Labor* (*90 Days Parts and Labor for Commercial Use)

This limited warranty begins on the original date of purchase, and is valid only on products purchased and used in the United States. To receive warranty service, the purchaser must contact SAMSUNG for problem determination and service procedures. Warranty service can only be performed by a SAMSUNG authorized service center. The original dated bill of sale must be presented upon request as proof of purchase to SAMSUNG or SAMSUNG's authorized service center. Transportation of the product to and from the service center is the responsibility of the purchaser.

SAMSUNG will repair or replace this product, at our option and at no charge as stipulated herein, with new or reconditioned parts or products if found to be defective during the limited warranty period specified above. All replaced parts and products become the property of SAMSUNG and must be returned to SAMSUNG. Replacement parts and products assume the remaining original warranty, or ninety (90) days, whichever is longer.

SAMSUNG's obligations with respect to software products distributed by SAMSUNG under the SAMSUNG brand name are set forth in the applicable end user license agreement. Non-SAMSUNG hardware and software products, if provided, are on an "AS IS" basis. Non-SAMSUNG manufacturers, suppliers, publishers, and service providers may provide their own warranties.

This limited warranty covers manufacturing defects in materials and workmanship encountered in normal, and except to the extent otherwise expressly provided for in this statement, noncommercial use of this product, and shall not apply to the following, including, but not limited to: damage which occurs in shipment; delivery and installation; applications and uses for which this product was not intended; altered product or serial numbers; cosmetic damage or exterior finish; accidents, abuse, neglect, fire, water, lightning or other acts of nature; use of products, equipment, systems, utilities, services, parts, supplies, accessories, applications, installations, repairs, external wiring or connectors not supplied and authorized by SAMSUNG, or which damage this product or result in service problems; incorrect electrical line voltage, fluctuations and surges; customer adjustments and failure to follow operating instructions, cleaning, maintenance and environmental instructions that are covered and prescribed in the instruction book; product removal or reinstallation; reception problems and distortion related to noise, echo, interference or other signal transmission and delivery problems. SAMSUNG does not warrant uninterrupted or error-free operation of the product.

THERE ARE NO EXPRESS WARRANTIES OTHER THAN THOSE LISTED AND DESCRIBED ABOVE, AND NO WARRANTIES WHETHER EXPRESS OR IMPLIED, INCLUDING, BUT NOT LIMITED TO, ANY IMPLIED WARRANTIES OF MERCHANTABILITY OR FITNESS FOR A PARTICULAR PURPOSE, SHALL APPLY AFTER THE EXPRESS WARRANTY PERIODS STATED ABOVE, AND NO OTHER EXPRESS WARRANTY OR GUARANTY GIVEN BY ANY PERSON, FIRM OR CORPORATION WITH RESPECT TO THIS PRODUCT SHALL BE BINDING ON SAMSUNG. SAMSUNG SHALL NOT BE LIABLE FOR LOSS OF REVENUE OR PROFITS, FAILURE TO REALIZE SAVINGS OR OTHER BENEFITS, OR ANY OTHER SPECIAL, INCIDENTAL OR CONSEQUENTIAL DAMAGES CAUSED BY THE USE, MISUSE OR INABILITY TO USE THIS PRODUCT, REGARDLESS OF THE LEGAL THEORY ON WHICH THE CLAIM IS BASED, AND EVEN IF SAMSUNG HAS BEEN ADVISED OF THE POSSIBILITY OF SUCH DAMAGES. NOR SHALL RECOVERY OF ANY KIND AGAINST SAMSUNG BE GREATER IN AMOUNT THAN THE PURCHASE PRICE OF THE PRODUCT SOLD BY SAMSUNG AND CAUSING THE ALLEGED DAMAGE. WITHOUT LIMITING THE FOREGOING, PURCHASER ASSUMES ALL RISK AND LIABILITY FOR LOSS, DAMAGE OR INJURY TO PURCHASER AND PURCHASER'S PROPERTY AND TO OTHERS AND THEIR PROPERTY ARISING OUT OF THE USE, MISUSE OR INABILITY TO USE THIS PRODUCT SOLD BY SAMSUNG NOT CAUSED DIRECTLY BY THE NEGLIGENCE OF SAMSUNG. THIS LIMITED WARRANTY SHALL NOT EXTEND TO ANYONE OTHER THAN THE ORIGINAL PURCHASER OF THIS PRODUCT, IS NONTRANSFERABLE AND STATES YOUR EXCLUSIVE REMEDY.

The benefits of this Limited Warranty extend only to the original purchaser of Samsung products from an authorized Samsung reseller. THIS LIMITED WARRANTY SHALL NOT APPLY TO ANY SAMSUNG PRODUCTS PURCHASED FROM UNAUTHORIZED RESELLERS OR RETAILERS, EXCEPT IN STATES WHERE SUCH RESTRICTION MAY BE PROHIBITED. For a list of Samsung authorized retailers, please go to: http://www.samsung.com/us/peaceofmind/authorized_resellers.html

Some states do not allow limitations on how long an implied warranty lasts, or the exclusion or limitation of incidental or consequential damages, so the above limitations or exclusions may not apply to you. This warranty gives you specific legal rights, and you may also have other rights which vary from state to state.

To obtain warranty hardware service, please contact SAMSUNG customer care center.



QUESTIONS OR COMMENTS?

COUNTRY	CALL	OR VISIT US ONLINE AT	WRITE
U.S.A	1-800-SAMSUNG (726-7864)	www.samsung.com/us/ support	Samsung Electronics America, Inc. 85 Challenger Road Ridgefield Park, NJ 07660

Free Manuals Download Website

<http://myh66.com>

<http://usermanuals.us>

<http://www.somanuals.com>

<http://www.4manuals.cc>

<http://www.manual-lib.com>

<http://www.404manual.com>

<http://www.luxmanual.com>

<http://aubethermostatmanual.com>

Golf course search by state

<http://golfingnear.com>

Email search by domain

<http://emailbydomain.com>

Auto manuals search

<http://auto.somanuals.com>

TV manuals search

<http://tv.somanuals.com>