

**SAMSUNG**

# Digital Surround AV Receiver System *HT-AS600*

**SAMSUNG ELECTRONICS CANADA, INC.**

**HEADQUARTERS**

7037 Financial Drive, Mississauga, Ontario, Canada L5N 6R3  
TEL: 1-905-542-3535  
[www.samsung.ca](http://www.samsung.ca)

**SERVICE DIVISION**

7037 Financial Drive, Mississauga, Ontario, Canada L5N 6R3  
1-800-SAMSUNG (1-800-726-7864)

**SAMSUNG**

ELECTRONICS

## Instruction Manual



AH68-01725S



# Safety Warnings

# Precautions

**CAUTION**  
RISK OF ELECTRIC SHOCK.  
DO NOT OPEN

**CAUTION:**  
TO REDUCE THE RISK OF ELECTRIC SHOCK, DO NOT REMOVE REAR COVER. NO USER SERVICEABLE PARTS INSIDE. REFER SERVICING TO QUALIFIED SERVICE PERSONNEL.

Note to CATV system installer :  
This reminder is provided to call the CATV system installer's attention to Section 820-40 of the NEC which provides guidelines for proper grounding and, in particular, specifies that the cable ground shall be connected to the grounding system of the building, as close to the point of cable entry as practical

-  This symbol indicates that dangerous voltage which can cause electric shock is present inside this unit.
-  This symbol alerts you to important operating and maintenance instructions accompanying the unit.

**WARNING:** To reduce the risk of fire or electric shock, do not expose this appliance to rain or moisture.

**CAUTION:** TO PREVENT ELECTRIC SHOCK, MATCH WIDE BLADE OF PLUG TO WIDE SLOT, FULLY INSERT.

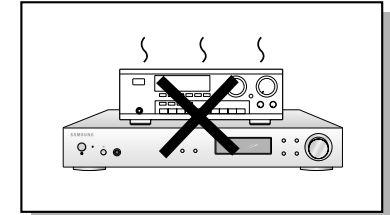
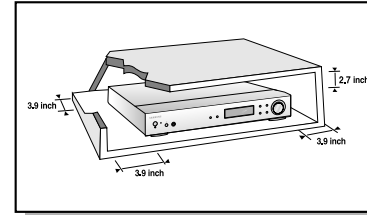

Ensure that the AC power supply in your house complies with the identification sticker located on the back of your player. Install your player horizontally, on a suitable base (furniture), with enough space around it for ventilation (3-4inches). Make sure the ventilation slots are not covered. Do not stack anything on top of the player. Do not place the player on amplifiers or other equipment which may become hot. Before moving the player, ensure the disc tray is empty. This player is designed for continuous use. Switching off the DVD player to the stand-by mode does not disconnect the electrical supply. In order to disconnect the player completely from the power supply, remove the main plug from the wall outlet, especially when left unused for a long period of time.

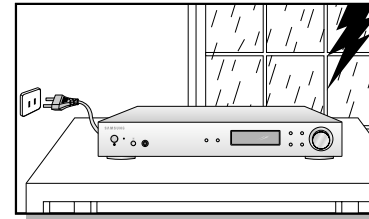

During thunderstorms, disconnect AC main plug from the wall outlet. Voltage peaks due to lightning could damage the unit.

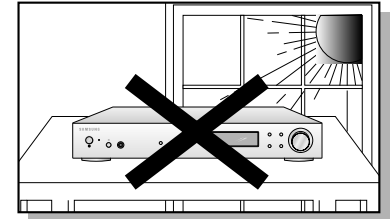

Do not expose the unit to direct sunlight or other heat sources. This could lead to overheating and malfunction of the unit.

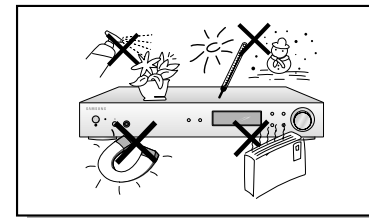

Protect the player from moisture (i.e. vases), and excess heat (e.g. fireplace) or equipment creating strong magnetic or electric fields (i.e. speakers...). Disconnect the power cable from the AC supply if the player malfunctions. Your player is not intended for industrial use. Use of this product is for personal use only. Condensation may occur if your player or disc have been stored in cold temperatures. If transporting the player during the winter, wait approximately 2 hours until the unit has reached room temperature before using.

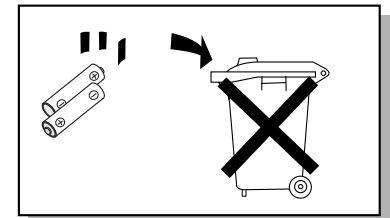

The battery used with this product contains chemicals that are harmful to the environment. Do not dispose of batteries in the general household trash.



# Features

## Dolby Pro Logic II

Dolby Pro Logic II is a new form of multi-channel audio signal decoding technology that improves upon existing Dolby Pro Logic.

## DTS (Digital Theater Systems)

DTS plays back 5.1 channel sound with less compression than Dolby Digital for richer sound.



# Contents

## PREPARATION

- Safety Warnings .....1
- Precautions.....2
- Features .....3
- Description .....5

## CONNECTIONS

- Connecting the Speakers .....9
- Connecting External Components .....11
- Connecting the FM and AM Antennas.....14

## OPERATION

- Before Using the AV Receiver .....15
- Selecting External Component Input .....16
- Setting the Speaker Mode .....17
- Setting the Speaker Listening Distance.....19
- Setting DRC (Dynamic Range Compression) .....21
- Test Tone .....22
- Setting Speaker Level .....25
- Dolby Pro Logic II Mode.....27
- Dolby Pro Logic II Effect .....29
- SFE Mode.....31
- Stereo Mode .....33

## RADIO OPERATION

- Listening to Radio .....35
- Presetting Radio Stations .....36

## MISCELLANEOUS

- Convenient Functions 37
- Operating TV with Remote Control.....39
- Operating your VCR (DVD) with Remote Control.....41
- Before Calling for Service.....43
- Specifications .....45
- WARRANTY .....46

PREPARATION

# Description

## [ Front Panel ]

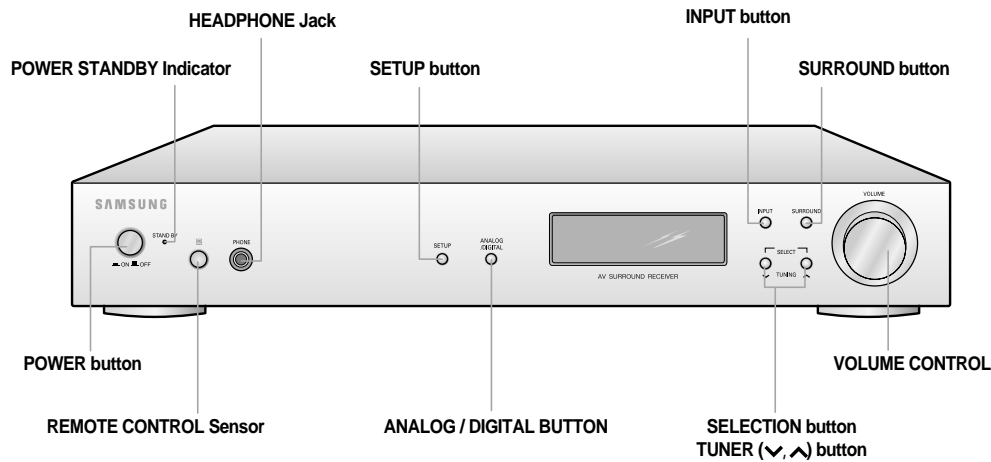

## [ Display ]

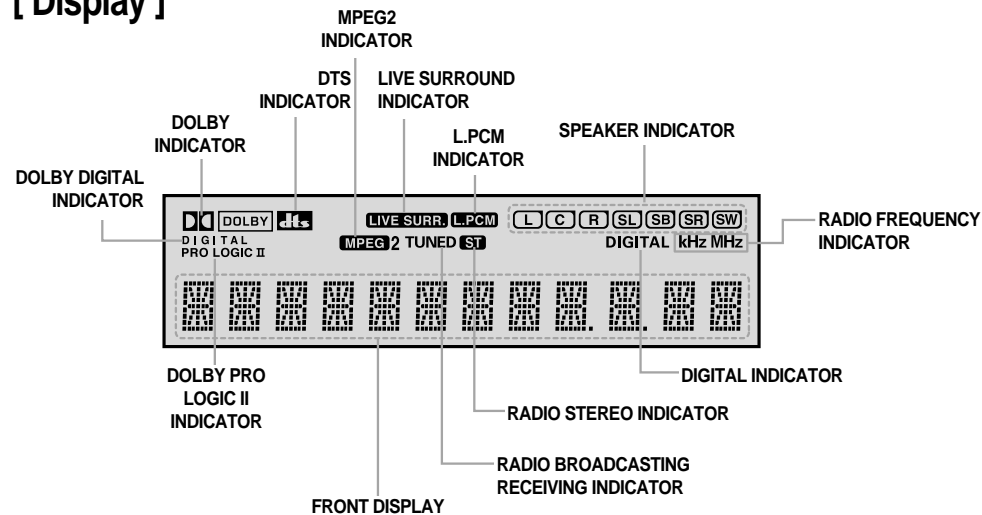

## [ Rear Panel ]

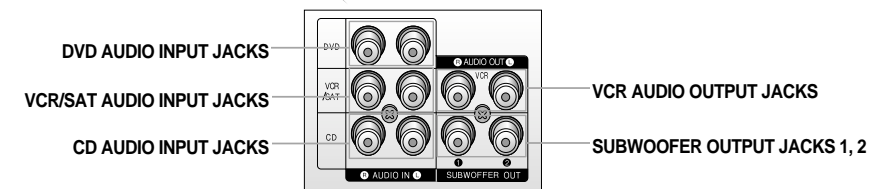
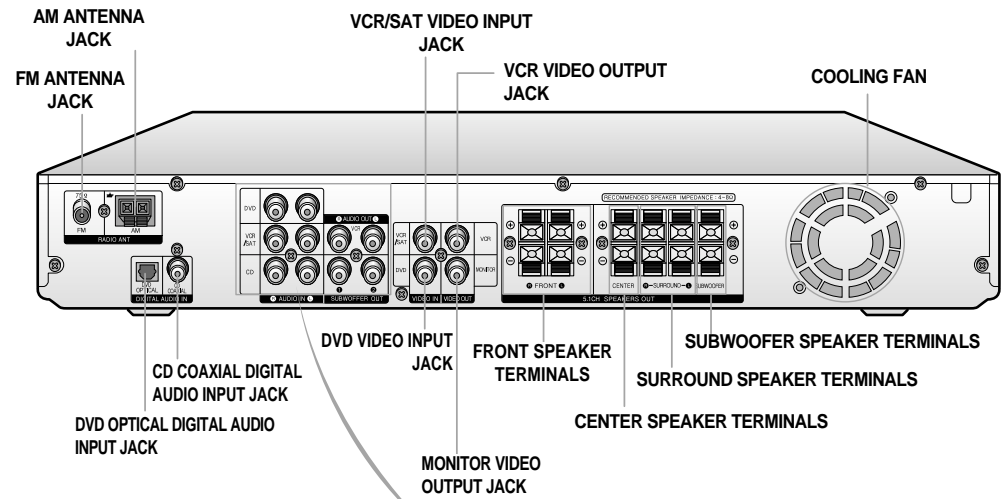

## ▶▶ Accessories ◀◀

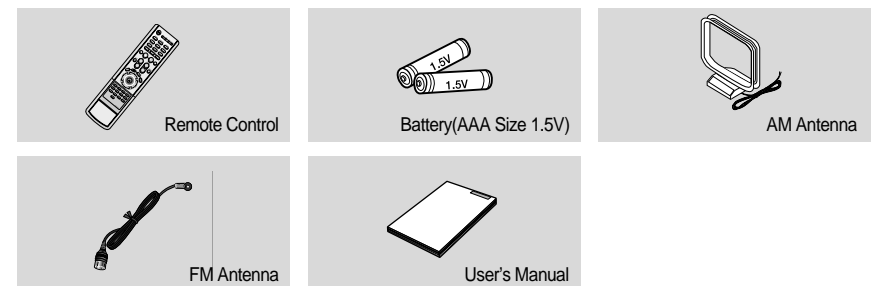

# Description

## [ Remote Control ]

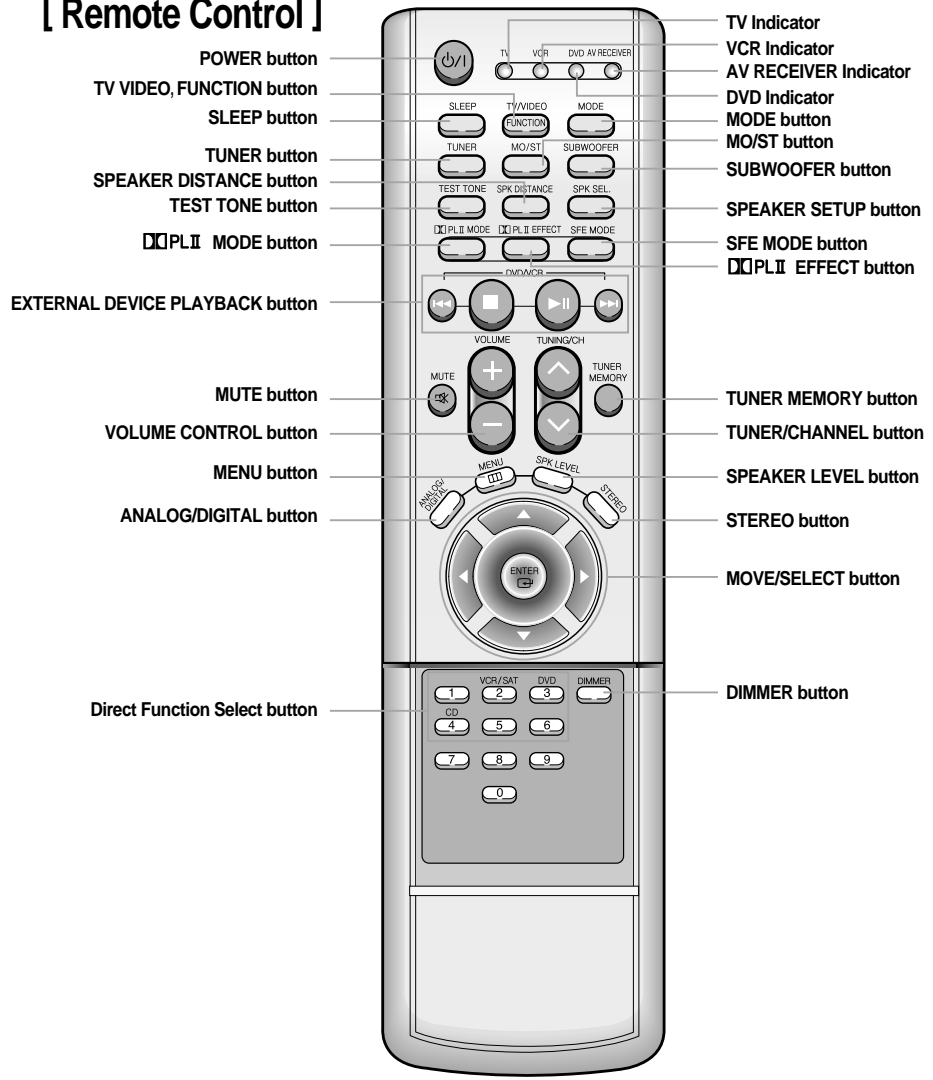

## Insert Remote Batteries

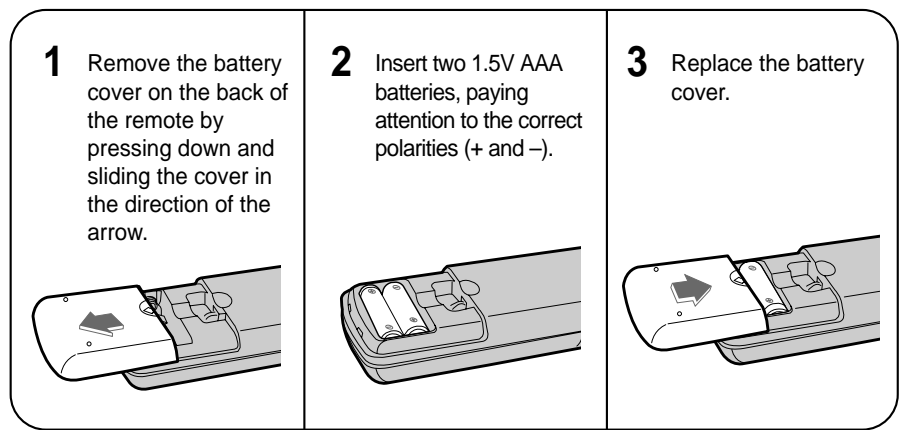

- Note**
- Follow these precautions to avoid leaking or cracking batteries:
    - Place batteries in the remote control so they match the polarity: (+) to (+) and (-) to (-).
    - Use the correct type of batteries. Batteries that look similar may differ in voltage.
    - Always replace both batteries at the same time.
    - Do not expose batteries to heat or flame.

## Range of Operation of the Remote Control

The remote control can be used up to approximately 23 feet/7 meters in a straight line. It can also be operated at a horizontal angle of up to 30° from the remote control sensor.

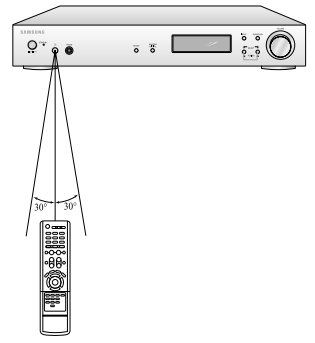

To open the remote control cover, push the top of the cover, then slide downward.



# Connecting the Speakers

Before moving or installing the product, be sure to turn off the power and disconnect the power cord.

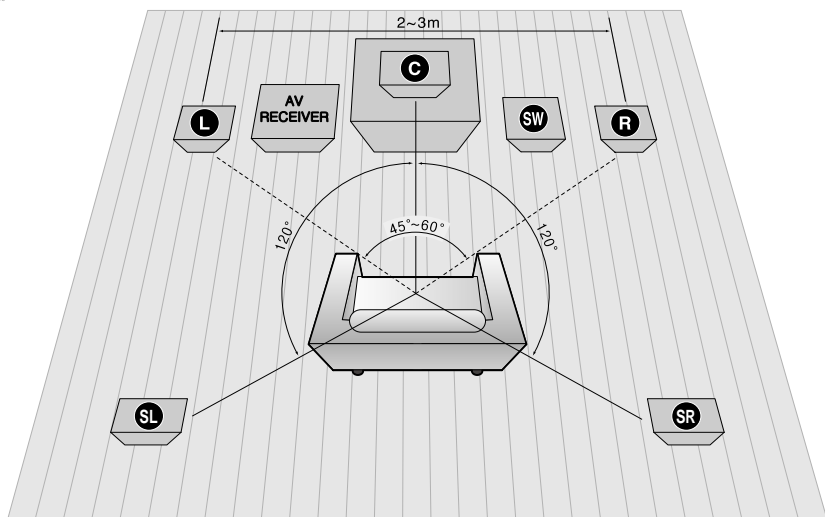

## Position of AV Receiver

- Place AV Receiver on a dedicated stand or rack.

## Front Speakers (L R)

- Place these speakers in front of your listening position, facing inwards (about 45°) toward you.
- Place the speakers so that their tweeters will be at the same height as your ear.
- Align the front face of the front speakers with the front face of the center speaker or place them slightly in front of the center speakers.

## Center Speaker (C)

- It is best to install it at the same height as the front speakers.
- You can also install it directly over or under the TV.

## Surround Speakers (SL SR)

- Place these speakers behind your listening position.
- If there isn't enough room, place these speakers so they face each other.
- Place them about 60 to 90cm (2 to 3feet) above your ear, facing slightly downward.
- Unlike the front and center speakers, the surround speakers are used to handle mainly sound effects and sound will not come from them all the time.

## Subwoofer (SW)

- The position of the subwoofer is not so critical. Place it anywhere you like.

**Note** When you place the speaker on the wall, make sure to fasten it tightly so that it may not fall off.

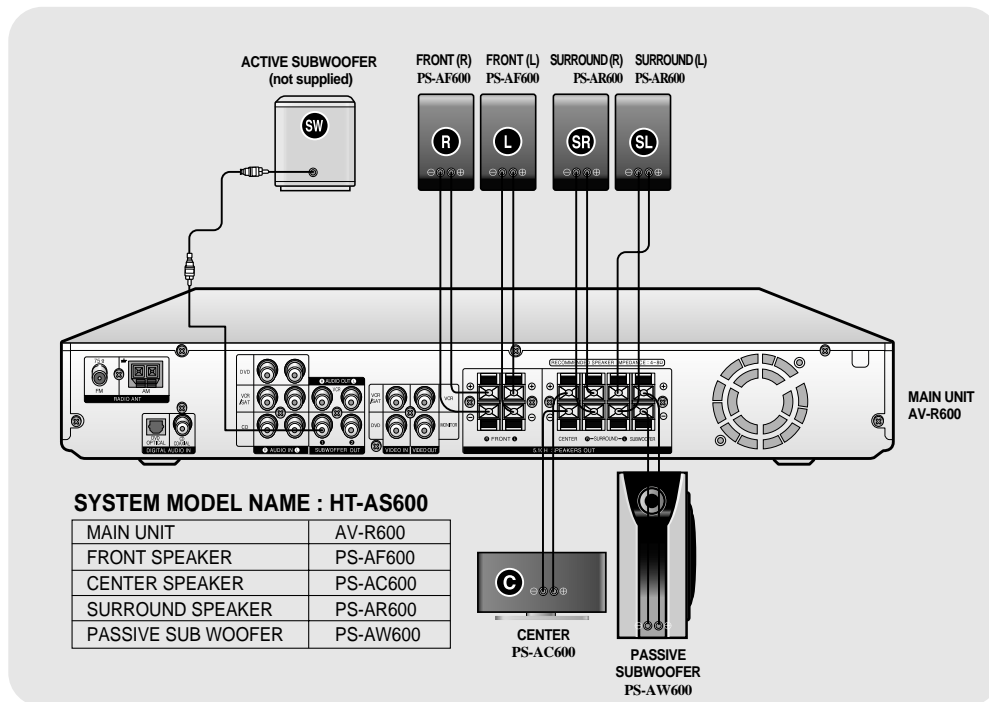

## Connecting Speaker Wire

- Press the tab of the speaker connector.
- Insert the black wire into the black(-) terminal and the gray wire into the gray(+) terminal.

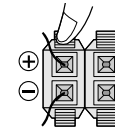
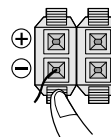

**Note** Never touch speaker terminals while the power is on. Doing so could result in electric shock. Make sure the polarities (+ and -) are correct.



# Connecting External Components

## Connecting Video Component

Before moving or installing the product, be sure to turn off the power and disconnect the power cord.

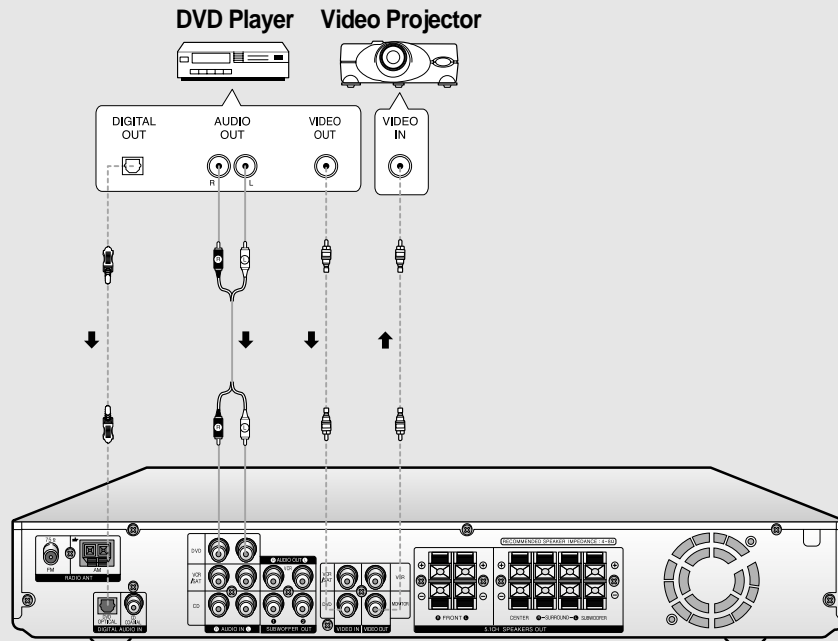

• Disconnect the power plug from the outlet if you do not use this unit for long period of time.

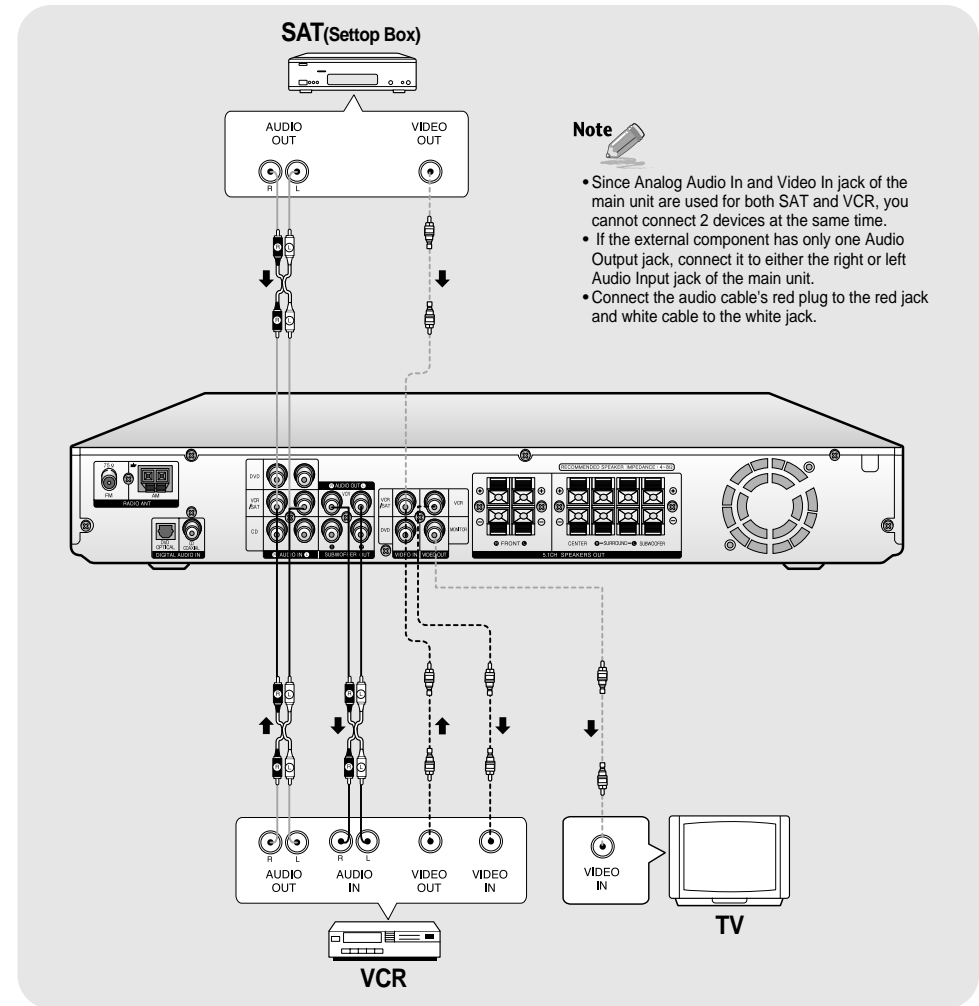

- Since Analog Audio In and Video In jack of the main unit are used for both SAT and VCR, you cannot connect 2 devices at the same time.
- If the external component has only one Audio Output jack, connect it to either the right or left Audio Input jack of the main unit.
- Connect the audio cable's red plug to the red jack and white cable to the white jack.

# Connecting External Component

## Connecting Audio Component

Before moving or installing the product, be sure to turn off the power and disconnect the power cord.

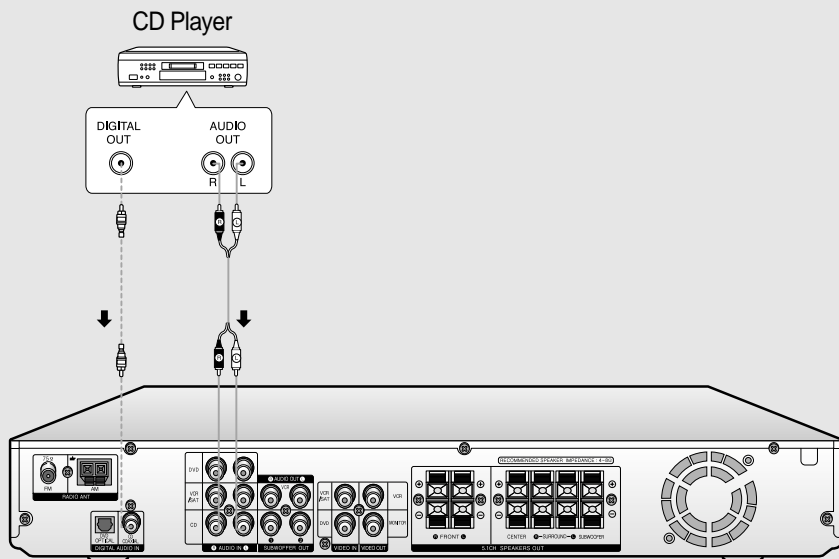

# Connecting the FM and AM Antennas

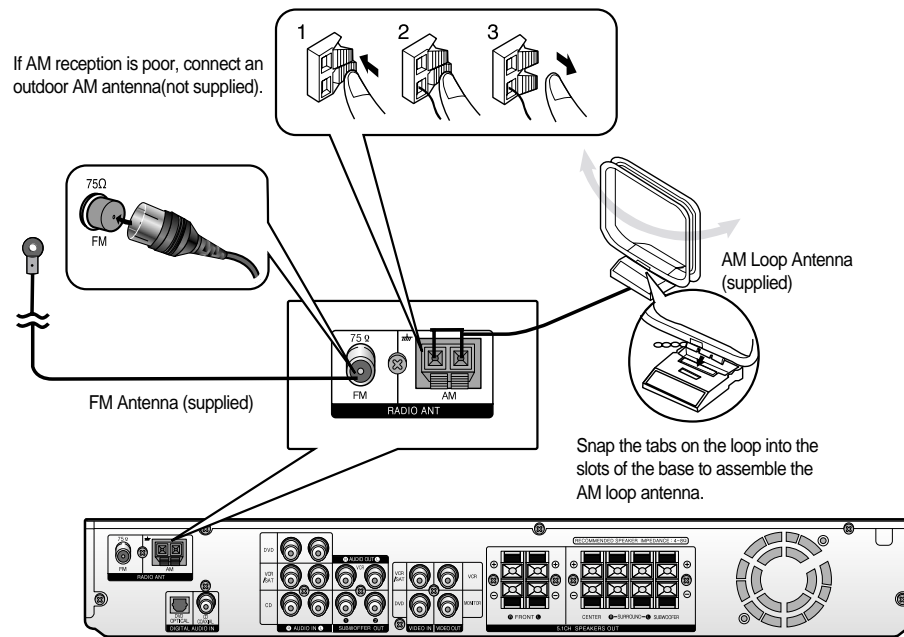

## FM antenna connection

1. Connect the FM antenna supplied to the FM 75Ω COAXIAL terminal as a temporary measure.
2. Slowly move the antenna wire around until you find a location where reception is good, then fasten it to a wall or other rigid surface.

## AM antenna connection

1. Connect the AM loop antenna supplied to the AM terminals.
2. If reception is poor, connect an outdoor single vinyl-covered wire to the AM terminal. (Keep the AM loop antenna connected).

## COOLING FAN

The cooling fan dissipates the heat generated inside the unit so that the unit can be operated normally. The cooling fan is activated automatically to supply cool air to the unit.

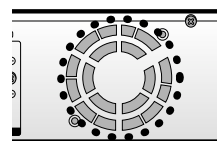

Please observe the following cautions for your safety.

- Make sure the unit is well-ventilated. If the unit has poor ventilation, the temperature inside the unit could rise and may damage it.
- Do not obstruct the cooling fan or ventilation holes. (If the cooling fan or ventilation holes are covered with a newspaper or cloth, heat may build up inside the unit and fire may result.)





# Before Using the AV Receiver



# Selecting External Component Input

## Turning On/Off

### MAIN UNIT

- 1 Connect the power plug to the outlet.
- 2 Press the **POWER** ( ) button of the main unit.
  - This unit will be turned on or off.

### REMOTE CONTROL

Press the **POWER** ( ) button of the remote control while main unit is turned on.

- This unit will be turned on or set to Standby mode.



- This unit will not turned on or off even if you press the **POWER** ( ) button on the remote control while the main unit is turned off.
- When you turn off the power by pressing the **POWER** ( ) button on the remote control, the unit will be in standby mode. To completely turn off the power, press the **POWER** ( ) button of the main unit. Standby indicator will be turned off.

## Functions of Dedicated Remote Control

You can operate TV, VCR, DVD, AV Receiver with one remote control. See pages 39-42 for more details.

### REMOTE CONTROL

Press **MODE** button.

- Each time you press this button, it will select and blink TV indicator → VCR indicator → DVD indicator → AV Receiver indicator in turn.

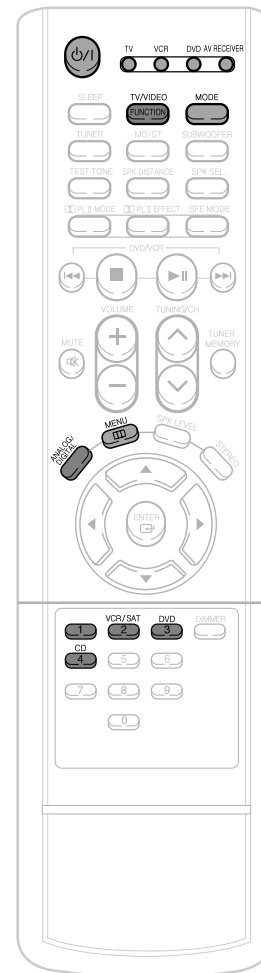

## To Select the Function

### REMOTE CONTROL

#### Method 1

Press the **FUNCTION** button.

- Each time you press the this button, CD → DVD → VCR/SAT → FM → AM will be selected in turn.

#### Method 2

 Press **DIRECT FUNCTION** Select button.

- You can directly select VCR/SAT, DVD, CD.

### MAIN UNIT

Press **INPUT** button.

- Each time you press the this button, CD → DVD → VCR/SAT → FM → AM will be selected in turn.

OPERATION

## To Select Analog/Digital Input

You can listen to sound in Analog 2 Channels or Dolby Digital 5.1 Channel using this unit.

Press the **ANALOG/DIGITAL** button.

- For DVD, VCR/SAT Function **ANALOG** and **OPTICAL** (DVD OPTICAL) will be selected repetitively.

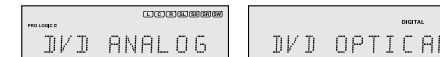

- For CD Function **ANALOG** and **COAXIAL** will be selected repetitively.

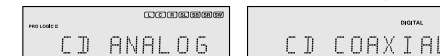

- You can enjoy Dolby Digital only if you connect the Audio Output jack of an external audio component to the optical/coaxial digital Audio Input jack on the main unit.
- You can operate this function only with the remote control.
- This function will be selected in analog only for VCR function.



# Setting the Speaker Mode

Before moving or installing the product, be sure to turn off the power and disconnect the power cord. Signal outputs and frequency response from the speaker will automatically be adjusted according to your speaker configuration and whether certain speakers are used or not.

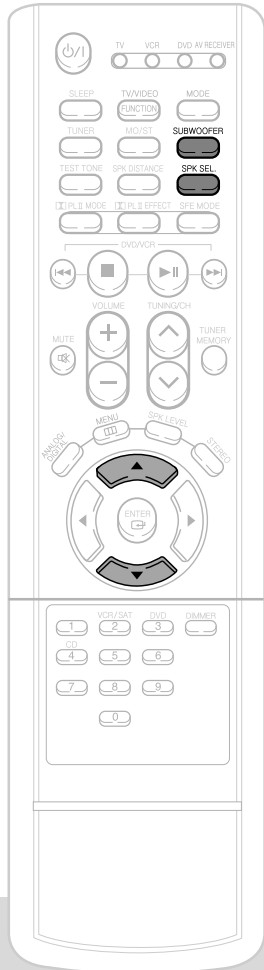

## REMOTE CONTROL

- 1 Press **SPK SEL.** button to select the speaker you want.
  - Each time you press this button, F.SPK → C.SPK → S.SPK → SW SPK → CROVR → SPK MODE OFF will be selected in turn.
- 2 Press **▲▼** button to set the speaker mode.

### To Exit Setup Mode

- Wait for about 5 seconds or press the **SPK SEL.** button of the remote control to select SPK MODE OFF.

### To turn the SUBWOOFER On or Off.

Press **SUBWOOFER** button.

- Each time you press this button, SW SPK : YES, SW SPK : NO will be selected in turn.
- If you play in 2 Channel Stereo, select 'YES' to use Subwoofer and 'NO' not to use.



• If F.SPK is set to 'SMALL', SW SPK is fixed to 'YES'.

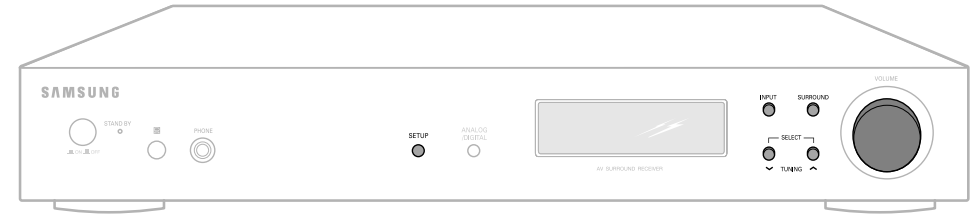

## MAIN UNIT

- 1 Press **SETUP** button.
  - "SETUP MODE" appears on the display and enters into Setup Mode.
- 2 Press **INPUT** button one time.
  - "SPEAKER SETUP" appears in the display.
- 3 Press **SURROUND** button to select the speaker you want.
  - Each time you press this button, F.SPK → C.SPK → S.SPK → SW SPK → CROVR will be selected in turn.
- 4 Press **SELECT** ( **▼, ▲** ) button to set the speaker mode.

### To Exit Setup Mode

- Wait for about 5 seconds or turn the **VOLUME CONTROL** of the main unit. "SETUP MODE OFF" appears on the display and exits Setup Mode.

### Setting the Speaker

- **F.SPK (Front)** : LARGE, SMALL
- **C.SPK (Center)** : LARGE, SMALL, NONE
- **S.SPK (Surround)** : LARGE, SMALL, NONE
- **SW SPK (Subwoofer)** : YES, NO
- **CROVR (Crossover Frequency)**: 60, 80, 100, 120, 150, 180, 200Hz

- **LARGE** : Select when you use large speaker. You can listen to full range sound.
- **SMALL** : Select this when you use small speaker. Bass below 100Hz will not be output.
- **NONE** : Select this when you use no speaker.
- **YES** : Select this when you use Subwoofer Speaker if you play back in 2 Channel Stereo.
- **NO** : Select when you do not use Subwoofer Speaker if you play back in 2 Channel Stereo.
- **CROVR** : Select the crossover frequency depending on the size of speaker connected when you use subwoofer. Select 60Hz if cone paper speaker is 5.6inch, select 80Hz for 4.8inch, 100Hz for 4inch, 120Hz for 3.2inch, 150Hz for 2.4inch, 180Hz and 200Hz for 1.6inch.



# Setting the Speaker Listening Distance

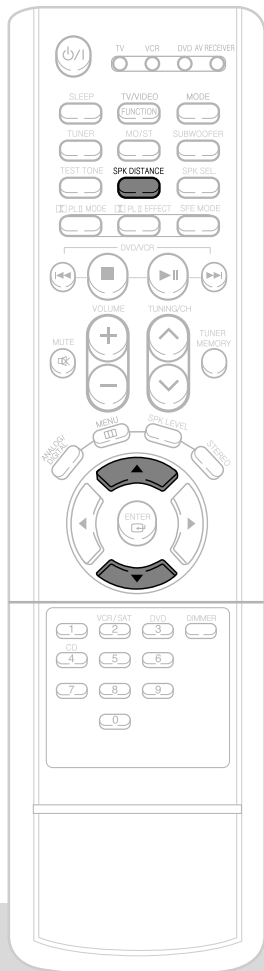

## REMOTE CONTROL

- 1 Press the **SPEAKER DISTANCE** button to select the speaker you want.
  - Each time you press this button, F.L → CEN → F.R → S.R → S.L → S.W → DISTANCE OFF will be selected in turn.
- 2 Press **▲▼** button to set the speaker distance.
  - For F.L, CEN, F.R, S.W Speaker, you can set the distance from the speaker to listening position between 0.0~1.5m in intervals of 0.3m.
  - For S. R, S.L Speaker, you can set the distance from the speaker to listening position between 0.0~4.5m in intervals of 0.3m.

### To Exit Setup Mode

- Wait for about 5 seconds or press the **SPEAKER DISTANCE** button of remote control to select DISTANCE OFF.

### Note

- If the listening position is beyond the range of speaker distance setup when you place the speaker, set the speaker distance to the maximum.

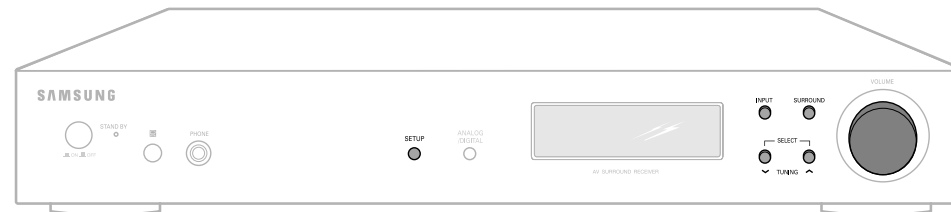

## MAIN UNIT

- 1 Press **SETUP** button.
  - "SETUP MODE" appears on the display and enters into Setup Mode.
- 2 Press **INPUT** button 2 times.
  - "DISTANCE SETUP" appears on the display.
- 3 Press **SURROUND** button to select the speaker you want.
  - Each time you press this button, F.L → CEN → F.R → S.R → S.L → S.W will be selected in turn.
- 4 Press **SELECT** (▼, ▲) button to set the speaker distance.
  - For F.L, CEN, F.R, S.W Speaker, you can set the distance from the speaker to listening position between 0.0~1.5m in intervals of 0.3m.
  - For S. R, S.L Speaker, you can set the distance from the speaker to listening position between 0.0~4.5m in intervals of 0.3m.

### To Exit Setup Mode

- Wait for about 5 seconds or turn the **VOLUME CONTROL** of the main unit. "SETUP MODE OFF" appears on the display and exit Setup Mode.

OPERATION

### Setting Speaker Distance

Set the distance from the speaker to listening position in intervals of 0.3m.

- **F.L (Front-Left)** : 0feet ~ 5feet
- **CEN (Center)** : 0feet ~ 5feet
- **F.R (Front-Right)** : 0feet ~ 5feet
- **S.R (Surround-Right)** : 0feet ~ 15feet
- **S.B (Surround Center)** : 0feet ~ 15feet
- **S.L (Rear-Left)** : 0feet ~ 15feet
- **SW (Subwoofer)** : 0feet ~ 5feet

# Setting DRC (Dynamic Range Compression)

You can use this function to enjoy Dolby Digital sound when watching movies at low volume at night.

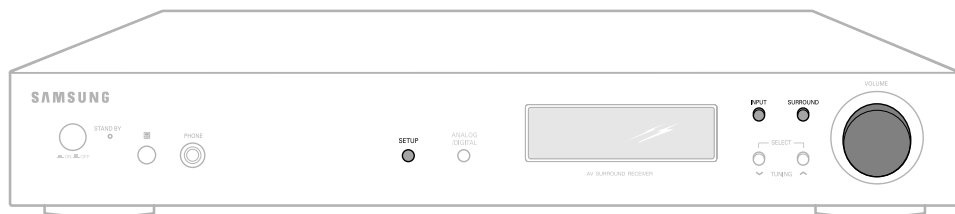

## MAIN UNIT

- 1 Press **SETUP** button.
  - "SETUP MODE" appears on the display and enters into Setup Mode.
- 2 Press **INPUT** button 3 times.
  - "DRC SETUP" appears on the display.
- 3 Press **SURROUND** button to set DRC.
  - Each time you press this button, DRC : STD → DRC : MAX → DRC : MIN will be selected in turn.

### To Exit Setup Mode

- Wait for about 5 seconds or turn the **VOLUME CONTROL** of the main unit. "SETUP MODE OFF" appears on the display and exits Setup Mode.

### Setting DRC

- **STD** : Sets DRC effect to standard.
- **MAX** : Sets DRC effect to maximum.
- **MIN** : Sets DRC effect to minimum.



• You can only set this function via the main unit.

# Test Tone

Use test tone to check the speaker connection status or level.

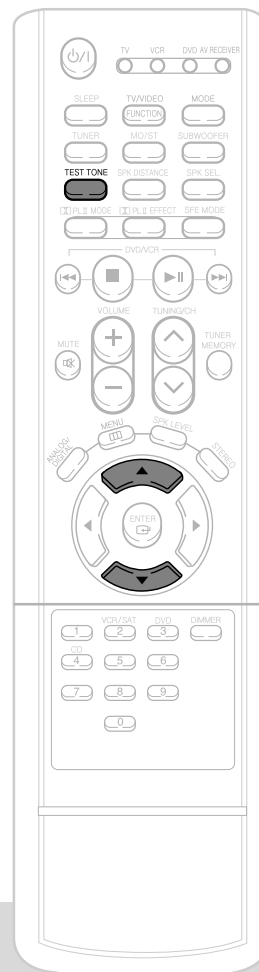

## To Automatically Output Test Tone



## REMOTE CONTROL

### 1 Press TEST TONE button.

- Test signal will be automatically output as follows; F.L → CEN → F.R → S.R → S.L → S.W.
- During test tone output, press **▲▼** button to adjust the speaker output level from -10 to +10 dB by 1 step.

### To Stop Test Tone

- Press **TEST TONE** button again.



# Test Tone

Use test tone to check speaker connection status or level.

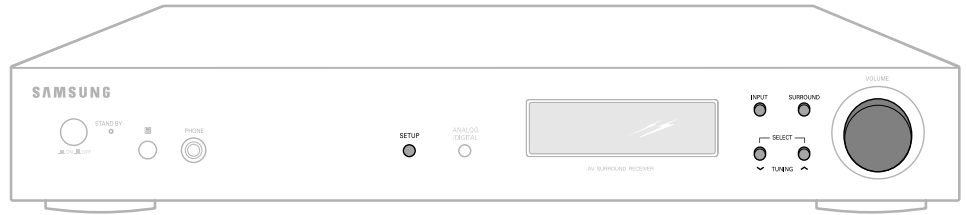
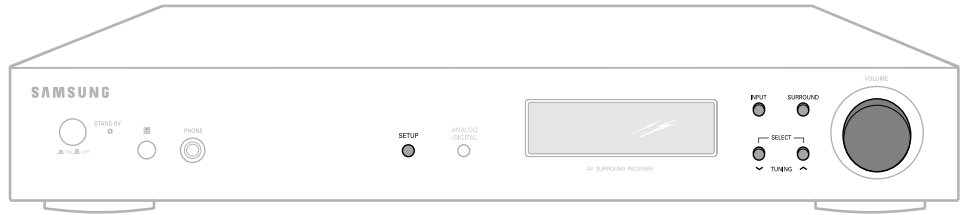

## To Automatically Output Test Tone



### MAIN UNIT

- 1 Press **SETUP** button.
  - "SETUP MODE" appears on the display and enters into Setup Mode.
- 2 Press **INPUT** button 4 times.
  - "TEST-T AUTO" appears in the display.
- 3 Press **SURROUND** button.
  - Test signal will be automatically output as follows; F.L → CEN → F.R → S.R → S.L → S.W.
  - During test signal output, press **SELECT** ( **▼**, **▲** ) button to adjust the speaker output level from -10 to +10 dB by 1 step.

### To Stop Test Tone

- Method 1)** Press **INPUT** button 2 times.
- "TEST-T OFF" appears on the display and test tone stops.
- Method 2)** Turn **VOLUME CONTROL**.
- "SETUP MODE OFF" appears on the display and test tone stops.

## To Manually Output Test Tone



### MAIN UNIT

- 1 Press **SETUP** button.
  - "SETUP MODE" appears on the display and enters into Setup Mode.
- 2 Press **INPUT** button 5 times.
  - "TEST-T MANU" appears in the display.
- 3 Press **SURROUND** button.
  - Each time you press this button, F.L → CEN → F.R → S.R → S.L → S.W will be selected in turn.
- 4 Press **SELECT** ( **▼**, **▲** ) button to set the test tone as you want.
  - You can adjust the speaker output level from -10 to +10dB by 1 step.

### To Stop Test Tone

- Method 1)** Press **INPUT** button 1 time.
- "TEST-T OFF" appears on the display and test signal stops.
- Method 2)** Turn **VOLUME CONTROL**.
- "SETUP MODE OFF" appears on the display and test tone stops.

OPERATION

### Test Tone Output

- **F.L (Front-Left)** : -10 ~ +10dB
- **CEN (Center)** : -10 ~ +10dB
- **F.R (Front-Right)** : -10 ~ +10dB
- **S.R (Surround-Right)** : -10 ~ +10dB
- **S.L (Surround-Left)** : -10 ~ +10dB
- **S.W (Subwoofer)** : -10 ~ +10dB

# Setting Speaker Level

You can set the balance and level of speakers

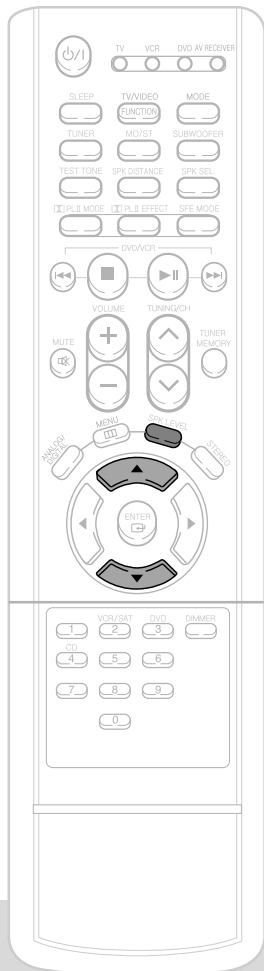

## Remote Control

**1** Press **SPK LEVEL** button to select the speaker you want.

- Each time you press this button, F.L → CEN → F.R → S.R → S.L → S.W → SPK LEVEL OFF will be selected in turn.

**2** Press **▲▼** button to set the speaker level you want.

- You can adjust it from -10 to +10dB by 1 step.
- The sound gets quieter at -10dB and louder at +10dB.
- Default setting value is 00dB.

### To Exit Setup Mode

- Wait for about 5 seconds or press **SPK LEVEL** button on the remote control to select SPK LEVEL OFF.

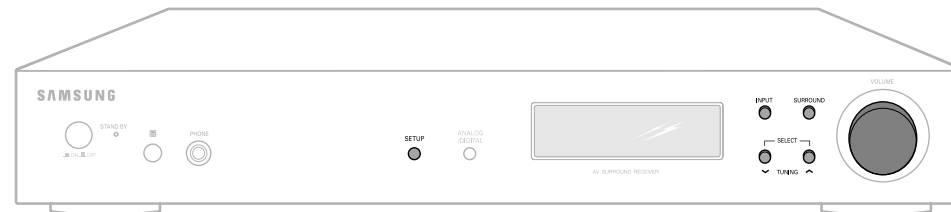

## MAIN UNIT

**1** Press **SETUP** button.

- "SETUP MODE" appears on the display and enters into Setup Mode.

**2** Press **INPUT** button 7 times.

- "LEVEL SETUP" appears on the display.

**3** Press **SURROUND** button.

- Each time you press this button, F.L → CEN → F.R → S.R → S.L → S.W will be selected in turn.

**4** Press **SELECT** (▼, ▲) button to set to the speaker level you want.

- You can adjust it from -10 to +10dB by 1 step.
- The sound gets smaller at -10dB and louder at +10dB.
- Default setting value is 00dB

### To Exit Setup Mode

- Wait for about 5 seconds or turn **VOLUME CONTROL** of the main unit. "SETUP MODE OFF" appears on the display and exits Setup Menu.

### Setting Speaker Level

- **F.L (Front-Left)** : -10 ~ +10dB
- **CEN (Center)** : -10 ~ +10dB
- **F.R (Front-Right)** : -10 ~ +10dB
- **S.R (Surround-Right)** : -10 ~ +10dB
- **S.L (Surround-Left)** : -10 ~ +10dB
- **S.W (Subwoofer)** : -10 ~ +10dB



# Dolby Pro Logic II Mode

This mode provides 5.1 channel sound from 2 channel sources

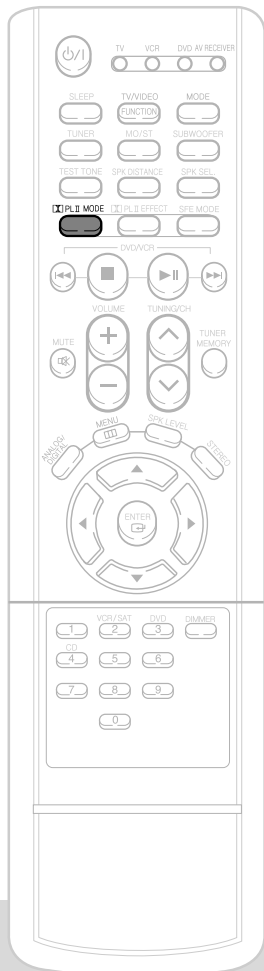

## REMOTE CONTROL

1 Press **DPL II MODE** button.

- Each time you press this button, MUSIC → CINEMA → MATRIX → PROLOGIC will be selected in turn.



### To Exit Setup Mode

- Wait for about 5 seconds.

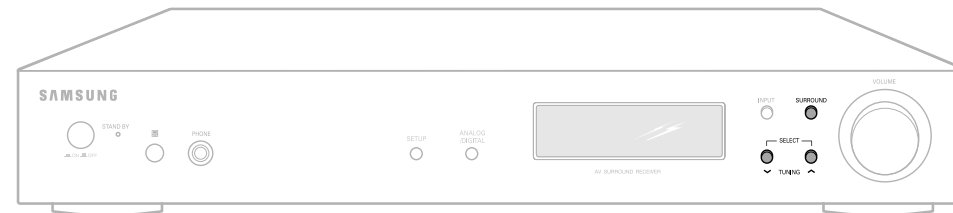

## MAIN UNIT

1 Press **SURROUND** button briefly to select "DPL II" Mode.

- Each time you press this button, DPL II → SFE → STEREO will be selected in turn.

2 Press **SELECT (↓, ↑)** button.

- Each time you press **SELECT (↑)** button, MUSIC → CINEMA → MATRIX → PROLOGIC will be selected in turn.
- Each time you press **SELECT (↓)** button, PROLOGIC → MATRIX → CINEMA → MUSIC will be selected in turn.

### To Exit Setup Mode

- Wait for about 5 seconds.

OPERATION

### Dolby Pro Logic II Mode

- **MUSIC** : Provides 5.1 Channel Surround sound to digital, analog or existing stereo sources such as CD, TAPE, FM, TV and Stereo VCR.
- **CINEMA** : Adds realism to the movie soundtrack.
- **MATRIX** : You will hear 5.1 Channel Surround sound.
- **PROLOGIC** : You will experience a surround effect with just the front left and right speakers.

### Note



- You cannot use Dolby Pro Logic II Mode for multi channel signals such as Dolby Digital and DTS.
- Pro Logic works only for PCM audio signals with sampling frequencies of 32KHz, 44KHz or 48KHz.
- Sound will not be output from rear center speaker if PCM audio signal is mono.



# Dolby Pro Logic II Effect

This function works only in Dolby PRO LOGIC II MUSIC Mode.

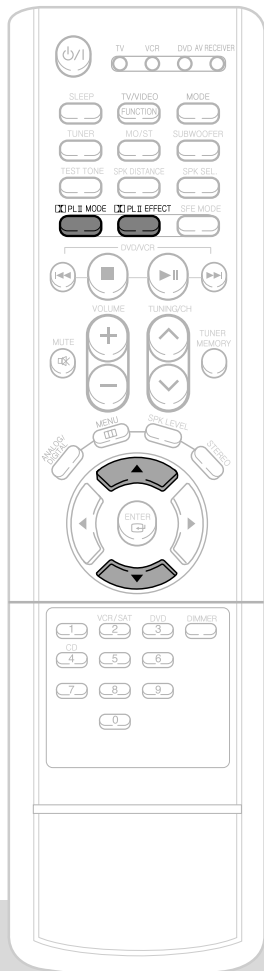

## REMOTE CONTROL

1 Press **PL II MODE** button to select 'MUSIC' Mode.

2 Press **PL II EFFECT** button.

- Each time you press this button, C-WIDTH → DIMENSION → PANORAMA → DPL II EFT OFF will be selected in turn.

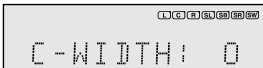

3 Press **▲▼** button to select Dolby Pro Logic II effect you want.

- C-WIDTH: You can set from 0 to 7.
- DIMENSION: You can set from -7 to +7.
- PANORAMA: You can Set it ON or OFF.

### To Exit Setup Mode

- Wait for about 5 seconds or press **PL II EFFECT** button of remote control to select DPL II EFT OFF.

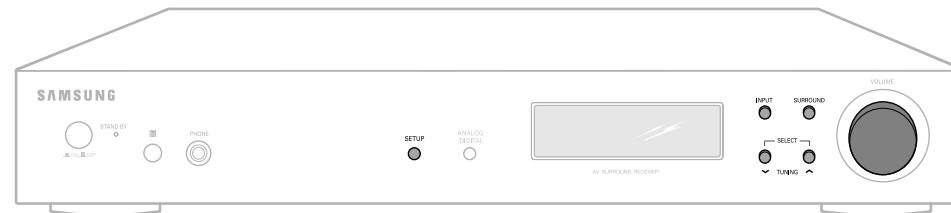

## MAIN UNIT

1 Press **SETUP** button.

- "SETUP MODE" appears on the display and enters into Setup Mode.

2 Press **INPUT** button 9 times.

- "DPL II MODE" appears on the display.

3 Press **SURROUND** button.

- Each time you press this button, C-WIDTH → DIMENSION → PANORAMA will be selected in turn.

4 Press **SELECT** (**▼, ▲**) button to select Dolby Pro Logic II effect you want.

### To Exit Setup Mode

- Wait for about 5 seconds or turn **VOLUME CONTROL** of the main unit. "SETUP MODE OFF" appears on the display and exits Setup Mode.

OPERATION

### Dolby Pro Logic IIx Effect

- **C-WIDTH** : This sets the width of the center image. The higher the setting, the less sound comes from the center speaker.
- **DIMENSION** : Incrementally adjusts the sound field (DSP) from the front or rear.
- **PANORAMA** : This mode extends the front stereo image to include the surround speakers for an exciting "wraparound" effect with side wall imaging.





# SFE Mode

Refer to the unique sound existing at specific place and you can feel live sound as if you are listening at actual site.

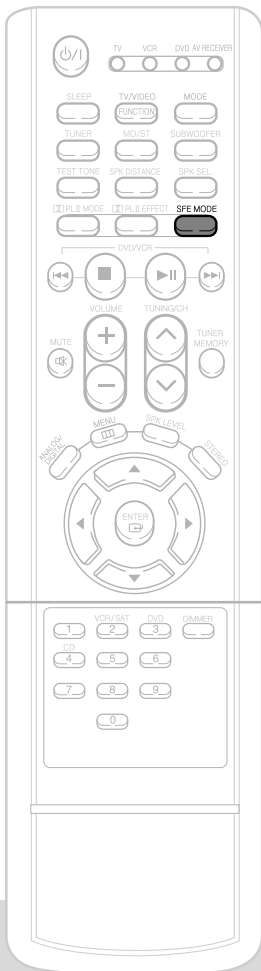

## REMOTE CONTROL

### 1 Press SFE MODE button.

- Each time you press this button, **HALL** → **THEATER** → **ARENA** → **CLUB** → **DOME** → **STADIUM** → **CHURCH** will be selected in turn.



### To Exit Setup Mode

- Wait for about 5 seconds.

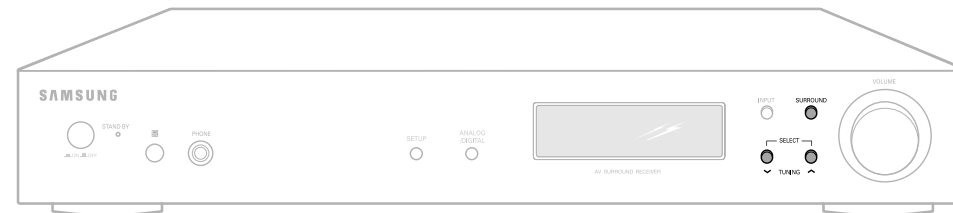

## MAIN UNIT

### 1 Press SURROUND button briefly to select 'SFE' Mode.

- Each time you press this button, **DPL II** → **SFE** → **STEREO** will be selected in turn.

### 2 Press SELECT( , ) button.

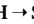
- Each time you press Select (  ) button, **HALL** → **THEATER** → **ARENA** → **CLUB** → **DOME** → **STADIUM** → **CHURCH** will be selected in turn
- Each time you press Select (  ) button, **CHURCH** → **STADIUM** → **DOME** → **CLUB** → **ARENA** → **THEATER** → **HALL** will be selected in turn.

### To Exit Setup Mode

- Wait for about 5 seconds.

# Stereo Mode

You can select this mode when you listen to sound through the Front Left and Right speakers and subwoofer.

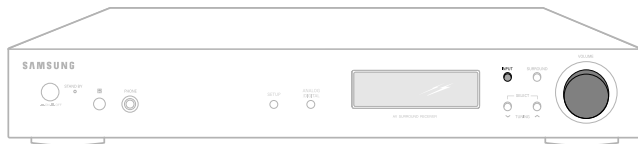
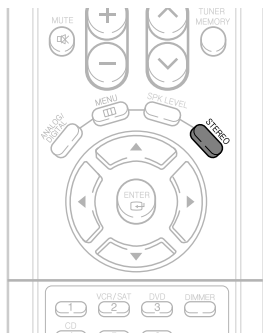

## REMOTE CONTROL

Press **STEREO** button.

- "STEREO" appears in the display and Stereo Mode is selected.



### To Exit Setup Mode

- Wait for about 5 seconds.

## MAIN UNIT

Press **SURROUND** button briefly to select 'STEREO'.

- Each time you press this button, DPL II → SFE → STEREO will be selected in turn.

### To Exit Setup Mode

- Wait for about 5 seconds.



Note

- When PCM and Analog Stereo signals are input, the left and right channels are played back in Stereo Mode.

## For Surround Mode and Input Signal

o = active, -- = inactive

Surround Mode	Input Signal	Decoding	Output Channel				Display Information	
			L/R	C	SL/SR	Sub Woofer	Display Signal Format	Channel Status
DOLBY (MUSIC, CINEMA, MATRIX, GAME, PROLOGIC)	Dolby D Surr. EX	Dolby Digital 5.1	o	o	o	o	(X) DIGITAL	L, C, R, SL, SR, SW
	Dolby D (5.1ch)	Dolby Digital 5.1	o	o	o	o	(X) DIGITAL	L, C, R, SL, SR, SW
	Dolby D (2ch)	Pro Logic II x	o	o	o	o	(X) DIGITAL	L, R
	Dolby D (2ch Surr)	Pro Logic II x	o	o	o	o	(X) DIGITAL	L, R
	L.PCM (Audio)	Pro Logic II x	o	o	o	o	L.PCM	L, R
	Analog	Pro Logic II x	o	o	o	o	ANALOG	-
NEO:6 (MUSIC, CINEMA)	DTS-ES	DTS 5.1	o	o	o	o	dts, ES	L, C, R, SL, SR, SW
	DTS 96/24	DTS 96/24	o	o	o	o	DTS 96/24	L, C, R, SL, SR, SW
	DTS (5.1)	DTS 5.1	o	o	o	o	dts	L, C, R, SL, SR, SW
	L.PCM (Audio)	Neo:6	o	o	o	-	L.PCM	L, R
	Analog	Neo:6	o	o	o	-	ANALOG	-
	Dolby D (2ch)	Neo:6	o	o	o	-	(X) DIGITAL	L, R
SFE	Dolby D (2ch Surr)	Neo:6	o	o	o	-	(X) DIGITAL	L, R
	Dolby Surr. EX	SFE	-	-	-	-	(X) DIGITAL	L, C, R, SL, SR, SW
	Dolby D (5.1ch)	SFE	-	-	-	-	(X) DIGITAL	L, C, R, SL, SR, SW
	Dolby D (2ch)	SFE	o	o	o	o	(X) DIGITAL	L, R
	Dolby D (2ch Surr)	SFE	o	o	o	o	(X) DIGITAL	L, R
	DTS-ES	SFE	-	-	-	-	dts, ES	L, C, R, SL, SR, SW
	DTS (5.1ch)	SFE	-	-	-	-	dts	L, C, R, SL, SR, SW
	L.PCM (Audio)	SFE	o	o	o	o	L.PCM	L, R
EXES	Analog	SFE	o	o	o	o	ANALOG	-
	Dolby D Surr. EX	Dolby Digital EX	o	o	o	o	(X) DIGITAL	L, C, R, SL, SR, SW
	Dolby D (5.1ch)	Dolby Digital EX	o	o	o	o	(X) DIGITAL	L, C, R, SL, SR, SW
	DTS-ES	DTS-ES	o	o	o	o	dts, ES	L, C, R, SL, SR, SW
STEREO	DTS (5.1ch)	DTS-ES	o	o	o	o	dts	L, C, R, SL, SR, SW
	Dolby Surr. EX	Stereo	o	-	-	o	(X) DIGITAL	L, C, R, SL, SR, SW
	Dolby D (5.1ch)	Stereo	o	-	-	o	(X) DIGITAL	L, C, R, SL, SR, SW
	Dolby D (2ch)	Stereo	o	-	-	-	(X) DIGITAL	L, R
	Dolby D (2ch Surr)	Stereo	o	-	-	-	(X) DIGITAL	L, R
	DTS-ES	Stereo	o	-	-	o	dts, ES	L, C, R, SL, SR, SW
	DTS 96/24	Stereo	o	-	-	o	dts 96/24	L, C, R, SL, SR, SW
	DTS (5.1ch)	Stereo	o	-	-	o	dts	L, C, R, SL, SR, SW
	L.PCM (Audio)	Stereo	o	-	-	-	L.PCM	L, R
	L.PCM 96KHz	Stereo	o	-	-	-	L.PCM	L, R
Analog	Stereo	o	-	-	-	ANALOG	-	

L/R : Front Speaker (Left/Right) C : Center Speaker SL/SR : Rear Speaker (Left/Right) SW : Subwoofer



Note

- 2 channel Dolby Digital signal has Dolby Digital Pro Logic. Speaker Setup is set to LARGE, SMALL, or YES.
- If there is no surround signal in DVD disk, sound will not output from rear-left speaker, rear-right speaker, center speaker, and subwoofer.

# Listening to Radio

You can listen to the chosen band (FM, AM broadcast stations) by using either the automatic or manual tuning operation.

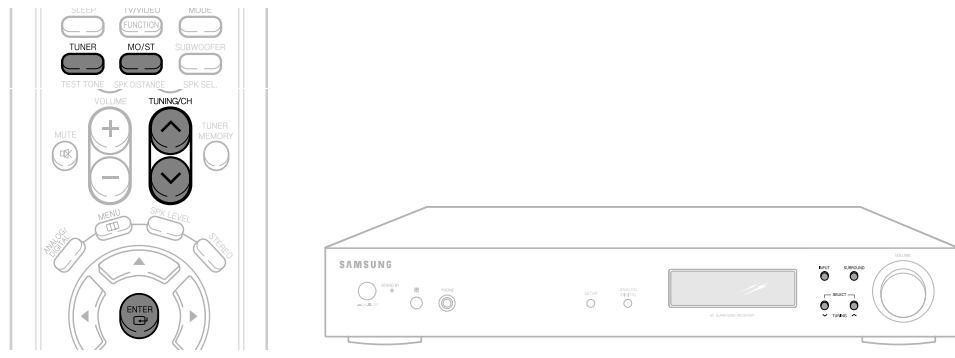

## REMOTE CONTROL

### 1 Press TUNER button.

- Each time you press this button, FM → AM will be repetitively selected.

### 2 Select frequency.

- Automatic Tuning 1 :
  - 1) Press **ENTER** button to select PRESET.
  - 2) Press **TUNING/CH** (  $\blacktriangledown$ ,  $\blacktriangle$  ) button to select the preset frequency.
- Automatic Tuning 2 :
  - 1) Press **ENTER** button to select MANUAL
  - 2) Press and hold **TUNING/CH** (  $\blacktriangledown$ ,  $\blacktriangle$  ) button to automatically tune in frequency.
- Manual Tuning :
  - 1) Press **ENTER** button to select MANUAL.
  - 2) Press **TUNING/CH** (  $\blacktriangledown$ ,  $\blacktriangle$  ) button briefly to increase or decrease frequency by step by step.

### To Listen to Mono/Stereo

Press **MO/ST** button on the remote.

- Each time you press this button, STEREO, MONO will be selected in turn.
- If you select MONO in the area with weak reception, it will help to reduce noise.
- This function works only with the Remote Control.

## MAIN UNIT

### 1 Press INPUT button to select FM or AM.

### 2 Select the frequency.

- Automatic Tuning :  
Press and hold **TUNING/CH** (  $\blacktriangledown$ ,  $\blacktriangle$  ) button to automatically tune in frequency.
- Manual Tuning :  
Press **TUNING/CH** (  $\blacktriangledown$ ,  $\blacktriangle$  ) button briefly to increase or decrease frequency step by step.

### How to select PRESET, MANUAL

1. Press the **SETUP** button.
2. Press the **INPUT** button 8 times.
3. Press the **SURROUND** button and select Manual or Preset.
  - This function operates only with the main unit.

# Presetting Radio Stations

You can preset up to 30 FM and AM stations.

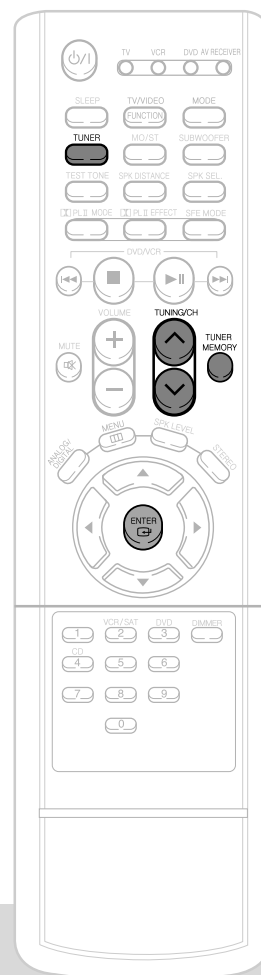

## REMOTE CONTROL

Ex) If you preset FM 89.1 station in 2ch

### 1 Press TUNER button.

- Each time you press this button, FM → AM will be selected in turn.

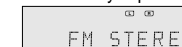

### 2 Press Select button and then TUNING/CH( $\blacktriangledown$ , $\blacktriangle$ ) button to select 89.1.

- Refer to step 2, page 35, to tune in automatically and manually.

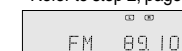

### 3 Press TUNER MEMORY button.

- Tuner number will blink on the display.



### 4 Press TUNING/CH( $\blacktriangledown$ , $\blacktriangle$ ) button to select preset 2.

- You can select from presets 1 to 30.



### 5 Press TUNER MEMORY button.

- Tuner number will disappear and station 89.1 will be saved in preset 2.

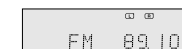

### 6 To preset other stations, repeat steps 2 to 5.

### To Listen to Preset Station

- Press Select button of the remote control to select the PRESET and press **TUNING/CH** (  $\blacktriangledown$ ,  $\blacktriangle$  ) button.

# Convenient Functions

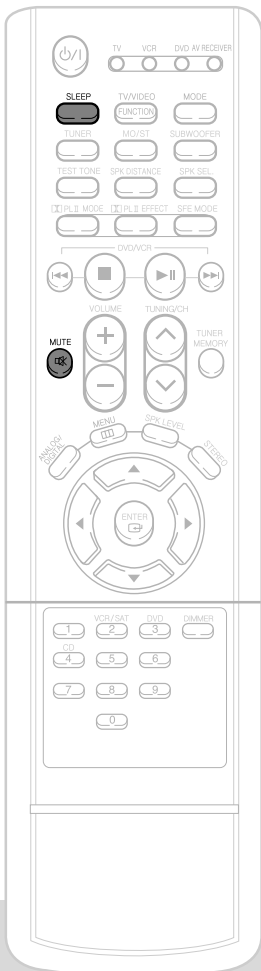

## Sleep Timer Function

You can set the time that this unit will shut itself off.

### REMOTE CONTROL

Press the **SLEEP** button.

- SLEEP : OFF → 15 → 30 → 45 → 60 → 90 → 120MIN will be selected in turn.

#### To Check Sleep Timer

Press **SLEEP** button.

- The remaining time before this unit will shut itself off is shown on the display.
- Pressing the button again changes the sleep time from what you have set earlier.

#### To Cancel Sleep Timer

- Press **SLEEP** button until SLEEP : OFF appears on the display.

## Mute Function

This function is useful when answering a doorbell or telephone call.

### REMOTE CONTROL

Press the **MUTE** button.

- **MUTE** appears on the display.

#### To Output Sound Again

Press **MUTE** button again.

- **MUTE** will disappear and sound will Output.



- SLEEP, Mute and Adjust Display function can only be operated with the remote control.

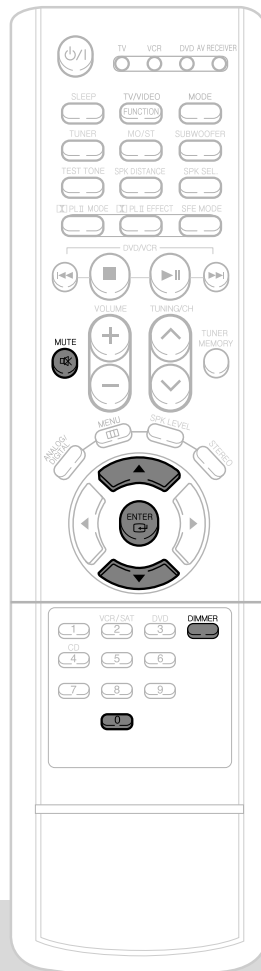

## Reset Function

### REMOTE CONTROL

- 1 Press the **MUTE** button.
  - **MUTE** appears on the display.
- 2 Press "0" button five times and then press **ENTER** button.
- 3 Press **▲▼** buttons to select "YES".
  - The unit will turn automatically back on in 5 seconds.

#### Caution!

- Using the RESET function will erase all stored settings.
- Do not use this unless necessary.

## Adjust the Display

You can adjust the brightness of the display.

### REMOTE CONTROL

Press the **DIMMER** button.

- Each time you press this, the brightness of the display will be adjusted.

## Using Headphone

Use headphones (not supplied) for private listening pleasure.

Connect the headphone to the headphone jack and listen to music.



- Do not turn the volume up too high when you use headphone.
- It may damage your hearing.



# Operating TV with Remote Control

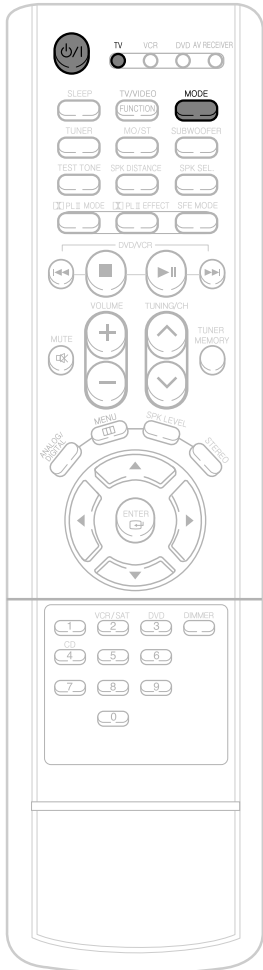

**1** Press **MODE** button to make the TV indicator on the remote control flash.

**2** Press **POWER**( $\text{⏻}$ ) button to turn on the TV.

**3** Point the remote control toward the TV.

**4** While holding down **POWER**( $\text{⏻}$ ) button, enter the code corresponding to your brand of TV.

- If the code matches the TV's code, the TV will be turned off.
- If there is more than one code listed for your TV in the table, enter one at a time to determine which code works.

**5** If TV is turned on or off when you press the power button of the remote control, the setting is completed.

- You can use the TV POWER, VOLUME, CHANNEL, and Numeric buttons (0-9).



**Note**

- The remote control may not work on some brands of TVs. Also, some operation may not be possible depending on your brand of TV.
- The remote control will work with Samsung TVs by default.

## TV Brand Code List

Brand	Code Number	Brand	Code Number	Brand	Code Number
ADMIRAL(M,WARDS)	056,057,058	LUXMAN	018	SYLVANIA	018,040,048,054,059,060,062
A MARK	001,015	LXI(SEARS)	019,054,056,059,060,062,063,065,071	SYMPHONIC	061,095,096
ANAM	001,002,003,004,005,006,007,008,009,010,011,012,013,014	MAGNAVOX	015,017,018,048,054,059,060,062,072,089	TATUNG	006
AOC	001,018,040,048	MARANTZ	040,054	TECHWOOD	018
BELL&HOWELL(M,WARDS)	057,058,081	MATSUI	054	TEKNIKA	003,015,018,025
BROCCSONIC	059,060	MGA	018,040	TMK	018,040
CANDLE	018	MITSUBISHIMGA	018,040,054,059,060,075,101	TOSHIBA	019,057,063,071,101,107,109,110,111,113
CETRONIC	003	MTC	018	VIDTECH	018
CITIZEN	003,018,025	NEC	018,019,020,040,059,060	VIDECH	059,060,069
CINEMA	097	NIKEI	003	WARDS	015,017,018,040,048,054,060,064
CLASSIC	003	ONKING	003	YAMAHA	018
CONCERTO	018	ONWA	003	YORK	040
CONTEC	046	PANASONIC	006,007,008,009,054,066,067,073,074	YUPITERU	003
CORONADO	015	PENNEY	018	ZENITH	058,079
CRAIG	003,005,061,082,083,084	PHILCO	003,015,017,018,048,054,059,062,069,090	ZONDA	001
CROSLER	062	PHILIPS	015,017,018,040,048,054,062,072,112,114,117,118	DONGYANG	003,054
CROWN	003	PIONEER	063,066,080,091	LOWE	054
CURTISMATES	059,061,063	PORTLAND	015,018,059	FINLUX	054,109,114
CXC	003	PROTON	040	YOKO	054
DAEWOO	002,003,004,015,016,017,018,019,020,021,022,023,024,025,026,027,028,029,030,032,034,035,036,040,048,059,090,099,100	QUASAR	006,066,067	LOEWE OPTA	054,114
DAYTRON	040	RADIO SHACK	017,048,056,060,061,075	PHONOLA	054,112,114
DYNASTY	003	RCA/PROSCAN	018,059,067,076,077,078,092,093,094	RADIOLA	054,112
EMERSON	003,015,040,046,059,061,064,082,083,084,085	REALISTIC	003,019	SCHNEIDER	054
FISHER	019,065,103	SAMPO	040	AKAI	103
FUNAI	003	SAMSUNG	000,015,016,017,040,043,046,047,048,049,054,059,060,098	GRUNDIG	108,109,113,119,120,121
FUTURETECH	003	SANYO	019,061,065,101,102,103,104	BLAUPUNKT	108
GENERALELECTRIC(GE)	006,040,056,059,066,067,068	SCOTT	003,040,060,061	SIEMENS	108
HALL MARK	040	SEARS	015,018,019	CGE	113
HITACHI	015,018,050,059,069	SHARP	015,057,064,101,105,106,115	IMPERIAL	113
INKEL	045	SIGNATURE2000(M,WARDS)	057,058	MIVAR	113
JCPENNY	056,059,067,086	SONY	050,051,052,053,055,101	SABA	114
JVC	070	SOUNDESIGN	003,040	BANG&OLUFSEN	114
KTV	059,061,087,088	SPECTRICON	001	BRIONVEGA	114
KEC	003,015,040	SSS	018	FORMENTI	114
KMC	015			METZ	114
LG(GOLDSTAR)	001,015,016,017,037,038,039,040,041,042,043,044,054,086			WEGA	114
				RADIOMARELLI	114
				SINGER	114
				SINUDYNE	114
				TELEFUNKEN	116

MISCELLANEOUS



# Operating your VCR (DVD) with Remote Control

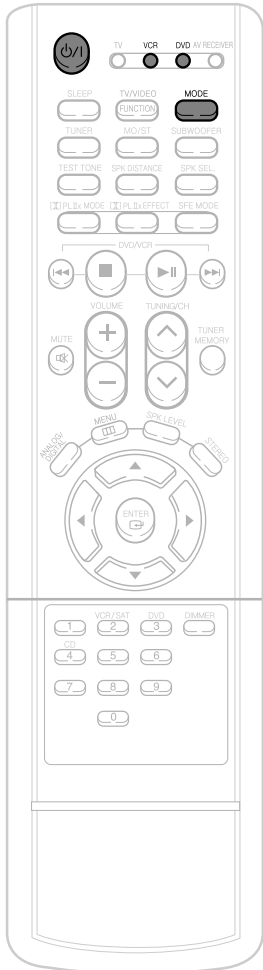

**1** Press **MODE** button to make VCR indicator on the remote control flash.

- If you operate DVD, press Device Select button to make DVD indicator on the remote control flash.

**2** Press **POWER**( $\text{⏻}$ ) button to turn on the VCR (DVD).

**3** Point the remote control toward the VCR (DVD).

**4** While holding down **POWER**( $\text{⏻}$ ) button, enter the code corresponding to your brand of VCR (DVD).

- If the code matches the VCR (DVD)'s code, the VCR (DVD) will be turned off.
- If there is more than one code listed for your VCR (DVD) in the table, enter one at a time to determine which code works.

**5** If VCR (DVD) is turned on or off when you press the power button of the remote controller, the setting is completed.

- You can use VCR (DVD) POWER, VOLUME, PLAY, PAUSE, STOP, SKIP and Numeric button (0-9).



**Note**

- The remote control may not work on some brands of VCR (DVD)s. Also, some operations may not be possible depending on your brand of VCR (DVD).
- The remote control will work with Samsung VCRs (DVDs) by default.

## VCR Brand Code List

Brand	Code Number	Brand	Code Number	Brand	Code Number
ADMIRAL(MWARDS)	043, 106	MEI	001, 033	TASHIRO	050
AWIA	044, 045, 046	MEMOREX	001, 025, 033, 054, 091, 100	TATUNG	047, 052, 092
AKAI	088, 089, 090	MINOLTA	020, 021, 062	TEAC	044, 047, 052, 092
ANAM	001, 002, 003, 004, 005, 033	MITSUBISHI/MGA	068, 069, 070, 101, 102	TECHNICS	001, 033, 049, 091
AOC	091	MTC	072	TEKNIKA	001, 025, 033
AUDIO DYNAMIC	019, 047, 092	MULTITECH	044, 057, 069	TOSHIBA	006, 051
BELL & HOWELL(MWARDS)	048, 093	NEC	019, 047, 052, 057, 092	TOTEVISION	025, 072
BROKSONIC	092, 094, 095	OLYMPIC	049, 091	TAEKWANG	087
CANON	001, 033, 049, 091	OPTIMUS	101	UNITECH	072
CAPEHART	011	ORION	103	VECTOR RESEARCH	019
CITIZEN	050	PANASONIC	001, 004, 033, 049, 067, 091, 107	VIDEO CONCEPTS	019
CRAIG	050, 072, 096	PENNEY	019, 020, 072	VIDEOSONIC	072
CRITERION	051	PENTAX	001, 020, 021, 033, 062	WARDS	001, 020, 031, 032, 033, 043, 050, 054, 072, 100, 105, 106, 109
CURTISMATHES	001, 031, 032, 033, 044, 091	PHILCO	001, 033, 046, 049, 091, 094	YAMAHA	019, 047, 048, 052, 092
DAEWOO	006, 007, 008, 009, 010, 011, 012, 013, 014, 015, 016, 017, 018, 046, 051, 091	PHILIPS	001, 030, 033, 049, 050, 066, 091	ZENITH	019, 047, 048, 052, 092
DAYTRON	011	PILOT	025	<b>DVD Brand Code List</b>	
DBX	019, 047, 052, 092	PIONEER	049		
EMERSON	025, 031, 032, 044, 046, 094, 095, 097, 098, 099	PORTLAND	011	Brand	Code Number
FISHER	009, 048, 053, 054, 055, 100	QUASAR	001, 033, 049, 067, 091, 107, 108	DENON	003, 032
FUNAI	044	RICO	036	DOONoon	019
GENERAL ELECTRIC(GE)	001, 031, 032, 033, 056, 091	RCA/PROSCAN	001, 020, 021, 031, 032, 033, 049, 051, 062, 066, 070, 091, 104	DMTECH	017
GO VIDEO	059, 060, 061	REALISTIC	001, 009, 025, 033, 044, 048, 054, 091, 101, 105	FISHER	002
HARMANKARDON	019	SAMSUNG	000, 006, 031, 032, 057, 058, 071, 072, 073, 074, 075, 076, 077, 078, 079, 080, 081	GE	006
HITACHI	020, 021, 049, 054, 062, 100	SANYO	008, 009, 046, 048, 050, 054, 058, 093, 100	HARMANKARDON	012
HQ	051	SANSUI	092	JVC	010, 013
INSTANT REPLAY	001, 033, 049, 091	SCOTT	006, 051, 054, 057, 069, 070, 100, 101	KENWOOD	008
JCL	001, 033	SEARS	020, 021, 025	LG	001
JCP	025	SHARP	043, 105, 106	MAGNAVOX	004
JCPENNY	047, 048, 052, 062, 091, 092	SINGER	096	MITSUBISHI	005, 016
JVC	001, 033, 047, 052, 063, 064, 065, 092	SIGNATURE 200(MWARDS)	043, 044, 054, 100, 106	ONKYO	004, 014
KENWOOD	047, 050, 052, 092	SHINTOM	096	OPTIMUS	011
LG(GOLDSTAR)	019, 020, 021, 022, 023, 024, 025, 026, 027, 028, 029, 030, 050	SONY	034, 035, 036, 037, 038, 039, 040, 041, 042, 082, 083, 084, 085, 086	PANASONIC	021
LX(SEARS)	020, 025, 044, 048, 050, 053, 054, 055, 062, 100	STS	020	PROSCAN	006
MAGIN	072	SYLVANIA	001, 033, 044, 049, 066, 091	PHILIPS	004, 023
MAGNAVOX	001, 031, 032, 033, 049, 066, 067, 091	SYMPHONIC	044	PIONEER	007, 011, 022, 025
MARANTZ	001, 019, 033, 047, 052, 092, 110	TANDY	009	RCA	006
MARTA	025, 050			SAMSUNG	000, 027
				SANYO	002
				SONY	015, 020
				THETA DIGITAL	011
				TOSHIBA	004, 018
				YAMAHA	009, 033
				ZENITH	004, 024
				TAEKWANG	026
				PS2	028
				X-BOX	029
				APEX	030
				MARANTZ	031



# Before Calling for Service

Symptom	Check	Remedy
Can't turn it on.	<ul style="list-style-type: none"> <li>Is the power cord plugged into the outlet?</li> </ul>	<ul style="list-style-type: none"> <li>Connect the power plug to the outlet.</li> </ul>
It does not work when the button is pressed.	<ul style="list-style-type: none"> <li>Is there static electricity in the air?</li> </ul>	<ul style="list-style-type: none"> <li>Disconnect the power plug and connect it again.</li> </ul>
Sound is not produced.	<ul style="list-style-type: none"> <li>Are the speaker and external component connected properly?</li> <li>Does the Mute function work?</li> <li>Is the volume set to minimum?</li> <li>Is the speaker setup selected to NONE?</li> </ul>	<ul style="list-style-type: none"> <li>Properly connect it.</li> <li>Press Mute button to cancel the function.</li> <li>Adjust the volume.</li> <li>Refer to pages 17~18 to select LARGE, SMALL or YES.</li> </ul>
Picture does not appear when the function is selected.	<ul style="list-style-type: none"> <li>Isn't the external component connected properly?</li> </ul>	<ul style="list-style-type: none"> <li>Properly connect it.</li> </ul>
Remote controller does not work.	<ul style="list-style-type: none"> <li>Are the batteries exhausted?</li> <li>Is the distance between remote control and main unit proper?</li> </ul>	<ul style="list-style-type: none"> <li>Replace with new batteries.</li> <li>Operate at close distance.</li> </ul>
The sound from each device is changed during stereo playback.	<ul style="list-style-type: none"> <li>Is the left/right speaker or left/right input/output code connected properly?</li> </ul>	<ul style="list-style-type: none"> <li>Check the left/right channel and properly connect it.</li> </ul>
Can't receive broadcasting.	<ul style="list-style-type: none"> <li>Is AM or FM antenna connected properly?</li> </ul>	<ul style="list-style-type: none"> <li>Properly connect the antenna.</li> <li>If the input strength of antenna connector is weak, install the FM antenna in a place with good reception.</li> </ul>
There is no sound from surround speaker.	<ul style="list-style-type: none"> <li>Is the surround speaker connected properly?</li> <li>Is S.SPK (Surround) set to NONE in Speaker Setup?</li> <li>Is Surround Mode selected to Stereo?</li> </ul>	<ul style="list-style-type: none"> <li>Refer to pages 9~10 to connect it properly.</li> <li>Refer to pages 17~18 to select LARGE or SMALL.</li> <li>Refer to pages 27~34 to select other Surround Mode.</li> </ul>
There is no sound from center speaker	<ul style="list-style-type: none"> <li>Is the center speaker connected properly?</li> <li>Is C.SPK (Center) selected to NONE in Speaker Setup?</li> <li>Is the Surround Mode selected to Stereo?</li> </ul>	<ul style="list-style-type: none"> <li>Refer to pages 9~10 to connect it properly.</li> <li>Refer to pages 17~18 to select LARGE or SMALL.</li> <li>Refer to pages 27~34 to select other Surround Modes.</li> </ul>

Symptom	Check	Remedy
Can't select Dolby Pro Logic II Mode.	<ul style="list-style-type: none"> <li>Is the input signal selected properly?</li> </ul>	<ul style="list-style-type: none"> <li>Select 2 channel Dolby Digital, PCM, and Analog input signal.</li> </ul>
There is no sound when playing DTS encoded DVD and CD.	<ul style="list-style-type: none"> <li>Is analog input selected?</li> </ul>	<ul style="list-style-type: none"> <li>Check whether digital external component is properly connected and refer to page 19 to select the digital input.</li> </ul>

## Product Protection Function

### Heat Protection

- Protection function works if the main unit is overheated or power transformer is overheated.
- Protection appears in the display when the "PROTECTION" function works.
  - If speaker terminal is shorted
  - If speaker cord is shorted
- If there is no problem when you turn it on again after turning it off, PROTECTION mark will disappear on the display and the unit will work properly.



#### Note

- If PROTECTION appears on the display, check whether speaker terminal is shorted and then turn on the device.



# Specifications

GENERAL	Power Supply	120V, 60 Hz		
	Standby Power Consumption	0.9W		
	Power Consumption	95W		
	Weight	9.25 lbs		
	Dimensions (W x H x D)	16.9 x 2.6 x 13.7 inches		
	Operating Temperature Range	41°F ~ 95°F		
	Operating Humidity Range	10%~75%		
FM TUNER	Frequency Response	87.5~108.0MHz		
	Usable Sensitivity	12dBf		
	S/N Ratio	MONO/STEREO 55/55dB		
	Distortion	MONO/STEREO 0.3/0.8%		
	Stereo Separation	30dB		
	Tuner Output Level	1KHz, 75KHz Dev		
AM TUNER	Frequency Response	522~1611KHz		
	S/N Ratio	40dB		
	Usable Sensitivity	60dBµV/m(Loop Antenna)		
	Distortion	2% (MOD:80%)		
AMPLIFIER	Rated Output	20Hz~20KHz/THD = 10%		
	Front Speaker(Left+Right)	4 Ω 100W/CH		
	Center Speaker	4 Ω 100W/CH		
	Surround Speaker(Left+Right)	4 Ω 100W/CH		
	Subwoofer	4 Ω 100W/CH		
	Input Sensitivity/Impedance	450mV/47kΩ		
	S/N Ratio(Analog Input/5.1CH Analog Input)	80dB		
	Separation(1KHz)	60dB		
FREQUENCY RESPONSE	Analog Input/5.1CH Analog Input	20Hz~20KHz(±3dB)		
	Digital Input/96KHz PCM	20Hz ~44KHz(±3dB)		
VIDEO OUTPUT	TV Format	NTSC/PAL		
	Input Level/Impedance	1Vp-p/75 Ω		
	Output Level/Impedance	1Vp-p/75 Ω		
	Video Frequency Response	5Hz to 10KHz(-3dB)		
	Component Video Frequency Response	5Hz to 40KHz(-3dB)		
	S/N Ratio	60dB		

SPEAKERS	Speaker system	Front / Surround	Center	Subwoofer speaker
	Impedance	4Ω x 4	4Ω	4Ω
	Rated input	100W	100W	100W
	Maximum input	200W	200W	200W
	Dimensions (W x H x D)	3.5 x 5.3 x 3.8 inches	7.8 x 4.2 x 3.9 inches	7.8 x 15.8 x 14.1 inches
	Weight	1.3 lbs	1.7 lbs	13.4 lbs

\* S/N ratio, distortion, separation and usable sensitivity are based on measurement using AES-17 filter.

**SAMSUNG**

## Samsung Limited Warranty

Samsung Electronics Canada Inc. (SECA), warrants that this product is free from defective material and workmanship.

SECA further warrants that if this product fails to operate properly within the specified warranty period and the failure is due to improper workmanship or defective material SECA will repair or replace the product at its option.

All warranty repairs must be performed by a SECA authorized service centre. (The name and address of the location nearest you can be obtained by calling toll free 1-800-726-7864 or visiting our web site at [www.samsung.ca](http://www.samsung.ca))

Labour	Parts
one (1) year (carry-in)	one (1) year

On carry-in models, transportation to and from the service centre is the customer's responsibility.

The original dated sales receipt must be retained by the customer and is the only acceptable proof of purchase. It must be presented to the authorized service centre at the time service is requested.

### Exclusions

This warranty does not cover damage due to accident, fire flood and/or other acts of God; misuse, incorrect line voltage, improper installation, improper or unauthorized repairs, commercial use, or damage that occurs in shipping. Exterior and interior finish, lamps and glass are not covered under this warranty. Customer adjustments which are explained in the instruction manual are not covered under the terms of this warranty.

This warranty will automatically be voided for any unit found with a missing or altered serial number. This warranty is valid only on products purchased and used in Canada.

MISCELLANEOUS



## Contact SAMSUNG WORLD WIDE

If you have any questions or comments relating to Samsung products, please contact the SAMSUNG customer care centre.

## Contactez SAMSUNG WORLD WIDE

Si vous avez des commentaires ou des questions concernant les produits Samsung, contactez le centre de service à la clientèle SAMSUNG.

Region	Country	Customer Care Center ☎	Web Site
North America	CANADA	1-800-SAMSUNG (7267864)	www.samsung.com/ca
	MEXICO	01-800-SAMSUNG (7267864)	www.samsung.com/mx
	U.S.A	1-800-SAMSUNG (7267864)	www.samsung.com
Latin America	ARGENTINE	0800-333-3733	www.samsung.com/ar
	BRAZIL	0800-124-421	www.samsung.com/br
	CHILE	800-726-7864(SAMSUNG)	www.samsung.com/cl
	COSTA RICA	0-800-507-7267	www.samsung.com/latin
	ECUADOR	1-800-10-7267	www.samsung.com/latin
	EL SALVADOR	800-6225	www.samsung.com/latin
	GUATEMALA	1-800-299-0013	www.samsung.com/latin
	JAMAICA	1-800-234-7267	www.samsung.com/latin
	PANAMA	800-7267	www.samsung.com/latin
	PUERTO RICO	1-800-682-3180	www.samsung.com/latin
	REP. DOMINICA	1-800-751-2676	www.samsung.com/latin
	TRINIDAD & TOBAGO	1-800-7267-864	www.samsung.com/latin
VENEZUELA	1-800-100-5303	www.samsung.com/latin	
Europe	BELGIUM	02 201 2418	www.samsung.com/be
	CZECH REPUBLIC	844 000 844	www.samsung.com/cz
	DENMARK	38 322 887	www.samsung.com/dk
	FINLAND	09 693 79 554	www.samsung.com/fi
	FRANCE	08 25 08 65 65 (0,15€/Min)	www.samsung.com/fr
	GERMANY	01805 - 121213 (€ 0,12/Min)	www.samsung.de
	HUNGARY	06 40 985 985	www.samsung.com/hu
	ITALIA	199 153 153	www.samsung.com/it
	LUXEMBURG	02 261 03 710	www.samsung.lu
	NETHERLANDS	0900 20 200 88 (€ 0.10/Min)	www.samsung.com/nl
	NORWAY	231 627 22	www.samsung.com/no
	POLAND	0 801 801 881	www.samsung.com/pl
	PORTUGAL	80 8 200 128	www.samsung.com/pt
	SLOVAKIA	0850 123 989	www.samsung.com/sk
	SPAIN	902 10 11 30	www.samsung.com/es
SWEDEN	08 585 367 87	www.samsung.com/se	
U.K	0870 242 0303	www.samsung.com/uk	
CIS	RUSSIA	8-800-200-0400	www.samsung.ru
	UKRAINE	8-800-502-0000	www.samsung.com/ur
Asia Pacific	AUSTRALIA	1300 362 603	www.samsung.com/au
	CHINA	800-810-5858, 010- 6475 1880	www.samsung.com.cn
	HONG KONG	2862 6001	www.samsung.com/hk
	INDIA	3030 8282 1600 1100 11	www.samsung.com/in
	INDONESIA	0800-112-8888	www.samsung.com/id
	JAPAN	0120-327-527	www.samsung.com/jp
	MALAYSIA	1800-88-9999	www.samsung.com/my
	PHILIPPINES	1800-10-SAMSUNG (7267864)	www.samsung.com/ph
	SINGAPORE	1800-SAMSUNG (7267864)	www.samsung.com/sg
Middle East & Africa	THAILAND	1800-29-3232 02-689-3232	www.samsung.com/th
	TAIWAN	0800-329-999	www.samsung.com/tw
	VIETNAM	1 800 588 889	www.samsung.com/vn
	SOUTH AFRICA	0860 7267864 (SAMSUNG)	www.samsung.com/za
	U.A.E	800SAMSUNG (7267864)	www.samsung.com/mea

## Free Manuals Download Website

<http://myh66.com>

<http://usermanuals.us>

<http://www.somanuals.com>

<http://www.4manuals.cc>

<http://www.manual-lib.com>

<http://www.404manual.com>

<http://www.luxmanual.com>

<http://aubethermostatmanual.com>

Golf course search by state

<http://golfingnear.com>

Email search by domain

<http://emailbydomain.com>

Auto manuals search

<http://auto.somanuals.com>

TV manuals search

<http://tv.somanuals.com>