

SCI

Resource Partners

Fresh Air, Surface and Fabric Regenerator



EdenPURE™
Air-Surface Sanitizer

The world leader in products for a healthy and comfortable environment – bringing the Garden of Eden into your home.

OWNER'S MANUAL



**MORE THAN JUST
AIR PURIFIERS...
THEY HELP
TO SANITIZE
BOTH THE AIR
AND SURFACES**



INCLUDES:

- INSTALLATION
- OPERATION
- SPECIFICATIONS
- FEATURES
- MAINTENANCE
- 10 PURIFICATION STEPS TO A HEALTHY HOME

IMPORTANT:
SAVE THIS BOOKLET! **A2840/R**

Healthy Home Resources

CONTENTS

EdenPURE™ G-7 (WHOLE HOUSE MODEL)

SPECIFICATIONS.....	1
SAFETY WARNINGS.....	2
FEATURES.....	3
INSPECTION & INSTALLATION.....	3
GENERAL OPERATION.....	4
GENERAL MAINTENANCE.....	5
MAINTENANCE DIAGRAMS.....	6
CHANGING THE UV LAMP.....	7
CHANGING THE FUSE.....	8
TROUBLESHOOTING.....	9
WARRANTY.....	18

EdenPURE™ AREA MODEL

SPECIFICATIONS.....	1
SAFETY WARNINGS.....	10
FEATURES.....	11
INSPECTION & INSTALLATION.....	11
ADVANCED FUNCTIONS.....	12
GENERAL OPERATION.....	13
FUNCTION OVERVIEW.....	13
GENERAL MAINTENANCE.....	14
WARRANTY.....	18

10 PURIFICATION STEPS TO A HEALTHY HOME.....15-17

Parts and Supplies: Contact the dealer you purchased your product from or visit www.rppurchase.com to locate your closest dealer.

SPECIFICATIONS

EdenPURE™ G-7



Power	110v AC, 60Hz
Fuse	1.6 amp slow blow fuse
Total Watts	5 - 70
Anion Ion Generator	Yes
Fan	5 Speeds
Dimensions	12 3/4" (H) x 8 7/8" (W) x 8 3/4" (D)
Weight	16 pounds
Activated Oxygen Output	Up to 360 mg per hour
Coverage	Up to 3000 sq. ft.

EdenPURE™ Area Model



Power	120v AC, 60Hz
Total Watts	30 - 45
Anion Ion Generator	Yes
Fan	3 Speeds
Dimensions	11 5/8" (H) x 12 5/8" (W) x 6 3/8" (D)
Weight	11 pounds
Activated Oxygen Output	Up to 50 mg per hour
Coverage	Up to 1000 sq. ft.

EdenPURE™ G-7



READ AND SAVE THESE INSTRUCTIONS

VERY IMPORTANT:

- *Read this manual carefully before operating.*
 - *Do not operate unit if unfamiliar with this manual.*
 - *Keep this manual for future reference.*
-



SAFETY WARNINGS



TO REDUCE THE RISK OF FIRE, ELECTRIC SHOCK OR INJURY, BASIC PRECAUTIONS SHOULD BE FOLLOWED INCLUDING:

- Disconnect power cord before performing any maintenance or service.
- The rear of the unit should always have at least one inch of open area to allow unrestricted airflow.
- To prevent injury, be sure the power cord is not accessible to small children.
- The supplied power voltage must be uniform with the appliance's permitted voltage indicated on the back of the unit. Appliances with 110v/60Hz cannot be used with a 220v/50 Hz power supply.
- Only connect to a properly grounded 3 prong circuit receptacle.
- Do not alter the cord or any other part of the unit.
- Do not use with a broken ceramic plate.
- Do not look directly at the UVC bulb while it is operating.
- Do not use outdoors or on wet surfaces.
- Do not use with a damaged cord or plug.
- Do not unplug by pulling on the cord. To unplug, grasp the plug, not the cord.
- Do not operate the unit in areas where flammable, combustible products, or where vapors may be present.
- Do not handle the plug or appliance with wet hands.
- Supervision is necessary when appliance is operated near children.
- Turn off all controls before unplugging unit from outlet.
- If appliance is not working as it should, has been dropped, damaged, left outdoors, or dropped into water, contact the sales representative where you purchased the unit or return it to your local service center.

FEATURES

- QUIET FIVE SPEED FAN
- ADJUSTABLE 24-HOUR CLOCK
- ADJUSTABLE POWER OFF TIMER
- ADJUSTABLE PURIFIER CONTROL (USED FOR RAPID ODOR REMOVAL AND SURFACE STERILIZATION)
- ANION - NEGATIVE ION GENERATOR (NEGATIVE IONS CAUSE THE FLOATING PARTICULATES TO CLING TOGETHER, FORMING A MASS WHICH DROPS THEM TO THE FLOOR TO BE SWEEPED UP)
- STERILIZE (UVC LIGHT HELPS REDUCE AIRBORNE GERMS AS THEY PASS THROUGH THE UNIT)
- HELPS REDUCE SMOKE AND ODORS FROM YOUR HOME, OFFICE, CAR, BOAT, RV, ETC...
- REDUCES MOLD, MILDEW AND BACTERIA
- REPLACEABLE UV LAMP
- REMOTE CONTROL OR MANUAL OPERATION VIA FRONT PANEL CONTROLS
- USER INTERFACE DISPLAY
- MAINTENANCE REMINDERS
- WASHABLE PURIFICATION PLATE
- WASHABLE PHOTO-CATALYTIC PROCESS SCREEN
- WASHABLE PRIMARY FILTER
- SLEEP MODE (DISABLES MOST OF THE DISPLAY LIGHTS, BUT UNIT CONTINUES TO OPERATE)
- IMPROVES INDOOR AIR QUALITY
- USES STANDARD HOUSEHOLD CURRENT

INSPECTION & INSTALLATION

1. Remove unit from shipping carton.
2. Check for shipping damage and loose or broken parts.
3. Remove any protective materials from the outside of the unit.
4. Read Owner's Manual thoroughly prior to operating or servicing the unit.
5. Insert the battery into the remote by sliding the battery compartment open and placing the battery with the positive side (+) facing up.
6. Open the Primary Filter by removing the four corner screws and remove all protective materials from the inside of the unit, i.e. tape used to hold the Catalytic Screen and/or UV Lamp in place.
7. Make sure Catalytic Screen is secure. (Refer to: "GENERAL MAINTENANCE", page 5)
8. Make sure the purification plate is secure and fully inserted in its slot. (Refer to: Page 6 Diagram B)
9. Reinstall the Primary Filter and any other temporarily removed parts before continuing.
10. Determine placement location for the unit. We recommend placing it up higher if possible. A securely fastened wall shelf would be an ideal location.
11. Plug the unit into a 3 prong grounded circuit receptacle.

GENERAL OPERATION

The unit can be operated using either the wireless remote or the front control panel.

1. On the rear of the purifier, switch the master power to the “on” position (the front display will light up).
2. Press the **ON/OFF** button on the front of purifier to power on the unit. The fan will start.
3. Press the **Fan▲** and **Fan▼** buttons to adjust the airflow speed to your desired level.
4. Press the **Purify▲** and **Purify▼** buttons to set the purifier setting from Stage 1 through Stage 5 to accommodate your desired level.
5. Press the **Sterilize** button to operate the UVC and Photo Catalyst sanitize feature. Press the **Sterilize** button again to stop its operation. The UVC bulb will produce a light blue glow on the inside of the unit when this feature is on. **Note: Do not look directly at the UVC Bulb while it is operating.**
6. Press the **Anion** button to turn on the negative ion generator. Press the **Anion** button again to stop the negative ion generator function.



Sleep Button

Press the **Sleep** button to use the screen saving mode. This will turn most of the display lights off. Press any button on the front panel to deactivate the sleep mode. The working mode of **Anion**, **Purify**, **Sterilize**, and **Fan Speed** will not change while in sleep mode. If the timer function is set to turn the power off at a set time, do not use the sleep function. The timer will only deactivate the sleep mode instead of shutting down the unit if the sleep mode is on.

Time/Set Button

Read these instructions thoroughly before setting the time.

***** After 8-10 seconds of inactivity, the clock will be set or you will have to start the process again. *****
The clock is a 24-hour clock; 13:00 would be 1:00 p.m.

To set the current time:

1. Press the **Time/Set** button twice. “Time” will blink on the display.
2. The **Purify▲** and **Purify▼** buttons adjust the hours. The **Fan▲** and **Fan▼** buttons adjust the minutes.

To set the power off timer:

1. While the unit is operating, press the **Time/Set** button once. “Time/Set” will blink on the display.
2. The **Purify▲** and **Purify▼** buttons adjust the hours. The **Fan▲** and **Fan▼** buttons adjust the minutes.

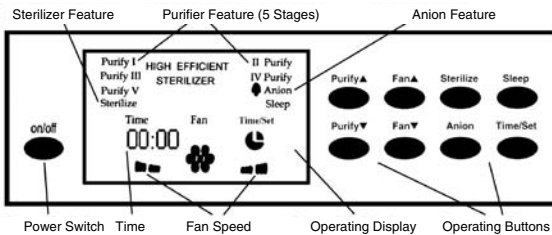

Remote

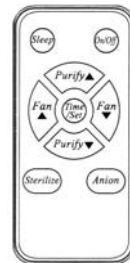

GENERAL MAINTENANCE

UNPLUG THE UNIT BEFORE PERFORMING ANY MAINTENANCE PROCEDURES

Recommended Monthly Maintenance

- Clean the Primary Filter
- Clean the Purifier Plate
- Clean the Catalytic Screen

PRIMARY FILTER & CATALYTIC SCREEN CLEANING

You have three options to clean the Primary filter and the Catalytic Screen:

1. When visibly dirty or after 30 days, remove the primary filter and the catalytic screen from the unit. With a hand-held vacuum, remove the heavy particulates from both filters. This method will extend the life of the filters and ensure proper function of the catalytic screen.
2. If vacuuming does not clean the filter sufficiently, remove the primary filter and the catalytic screen from the unit and wash them in warm water. Brush gently with a toothbrush to remove particulates. Allow to dry thoroughly before re-installing.
NOTE: Do not use soap because it could damage the filters.
3. If a replacement or additional filter and/or catalytic screen are needed, contact the dealer you purchased your product from or visit www.rppurchase.com to locate your closest dealer.

CLEANING THE PURIFICATION PLATE

1. Remove the Purification Plate (see Purification Plate and Catalytic Screen Removal below).
2. Wash the Purification Plate with about 1 drop of mild dish soap (per side) and a toothbrush.
3. Use the toothbrush to make small circular motions over all of the metal mesh areas. Be careful not to drop or break the Purification Plate while cleaning.
4. Rinse with water and allow it to air dry completely before reinstalling.

PRIMARY FILTER REMOVAL

1. Unplug the power to the unit.
2. Unscrew the four rear corner screws from the Primary filter and pull the filter handle to remove. **Refer to Diagram A**
3. After servicing Primary filter, place it back in its original position and re-install the four corner screws.

PURIFICATION PLATE AND CATALYTIC SCREEN REMOVAL

1. Remove Primary filter.
2. Carefully remove the Purification Plate pulling it straight out. This is an ideal time to clean the Purification Plate. **Refer to Diagram B.**
3. Gently pull the Catalytic Screen handle to remove it for cleaning. **Refer to Diagram C.**
4. After servicing Catalytic Screen, place it back in its original position by placing the bottom of screen in first.
5. Carefully re-insert the Purification Plate into its original position. Make sure the Purification Plate is fully inserted.
6. Place the Primary filter back in its original position and re-install the four corner screws.

DIAGRAM - A

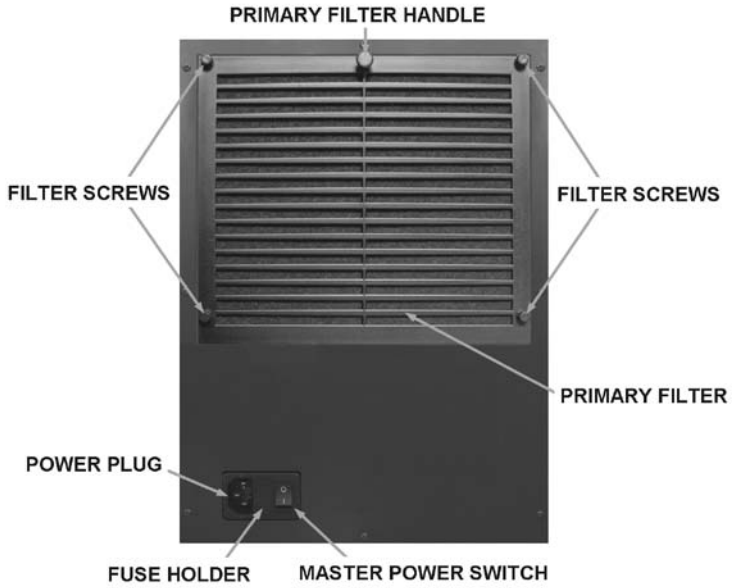

DIAGRAM - B



DIAGRAM - C



GENERAL MAINTENANCE CONTINUED

UNPLUG THE UNIT BEFORE PERFORMING ANY MAINTENANCE PROCEDURES

CHANGING THE UV LAMP

1. Unplug the power to the unit.
2. Remove the Primary filter by removing the 4 corner screws.
3. Remove the tape on either end of the UV Lamp if it is present.
4. Place one finger from each hand (middle or index) on the metal ends of the UV Lamp. Very carefully, apply just enough pressure to roll the lamp (preferably towards the back of the unit) until it is loose. **Note: Be careful not to cut yourself when removing the UV lamp.**
5. Remove the old UV Lamp and insert the new one by aligning the end pins to slide into the end sockets (just like a standard fluorescent bulb).
6. Once both sets of end pins are in their slots, place one finger from each hand (middle or index) on the metal ends of the UV Lamp. Very carefully apply just enough pressure to roll the lamp (preferably towards the back of the unit) until it is secure on both ends. **Note: Be careful not to cut yourself when reinstalling the UV lamp.**
7. Place the Primary filter back in its original position and re-install the four corner screws.
8. Plug the power cord back into the unit and turn it on. Confirm the new UV Lamp is functioning properly. If it is not working properly, repeat steps 1, 2, and 6. Test the UV Lamp again.

DIAGRAM - D



GENERAL MAINTENANCE CONTINUED

UNPLUG THE UNIT BEFORE PERFORMING ANY MAINTENANCE PROCEDURES

CHANGING THE FUSE

1. Unplug the power to the unit.
2. Remove the fuse holder by using your fingernail or a flat blade screwdriver.
3. Remove the blown fuse and use it to push out the spare fuse.
4. Place the new fuse into place and re-insert fuse holder.
5. Plug the power cord back into the unit and turn the master power on.

DIAGRAM - E

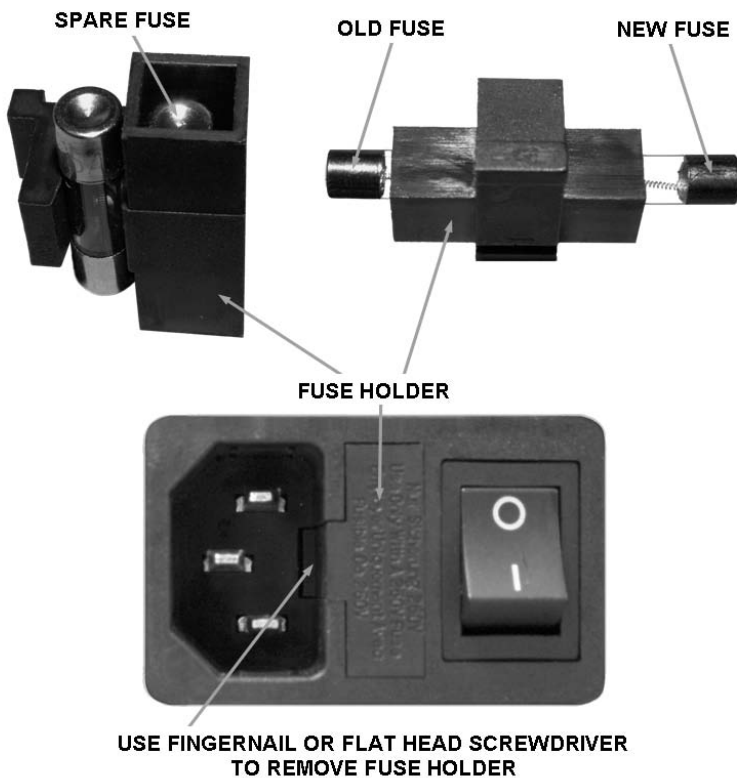

TROUBLESHOOTING

- 1. I have plugged in the unit, turned "ON" the main power switch (on the back of unit), pressed the ON/OFF button on the remote (or the front panel) and nothing happens. What's wrong?**
 - Make sure the power cord is inserted completely into the receptacle on the back of the unit.
 - Make sure the electrical outlet is capable of providing power to the unit.
 - Check the primary filter located on the back of the unit to ensure that the safety switch activator clip depresses the safety switch.
 - Check to see if the proper fuse is installed and that it is operational.
- 2. The fan is operating but the purifier plate is not working or the purifier lights are blinking. What's wrong?**
 - Check the purifier plate to see if it is cracked or broken. If so, the purifier plate will need replaced.
 - Ensure maintenance procedures required for the purifier plate have been performed according to the "General Maintenance" section of this Owners Manual. Order new plates from your dealer if needed.
 - Electrical contacts are not contacting the screen portion of the purifier plate. Unplug and inspect the unit for any loose connections.
 - Make sure the purification plate is fully depressed into slot.
 - Do not attempt to disassemble or service the unit or you will void the warranty.
- 3. The purifier plate is making a noise, has a burning smell, and/or appears to arc/spark. What is the problem?**
 - The purifier plate is most likely cracked. Refer to the answers for question # 2.
- 4. The UV lamp is not functioning or the sterilize display light is blinking.**
 - Check lamp for proper installation. See General Maintenance section of this Owners Manual.
 - Replace UV Lamp. Order a new UV bulb from your dealer if needed.
- 5. What are the most typical application problems?**
 - **Symptom:** A belief that the equipment is placed in the proper environment, but its operation appears unsuccessful.
Problem: Lack of air movement, improper placement of the unit.
 - **Symptom:** Strong odors still remain within the environment after operating the unit.
Problem: Purifier setting is too low or improper placement of the unit.
 - **Symptom:** A strong odor of activated oxygen is present within the environment.
Problem: Purifier setting is too high and/or a lack of air movement.
 - **Symptom:** Visible haze of smoke and/or particulate remains within the environment.
Problem: Lack of air movement, Anion feature is not turned on, or improper placement of the unit.
- 6. How can I tell if the UV lamp is functioning?**
 - The UV lamp will produce a glow that is visible through the front grill under low light conditions.
 - CAUTION: Do not look directly at the glowing lamp.
- 7. The unit does not operate.**
 - Is the unit plugged in?
 - Are you sure the outlet is active?
 - Is the main power switch turned on?
 - Is the rear primary filter installed properly and depressing the safety switch inward?
 - Does the fuse need to be replaced?
 - Is the unit properly placed away from objects that may obstruct airflow?
 - Is the primary filter clean?
 - Is the catalytic screen clean?
 - Is the purifier plate clean?

If your unit fails to operate properly after performing troubleshooting, contact your Sales Representative or Service Center for further assistance.

A list of available Sales Representatives and Service Centers can be located by visiting our website at www.rppurchase.com or by calling 866-786-8946.

EdenPURE™ Area Model



READ AND SAVE THESE INSTRUCTIONS

VERY IMPORTANT:

- *Read this manual carefully before operating.*
- *Do not operate unit if unfamiliar with this manual.*
- *Keep this manual for future reference.*



SAFETY WARNINGS



TO REDUCE THE RISK OF FIRE, ELECTRIC SHOCK OR INJURY, BASIC PRECAUTIONS SHOULD BE FOLLOWED INCLUDING:

- Disconnect power cord before performing any maintenance or service.
- The rear of the unit should always have at least one inch of open area to allow unrestricted airflow.
- To prevent injury, be sure the power cord is not accessible to small children.
- The supplied power voltage must be uniform with the appliance's permitted voltage indicated on the back of the unit. Appliances with 110v/60Hz cannot be used with a 220v/50 Hz power supply.
- Only connect to a properly grounded 3 prong circuit receptacle.
- Do not alter the cord or any other part of the unit.
- Do not look directly at the UVC bulb while it is operating.
- Do not use outdoors or on wet surfaces.
- Do not use with a damaged cord or plug.
- Do not unplug by pulling on the cord. To unplug, grasp the plug, not the cord.
- Do not operate the unit in areas where flammable, combustible products, or where vapors may be present.
- Do not handle the plug or appliance with wet hands.
- Supervision is necessary when appliance is operated near children.
- Turn off all controls before unplugging unit from outlet.
- If appliance is not working as it should, has been dropped, damaged, left outdoors, or dropped into water, contact the sales representative where you purchased the unit or return it to your local service center.

FEATURES

- QUIET THREE SPEED FAN
- AUTO MODE CYCLES OZONE OR ANION (ION GENERATOR) ON AND OFF AUTOMATICALLY
- MANUAL MODE AUTOMATICALLY DEFAULTS TO ANION FEATURE AFTER 2 HOURS
- 2 OR 4 HOUR TIMER MODE OPERATES UNIT FOR 2 OR 4 HOURS AND THEN SHUTS OFF AUTOMATICALLY
- OZONE GENERATOR (USED FOR RAPID ODOR REMOVAL AND SURFACE STERILIZATION)
- ANION - NEGATIVE ION GENERATOR (NEGATIVE IONS CAUSE THE FLOATING PARTICULATES TO CLING TOGETHER, FORMING A MASS WHICH DROPS THEM TO THE FLOOR TO BE SWEEPED UP)
- STERILIZE (UV LIGHT HELPS REDUCE AIRBORNE GERMS AS THEY PASS THROUGH THE UNIT)
- HELPS REDUCE SMOKE AND ODORS FROM YOUR HOME, OFFICE, CAR, BOAT, RV, ETC...
- REDUCES MOLD, MILDEW AND BACTERIA
- REPLACEABLE UV LAMP
- WIRELESS REMOTE CONTROL OR MANUAL OPERATION VIA FRONT PANEL CONTROLS
- WASHABLE PRE-FILTER
- WASHABLE HEPA FILTER
- DIGITAL DISPLAY WITH SLEEP MODE (THE BACKLIGHT TURNS ITSELF OFF AFTER ADJUSTING SETTINGS)
- IMPROVES INDOOR AIR QUALITY
- USES STANDARD HOUSEHOLD CURRENT

INSPECTION & INSTALLATION

1. Remove unit from shipping carton.
2. Check for shipping damage and loose or broken parts.
3. Remove any protective materials from the outside of the unit.
4. Remove the filter panel on the right side of the machine and make sure the plastic cover has been removed from the filter.
5. Read Owner's Manual thoroughly prior to operating or servicing the unit.
6. Insert the battery into the remote by sliding the battery compartment open and placing the battery with the positive side (+) facing the bottom of the remote.
7. Determine placement location for the unit. We recommend placing it up higher if possible. A securely fastened wall shelf would be an ideal location.
8. Plug the unit into an unused power outlet.

ADVANCED FUNCTIONS

Ozone Function (use is optional)

Used for rapid odor removal and surface sterilization. Select this feature by pressing the “**FUNCTION**” button until you see “**OZONE**” on the digital display.

Anion Function

This unit includes a negative ion generator. Negative ions literally sweep your breathing space clean of many lung damaging pollutants by causing the floating particulates to cling together, forming a mass which drops them to the floor to be swept up. Select this feature by pressing the “**FUNCTION**” button until you see “**ANION**” on the digital display.

UV/TiO2 (UV Bulb Sterilizer)

An advanced UV Bulb sterilizes the air that passes through the unit. You should allow this feature to run continuously to achieve optimal fresh air output. Turn this feature on or off by pressing the “**UV/TiO2**” button until you see “**UV: ON**” or “**UV: OFF**” on the digital display.

Fan Speed

This unit has a quiet 3-speed fan. Adjust the fan speed by pressing the “**SPEED**” button. The display will show 1 - 3 bars under “**SPEED**” on the display. The smallest bar represents the lowest speed and the largest bar represents the highest speed.

Manual Mode

This mode will automatically set the function to Anion after operating for 2 hours. This mode will only disable the Ozone function (not the fan speed or UV Bulb). Select this feature by pressing the “**MODE**” button until you see “**MANU**” on the digital display.

Auto Mode

This mode will operate the unit for 20 minutes at your desired settings, turn itself off for 40 minutes, and continue to repeat the same cycle until you stop the “**AUTO**” mode. Select this feature by pressing the “**MODE**” button until you see “**AUTO**” on the digital display.

2 Hours Mode

This mode will operate the unit at your desired settings and turn itself off automatically after 2 hours. Select this feature by pressing the “**MODE**” button until you see “**2HOURS**” on the digital display.

4 Hours Mode

This mode will operate the unit at your desired settings and turn itself off automatically after 4 hours. Select this feature by pressing the “**MODE**” button until you see “**4HOURS**” on the digital display.

GENERAL OPERATION

The unit can be operated using either the wireless remote or the front control panel.

1. Press the **POWER** button. This starts the unit and turns on the LED display. The soft blue backlight will turn off after approximately 20 seconds.
2. Press the **MODE** button successively to select your desired mode; **MANUAL, AUTO, 2 HOURS, 4 HOURS** (see Advanced Functions). **Note: Ozone setting will operate for 2 hours and then revert to ANION.**
3. Press the **FUNCTION** button successively to select **ANION** or **OZONE**. If the unit is set to **OZONE**, it will convert automatically to **ANION** after 2 hours. However, if set to **AUTO** mode; the Ozone will operate for 20 minutes, turn off for 40 minutes, and then continue to repeat the same cycle until you stop the **AUTO** mode.
4. Press the **UV/TiO2** button to power the UV Bulb sterilizer **ON** and **OFF**. We recommend you leave this feature turned on. **Note: Do not look directly at the UV Bulb while it is operating.**
5. Press the **FAN** button successively to adjust the fan speed between low, medium and high.

FUNCTION OVERVIEW

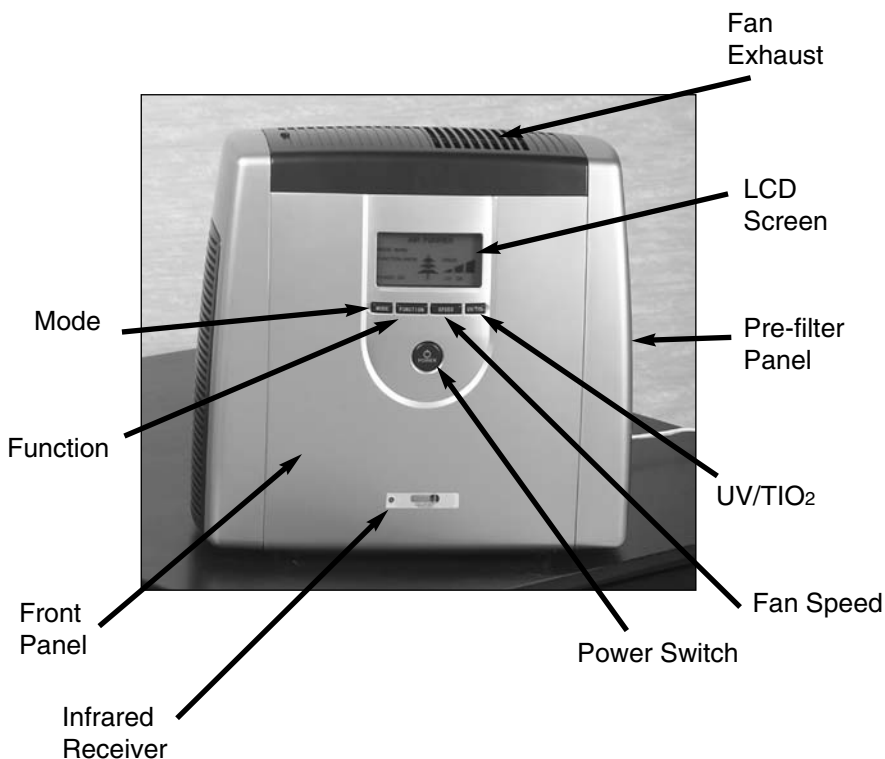

GENERAL MAINTENANCE

UNPLUG THE UNIT BEFORE PERFORMING ANY MAINTENANCE PROCEDURES

Recommended Monthly Maintenance

- Clean the Pre-Filter
- Clean the HEPA Filter

CLEANING THE PRE-FILTER & THE HEPA FILTER

When visibly dirty or after 30 days:

1. Unplug the power to the unit.
2. Remove the pre-filter by lifting up on the bottom center of the pre-filter panel. (Diagram 1)
3. Remove the HEPA filter by pulling on its ribbon handle. (Diagram 2)
4. With a hand-held vacuum, remove the heavy particulate from both sides of the filters.
5. Re-install the HEPA filter leaving the ribbon handle facing out.
6. Re-install the pre-filter panel. (Diagram 1)

If vacuuming does not clean the filters sufficiently:

1. Rinse both filters in warm water. **NOTE: DO NOT use soap, soak in water, scrub with brush, or squeeze the filters.**
2. Shake the excess water off of the filters.
3. Allow both filters to dry thoroughly before re-installing. **NOTE: DO NOT force the filters to dry using any alternative methods.**
4. Re-install the HEPA filter leaving the ribbon handle facing out.
5. Re-install the pre-filter panel. (Diagram 1)

Contact your dealer for replacement filters:

1. Contact the dealer you purchased your product from or visit www.rppurchase.com to locate your closest dealer.

CHANGING THE UV LAMP

1. Unplug the power to the unit.
2. Remove the pre-filter by lifting up on the bottom center of the pre-filter panel. (Diagram 1)
3. Remove the HEPA filter by pulling on its ribbon handle. (Diagram 2)
4. Carefully roll the UV Bulb until it is loose (bulb fitting is similar to a fluorescent bulb). (Diagram 3)
5. Remove the UV Bulb. (Diagram 4)
6. Insert new UV Bulb making sure the ends slide into their slots.
7. Carefully roll the UV Bulb until it is not loose. (Diagram 3)
8. Re-install the HEPA filter leaving the ribbon handle facing out.
9. Re-install the pre-filter panel. (Diagram 1)
10. Plug the power back in and then turn on the UV setting to make sure the bulb is functioning properly. If it doesn't light up, repeat the above steps again to make sure the bulb is properly installed into its slots.



Diagram 1



Diagram 2



Diagram 3



Diagram 4

10 PURIFICATION STEPS TO A HEALTHY HOME

These 10 Purification tips are designed to demonstrate immediate results and help speed up the purifying process in your home or office. These steps can provide amazing results and are well worth recommending to family and friends!

Please note that with everyday normal use, the air purifier should be securely located on the highest piece of furniture in your main living area.

NOTICE: During the purification process you may get a "Bleach" smell, that's good! It tells you that the air purifier is working and the O3 is oxidizing (breaking down) the toxins, chemicals and bacteria into pure Oxygen, H2O, and Carbon Dioxide. This purification process turns your stale, toxic, sick home air into a vibrant healthy home environment.

NOTE: Some steps work best with the EdenPURE™ G-7.

PUT YOUR AIR PURIFIER TO THE TEST... THREE RULES TO REMEMBER

Your new air purifier not only helps purify indoor air, but all your home surfaces as well. That's right, your carpets, clothes, towels, shoes, cat, dog, you, your children and the list goes on and on.

- A. HAVE FUN! Experiment! Your air purifier is portable! Move it around! But be considerate of the other people in the house. It is rare, but occasionally some people initially do not like the smell of the Activated Oxygen and that's O.K., they eventually will. Once you sanitize and bathe your entire home with nature's cleaning elements, only a small, undetectable amount of O3 is necessary to maintain the natural level of purity. Put it through its paces and marvel at the magic of nature's purification at work indoors.
- B. ALWAYS keep the back (G-7) or sides (area model) of your air purifier clear of obstructions so as to allow it to properly draw air through it.
- C. ALWAYS be watchful of the electric cord. Keep away from water and excessive heat, and prevent pinching the cord.

RV Vehicles (Boats and other target items)

Have you ever taken the cover off your boat and been blown away by the musty smells? This tip will purify your musty seasonal clothing, tenting and camping gear, as well as RVs. Do this step if you want to protect your valued items from nasty odors and potentially harmful mold and mildew while they are in storage.

- A. Place opened items or opened hanging items in front of your air purifier in a closet or storage unit. Or, lay the gear out on the floor tented with a sheet leaving the back (G-7) or sides (area model) open for ventilation.
- B. Turn the air purifier on. Set the purify setting to its highest level (G-7). Select the ozone option for the area model.
- C. Allow this "setup" to run for 1 to 2 hours. Let your nose be the judge.
- D. For RVs, campers, tents and boats, place the unit inside and make sure there is a small window or a vent open for ventilation. Leave the purifier in the unit for 2 to 24 hours depending on the severity of the mold or odor problem. NOTE: If you are allergic to the outdoor pollen and mold that finds its way into the RV or camper at night or you are an avid camper, consider investing in a second Purifier for travel. Remember, when mold oxidizes, it smells like Chlorine. Wait for the after thunderstorm fresh air smell before removing the unit or turning it down/off.

Automobiles Keep your car smelling fresh or "detox" a new car

This step can help you reduce or eliminate that stale smell your car can get as it ages, as well as help eliminate the hazardous toxic fumes left behind in a new car, or odors from a smoker or a pet passenger. This is a single treatment that will have to be repeated again and again as fumes build up.

- A. Place your air purifier on the front seat of your car.
- B. Make sure the back (G-7) or sides (area model) of your air purifier are clear so you maintain good airflow through the machine.
- C. Turn your car ignition to the "on" position and turn your car's heating/cooling ventilation fan on.
- D. Turn the air purifier on. Set the purify setting to its highest level (G-7). Select the ozone option for the area model. Set the fan to medium.
- E. Watch the cord as you close the door or put it through the window.
- F. Allow this "setup" to run 1 to 2 hours or longer depending on the smells. Your nose knows.

Keep your pores healthy with naturally sanitized clothes Dry cleaning making you sneeze?

This step can help reduce and eliminate that nasty toxic residue and odor left behind in your clothing by your cleaning solutions or by the dry cleaner.

- A. Remove any plastic or paper wrap and hang the clothing in a closet or bathroom.
- B. Place your air purifier as high as possible (G-7) or under the clothing (area model) and blowing directly (if possible) on the clothing to be sanitized.
- C. Turn the air purifier on. Set the purify setting to its highest level (G-7). Select the ozone option for the area model. Set the fan to medium.
- D. Make sure the back (G-7) or sides (area model) of your air purifier are clear so you maintain good airflow through the machine. Watch the cord as you close the door.
- E. Allow this "setup" to run for 1 to 2 hours depending on the smell. Again, let your nose be your judge.

Cleaning Up Heating and Cooling With Purification! This is your home's lungs

This step takes the most time and is the most beneficial to you. Purifying your heating and cooling ventilation system could alone pay for your air purifier. It costs up to \$700.00 to have your home ventilation ductwork chemically treated to prevent infection and breathing disorders. This step alone will more than pay for your air purifier and is worth recommending to those you love! Your air purifier will help keep your house environmentally spic-n-span, continuously. This step works best with the EdenPURE™ G-7.

- A. Just place your air purifier directly in front of and facing the cold air return or intake of your ventilation system.
- B. Turn the air purifier on. Set the purify setting to its highest level (G-7). Select the ozone option for the area model. Set the fan to low.
- C. Now turn on your Heating/Cooling system fan for continuous operation.
- D. Allow the "setup" to run at least 12 hours or until you smell the sweet smell of Fresh Activated Oxygen coming out the vents farthest away from the central air/fan unit. The longer the better. You can let it run this way all day while you're away. If you do leave it on all day, open all your closet doors to freshen them up at the same time.

Sound, healthy sleep environment

This step won't take long and has the potential to give you the best night's sleep ever! You spend one third of your life here. Your overall quality of sleep may be impacted by the freshness of your mattress. A mattress can be so filthy that it is illegal in some states to resell. This step works best with the EdenPURE™ G-7.

- A. Simply pull the blankets back to expose the mattress and pillows.
- B. Set the air purifier on the foot of your bed, pointed toward the headboard.
- C. Turn your air purifier on high.
- D. Cover your air purifier and your whole bed with a light sheet to make a "tent" over everything except the back of the air purifier (so it can breathe). This will concentrate the Activated Oxygen deep into your bedding to reduce or oxidize the gross stuff (dust mite excretion) in your beds that affects your breathing and thus reduces your ability to get a good night sleep.
- E. Make sure the back (G-7) or sides (area model) of your air purifier are clear so you maintain good airflow through the machine.
- F. Then close the door to the room and allow the air purifier to disinfect for 2 to 4 hours or all day while you're away, and then walk into an environmentally pure room.

NOTE: You will be tempted to sleep with the unit in your room. However, that is not necessary once the room is sanitized. You will normally get a smaller amount of concentration with the purifier when it is placed in a main living area. The higher concentration won't harm you, but those who are sensitive may find it annoying.

Tame Pet Odors

This step can help you reduce or eliminate that obnoxious smell that our loving pets sometimes leave us to deal with in our lives. This step can be amazing and is worth recommending to friends if they have pet odor problems. If you need to treat a whole room, follow the steps below. This step works best with the EdenPURE™ G-7.

- A. Place your air purifier in front of and facing the problem spot directly on the floor.
- B. Turn the air purifier on. Set the purify setting to its highest level (G-7). Select the ozone option for the area model. Set the fan to low.
- C. Make sure the back (G-7) or sides (area model) of your air purifier are clear so you maintain good airflow through the machine.
- D. Allow this "setup" to run for 2 to 24 hours, or longer, depending on the smell. Let your nose be the judge.

NOTE: To purify a stinky spot on the carpet, cover the air purifier and the spot with a light sheet creating the tent effect as you did with your bedding. Make sure you don't block the airflow through the air purifier.

Mold Blast the Basement

This step will amaze you as your nasty, mold and mildew-smelling basement becomes transformed into a sweet smelling pleasant place to spend time. Now, you may have to run a dehumidifier if the basement environment is really damp. Mold and mildew love dampness.

- A. Place your air purifier in the center of the basement about 5 to 6 feet above the floor or as high as possible.
- B. Turn the air purifier on. Set the purify setting to its highest level (G-7). Select the ozone option for the area model. Set the fan to high.
- C. Place an additional fan in the room if necessary to circulate the Activated Oxygen to every corner of the basement if the basement has poor airflow.
- D. Allow the "setup" to run for 6 to 8 hours for mild/moderate problems. Allow it to operate from 2 to 4 days if you have a serious problem in your basement. Remember, according to experts, if you can smell the mold or mildew, you could be at risk! So, let's remove and/or significantly reduce deadly mold!

NOTE: For severely infected or damp areas, consider a second air purifier. ALSO REMEMBER: When you set up for initial purifying for purging purposes and when oxidizing mold you will normally smell a detergent like smell resembling chlorine until there is a reduction in the amount of mold.

Hammer Remodeling Fumes

This step can help reduce and eliminate those hazardous toxic fumes and dust created in your home during and after you paint, lay carpet, install cabinetry or after almost any remodeling job! This procedure can be amazing and is worth recommending to friends who are also remodeling or building.

- A. Place your air purifier in the center of the room about 5 to 6 feet above the floor.
- B. Turn the air purifier on. Set the purify setting to its highest level (G-7). Select the ozone option for the area model. Set the fan to medium.
- C. Place an additional fan in the room to circulate the Activated Oxygen to every corner of the room if the area has poor airflow.
- D. Allow this "setup" to run for 2 to 24 hours, or longer, depending on the smell. Let your nose be the judge.

NOTE: You may initially get a "bleach" smell, that's good! It tells you the O³ is transforming the toxins, chemicals and bacteria into pure oxygen, H²O, O² and carbon dioxide.

Flush Your Bathroom

This step can help reduce that nasty mold and mildew; it will also help keep those gross, infectious, microscopic bacteria and creatures from taking over your bathroom!

- A. Place your air purifier in the center of the bathroom about 5 to 6 feet above the floor.
- B. Turn the air purifier on. Set the purify setting to its highest level (G-7). Select the ozone option for the area model. Set the fan to medium.
- C. Allow the "setup" to run for 2 to 4 hours.
- D. This procedure should be repeated at least once per month to help maintain a safe and healthy bathroom. Also keep in mind that when you have the purifier on, it is for purging purposes and when oxidizing mold you will normally smell a detergent-like smell resembling chlorine until there is a reduction in the amount of mold. However, the air purifier does not produce Chlorine, it only produces activated oxygen. This is the same natural process the sun and thunderstorms produce to clean up the outdoor air pollution.

Spring Clean the Closet

Oxidize chemicals from dry cleaning or smelly clothes in general

This step can help you reduce or eliminate that stale old smell from all of your closets and storage units.

- A. Place your air purifier in the center of the closet or storage space up as high as you can get it. If what you're purifying is a small item like a chest or trunk, close the lid within 1 inch of fully closed. You must allow some fresh air in for your air purifier to work best.
- B. Turn the air purifier on. Set the purify setting to its highest level (G-7). Select the ozone option for the area model. Set the fan to high.
- C. Make sure the back (G-7) or sides (area model) of your air purifier are clear so you maintain good airflow through the machine.
- D. Watch the cord so that you don't pinch it when closing the door.
- E. Allow this "setup" to run for 1 to 2 hours depending on how fully you pack your closet or the size of the storage area. It is OK to run it all day.

NOTE: For stinky, smelly shoes or a smoke drenched jacket, place the item in front of your air purifier for an extra hour or so.

WARRANTY

WARRANTY:

SCI Resource Partners warrants this product, to the original purchaser or gift recipient, to be free from defects in workmanship and materials under normal use and service, for a period of one year from the date of purchase.

LIMITATIONS:

ALL WARRANTIES IMPLIED BY LAW, INCLUDING THE IMPLIED WARRANTIES OF MERCHANTABILITY AND FITNESS FOR A PARTICULAR PURPOSE, ARE EXPRESSLY LIMITED TO THE DURATION OF THE WARRANTY SET FORTH ABOVE. Some jurisdictions do not allow limitations on the length of the implied warranty, so the above limitation may not apply to you.

IN NO EVENT SHALL SCI RESOURCE PARTNERS BE LIABLE FOR ANY INCIDENTAL OR CONSEQUENTIAL DAMAGES, LOSS OF PROFIT, OR MEDICAL EXPENSES CAUSED BY ANY DEFECT, FAILURE, MISUSE, OR MALFUNCTION OF THE PRODUCT. Some jurisdictions do not allow the exclusion of limitation of incidental or consequential damages, so the above limitation or exclusion may not apply to you. The Company will not be responsible for damages or losses, direct or indirect, caused by misuse, abuse, accident, negligence, conditions of transportation or storage, or failure to follow instructions. The Company will not be responsible for any statements that are made or published, written or oral, that are inconsistent with this written warranty, or which are misleading or inconsistent with the facts as published by the Company in the literature or specifications.

WARRANTY RESTRICTION:

This warranty is invalid if the factory-applied serial number has been altered or removed from the product.

WARRANTY CLAIM PROCEDURE:

To obtain warranty service customer must:

- 1) Provide proof of purchase in the form of a Bill of Sale or receipted invoice, evidence unit is within the warranty period.
- 2) Contact the Dealer you purchased your equipment from.

Please clip and return warranty card below

SCI Resource Partners' Warranty Registration

Please return this card within 30 days of purchase to activate your warranty. Thank You.

E-mail Address _____ @ _____

Firstname _____ M.I. _____ Lastname _____

Street _____ Apt.# _____

City _____ State _____ Zip code _____

Model purchased _____ Serial# _____

Date of purchase: _____ Place of Purchase: _____

Name of Representative or Service Center: _____

Are you interested in your own Distribution Business? Yes _____ No _____

Phone : _____ - _____ - _____ Best time to contact you _____

SCI
Resource Partners

Suarez Corporation Industries
Resource Partners
7800 Whipple Ave. NW
North Canton, Ohio 44720-6928

1-866-786-8946
www.rppurchase.com



First-Class
Postage
Required
Post Office
will not deliver
without proper
postage.

Suarez Corporation Industries
Resource Partners
7800 Whipple Ave. NW
North Canton, Ohio 44720-6928



Free Manuals Download Website

<http://myh66.com>

<http://usermanuals.us>

<http://www.somanuals.com>

<http://www.4manuals.cc>

<http://www.manual-lib.com>

<http://www.404manual.com>

<http://www.luxmanual.com>

<http://aubethermostatmanual.com>

Golf course search by state

<http://golfingnear.com>

Email search by domain

<http://emailbydomain.com>

Auto manuals search

<http://auto.somanuals.com>

TV manuals search

<http://tv.somanuals.com>