

Swann Technical Support

All Countries E-mail: tech@swann.com.au

Telephone Helpdesk

UNITED STATES toll free

877-274-3695

(Sun-Thurs, 2pm-10.30pm PST)

800-627-2799

(Mon-Fri, 9am-1pm PST)

USA Exchange & Repairs

562-777-2551

(Mon-Fri, 9am-5pm PST)

AUSTRALIA toll free

1300 13 8324

(Mon-Fri, 9am-5.30pm Aus EST)

International

+61 3 8412 4610

(Mon-Fri, 9am-5.30pm Aus EST)

See <http://www.worldtimeserver.com> for information on different time zones and the time in Melbourne Australia compared to your local time.

Warranty Information

Swann Communications warrants this product against defects in workmanship and material for a period of one (1) year from it's original purchase date. You must present your receipt as proof of date of purchase for warranty validation. Any unit which proves defective during the stated period will be repaired without charge for parts or labour or replaced at the sole discretion of Swann. The repair or replacement will be warranted for either ninety days or the remainder of the original one year warranty period, whichever is longer. The end user is responsible for all freight charges incurred to send the product to Swann's repair centres. The end user is responsible for all shipping costs incurred when shipping from and to any country other than the country of origin. The warranty does not cover any incidental, accidental or consequential damages arising from the use of or the inability to use this product. Any costs associated with the fitting or removal of this product by a tradesman or other person or any other costs associated with its use are the responsibility of the end user. This warranty applies to the original purchaser of the product only and is not transferrable to any third party.

Unauthorised end user or third party modifications to any component or evidence of misuse or abuse of the device will render all warranties void.

Color Video Doorphone High Resolution Intercom

Safely see who's at the door before you answer it



Installation Guide

www.swannsecurity.com

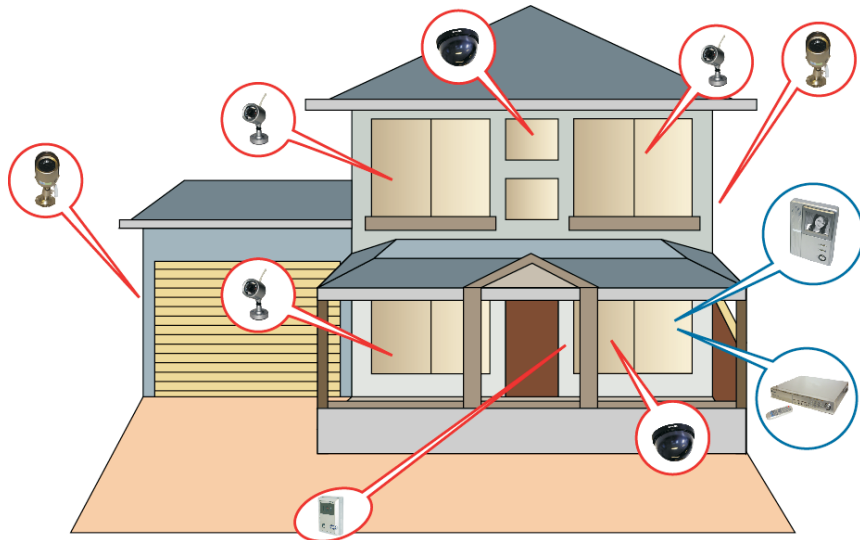

Firstly check if the monitor is getting power, make sure the 16VDC 1A power supply is firmly connected to the power socket. Then make sure you have correctly wired the Doorphone system by referring to the Wiring Diagram illustrations on page 8. Test by pressing the "Talk/Monitor" button on the monitor. You should see an image from the intercom unit if the system has been correctly installed.

Frequently Asked Questions

Q. Why can't I see the person at the door?

A. Firstly make sure you have followed the steps in the Quick User Guide above. Then try adjusting the camera location, viewing direction of the camera, and contrast to improve the picture. During times of low light, if you find your visitors are standing too far from the intercom to be seen, we recommend providing an additional light source to help illuminate the entrance area.

Q. Why can't I hear the person at the door?

A. Firstly make sure you have followed the steps in the Quick User Guide above. Now try pressing the "Call" button on the front of the intercom unit. Once the monitor unit chimes, press the "Talk/Monitor" button to test communications. If you can not hear the other person, try moving closer to the microphone on the intercom and monitor units.

Q. Why can't I hear the doorbell ring?

A. Firstly make sure you have followed the steps in the Quick User Guide above. To activate the door chime, press the "Call" button on the front of the intercom unit.

Q. How do I extend the length of the cable from the monitor to intercom unit?

A. You can extend the length of the cable by using (2 x 0.75mm²) copper cable in PVC insulation. For example figure 8 speaker cable.

Q. What type of cable should I use to connect the intercom unit my electronic door latch?

A. We recommend using (2 x 0.15mm²) copper cable. For example telephone cable.

Q. Can I use more than one monitor with my Doorphone system?

A. No. However you can use the TV Output to view the images on your TV. Please refer to page 3 for more information.

DVR4NET - PLUS
4 Camera Digital Video Recorder



Night Hawk
Wireless Outdoor Camera



DIY Security Kit
2 Real & 2 Imitation Cameras Security Monitoring System



Microcam II
Wireless Security Camera



CCTV Professional 4 Camera Pack
Professional Security Camera



Imitation Dome Cam
Imitation Security Camera



AV Power Cable - 18m/60ft
Camera Accessory



■ Indoor-monitor

Power supply	DC16V
Power consumption	About 10W in operation; about 0.5W in standby
Operation temperature	5 ~ 122 °F /-15~50°C
Conversation System	Bi-directional conversation through the receiver
Calling Tone	"Ding Dong" chime
Conversation Time	Automatic cut off after about 2 minutes
Scanning Frequency	Horizontal:15.625KHz Vertical: 50Hz
External dimension	7 1/3x5 1/12x1 1/8x1 30x27mm(LxWxH)

■ Camera

Power supply	DC12V , 0.25A (supplied by the monitor)
Power consumption	About 2.0W in operation
Operation temperature	5 ~ 122 °F /-15~50°C
Picture Sensor	1/4" CMOS
Field of View	Diagonal: about 53°
Min. Lighting	0.1 lux @ about 11.8in/30cm
Lighting	6 Infrared illuminators
External dimension	47/12x31/3x1 1/4in/120x88x34mm(LxWxH)

Table of Contents 3

Functions 4

Package Contents 5

Monitor Features 6

Camera Features 6

Installation 7

Wiring diagram 8

Operation 9

Specifications 10

Quick User Guide 11

Frequently Asked Questions 11

Help Desk / Support Details 12

Warranty Information 12

■ Hands free Communication

This device provides hands free communication between the color TFT-LCD monitor and the outdoor intercom unit. With a press of a button, you can communicate with the visitor at the door.

■ Automatic Display

When the visitors press the doorbell button, the bell will ring and a picture of the visitor will be automatically displayed. You can safely identify the visitor before talking or opening the door.

■ Unlock Button

With a button for opening an electronic door latch, you are able to open the door from the LCD monitor without going directly to the door.

* Note: This is an optional extra available from Swann. (SW-D-LOCK)

■ Night Vision

The 6 infrared LEDs on the camera allows you to recognize the visitor during times of low light.

* Night vision distance will vary with the amount of available light.

■ Visitor at the door

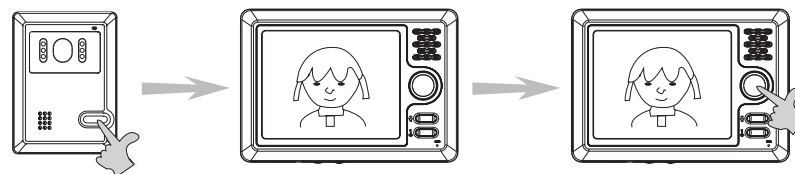

A visitor presses the "call" button on the intercom.

The door phone will ring and the visitor is displayed on the LCD monitor.

Press the "talk" button to communicate with the visitor.

- Once you press "talk" button to communicate with the visitor, the LCD monitor will be shut down automatically in 2 minutes.
- When the visitor presses the "call" button, the picture will be displayed on the LCD monitor. If no one answers, the monitor will automatically go back into standby mode after 60 seconds.

■ Other operations

Warning button

If you get malice visitors, you can press warning button. The intercom unit will give an audible alarm and bring attention to area around the intercom unit.

Adjustable volume/contrast

If you think the monitor volume is not loud enough or the picture shown on the screen is too bright, you can alter this by adjusting the volume or contrast wheel found underneath the LCD monitor.

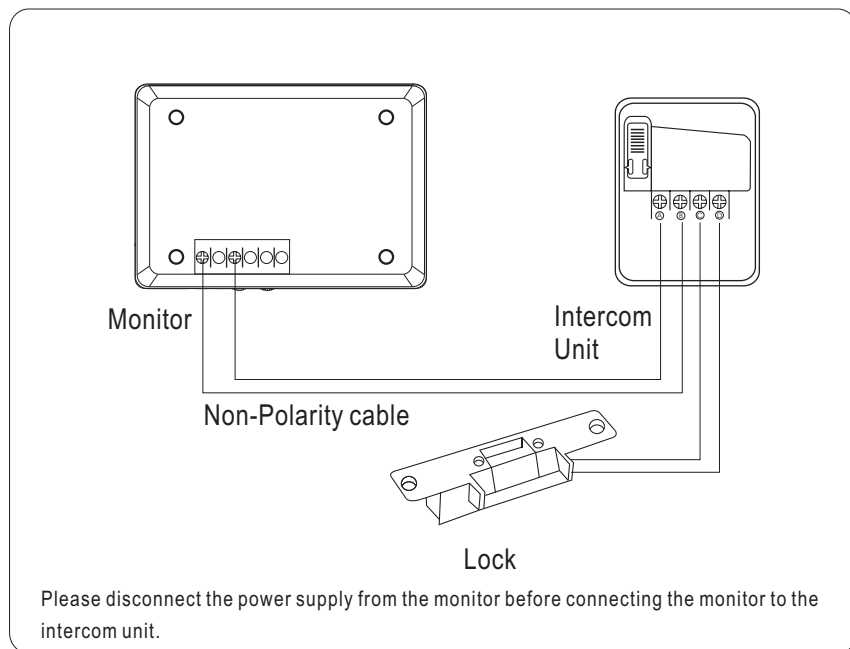

Open the door with the touch of a button by installing Swann's Electric Door Strike* (SW-D-LOCK).

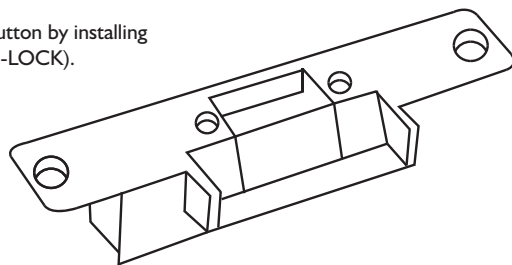

*Sold separately

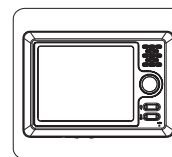

Monitor

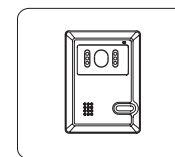

Intercom unit

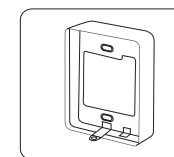

Camera bracket

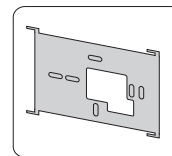

Support for Wall-mount



Installation guide

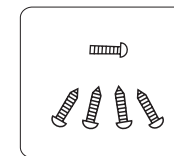

Screws

Important Informations

Do not put the doorphone near strong magnetic fields, such as a television or video recorder .

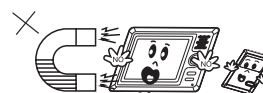

Turn off the power if not use for long time.



Do not spray water directly on the video doorphone.

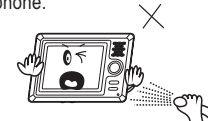

Do not damage the video doorphone.



Do not place unit in direct sunlight or expose it to rain.



There may be high voltage inside the system, do not under any circumstances disassemble this device.

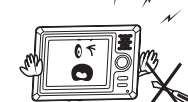

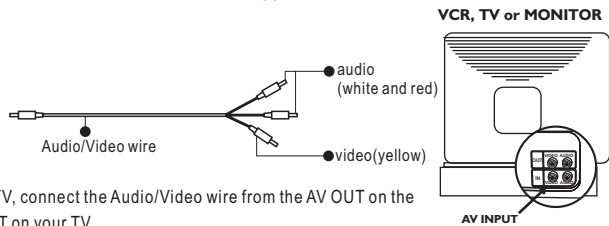
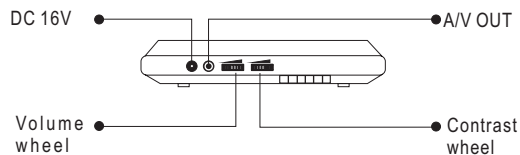
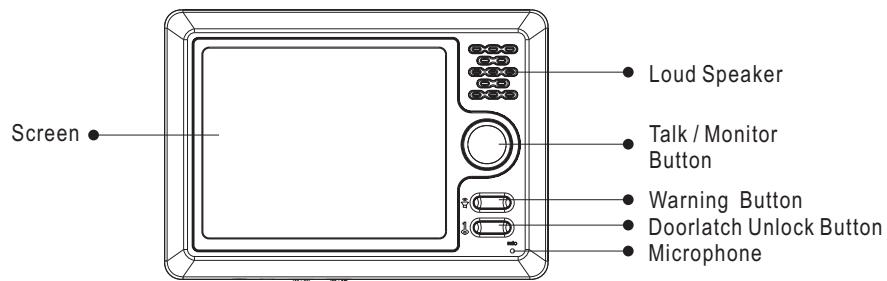

To view the image on your TV, connect the Audio/Video wire from the AV OUT on the LCD monitor to an AV INPUT on your TV.

Camera Features

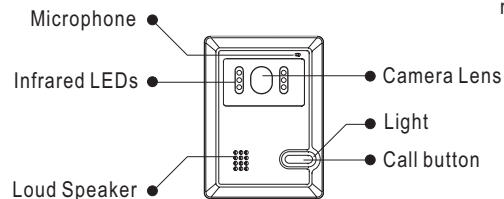

Switch for adjusting camera angle (move up to tilt camera down and move down to tilt camera up)

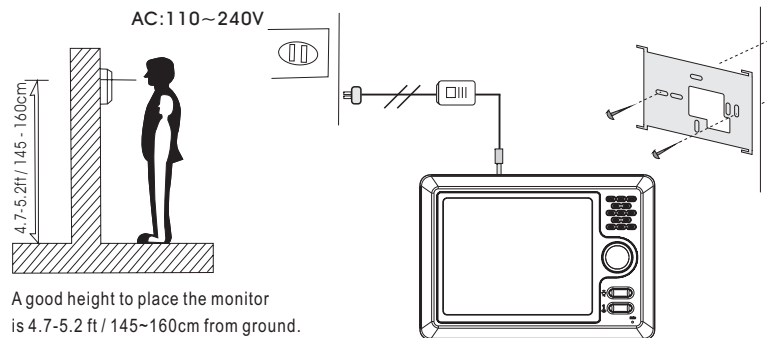
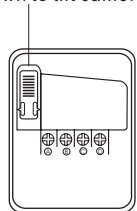

A good height to place the monitor is 4.7-5.2 ft / 145~160cm from ground.

Fix the wall mount on the wall using the supplied screws and then attach the monitor.

Installation of the camera

Positioning the lens using the switch on the back of the camera to adjust the angle of the lens:

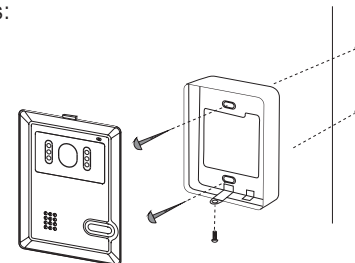
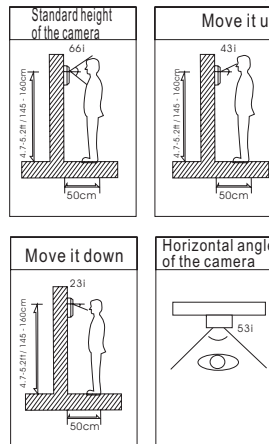

Location:
Keep the camera away from direct sunlight and the effects of poor weather.

Free Manuals Download Website

<http://myh66.com>

<http://usermanuals.us>

<http://www.somanuals.com>

<http://www.4manuals.cc>

<http://www.manual-lib.com>

<http://www.404manual.com>

<http://www.luxmanual.com>

<http://aubethermostatmanual.com>

Golf course search by state

<http://golfingnear.com>

Email search by domain

<http://emailbydomain.com>

Auto manuals search

<http://auto.somanuals.com>

TV manuals search

<http://tv.somanuals.com>