

## ST414FG

### 14 INCH COLOR TELEVISION

## FEATURES

- **181 Channel Selection**- All VHF/UHF channels plus up to 125 cable channels.
- **PLL Frequency Synthesized Tuning**- Provides free and easy channel selection and lets you tune directly to any channel using the channel number buttons on the remote control.
- **Sleep Timer**
- **Closed Caption Decoder**
- **Auto Shut Off Function**- If there is no signal input from the antenna terminal and no user operation for 15 minutes, the TV will turn itself off automatically.
- **V-CHIP**- Enables parents to prevent their children from watching inappropriate material on TV.
- **Tinted, Bright Black Matrix Picture Tube**
- **Full-Function Remote Control**
- **On-Screen Function Display**
- **Front AV Input**
- **Resume Function**- If the power fails or is disconnected while the TV is on, the TV will turn on automatically when the power resumes.
- **Flat Screen Picture Tube**

## PRECAUTIONS

- Place your TV in a room with adequate ventilation.
- Keep your TV set away from sources of direct heat, such as heat registers or direct sunlight.
- Do not place your TV on soft surfaces, such as rugs or blankets.
- Leave enough room for air to circulate around the bottom, top and back of the set.

The serial number of this product may be found on the back of the TV. No others have the same serial number as yours. You should record the number and other vital information here and retain this book as a permanent record of your purchase to aid identification in case of theft.

Date of Purchase		Dealer Phone No.	
Dealer Purchase from		Model No.	
Dealer Address		Serial No.	

**IF YOU NEED ADDITIONAL ASSISTANCE WITH SET-UP OR OPERATING AFTER READING OWNER'S MANUAL, PLEASE CALL TOLL FREE 1-800-242-7158 OR VISIT OUR WEB SITE AT <http://www.Symphonic.us>**

## FUNAI CORPORATION LIMITED WARRANTY

FUNAI CORP. will repair this product, free of charge in the USA in the event of defect in materials or workmanship as follows:

### DURATION:

**PARTS:** FUNAI CORP. will provide parts to replace defective parts without charge for one (1) year from the date of original retail purchase. Two (2) years for Picture Tube. Certain parts are excluded from this warranty.

### LABOR:

FUNAI CORP. will provide the labor without charge for a period of ninety (90) days from the date of original retail purchase.

### LIMITS AND EXCLUSIONS:

THIS WARRANTY IS EXTENDED ONLY TO THE ORIGINAL RETAIL PURCHASER. A PURCHASE RECEIPT OR OTHER PROOF OF ORIGINAL RETAIL PURCHASE WILL BE REQUIRED TOGETHER WITH THE PRODUCT TO OBTAIN SERVICE UNDER THIS WARRANTY.

This warranty shall not be extended to any other person or transferee.

This warranty is void and of no effect if any serial numbers on the product are altered, replaced, defaced, missing or if service was attempted by an unauthorized service center. This limited warranty does not apply to any product not purchased and used in the United States.

This warranty only covers failures due to defects in material or workmanship which occurs during normal use. It does not cover damage which occurs in shipment, or failures which are caused by repairs, alterations or product not supplied by FUNAI CORP., or damage which results from accident, misuse, abuse, mishandling, misapplication, alteration, faulty installation, improper maintenance, commercial use such as hotel, rental or office use of this product or damage which results from fire, flood, lightning or other acts of God.

THIS WARRANTY DOES NOT COVER PACKING MATERIALS, ANY ACCESSORIES (EXCEPT REMOTE CONTROL), ANY COSMETIC PARTS, COMPLETE ASSEMBLY PARTS, DEMO OR FLOOR MODELS.

FUNAI CORP. AND ITS REPRESENTATIVES OR AGENTS SHALL IN NO EVENT BE LIABLE FOR ANY GENERAL, INDIRECT OR CONSEQUENTIAL DAMAGES ARISING OUT OF OR OCCASIONED BY THE USE OF OR THE INABILITY TO USE THIS PRODUCT. THIS WARRANTY IS MADE IN LIEU OF ALL OTHER WARRANTIES, EXPRESS OR IMPLIED, AND OF ALL OTHER LIABILITIES ON THE PART OF FUNAI. ALL OTHER WARRANTIES INCLUDING THE WARRANTY OF MERCHANTABILITY AND FITNESS FOR A PARTICULAR PURPOSE, ARE HEREBY DISCLAIMED BY FUNAI AND ITS REPRESENTATIVES IN THE UNITED STATES.

ALL WARRANTY INSPECTIONS AND REPAIRS MUST BE PERFORMED BY AN AUTHORIZED SERVICE CENTER. THIS WARRANTY IS ONLY VALID WHEN THE UNIT IS CARRIED-IN TO AN AUTHORIZED SERVICE CENTER.

THE PRODUCT MUST BE ACCOMPANIED BY A COPY OF THE ORIGINAL RETAIL PURCHASE RECEIPT. IF NO PROOF OF PURCHASE IS ATTACHED, THE WARRANTY WILL NOT BE HONORED AND REPAIRS COSTS WILL BE CHARGED.

### IMPORTANT:

THIS LIMITED WARRANTY GIVES YOU SPECIFIC LEGAL RIGHTS. YOU MAY HAVE OTHER RIGHTS THAT VARY FROM STATE TO STATE. IF, AT ANY TIME DURING THE WARRANTY PERIOD, YOU ARE UNABLE TO OBTAIN SATISFACTION WITH THE REPAIR OF THIS PRODUCT, PLEASE CONTACT FUNAI CORP.

### ATTENTION:

FUNAI CORP. RESERVES THE RIGHT TO MODIFY ANY DESIGN OF THIS PRODUCT WITHOUT PRIOR NOTICE.

### WARRANTY STATEMENT REGARDING NON AUTHORIZED REPAIRS:

To obtain warranty service, you must take the product, or deliver the product freight prepaid, in either its original packaging or packaging affording an equal degree of protection, to any AUTHORIZED SERVICE CENTER. FUNAI CORP. will not reimburse you for any service done by unauthorized service providers without prior written approval.

To locate your nearest AUTHORIZED SERVICE CENTER or for general service inquiries, please contact us at :

FUNAI CORPORATION  
Customer Service  
Tel :1-800-242-7158  
<http://www.Symphonic.us>

19900 Van Ness Avenue, Torrance, CA 90501

1EMN21761

Printed in Malaysia  
L4000UA \* \* \* \* \*

## IMPORTANT SAFEGUARDS

### WARNING:

TO REDUCE THE RISK OF FIRE OR ELECTRIC SHOCK, DO NOT EXPOSE THIS APPLIANCE TO RAIN OR MOISTURE.



**CAUTION:** TO REDUCE THE RISK OF ELECTRIC SHOCK, DO NOT REMOVE COVER (OR BACK) NO USER SERVICEABLE PARTS INSIDE. REFER SERVICING TO QUALIFIED SERVICE PERSONNEL.

The important note is located on the rear of the cabinet.

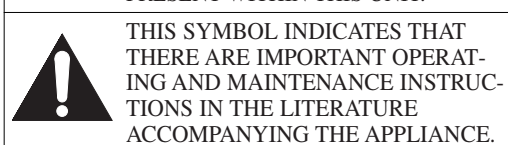
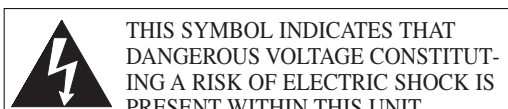

1. **READ INSTRUCTIONS** - All the safety and operating instructions should be read before the appliance is operated.
2. **RETAIN INSTRUCTIONS** - The safety and operating instructions should be retained for future reference.
3. **HEED WARNINGS** - All warnings on the appliance and in the operating instructions should be adhered to.
4. **FOLLOW INSTRUCTIONS** - All operating and use instructions should be followed.
5. **CLEANING** - Unplug TV from the wall outlet before cleaning. Do not use liquid cleaners or aerosol cleaners. Use a damp cloth for cleaning.  
**EXCEPTION:** A product that is meant for uninterrupted service and, that for some specific reason, such as the possibility of the loss of an authorization code for a CATV converter, is not intended to be unplugged by the user for cleaning or any other purpose, may exclude the reference to unplugging the appliance in the cleaning description otherwise required in item 5.
6. **ATTACHMENTS** - Do not use attachments not recommended by the TV manufacturer as they may cause hazards.
7. **WATER AND MOISTURE** - Do not use this TV near water, for example, near a bath tub, wash bowl, kitchen sink, or laundry tub, in a wet basement, or near a swimming pool, and the like.
8. **ACCESSORIES** - Do not place this TV on an unstable cart, stand, tripod, bracket, or table. The TV may fall, causing serious injury to someone, and serious damage to the appliance. Use only with a cart, stand, tripod, bracket, or table recommended by the manufacturer, or sold with the TV.  
Any mounting of the appliance should follow the manufacturer's instructions and should use a mounting accessory recommended by the manufacturer. An appliance and cart combination should be moved with care. Quick stops, excessive force, and uneven surfaces may cause the appliance and cart combination to overturn.

**AMEUBLES** - Cet appareil ne doit être placé que sur un meuble (avec ou sans roulettes) recommandé par le fabricant. Si vous l'installez sur un meuble à roulettes, déplacez les deux ensembles avec précaution. Un arrêt brusque, l'utilisation d'une force excessive et des surfaces irrégulières risquent de déstabiliser l'ensemble et de le renverser.

9. **VENTILATION** - Slots and openings in the cabinet and the back or bottom are provided for ventilation and to ensure reliable operation of the TV and to protect it from overheating, these openings must not be blocked or covered. The openings should never be blocked by placing the TV on a bed, sofa, rug, or other similar surface. This TV should never be placed near or over a radiator or heat register. This TV should not be placed in a built-in installation such as a bookcase or rack unless proper ventilation is provided or the manufacturer's instructions have been adhered to.
10. **POWER SOURCES** - This TV should be operated only from the type of power source indicated on the marking label. If you are not sure of the type of power supply to your home, consult your appliance dealer or local power company. For TVs intended to operate from battery power, or other sources, refer to the operating instructions.
11. **GROUNDING OR POLARIZATION** - This TV is equipped with a polarized alternating-current line plug (a plug having one blade wider than the other). This plug will fit into the power outlet only one way. This is a safety feature. If you are unable to insert the plug fully into the outlet, try reversing the plug. If the plug should still fail to fit, contact your electrician to replace your obsolete outlet. Do not defeat the safety purpose of the polarized plug.
12. **POWER-CORD PROTECTION** - Power-supply cords should be routed so that they are not likely to be walked on or pinched by items placed upon or against them, paying particular attention to cords at plugs, convenience receptacles, and the point where they exit from the appliance.

13. **OUTDOOR ANTENNA GROUNDING** - If an outside antenna or cable system is connected to the TV, be sure the antenna or cable system is grounded so as to provide some protection against voltage surges and built-up static charges. Article 810 of the National Electrical Code, ANSI/NFPA No. 70, provides information with respect to proper grounding of the mast and supporting structure, grounding of the lead-in wire to an antenna discharge unit, size of grounding conductors, location of antenna-discharge unit, connection to grounding electrodes, and requirements for the grounding electrode. (Fig. A)
14. **LIGHTNING** - For added protection for this TV receiver during a lightning storm, or when it is left unattended and unused for long periods of time, unplug it from the wall outlet and disconnect the antenna or cable system. This will prevent damage to the TV due to lightning and power-line surges.
15. **POWER LINES** - An outside antenna system should not be located in the vicinity of overhead power lines or other electric light of power circuits, or where it can fall into such power lines or circuits. When installing an outside antenna system, extreme care should be taken to keep from touching such power lines or circuits as contact with them might be fatal.
16. **OVERLOADING** - Do not overload wall outlets and extension cords as this can result in a risk of fire or electric shock.
17. **OBJECT AND LIQUID ENTRY** - Never push objects of any kind into this TV through openings as they may touch dangerous voltage points or short out parts that could result in a fire or electric shock. Never spill liquid of any kind on the TV.
18. **SERVICING** - Do not attempt to service this TV yourself as opening or removing covers may expose you to dangerous voltage or other hazards. Refer all servicing to qualified service personnel.
19. **DAMAGE REQUIRING SERVICE** - Unplug this TV from the wall outlet and refer servicing to qualified service personnel under the following conditions:
  - a. When the power supply cord or plug is damaged or frayed.
  - b. If liquid has been spilled, or objects have fallen into the TV.
  - c. If the TV has been exposed to rain or water.
  - d. If the TV does not operate normally by following the operating instructions. Adjust only those controls that are covered by the operating instructions, as improper adjustment of other controls may result in damage and will often require extensive work by a qualified technician to restore the TV to its normal operation.
  - e. If the TV has been dropped or damaged in any way.
  - f. When the TV exhibits a distinct change in performance, this indicates a need for service.
20. **REPLACEMENT PARTS** - When replacement parts are required, be sure the service technician uses replacement parts specified by the manufacturer that have the same characteristics as the original part. Unauthorized substitutions may result in fire, electric shock, injury to persons or other hazards.
21. **SAFETY CHECK** - Upon completion of any service or repairs to this TV, ask the service technician to perform routine safety checks to determine that the TV is in proper operating condition.
22. **HEAT** - This TV product should be situated away from heat sources such as radiators, heat registers, stoves, or other products (including amplifiers) that produce heat.

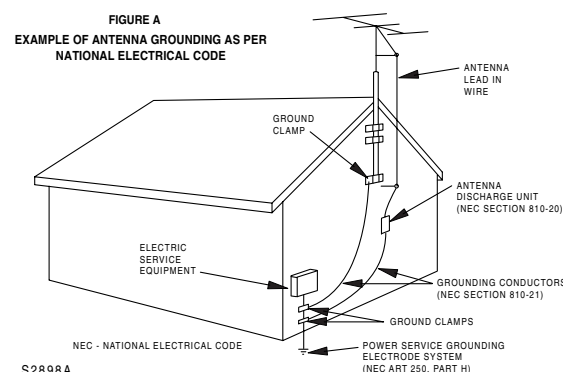

**FCC WARNING** - This equipment may generate or use radio frequency energy. Changes or modifications to this equipment may cause harmful interference unless the modifications are expressly approved in the instruction manual. The user could lose the authority to operate this equipment if an unauthorized change or modification is made.

### Note to CATV system installer:

This reminder is provided to call the CATV system installer's attention to Article 820-40 of the NEC that provides guidelines for proper grounding and, in particular, specifies that the cable ground shall be connected to the grounding system of the building as close to the point of cable entry as practical.

# PREPARATION FOR USE

## CONNECTIONS

Plug the incoming cable into the ANT. IN jack on the rear of the TV.

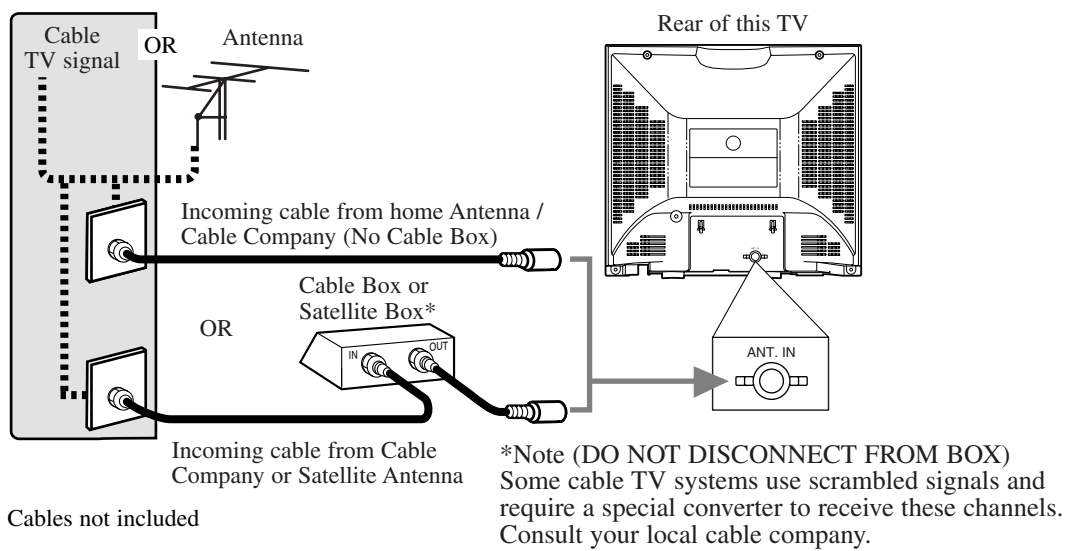

**CAUTION: TO PREVENT ELECTRIC SHOCK, MATCH WIDE BLADE OF PLUG TO WIDE SLOT, FULLY INSERT.**

**ATTENTION: POUR ÉVITER LES CHOCS ÉLECTRIQUES, INTRODUIRE LA LAME LA PLUS LARGE DE LA FICHE DANS LA BORNE CORRESPONDANTE DE LA PRISE ET POUSSER JUSQU'AU FOND.**

### Note:

- For your safety and to avoid damages to the unit, unplug the antenna cable from the ANT. IN jack before moving the unit.

## [EXTERNAL CONNECTION]

Front AUDIO/VIDEO input

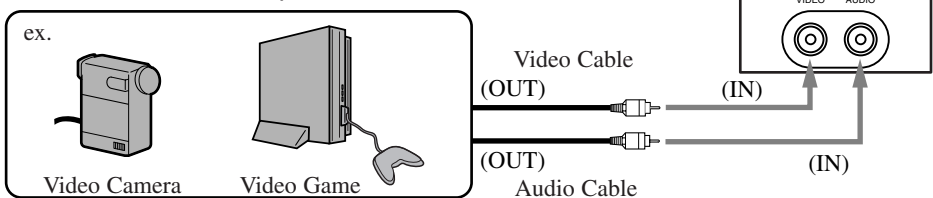

## INSTALLING THE BATTERIES

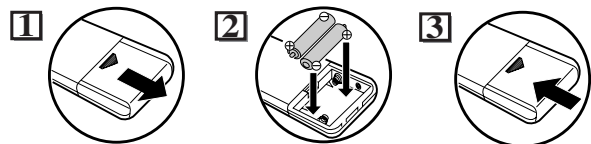

Install two AA batteries (supplied) matching the polarity indicated inside battery compartment of the remote control.

## [BATTERY PRECAUTIONS]

- Be sure to follow the correct polarity as indicated in the battery compartment. Reversed batteries may cause damage to the device.
- Do not mix different types of batteries together (e.g. Alkaline and Carbon-Zinc) or old batteries with fresh ones.
- If the device is not to be used for a long period of time, remove the batteries to prevent damage or injury from possible battery leakage.
- Do not try to recharge batteries not intended to be recharged; they can overheat and rupture.

## INITIAL SETUP

When you turn on the power for the first time, the "SELECT LANGUAGE" menu is displayed. The "INITIAL SETUP" menu is displayed every time you turn on the unit unless the scanning is completed.

**1** Select the desired language according to the screen indication. After that, the TV performs "AUTO PRESET CH" to scan channels available for the broadcasting in your area.

SELECT LANGUAGE  
ENGLISH NEXT:PRESS CH▲  
ESPAÑOL DESPUES:PRESSIONE CH▼  
FRANÇAIS APRES:PRESSEZ VOL▲

— INITIAL SETUP —  
PLEASE CONNECT ANTENNA OR CABLE OR SATELLITE TO THIS UNIT. THEN PRESS CH ▲, IN ORDER TO PERFORM "AUTO PRESET CH".

**2** If the TV screen shows snow noise and there is no operation for more than 10 seconds, "HELPFUL HINTS" appears. Follow the instructions listed on the screen.

- HELPFUL HINTS -  
1. PLEASE CHECK TO SEE IF THE ANTENNA/CABLE/SATELLITE IS PROPERLY CONNECTED.  
2. DID YOU PERFORM "AUTO PRESET CH"?  
3. PLEASE REFER TO FRONT PAGE OF THE OWNER'S MANUAL OR REAR PANEL FOR SUPPORT LINE INFORMATION.

When the scanning is completed, or [MENU] is pressed during channel scanning to cancel it, the tuner stops on the lowest memorized channel.

### Notes:

- In case no channel can be received by the channel scanning, "NO TV SIGNALS" is displayed on the screen. Turn off the unit and check the antenna connection, then follow step 1 again.
- If those settings do not work properly, please call our help line on the front page of this owner's manual.

## SELECTING AUDIO/VIDEO INPUT

You can select external input jacks by pressing [GAME] on the remote control.

**1** To use external input

Picture: GAME (ON)  
Input: External

**2** To return to TV channel

15

In the Game mode, you can use front input jacks with suitable picture adjustments for video games.

### Notes:

- If you press [GAME] when the TV is off, the TV turns on and enters in Game mode.
- If you adjust another picture control while in Game mode, this mode will automatically be canceled.

You can enter into Video mode from Game mode by adjusting a Picture control.

**1** To use external input

Picture: GAME (ON)  
Input: External

**2** To cancel Game mode only

Select "PICTURE"

After 10 seconds

Picture: Customized  
Input: External

**3** To return to TV channel

2 times

15

# OPERATIONS

## REMOTE CONTROL AND FRONT PANEL FUNCTION

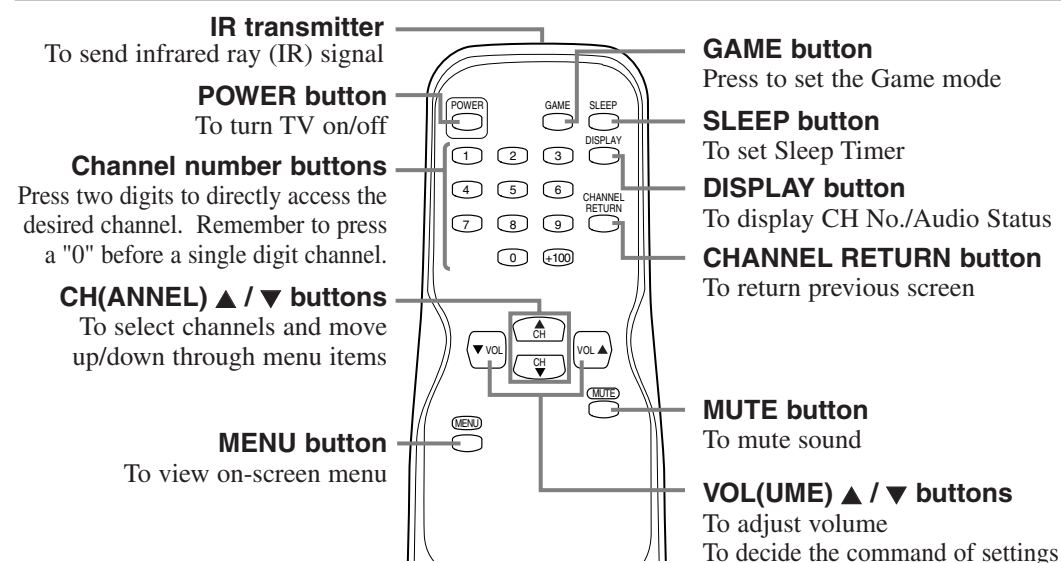

### Note:

- You can test if the remote control sends out the infrared signal with an AM radio. (Refer to "TROUBLESHOOTING GUIDE".)

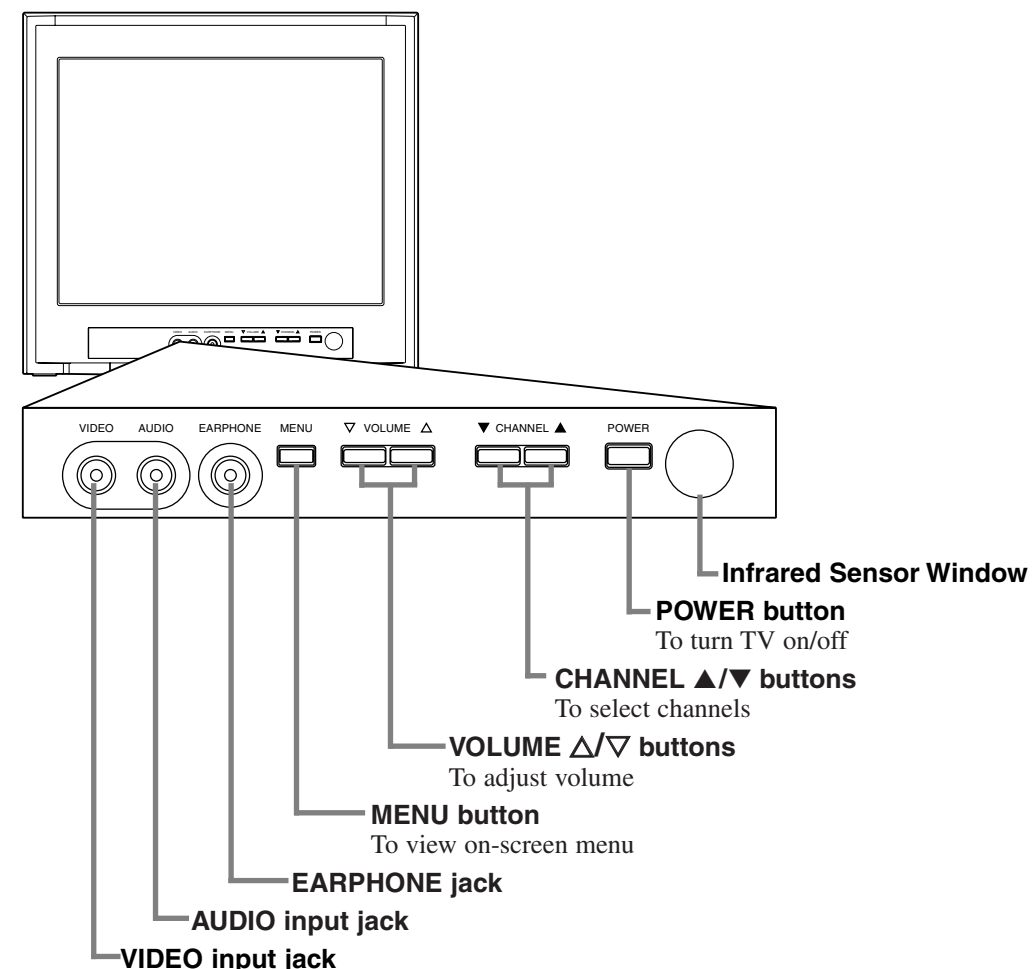

### Note:

- If some digits appear in the corner of the screen when the unit is turned on for the first time, press [POWER] without unplugging the power cord.

# OPERATIONS (Continued)

## CHANNEL SETTING

### [AUTO PRESET CHANNELS]

As the initial setting, this TV has memorized all channels, including the ones not available in your area. This feature automatically puts only available channels into the memory.

**1** Select "CHANNEL SET"

PICTURE CHANNEL SET [ENG] / ESP / FRA V-CHIP SET UP CAPTION [OFF]

**2** Select "AUTO PRESET CH"

ADD/DELETE AUTO PRESET CH

The tuner scans and memorizes all available channels in your area.

**3** When the scanning is completed, the lowest memorized channel appears on the TV screen.

#### Notes:

- The TV distinguishes between standard TV channels and cable (CATV) channels.
- The TV may recognize TV channels as CATV channels if reception condition is poor. If this happens, check the antenna connections and try steps **2** to **3** again when reception conditions are better.
- If there is no TV signal input, "NO TV SIGNALS" will appear on the display after the completion of channel scanning.

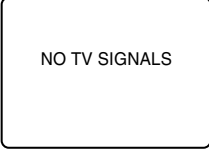

### [ADDING/DELETING CHANNELS]

You can add or delete channels manually.

**1** Select "CHANNEL SET"

PICTURE CHANNEL SET [ENG] / ESP / FRA V-CHIP SET UP CAPTION [OFF]

**2** Select "ADD/DELETE"

ADD/DELETE AUTO PRESET CH

**3** Select the channel you wish

OR

**4** Add or delete the channel

ADD/DELETE

Add: light blue  
Delete: light red

#### Note:

- The menu will disappear automatically after about 10 seconds.

## CLOSED CAPTION

You may view specially labeled (cc) TV programs, movies, news and prerecorded tapes, etc. with either a dialogue caption or text display added to the program.

**1** Select "CAPTION"

PICTURE CHANNEL SET [ENG] / ESP / FRA V-CHIP SET UP CAPTION [OFF]

### [CAPTION MODE (C1, C2)]

- CAPTION1 (C1)** displays standard closed captions (what a character is saying).
- CAPTION2 (C2)** displays foreign language closed captions (foreign language words showing what a character is saying).
- There are three ways of displaying according to programs:
  - Paint-on mode:** Displays input characters on the screen immediately.
  - Pop-on mode:** Once characters are stored in memory, they are displayed all at once.
  - Roll-up mode:** Displays the characters continuously by scrolling (max. 4 lines).

### [TEXT MODE (T1, T2)]

- TEXT1 (T1)** and **TEXT2 (T2)** display half-screen text by scrolling (such as a channel guide, schedule or announcement).

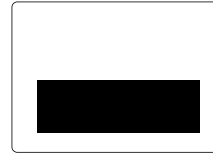

### **2** Select the desired caption mode

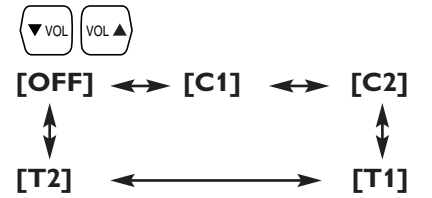

### **3** To exit the menu



#### Notes:

- If closed captioning is not broadcasted, you cannot receive it and nothing is displayed.
- When your TV receives a special effects playback signal (i.e., Search, Slow and Still) from a VCR's video output channel (CH3 or CH4), the TV may not display the correct caption or text.
- Captions and texts may not match the TV voice exactly.
- Interference may cause the closed caption system not to function properly.
- The caption or text characters will not be displayed while the menu display or functions display is shown.
- If a black box appears on the screen, this means that the TV is set to TEXT mode. To clear screen, select CAPTION [C1], [C2] or [OFF].

## SLEEP TIMER SETTING

**1**

SLEEP 0

**2**

SLEEP 10

The time increases by 10 minutes up to 90.

#### Notes:

- When you disconnect the unit from the AC outlet or when you have a power failure, the sleep time will be lost.
- To cancel the sleep timer, press [SLEEP] repeatedly until "SLEEP 0" is displayed.
- The Sleep Timer Setting display will disappear automatically after 10 seconds of the operation.

## OPTIONAL SETTINGS

### LANGUAGE SELECTION

**1** Select "[ENG]/ESP/FRA"

PICTURE CHANNEL SET [ENG] / ESP / FRA V-CHIP SET UP CAPTION [OFF]

### **2** Select the desired language

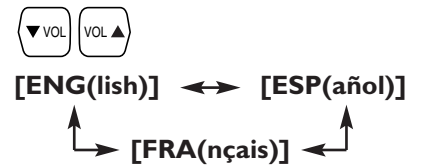

### **3** To exit the menu



## PICTURE ADJUSTMENT

**1** Select "PICTURE"

PICTURE CHANNEL SET [ENG] / ESP / FRA V-CHIP SET UP CAPTION [OFF]

**2** Select an item to adjust

[GAME MODE] ↔ [BRIGHT] ↔ [CONTRAST]  
↕  
[SHARPNESS] ↔ [TINT] ↔ [COLOR]

**3** Adjust the setting

[+] BRIGHT [-]

### GAME MODE

Set to the most suitable position for video games.

[-] : OFF                      [+] : ON

### BRIGHT

Adjust until the darkest parts of the picture are as bright as you prefer.

[-] : decrease brightness

[+] : increase brightness

### CONTRAST

Adjust to increase or decrease contrast.

[-] : decrease contrast

[+] : increase contrast

### COLOR

Adjust to be brilliant or pale color.

[-] : be pale color            [+] : be brilliant color

### TINT

Adjust to obtain natural skin tones.

[-] : add red                      [+] : add green

### SHARPNESS

Adjust the detail of the picture.

[-] : less clear                      [+] : more clearer

#### Notes:

- The display will disappear automatically after 10 seconds unless you press any buttons.
- Magnetism from nearby appliances and speakers might affect the color of the TV picture. If this happens, press [POWER] to turn off the TV and turn it on again after about 30 minutes.

# OPTIONAL SETTINGS (Continued)

## V-CHIP SET UP

This enables parents to prevent their children from watching inappropriate material on TV.

- The limitation is not available for news, sports programs, unedited movies on premium cable channels and Emergency Broadcast System signals.
- When you try to access to a program which is blocked, "PROTECTED PROGRAM by ..." message appears on the TV screen.
- Programming may be rated by the Motion Picture Association of America (MPAA) or according to the Television Parental Guidelines. In order to block any inappropriate programming, set your limits in both MPAA RATING and TV RATING.

**1** Select "V-CHIP SET UP"

PICTURE CHANNEL SET [ENG] / ESP / FRA  
V-CHIP SET UP CAPTION [OFF]

**2** Enter 4-digit access code. If you have not set up your personal access code, enter 0000 (default access code).

ACCESS CODE [ ] [ ] [ ] [ ]

**3** Press [CH ▲ / ▼] to select "TV RATING", "MPAA RATING" or "CHANGE CODE", then press [VOL ▲].

TV RATING [A]  
MPAA RATING [B]  
CHANGE CODE [C]

## A [TV RATING SET UP]

**4** Select a rating

TV-Y [VIEW]  
TV-Y7 ( ) [VIEW]  
TV-G [VIEW]  
TV-PG ( ) [VIEW]  
TV-14 ( ) [VIEW]  
TV-MA ( ) [VIEW]

<Selection> <Rating Category Explanations>

- TV-Y : Appropriate for all children
- TV-Y7 : Appropriate for children seven and older
- TV-G : General Audience
- TV-PG : Parental Guidance suggested
- TV-14 : Unsuitable for children under 14
- TV-MA : Mature audience only

**5-1** \* Rating with no sub categories  
Set to [BLOCK] or [VIEW]

TV-Y [VIEW]  
TV-Y7 ( ) [VIEW]  
TV-G [BLOCK]  
TV-PG (DLSV) [BLOCK]  
TV-14 (DLSV) [BLOCK]  
TV-MA ( LSV) [BLOCK]

**5-2** \* Rating with sub categories

2 times

Select a rating

Sub categories

TV-PG [BLOCK]  
D [BLOCK]  
L [BLOCK]  
S [BLOCK]  
V [BLOCK]

Set to [BLOCK] or [VIEW]

TV-PG [BLOCK]  
D [VIEW]  
L [BLOCK]  
S [BLOCK]  
V [BLOCK]

<Selection> <Rating Category Explanations>

- TV-Y7  
FV : Fantasy Violence
- TV-PG / TV-14 / TV-MA :  
D : Suggestive Dialog (TV-PG, TV-14 only)
- L : Coarse Language
- S : Sexual Situation
- V : Violence

**6** To exit the menu

## B [MPAA RATING SET UP]

**4** Select a rating

G [VIEW]  
PG [VIEW]  
PG-13 [VIEW]  
R [VIEW]  
NC-17 [VIEW]  
X [VIEW]

**5** Set to [BLOCK] or [VIEW]

repeatedly

G [VIEW]  
PG [VIEW]  
PG-13 [VIEW]  
R [BLOCK]  
NC-17 [BLOCK]  
X [BLOCK]

<Selection> <Rating Category Explanations>

- G : General Audience
- PG : Parental Guidance suggested
- PG-13 : Unsuitable for children under 13
- R : Restricted; under 17 requires accompanying parent or adult guardian
- NC-17 : No one under 17 admitted
- X : Mature audience only

**6** To exit the menu

## Notes (for TV RATING and MPAA RATING):

- You cannot access the setup menu when the "PROTECTED PROGRAM by ..." message appears. Move to an unblocked channel before you press [MENU].
- When you select a rating and set it to [BLOCK], the higher ratings will be blocked automatically. The lower ratings will be available for viewing.
- When you set "X" or "TV-MA" to [VIEW], all ratings turn to [VIEW] automatically.

## C [CHANGING THE ACCESS CODE]

**4** Enter 4-digit code.

NEW CODE [X][X][X][X]  
CONFIRM CODE [ ] [ ] [ ] [ ]

**5** To exit the menu

**Notes:**

- Make sure you enter exactly the same new code in the "NEW CODE" space as one in the "CONFIRM CODE" space. If they are different, the "NEW CODE" space is cleared for redoing.
- Your personal access code will be erased and will return to the default (0000) when a power failure occurs or when you turn off the power using a wall switch. If you have forgotten the code, unplug the power cord for 10 seconds to restore the access code to 0000.

# TROUBLESHOOTING GUIDE

Sometimes a performance problem can be easily solved by checking seemingly apparent but often overlooked possibilities. Before arranging for service, check these items. It could save your time and money.

QUICK SERVICE CHECK LIST	PROBLEM													
	Remote Control Doesn't Work	Bars On Screen	Picture Distorted	Picture Rolls Vertically	No Color	Poor Reception on Some Channels	Weak Picture	Lines or Streaks in Picture	Ghosts in Picture	Picture Blurred	Sound OK, Picture Poor	Picture OK, Sound Poor	No Picture or Sound	Different color marks on screen
Try a new channel, if OK, then possible station trouble.			X	X	X	X	X	X	X	X	X	X	X	X
Is TV plugged in? Power at outlet?	X													X
Is TV's power on?														X
Is antenna or cable connected to terminal on the back of the set?					X	X	X	X	X	X	X	X	X	X
If outside antenna is being used, check for broken wire or loose connection.	X	X	X	X	X	X	X	X	X	X	X	X	X	X
Check for local interference.	X	X	X	X	X	X	X	X	X	X	X	X	X	X
Turn off the TV and then turn it on after about a minute.														X
Adjust COLOR control.					X									
Adjust CONTRAST & BRIGHT control.										X				
Check batteries in remote control.	X													
Move the TV away from the nearby appliances which generate a magnetic field. Turn off using [POWER], then turn it on again 30 minutes later or so.														X
Check if there is an obstacle between the sensor and the remote control.	X													
Test the signal output.* If OK, then possible remote sensor trouble.	X													

\*Additional Remote Test  
Tune an AM radio to a band with no broadcasting. Press a button on the remote control toward the radio. Sound will be fluttering when you press any key and the radio receives the signal. This means the remote control unit is working.

Closed Caption Problem	Possible Remedy
Misspelled captions are shown.	Spelling errors may pass through uncorrected by the closed captioning production company in a live broadcast.
Text is not shown in its entirety or there is a delay of what is being said.	Captions that are delayed a few seconds behind the actual dialogue are common for live broadcasts. Most captioning production companies can display a dialogue to a maximum of 220 words per minute. If a dialogue exceeds that rate, selective editing is used to insure that the captions remain up-to-date with the current TV screen dialogue.
Captions are scrambled with white boxes on the TV screen.	Interference caused by building, power lines, thunderstorms, etc. may cause scrambled or incomplete captions to appear.
No captions are displayed in a program which must contain closed caption.	Broadcasters may use a time compression process to the actual program so that additional advertising time can be given. In this case, captions will be lost since the decoder cannot read the compressed information.
No captions are displayed when playing a prerecorded videotape with closed caption.	The videotape may be either an illegal copy or the tape duplicating company may accidentally have left out the captioning signals during the copying process.
The TV screen shows a black box.	You are in TEXT mode. Select CAPTION [C1], [C2] or [OFF].

# MAINTENANCE

## CABINET CLEANING

- Wipe the front panel and other exterior surfaces of the TV with a soft cloth immersed in lukewarm water and wrung dry.
- Never use a solvent or alcohol. Do not spray insecticide liquid near the TV. Such chemicals may cause damage and discoloration to the exposed surfaces.

## PICTURE TUBE CLEANING

Wipe the picture tube of the TV with a soft cloth. Before cleaning the picture tube, disconnect the power cord.

# SUPPLIED ACCESSORIES

- Owner's Manual (1EMN21761)
- Remote control unit (NE121UE)
- Batteries ("AA" x 2)

# SPECIFICATIONS

## GENERAL SPECIFICATIONS

Television system:	NTSC-M TV Standard
Closed Caption System:	§15.119/FCC
Channel coverage	VHF: 2 - 13 UHF: 14 - 69 CATV: 2 - 13, A - W, W+1 - W+84, A-5 - A-1, 5A
Tuning System:	181 channels frequency synthesized tuning system
Channel access:	Direct access keyboard, programmable scan and up/down
Terminals	
Antenna input:	VHF/UHF/CATV 75 ohm unbalanced (F-type)
Video input:	RCA connector x 1 (1 x Front)
Audio input:	RCA connector x 1 (1 x Front)
Earphone:	1/8" monaural (3.5mm)
1 speaker	

## ELECTRICAL SPECIFICATIONS

Sound output: 1W, 8 ohm x 1

## OTHER SPECIFICATIONS

Remote control:	Digital encoded infrared light system
Operating temperature:	5°C to 40°C (41°F - 104°F)
Power requirements:	AC120V, 60Hz
Power consumption (Maximum):	55W
Picture tube:	14"
Dimensions:	H : 12-15/16" (329mm) W : 14-1/8" (358mm) D : 15-1/8" (384.5mm)
Weight:	23.1 lbs. (10.5kg)

- Designs and specifications are subject to change without notice and without our legal obligation.
- If there is a discrepancy between languages, the default language will be English.



# PREPARATIVOS PARA EL USO

## CONEXIONES

Enchufe el cable de entrada en la toma ANT. IN atrás de la unidad.

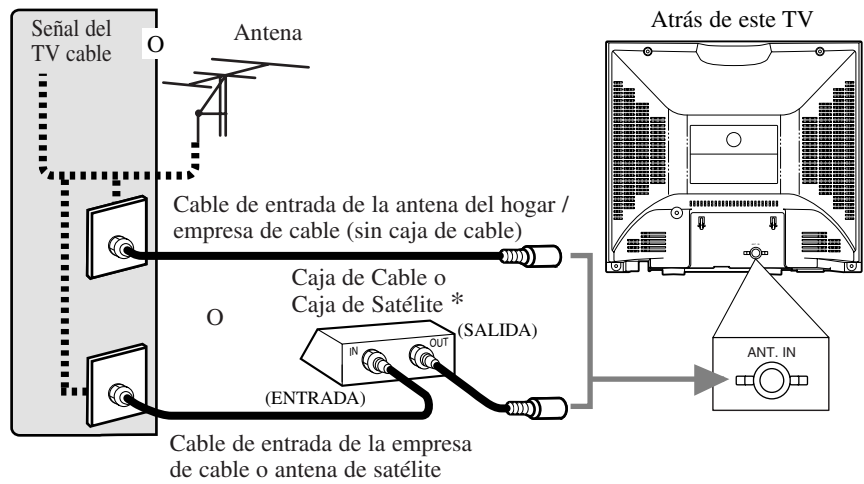

Cable bifilar plano

\*Nota (NO DESCONECTAR DE LA CAJA DE CABLE)  
Algunos sistemas de TV por cable utilizan señales codificadas y requieren un convertidor especial para recibir estos canales. Consulte con su empresa de cable local.

**PRECAUCIÓN:** PARA IMPEDIR DESCARGAS ELÉCTRICAS, INTRODUZCA LA PATILLA ANCHA EN LA RANURA ANCHA E INSERTE A FONDO LA CLAVIJA.

### NOTA:

- Para su seguridad y para evitar que se dañe la unidad, desenchufe el cable de antena de la toma ANT. IN antes de mover la unidad.

### [CONEXIÓN EXTERNA]

Entrada AUDIO/VIDEO frontales

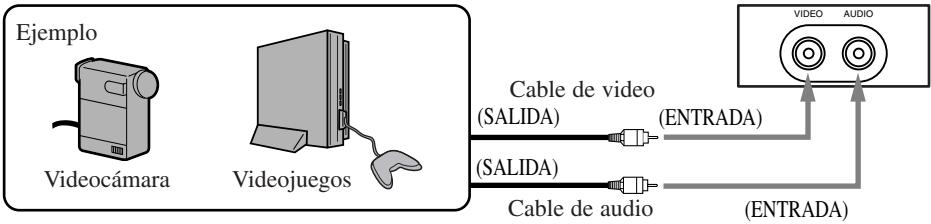

## INSTALACION DE LAS PILAS

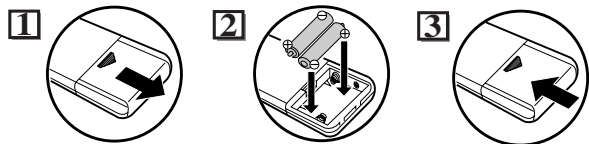

Instale dos pilas AA (incluidas) de tal forma que coincida la polaridad dentro de compartimiento de pilas del mando a distancia.

### [PRECAUCIONES CON LAS PILAS]

- Asegúrese de cumplir con la polaridad correcta tal como se indica en el compartimiento de pilas. Una polaridad invertida puede dañar el equipo.
- No mezcle distintos tipos de pilas entre sí (por ejemplo: alcalinas y carbono-zinc) o pilas viejas y nuevas.
- Si el equipo no se va a utilizar durante mucho tiempo, saque las pilas para evitar daño o herida por posible fuga de la pila.
- No trate de recargar pilas no diseñadas para recarga; pueden calentarse excesivamente y romperse.

## PREPARACIÓN INICIAL

Quando se enciende la unidad por primera vez, se muestra la pantalla de "SELECT LANGUAGE". El menú de "INSTALACIÓN INICIAL" se muestra cada vez que encienda la unidad a menos que la exploración haya finalizado.

**1** Seleccione el idioma deseado según lo indicado en la pantalla. Después de eso, el TV realiza "PREA. AUTO CA." para explorar los canales disponibles para emisión en su zona.

**2** Si la pantalla del TV muestra "interferencias de nieve" y no funciona bien durante más de 10 segundos, aparecerá "SUGERENCIAS ÚTILES". Siga las instrucciones de la pantalla.

Al finalizar la exploración, o cuando se presiona el botón [MENU] durante la exploración de canales para cancelarla, el sintonizador se detiene en el canal memorizado más bajo.

- Notas:**
- En caso de que no pueda recibirse ningún canal mediante la exploración de canales, "NO HAY SEÑAL DE TV" aparece en pantalla. Apague la unidad y compruebe la conexión de la antena; a continuación, aplique otra vez el paso 1.
  - Si este ajuste no funciona correctamente, llame a nuestro teléfono de asistencia (en la portada en este manual del usuario).

## SELECCION DE LA ENTRADA AUDIO/VIDEO

Puede seleccionar tomas de entrada externa presionando [GAME] en el mando a distancia.

**1** Para utilizar la entrada externa

Imagen: GAME (ON)  
Entrada: Externa

**2** Para volver al canal de TV

En el modo Game, puede utilizar las tomas de entrada frontales con ajustes de imagen adecuados para videojuegos.

- Notas:**
- Si presiona [GAME] cuando el TV está apagado, el TV se enciende y entra en el modo Game.
  - Si ajusta otro control de imagen cuando está en el modo Game, este modo se cancelará automáticamente.

Puede entrar en el modo de video el modo Game ajustando un control de imagen.

**1** Para utilizar la entrada externa

Imagen: GAME (ON)  
Entrada: Externa

**2** Para cancelar sólo el modo Game

Imagen: Personalizada  
Entrada: Externa

**3** Para volver al canal de TV

Imagen: Personalizada  
Entrada: Externa

# OPERACIONES

## FUNCIONES DEL MANDO A DISTANCIA Y PANEL FRONTAL

**Transmisor de infrarrojos**  
Para enviar una señal de rayos infrarrojos

**Botón POWER**  
Para encender/apagar el TV

**Botones de número de canal**  
Pulse dos dígitos para acceder directamente al canal deseado. Recuerde pulsar "0" antes de pulsar el número de un canal de un solo dígito.

**Botones CH(ANNEL) ▲ / ▼**  
Para seleccionar los canales y desplazarse hacia arriba y abajo a través de los elementos de los menús

**Botón MENU**  
Para visualizar el menú en la pantalla

**Botón GAME**  
Púlselo para seleccionar el modo de juegos

**Botón SLEEP**  
Para ajustar el Temporizador para dormir

**Botón DISPLAY**  
Para mostrar el estado de N° CA/audio

**Botón CHANNEL RETURN**  
Para volver a la pantalla anterior

**Botón MUTE**  
Suprime la salida de sonido

**Botones VOL(UME) ▲ / ▼**  
Para ajustar el volumen  
Para decidir los comandos de ajuste

### Nota:

- Haga una prueba para confirmar que el mando a distancia envía una señal de infrarrojos con una radio AM. (Consulte "GUÍA DE LOCALIZACION DE PROBLEMAS".)

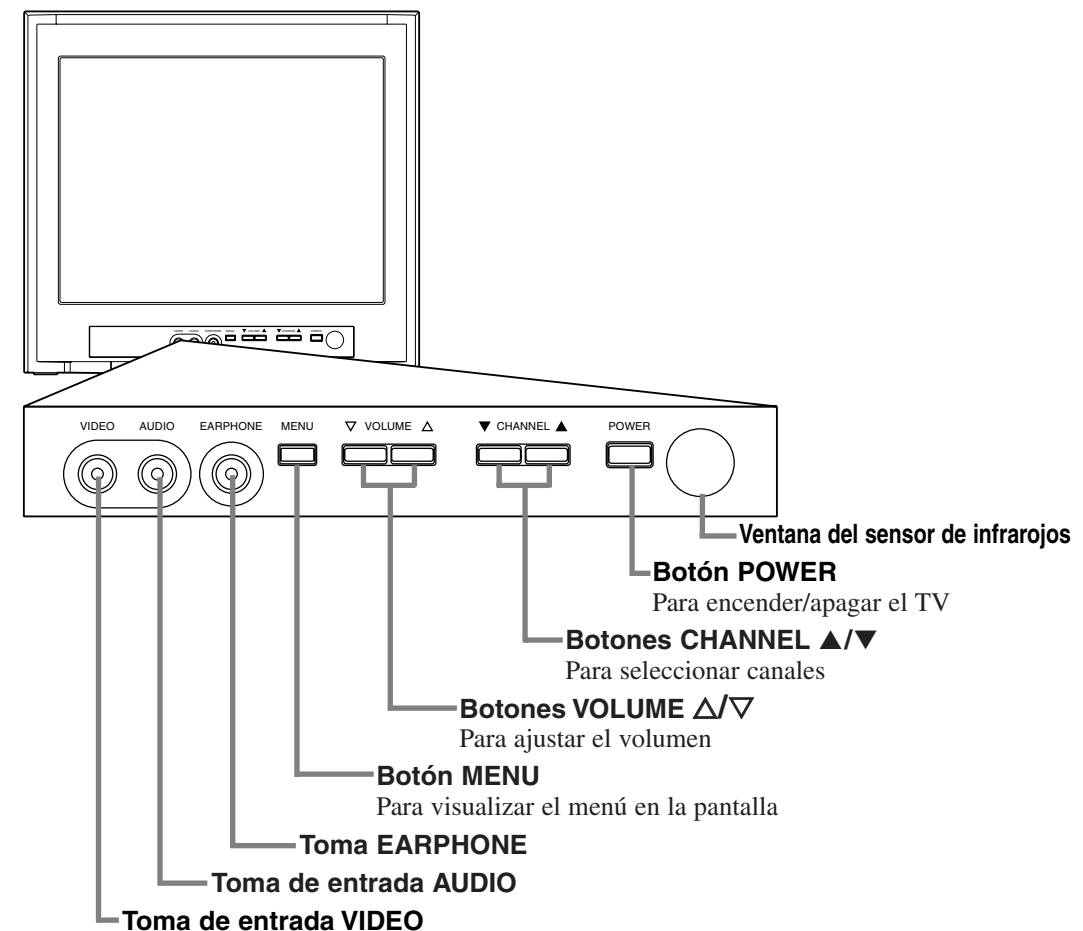

### Nota:

- Si aparecen algunas cifras en la esquina de la pantalla cuando se enciende la unidad por primera vez, presione [POWER] sin desenchufar el cable eléctrico.

# OPERACIONES (continúa)

## AJUSTE DE CANAL

### [PREAJUSTE AUTO DE CANALES]

Como el ajuste inicial, todos canales están memorizados en este TV, incluyendo los canales no disponibles en su área. Esta función puede poner los canales sólo disponibles en la memoria.

**1** Seleccione "CANAL PREP."

IMAGEN  
CANAL PREP.  
ENG / [ESP] / FRA  
AJUSTE DE V-CHIP  
TITULO [OFF]

**2** Seleccione "PREA. AUTO CA."

AGREGAR/BORRAR  
PREA. AUTO CA.

El sintonizador barre y memoriza todos los canales existentes en su región.

**3** Cuando se completó el barrido, aparece el canal memorizado más bajo en la pantalla de TV.

**Notas:**

- El TV diferencia entre los canales de TV normales y los canales de cable (CATV).
- El TV puede reconocer los canales de TV como canales CATV si el estado de la recepción es malo. En este caso, verifique las conexiones de la antena y pruebe nuevamente los pasos 2 a 3 cuando las condiciones de la recepción sean mejores.
- Si no hay entrada de señal de TV, aparecerá "NO HAY SEÑAL DE TV" en la pantalla después de completar el barrido de canales.

NO HAY SEÑAL DE TV

### [AGREGACIÓN / BORRADO DE CANALES]

Es posible agregar o borrar los canales manualmente.

**1** Seleccione "CANAL PREP."

IMAGEN  
CANAL PREP.  
ENG / [ESP] / FRA  
AJUSTE DE V-CHIP  
TITULO [OFF]

**2** Seleccione "AGREGAR/BORRAR"

AGREGAR/BORRAR  
PREA. AUTO CA.

**3** Seleccione el canal deseado

**4** Agregue o borre el canal

Agregue: celeste  
Borre: rojo claro

**Nota:**

- El menú desaparecerá automáticamente después de 10 segundos.

## SUBTITULOS NARRATIVOS

Puede ver el programa de TV con etiqueta especial (cc), películas, noticias y cintas pregabadas, etc. con el subtítulo de diálogo o con el texto agregado al programa.

**1** Seleccione "TITULO"

IMAGEN  
CANAL PREP.  
ENG / [ESP] / FRA  
AJUSTE DE V-CHIP  
TITULO [OFF]

### [MODO DE TITULO (C1, C2)]

- TITULO1 (C1)**  
muestra subtítulos narrativos normales (qué es lo que dice un personaje).
- TITULO2 (C2)**  
muestra los subtítulos narrativos de un idioma extranjero (palabras en idioma extranjero mostrando lo que dice un personaje).
- Hay tres formas de mostrar de acuerdo con el programa:
  - Modo pintado:** Muestra inmediatamente los caracteres entrados en la pantalla.
  - Modo emergente:** Una vez memorizados los caracteres, aparecen de una vez.
  - Modo de avance:** Muestra los caracteres continuamente en un rollo (máx. 4 líneas).

### [MODO DE TEXTO (T1, T2)]

- El TEXTO1 (T1) y TEXTO2 (T2) muestran texto en media pantalla mediante rollo (como una guía de canal, programa o avisos).

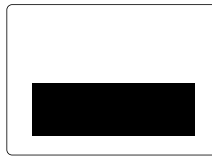

**2** Seleccione el modo de subtítulo deseado

**3** Para salir del menú

**Notas:**

- Si no se transmite el subtítulo narrativo, no lo podrá recibir y no aparecerá nada.
- Cuando su TV recibe una señal de reproducción de efectos especiales (es decir, búsqueda, cámara lenta y congelada) de un canal de salida de video de la videogradora (CA3 o CA4), el TV puede no mostrar el subtítulo o texto correcto.
- Los subtítulos y textos pueden no coincidir exactamente con la voz del TV.
- Las interferencias pueden hacer que el sistema de subtítulo narrativo no funcione correctamente.
- Los caracteres de subtítulos o texto no aparecerán mientras aparezcan las indicaciones de menú o de funciones.
- Si aparece una caja negra en la pantalla, significa que el TV está en el modo de TEXTO. Para borrar la pantalla, seleccione TITULO [C1], [C2] u [OFF].

## AJUSTE DEL TEMPORIZADOR PARA DORMIR

**1**

**2**

El tiempo aumenta en 10 minutos hasta 90.

**Notas:**

- Cuando desconecte la unidad del tomacorriente de CA o cuando tiene un corte eléctrico, se perderá el tiempo para dormir.
- Para cancelar el temporizador para dormir, presione repetidamente [SLEEP] hasta que aparezca "REPOSAR 0".
- La pantalla de ajuste del temporizador para dormir desaparecerá automáticamente después de 10 segundos del funcionamiento.

## AJUSTES OPCIONALES

### SELECCION DE IDIOMA

**1** Seleccione "ENG/[ESP]/FRA"

IMAGEN  
CANAL PREP.  
ENG / [ESP] / FRA  
AJUSTE DE V-CHIP  
TITULO [OFF]

**2** Seleccione el idioma deseado

**3** Para salir del menú

## AJUSTE DE IMAGEN

**1** Seleccione "IMAGEN"

IMAGEN  
CANAL PREP.  
ENG / [ESP] / FRA  
AJUSTE DE V-CHIP  
TITULO [OFF]

**2** Seleccione un ítem a ajustar

**3** Ajuste la selección

**MODO GAME**  
Ajuste a la posición más adecuada para videojuegos.  
[-] : OFF                      [+] : ON

**CLARIDAD**  
Ajuste hasta que las partes más oscuras de la imagen tengan el brillo preferido.  
[-] : disminuye el brillo  
[+] : aumenta el brillo

**CONTRASTE**  
Ajuste para aumentar o reducir el contraste.  
[-] : disminuye el contraste  
[+] : aumenta el contraste

**COLOR**  
Ajuste el color a brillante o pálido.  
[-] : color pálido              [+] : color brillante

**MATIZ**  
Ajuste para obtener tonos de piel naturales.  
[-] : agregue rojo              [+] : agregue verde

**AGUDEZA**  
Ajuste para ver más detalles en la imagen.  
[-] : suave                      [+] : nítido

**Notas:**

- La indicación desaparecerá automáticamente después de 10 segundos a menos que presione un botón.
- El magnetismo de aparatos cercanos y de los altavoces puede afectar el color de la imagen de TV. En este caso, presione [POWER] para apagar el TV y vuelva a encender después de unos 30 minutos.

# AJUSTES OPCIONALES (continúa)

## INSTALACION DE V-CHIP

Permite que los padres prohíban que sus hijos vean material no apto para ellos en la TV.

- La limitación no existe para las noticias, programa de deportes, películas no editadas en los canales de cable premio y las señales del sistema de transmisión de emergencia.
- Cuando intenta acceder a programas bloqueados, aparece un mensaje "PROGRAMA PROHIBIDO por ..." en la pantalla de TV.
- La programación puede tener clasificación de la Asociación Americana de Películas (MPAA) o las Guías de Padres para Televisión. Para bloquear programación no apta, ajuste sus límites de nivel para CLASE DE MPAA y CLASE DE TV.

**1** Seleccione "AJUSTE DE V-CHIP"

IMAGEN  
CANAL PREP.  
ENG / [ESP] / FRA  
▶ AJUSTE DE V-CHIP  
TITULO [OFF]

**2** Ingrese el código de acceso de 4 cifras. Si no seleccionó el código de acceso de 4 cifras, ingrese 0000 (código de acceso por omisión).

CODIGO DE ACCESO

**3** Presione [CH ▲ / ▼] para seleccionar "CLASE DE TV", "CLASE DE MPAA" o "CAMBIAR CODIGO", y presione [VOL ▲].

▶ CLASE DE TV [A]  
▶ CLASE DE MPAA [B]  
▶ CAMBIAR CODIGO [C]

## A [INSTALACION DE CLASE DE TV]

**4** Seleccione un nivel.

▶ TV-Y [MIRAR]  
TV-Y7 ( ) [MIRAR]  
TV-G [MIRAR]  
TV-PG ( ) [MIRAR]  
TV-14 ( ) [MIRAR]  
TV-MA ( ) [MIRAR]

<Selección> <Explicaciones de categoría de nivel>

- TV-Y : Apto para todos los niños
- TV-Y7 : Apto para niños mayores de 7 años
- TV-G : Auditorio general
- TV-PG : Se sugiere Guía de Padres
- TV-14 : No apto para niños de menos de 14 años
- TV-MA : Sólo para adultos

**5-1** \* Nivel sin subcategorías  
Ajuste a [BLOQ.] o [MIRAR]

▶ TV-Y [MIRAR]  
TV-Y7 ( ) [MIRAR]  
▶ TV-G [BLOQ.]  
TV-PG (DLSV) [BLOQ.]  
TV-14 (DLSV) [BLOQ.]  
TV-MA (LSV) [BLOQ.]

**5-2** \* Nivel con subcategorías

▶ TV-Y [MIRAR]  
TV-Y7 ( ) [MIRAR]  
TV-G [MIRAR]  
▶ TV-PG ( ) [MIRAR]  
TV-14 ( ) [MIRAR]  
TV-MA ( ) [MIRAR]

Subcategorías

▶ TV-PG [BLOQ.]

▶ D [BLOQ.]  
L [BLOQ.]  
S [BLOQ.]  
V [BLOQ.]

▶ TV-PG [BLOQ.]

▶ D [MIRAR]  
L [BLOQ.]  
S [BLOQ.]  
V [BLOQ.]

<Selección> <Explicaciones de categoría de nivel>

- TV-Y7  
FV : Violencia en fantasía
- TV-PG / TV-14 / TV-MA :  
D : Diálogo sugerente (Sólo TV-PG, TV-14)
- L : Lenguaje inapropiado
- S : Situaciones sexuales
- V : Violencia

**6** Para salir del menú

[MENU]

## B [AJUSTE DE CLASE DE MPAA]

**4** Seleccione un nivel

▶ G [MIRAR]  
PG [MIRAR]  
PG-13 [MIRAR]  
R [MIRAR]  
NC-17 [MIRAR]  
X [MIRAR]

**5** Ajuste a [BLOQ.] o [MIRAR]

▶ G [MIRAR]  
PG [MIRAR]  
▶ PG-13 [MIRAR]  
R [BLOQ.]  
NC-17 [BLOQ.]  
X [BLOQ.]

repetidamente

<Selección> <Explicaciones de categoría de nivel>

- G : Audiencia general
- PG : Se sugiere Guía de Padres
- PG-13 : No apto para niños de menos de 13
- R : Limitación, los menores de 17 deben estar acompañados por un padre o adulto responsable
- NC-17 : Prohibido para menores de 17
- X : Sólo para adultos

**6** Para salir del menú

[MENU]

## Notas (para niveles CLASE DE TV y CLASE DE MPAA):

- No puede tener acceso al menú de ajustes cuando aparece el mensaje "PROGRAMA PROHIBIDO por ...". Vaya a un canal no bloqueado antes de presionar [MENU].
- Cuando selecciona un nivel y [BLOQ.], los niveles más altos se bloquean automáticamente. Los niveles más bajos pueden verse.
- Cuando usted configura "X" o "TV-MA" a [MIRAR], todas las calificaciones pasan automáticamente a [MIRAR].

## C [CAMBIO DEL CODIGO DE ACCESO]

**4** Para ingresar su código de acceso viejo.

1 2 3  
4 5 6  
7 8 9  
0 +100

CODIGO NUEVO  
XXXX

CODIGO CONFIRMADO  
----

**5** Para salir del menú

[MENU]

**Notas:**

- Asegúrese de entrar exactamente el mismo nuevo código en el espacio "CODIGO CONFIRMADO" que en el espacio "CODIGO NUEVO". Si son diferentes, se borra el espacio "CODIGO NUEVO" para volver a empezar.
- Se borrará su código de acceso personal y volverá al valor por omisión (0000) cuando se produce un corte eléctrico o cuando desconecte la electricidad con un interruptor de pared. Si se olvidó el código, desenchufe el cable eléctrico durante 10 segundos para volver el código de acceso a 0000.

# GUIA DE LOCALIZACION DE PROBLEMAS

A veces el problema del funcionamiento puede resolverse fácilmente verificando posibilidades que son obvias pero se olvidó de confirmar. Antes de solicitar el servicio, verifique estos puntos. Le ahorrará tiempo y dinero.

LISTA DE VERIFICACION RAPIDA DE SERVICIO	PROBLEMA													
	Mando a distancia no funciona	Barras en la pantalla	Imagen distorsionada	Imagen avanza verticalmente	No hay color	Mala recepción en algunos canales	Imagen débil	Líneas o rayas en la imagen	Fantasma en la imagen	Imagen borrosa	Sonido bueno, imagen mala	Sonido mala, imagen bueno	Ni imagen ni sonido	Diferentes marcas de color en pantalla
<b>POSIBLE SOLUCION</b>														
Pruebe con un nuevo canal, si está bien, hay problema en la emisora.			X	X	X	X	X	X	X	X	X	X	X	X
¿Está enchufado el TV?	X													X
¿Hay electricidad en el tomacorriente?														X
¿Está encendido el TV?														X
¿Hay un cable de antena conectado al terminal atrás del aparato?					X	X	X	X	X	X	X	X	X	X
Si se utiliza una antena externa, verifique por cable roto o conexión floja.		X	X	X	X	X	X	X	X	X	X	X	X	X
Verifique por interferencia local.		X	X	X	X	X	X	X	X	X	X	X	X	X
Apague el TV y vuelva a encender después de un minuto.														X
Ajuste el control COLOR.					X									
Ajuste el control CONTRASTE y CLARIDAD.							X			X				
Verifique las pilas del mando a distancia.	X													
Aleje el TV de aparatos cercanos que generen campos magnéticos.														X
Apague con [POWER] y encienda después de 30 minutos.														
Verifique que no haya obstáculos entre el sensor y el mando a distancia.	X													
<b>Haga una prueba de salida de señal.*</b>	X													
<b>Si está bien, puede haber un fallo del sensor a distancia.</b>														

\*Prueba suplementaria del mando a distancia  
Sintonice una radio AM a una banda que no tenga emisoras. Presione un botón en el mando a distancia apuntando hacia la radio. El sonido oscila cuando presione una tecla y la radio recibe una señal. Esto significa que la unidad del mando a distancia está funcionando.

Problema de capción cerrada	Possible solución
Aparecen subtítulos con error de ortografía.	Los errores de ortografía pueden pasar inadvertidos por la empresa que prepara los subtítulos narrativos en una transmisión en vivo.
No aparece todo el texto o hubo un retardo en lo que dijo.	Los subtítulos con retardo de unos segundos detrás del diálogo real son comunes en las transmisiones en vivo. La mayoría de las empresas que preparan subtítulos pueden mostrar un diálogo a un máximo de 220 palabras por minuto. Si un diálogo supera esa velocidad, se utiliza una edición selectiva para que los subtítulos sigan el diálogo actual en la pantalla de TV.
Los subtítulos aparecen mal con recuadros blancos en la pantalla de TV.	La interferencia de edificios, líneas de tensión, tormentas, etc. pueden hacer que el subtítulos aparezca mal o incompleta.
No aparecen subtítulos en un programa que debería tener subtítulos narrativos.	Las emisoras pueden utilizar un proceso de compresión de tiempo en el programa para dar más tiempo de publicidad. En este caso, los subtítulos pueden perderse porque el decodificador no puede leer la información comprimida.
No aparecen subtítulos cuando reproduce una videocinta pregrabada con subtítulo narrativo.	La videocinta puede ser una copia ilegal de la cinta o la empresa que hizo copias puede haber perdido accidentalmente las señales de subtítulos durante el copiado.
La pantalla de TV muestra un recuadro negro.	Está en el modo de TEXTO. Seleccione TITULO [C1], [C2] u [OFF].

# MANTENIMIENTO

## LIMPIEZA DEL MUEBLE

- Frote el panel frontal y otras superficies exteriores del TV con un paño suave empapado en agua tibia y estrujado.
- Nunca utilice un disolvente o alcohol. No rocíe líquido insecticida cerca del TV. Estos químicos pueden dañar la superficie expuesta o perder color.

## LIMPIEZA DEL TUBO DE IMAGEN

Limpie el tubo de imagen del TV con un paño suave. Antes de limpiar el tubo de imagen, desconecte el cable eléctrico.

# ACCESORIOS INCLUIDOS

- Manual del usuario (1EMN21761)
- Unidad del mando a distancia (NE121UE)
- Pilas ("AA" x 2)

# ESPECIFICACIONES

## ESPECIFICACIONES GENERALES

Sistema de televisión: NTSC-M  
TV normal

Sistema de subtítulos narrativos: \$15.119/FCC

Gama de canales

VHF: 2 - 13  
UHF: 14 - 69  
CATV: 2 - 13, A - W, W+1 - W+84, A-5 - A-1, 5A

Sistema de sintonización: Sistema de sintonización sintetizada de frecuencia de 181 canales

Acceso de canal: Teclado de acceso directo, programable para barrido arriba/abajo

Terminales

Entrada de antena: VHF/UHF/CATV  
75 ohmios desequilibrado (tipo F)

Entrada de video: Conector RCA x 1 (1 x frontal)

Entrada de audio: Conector RCA x 1 (1 x frontal)

Auricular: 1/8 pulg. monoaural (3,5mm)

1 altavoz

## OTRAS ESPECIFICACIONES

Mando a distancia: Sistema de infrarrojos con codificación digital

Temperatura de funcionamiento: 5°C a 40°C (41°F - 104°F)

Requisitos eléctricos: CA de 120V, 60Hz

Consumo de energía (máxima): 55W

Tubo catódico: 14 pulg.

Dimensiones: Al: 12-15/16 pulg.(329mm)  
An: 14-1/8 pulg.(358mm)  
Prof: 15-1/8 pulg.(384,5mm)

Peso: 23,1 lbs. (10,5kg)

- El diseño y las especificaciones están sujetos a cambios sin previo aviso y sin obligación legal.
- Si hay una diferencia entre idiomas, el idioma básico será el inglés.

## ESPECIFICACIONES ELECTRICAS

Salida de sonido: 1W, 8 ohmios x 1



## Free Manuals Download Website

<http://myh66.com>

<http://usermanuals.us>

<http://www.somanuals.com>

<http://www.4manuals.cc>

<http://www.manual-lib.com>

<http://www.404manual.com>

<http://www.luxmanual.com>

<http://aubethermostatmanual.com>

Golf course search by state

<http://golfingnear.com>

Email search by domain

<http://emailbydomain.com>

Auto manuals search

<http://auto.somanuals.com>

TV manuals search

<http://tv.somanuals.com>