

# User guide

## W995

**Thank you** for purchasing a Sony Ericsson W995 Walkman™. For additional phone content, go to [www.sonyericsson.com/tun](http://www.sonyericsson.com/tun). Register now to get free online storage and special offers at [www.sonyericsson.com/myphone](http://www.sonyericsson.com/myphone). For product support, go to [www.sonyericsson.com/support](http://www.sonyericsson.com/support). Please read the *Important information* before you use your phone.

### Instruction symbols

These symbols may appear in the User guide.

- ! Note
- 💡 Tip
- ⚠ Warning
- > Use a selection or navigation key to scroll and select. See *Navigation* on page 8.

## Getting started

### Assembly

Before you start using your phone, you need to insert a SIM card and the battery.

#### To insert the SIM card



- 1 Unlock the battery cover lock.
- 2 Remove the battery cover.
- 3 Slide the SIM card into its holder with the gold-coloured contacts facing down.

#### To insert the battery

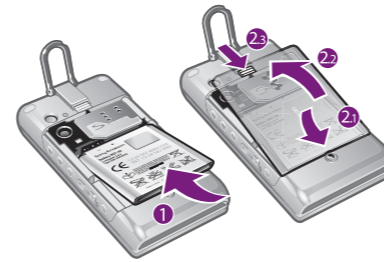

- 1 Insert the battery with the label side up and the connectors facing each other.
- 2 Attach the battery cover and lock it.

## Turning on the phone

### To turn on the phone



- 1 Press and hold down **⏻**.
- 2 Enter your SIM card PIN, if requested, and select **OK**.
- 3 Select a language.
- 4 Follow the instructions to use the setup wizard for basic settings and useful tips.

💡 If you want to correct a mistake when you enter your PIN, press **⏻**.

### Help

In addition to this User guide, an extended User guide, Feature guides and more information are available at [www.sonyericsson.com/support](http://www.sonyericsson.com/support). Help and information are also available in your phone.

- To access the User guide
- Select **Menu** > **Settings** > **User help** > **User guide**.

## Phone overview



- 1 Ear speaker
- 2 Screen light sensor
- 3 Screen
- 4 Connector for charger, handsfree and USB cable
- 5 Selection keys
- 6 Navigation key
- 7 Call key
- 8 Activity menu key
- 9 Walkman™ key
- 10 Video call camera
- 11 End, On/off key
- 12 C key (Clear)
- 13 Silent key

### To view tips and tricks

- Select **Menu** > **Settings** > **User help** > **Tips and tricks**.

### To view information about functions

- Scroll to a function and select **Info**, if available. In some cases, **Info** appears under **Options**.

## Charging the battery

The phone battery is partly charged when you buy it. To charge the battery



- 1 Connect the charger to the phone. It takes approximately 2.5 hours to fully charge the battery. Press a key to view the screen.
- 2 Remove the charger by tilting the plug upwards.

💡 You can use your phone while it is charging. You can charge the battery at any time and for more or less than 2.5 hours. You can interrupt the charging without damaging the battery.



- 14 Audio jack for headphones
- 15 Integrated stand
- 16 Screen light sensor
- 17 Flash
- 18 Main camera
- 19 Media player key - previous/rewind
- 20 Media player key - play/pause
- 21 Media player key - next/fast forward
- 22 Volume, digital zoom
- 23 Camera key

### To navigate the phone menus

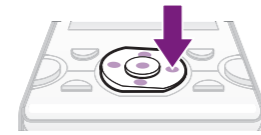

- Press the navigation key **⬅**, **⬆**, **⬇** or **➡** to move through the menus.

### To end a function

- Press **⏻**.

### To return to standby

- Press **⏻**.

### To delete items

- Press **⏻** to delete items such as numbers, letters, pictures and sounds.

## Memory card

! You may have to purchase a memory card separately.

Your phone supports Memory Stick Micro™ (M2™) memory card adding more storage space to your phone. It can also be used as a portable memory card with other compatible devices.

You can move content between a memory card and the phone memory. See *Handling content in the phone* on page 22.

### To insert a memory card



- Remove the battery cover and insert the memory card with the gold-coloured contacts facing up.

### To remove a memory card

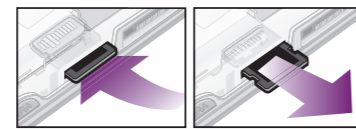

- Remove the battery cover and press the edge of the memory card to release and remove it.

## Entering Text

You can use multitap text input or T9™ Text Input **T9** to enter text. The T9 Text Input method uses a built-in dictionary.

### To change text input method

- When you enter text, press and hold down **⌨**.

### To shift between capitals and lower-case letters

- When you enter text, press **⌨**.

### To enter numbers

- When you enter text, press and hold down **0-9**.

### To enter periods and commas

- When you enter text, press **1**.

### To enter a symbol

- 1 When you enter text, select **Options** > **Add symbol**.
- 2 Scroll to a symbol and select **Insert**.

### To enter text using T9™ Text Input

- 1 Select, for example, **Menu** > **Messaging** > **Write new** > **Message**.
- 2 If **T9** is not displayed, press and hold down **⌨** to change to T9 Text Input.
- 3 Press each key only once, even if the letter you want is not the first letter on the key. For example, to write the word "Jane", press **5**, **2**, **6**, **3**. Write the whole word before looking at the suggestions.
- 4 Use **⬅** or **➡** to view suggestions.
- 5 Press **⌨** to accept a suggestion.

### To enter text using multitap

- 1 From standby select, for example, **Menu** > **Messaging** > **Write new** > **Message**.
- 2 If **T9** is displayed, press and hold down **⌨** to change to multitap text input.
- 3 Press **⌨** - **⌨** repeatedly until the desired letter appears.

- 4 When a word is written, press **⌨** to add a space.

## Calling

### Making and Receiving Calls

You need to turn on your phone and be within range of a network.

#### To make a call

- 1 Enter a phone number (with international country code and area code, if applicable).
- 2 Press **⏻**.

💡 You can call numbers from your contacts and call list. See *Contacts* on page 14, and *Call List* on page 13.

#### To end a call

- Press **⏻**.

#### To make international calls

- 1 Press and hold down **0-0** until a "+" sign appears.
- 2 Enter the country code, area code (without the first zero) and phone number.
- 3 Press **⏻**.

#### To answer a call

- Press **⏻**.

#### To reject a call

- Press **⏻**.

#### To change the ear speaker volume during a call

- Press the volume key up or down.

## Media player keys



You can use the media player keys to control the Walkman™ player, video player and radio. The keys work even if the key lock is on when a handsfree is attached, and also when the Walkman™ player is minimized.

### Walkman™ player

You can use the media player keys to control the Walkman™ player. For more information, see *Media player keys* on page 16.

When listening to music through the loudspeaker you can use the integrated stand to place the phone on a table. For more information about the integrated stand, see *Integrated stand* on page 31.

#### To play music

- 1 Select **Menu** > **Media** > **Music**.
- 2 Browse by category using the navigation key.
- 3 Scroll to a title and press **▶**.

#### To stop playing music

- Press **⏻**.

### To fast forward and rewind

- Press and hold down **⏭** or **⏮**.

### To move between tracks

- Press **⏭** or **⏮**.

### Shake control

#### To switch tracks

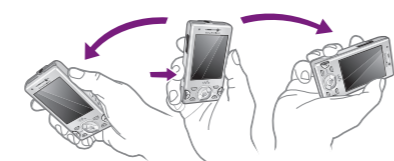

- 1 When music is playing, press and hold down **⏭** and move the phone to the right with a flick of your wrist to go to the next track.
- 2 To go to the previous track, use the same action to the left.

### To shuffle tracks



- When music is playing, press and hold down **⏭** and shake your phone.

### To change the volume



- 1 When music is playing, hold the phone out in front of you facing upwards.

- 2 Press and hold down **⏭** and bend your arm upwards towards you to increase the volume. To decrease the volume, repeat the action in the opposite direction.

## TrackID™

TrackID™ is a music recognition service. You can search for title, artist and album name for a track you hear playing through a loudspeaker or on the radio in your phone. If you cannot use TrackID™, see *I cannot use Internet-based services* on page 34.

### To search for track information

- When you hear a track through a loudspeaker, select **Menu** > **Entertainment** > **TrackID™** > **Start**.
- When the radio in your phone is playing select **Options** > **TrackID™**.

💡 For best results, use TrackID™ in a quiet area.

## Radio

You can use the media player keys to control the radio. For more information, see *Media player keys* on page 16.

! Do not use your phone as a radio in places where this is prohibited.

### To turn on the radio

- 1 Connect a handsfree to the phone.
- 2 Select **Menu** > **Entertainment** > **Radio**.

💡 You can use **⏻** to turn on the radio. **⏻** starts the last used music application, that is the radio or the Walkman™ player.

## Saving channels

You can save up to 20 preset channels.

### To save channels automatically

- Select **Options** > **Auto save**.

### To switch between saved channels

- Press **⬅** or **➡**.

## Imaging

You can take photos and record video clips to view, save or send. You find saved photos and video clips in **Media** and in **File manager**.

## Using the camera

### To activate the camera

- From standby press and hold down **⏻**.

## Viewfinder and camera keys

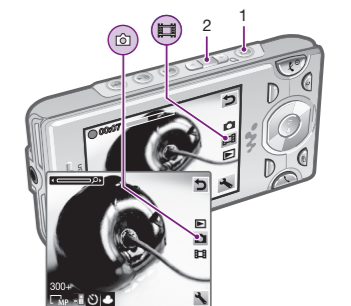

- 1 Activate the camera/Take photos/Record video
- 2 Zoom in or out

### To take a photo

- 1 Activate the camera and press the navigation key to scroll to **⏻**.
- 2 Press **⏻** halfway down to use auto focus.
- 3 When the dot and focus frame are green, press **⏻** fully down to take a photo. The photo is automatically saved.

### To record a video clip

- 1 Activate the camera and press the navigation key to scroll to **⏻**.
- 2 Press **⏻** fully down to start recording.



3 To stop recording, press **[STOP]** fully down. The video clip is automatically saved.

To view photos

- 1 Activate the camera and press the navigation key to scroll to **[PHOTO]**.
- 2 Scroll through the photos.

To view video clips

- 1 Activate the camera and press the navigation key to scroll to **[VIDEO]**.
- 2 Scroll to a video clip and press the center selection key.

To change settings

- Activate the camera and select **[CAMERA]**.

To view information about settings

- Scroll to a setting and select **[SETTINGS]**.

## Transferring and handling content

You can transfer and handle content such as pictures and music.

- ! You are not allowed to exchange some copyright-protected material. **[COPYRIGHT]** identifies a protected item.

### Handling content in the phone

You can use **File manager** to handle content saved in the phone memory or on a memory card. Tabs and icons in **File manager** show where the content is saved. If the memory is full, delete some content to create space.

To move items between the phone memory and the memory card

- 1 Select **Menu > Organizer > File manager**.
- 2 Find an item and select **Options > Manage file > Move**.
- 3 Select **Memory card** or **Phone**.
- 4 Scroll to a folder and select **Open**.
- 5 Select **Paste**.

### Sending content to another phone

You can send content, for example, in messages or using Bluetooth™ wireless technology.

To send content

- 1 Scroll to an item and select **Options > Send**.
- 2 Select a transfer method.

- ! Make sure the receiving device supports the transfer method you select.

### Using a USB cable

You can connect your phone to a computer with a USB cable to synchronize, transfer and back up phone content and use your phone as a modem. For more information, go to [www.sonyericsson.com/support](http://www.sonyericsson.com/support) to read Feature guides.

- ! You may have to purchase a USB cable separately.

### Before using a USB cable

See *Required operating systems* on page 25.

- ! Only use a USB cable supported by your phone. Do not remove the USB cable from your phone or computer during transfer as this may corrupt the memory card or the phone memory.

To disconnect the USB cable safely

- 1 **Computer:** Close any software that you are using with your phone.
- 2 Disconnect the USB cable.

### Drag and drop content

You can drag and drop content between your phone, a memory card and a computer in *Microsoft Windows Explorer*.

To drag and drop content

- 1 Connect your phone to a computer using a USB cable.
- 2 **Phone:** Select **Media transfer**. The phone will remain activated during file transfer.
- 3 **Computer:** Wait until the phone memory and memory card appear as external disks in *Windows Explorer*.
- 4 Drag and drop selected files between the phone and the computer.

### Transferring content to and from a computer

You can use Media Go™ to transfer media content between your phone and a computer.

- ! Media Go™ is available for download at [www.sonyericsson.com/support](http://www.sonyericsson.com/support).

- ! When using Media Go™ to transfer video clips to your phone, the video clips are automatically transcoded for best viewing experience. If you transfer video clips using another program than Media Go™, we recommend that you select H.264 Baseline profile video, up to QVGA at 30 fps, VBR 384 kbps (max 768

kbps) with AAC+ audio at 128 kbps (max 255 kbps), 48 kHz and stereo audio in mp4 file format.

### Required operating systems

You need one of these operating systems to use Sony Ericsson PC software:

- Microsoft® Windows Vista™
- Microsoft® Windows XP, Service Pack 2 or higher

To download Media Go™

- 1 **Computer:** In your Internet browser, go to [www.sonyericsson.com/support](http://www.sonyericsson.com/support).
- 2 Select a region and country.
- 3 Select **Software downloads**.
- 4 Select a phone from the list.
- 5 Select **Read more and download** under Media Go™.
- 6 Select **Download now** and save the file to your computer.

- ! Remember where you save the file.

To install Media Go™ from the downloaded file

- 1 Locate the downloaded Media Go™ file on the computer.
- 2 Double-click the file and follow the instructions.

To transfer content using Media Go™

- ! Do not remove the USB cable from your phone or computer during transfer, as this may corrupt the memory card or the phone memory.

- 1 Connect the phone to a computer with a USB cable supported by your phone.
- 2 **Computer:** Select **Start/Programs/Sony/Media Go™**.
- 3 **Phone:** Select **Media transfer**.

4 **Computer:** Select **Transfer to or from Device using Media Go™** and click **OK**.

5 Wait until the phone appears in Media Go™.

- 6 Move files between your phone and the computer in Media Go™.

### Backing up and restoring

You can backup and restore contacts, the calendar, tasks, notes and bookmarks using the *Sony Ericsson PC Suite*. Before backing up and restoring, you need to install the *Sony Ericsson PC Suite*, which is available from [www.sonyericsson.com/support](http://www.sonyericsson.com/support).

You can backup and restore contacts within your phone using a Memory Stick Micro™ (M2™) memory card. You can move content between the memory card and the phone memory. See *Handling content in the phone* on page 22.

- ! Back up your phone content regularly to make sure you do not lose it.

To make a backup using the Sony Ericsson PC Suite

- 1 **Computer:** Start the *Sony Ericsson PC Suite* from **Start/Programs/Sony Ericsson/Sony Ericsson PC Suite**.
- 2 Follow the instructions in the *Sony Ericsson PC Suite* for how to connect.
- 3 **Phone:** Select **Phone mode**.
- 4 **Computer:** Go to the backup and restore section in the *Sony Ericsson PC Suite* and make a backup.

## Messaging

To view a message from the inbox

- 1 Select **Menu > Messaging > Inbox**.

2 Scroll to the message and select **View**.

### Sending messages

You can send messages from your phone. The maximum size of a standard text message is 160 characters including spaces if no other items are added to the message. If you enter more than 160 characters, a second message is created. Your messages are sent as one concatenated message.

To create and send a message

- 1 Select **Menu > Messaging > Write new > Message**.
- 2 Enter text. To add items to the message, press **[@]**, scroll **[OK]** and select an item.
- 3 Select **Continue > Contacts lookup**.
- 4 Select a recipient and select **Send**.

- ! If you send a message to a group, you will be charged for each member.

## Internet

If you cannot use the Internet, see *I cannot use Internet-based services* on page 34.

To start browsing

- 1 Select **Search**.
- 2 Enter a Web address, a search phrase or the name of a bookmark.
- 3 Scroll to an item in the list and select **Go to** or **Search**.

To exit the browser

- Select **Options > Exit browser**.

### Wi-Fi™

Using Wi-Fi™ you can access the Internet wirelessly with your phone. You can browse the Internet at home (personal networks) or in public access zones (hot spots):

- Personal networks – usually protected. A pass phrase or a key is required from the owner.
- Hot spots – usually non-protected but often requires you to log on to the operator’s service before you get Internet access.

### Using Wi-Fi

To be able to browse the Internet using Wi-Fi you need to search for and connect to an available network and then open the Internet browser.

To turn on Wi-Fi

- Select **Menu > Settings > Connectivity > Wi-Fi > Turn on**.

To connect to a network

- 1 Select **Menu > Settings > Connectivity > Wi-Fi**.
- 2 Scroll to a network and select **Connect**.

To start browsing using Wi-Fi

- 1 Make sure **[WiFi]** is showing in the status bar.
- 2 Select **Menu > Internet**.

- ! Often used networks can be saved as favorites. These will connect automatically when you are within range if you turn on **Auto connect**.

## GPS

Your phone has a GPS receiver that uses satellite signals to calculate your location.

- ! If you cannot use some GPS features, see *I cannot use Internet-based services* on page 34.

### Using GPS

Your location can be found when you have a clear view of the sky. If your location is not found after a few minutes, move to another location. To help the search, stand still and do not cover the GPS antenna.

- ! The first time you use the GPS it may take up to 10 minutes before your location is found.



### Assisted start

With **Assisted start** your location is calculated more quickly. If not turned off, **Assisted start** will automatically be used to find your location when Assisted GPS (A-GPS) technology is available.

To set when to use Assisted start

- 1 Select **Menu > Location services > Settings > Assisted start**.
- 2 Select an option.

## More Features

### Flight mode

In **Flight mode** the network and radio transceivers are turned off to prevent disturbance to sensitive equipment. When the flight mode menu is activated you are asked to select a mode the next time you turn on your phone:

- **Normal mode** – full functionality
- **Flight mode** – limited functionality

To activate the flight mode menu

- Select **Menu > Settings > General > Flight mode > Continue > Show at startup**.

To select flight mode

- 1 When the flight mode menu is activated, turn off your phone.
- 2 Turn on your phone and select **Flight mode**.

### Update Service

You can update your phone with the latest software using your phone or a PC.

- ! Updating using your phone is not possible in all countries/regions.

To view the current software in the phone

- 1 Select **Menu > Settings > General > Update service**.

2 Select **Software version**.

### Update Service using a PC

You can update your phone using a USB cable and an Internet-connected PC.

- ! Make sure all personal data in your phone memory is backed up before you perform an update using a PC. See *Backing up and restoring* on page 26.

To use Update Service using a PC

- Go to [www.sonyericsson.com/updateservice](http://www.sonyericsson.com/updateservice).

### Ringtones

To set a ringtone

- 1 Select **Menu > Settings > Sounds & alerts > Ringtone**.
- 2 Find and select a ringtone.

To turn off the ringtone

- Press **[MUTE]** and then press and hold down **[END]**.

- ! The alarm signal is not affected.

### Integrated stand

The integrated stand is on the back of your phone. You can use it to place the phone on a table and enjoy multimedia content.

- ! To listen to music or view video clips when using the integrated stand and headphones, you need to connect the headphones to the 0.14 inch (3.5 mm) audio jack.



### Locks

#### SIM card lock

This lock only protects your subscription. Your phone will work with a new SIM card. If the lock is on, you have to enter a PIN (Personal Identity Number). If you enter your PIN incorrectly three times in a row, the SIM card is blocked and you need to enter your PUK (Personal Unlocking Key). Your PIN and PUK are supplied by your network operator.

To unlock the SIM card

- 1 When **PIN blocked** appears, enter your PUK and select **OK**.
- 2 Enter a new four-to-eight-digit PIN and select **OK**.
- 3 Re-enter the new PIN and select **OK**.

To edit the PIN

- 1 Select **Menu > Settings > General > Security > Locks > SIM Protection > Change PIN**.

2 Enter your PIN and select **OK**.

- 3 Enter a new four-to-eight-digit PIN and select **OK**.
- 4 Re-enter the new PIN and select **OK**.

- ! If **Codes do not match** appears, you entered the new PIN incorrectly. If **Wrong PIN** appears, followed by **Old PIN**, you entered your old PIN incorrectly.

## Troubleshooting

Some problems can be fixed using Update Service. Using Update Service on regular basis will optimize the phone’s performance. See *Update Service* on page 30. Some problems will require you to call your network operator.

For more support go to [www.sonyericsson.com/support](http://www.sonyericsson.com/support).

### Common Questions

**I have problems with memory capacity or the phone is working slowly**  
Restart your phone every day to free memory or do a **Master reset**.

#### Master reset

If you select **Reset settings**, the changes that you have made to settings will be deleted. If you select **Reset all**, your settings and content, such as contacts, messages, pictures, sounds and downloaded games, will be deleted. You may also lose content that was in the phone at purchase.

To reset the phone

- 1 Select **Menu > Settings > General > Master reset**.

- 2 Select an option.
- 3 Follow the instructions that appear.

### I cannot charge the phone or battery capacity is low

The charger is not properly connected or the battery connection is poor. Remove the battery and clean the connectors. The battery is worn out and needs to be replaced. See *Charging the battery* on page 6.

### No battery icon appears when I start charging the phone

It may take a few minutes before the battery icon appears on the screen.

### Some menu options appear in gray

A service is not activated. Contact your network operator.

### I cannot use Internet-based services

Your subscription does not include data capability. Settings are missing or incorrect. You can download settings using the setup wizard or by going to [www.sonyericsson.com/support](http://www.sonyericsson.com/support).

To download settings

- 1 Select **Menu > Settings > User help > Settings download**.
- 2 Follow the instructions that appear.

- ! Contact your network operator or service provider for more information.

### I cannot send messages from my phone

Most messages require a service center number to send them. The number is supplied by your service provider and

is usually saved on the SIM card. If the number to your service center is not saved on your SIM card, you must enter the number yourself.

To send most picture messages, you must set an MMS profile and the address of your message server. If no MMS profile or message server exists, you can receive all the settings automatically from your network operator, download settings using the setup wizard or at [www.sonyericsson.com/support](http://www.sonyericsson.com/support).

To enter a service center number

- 1 Select **Menu > Settings > Connectivity > Message settings > Text message** and scroll to **Service center**. The number is shown if it is saved on the SIM card.
- 2 If there is no number shown, select **Edit**.
- 3 Scroll to **New Service Center** and select **Add**.
- 4 Enter the number, including the international “+” sign and country code.
- 5 Select **Save**.

To select an MMS profile

- 1 Select **Menu > Settings > Connectivity > Message settings > Picture message**.
- 2 Select an existing profile or create a new one.
- To set the message server address
  - 1 Select **Menu > Settings > Connectivity > Message settings > Picture message**.
  - 2 Scroll to a profile and select **Options > Edit**.
  - 3 Scroll to **Message server** and select **Edit**.
  - 4 Enter the address and select **OK > Save**.

[www.sonyericsson.com](http://www.sonyericsson.com)



Sony Ericsson Mobile Communications AB  
SE-221 88 Lund, Sweden

1224-1215.1

and make sure that the network has coverage where you are.

The SIM card is not working properly. Insert your SIM card in another phone. If this works, it is probably your phone that is causing the problem. Please contact the nearest Sony Ericsson service location.

### Emergency calls only

You are within range of a network, but you are not allowed to use it. However, in an emergency, some network operators allow you to call the international emergency number 112. See *Emergency calls* on page 13.

## Legal information

### Sony Ericsson W995 Walkman™

This User guide is published by Sony Ericsson Mobile Communications AB or its local affiliated company, without any warranty. Improvements and changes to this User guide necessitated by typographical errors, inaccuracies of current information, or improvements to programs and/or equipment, may be made by Sony Ericsson Mobile Communications AB at any time and without notice. Such changes will, however, be incorporated into new editions of this User guide.

All rights reserved.  
©Sony Ericsson Mobile Communications AB, 2009

Publication number: 1224-1215.1

Attention: Some of the services and features described in this User guide are not supported by all networks and/or service providers in all areas. Without limitation, this applies to the GSM International Emergency Number 112. Please contact your network operator or service provider to determine availability of any specific service or feature and whether additional access or usage fees apply.

Your phone has the capability to download, store and forward additional content, for example ringtones. The use of such content may be restricted or prohibited by rights of third parties, including but not limited to restriction under applicable copyright laws. You, and not

Sony Ericsson, are entirely responsible for additional content that you download to or forward from your phone. Prior to your use of any additional content, please verify that your intended use is properly licensed or is otherwise authorized. Sony Ericsson does not guarantee the accuracy, integrity or quality of any additional content or any other third party content. Under no circumstances will Sony Ericsson be liable in any way for your improper use of additional content or other third party content.

Bluetooth is a trademark or a registered trademark of Bluetooth SIG Inc. and any use of such mark by Sony Ericsson is under license.

The Liquid Identity logo, SensMe, PlayNow, MusicDJ, PhotoDJ, TrackID, Style-Up and VideoDJ are trademarks or registered trademarks of Sony Ericsson Mobile Communications AB.

TrackID™ is powered by Gracenote Mobile MusicID™. Gracenote and Gracenote Mobile MusicID are trademarks or registered trademarks of Gracenote, Inc.

WALKMAN, WALKMAN logo, Sony, Memory Stick Micro™, M2™ and Media Go are trademarks or registered trademarks of Sony Corporation.

Wi-Fi is a trademark or a registered trademark of the Wi-Fi Alliance.

DLNA is a trademark or registered trademark of the Digital Living Network Alliance.

Google™, Google Maps™, YouTube and the YouTube logo are trademarks or registered trademarks of Google, Inc.

PLAYSTATION is a trademark or registered trademark of Sony Computer Entertainment, Inc.

Wayfinder and Wayfinder Navigator are trademarks or registered trademarks of Wayfinder Systems AB.

Ericsson is a trademark or registered trademark of Telefonaktiebolaget LM Ericsson.

Microsoft, Windows and Vista are registered trademarks or trademarks of Microsoft Corporation in the United States and/or other countries.

T9™ Text Input is a trademark or a registered trademark of Tegic Communications. T9™ Text Input is licensed under one or more of the following: U.S. Pat. Nos. 5,818,437, 5,953,541, 5,187,480, 5,945,928, and 6,011,654; Canadian Pat. No. 1,331,057; United Kingdom Pat. No. 2,238,414B; Hong Kong Standard Pat. No. HK0940329; Republic of Singapore Pat. No. 51383; Euro.Pat. No. 0,842,463(96927260.8) DE/DK, FI, FR, IT, NL, PT, ES, SE, GB; and additional patents are pending worldwide.

This product is protected by certain intellectual property rights of Microsoft. Use or distribution of such technology outside of this product is prohibited without a license from Microsoft.

Other product and company names mentioned herein may be the trademarks of their respective owners.

Any rights not expressly granted herein are reserved.

All illustrations are for illustration only and may not accurately depict the actual phone.

## Free Manuals Download Website

<http://myh66.com>

<http://usermanuals.us>

<http://www.somanuals.com>

<http://www.4manuals.cc>

<http://www.manual-lib.com>

<http://www.404manual.com>

<http://www.luxmanual.com>

<http://aubethermostatmanual.com>

Golf course search by state

<http://golfingnear.com>

Email search by domain

<http://emailbydomain.com>

Auto manuals search

<http://auto.somanuals.com>

TV manuals search

<http://tv.somanuals.com>