

# INSTALLATION INSTRUCTIONS

HEADLIGHT KIT  
MFG. NO. 1690464  
FOR LAWN TRACTORS

## PREPARATION

If the tractor manufacturer's number is 1690343, discard the longer center clip and the shorter side clips. For all other tractors, discard the shorter center clip and longer side clips.

## KIT PARTS

This kit consists of the parts shown in figure 1.

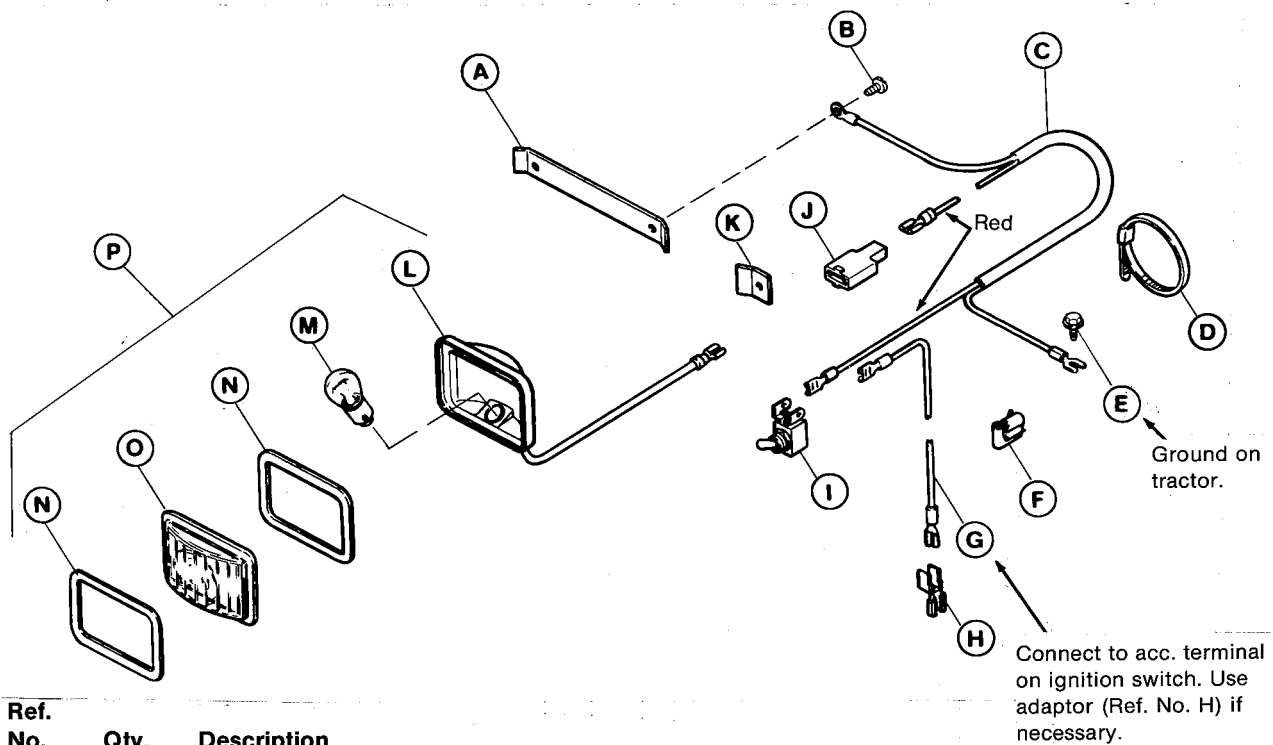

Ref. No.	Qty.	Description
A	1	CLIP, Center, Shorter (For 1690343 tractors)
	1	CLIP, Center, Longer (For all except 1690343)
B	4	SCREW, Plastite, #10-14 x 1/2
C	1	WIRE ASSY., Headlights
D	1	TIE, Cable
E	1	SCREW, Hex Hd., Taptite, 1/4-20 x 3/8
F	1	CLIP, Speed
G	1	WIRE ASSY.
H	1	ADAPTOR, 2-Way
I	1	SWITCH, Toggle
J	1	CONNECTOR, Insulated
K	2	CLIP, Side, Longer (For 1690343 tractors)
	2	CLIP, Side, Shorter (For all except 1690343)
L	2	REFLECTOR ASSY.
M	2	BULB, #199
N	4	GASKET, Lens
O	2	LENS, Clear Plastic
P	2	LIGHT ASSY.

Figure 1. Headlight Assembly

## INSTALLATION



### WARNING

For your personal safety, stop tractor engine and remove ignition key to prevent accidental starting. Then disconnect negative battery cable and fasten it away from engine. If engine has been running, wait for hot muffler to cool before installing lights.

1. Using a saber saw or a keyhole saw, cut thru the remaining material to remove the two headlight blocks in the grille.

### NOTE

Each light assembly has one lens and two gaskets. Place one gasket inside lens and one gasket between lens and grille.

2. Place the headlights into the two openings as shown in figure 2. Secure the headlights with one center clip and two side clips. For 1690343 tractors, use two plastite screws for center clip and two existing capscrews for side clips. For other models, Use four plastite screws.

3. Plug the headlight wires (G) into the insulated connector (H).

4. Notice that red wire extends from both ends of harness. Connect short end (F) into the insulated connector (H).

5. Loosen the right-hand plastite screw (C) and install the black wire (E).

6. Attach the other end of the black wire to the hole in tractor frame with the taptite screw as shown in figure 3.

7. Remove the two capscrews and the two taptite screws holding the upper dash and raise the dash carefully a few inches to permit access to the inside. The nut can be removed from the ignition switch for additional access. Remove the steering wheel and note position of washers for re-installation.

8. Route the red wire rearward from front of tractor behind the starter and through the hole in lower dash (the starter wires are also routed through this hole). See figure 3.

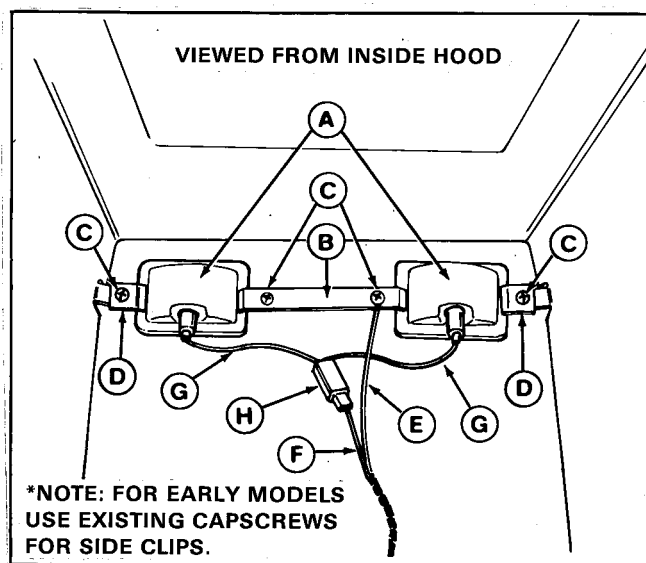

Figure 2. Install Headlights

- |                    |                        |
|--------------------|------------------------|
| A. Headlight       | E. Black Wire          |
| B. Center Clip     | F. Red Wire            |
| C. Plastite Screws | G. Headlight Wire      |
| D. Side Clips      | H. Insulated Connector |

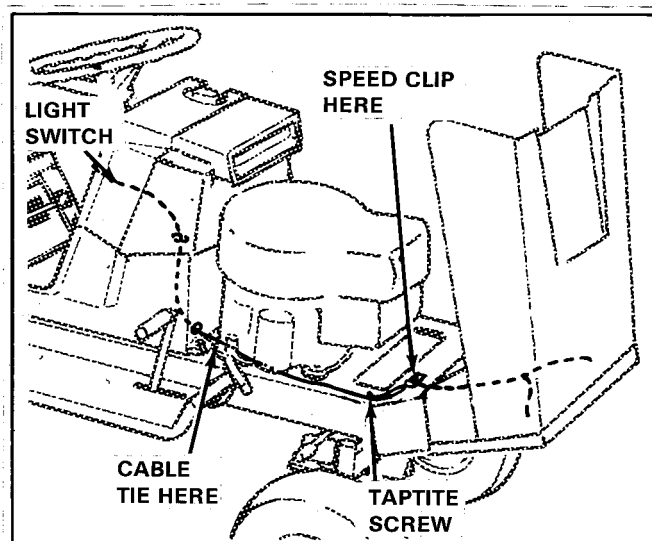
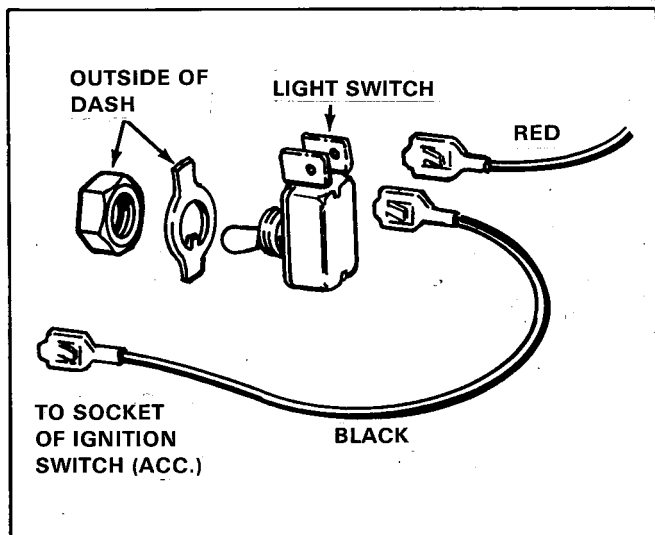

Figure 3. Installing Wiring Harness

9. Pull the red wire up through the larger hole in the top of the lower dash. Attach the red wire to terminal on light switch (see figure 4).
10. Attach the short black wire provided to the remaining terminal on the light switch (see figure 4). Attach the other end of the black wire to the vacant terminal on the ignition switch (accessory terminal). Make sure all wires are pressed onto the terminals and are fully locked in position.



**Figure 4. Installing Light Switch**

11. Push the plug out of the dash from the inside and install the light switch in this hole. The slot in light switch threads should face downwards.
12. Place the ON-OFF plate on switch threads outside of dash and tighten on the hex nut provided (see figure 4). Discard the serrated washer provided with the switch. Be sure to reassemble ignition switch in dash if it was removed.
13. Reconnect negative battery cable and check lights by turning ignition key to "run" and light switch to "on". REMOVE key again after check.
14. Reinstall upper dash on lower dash.
15. Fasten red headlight wire to starter wires near the hole in lower dash with the plastic cable tie provided (see figure 3).
16. Fasten wiring harness to frame with the speed clip provided (see figure 3). The speed clip is installed on frame to hold wires away from muffler.
17. If the steering wheel was removed, install and torque the locknut to 10 ft. lbs. If steering wheel is type secured by nut in center of hub, be sure dome washer is "dome up" on the shaft.
18. Close hood and check fit with upper dash. If necessary, readjust hood forward or back for snug fit to upper dash.

## Free Manuals Download Website

<http://myh66.com>

<http://usermanuals.us>

<http://www.somanuals.com>

<http://www.4manuals.cc>

<http://www.manual-lib.com>

<http://www.404manual.com>

<http://www.luxmanual.com>

<http://aubethermostatmanual.com>

Golf course search by state

<http://golfingnear.com>

Email search by domain

<http://emailbydomain.com>

Auto manuals search

<http://auto.somanuals.com>

TV manuals search

<http://tv.somanuals.com>