

# Personal Audio Docking System

## Operating Instructions

RDP-XF100iP



©2010 Sony Corporation

Printed in China

<http://www.sony.net/>

### Owner's Record

The model number and the serial number are located on the bottom.  
Record the serial number in the space provided below. Refer to them whenever you call upon your Sony dealer regarding this product.

Model No. RDP-XF100iP

Serial No. \_\_\_\_\_

For customers in the USA  
Please register this product on line at <http://www.sony.com/productregistration>  
Proper registration will enable us to send you periodic mailings about new products, services, and other important announcements. Registering your product will also allow us to contact you in the unlikely event that the product needs adjustment or modification. Thank you.

### WARNING

To reduce the risk of fire or electric shock, do not expose this apparatus to rain or moisture.

To reduce the risk of fire, do not cover the ventilation of the apparatus with newspapers, tablecloths, curtains, etc. And do not place lighted candles on the apparatus.

To reduce the risk of fire or electric shock, do not expose this apparatus to dripping or splashing, and do not place objects filled with liquids, such as vases, on the apparatus.

Do not install the appliance in a confined space, such as a bookcase or built-in cabinet.

Do not expose the batteries (battery pack or batteries installed) to excessive heat such as sunshine, fire or the like for a long time.

As the main plug is used to disconnect the unit from the mains, connect the unit to an easily accessible AC outlet. Should you notice an abnormality in the unit, disconnect the main plug from the AC outlet immediately.

The unit is not disconnected from the AC power source (mains) as long as it is connected to the wall outlet, even if the unit itself has been turned off.

The nameplate and important information concerning safety are located on the bottom exterior of main unit and on the surface of AC power adaptor.

You are cautioned that any changes or modifications not expressly approved in this manual could void your authority to operate this equipment.

### CAUTION

Danger of explosion if battery is incorrectly replaced. Replace only with the same type.

### NOTE

This equipment has been tested and found to comply with the limits for a Class B digital device, pursuant to Part 15 of the FCC Rules. These limits are designed to provide reasonable protection against harmful interference in a residential installation. This equipment generates, uses and can radiate radio frequency energy and, if not installed and used in accordance with the instructions, may cause harmful interference to radio communications. However, there is no guarantee that interference will not occur in a particular installation. If this equipment does cause harmful interference to radio or television reception, which can be determined by turning the equipment off and on, the user is encouraged to try to correct the interference by one or more of the following measures:

- Reorient or relocate the receiving antenna.
- Increase the separation between the equipment and receiver.
- Connect the equipment into an outlet on a circuit different from that to which the receiver is connected.
- Consult the dealer or an experienced radio/TV technician for help.

### WARNING

- Replace the battery for the remote commander with a Sony CR2025 lithium battery. Use of another battery may present a risk of fire or explosion.
- Battery may explode if mistreated. Do not recharge, disassemble or dispose of in fire.
- Dispose of used battery promptly. Keep away from children.

### Important Safety Instructions

- 1) Read these instructions.
- 2) Keep these instructions.
- 3) Heed all warnings.
- 4) Follow all instructions.
- 5) Do not use this apparatus near water.
- 6) Clean only with dry cloth.
- 7) Do not block any ventilation openings. Install in accordance with the manufacturer's instructions.
- 8) Do not install near any heat sources such as radiators, heat registers, stoves, or other apparatus (including amplifiers) that produce heat.
- 9) Do not defeat the safety purpose of the polarized or grounding-type plug. A polarized plug has two blades with one wider than the other. A grounding type plug has two blades and a third grounding prong. The wide blade or the third prong are provided for your safety. If the provided plug does not fit into your outlet, consult an electrician for replacement of the obsolete outlet.
- 10) Protect the power cord from being walked on or pinched particularly at plugs, convenience receptacles, and the point where they exit from the apparatus.
- 11) Only use attachments/accessories specified by the manufacturer.
- 12) Use only with the cart, stand, tripod, bracket, or table specified by the manufacturer, or sold with the apparatus. When a cart is used, use caution when moving the cart/apparatus combination to avoid injury from tip-over.

- 13) Unplug this apparatus during lightning storms or when unused for long periods of time.
- 14) Refer all servicing to qualified service personnel. Servicing is required when the apparatus has been damaged in any way, such as power-supply cord or plug is damaged, liquid has been spilled or objects have fallen into the apparatus, the apparatus has been exposed to rain or moisture, does not operate normally, or has been dropped.

### For the state of california, USA only

Perchlorate Material -special handling may apply, see [www.dtsc.ca.gov/hazardouswaste/perchlorate](http://www.dtsc.ca.gov/hazardouswaste/perchlorate)  
Perchlorate Material: Lithium battery contains perchlorate

### RECYCLING NICKEL METAL HYDRIDE BATTERIES

Nickel Metal Hydride batteries are recyclable. You can help preserve our environment by returning your used rechargeable batteries to the collection and recycling location nearest you.



For more information regarding recycling of rechargeable batteries, call toll free 1-800-822-8837 or visit <http://www.rbc.org/>

**Caution:** Do not handle damaged or leaking Nickel Metal Hydride batteries.

The validity of the CE marking is restricted to only those countries where it is legally enforced, mainly in the countries EEA (European Economic Area).



### Features

- Compatible with iPod®/iPhone®
- FM tuner with 20 station presets
- Rechargeable battery for portable use
- Audio in function
- Wireless remote commander supplied

### Precautions

- Play the unit on the power source specified in "Specifications."
- To disconnect the AC power cord (mains lead), pull it out by the plug, not the cord.
- Since a strong magnet is used for the speaker, keep personal credit cards using magnetic coding or spring-wound watches away from the unit to prevent possible damage from the magnet.
- Do not leave the unit in a location near a heat source such as a radiator or air duct, or in a place subject to direct sunlight, excessive dust, mechanical vibration, or shock.
- Allow adequate air circulation to prevent internal heat build-up. Do not place the unit on a surface (a rug, a blanket, etc.) or near materials (a curtain) which might block the ventilation holes.
- Should any solid object or liquid fall into the unit, unplug the unit and have it checked by qualified personnel before operating it any further.
- To clean the casing, use a soft cloth dampened with a mild detergent solution.

### NOTES ON LITHIUM BATTERY

- Wipe the battery with a dry cloth to assure a good contact.
- Be sure to observe the correct polarity when installing the battery.
- Do not hold the battery with metallic tweezers, otherwise a short-circuit may occur.

If you have any questions or problems concerning your unit, please consult your nearest Sony dealer.

### Power sources

#### Preparing a power source

Charge the rechargeable battery before using this unit for the first time, or when the battery is depleted. You can operate the unit while charging.

- 1 Connect the AC power cord (supplied) to the AC power adaptor (supplied).
- 2 Connect the AC power adaptor to the DC IN 20V jack on the back of this unit firmly and plug it into a wall outlet.

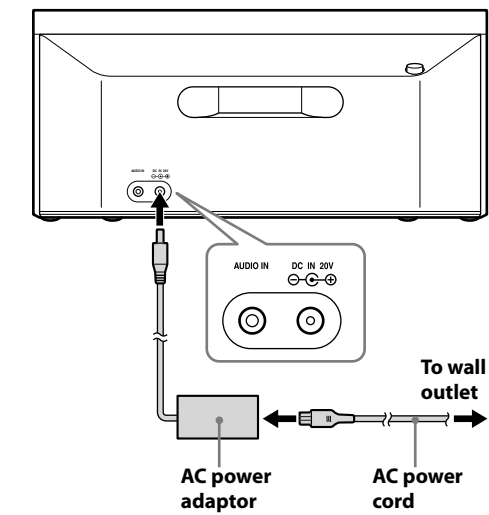

#### Note on the AC power adaptor

- Use the Sony supplied AC power adaptor only. The polarity of the plugs of other manufactures may be different. Failure to use the supplied AC power adaptor may cause the unit to malfunction.



- 3 Confirm that charging has started.

When charging start, the battery indicator appears. While charging, the charging indicator animation loops.

#### When the unit is turned off



When charging completes, the full battery indicator appears for a while, and then disappears.



#### Notes

- If you connect the AC power adaptor when the battery is fully charged, the full battery indicator appears for a while, and then disappears.
- If you connect the AC power adaptor when the battery power is low, charging starts and the low battery and charging indicator animation loops.

The unit cannot perform operations without the AC power adaptor while the low battery indicator appears.



#### When the unit is turned on

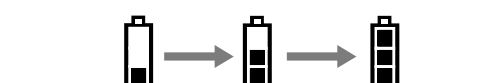

When charging completes, the full battery indicator appears.



#### Note

- It will take approximately 7 hours to charge the battery.

### Using the rechargeable battery

You can operate the unit with the rechargeable battery instead of the AC power adaptor.

#### Note

- The maximum output will be lower when the AC power adaptor is disconnected.

#### To check the remaining power of the battery

The remaining power of the battery will be indicated when the unit is turned on. As the remaining battery power depletes, the battery indicator decreases.

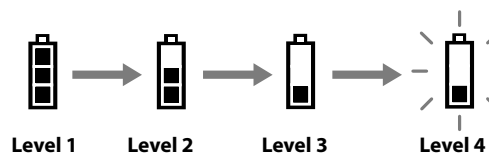

When the battery becomes almost fully depleted, "LOW BATT" flashes and the unit will turn off. To charge the battery, connect the AC power adaptor. (See "Preparing a power source.")



#### Notes

- The remaining battery power will not be indicated when the unit is turned off.
- The unit requires at least 30 minutes to charge the battery if "LOW BATT" appears.
- The battery indicator shows approximate remaining battery power.
- Operating conditions will affect the rate of battery depletion.

### Battery life

When	Battery life
Playback of iPod	approx. 7hours*
FM reception	approx. 7hours

Measured in accordance with the JEITA (Japan Electronics and Information Technology Industries Association) standard.

\* Playback time measured using a fully charged rechargeable battery with a fully charged iPod classic.

### When to replace the rechargeable battery pack

Repeated recharging causes the capacity of the rechargeable battery power to decrease over time. Replace the rechargeable battery pack when its capacity becomes half the usual time, even after charging the battery fully.

#### Note

- The rechargeable battery pack is not a commercially available product. To purchase a rechargeable battery pack (NH - 2000 RDP), consult with your nearest Sony dealer.

### Replacing the rechargeable battery pack

- 1 Slide the latch to **UNLOCK**, and slide **RELEASE** in the direction of the arrow on the bottom of this unit. The battery compartment cover opens, then remove the cover.
- 2 Use a coin, etc., to pull out the rechargeable battery pack.
- 3 Remove the rechargeable battery pack and disconnect the lead from the jack inside the battery compartment.
- 4 Connect the lead of a new rechargeable battery pack to the jack and insert the battery in the unit.
- 5 Close the battery compartment cover and slide the latch to **LOCK**.

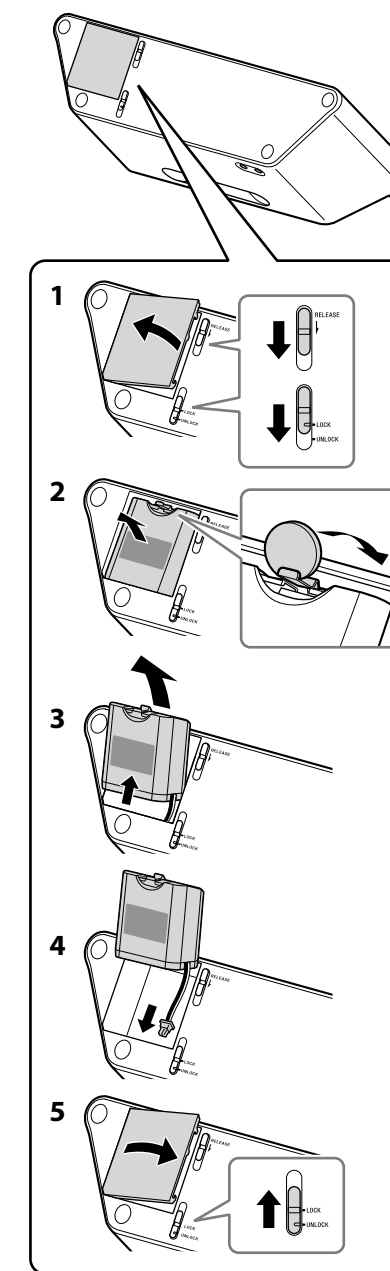

#### Notes

- Charge a new battery pack before use. See "Preparing a power source" for details.
- Turn off the unit, before replacing the rechargeable battery pack.
- When replacing the rechargeable battery pack, place a soft cloth, etc., under the unit.

### Preparing the remote commander

Before using the remote commander for the first time, remove the insulation film.



### To know when to replace the battery

With normal use, the battery (CR2025) should last for about 6 months. When the remote commander no longer operates the unit, replace the battery with a new one.

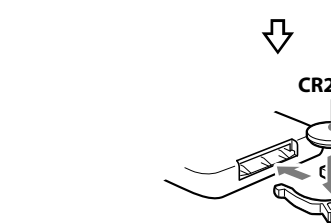

#### Notes

- Do not attempt to charge the battery.
- If you are not going to use the remote commander for a long time, remove the battery to avoid any damage that may be caused by leakage and corrosion.

SONY

Portable Audio

## LIMITED WARRANTY (U.S. Only)

Sony Electronics Inc. ("Sony") warrants this product against defects in material or workmanship for the time periods and as set forth below when purchased directly from Sony or a Sony Retailer. Pursuant to this Limited Warranty, Sony will, at its option, (i) repair the product using new or refurbished parts or (ii) replace the product with a new or refurbished product. For purposes of this Limited Warranty, "refurbished" means a product or part that has been returned to its original specifications. In the event of a defect, these are your exclusive remedies.

**Labor:** For a period of one (1) year from the original date of purchase of the product ("Labor Warranty"), Sony will, at its option, repair or replace with new or refurbished product, product determined to be defective. If Sony elects to replace the product after this Labor Warranty has expired but while the Parts Warranty below is still in effect, it will do so for the applicable labor charge.

**Parts:** For a period of one (1) year from the original date of purchase of product ("Parts Warranty"), Sony will supply new or refurbished replacement parts in exchange for parts determined to be defective.

This Limited Warranty covers only the hardware components packaged with the Product. It does not cover technical assistance for hardware or software usage and it does not cover any software products whether or not contained in the Product; any such software is provided "AS IS" unless expressly provided for in an enclosed software Limited Warranty. Please refer to the End User License Agreements included with the Product for your rights and obligations with respect to the software.

**Instructions:** To obtain warranty service, you must deliver the product, freight prepaid, in either its original packaging or packaging affording an equal degree of protection to the Sony authorized service facility specified. It is your responsibility to backup any data, software or other materials you may have stored or preserved on your unit. It is likely that such data, software, or other materials will be lost or reformatted during service and Sony will not be responsible for any such damage or loss. A dated purchase receipt from Sony or a Sony Retailer is required. For specific instructions on how to obtain warranty service for your product,

Visit Sony's Web Site:  
[www.sony.com/support](http://www.sony.com/support)

Or call the Sony Customer Information Service Center  
1-800-222-SONY (7669)

For an accessory or part not available from your authorized dealer, call:  
1-800-488-SONY (7669)

**Repair / Replacement Warranty:** This Limited Warranty shall apply to any repair, replacement part or replacement product for the remainder of the original Limited Warranty period or for ninety (90) days, whichever is longer. Any parts or product replaced under this Limited Warranty will become the property of Sony.

This Limited Warranty only covers product issues caused by defects in material or workmanship during ordinary consumer use; it does not cover product issues caused by any other reason, including but not limited to product issues due to commercial use, acts of God, misuse, limitations of technology, or modification of or to any part of the Sony product or product purchased from other than Sony or a Sony Retailer. To determine if a retailer is part of the Sony Retailer Network, please contact Sony's Customer Service Call Center or go to [www.sony.com/support](http://www.sony.com/support). This Limited Warranty does not cover Sony products sold AS IS or WITH ALL FAULTS or consumables (such as fuses or batteries). This Limited Warranty is invalid if the factory-applied serial number has been altered or removed from the product. This Limited Warranty is valid only in the United States.

**LIMITATION ON DAMAGES:** SONY SHALL NOT BE LIABLE FOR ANY INCIDENTAL OR CONSEQUENTIAL DAMAGES FOR BREACH OF ANY EXPRESS OR IMPLIED WARRANTY ON THIS PRODUCT.

**DURATION OF IMPLIED WARRANTIES:** EXCEPT TO THE EXTENT PROHIBITED BY APPLICABLE LAW, ANY IMPLIED WARRANTY OF MERCHANTABILITY OR FITNESS FOR A PARTICULAR PURPOSE ON THIS PRODUCT IS LIMITED IN DURATION TO THE DURATION OF THIS WARRANTY.

Some states do not allow the exclusion or limitation of incidental or consequential damages, or allow limitations on how long an implied warranty lasts, so the above limitations or exclusions may not apply to you. This Limited Warranty gives you specific legal rights and you may have other rights which vary from state to state.



## Operations

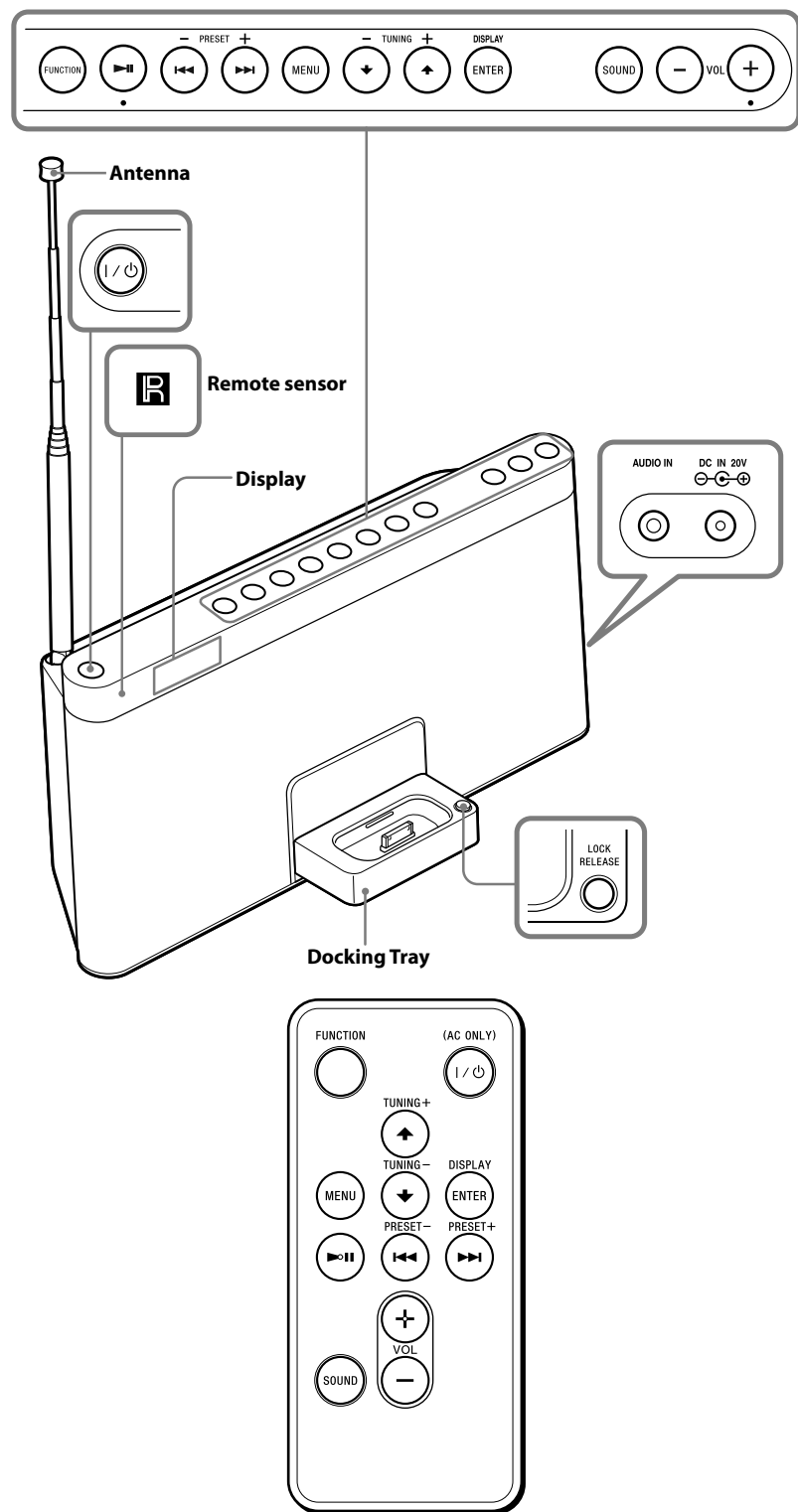

VOL + and ►II on the unit and the remote commander have a tactile dot.

## Before using the unit

### To turn on/off the power

Press I/⏻ (power). I/⏻ (power) button indicator will light up in green when the unit is turned on.

### To adjust the volume

Press VOL +/-.

#### Notes

- While the unit is turned off, only the I/⏻ (power) button will function.

### Power management system

After playback of the iPod (or component connected to AUDIO IN jack) has finished, if no operation is performed for about 20 minutes, the unit will automatically turn off.

#### Notes

- While the unit is turned on, if no operation is performed for more than about 30 seconds, the display turns off. In this case, press DISPLAY to turn on the display again.
- The unit cannot be turned on with the remote commander when the AC power adaptor is disconnected.

### Power off hold function

You can set the power off hold function in order to avoid unintentional powering on while carrying the unit.

#### To set the power off hold function

Press and hold I/⏻ (power) when the AC power adaptor is disconnected.

“HOLD” flashes 2 times and the display turns off. The unit cannot be turned on by pressing I/⏻ (power) while the power off hold function is set.

#### To cancel the power off hold function

Press and hold I/⏻ (power). “RELEASE” flashes 2 times and the power off hold function is canceled. The unit will turn on automatically.

#### Tip

- The power off hold function will be canceled if you connect the AC power adaptor to the unit.

## To set the iPod

- Press **PUSH OPEN** on the Docking Tray at the front of this unit to open.  
The tray clicks to lock at the open position.

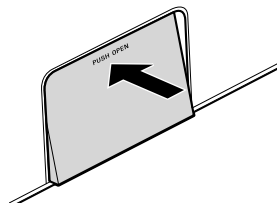

- Attach the adapter for your iPod/iPhone.

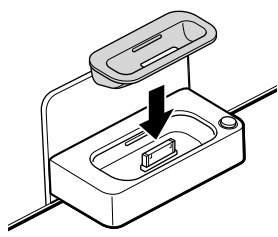

- Set your iPod/iPhone in the tray.

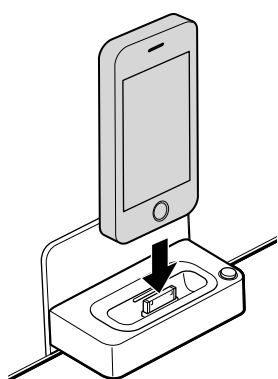

#### Tip

- Remove the case or cover from your iPod before setting it in the tray to ensure a stable connection.

### To close the Docking Tray

Press and hold **LOCK RELEASE** on the corner of the Docking Tray and close the tray.

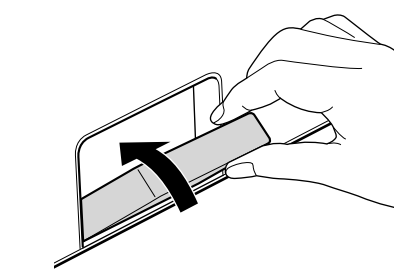
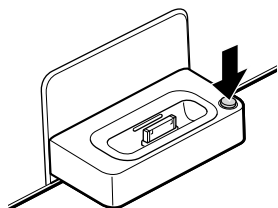

## Playing an iPod

- Press I/⏻ (power).
- Press **FUNCTION** repeatedly until “iPod” appears in the display.



- Press ►II.

The iPod begins to play back.

You can operate the connected iPod by this unit or the buttons on iPod.

To	Press
Turn off the iPod	Press and hold ►II.
Pause playback	►II To resume play, press again.
Go to the next track	►►1 (forward)
Go back to the previous track	◄◄1 (backward)*
Locate a point while listening to the sound	►►1 (forward) or ◄◄1 (backward) while playing and hold until you find the point.
Locate a point while observing the display on iPod	►►1 (forward) or ◄◄1 (backward) in pause and hold until you find the point.
Go back to the previous menu	<b>MENU</b>
Select a menu item or a track for playback	♦ (up)/♦ (down)
Execute the selected menu item or begin playback	<b>ENTER</b>

\* During playback, this operation returns you to the beginning of the current track. To go back to the previous track, press twice.

#### Notes

- When placing or removing the iPod, hold the iPod at the same angle as that of the connector on this unit, and do not twist or bend the iPod as connector damage may result.
- Do not carry the unit with an iPod set on the connector. Doing so may cause a malfunction.
- When placing or removing the iPod, hold the Docking Tray securely.
- Before disconnecting the iPod, pause playback.

### On copyrights

iPhone, iPod, iPod classic, iPod nano, and iPod touch are trademarks of Apple Inc., registered in the U.S. and other countries. “Made for iPod,” and “Made for iPhone” mean that an electronic accessory has been designed to connect specifically to iPod or iPhone, respectively, and has been certified by the developer to meet Apple performance standards. Apple is not responsible for the operation of this device or its compliance with safety and regulatory standards. Please note that the use of this accessory with iPod or iPhone may affect wireless performance.

### To use this unit as a battery charger for your iPod

You can use the unit as a battery charger for your iPod. Charge your iPod when the AC power adaptor is connected.

The charging status appears in the display of iPod. For details, see the user’s guide of your iPod.

#### Tip

- You can also charge your iPod without the AC power adaptor by pressing **FUNCTION** to select “iPod” when the battery indicator shows Level 1 or Level 2.

## Listening to the radio

- Press I/⏻ (power).
- Press **FUNCTION** repeatedly until “RADIO” appears in the display.



Frequency digits appear in the display after a short period.

- Press and hold **TUNING +/-** until the frequency digits begin to change in the display.  
The unit automatically scans the radio frequencies and stops when it finds a clear station.  
If you cannot tune in a station, press **TUNING +/-** repeatedly to change the frequency step-by-step.  
When an FM stereo broadcast is received, “STEREO” appears.



#### Tips

- If you touch or operate an iPod connected to this unit while listening to the radio, noise may occur. Avoid touching or operating the iPod in this case.
- If you are listening to the radio with an iPhone connected to the unit, interference with radio reception may occur. Remove the iPhone in this case.

### To improve the reception

Extend the telescopic antenna to its full length and adjust the angle for best reception.



#### Note

- Adjust the direction of the antenna by holding the bottom of it. The antenna can be damaged if you move the antenna with excessive force.

## Presetting radio stations

You can preset up to 20 radio stations in the unit’s memory.

- Press **MENU**.
- Press **↑/↓** to select “AUTO PRESET,” and press **ENTER**.

The stations are stored in memory from the lower frequencies to the higher ones automatically.



#### Tip

- To go back to the previous status, press **MENU** before pressing **ENTER** to set.

### If a station cannot be preset automatically

You may need to preset a station with a weak signal manually.

- Tune in the station you want.
- Press **MENU**.
- Press **↑/↓** to select “PRESET,” and press **ENTER**.



- Press **↑/↓** to select the desired preset number, and press **ENTER**.

The new station replaces the old one.



#### Tip

- To go back to the previous status, press **MENU** before pressing **ENTER** to set in step 4.

### To play preset radio stations

Press **PRESET +/-** to tune in a stored station.



## Setting an FM stereo broadcast to monaural sound

You can set an FM stereo broadcast to monaural sound, if FM reception is noisy.

- Press **MENU**.
- Press **↑/↓** to select “ST/MONO,” and press **ENTER**.



- Press **↑/↓** to select “MONO,” and press **ENTER**.



The FM broadcast will play in monaural.

#### Tips

- For stereo sound, select “STEREO” in step 3.
- To go back to the previous status, press **MENU** before pressing **ENTER** to set in step 3.



## Connecting optional components

You can enjoy the sound from an optional component such as a portable digital music player through the speakers of this unit. Be sure to turn off the power of each component before making any connections. For details, refer to the instruction manual of the component to be connected.

- Connect the **AUDIO IN** jack on the back of the unit to the line output jack of the portable digital music player or other component using an audio connecting cable.
- Press I/⏻ (power) to turn on the unit.
- Turn the connected component on.

- Press **FUNCTION** repeatedly until “AUDIO IN” appears in the display.

The sound from the connected component is output from the speakers of this unit.

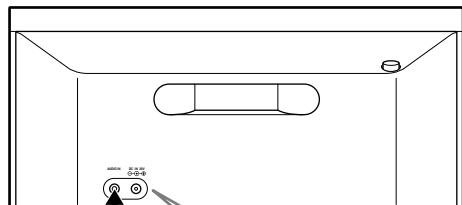

#### Notes

- Refer also to the connected equipment’s manual.
- The supplied audio connecting cable may not be usable with some external equipment. In this case, use a cord suitable for the external equipment you are using.
- If you listen to the radio with external equipment connected, turn off the connected equipment to prevent noise. If noise occurs, even when the equipment is turned off, disconnect and place the external equipment away from the unit.

## Selecting audio emphasis (equalization)

You can adjust the emphasis of the sound. Press **SOUND** repeatedly to select the desired audio emphasis.



## Troubleshooting

### General

**The power will not turn on when the AC power adaptor is connected.**

- Make sure the AC power adaptor is connected to the wall outlet firmly.

**The power will not turn on when the AC power adaptor is disconnected.**

- The power off hold function may be set. In this case, cancel the power off hold function. (See “Power off hold function.”)
- The rechargeable battery may be depleted. In this case, connect to the AC power adaptor to charge the battery. (See “Preparing a power source.”)

**The buttons on the unit do not function.**

- When the unit is turned off, only the I/⏻ (power) button functions. Turn on the unit before operation.

**The rechargeable battery is depleted.**

- Connect to the AC power adaptor to charge the battery.

**There is no audio.**

- Adjust the **VOL +/-**.

**Noise is heard.**

- Ensure that the unit is not in the vicinity of in-use portable phones, etc.

**The display turns off.**

- If no operation is performed for more than 30 seconds, the display turns off. Press **DISPLAY** to turn on the display again.

**“ERROR” appears in the display and the unit turns off automatically.**

- If this symptom occurs frequently, consult your nearest Sony dealer.

### iPod

**There is no audio.**

- Make sure the iPod is connected firmly.

**Operation is not performed.**

- Make sure the iPod is connected firmly.

**The iPod cannot be charged when the AC power adaptor is disconnected.**

- You cannot charge the iPod when the battery power of the unit is low.

**The Docking Tray cannot be closed.**

- Press and hold the **LOCK RELEASE** while closing the Docking Tray.

### Radio

**Reception is poor.**

- Extend the antenna to its full length, and orientate for best FM reception.

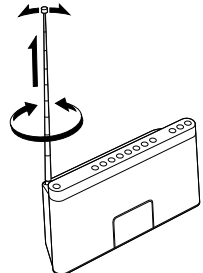

**The audio is weak or is of poor quality.**

- Move the unit away from the TV.

**The TV picture is unstable.**

- If you are listening to an FM program near the TV with an indoor antenna, move the unit away from the TV.

### Remote

**The remote does not function.**

- The unit cannot be turned on with the remote commander when the AC power adaptor is disconnected. In this case, press I/⏻ (power) on the unit to turn on.
- Replace the battery in the remote commander with a new one if it is weak.
- Make sure that you are pointing the remote at the remote sensor on the unit.
- Remove any obstacles in the path of the remote and the unit.
- Make sure the remote sensor is not exposed to strong light such as direct sunlight or fluorescent lamp light.
- Move closer to the unit when using the remote.

If the problem persists, consult your nearest Sony dealer.

## Specifications

### AUDIO POWER SPECIFICATIONS

POWER OUTPUT AND TOTAL HARMONIC

DISTORTION:

With 4 ohm loads both channels driven, from 150 Hz -10,000 Hz; rated 18 watts per channel minimum RMS power, with no more than 10 % total harmonic distortion.

### Section for iPod

DC out: 5V

MAX: 500mA

### Radio section

Band	Frequency	Channel step
FM	87.5 MHz – 108 MHz	0.1 MHz

### General

#### Speaker

Approx. 7.6 cm (3 inches) dia. 4 Ω

#### Input

AUDIO IN jack (ø 3.5 mm stereo minijack)

#### Power output

20 W + 20 W (at 1% harmonic distortion)

(With the AC power adaptor)

#### Power requirements

Rechargeable battery pack:

NH - 2000 RDP

#### Battery life

See “Battery life” of “Using the rechargeable battery” for details.

#### External power source

DC IN 20V

#### Dimensions

Approx. 356.0 mm × 162.8 mm × 119.7 mm (w/h/d)

(14 1/16 inches × 6 7/16 inches × 4 3/4 inches)

#### Mass

Approx. 1.9 kg (4 lb 3 oz)

#### Supplied accessories

Remote commander (1)

AC power adaptor (1)

AC power cord (1)

Audio connecting cable (1)

Universal Dock Adapter for iPhone (1)

Universal Dock Adapter for iPhone 3G & iPhone 3GS (1)

Universal Dock Adapter for iPhone 4 (1)

Design and specifications are subject to change without notice.

## Compatible iPod/iPhone models

Compatible iPod/iPhone models are as follows. Update your iPod/iPhone to use the latest software before you use it.

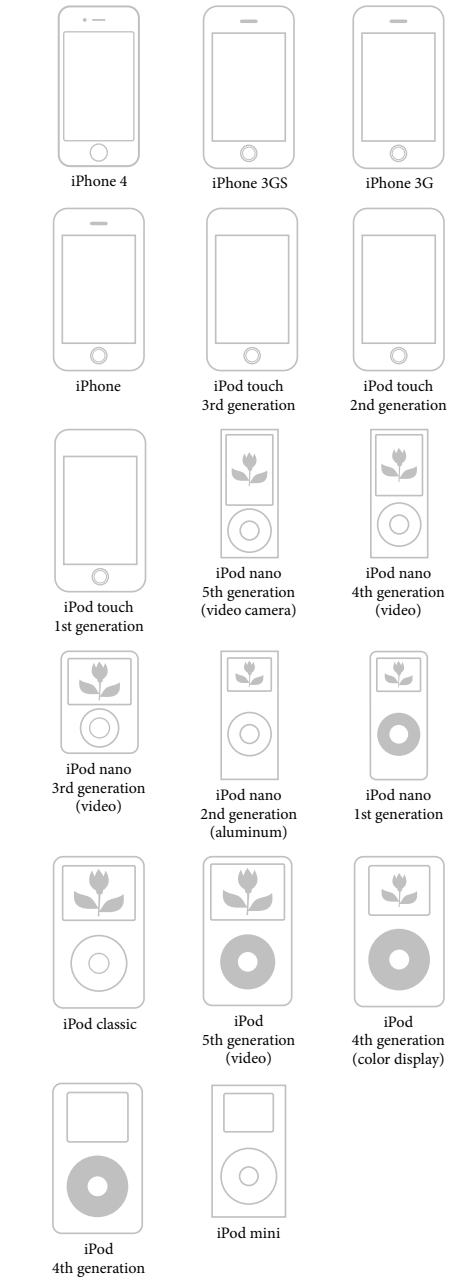

#### Notes

- In these Operating Instructions, “iPod” is used as a general reference to iPod functions on an iPod or iPhone, unless otherwise specified by the text or illustrations.
- The connector of the unit is solely for use with an iPod. If you use devices that do not have the same connector, connect to the **AUDIO IN** jack of this unit with the supplied audio connecting cable.
- Sony cannot accept responsibility in the event that data recorded to an iPod is lost or damaged when using an iPod connected to this unit.

## Free Manuals Download Website

<http://myh66.com>

<http://usermanuals.us>

<http://www.somanuals.com>

<http://www.4manuals.cc>

<http://www.manual-lib.com>

<http://www.404manual.com>

<http://www.luxmanual.com>

<http://aubethermostatmanual.com>

Golf course search by state

<http://golfingnear.com>

Email search by domain

<http://emailbydomain.com>

Auto manuals search

<http://auto.somanuals.com>

TV manuals search

<http://tv.somanuals.com>