

SONY®

2-653-429-12 (1)

D-NE830/NE830LS

Operating Instructions

ATRAC CD Walkman

Portable CD Player



ATRAC



WALKMAN

WARNING

To reduce the risk of fire or electric shock, do not expose this apparatus to rain or moisture.

Do not install the appliance in a confined space, such as a bookcase or built-in cabinet.

To reduce the risk of fire, do not cover the ventilation of the apparatus with newspapers, table-cloths, curtains, etc. And do not place lighted candles on the apparatus.

To reduce the risk of fire or electric shock, do not place objects filled with liquids, such as vases, on the apparatus.

CAUTION

The use of optical instruments with this product will increase eye hazard.

Certain countries may regulate disposal of the battery used to power this product. Please consult with your local authority.

CAUTION

- INVISIBLE LASER RADIATION WHEN OPEN
- DO NOT STARE INTO BEAM OR VIEW DIRECTLY WITH OPTICAL INSTRUMENTS
- CLASS 1M INVISIBLE LASER RADIATION WHEN OPEN
- DO NOT VIEW DIRECTLY WITH OPTICAL INSTRUMENTS

The validity of the CE marking is restricted to only those countries where it is legally enforced, mainly in the countries EEA (European Economic Area).

Disposal of Old Electrical & Electronic Equipment (Applicable in the European Union and other European countries with separate collection systems)



This symbol on the product or on its packaging indicates that this product shall not be treated as household waste. Instead it shall be handed over to the applicable collection point for the recycling of electrical and electronic equipment. By ensuring this product is disposed of correctly, you will help prevent potential negative consequences for the environment and human health, which could otherwise be caused by inappropriate waste handling of this product. The recycling of materials will help to conserve natural resources. For more detailed information about recycling of this product, please contact your local Civic Office, your household waste disposal service or the shop where you purchased the product.
Applicable Accessories: Headphones, remote control

Table of Contents

Create Your Own ATRAC CDs	4
Which discs can you play on this CD player?	5
Precautions	7
On safety	7
On the CD player	7
On handling CDs	7
On headphones	7

Getting Started

Checking the Supplied Accessories	8
Guide to Parts and Controls	9
Preparing a Power Source (Rechargeable Battery)	11
When using a dry battery	12
Checking the remaining power of the battery	13
When using the AC power adaptor.....	14

Playback

Playing a CD	15
Basic playback operations (Play, stop, search)	16
Locking the controls (HOLD)	17
Searching for Your Favorite Track/File .	17
Searching by viewing a list of groups/files (List View)	17
Checking CD information on the display.	18
Changing Playback Options (PLAY MODE)	19
Playback options (PLAY MODE)	20
Playing groups.....	21
Playing your favorite tracks (Bookmark play).....	21
Playing your favorite play lists (m3u play list play).....	21
Playing tracks in your favorite order (PGM play).....	22
Playing tracks repeatedly (Repeat play)...	22

Changing Sound Quality	23
Selecting the sound quality	23
Customizing sound quality	23
SOUND items	24
Changing Optional Settings	25
Setting various functions	25
OPTION items	26
Connecting Other Devices	29

Additional Information

Troubleshooting	30
Maintenance	34
Specifications	34
Optional Accessories	35
SonicStage Download Website	35
Index	36

Instructions in this manual mainly describe the controls on the remote.

Depending on the region in which you use the player, indications displayed on your remote may be slightly different from those shown in the Operating Instructions.

About trademarks

“WALKMAN” is a registered trademark of Sony Corporation to represent Headphone Stereo products.  is a trademark of Sony Corporation.

SonicStage is a trademark of Sony Corporation.

ATRAC, ATRAC3, ATRAC3plus and ATRAC Advanced Lossless are trademarks of Sony Corporation.

Create Your Own ATRAC CDs

In addition to the regular audio CDs, you can play original CDs (“ATRAC” CDs) that you created with the SonicStage software. Using SonicStage, about 30 audio CDs* can be recorded on one CD-R or CD-RW. SonicStage can be downloaded free of charge.

The following is a quick overview of how you listen to music on your ATRAC CD.

Install SonicStage on your computer.

SonicStage is a software product that takes music from audio CDs or downloaded from the Internet onto your computer to create your own original CDs. SonicStage can be downloaded from the specified site (☞ page 35) and installed on your computer.

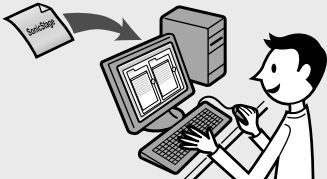

Create an ATRAC CD.

After selecting your favorite songs from music stored on your computer, record them on a CD-R/CD-RW using SonicStage.

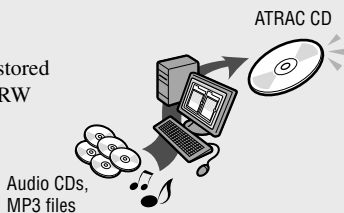

Listen to them with this CD player.

You can take lots of songs wherever you go on your original CD.



- The appropriate system environment to access the Internet is required. For details, refer to the instruction manual of your computer.
- For how to install SonicStage and how to create an ATRAC CD, visit and get information from the specified site for downloading SonicStage. You can also check the SonicStage help section.

* When the total playing time of one CD (album) is estimated at 60 minutes and you are recording on a 700 MB CD-R/CD-RW at 48 kbps in ATRAC format.

For customers who purchased the models supplied with the SonicStage (CD-ROM)

- You can install SonicStage from the supplied CD-ROM.
- Please see the supplied “Installation/Operating Guide” for how to install SonicStage and how to create ATRAC CDs.

Which discs can you play on this CD player?



Audio CDs:

CD-DA format CDs

CD-DA (Compact Disc Digital Audio) is a recording standard used for Audio CDs.



ATRAC CDs:

CD-R/CD-RW on which audio data compressed in the ATRAC format has been recorded*

ATRAC is the general term used to refer to Sony Corporation audio codec technologies ATRAC3, ATRAC3plus, and ATRAC Advanced Lossless**. ATRAC3 and ATRAC3plus, with their high quality compression ratio, and ATRAC Advanced Lossless**, with its no-data-loss compression, combine to provide a vast array of possibilities.

** This player is not compatible with ATRAC Advanced Lossless.

Bit rates and sampling frequencies this CD player can play are:

	Bit rates	Sampling frequencies
ATRAC3	66/105/132 kbps	44.1 kHz
ATRAC3plus	48/64/256 kbps	44.1 kHz

Information (track name, album name, artist name, etc.) of up to 62-characters can be displayed on this CD player.



MP3 CDs:

CD-R/CD-RW on which audio data compressed in the MP3 format has been recorded*

Bit rates and sampling frequencies this CD player can play are shown below. Variable Bit Rate (VBR) files can also be played.

	Bit rates	Sampling frequencies
MPEG-1 Layer3	32 - 320 kbps	32/44.1/48 kHz
MPEG-2 Layer3	8 - 160 kbps	16/22.05/24 kHz
MPEG-2.5 Layer3	8 - 160 kbps	8/11.025/12 kHz

This CD player conforms to Version 1.0/1.1/2.2/2.3/2.4 of the ID3 tag format. ID3 tag is a format for adding certain information (track name, album name, artist name, etc.) to MP3 files. Up to 64 characters of ID3 tag information can be displayed on this CD player.



CD-Extra and Mix-Mode CDs:

CD-R/CD-RW on which CD-DA format data and CD-ROM format data are recorded together.*

If you cannot play your CD, change the “CD-EXTRA” setting (Ⓢ page 27). Then you may play your CD.

An ATRAC CD on which audio data compressed in the MP3 format has been recorded using software other than SonicStage can also be played.

With SonicStage, you cannot create a CD on which mixed format audio data is recorded.

* Only ISO 9660 Level 1/2 and Joliet extension format discs can be played.

Continued

Music discs encoded with copyright protection technologies

This product is designed to play back discs that conform to the Compact Disc (CD) standard. Recently, various music discs encoded with copyright protection technologies are marketed by some record companies. Please be aware that among those discs, there are some that do not conform to the CD standard and may not be playable by this product.

Note on DualDiscs

A DualDisc is a two sided disc product which mates DVD recorded material on one side with digital audio material on the other side. However, since the audio material side does not conform to the Compact Disc (CD) standard, playback on this product is not guaranteed.

Difference in File structures of ATRAC CDs and MP3 CDs

ATRAC CDs and MP3 CDs consist of “files” and “groups.” A “file” is equivalent to a “track” of an audio CD. A “group” is a bundle of files and is equivalent to an “album.”

For MP3 CDs, this CD player recognizes an MP3 folder as a “group” so that ATRAC CDs and MP3 CDs can be operated in the same way.

The usable number of groups and files

- Maximum number of groups: 256
- Maximum number of files: 999

Playing order of ATRAC CDs and MP3 CDs

For ATRAC CDs, files are played in the order selected in SonicStage.

For MP3 CDs, the playing order may differ depending on the method used to record MP3 files on the disc. A “play list” which contains an MP3 file playing order can also be played. In the following example, files are played in order of ① to ⑦.

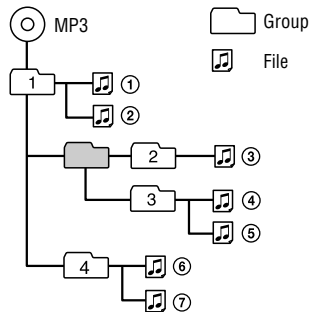

(Maximum directory levels: 8)

Notes

- If **ATRAC** files and MP3 files are recorded on the same CD, this CD player plays the **ATRAC** files first.
- The playback capability of this CD player may vary depending on the quality of the disc and the condition of the recording device.
- Acceptable characters are A to Z, a to z, 0 to 9, and _ (underscore).
- On a disc that has **ATRAC**/MP3 files, do not save files in other formats and do not make unnecessary folders.

About ATRAC CDs

- CD-Rs/CD-RWs recorded in the **ATRAC** format cannot be played on your computer.

About MP3 CDs

- Be sure to add the file extension “mp3” to the file name. However, if you add the extension “mp3” to a file other than an MP3 file, the player will not be able to recognize the file properly.
- To compress a source in an MP3 file, we recommend setting the compression parameters to “44.1 kHz,” “128 kbps,” and “Constant Bit Rate.”
- To record up to the maximum capacity, set the writing software to “halting of writing.”
- To record up to the maximum capacity at one time on media that has nothing recorded on it, set the writing software to “Disc at Once.”

Precautions

On safety

- Should any solid objects or liquid fall into the CD player, unplug it and have it checked by qualified personnel before operating it any further.
- Do not put any foreign objects in the DC IN 3 V (external power input) jack.

On the CD player

- Keep the lens on the CD player clean and do not touch it. If you do so, the lens may be damaged and the CD player will not operate properly.
- Do not put any heavy object on top of the CD player. The CD player and the CD may be damaged.
- Do not leave the CD player in a location near heat sources, or in a place subject to direct sunlight, excessive dust or sand, moisture, rain, mechanical shock, unlevelled surface, or in a car with its windows closed.
- If the CD player causes interference to the radio or television reception, turn off the CD player or move it away from the radio or television.
- Discs with non-standard shapes (e.g., heart, square, star) cannot be played on this CD player. Attempting to do so may damage the CD player. Do not use such discs.

On handling CDs

- To keep the CD clean, handle it by its edge. Do not touch the surface.
- Do not stick paper or tape onto the CD.
- Do not expose the CD to direct sunlight or heat sources such as hot air ducts. Do not leave the CD in a car parked under direct sunlight.

On headphones

Road safety

Do not use headphones while driving, cycling, or operating any motorized vehicle. It may create a traffic hazard and is illegal in some areas. It can also be potentially dangerous to play your headsets at high volume while walking, especially at pedestrian crossings. You should exercise extreme caution or discontinue use in potentially hazardous situations.

Preventing hearing damage

Avoid using headphones at high volume. Hearing experts advise against continuous, loud and extended play. If you experience a ringing in your ears, reduce volume or discontinue use.

Consideration for others

Keep the volume at a moderate level. This will allow you to hear outside sounds and to be considerate to the people around you.

Checking the Supplied Accessories

- AC power adaptor (AC-ES3010K2) (1)

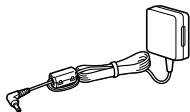

- External battery case (1)

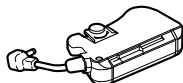

- Rechargeable battery (1)



- Battery carrying case (1)

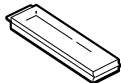

- Carrying Pouch (1)



- Headphones (1)



- Remote control (Remote) (1)
(For this CD player only)



- Operating instructions (1)
- AC plug adaptor (Supplied with tourist model) (1)

Note

Use only the supplied remote. You cannot operate this player with any other remote.

To connect your headphones to the remote

Connect the plug of your headphones to the remote securely.

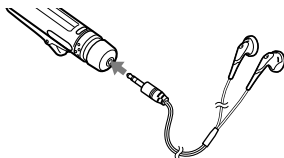

To use the clip of the remote

You can change the direction of the clip. Turn the clip as shown below. You can also reverse the direction of the track name, etc. (Ⓜpage 25, 27).

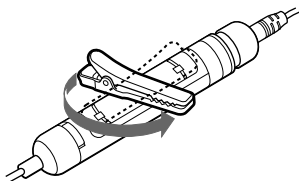

Guide to Parts and Controls

CD player (rear)

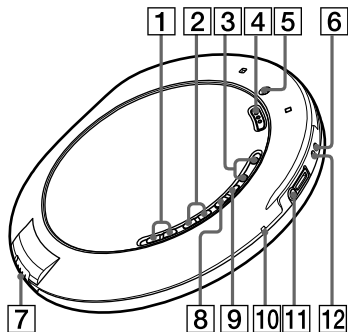

Remote

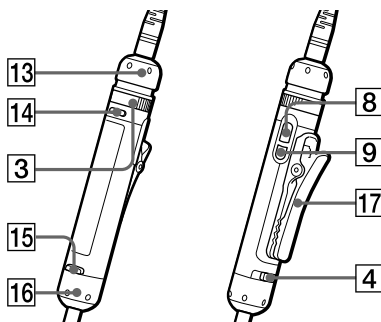

- 1 (group) +/- buttons (☞ page 16)
- 2 buttons (☞ page 16)
- 3 CD Player:
VOL (Volume) +/- buttons (☞ page 15)
Remote:
VOL (Volume) +/- control
(☞ page 15, 17, 22, 23)
- 4 HOLD switch (☞ page 17)
- 5 Screw hole for the external battery case
(☞ page 12, 13)
- 6 EXT BATT jack (☞ page 12, 13)
- 7 OPEN switch (☞ page 11, 15)
- 8 (play/pause)* button (☞ page 15-17,
19, 21-23)
- 9 CD Player:
■ (stop)/CHG button (☞ page 11, 16)
Remote:
■ (stop) button (☞ page 16, 23, 24, 26)
- 10 OPR (Operation) lamp (☞ page 11, 12,
15, 17)
- 11 (headphones)/LINE OUT jack (☞ page
15, 29)
- 12 DC IN 3V jack (☞ page 11, 14)
- 13 Operation dial (☞ page 16, 17, 21-23, 25)
- 14 SEARCH button (☞ page 17)
- 15 Function button (☞ page 18, 19, 22, 23,
25)
- 16 Function dial (☞ page 18, 19, 22, 23, 25)
- 17 Clip (☞ page 8)

* This button has a tactile dot.

Continued

Remote display

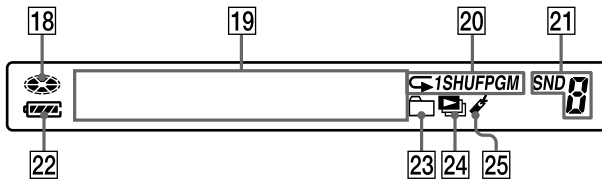

- 18 Disc indicator (☞ page 15)
- 19 Character information display (☞ page 18)
- 20 Play mode indicator (☞ page 20-22)
- 21 Sound indicator (☞ page 23)
- 22 Battery indicator (☞ page 11, 13)
- 23 Group indicator (☞ page 20, 21)
- 24 Play list indicator (☞ page 20, 21)
- 25 Bookmark indicator (☞ page 20, 21)

Preparing a Power Source (Rechargeable Battery)

Charge the rechargeable battery before using it for the first time or when it is depleted. To maintain the original battery capacity longer, charge the battery only when it is completely depleted ("Lo Batt" appears on the display).

- 1 Slide the OPEN switch to open the lid of your player.

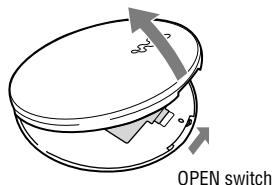

- 2 Open the battery compartment lid inside the player.

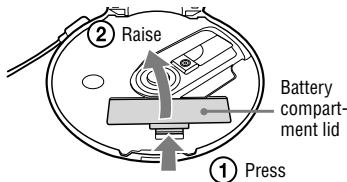

- 3 Insert the NH-14WM rechargeable battery (supplied) matching the ⊕ end of the battery to the ⊕ diagram in the battery compartment and close the lids of the battery compartment and the player until they click into place.

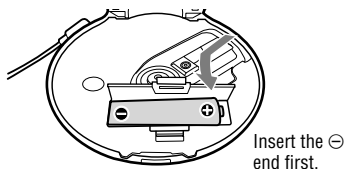

- 4 Connect the AC power adaptor to the DC IN 3 V jack of your CD player and an AC outlet, then press ■/CHG to start charging.

The OPR lamp on the CD player flashes, then lights up.

When the remote is connected, "Charging" flashes and the indicator sections of  (battery) light up in succession in the remote display.

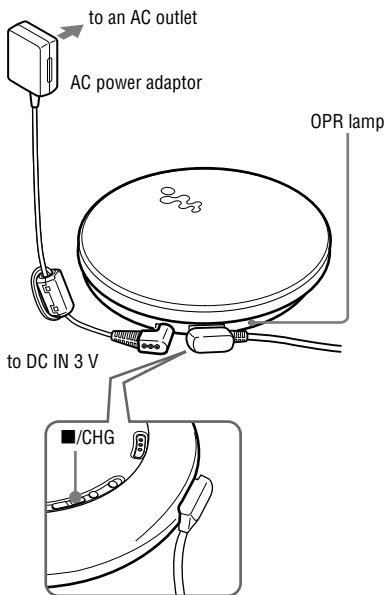

When the battery is completely charged, the OPR lamp goes off and "Charging" disappears.

Continued 

Notes

- Do not charge any rechargeable battery other than an NH-14WM (supplied) or NH-10WM (not supplied) using this AC power adaptor.
- If you press ►|| during charging, charging stops and playback of the CD starts.
- If you connect the AC power adaptor to the player during playback, play stops.
- During charging, the player and the rechargeable battery become hot. This poses no danger.
- Take out the rechargeable battery when the player is not to be used for a long time.

To remove the rechargeable battery

Push the ⊖ end of the rechargeable battery.

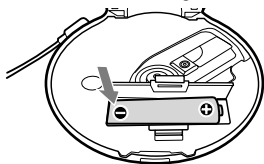

Note on the useful life of the rechargeable battery and when to replace it

If the battery is new or has not been used for a long time, it may not charge completely. In that case, charge it until the OPR lamp goes off and then use the player until the battery is completely depleted (“Lo Batt” appears on the display). Repeat this procedure several times.

When the battery life is still shorter by about half of a normal charge after trying this procedure, replace the battery with a new rechargeable battery.

Note on carrying the rechargeable battery

Use the supplied battery carrying case to protect against unexpected heat. If the rechargeable battery comes into contact with the metallic objects, heat or fire may occur due to a short circuit.

When using a dry battery

You can extend the power available by using a dry battery, together with a rechargeable battery by attaching the external battery case. Make sure to remove the AC power adaptor when attaching the external battery case. The battery in the player and that in the external battery case are discharged simultaneously.

Notes

- When using the rechargeable battery and dry battery together to extend power, use a fully charged rechargeable battery and new dry battery.
- When you use the CD player on battery power, use an alkaline battery only. If you use any other type of battery, the player may not give its full performance. A decrease in battery life, etc. may occur.

- 1** Insert an LR6 (size AA) alkaline battery (not supplied) by matching the ⊕ to the diagram inside the battery case and close the battery case lid.

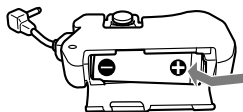

- 2** Attach the battery case to the player securely and fasten the screw in the direction of LOCK. Connect the battery case to EXT BATT jack.

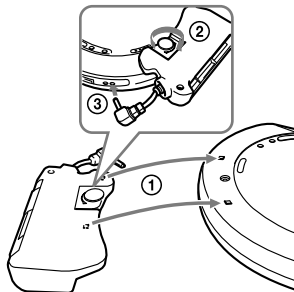

To remove the external battery case

Unfasten the screw in the direction of RELEASE. Then, disconnect the battery case from EXT BATT jack.

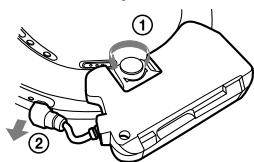

Checking the remaining power of the battery

The remaining power of the battery is indicated in the display as shown below. As the black indicator section decreases, the remaining power is depleted further.

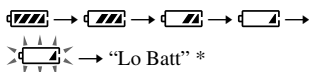

* Beep sounds.

When the battery is depleted, charge the rechargeable battery or replace the dry battery with a new one.

Notes

- The display shows the approximate battery power remaining. For example, one section does not always indicate one-fourth of the battery power.
- Depending on the operating conditions, the display may increase or decrease relative to the actual power remaining.

Battery life ¹⁾

When using one NH-14WM rechargeable battery (charged for about 5 hours ²⁾)

	G-PROTECTION	
	"1"	"2"
Audio CD	16	14
ATRAC CD ³⁾	40	40
MP3 CD ⁴⁾	26	26

When using the external battery case (one alkaline battery ⁵⁾)

	G-PROTECTION	
	"1"	"2"
Audio CD	24	21
ATRAC CD ³⁾	61	61
MP3 CD ⁴⁾	41	41

When using one NH-14WM rechargeable battery and the external battery case (one alkaline battery ⁵⁾)

	G-PROTECTION	
	"1"	"2"
Audio CD	42	38
ATRAC CD ³⁾	105	105
MP3 CD ⁴⁾	73	73

1) Measured value using the JEITA (Japan Electronics and Information Technology Industries Association)

Playing time shown is approximate hours, when you use the player on a flat and stable surface and "POWER SAVE" is set to "2" (Ⓞpage 27). This value varies depending on how the player is used.

2) Charging time varies depending on how the rechargeable battery is used.

3) Recorded at 48 kbps

4) Recorded at 128 kbps

5) When using a Sony LR6 (SG) alkaline battery (produced in Japan)

Continued ➞

Notes on rechargeable batteries and dry batteries

- Do not charge dry batteries.
- Do not throw the batteries into a fire.
- Do not carry batteries in a pocket, etc. with coins or other metallic objects. The battery can generate heat if its positive and negative terminals are accidentally allowed to come into contact with a metallic object.
- Do not mix rechargeable batteries with dry batteries.
- Do not mix new batteries with old ones.
- Do not use different types of batteries together.
- When the batteries are not to be used for a long time, remove them.
- If battery leakage occurs, wipe off any deposit left in the battery compartment, and install new batteries. If the deposit adheres to your skin, wash it off thoroughly.

When using the AC power adaptor

You can use the player powered by the AC power adaptor without battery.

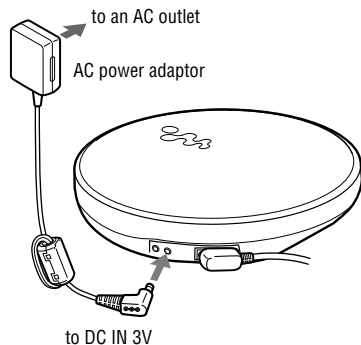

- 1** Connect the AC power adaptor to the DC IN 3V jack of your CD player and an AC outlet.

Notes on the AC power adaptor

- Disconnect all power sources when the player is not to be used for a long time.
- Use only the AC power adaptor supplied. If your player is not supplied with an AC power adaptor, use an AC-E30HG AC power adaptor*. Do not use any other AC power adaptor. It may cause a malfunction.

* Not available in Australia and some other regions. Ask your dealer for detailed information.

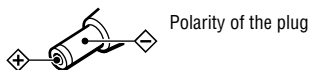

- Do not touch the AC power adaptor with wet hands.
- Connect the AC power adaptor to an easily accessible AC outlet. Should you notice an abnormality in the AC power adaptor, disconnect it from the AC outlet immediately.

Playing a CD

1 Slide the OPEN switch to open the player lid.

Connect the headphones with the remote to the player beforehand.

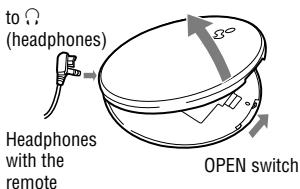

2 Place the CD on the tray and close the lid.

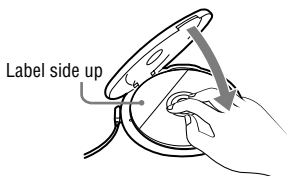

The OPR lamp lights up repetitively in red, orange and green, in turn.

3 Press ►|| on the remote.

 (disc) moves, and the player starts playback.

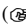
Color of the OPR lamp changes according to the format type of the music source ( page 5) being played. Red: CD-DA format, Green: ATRAC format and Orange: MP3 format.



4 Adjust the volume by turning the VOL +/- control on the remote.

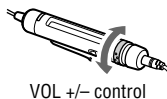

VOL +/- control

On the CD player

After placing the CD on the tray in step 2, press ►|| and adjust the volume by pressing VOL +/-.

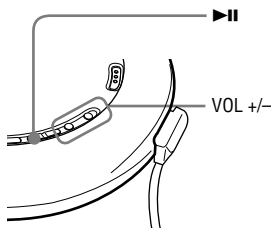

To remove the CD

Remove the CD while pressing the pivot in the center of the tray.

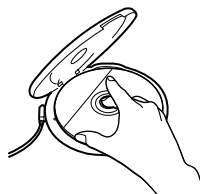

Continued 

Basic playback operations (Play, stop, search)

Remote

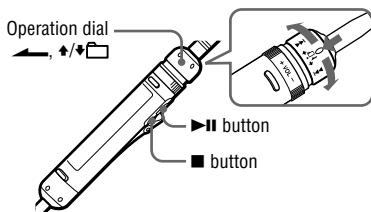

To		Operation on the remote (Operation on the player is in parentheses)
Play	Play from the first track	From stop, press and hold ▶ until playback starts. (From stop, press and hold ▶ until playback starts.)
Stop	Pause/Resume play after pausing	Press ▶ . (Press ▶ .)
	Stop playback	Press ■ (stop). (Press ■/CHG.)
Search	Find the beginning of the current track ¹⁾	Turn the operation dial toward ◀◀ once. (Press ◀◀ once.)
	Find the beginning of previous tracks ¹⁾	Turn the operation dial toward ◀◀ repeatedly. (Press ◀◀ repeatedly.)
	Find the beginning of the next track ¹⁾	Turn the operation dial toward ▶▶ once. (Press ▶▶ once.)
	Find the beginning of succeeding tracks ¹⁾	Turn the operation dial toward ▶▶ repeatedly. (Press ▶▶ repeatedly.)
	Go backwards quickly ¹⁾	Turn the operation dial toward ◀◀ and hold it. (Press and hold ◀◀.)
	Go forward quickly ¹⁾	Turn the operation dial toward ▶▶ and hold it. (Press and hold ▶▶.)
	Jump to succeeding groups ²⁾	Turn the operation dial toward ◀◀ repeatedly while you keep the dial pressed in the direction of ◀. (Press ◀ (group) + repeatedly.)
	Jump to previous groups ²⁾	Turn the operation dial toward ▶▶ repeatedly while you keep the dial pressed in the direction of ▶. (Press ▶ (group) - repeatedly.)

1) You can operate during both play and pause.

2) You can operate during play of a CD other than audio CDs.

Locking the controls (HOLD)

You can prevent accidental button presses while carrying the player by locking the controls. The OPR lamp flashes if you press any button when the HOLD function on the player is activated.

1 Slide the HOLD switch on the remote or on the player (on the back) in the direction of the arrow.

You can use the HOLD function for the remote and the player separately. For example, even if the HOLD function on the player is activated, you can operate the player by using the remote unless you set HOLD on the remote to on, too.

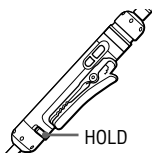

To unlock the controls

Slide the HOLD switch in the direction opposite to that of arrow.

Note

Even if the HOLD function is working, "HOLD" will not appear on the display of the remote.

Searching for Your Favorite Track/File

Searching by viewing a list of groups/files (List View)

You can search for a track/file by checking the format type of the music source and the names of groups and files.



1 Press SEARCH on the remote.

2 Turn the VOL +/- control to select a group, and then press ►II.

If you select a group on an MP3 CD, etc. by searching through all the directories, turn the operation dial toward ◀◀ or ▶▶.

3 Turn the VOL +/- control to select a file, and then press ►II.

The file you have selected starts playing.

To return to the previous screen

Turn the operation dial on the remote toward ◀◀, or turn the operation dial toward ◻◻ while you keep the dial pressed in the direction of ◀.

To cancel searching

Press ■ on the remote.

Continued ⇨

Checking CD information on the display

You can check CD information on the display of the remote.

Depending on the region in which you purchased your CD player, the default language may not be “ENGLISH.” Change the LANGUAGE setting, if necessary (Ⓢ page 26).

When you are playing an MP3 CD containing files with an ID3 tag, ID3 tag information is displayed. (When there is no ID3 tag information, file name or group name is displayed.) (Ⓢ page 5)

Notes

- The characters A-Z, a-z, 0-9, and _ can be displayed on this player.
- Before playing a file, the player reads all file and group (or folder) information on the CD. “Reading” is displayed. Depending on the content of the CD, it may take some time to accomplish this reading.
- If the file does not belong to any group, “MP3 ROOT” appears on the display.

To check information on the remote display

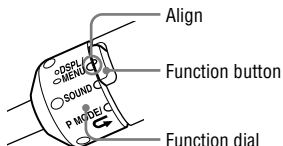

Turn the function dial on the remote to select DSPL/MENU and press the function button repeatedly.

Audio CD

Track number, elapsed playing time (Track name, artist name)¹⁾

001 01:02

Total number of the files on the CD, time remaining on the CD (Album name)¹⁾

012 -63:42

Animation screen



ATRAC CD/MP3 CD

File number, file name, artist name, elapsed playing time

001 In Your H

File number, album name, CODEC information²⁾, remaining time of the current file

001 Green Tre

Animation screen

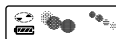

- 1)When you are playing an audio CD containing text information such as CD-TEXT, information in parentheses is displayed.
- 2)Bit rate and sampling frequencies are displayed. While an MP3 file made at VBR (variable bit rate) is being played, “VBR” appears on the display instead of a bit rate. In some cases, “VBR” appears halfway through playback, rather than from the beginning.

Changing Playback Options (PLAY MODE)

You can use various playback options such as selecting songs you want to listen to, and playing songs in your favorite order.

For details about playback options, see  page 20.

You can also play songs repeatedly using the playback options you choose (repeat play,  page 22).

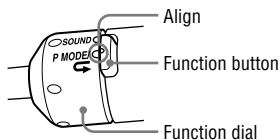

- 1 During play, turn the function dial on the remote to P MODE/↔ and press the function button repeatedly to select a playback option.**

The playback option you selected lights up or flashes.

If the playback option flashes, press **▶||**.

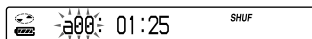





To return to normal play

Turn the function dial on the remote to P MODE/↔ and press the function button repeatedly until the playback option disappears.

Continued 

Playback options (PLAY MODE)

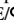
Display on the remote	Explanation
No indication	All tracks on the CD are played in a track number order. For the ATRAC CD/MP3 CD, a playing order is different according to the setting of the "PLAY ORDER."
	All files in the selected group or all groups are played (ATRAC CD/MP3 CD only) (☞ page 21).
1	The current track is played once.
SHUF	All tracks on the CD are played once in random order.
 SHUF	All files in the selected group are played once in random order (ATRAC CD/MP3 CD only) (☞ page 21).
	Tracks to which Bookmarks have been added are played. The play of tracks with Bookmarks starts in track number order, not in the order you added the Bookmarks (☞ page 21).
	Tracks in the selected m3u play list* are played (MP3 CD only) (☞ page 21).
a00	The tracks you have played most frequently from the CD are played from the 10th to the first.
a00 SHUF	Up to 32 tracks, which the player has automatically memorized as the most frequently played ones, are played in random order.
PGM	Up to 64 tracks are played in your favorite order (☞ page 22).
INTRO	About the first 10 seconds of all tracks which follow the current track are played once. If you turn the function dial to select P MODE/  , and press the function button during INTRO play, you can listen to the current track to the end.

*An m3u play list is a file in which an MP3 file playing order has been encoded. To use the play list function, record MP3 files on a CD-R/CD-RW using encoding software that supports the m3u format.

You can play the top 8 lists (listed by file name) on your screen.

Playing groups

1 In step 1 of “Changing Playback Options (PLAY MODE)” (☞ page 19), select “□” or “□SHUF.”

2 Turn the VOL +/- control to select a group.

If you select a group on an MP3 CD, etc. by searching through all the directories, turn the operation dial toward ◀◀ or ▶▶.

If you select a group within the same directory, turn the VOL +/- control.

3 Press ▶II for 2 seconds or more.

The player starts playback of all files in the group you have selected.

Note

If the group has no tracks, or the group is located in the lowest directory level, “Invalid” appears on the display.

Playing your favorite tracks (Bookmark play)

1 During play of the track to which you want to add a Bookmark, press and hold ▶II on the remote until ✎ flashes slowly.

2 If you want to add a Bookmark to two or more tracks, repeat step 1.

You can add Bookmarks to up to 10 CDs for audio CDs (up to 99 tracks for each CD) and up to 5 CDs* for ATRAC CDs/MP3 CDs (up to 999 tracks for each CD).

3 In the step 1 of “Changing Playback Options (PLAY MODE)” (☞ page 19), select ✎ (Bookmark).

4 Press ▶II.

To remove Bookmarks

During play of a track with a Bookmark, press and hold ▶II on the remote until ✎ disappears.

Notes

- If you try to add Bookmarks to tracks on an 11th CD (on a 6th CD* when playing ATRAC CDs/MP3 CDs), the Bookmarks of the CD you played first will be erased.
 - All Bookmarks stored in memory will be erased if you remove all power sources, or if you continue playing the player on the rechargeable battery while “Lo Batt” is displayed, without charging the battery.
- * When each CD has 513 tracks or more.

Playing your favorite play lists (m3u play list play)

1 In the step 1 of “Changing Playback Options (PLAY MODE)” (☞ page 19), select 📄 (play list).

2 Turn the operation dial on the remote toward ◀◀ or ▶▶ to select a play list you want.

3 Press ▶II.

Continued ➞

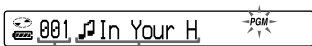

Playing tracks in your favorite order (PGM play)

- 1 While the player stopped, turn the function dial on the remote to select **P MODE**/ and press the function button repeatedly until “PGM” (program) flashes.

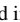

Playing order Track name or file name

- 2 Turn the **VOL +/-** control to select a track, and then press and hold **▶II** until the display changes.

When playing an ATRAC CD/MP3 CD:
You can also select a file in another group by turning the operation dial toward  or  while you keep the dial pressed in the direction of .

- 3 Repeat step 2 to select tracks in your favorite order.

You can select up to 64 tracks.
When you finish entering the 64th track, the track number selected first (audio CD)/file name (ATRAC CD/MP3 CD) appears on the display.
If you select 65 tracks or more, the tracks selected first are erased one by one.



- 4 Press **▶II**.

Playback starts in the selected order.

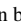
To check the program

- 1 While the player is stopped, turn the function dial on the remote to select **P MODE**/ and press the function button repeatedly until “PGM” flashes. Then, press and hold **▶II** on the remote until the display changes.
- 2 Whenever you press and hold **▶II** on the remote until the display changes, the tracks are displayed in playing order.



Playing tracks repeatedly (Repeat play)

- 1 Turn the function dial on the remote to select **P MODE**/ and press the function button repeatedly to select the playback option you want to repeat ( page 20).
-

- 2 Press and hold the function button until  (repeat) appears.

The playback option you have selected repeats.

To return to normal play

Turn the function dial on the remote to select **P MODE**/, and then press and hold the function button until  disappears.

Changing Sound Quality

For details about the setting of SOUND items, see  page 24.

Selecting the sound quality

You can set up the “EQUALIZER” setting and/or “CLEARBASS” setting. If you set both at the same time, you can enjoy more bass sound along with the sound quality you want.

1 Turn the function dial on the remote to select SOUND.

2 Press the function button repeatedly until “EQUALIZER” or “CLEARBASS” appears.

3 Press **▶II**.

4 Turn the operation dial toward **◀◀** or **▶▶** to select the sound quality you want.

5 Press **▶II**.

Customizing sound quality

You can adjust sound quality for each frequency range individually, checking the shape of the wave on the display.

1 Turn the function dial on the remote to select SOUND, and then press the function button repeatedly until “EQUALIZER” appears and press **▶II**.

2 Turn the operation dial toward **◀◀** or **▶▶** repeatedly to select “CUSTOM” and press **▶II**.

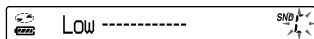

3 Turn and hold the operation dial toward **◀◀** or **▶▶** for 2 seconds or more until the frequency range you want to set up appears.

“Low” is displayed first.

There are 3 frequency ranges; “Low” (low range audio), “Mid” (middle range audio), and “Hi” (high range audio).

4 Turn the operation dial toward **◀◀** or **▶▶** repeatedly to select the shape of the wave.

There are 3 shapes stored in memory for each frequency range.

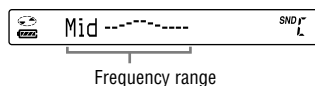

5 Turn the VOL +/- control repeatedly to select the sound volume.

The sound volume can be adjusted in 7 levels.

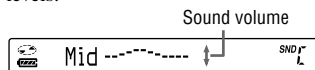

6 Repeat steps 3 to 5 to make adjustment for the remaining 2 frequency ranges.

7 Press **▶II**.

To return to the previous screen

Press  on the remote.

To cancel the adjustment operation

Press  on the remote for 2 seconds or more.

Notes

- If the sound is distorted by your sound settings when you turn up the volume, turn the volume down.
- If you feel a difference in sound volume between the “CUSTOM” sound setting and other sound settings, adjust the volume to your preference.

Continued 

SOUND items

To return to the previous screen, press **■** on the remote. To cancel the setting operation, press **■** on the remote for 2 seconds or more.

Item	Options (●: Default setting)
EQUALIZER (Equalizer setting)	● OFF Normal sound quality
	SOFT For vocal, stressing middle range audio
	ACTIVE Lively sounds, emphasizing high and low range audio
	HEAVY Powerful sounds, further emphasizing high and low ranges compared with ACTIVE sound
	CUSTOM Customized sound (see  page 23 for details)
CLEARBASS (Bass sound setting)	● OFF Normal sound quality.
	BASS 1 Emphasizing bass sound.
	BASS 2 Emphasizing bass sound more than BASS 1.
	BASS 3 Emphasizing bass sound more than BASS 2.

Note

If you change the setting of the EQUALIZER item after you have set the CLEARBASS item, the setting of the EQUALIZER item get priority.

When you set both the EQUALIZER items and the CLEARBASS item, set the EQUALIZER item first.

Changing Optional Settings

For details about the setting of OPTION items, see [page 26](#).

Setting various functions

You can set the various functions such as the language for the menu and the playback order of the groups/files.

1 Turn the function dial on the remote to DSPL/MENU, and then press and hold the function button.

2 Turn the operation dial toward **◀◀ or **▶▶** to select the item you want to set up, and then press **▶II**.**



3 Turn the operation dial toward **◀◀ or **▶▶** to select an option, and then press **▶II**.**

When you are setting the “LANGUAGE” or “PLAY ORDER,” repeat step **3**.

Continued

OPTION items

To return to the previous screen, press **■** on the remote. To cancel the setting operation, press **■** on the remote for 2 seconds or more.

Items	Options (●: Default settings)		
LANGUAGE (Language for menu, etc.)	MENU	<ul style="list-style-type: none"> ● ENGLISH FRANCAIS DEUTSCH ITALIANO 日本語* 한국어* PORTUGUÊS РУССКИЙ 简体中文* ESPAÑOL 繁體中文* * D-NE830LS only 	Select the language for menu text, warning message, etc.
	TEXT ^{1) 2)}	<ul style="list-style-type: none"> ● AUTO³⁾ ENGLISH FRANCAIS DEUTSCH ITALIANO 日本語* 한국어* PORTUGUÊS РУССКИЙ 简体中文* ESPAÑOL 繁體中文* * D-NE830LS only 	
G-PROTECTION ^{1) 4)} (To prevent sound skipping)	● 1	Protection against sound skipping is provided with high quality CD sound.	
	2	Enhanced protection against sound skipping is provided.	
AVLS ⁵⁾ (Limiting volume)	● OFF	The volume changes without limiting the volume level.	
	ON	The maximum volume is limited to protect your hearing.	

Items	Options (●: Default settings)		
TIMER (Off timer)	● OFF	The timer does not work.	
	ON	1-99 min At the preset time, "OFF TIMER" appears on the display for about 5 seconds, and the player automatically stops playback. Turn the VOL +/- control on the remote repeatedly to increase or decrease the length of time by 5 minutes, or keep turning the VOL +/- control to increase or decrease by 1 minute. The default setting is "10 min."	
AUDIO OUT ¹⁾ (External audio output)	● HEADPHONE	Select this when you connect the supplied headphones.	
	LINE OUT	Select this when you connect other devices such as active speakers with an audio cord (Ⓢ page 29).	
BEEP (Sound of operation)	● ON	The beep sounds when you operate the player.	
	OFF	The beep is turned off.	
SEAMLESS ^{1) 6)} (Playing tracks continuously)	● OFF	The CD is played as recorded on the disc, including spaces between tracks.	
	ON	The CD is played without space between tracks.	
POWER SAVE ¹⁾ (The LCD backlight on the remote and the OPR lamp on the player)	● OFF	On the remote, the display lights up for about 10 seconds, then turns off. The OPR lamp on the player remains lit.	
	1	Neither the display on the remote nor the OPR lamp on the CD player lights up.	
	2	Neither the display on the remote nor the OPR lamp on the CD player lights up. Furthermore, the SOUND settings are not effective.	
PLAY ORDER ^{1) 7)} (Playback order)	TRACK	● NORMAL	Play back the music source in the order of recording.
		ID3TAG TNO	Play back in the order of ID3 tag number.
		FILE NAME	Play back in the alphabetical order of the file names.
	GROUP	● OFF	Play back the music source in the order of recording.
		ON	Play back the music source in the order of group names.
DIRECTION (Inverting the characters on the display)	● NORMAL	The characters appear on the display in the normal direction.	
	REVERSE	The characters appear on the display in the reverse direction so that you can read them from the opposite side. When you set the CUSTOM items of the EQUALIZER settings or when you search for the track/file using the List View function, VOL +/- on the remote operate in an opposite way.	
CD-EXTRA ^{1) 8)} (Playback by disc format)	● OFF	Set to "OFF" as long as you can play your CD normally.	
	ON	If you cannot play your CD-Extra, set to "ON." You may play it.	

Continued ⇨

Items	Options (●: Default settings)
ANIMATION (Selecting animation screen)	● OFF The ordinary playback screen is displayed when you have not used any controls for a specified period of time.
	ON Animation screen appears when you have not used any controls for a specified period of time.

- 1) You can set this up only while the player is stopped.
- 2) The TEXT option cannot be set for Audio CDs. For CD-Extra CDs, you can select the TEXT option when "CD-EXTRA" is set to "ON."
- 3) The item "AUTO" is displayed in the same language that you selected for the "LANGUAGE" - "MENU" options.
- 4) Depending on the model you purchased, "G-PRO" is displayed on the remote.
- 5) AVLS is an abbreviation for the Automatic Volume Limiter System.
- 6) This function works only for ATRAC CDs.
- 7) This function does not work for Audio CDs.
- 8) This function works only for Audio CDs and CD-Extra CDs.

Notes

- Even if "G-PROTECTION" is set to "2," sound may skip:
 - when the CD player receives stronger continuous shock than expected,
 - when a dirty or scratched CD is played, or
 - for CD-Rs/CD-RWs, when a poor-quality disc is played or there is a problem with the original recording device or application software.
- Even if "SEAMLESS" is set to "ON," the tracks may not play continuously depending on how the source music was recorded.

Connecting Other Devices

You can listen to CDs through a stereo system and record CDs on a cassette tape. See the instruction manual that comes with the device you want to connect.

Be sure to turn off all devices before making the connections and changing the settings explained below.

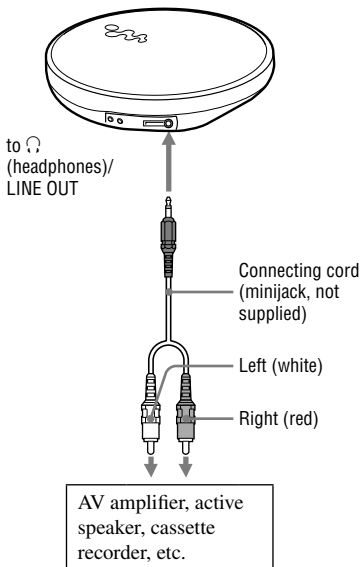

You need to change the setting for “AUDIO OUT” so that sound is output to the connected device. The settings of “AUDIO OUT” are shown below. To make those settings, see page 25, 27.

Connected device	Setting
Headphones	HEADPHONE
Device connected using the connecting cord	LINE OUT

When you connect another device, set this to “LINE OUT.” When the setting is “LINE OUT,” volume cannot be adjusted using either the player or the remote, and the sound function does not work.

Notes

- Before you play a CD, turn down the volume of the connected device to avoid damaging the connected speaker.
- Use the AC power adaptor for recording. If you use the rechargeable battery or a dry battery as a power source, the battery may become completely depleted in the middle of recording.
- To record high quality CD sound, set “G-PRO (G-PROTECTION)” to “1.”

Troubleshooting

Should any problem persist after you have checked these symptoms, consult your nearest Sony dealer.

Power

Symptom	Cause and/or corrective action
The rechargeable battery cannot be charged.	<ul style="list-style-type: none"> → The rechargeable battery is not inserted in the battery compartment. Insert the rechargeable battery (☞ page 11). → ■/CHG is not pressed. Connect the AC power adaptor and press ■/CHG. → The CD is playing. Turn it off (☞ page 16).



Sound

Symptom	Cause and/or corrective action
The volume does not increase even if you turn the VOL +/- control on the remote in the + direction repeatedly (even if you press VOL + repeatedly on the player).	<ul style="list-style-type: none"> → "AVLS" is set to "ON." Set it to "OFF" (☞ page 26). → "AUDIO OUT" is set to "LINE OUT." Set it to "HEADPHONE" (☞ page 29).
No sound, or noise is heard.	<ul style="list-style-type: none"> → Connect the headphones plugs firmly. → The plugs are dirty. Clean the headphones plugs with a dry soft cloth periodically.
The volume cannot be adjusted.	→ "AUDIO OUT" is set to "LINE OUT." Set "AUDIO OUT" to "HEADPHONE" (☞ page 29). When adjust the volume using the volume control on the connected device, set "AUDIO OUT" to "LINE OUT" (☞ page 29).
A rustling noise is heard from the CD.	→ Close the lid of the battery compartment firmly (☞ page 11).
When using the player with a stereo system connected, the sound is distorted or noisy.	→ "AUDIO OUT" is set to "HEADPHONE." Set "AUDIO OUT" to "LINE OUT" (☞ page 29).
EQUALIZER items cannot be set up.	→ "POWER SAVE" is set to "2" (☞ page 27).

Operation/Playback

Symptom	Cause and/or corrective action
The playing time is too short. The CD does not play.	<ul style="list-style-type: none">→ Check that you are using an alkaline battery and not a manganese battery.→ Replace the dry battery with a new LR6 (size AA) alkaline battery (☞ page 12).→ Charge and discharge the rechargeable battery several times (☞ page 12).
Certain tracks cannot be played.	<ul style="list-style-type: none">→ You tried to play files saved in a format that is not compatible with this player (☞ page 5).→ Change the setting of “CD-EXTRA.” You may play your CD (☞ page 27).
“Lo Batt” appears on the display, and the CD does not play.	<ul style="list-style-type: none">→ The rechargeable battery is used up completely. Charge the battery (☞ page 11).→ Replace the dry battery with a new LR6 (size AA) alkaline battery (☞ page 12).
“Hi DC in” appears on the display.	<ul style="list-style-type: none">→ An AC power adaptor which is rated higher than the one supplied or recommended is being used. Use only the supplied AC power adaptor or the car battery cord recommended in “Optional Accessories” (☞ page 35).
The CD does not play, or “No Disc” appears on the display when a CD is placed in the player.	<ul style="list-style-type: none">→ The CD is dirty or defective. Clean it or change it.→ Check that the CD is inserted with the label side up (☞ page 15).→ Moisture condensation* has occurred. Leave the CD player aside for several hours until the moisture evaporates. * Moisture is likely to condense on the lense inside the CD player when you bring the player from the cold outdoors into the warm indoors.→ Close the lid of the battery compartment firmly (☞ page 11).→ Make sure the battery is inserted correctly (☞ page 11, 12).→ Connect the AC power adaptor to an AC outlet securely (☞ page 14).→ Press ► after one second or more has passed since the AC power adaptor was connected.→ The CD-R/CD-RW in the player is blank.→ There is a problem with the quality of the CD-R/CD-RW, recording device, or application software.
The OPR lamp flashes on the player when you press a button, and the CD does not play.	<ul style="list-style-type: none">→ The buttons are locked. Slide the HOLD switch back (☞ page 17).

Continued ⇨

Symptom	Cause and/or corrective action
Playback starts from the point you stopped (resume function).	→ The resume function is working. To start play from the first track, press ▶ while the player is stopped until the first track starts playing (☞ page 16), or open the lid of the player. Or, remove all power sources, and then insert the battery or connect the AC power adaptor again.
During playback of an ATRAC CD or MP3 CD, the CD does not rotate but you can hear the sound normally.	→ This player is designed to stop the rotation of an ATRAC CD or MP3 CD during playback to reduce the power consumption. The player is not malfunctioning.
“No File” appears on the display after you press ▶ or when the lid of the player is closed.	<ul style="list-style-type: none"> → There are no ATRAC/MP3 files on the CD-R/CD-RW. → A CD-R/CD-RW from which the data has been erased is being used. → The CD is dirty.
The LCD display becomes hard to see or slows down.	→ You are using your CD player at high temperatures (above 40°C/104°F) or at low temperatures (below 0°C/32°F). At room temperature, the display will return to its normal operating condition.
 is flashing quickly on the display of the remote control, and you cannot locate the beginning of the track or a specific point in the track.	→ The CD player has entered the preparation stage of Bookmark play. Change the PLAY MODE setting to normal play (no display) (☞ page 20).
Even though you have not selected Bookmark play,  (Bookmark) flashes.	→ If you have selected a playback option other than Bookmark play,  (Bookmark) flashes.
Play stopped abruptly.	<ul style="list-style-type: none"> → The off timer has been set. Change the setting of “TIMER” to “OFF” (☞ page 27). → The rechargeable battery or the dry battery is used up completely. Charge the rechargeable battery (☞ page 11), or replace the dry battery with a new LR6 (size AA) alkaline battery (☞ page 12).

Others

Symptom	Cause and/or corrective action
When closing the lid of the CD player, the CD starts to rotate.	→ The player is reading the information on the CD, not malfunctioning.
You cannot operate the CD player properly using the remote.	→ The buttons on the player are kept pressed by mistake. → The remote is not connected securely.

Maintenance

To clean the casing

Use a soft cloth slightly moistened in water or a mild detergent solution. Do not use alcohol, benzine or thinner.

Specifications

System

Compact disc digital audio system

Laser diode properties

Emission duration: Continuous

Laser output: Less than 44.6 μ W

(This output is the value measured at a distance of 200 mm from the objective lens surface on the optical pick-up block with 7 mm aperture.)

D-A conversion

1-bit quartz time-axis control

Frequency response

20 - 20 000 Hz \pm 2 dB (measured by JEITA)

Output

Line output (stereo minijack)

Output level 0.7 V rms at 47 k Ω

Recommended load impedance over 10 k Ω

Headphones (stereo minijack)

Approx. 5 mW + Approx. 5 mW at 16 Ω

(Approx. 1 mW + Approx. 1 mW at 16 Ω)*

* For the area code "EU8" model.

For the area code of the model you purchased, check the upper left side of the bar code on the package.

Power requirements

- Sony NH-14WM rechargeable battery:
1.2 V DC \times 1
- LR6 (size AA) battery: 1.5 V DC \times 1
- AC power adaptor (DC IN 3 V jack):
220 V, 50 Hz (Model for China)
120 V, 60 Hz (Model for Mexico)
- Rated current: 1 A

Operating temperature

5°C - 35°C (41°F - 95°F)

Dimensions (w/h/d) (excluding projecting parts and controls)

Approx. 135.8 \times 17.0 \times 135.8 mm

(5 $\frac{3}{8}$ \times 1 $\frac{1}{16}$ \times 5 $\frac{3}{8}$ in.)

Mass (excluding accessories)

Approx. 176 g (6.3 oz.)

US and foreign patents licensed from Dolby Laboratories.

MPEG Layer-3 audio coding technology and patents licensed from Fraunhofer IIS and Thomson.

Design and specifications are subject to change without notice.

Optional Accessories

AC power adaptor	AC-E30HG*
Active speaker system	SRS-Z30/Z31 SRS-Z510
Car battery cord	DCC-E345
Car battery cord with car connecting pack	DCC-E34CP
Car connecting pack	CPA-9C
Connecting cord	RK-G129 RK-G136
Earphones (except for the customers in France)	MDR-EX51LP MDR-EX71SL MDR-G74SL
Earphones (for the customers in France)	MDR-E0931SP

* Specifications for AC power adaptors vary for each area. Check your local voltage and the shape of the plug before purchasing.

Your dealer may not handle some of the accessories listed above. Please ask the dealer for detailed information about the accessories in your country/region.

SonicStage Download Website

You can install SonicStage by the following;

- 1 Select from below your region website.
- 2 Access the SonicStage free download website and download following the instructions provided.
(Before downloading please read carefully the information provided on the site.)
- 3 Download the file, and execute according to the instructions.
 - For customers in Asia, the Middle East, Africa and Oceania:
<http://www.css.ap.sony.com>
(TOP page → Downloads → Personal Audio → SonicStage)
 - For customers in Europe:
<http://www.sonydigital-link.com/dna>
(Top page → ATRAC CD → SonicStage)
 - For customers with Overseas Models:
<http://www.sony.co.jp/overseas/support>
(TOP page → SonicStage Download Service)

Index

Symbols

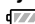
 (Battery) 11, 13

 (Disc) 15

1 20

a00 20

a00 SHUF 20

 (Bookmark) 20, 21

 (Group) 20

PGM 20, 22

 (Play list) 20, 21

SHUF 20

 (Repeat) 22

A

ACTIVE 24

AC power adaptor 8

ANIMATION 28

ATRAC 5

ATRAC CD 5

AUDIO OUT 27, 29

AVLS 26

B

Battery carrying case 8

Battery compartment lid 11

Battery life 13

BEEP 27

Bookmark 21

C

CD-DA format 5

CD-EXTRA 27

CD-Extra 5

CD-TEXT 18

CLEARBASS 23, 24

Clip on the remote 8

CUSTOM 24

D

DIRECTION 27

E

EQUALIZER 23, 24

External battery case 8, 12

G

G-PROTECTION 26

GROUP 27

Group 6, 21

H

HEADPHONE 27, 29

Headphones 8

HEAVY 24

HOLD function 17

I

ID3 tag 18

INTRO 20

L

LANGUAGE 26

LINE OUT 27, 29

List View 17

M

m3u play list play 20, 21

MENU 26

Mix-Mode CD 5

MP3 CD 5

O

Optional Accessories 35

P

Pause 16

Play 16

PLAY MODE 19

PLAY ORDER 27

POWER SAVE 27

R

Rechargeable battery 8, 11

Remote control 8

Remote display 10, 18

Repeat play 22

S

SEAMLESS 27

Search 16, 17

SOFT 24

SonicStage 4

SOUND 24

Stop 16

T

TEXT 26

TIMER 27

TRACK 27



Printed on 100 % recycled paper.

<http://www.sony.net/>

Sony Corporation Printed in Malaysia



* 2 6 5 3 4 2 9 1 2 * (1)

Free Manuals Download Website

<http://myh66.com>

<http://usermanuals.us>

<http://www.somanuals.com>

<http://www.4manuals.cc>

<http://www.manual-lib.com>

<http://www.404manual.com>

<http://www.luxmanual.com>

<http://aubethermostatmanual.com>

Golf course search by state

<http://golfingnear.com>

Email search by domain

<http://emailbydomain.com>

Auto manuals search

<http://auto.somanuals.com>

TV manuals search

<http://tv.somanuals.com>