

FM/AM 2 BAND RADIO

ICF-38

Operating Instructions

©2008 Sony Corporation Printed in China



* 3 2 2 5 9 9 2 2 3 * (1)

<http://www.sony.net/>

For customers who purchased this product in the USA

Please register this product on line at <http://www.sony.com/productregistration>.

Proper registration will enable us to send you periodic mailings about new products, services, and other important announcements. Registering your product will also allow us to contact you in the unlikely event that the product needs adjustment or modification. Thank you.

WARNING

To reduce the risk of fire or electric shock, do not expose this apparatus to rain or moisture.

Do not expose the batteries (battery pack or batteries installed) to excessive heat such as sunshine, fire or the like for a long time.

As the main plug is used to disconnect the unit from the mains, connect the unit to an easily accessible AC outlet. Should you notice an abnormality in the unit, disconnect the main plug from the AC outlet immediately.

The unit is not disconnected from the AC power source (mains) as long as it is connected to the wall outlet, even if the player itself has been turned off.

Do not install the appliance in a confined space, such as a bookcase or built-in cabinet.

You are cautioned that any changes or modifications not expressly approved in this manual could void your authority to operate this equipment.



This symbol is intended to alert the user to the presence of uninsulated "dangerous voltage" within the product's enclosure that may be of sufficient magnitude to constitute a risk of electric shock to persons.



This symbol is intended to alert the user to the presence of important operating and maintenance (servicing) instructions in the literature accompanying the appliance.

* The graphical symbols are on the bottom enclosure.

Important Safety Instructions

- 1) Read these instructions.
- 2) Keep these instructions.
- 3) Heed all warnings.
- 4) Follow all instructions.
- 5) Do not use this apparatus near water.
- 6) Clean only with dry cloth.
- 7) Do not block any ventilation openings. Install in accordance with the manufacturer's instructions.
- 8) Do not install near any heat sources such as radiators, heat registers, stoves, or other apparatus (including amplifiers) that produce heat.
- 9) Do not defeat the safety purpose of the polarized or grounding-type plug. A polarized plug has two blades with one wider than the other. A grounding type plug has two blades and a third grounding prong. The wide blade or the third prong are provided for your safety. If the provided plug does not fit into your outlet, consult an electrician for replacement of the obsolete outlet.
- 10) Protect the power cord from being walked on or pinched particularly at plugs, convenience receptacles, and the point where they exit from the apparatus.
- 11) Only use attachments/accessories specified by the manufacturer.
- 12) Use only with the cart, stand, tripod, bracket, or table specified by the manufacturer, or sold with the apparatus. When a cart is used, use caution when moving the cart/apparatus combination to avoid injury from tip-over.



- 13) Unplug this apparatus during lightning storms or when unused for long periods of time.
- 14) Refer all servicing to qualified service personnel. Servicing is required when the apparatus has been damaged in any way, such as power-supply cord or plug is damaged, liquid has been spilled or objects have fallen into the apparatus, the apparatus has been exposed to rain or moisture, does not operate normally, or has been dropped.

SONY®

Portable Audio

LIMITED WARRANTY (U.S. Only)

Sony Electronics Inc. ("Sony") warrants this product against defects in material or workmanship for the time periods and as set forth below when purchased directly from Sony or a Sony Retailer. Pursuant to this Limited Warranty, Sony will, at its option, (i) repair the product using new or refurbished parts or (ii) replace the product with a new or refurbished product. For purposes of this Limited Warranty, "refurbished" means a product or part that has been returned to its original specifications. **In the event of a defect, these are your exclusive remedies.**

Term: For a period of one (1) year from the original date of purchase of the product, Sony will, at its option, repair or replace with new or refurbished product or parts, any product or parts determined to be defective.

This Limited Warranty covers only the hardware components packaged with the Product. It does not cover technical assistance for hardware or software usage and it does not cover any software products whether or not contained in the Product; any such software is provided "AS IS" unless expressly provided for in any enclosed software Limited Warranty. Please refer to the End User License Agreements included with the Product for your rights and obligations with respect to the software.

Instructions: To obtain warranty service, you must deliver the product, freight prepaid, in either its original packaging or packaging affording an equal degree of protection to the Sony authorized service facility specified. **It is your responsibility to backup any data, software or other materials you may have stored or preserved on your unit. It is likely that such data, software, or other materials will be lost or reformatted during service and Sony will not be responsible for any such damage or loss.** A dated purchase receipt from Sony or a Sony Retailer is required. For specific instructions on how to obtain warranty service for your product,

The Address of the Laredo Fulfillment Center is:

Laredo Fulfillment Center
10227 Crossroads Loop Suite B
Laredo, TX 78045

Visit Sony's Web Site:
www.sony.com/support

Or call the **Sony Customer Information Service Center**
1-800-222-SONY (7669)

For an accessory or part not available from your authorized dealer, call:

1-800-488-SONY (7669)

Repair / Replacement Warranty: This Limited Warranty shall apply to any repair, replacement part or replacement product for the remainder of the original Limited Warranty period or for ninety (90) days, whichever is longer. Any parts or product replaced under this Limited Warranty will become the property of Sony.

This Limited Warranty only covers product issues caused by defects in material or workmanship during ordinary consumer use; it does not cover product issues caused by any other reason, including but not limited to product issues due to commercial use, acts of God, misuse, limitations of technology, or modification of or to any part of the Sony product or product purchased from other than Sony or a Sony Retailer. To determine if a retailer is part of the Sony Retailer Network, please contact Sony's Customer Service Call Center or go to www.sony.com/support. This Limited Warranty does not cover Sony products sold AS IS or WITH ALL FAULTS or consumables (such as fuses or batteries). This Limited Warranty is invalid if the factory-applied serial number has been altered or removed from the product. This Limited Warranty is valid only in the United States.

LIMITATION ON DAMAGES: SONY SHALL NOT BE LIABLE FOR ANY INCIDENTAL OR CONSEQUENTIAL DAMAGES FOR BREACH OF ANY EXPRESS OR IMPLIED WARRANTY ON THIS PRODUCT.

DURATION OF IMPLIED WARRANTIES: EXCEPT TO THE EXTENT PROHIBITED BY APPLICABLE LAW, ANY IMPLIED WARRANTY OF MERCHANTABILITY OR FITNESS FOR A PARTICULAR PURPOSE ON THIS PRODUCT IS LIMITED IN DURATION TO THE DURATION OF THIS WARRANTY.

Some states do not allow the exclusion or limitation of incidental or consequential damages, or allow limitations on how long an implied warranty lasts, so the above limitations or exclusions may not apply to you. This Limited Warranty gives you specific legal rights and you may have other rights which vary from state to state.

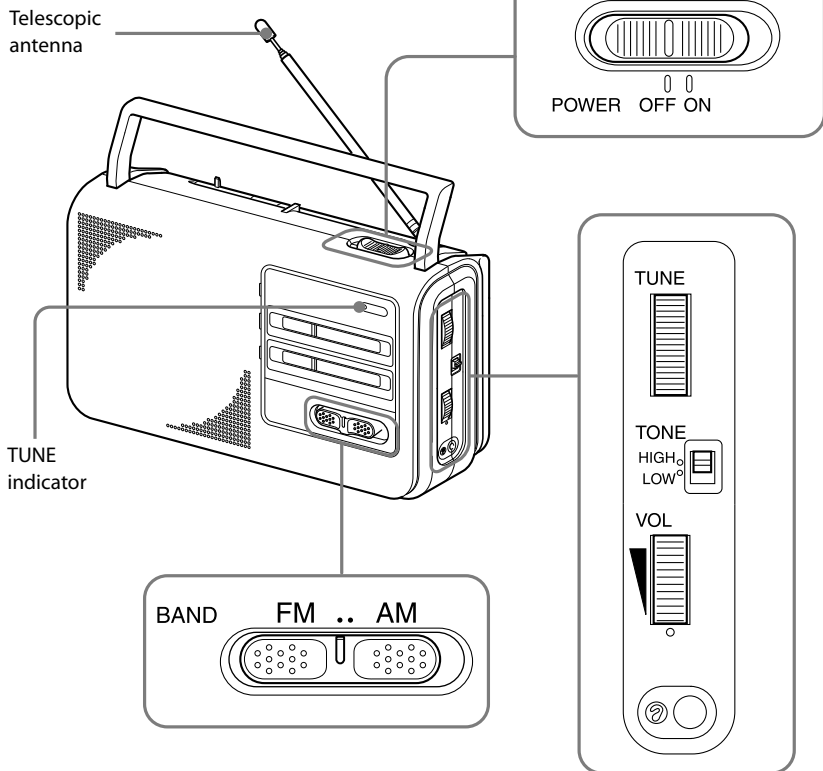

Before You Begin

Thank you for choosing the Sony 2 band radio! This unit will give you many hours of reliable service and listening pleasure. Before operating your unit, please read these instructions thoroughly and retain them for future reference.

Note

Adjust the direction of the antenna, holding the bottom of it. The antenna can be damaged when you move the antenna with excessive force.



AM: Rotate the unit horizontally for optimum reception. A ferrite bar antenna is built into the unit.

Features

- Good sound and high sensitivity
- Tuning indicator for easy tuning
- Tone control switch
- 2 Way Power AC/DC Operation

Choosing Power Sources

You can use this unit with four size AA(R6) batteries or the house current. The AC power cord is in the battery compartment.

Batteries (See Fig. A)

- 1 Open the lid of the battery compartment.
- 2 Insert four size AA(R6) batteries (not supplied) with correct polarity.
- 3 Close the lid.

Battery life (Approx. hours)	(JEITA*)	
	Using Sony alkaline size AA(LR6) batteries	Using Sony size AA(R6) batteries
FM	74	28
AM	82	30

* Measured by JEITA (Japan Electronics and Information Technology Industries Association) standards. The actual battery life may vary depending on the circumstance of the unit.

Replacing batteries

When the sound becomes weak or distorted, replace all the batteries with new ones.

Notes on batteries

- Insert the batteries with correct polarity.
- Do not charge the dry batteries.
- Do not use different types of batteries at the same time.
- When you replace the batteries, replace all with new ones.
- When the unit is not being used for a long period of time, remove the batteries to avoid damage from battery leakage and corrosion.
- If a battery leakage occurs, wipe the battery compartment with a soft cloth before inserting new ones.

House Current (See Fig. B)

- 1 Open the lid of the battery compartment and set the AC power cord into the groove properly.
- 2 Close the lid.
- 3 Plug into a wall outlet.

To attach the battery compartment lid if it is accidentally detached (See Fig. C)

- 1 Put in one side of the lid as illustrated.
- 2 Push the other side to attach.

Playing the Radio

- 1 Slide **POWER** to **ON** to turn on the radio.
- 2 Select **FM** or **AM**, and tune in to a station using **TUNE**.
TUNE (tuning) indicator lights up when a station is tuned in.
- 3 Adjust the volume using **VOL**.
- 4 Adjust the tone to your preference using **TONE**.
To obtain clear treble, set to "**HIGH**".
To reinforce bass, set to "**LOW**".

- To turn off the radio, set **POWER** to **OFF**.
- To listen with an earphone (not supplied) connect the earphone to the Ⓞ (earphone) jack. The speaker is deactivated when an earphone is connected.

To improve Receiving condition (See Fig. D)

FM: Extend the telescopic antenna and adjust the length and angle for the best reception.

A

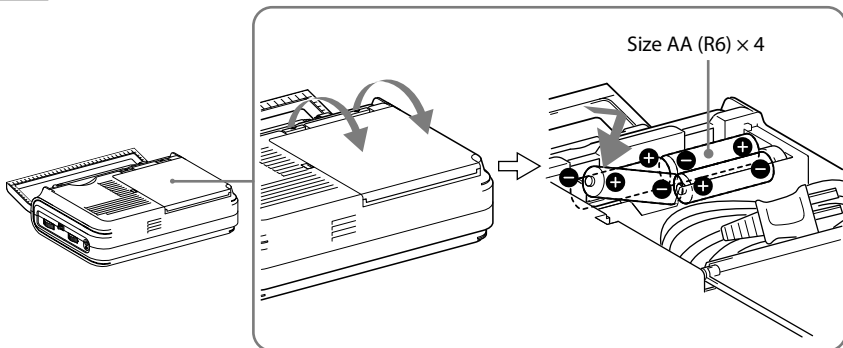

B

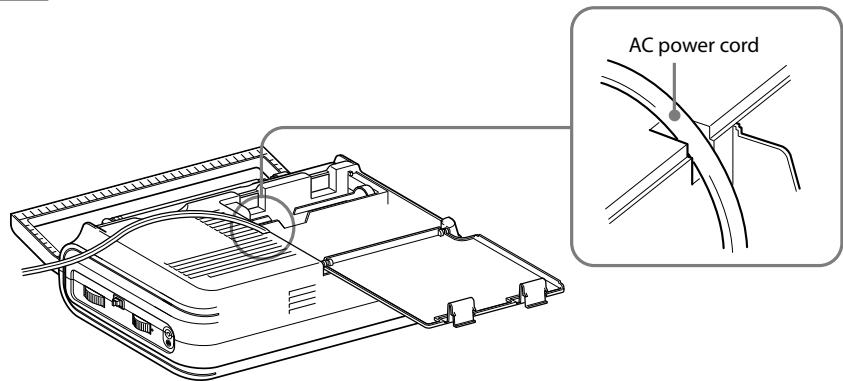

C

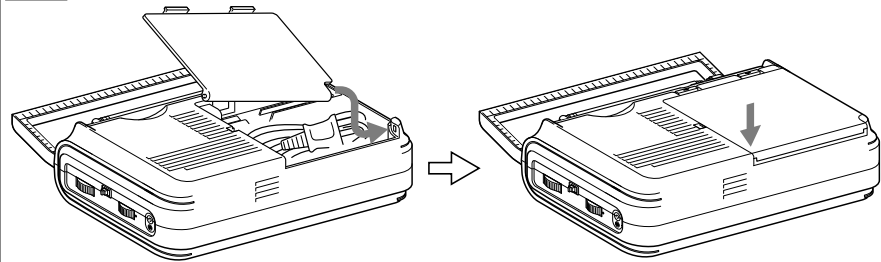

D

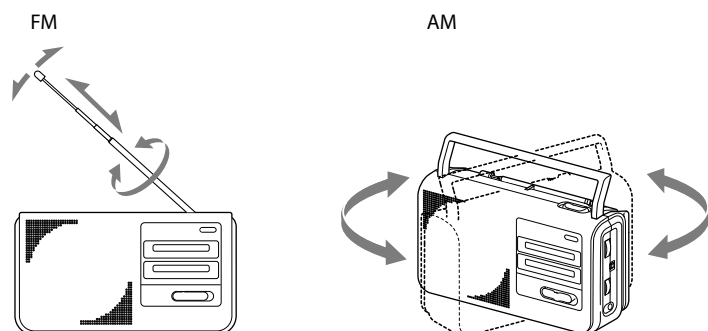

If you have any questions or problems concerning your unit, please consult your nearest Sony dealer.

Specifications

Frequency range

FM: 87.5-108 MHz
AM: 530-1 710 kHz

Speaker

Approx. 9.2 cm (3 5/8 in.) dia., 4 Ω

Power output

400 mW (at 10 % harmonic distortion)

Output

Ⓞ (earphone) jack (ø 3.5 mm minijack)

Power requirements

120 V AC, 60 Hz with the equipped AC power cord
6 V DC with four size AA(R6) batteries

Dimensions

Approx. 234 × 133 × 68.5 mm (w/h/d)
(9 7/32 × 5 1/4 × 2 23/32 in.) incl. projecting parts with the carrying handle pushed in.

Mass

Approx. 848 g (29.9 oz.)

Design and specifications are subject to change without notice.

Free Manuals Download Website

<http://myh66.com>

<http://usermanuals.us>

<http://www.somanuals.com>

<http://www.4manuals.cc>

<http://www.manual-lib.com>

<http://www.404manual.com>

<http://www.luxmanual.com>

<http://aubethermostatmanual.com>

Golf course search by state

<http://golfingnear.com>

Email search by domain

<http://emailbydomain.com>

Auto manuals search

<http://auto.somanuals.com>

TV manuals search

<http://tv.somanuals.com>