

FM Stereo/AM PLL Synthesized Radio

Operating Instructions

SRF-M78

sports
FM/AM **WALKMAN**

WALKMAN is a
registered trademark
of Sony Corporation

Sony Corporation © 1996 Printed in Taiwan, R.O.C.

||

LIMITED WARRANTY Portable Audio

SONY ELECTRONICS INC. ("SONY") warrants this Product (including any accessories) against defects in material or workmanship as follows:

1. For a period of one (1) year from the date of purchase, Sony will replace at no charge through your SONY authorized dealer, Sony owned Service Center, or the Sony Parts Center Exchange Department, the defective unit. After this one (1) year period, you must pay for the replacement unit. This warranty does not cover costs incurred in connection with the removal and re-installation of radios, speakers or accessories, nor does it cover any other contingent expenses.

2. To obtain warranty service, you must take the Product, or deliver the Product freight prepaid, in either its original packaging or packaging affording an equal degree of protection, to any authorized SONY service facility.

This warranty does not cover customer instruction, installation, set up adjustments or signal reception problems.

This warranty does not cover cosmetic damage or damage due to acts of God, accident, misuse, abuse, negligence, commercial use, or modification of, or to any part of the Product, including the receiver. This warranty does not cover damage due to improper operation or maintenance, connection to improper voltage supply, or attempted repair by anyone other than a facility authorized by Sony to service the Product. This warranty does not cover Products sold AS IS or WITH ALL FAULTS, or consumables (such as fuses or batteries). This warranty is valid only in the United States.

Proof of purchase in the form of a bill of sale or receipted invoice which is evidence that the unit is within the Warranty period must be presented to obtain warranty service.

This warranty is invalid if the factory applied serial number has been altered or removed from the Product.

REPAIR OR REPLACEMENT AS PROVIDED UNDER THIS WARRANTY IS THE EXCLUSIVE REMEDY OF THE CONSUMER. SONY SHALL NOT BE LIABLE FOR ANY INCIDENTAL OR CONSEQUENTIAL DAMAGES FOR BREACH OF ANY EXPRESS OR IMPLIED WARRANTY ON THIS PRODUCT, EXCEPT TO THE EXTENT PROHIBITED BY APPLICABLE LAW. ANY IMPLIED WARRANTY OF MERCHANTABILITY OR FITNESS FOR A PARTICULAR PURPOSE ON THIS PRODUCT IS LIMITED IN DURATION TO THE DURATION OF THIS WARRANTY.

Some states do not allow the exclusion or limitation of incidental or consequential damages, or allow limitations on how long an implied warranty lasts, so the above limitations or exclusions may not apply to you. In addition, if you enter into a service contract with the Sony Partnership within 90 days of the date of sale, the limitation on how long an implied warranty lasts does not apply to you. This warranty gives you specific legal rights, and you may have other rights which vary from state to state.

The address of the Sony Parts Center - Exchange Department is:

SONY PARTS CENTER - EXCHANGE DEPARTMENT
8281 NW 107th Terrace
Kansas City, Missouri 64153

For your convenience, SONY ELECTRONICS INC. has established telephone numbers for frequently asked questions:

To locate the servicer or dealer nearest you, call:

1-(800)-342-5721

For service assistance or resolution of a service problem, call:

SONY CUSTOMER RELATIONS CENTER
1-(800)-282-2848

For Product information or operation, call:

SONY CUSTOMER INFORMATION CENTER
(201)-368-9272

or write to:
Sony Customer Information Center
One Sony Drive
Park Ridge, New Jersey 07656-8003

For an accessory or part not available from your authorized dealer, call:

1-(800)-488-SONY (7669)

Before You Begin

Thank you for choosing the Sony radio! It will give you many hours of reliable service and listening pleasure. Before operating the radio, please read these instructions thoroughly and retain them for future reference.

Features

- FM stereo/AM PLL (Phase Locked Loop) synthesized radio.
- Up to 10 stations (5 for each band FM or AM) can be stored for button-touch tuning - memory preset tuning.
- Easy attachable wraparound arm band.
- Water-resistant for all-weather use.

Notes on AM Channel Step

The AM channel step differs depending on the area. The Channel step of this unit is factory-set to 10 kHz.

| Area | Channel step |
|------------------------------------|--------------|
| North and South American countries | 10 kHz |
| Other countries | 9 kHz |

Precautions

- Operate the unit only on 3 V DC with two size AAA (R03) batteries.
- The name plate indicating operating voltage, etc. is located at the rear.
- Avoid exposure to temperature extremes, direct sunlight, moisture, sand, dust, or mechanical shock. Never leave in a car parked in the sun.
- Should anything fall into the unit, remove the batteries, and have the unit checked by qualified personnel before operating it any further.
- To clean the casing, use a soft cloth dampened with a mild detergent solution.
- In vehicles or buildings, radio reception may be difficult or noisy. Try listening near a window.

Notes on Headphones

Road safety

Do not use headphones while driving, cycling, or operating any motorized vehicle. It may create a traffic hazard and is illegal in many areas. It can also be potentially dangerous to play your headphones at high volume while walking, especially at pedestrian crossings. You should exercise extreme caution or discontinue use in potentially hazardous situations.

Preventing hearing damage

Avoid using headphones at high volume. Hearing experts advise against continuous, loud and extended play. If you experience a ringing in your ears, reduce volume or discontinue use.

Caring for others

Keep the volume at a moderate level. This will allow you to hear outside sounds and to be considerate to people around you.

Warning

If there is lightning when you are using the unit, take off the headphones immediately.

Do not Immerse in Water

This product is designed to be water-resistant, but should not be immersed in water or come in continuous contact with water.

- Before installing the batteries, be sure to wipe off drops of water on the unit.
- The supplied headphones are not meant to be immersed in water or come in continuous contact with water, if they get wet, dry them with a soft cloth. Never use an electric hair dryer while wearing the headphones.

If you have any questions or problems concerning your unit, please consult your nearest Sony dealer.

Specifications

Time display: 12-hour system

Frequency range:

| Frequency | Channel step |
|--|--------------------|
| FM : 87.5 - 108 MHz AM : 530 - 1710 kHz | 0.1 MHz 10 kHz |
| FM : 87.5 - 108 MHz AM : 531 - 1710 kHz | 0.05 MHz* 9 kHz |

* The frequency display is raised or lowered by steps of 0.1 MHz. (Example: Frequency 88.05 MHz is displayed as "88.0 MHz".)

Output:

- jack (stereo minijack)

Power output:

15 mW + 15 mW (at 10 % harmonic distortion)

Power requirements:

3 V DC, two size AAA (R03) batteries

Battery life:

Using Sony batteries UM4(NU)

FM : Approx. 13 hours

AM: Approx. 20 hours

Dimensions:

Approx. 105 x 68 x 38.6 mm (w/h/d)
(4 1/8 x 2 3/4 x 1 1/2 inches) excl.
projecting parts and controls

Mass:

Approx. 85 g (3 oz) not incl. batteries

Accessories supplied:

Stereo headphones (1, vertical-in-the-ear type)

Arm band (1)

Design and specifications are subject to change without notice.

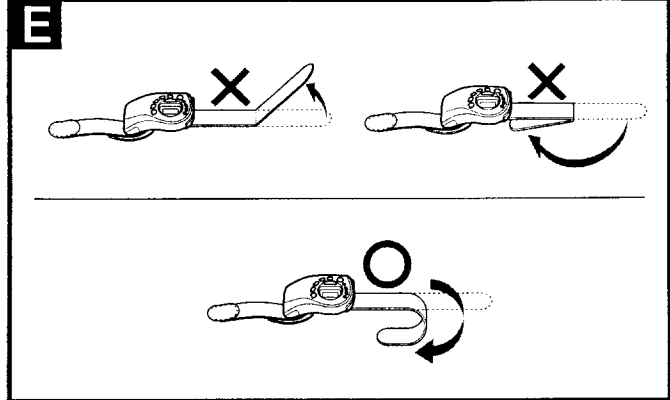
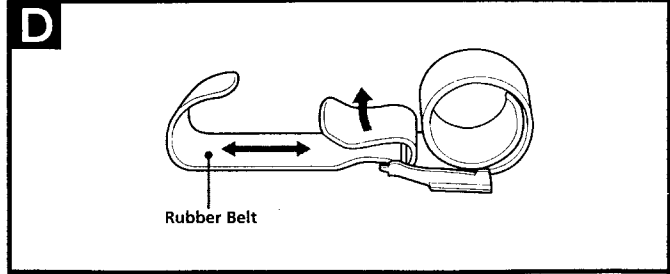
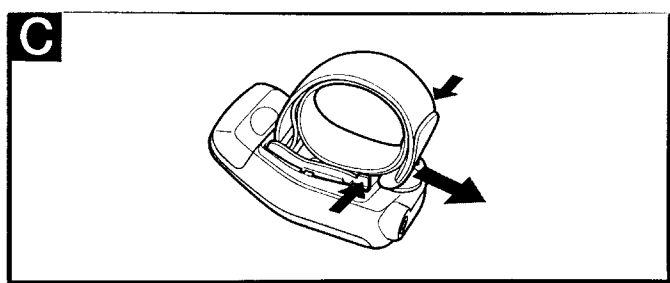
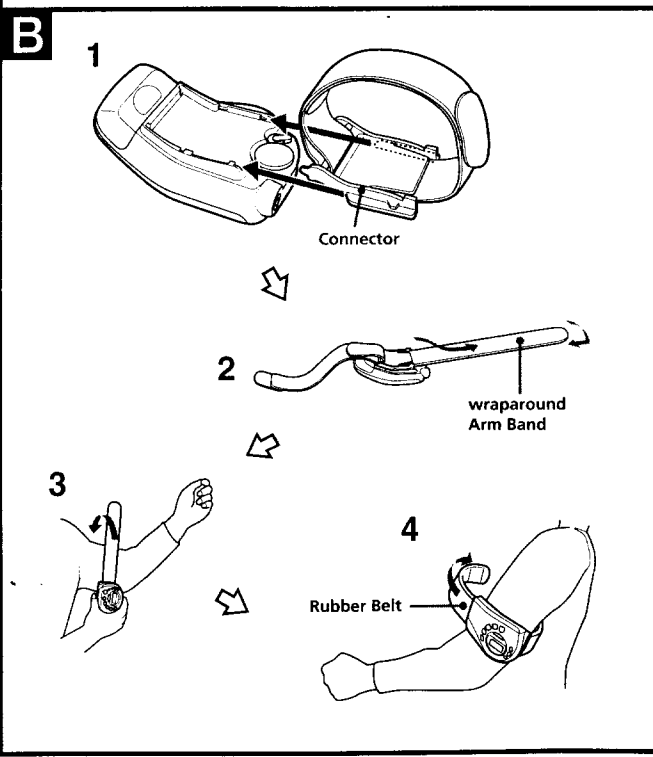
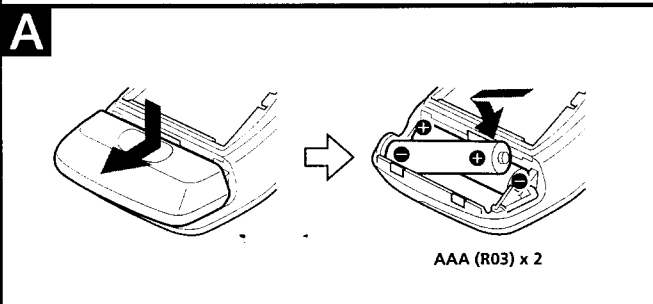
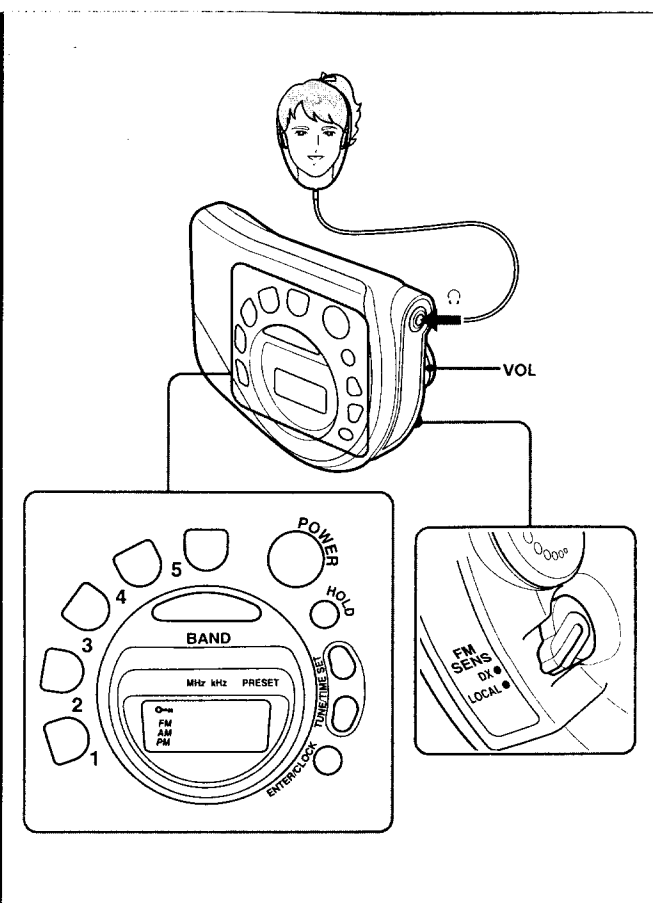

Installing Batteries

- 1 Install two size AAA (R03) batteries (not supplied) with correct polarity. (See fig **A**.)

- When you install batteries for the first time, the display will flash "AM 12:00". To stop flashing, press **ENTER/CLOCK**.
- For battery life, see "Specifications".

Knowing When to Replace the Battery

- When the batteries become weak, the sound becomes weak or distorted. When the batteries are completely exhausted, the power is turned off and "0 0 0" in the display flashes. When the power is turned on with the indication flashing, the power will be turned off right away. When "0 0 0" starts flashing, replace both batteries with new ones.
- Replace the batteries within about 40 seconds after removing the batteries. If you do not replace them within 40 seconds, the preset stations may be erased, the clock setting may be cleared and "AM 12:00" flashes in the display.
- When the batteries are removed for a long time, preset stations will be erased and "AM 12:00" is displayed. Store stations and set the clock again.

Note

When the unit is not to be used for a long period of time, remove the batteries to avoid damage caused by battery leakage and corrosion.

Setting the Clock

Set the clock when the radio is turned off.

- 1 When you insert batteries for the first time, digits flash in the display. To stop flashing, press **ENTER/CLOCK**.
 - 2 While holding down **ENTER/CLOCK**, press either **TUNE/TIME SET +** or **-** till the correct time appears in the display. When you release **ENTER/CLOCK**, the clock begins to operate and ":" flashes.
- Each press of **TUNE/TIME SET +** or **-** advances or returns the displayed time by one minute.
 - To set the current time rapidly, keep pressing **TUNE/TIME SET +** or **-** while holding down **ENTER/CLOCK**.

Changing AM Channel Step

The channel step of this unit is factory-set to 10 kHz to match the frequency allocation system of the country as listed.

You can change the channel step.

| Area | Channel step |
|------------------------------------|--------------|
| North and South American countries | 10 kHz |
| Other countries | 9 kHz |

- 1 Change the AM channel step when the radio is turned off.
 - 2 While holding down **ENTER/CLOCK**, keep pressing **POWER** for more than 5 seconds. The AM channel step will be changed. If you proceed step 2 again, the channel step changes again.
- When the AM channel step is changed, the preset stations will be erased, the clock setting will be cleared and "AM 12:00" flashes in the display.

Playing the Radio

Manual Tuning

- 1** Connect the supplied headphones to the  (headphones) jack.
 - 2** Press **POWER** to turn the radio on.
 - 3** Press **BAND** to select the band. Each press changes the band FM/AM alternately.
 - 4** Tune in a station by pressing either **TUNE/TIME SET +** or **-**.
 - 5** Adjust **VOL** (volume).
- To turn off the radio, press **POWER**.

To improve radio reception

FM: Extend the headphones cord so that the FM sensitivity will be increased, as it serves as the FM antenna.

AM: Rotate the unit horizontally for optimum reception. A ferrite bar antenna is built into the unit.

On FM SENS DX/LOCAL selector (for FM reception)

DX: Normally set it to this position.

LOCAL: If a very strong station signal causes noise, set it to this position. The reception will be more stable and noise will be reduced.

To prevent accidental change of the receiving station

Press **HOLD**. "⏻" is displayed, indicating that all the functions of the buttons are locked. To release the key protection, press **HOLD** again.

Preset Tuning

Once you preset the desired stations, you can tune them in by a simple operation. You can preset up to 5 stations for each of the FM and AM bands.

Presetting the Station

Example: To set AM 1260 kHz in preset button 2.

- 1 Preset **POWER** to turn the radio on.
- 2 Tune in the station to preset. (See "Manual Tuning".)
- 3 While holding down **ENTER/CLOCK**, press the appropriate preset button 2.
The station will be stored and the preset number will appear in the display.

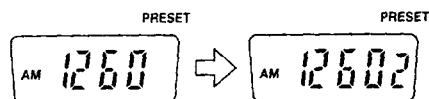

- To change the preset station, set a new station's frequency in the number whose station you want to change. The previous frequency is canceled.

Tuning in a Preset Station

- 1 Press **POWER** to turn the radio on.
- 2 Select the desired band by pressing **BAND**.
- 3 Press the desired preset number button.
The preset number will appear in the display.
- 4 Adjust **VOL** (volume).

Using the Arm Band (See fig. B)

- 1 Hold both edges of the connector and slide the connector onto the unit until you hear a click
- 2 Unwind and straighten the wraparound band. To more easily straighten the band, slightly bend the tip of the band in the opposite direction.
- 3 Hold the body of the unit and attach the straightened band to your arm. The band will wind by itself.
- 4 Tighten the band with the rubber belt.

To remove the arm band from the unit (See fig. C)

Hold both edges of the connector and slide the connector.

To vary the length of the rubber belt to fit your arm (See fig. D)

Move the velcro fastener to the proper position.

If the rubber belt and wraparound band becomes dirty

Remove the rubber belt from the unit and clean them.

Caution (See fig. E)

- Avoid bending the wraparound band forcibly in the opposite direction. It may break.
- The straightened band will wind easily when you touch or wiggle it. Be sure to treat it carefully.

Free Manuals Download Website

<http://myh66.com>

<http://usermanuals.us>

<http://www.somanuals.com>

<http://www.4manuals.cc>

<http://www.manual-lib.com>

<http://www.404manual.com>

<http://www.luxmanual.com>

<http://aubethermostatmanual.com>

Golf course search by state

<http://golfingnear.com>

Email search by domain

<http://emailbydomain.com>

Auto manuals search

<http://auto.somanuals.com>

TV manuals search

<http://tv.somanuals.com>