

# *Micro Hi-Fi Component System*

---

## Operating Instructions

## Owner's Record

The model and serial numbers are located at the rear. Record the serial number in the space provided below. Refer to them whenever you call upon your Sony dealer regarding this product.

Model No. \_\_\_\_\_ Serial No. \_\_\_\_\_



*CMT-CP333*  
*CMT-CP300*

## WARNING

### To prevent fire or shock hazard, do not expose the unit to rain or moisture.

To avoid electrical shock, do not open the cabinet. Refer servicing to qualified personnel only.

Do not install the appliance in a confined space, such as a bookcase or built-in cabinet.

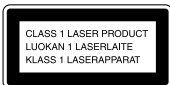

This appliance is classified as a CLASS 1 LASER product. The CLASS 1 LASER PRODUCT MARKING is located on the rear exterior.

To prevent fire, do not cover the ventilation of the apparatus with news papers, table-cloths, curtains, etc. And don't place lighted candles on the apparatus.

To prevent fire or shock hazard, do not place objects filled with liquids, such as vases, on the apparatus.



Don't throw away the battery with general house waste, dispose of it correctly as chemical waste.

### NOTICE FOR THE CUSTOMERS IN THE U.S.A.

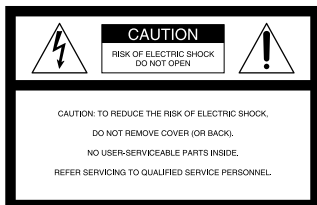

This symbol is intended to alert the user to the presence of uninsulated "dangerous voltage" within the product's enclosure that may be of sufficient magnitude to constitute a risk of electric shock to persons.



This symbol is intended to alert the user to the presence of important operating and maintenance (servicing) instructions in the literature accompanying the appliance.

### CAUTION

The use of optical instruments with this product will increase eye hazard.

### Note to CATV system installer:

This reminder is provided to call the CATV system installer's attention to Article 820-40 of the NEC that provides guidelines for proper grounding and, in particular, specifies that the cable ground shall be connected to the grounding system of the building, as close to the point of cable entry as practical.

### WARNING

This equipment has been tested and found to comply with the limits for a Class B digital device, pursuant to Part 15 of the FCC Rules. These limits are designed to provide reasonable protection against harmful interference in a residential installation. This equipment generates, uses, and can radiate radio frequency energy and, if not installed and used in accordance with the instructions, may cause harmful interference to radio communications. However, there is no guarantee that interference will not occur in a particular installation. If this equipment does cause harmful interference to radio or television reception, which can be determined by turning the equipment off and on, the user is encouraged to try to correct the interference by one or more of the following measures:

- Reorient or relocate the receiving antenna.
- Increase the separation between the equipment and receiver.
- Connect the equipment into an outlet on a circuit different from that to which the receiver is connected.
- Consult the dealer or an experienced radio/TV technician for help.

### CAUTION

You are cautioned that any changes or modifications not expressly approved in this manual could void your authority to operate this equipment.

### NOTICE FOR THE CUSTOMERS IN CANADA

#### CAUTION

TO PREVENT ELECTRIC SHOCK, DO NOT USE THIS POLARIZED AC PLUG WITH AN EXTENSION CORD, RECEPTACLE OR OTHER OUTLET UNLESS THE BLADES CAN BE FULLY INSERTED TO PREVENT BLADE EXPOSURE.

For the customers in North America



ENERGY STAR® is a U.S. registered mark.

As an ENERGY STAR® partner, Sony Corporation has determined that this product meets the ENERGY STAR® guidelines for energy efficiency.

# Table of Contents

## Parts Identification

Main unit .....	4
Remote Control .....	5

## Getting Started

Hooking up the system .....	6
Inserting two size-AA (R6) batteries into the remote control .....	7
Setting the time .....	7
Saving power in standby mode .....	7

## CD

Loading the CD .....	8
Playing the CD — Normal Play/Shuffle Play/Repeat Play ....	8
Programming the CD tracks — Program Play .....	9
Using the CD display .....	10

## Tuner

Presetting radio stations .....	11
Listening to the radio — Preset Tuning .....	11
Using the Radio Data System (RDS)* ...	12

## Tape

Loading a tape .....	13
Playing a tape .....	13
Recording to a tape — CD Synchro Recording/ Recording Manually/Program Edit ....	14
Timer-recording radio programs .....	15

## Sound Adjustment

Adjusting the sound .....	17
---------------------------	----

## Other Features

Falling asleep to music — Sleep Timer .....	17
Waking up to music — Daily Timer .....	18

## Optional Components

Hooking up the optional components ....	19
---	----

## Additional Information

Precautions .....	20
Troubleshooting .....	21
Specifications .....	23

\* European model only

The items are arranged in alphabetical order.

Refer to the pages indicated in parentheses () for details.

## Main unit

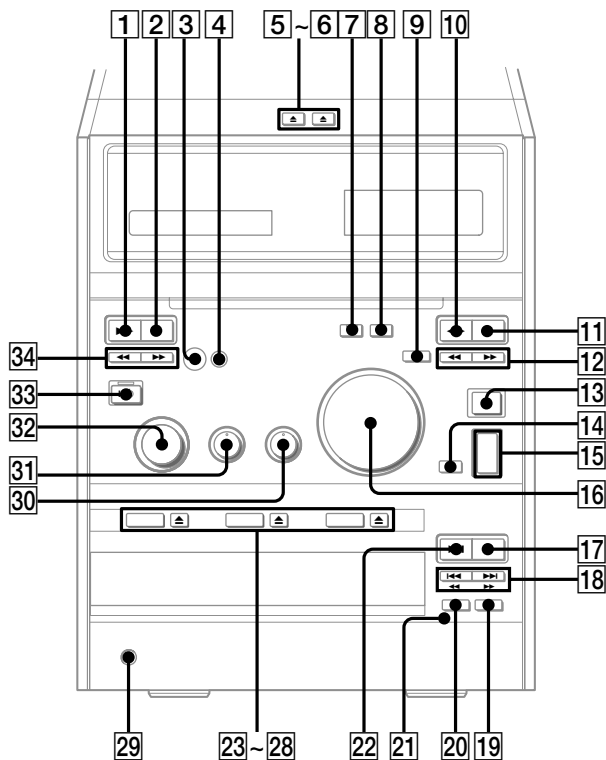

1 DISC indicator **21** (8, 9)

BASS **31** (17)

CD 1 **23** (9)

CD 1 **▲24** (8, 9)

CD 2 **25** (9)

CD 2 **▲26** (8, 9)

CD 3 **27** (9)

CD 3 **▲28** (8, 9)

CD SYNC **7** (14, 15)

CD **▶▶22** (8~10)

CD **■17** (8, 10)

CD **◀◀/▶▶18** (8, 9)

CD **◀◀/▶▶18** (8)

DECK A EJECT **▲5** (13)

DECK B EJECT **▲6** (13)

DSG **4** (17, 19)

FUNCTION **32** (8, 9, 11, 13, 14, 19)

PHONES jack **29**

PLAY MODE **20** (8~10, 15)

Remote sensor **3**

REPEAT **19** (9)

TAPE A **▶1** (13)

TAPE B **◀10** (13~15)

TAPE A **■2** (13)

TAPE B **■11** (13~15)

TAPE A **◀◀/▶▶34** (13)

TAPE B **◀◀/▶▶12** (13)

TAPE REC **●8** (14)

TAPE **||9** (13~15)

TREBLE **30** (17)

TUNER BAND **13** (11)

TUNING MODE **14** (11, 12)

TUNING +/- **15** (11, 12)

VOLUME **16** (18)

### BUTTON DESCRIPTIONS

**I/P** (power) **33** (7, 11, 16, 18, 19, 22)

# Remote Control

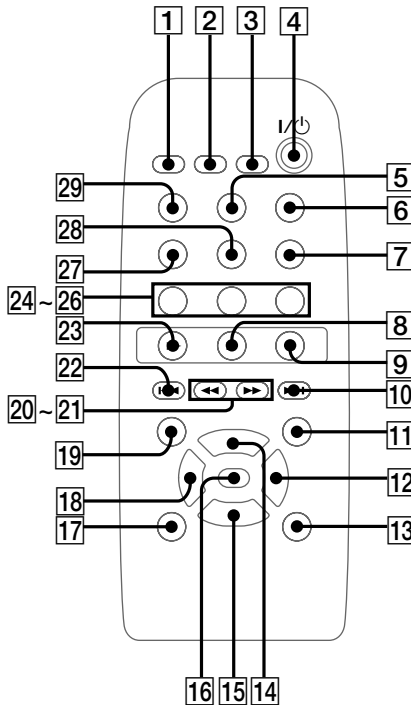

- BASS/TREBLE **19** (17)
- CD **27** (8)
- DIRECTION **17** (13~15)
- DISC1 **24** (9)
- DISC2 **25** (9)
- DISC3 **26** (9)
- DISPLAY **12** (7, 10, 12)
- DSG **11** (17)
- ENTER **16** (7, 11, 15, 18)
- FUNCTION **5** (8, 9, 11, 13, 14, 19)
- MEMORY **18** (11)

- PLAY MODE **29** (8~10, 15)
- SLEEP **1** (17)
- STEREO/MONO **13** (12)
- TAPE A/B **28** (13)
- TIMER SELECT **2** (16, 18)
- TIMER SET **3** (7, 15, 18)
- TUNER/BAND **7** (11)
- TUNING MODE **6** (11, 12)
- VOL + **14** (18)
- VOL - **15** (18)

## BUTTON DESCRIPTIONS

- ▶ **23** (8~10, 13~15)
- || **8** (8, 13~15)
- **9** (8, 10, 13~15)
- ◀◀ **22** (7~9, 11, 15, 17, 18)
- ▶▶ **10** (7~9, 11, 15, 17, 18)
- ◀◀ **20** (8, 11~13)
- ▶▶ **21** (8, 11~13)
- I/⏻ (power) **4** (7, 11, 16, 18)

## Hooking up the system

Follow steps **1** through **4** of the procedure below to hook up your system using the supplied cords and accessories.

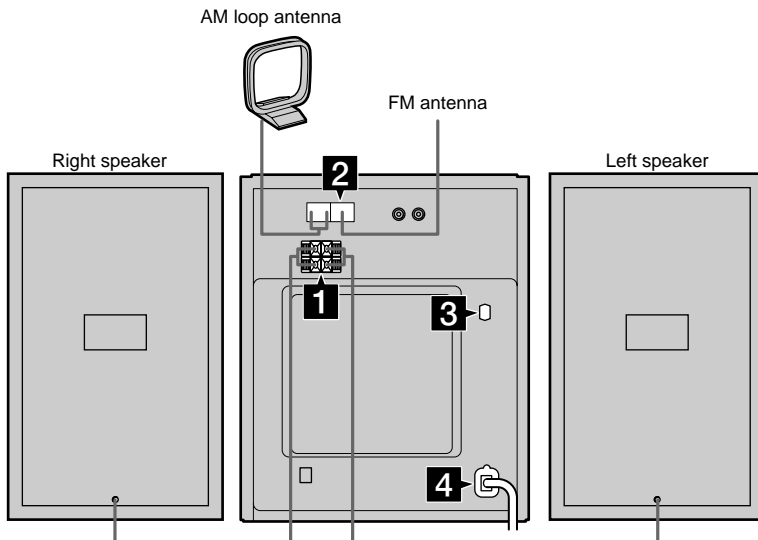

### 1 Connect the speakers.

Connect the right and left speaker cords to the SPEAKER terminals as shown below.

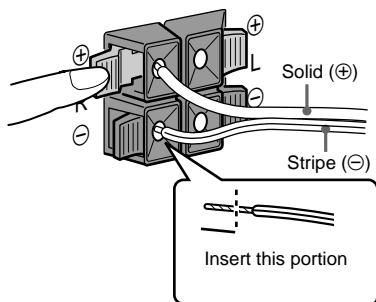

### 2 Connect the FM and AM antennas.

Set the AM loop antenna up before connecting it.

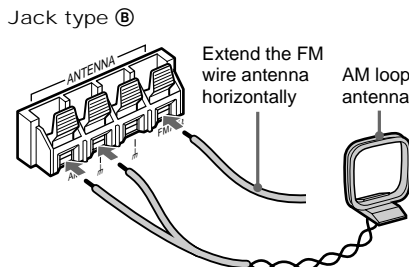
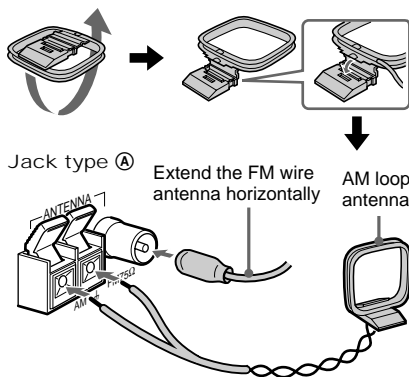

- 3** For models with a voltage selector, set **VOLTAGE SELECTOR** to the local power line voltage.

110V-120V



220V-240V

VOLTAGE  
SELECTOR

- 4** Connect the power cord to a wall outlet.

If the plug does not fit the wall socket, detach the supplied plug adaptor (only for models equipped with an adaptor).

To turn on the system, press **I/⏻**.

## Inserting two size-AA (R6) batteries into the remote control

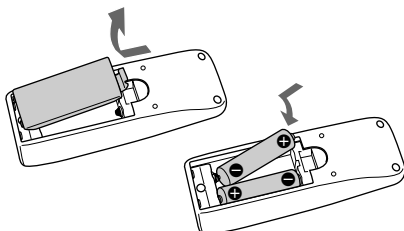

### Tip

When the remote no longer operates the system, replace both batteries with new ones.

### Note

If you do not use the remote for a long period of time, remove the batteries to prevent possible damage from battery leakage and corrosion.

## Setting the time

- 1** Turn on the system.
- 2** Press **TIMER SET** on the remote.  
If you are setting the clock for the first time, go to step 5.
- 3** Press **◀◀/▶▶** on the remote repeatedly until **"CLOCK"** appears in the display.
- 4** Press **ENTER** on the remote.  
The hour indication flashes.
- 5** Press **◀◀/▶▶** on the remote repeatedly to set the hour.
- 6** Press **ENTER** on the remote.  
The minute indication flashes.
- 7** Press **◀◀/▶▶** on the remote repeatedly to set the minute.
- 8** Press **ENTER** on the remote.  
The clock will begin operating.

To reset the system clock

Start over from step 1.

## Saving power in standby mode

Press **DISPLAY** on the remote repeatedly while the system is turned off.

The system switches as follows:

Clock display ↔ Power Saving Mode

## Loading the CD

- 1 Press any one of the **▲** buttons for CD 1 - 3.

The disc tray slides out.

- 2 Load a CD onto the disc tray.

Load with the label side up. When you play a CD single (8 cm CD), load it onto the inner circle of the tray.

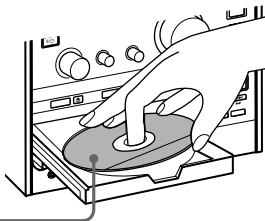

- 3 Press the same **▲** to close the disc tray.

## Playing the CD

### — Normal Play/Shuffle Play/Repeat Play

This system lets you play CDs in different play modes.

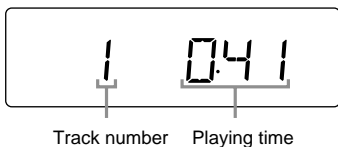

- 1 Turn **FUNCTION** (or press **FUNCTION** on the remote repeatedly) until "CD" appears in the display.

The indicator surrounding the CD **▶▶** and CD **■** buttons lights up.

You can switch the function to CD by pressing the CD button on the remote.

- 2 Press **PLAY MODE** repeatedly until the mode you want appears in the display.

Select	To play
No display	The selected CD in original order when the 1 DISC indicator lights up. All the CDs in consecutive order when the 1 DISC indicator goes off.
SHUFFLE	The tracks on the selected CD in random order when the 1 DISC indicator lights up. The tracks on all the CDs in random order when the 1 DISC indicator goes off.
PGM	The tracks on all the CDs in any order that you want (see "Programming the CD tracks" on page 9).

- 3 Press CD **▶▶** (or **▶** on the remote).

## Other Operations

To	Do this
Stop playback	Press CD <b>■</b> .
Pause	Press CD <b>▶▶</b> (or <b>  </b> on the remote). Press again to resume playback.
Select a track	During playback or pause, press CD <b>◀◀/▶▶</b> repeatedly until you find the desired track.
Find a point in a track	During playback, press and hold down CD <b>◀◀/▶▶</b> until you find the desired point.



To	Do this
Select a CD	Press any one of the buttons, CD 1 - 3 (or DISC1 - 3 on the remote). The CD changes automatically and the selected CD starts playing back. When you press any one of the buttons, CD 1 - 3 (or DISC1 - 3 on the remote), during playback, the CD changes automatically and the selected CD starts playing back.
Remove a CD	Press any one of the ▲ buttons for CD 1 - 3 to open the tray containing the desired CD.
Play repeatedly (Repeat Play)	Press REPEAT repeatedly during playback until "REPEAT" or "REPEAT 1" appears in the display. REPEAT: For all the tracks on the CD(s) (up to five times). REPEAT 1: For only the currently playing track. To cancel playing repeatedly, press REPEAT repeatedly until "REPEAT" and "REPEAT 1" disappear from the display.

#### Tip

When a CD is selected or playing back, one of the indicators for CD 1 - 3 lights up green. When a CD is loaded on a tray, the respective indicators for CD 1 - 3 light(s) up orange.

#### Note

You cannot perform Repeat Play when you select "SHUFFLE" with the 1 DISC indicator turned off.

## Programming the CD tracks

### — Program Play

You can make a program of up to 25 tracks in any order that you want, selected from the tracks on all three CDs.

- 1 Turn **FUNCTION** (or press **FUNCTION** on the remote repeatedly) until "CD" appears in the display.
- 2 Press **PLAY MODE** repeatedly until "PGM" appears in the display.
- 3 Press any one of the buttons, **CD 1 - 3** (or **DISC1 - 3** on the remote), to select the desired CD.  
To program all the tracks on a CD at one time, go to step 5 while "AL" is displayed.
- 4 Press **CD** ◀◀/▶▶ repeatedly until the desired track number appears in the display.

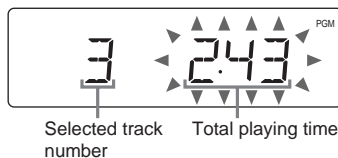

- 5 Press **PLAY MODE**.  
The selected track is programmed.  
The selection number appears in the display.
- 6 To program additional tracks, repeat steps 3 through 5.
- 7 Press **CD** ▶▶ (or ▶ on the remote).

continued

## Programming the CD tracks (continued)

To	Do this
Cancel Program Play	Press PLAY MODE repeatedly until "PGM" disappears from the display.
Add a track to the end of the program	Do steps 3 through 5 with Program Play stopped.
Erase the entire program	Press CD ■ with Program Play stopped.

### Tips

- The program you made remains after Program Play finishes. To play the program again, switch the function to CD, and then press CD ►|| (or ► on the remote).
- "--:--" appears in the display when the total program time exceeds 100 minutes, or when you select a track whose number is 21 or over.

## Using the CD display

### Press DISPLAY on the remote repeatedly.

When a CD TEXT disc is loaded, you can check the information recorded on the disc, such as the titles.

The display changes as follows:

During normal playback

Current track number and elapsed playing time of the track → Current track number and remaining playing time of the track → Remaining playing time of the current CD → Track title of the current track\* → Clock display → Current track number and elapsed playing time of the track → .....

While the CD is stopped

Total number of tracks and total playing time of the current CD → Disc title\* → Clock display → Total number of tracks and total playing time of the current CD → .....

- \* If a CD that has no title is loaded, nothing appears.  
When the CD contains 21 tracks or more, CD TEXT is not displayed for each track starting with the 21st.

### Note

When the 1 DISC indicator goes off, the remaining playing time of the current disc will appear as "--:--".

## Presetting radio stations

The system can store a total of 30 preset stations (20 for FM and 10 for AM).

- 1 Turn **FUNCTION** (or press **FUNCTION** on the remote repeatedly) until **“TUNER”** appears in the display.

The indicator surrounding the TUNER BAND button lights up.

- 2 Press **TUNER BAND** to select **FM** or **AM**.

- 3 Press **TUNING MODE** repeatedly until **“AUTO”** appears in the display.

- 4 Press **TUNING +/-** (or **◀▶**) on the remote).

The frequency changes as the system scans for a station. Scanning stops automatically when a station is tuned in. At that time, **“TUNED”** and **“STEREO”** (for stereo program only) appear.

- 5 Press **MEMORY** on the remote.

A preset number flashes.

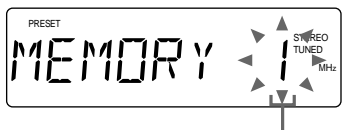

Preset number

- 6 Press **◀▶** on the remote repeatedly to select the preset number that you want.

- 7 Press **ENTER** on the remote.

The station is stored to the selected preset number.

- 8 Repeat steps 2 through 7 to preset other stations.

To tune in a weak station

In step 3, press **TUNING MODE** repeatedly until **“AUTO”** and **“PRESET”** disappear from the display, then press **TUNING +/-** (or **◀▶**) on the remote) repeatedly to tune in the station.

To change the preset number  
Start over from step 2.

Tip

The preset stations are saved in the system's memory for about a day even if you disconnect the power cord or a power failure occurs.

To change the AM tuning interval (not applicable on the European, Middle Eastern and Philippine models)

The AM tuning interval is factory-preset to 9 kHz (or 10 kHz for some areas). To switch the AM tuning interval, tune in any AM station first, then turn off the system. Pressing and holding down **TUNING +**, turn the system back on. When you change the interval, all the AM preset stations are erased. To change back to the original interval, repeat the same procedure.

## Listening to the radio

### — Preset Tuning

Presetting radio stations in the system's memory in advance make it easy to tune in those stations later (see “Presetting radio stations” on this page).

- 1 Turn **FUNCTION** (or press **FUNCTION** on the remote repeatedly) until **“TUNER”** appears in the display.

- 2 Press **TUNER BAND** to select **FM** or **AM**.

- 3 Press **TUNING MODE** repeatedly until **“PRESET”** appears in the display.

- 4 Press **TUNING +/-** (or **◀▶**) on the remote) repeatedly to display the preset number of the desired station.

To turn off the radio

Press **I/⏻**.

continued

## **Listening to the radio (continued)**

To tune in a non-preset radio station  
In step 3, press TUNING MODE repeatedly until "AUTO" and "PRESET" disappear from the display, then press TUNING +/- (or ◀▶) on the remote) repeatedly to tune in the desired station (Manual Tuning).

### Tips

- If there is static during an FM broadcast, press STEREO/MONO on the remote until "MONO" appears in the display. After "MONO" appears in the display, the frequency will appear. The broadcast will no longer be in stereo, but the reception will improve.
- To improve the reception, adjust the supplied antennas or connect an external antenna.

## **Using the Radio Data System (RDS)**

(European model only)

What is the Radio Data System?

Radio Data System (RDS)\* is a broadcasting service that allows radio stations to send additional information along with the regular program signal.

### Note

RDS may not work properly if the station you have tuned in is not transmitting the RDS signal properly or if the signal is weak.

\* Not all FM stations provide RDS service, nor do they all provide the same type of services. If you are not familiar with the RDS system, check with your local radio stations for details on RDS services in your area.

## Receiving RDS broadcasts

### **Simply select a station from the FM band.**

When you tune in a station that provides RDS services, the station name appears in the display.

To check the RDS information

Each time you press DISPLAY on the remote, the display changes as follows:

Station name\* → Frequency → Clock display  
→ Station name\* → .....

\* If the RDS broadcast is not properly received, the station name may not appear in the display.

## Loading a tape

- 1 Press **DECK A (or B) EJECT** ▲.
- 2 Load a recorded/recordable tape into the cassette holder A\* (or B).

With the side you want to play/record on facing towards you

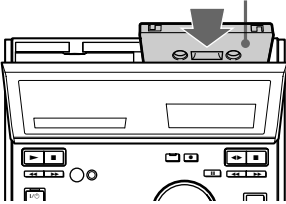

\* Playback only

## Playing a tape

You can use Type I (normal) tape.

- 1 Load a recorded tape into the cassette holder A (or B).
- 2 Turn **FUNCTION** (or press **FUNCTION** on the remote repeatedly) until “TAPE A” (or “TAPE B”) appears in the display.

The indicator surrounding the TAPE A ► (or B ◀►) and TAPE A (or B) ■ buttons lights up.

To switch to the other deck, press TAPE A/B on the remote.

- 3 Press **DIRECTION** on the remote repeatedly to select “↔” to play one side of the tape or “↔↔”\*\* to play both sides repeatedly (up to five times).

To play both tapes in consecutive order, select “R” (Relay)\*\*.

\* Deck A does not play the reverse side.

\*\* The front side of the tape in deck A plays once, and then both sides of the tape in deck B play repeatedly (up to five times).

- 4 Press **TAPE A** ► (or B ◀►) (or ► on the remote).

Press TAPE B ◀► (or ► on the remote) again to play the reverse side of the tape in deck B. The tape starts playing back.

## Other Operations

To	Do this
Stop playback	Press TAPE A (or B) ■.
Pause*	Press TAPE ■. Press again to resume playback.
Fast-forward or rewind	With the tape stopped, press TAPE A (or B) ◀◀/▶▶.
Remove a tape**	Press DECK A (or B) EJECT ▲.

\* On deck B only

\*\* Do not press DECK A (or B) EJECT ▲ while the tape is moving.

## Recording to a tape

### — CD Synchro Recording/Recording Manually/Program Edit

You can record from a CD, radio, tape or any of the connected components. You can use Type I (normal) tape.

Steps	Recording from CDs (CD Synchro Recording)	Recording manually
1	Load a recordable tape into the cassette holder B.	
2	Load a CD onto the disc tray.	Turn FUNCTION (or press FUNCTION on the remote repeatedly) to select the source you want to record from.
3	Turn FUNCTION (or press FUNCTION on the remote repeatedly) until "CD" appears in the display. To record from a CD in original order, switch the play mode to Normal Play.	Load a CD or a recorded tape, or tune in the desired station.
4	Press CD SYNC.	Press TAPE REC ●.
	The tape B stands by for recording. "REC" and "▶" (or "◀") appear. To start recording on the side facing away from you, press TAPE B ◀▶ until "REC▶" changes to "◀REC."	
5	Press DIRECTION on the remote repeatedly to select "↔" to record on one side of the tape or "↔↔" to record on both sides.	
6	Press TAPE II.	Press TAPE II, and then start playing the desired source.

To stop recording

Press TAPE B ■.

Tip

For recording manually:

To pause recording, press TAPE II.

## Recording CD tracks in your favorite order

— *Program Edit*

- 1 Load a recordable tape into the cassette holder B.**
- 2 Load a CD onto the disc tray.**
- 3 Do steps 1 through 6 in Program Play (see page 9).**
- 4 Press CD SYNC.**

The tape B stands by for recording and the CD(s) stand(s) by for playback.  
“REC” and “▶” (or “◀”) appear, and the CD SYNC indicator lights up.  
To start recording on the side facing away from you, press TAPE B ◀▶ until “REC▶” changes to “◀REC.”
- 5 Press DIRECTION on the remote repeatedly to select “↔” to record on one side of the tape or “↔↔” to record on both sides.**
- 6 Press TAPE II.**

To	Do this
Stop recording	Press TAPE B ■.
Cancel Program Edit	Press PLAY MODE repeatedly until “PGM” disappears from the display.

## Timer-recording radio programs

To timer-record, make sure that you have set the system clock correctly (see “Setting the time” on page 7) and preset the radio station (see “Presetting radio stations” on page 11).

- 1 Tune in the desired preset radio station (see “Listening to the radio” on page 11).**
- 2 Load a recordable tape into the cassette holder B.**
- 3 Press TIMER SET on the remote.**
- 4 Press ◀◀/▶▶ on the remote repeatedly until “REC” appears in the display.**

“REC” and “⊖ REC” appear in the display.
- 5 Press ENTER on the remote.**

“ON TIME” appears, then the hour indication flashes.
- 6 Set the starting time.**

Press ◀◀/▶▶ on the remote repeatedly to set the hour, then press ENTER on the remote.  
The minute indication begins flashing next.  
Press ◀◀/▶▶ on the remote repeatedly to set the minute, then press ENTER on the remote.  
“OFF TIME” appears, then the hour indication flashes again.

continued

## Timer-recording radio programs (continued)

### 7 Set the stopping time by repeating step 6.

The start time, the stopping time, “TUNER”, and the preset station appear in turn, then the original display returns.

### 8 Press **⏻** to turn off the system.

When the recording starts, the volume level is automatically set to the minimum.

To	Do this
Check the settings	Press TIMER SELECT on the remote repeatedly until “⏻ REC” appears in the display. The preset items appear in turn.
Turn off the timer	Press TIMER SELECT on the remote repeatedly until “⏻ REC” disappears from the display.

#### Tip

Once you set the timer, the time settings will remain in the system’s memory until you change them, even when you turn the system or the timer off. The settings that were last used will be in effect when you turn the timer on again.

#### Notes

- The system will turn on 15 seconds before the specified starting time.
- If the system is turned on at the specified starting time, recording will not occur.
- When you have set the Sleep Timer, the timer recording will not operate until the Sleep Timer Function is turned off.



## Adjusting the sound

Generating a more dynamic sound (Dynamic Sound Generator)

Press DSG.

To cancel the DSG, press DSG again.

Adjusting the bass

Turn BASS.

You can adjust the bass in 7 steps.

Adjusting the treble

Turn TREBLE.

You can adjust the treble in 7 steps.

To adjust the bass or treble with the remote

- 1 Press BASS/TREBLE repeatedly to select "BASS" (or "TREBLE").
- 2 While "BASS" (or "TREBLE") appears in the display, press **◀◀/▶▶** repeatedly to adjust the bass (or treble).

## Falling asleep to music

### — Sleep Timer

The Sleep Timer Function lets you specify a sleep time, after which the system stops playing and turns off automatically. You can thus fall asleep to music.

#### Press SLEEP on the remote repeatedly.

The sleep time changes as follows:

AUTO\* → 90MIN → 80MIN → 70MIN → ... → 10MIN → OFF → AUTO\* → ...

\* The system turns off after the current CD or tape finishes playing (up to 100 minutes). The system also turns off when you manually stop the CD or tape.

To	Press
Check the remaining sleep time	SLEEP on the remote once.
Change the sleep time	SLEEP on the remote repeatedly until the time you want appears.
Cancel the Sleep Timer Function	SLEEP on the remote repeatedly until "OFF" appears.

# Waking up to music

## — Daily Timer

By setting the Daily Timer, you can make the system automatically turn on and off at specified times. To use this function, make sure that you have set the system clock correctly (see “Setting the time” on page 7).

### 1 Prepare the music source you want to listen to when the system turns on.

- CD: Load a CD. To start playing from a specific track, make a program (see “Programming the CD tracks” on page 9).
- Tape: Load a tape with the side you want to play facing towards you.
- Radio: Tune in the preset radio station that you want (see “Listening to the radio” on page 11).

### 2 Adjust the volume.

### 3 Press **TIMER SET** on the remote.

### 4 Press **◀▶** on the remote repeatedly until “DAILY” appears in the display.

“DAILY” and “⊖ DAILY” appear in the display.

### 5 Press **ENTER** on the remote.

“ON TIME” appears, then the hour indication flashes.

### 6 Set the starting time.

Press **◀▶** on the remote repeatedly to set the hour, then press **ENTER** on the remote.

The minute indication begins flashing next.

Press **◀▶** on the remote repeatedly to set the minute, then press **ENTER** on the remote.

“OFF TIME” appears, then the hour indication flashes again.

### 7 Set the stopping time by repeating step 6.

### 8 Press **◀▶** on the remote repeatedly until the music source you want appears.

The display changes as follows:



### 9 Press **ENTER** on the remote.

The starting time, the stopping time, and the music source appear in turn, then the original display returns.

### 10 Press **I/⏻** to turn off the system.

To	Do this
Check the settings	Press <b>TIMER SELECT</b> on the remote repeatedly until “⊖ DAILY” appears in the display. The preset items appear in turn.
Turn off the timer	Press <b>TIMER SELECT</b> on the remote repeatedly until “⊖ DAILY” disappears from the display.

#### Tip

Once you set the timer, the time settings will remain in the system’s memory until you change them, even when you turn the system or the timer off. The settings that were last used will be in effect when you turn the timer on again.

#### Notes

- The system will turn on 15 seconds before the specified starting time.
- When you have set the Sleep Timer, the Daily Timer will not operate until the Sleep Timer Function is turned off.

## Hooking up the optional components

You can connect a variety of components to your system in order to enhance it. Make sure that the color of the plugs matches that of the connectors.

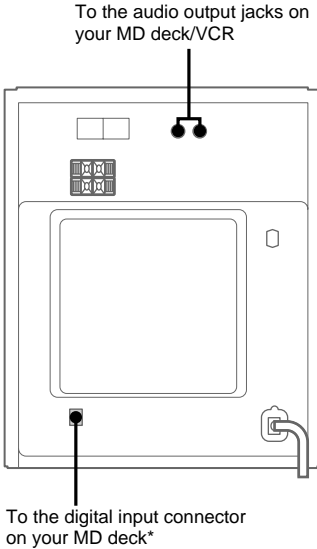

**Tip**

If you cannot select “VIDEO” by turning FUNCTION (or press FUNCTION on the remote repeatedly), press **I/C** while pressing down DSG in standby mode. The function will change from “MD” to “VIDEO”, and “VIDEO” will appear in the display. To change back to “MD”, repeat this procedure.

\* If the jack is covered with a cap, remove it before use.

To	Do This
Make a digital recording from CD to MD	Connect an optical cable.
Listen to the connected MD deck	Turn FUNCTION (or press FUNCTION on the remote repeatedly) until “MD” appears in the display.
Listen to the connected VCR	Turn FUNCTION (or press FUNCTION on the remote repeatedly) until “VIDEO” appears in the display.

### Precautions

#### On operating voltage

Before operating the system, check that the operating voltage of your system is identical with the voltage of your local power supply.

#### On safety

- The unit is not disconnected from the AC power source (mains) as long as it is connected to the wall outlet, even if the unit itself has been turned off.
- Unplug the system from the wall outlet (mains) if it will not be used for an extended period of time. To disconnect the power cord (mains lead), pull it out by the plug. Never pull the cord itself.
- Should any solid object or liquid fall into the system, unplug the system and have it checked by qualified personnel before operating it any further.
- AC power cord must be changed only at the qualified service shop.

#### On placement

- Do not place the system in an inclined position.
- Do not place the system in locations where it is:
  - Extremely hot or cold
  - Dusty or dirty
  - Very humid
  - Subject to vibrations
  - Subject to direct sunlight
- Use caution when placing the unit or speakers on surfaces that have been specially treated (with wax, oil, polish, etc.) as staining or discoloration of the surface may result.

#### On heat buildup

- Although the unit heats up during operation, this is not a malfunction.
- Place the system in a location with adequate ventilation to prevent heat build-up in the system.

If you continuously use this system at a large volume, the cabinet temperature of the top, side and bottom rises considerably. To avoid burning yourself, do not touch the cabinet.

To prevent a malfunction, do not cover the ventilation hole for the cooling fan.

#### On operation

- If the system is brought directly from a cold place to a warm place, or is placed in a very damp room, moisture may condense on the lens inside the CD player. Should this occur, the system will not operate properly. Remove the CD and leave the system turned on for about an hour until the moisture evaporates.
- When moving the unit, remove any disc that may be on the disc tray.

If you have any questions or problems concerning your system, please consult your nearest Sony dealer.

#### Notes on CDs

- Before playing a CD, clean the CD surface with a cleaning cloth. Wipe the CD from the center out.
- Do not play a CD with tape, stickers, or adhesives on any of its surfaces as this may damage the system.
- Do not use solvents.
- Do not expose the CDs to direct sunlight or heat sources.

#### Note on CD-R/CD-RW playback

Discs recorded on CD-R/CD-RW drives may not be played back because of scratches, dirt, recording condition or the driver's characteristics. Besides, the discs, which are not yet finalized at the end of recording, cannot be played back.

#### Music discs encoded with copyright protection technologies

This product is designed to playback discs that conform to the Compact Disc (CD) standard. Recently, various music discs encoded with copyright protection technologies are marketed by some record companies. Please be aware that among those discs, there are some that do not conform to the CD standard and may not be playable by this product.

#### Cleaning the cabinet

Clean the cabinet, panel and controls with a soft cloth slightly moistened with mild detergent solution. Do not use any type of abrasive pad, scouring powder or solvent such as thinner, benzene or alcohol.

#### To save a tape permanently

To prevent a tape from being accidentally recorded over, break off the cassette tabs from side A or side B as illustrated.

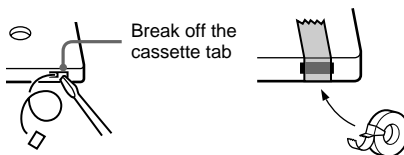

If you later want to reuse the tape for recording, cover the broken tab with adhesive tape.

Before placing a cassette in the tape deck

Take up any slack in the tape. Otherwise the tape may get entangled in the tape deck's playing mechanism and become damaged.

When using a tape longer than 90 minutes

The tape is very elastic. Do not change the tape operations such as play, stop, and fast-winding etc. too frequently. The tape may get entangled in the tape deck's playing mechanism.

Cleaning the tape heads

Clean the tape heads after every 10 hours of use. Make sure to clean the tape heads before making an important recording or after playing an old tape. Use a commercially available dry-type or wet-type cleaning cassette. For details, refer to the instructions of the cleaning cassette.

Demagnetizing the tape heads

Demagnetize the tape heads and the metal parts that have contact with the tape after every 20 to 30 hours of use with a commercially available demagnetizing cassette. For details, refer to the instructions of the demagnetizing cassette.

## Troubleshooting

Should you encounter a problem with your system, do the following:

- 1 Make sure the power cord and speaker cords are correctly and firmly connected.
- 2 Find your problem in the troubleshooting checklist below and take the indicated corrective action.

If the problem persists after doing all of the above, consult your nearest Sony dealer.

## General

---

**There is no sound from the speakers.**

- Adjust the volume.
  - The headphones are connected.
  - Check the speaker connections.
- 

**There is severe hum or noise.**

- A TV or VCR is placed too close to the unit. Move the unit away from the TV or VCR.
- 

**"--:--" appears in the display.**

- A power interruption has occurred. Set the clock (see page 7) and timer settings (see pages 15 and 18) again.
- 

**The timer does not function.**

- Make sure the clock is correctly set (see page 7).
  - You cannot operate the Daily Timer and the timer recording at the same time.
- 

**"⊖ DAILY" and "⊖ REC" do not appear when you press TIMER SELECT on the remote.**

- Make sure each timer is correctly set (see pages 15 and 18).
  - Make sure the clock is correctly set (see page 7).
- 

**The color on the TV screen is irregular.**

- Move the speakers farther away from the TV set.
- 

**The remote does not work.**

- There is an obstacle between the remote and the unit.
  - You are not pointing the remote in the direction of the system's sensor.
  - The batteries in the remote have run down. Replace the batteries.
  - Make sure that the batteries are inserted correctly.
- 

continued

## Troubleshooting (continued)

### Speakers

---

**Sound comes from only one channel, or the left and right volumes are unbalanced.**

- Check the speaker connections and placement.
- 

### CD Player

---

**The CD will not play.**

- The CD is dirty.
  - The surface of the CD is scratched. Replace the CD.
  - The CD is loaded with the label side down.
  - Condensation has built up in the system. Remove the CD and leave the system turned on for about an hour until the moisture evaporates.
- 

**Play does not start from the first track.**

- The player is in Program or Shuffle Play. Press PLAY MODE repeatedly until “PGM” and “SHUFFLE” disappear.
- 

### Tape Deck

---

**Recording cannot be done.**

- There is no tape in the cassette holder B.
  - The record protect tab has been removed from the cassette (see page 20).
  - The tape has come to the end.
- 

**The tape does not record or play, or there is a decrease in sound level.**

- The heads are dirty. Clean them (see page 21).
  - The record/playback heads are magnetized. Demagnetize them (see page 21).
- 

**The tape does not erase completely.**

- The record/playback heads are magnetized. Demagnetize them (see page 21).
- 

**There is excessive wow or flutter, or the sound drops out.**

- The capstans or pinch rollers are dirty. Clean them (see page 21).
- 

**Noise increases or the high frequencies are missing.**

- The record/playback heads are magnetized. Demagnetize them (see page 21).
- 

### Tuner

---

**There is a severe hum or noise (“TUNED” or “STEREO” flashes).**

- Adjust the antenna.
  - The signal strength is too weak. Connect an external antenna.
  - Make sure that the antenna is connected properly.
  - Do not bend or roll up the antenna.
  - The two wires comprising the FM antenna have been pulled further apart since the system was first purchased. Repair or replace with a new one.
  - The AM antenna wire is detached from the stand.
  - Keep the antennas as far away from the speaker cords as possible.
- 

**A stereo FM program cannot be received in stereo.**

- Press STEREO/MONO on the remote until “STEREO” appears in the display.
- 

### Resetting the system

- 1** Disconnect the power cord from the wall outlet.
- 2** Connect the power cord to the wall outlet again.
- 3** Turn on the system.
- 4** Press I/⏻ while pressing down TAPE A ■ and TAPE B ■.

The system is reset to the factory settings. All previous settings are cleared and must be set again.

### Messages

One of the following messages may appear or flash in the display during operations.

---

#### NO DISC

- There is no CD on the disc tray.
- 

#### PGM FULL

- You try to program 26 tracks or more.
-

# Specifications

## Amplifier section

For the U.S. model

### AUDIO POWER SPECIFICATIONS

#### POWER OUTPUT AND TOTAL

#### HARMONIC DISTORTION:

##### CMT-CP333:

With 6-ohm loads, both channels driven, from 120 - 10,000 Hz; rated 40 watts per channel minimum RMS power, with no more than 10% total harmonic distortion from 250 milliwatts to rated output.

##### CMT-CP300:

With 6-ohm loads, both channels driven, from 120 - 10,000 Hz; rated 29 watts per channel minimum RMS power, with no more than 0.9% total harmonic distortion from 250 milliwatts to rated output.

##### North American model (CMT-CP333):

Continuous RMS power output (reference):  
40 + 40 W  
(6 ohms at 1 kHz, 10% THD)

Total harmonic distortion less than 0.07% (6 ohms at 1 kHz, 32 W)

##### North American model (CMT-CP300):

Continuous RMS power output (reference):  
35 + 35 W  
(6 ohms at 1 kHz, 10% THD)

Total harmonic distortion less than 0.07% (6 ohms at 1 kHz, 28 W)

##### European model (CMT-CP333):

DIN power output (rated): 32 + 32 W  
(6 ohms at 1 kHz, DIN)  
Continuous RMS power output (reference):  
40 + 40 W  
(6 ohms at 1 kHz, 10% THD)

Music power output (reference):  
100 + 100 W

##### European model (CMT-CP300):

DIN power output (rated): 30 + 30 W  
(6 ohms at 1 kHz, DIN)  
Continuous RMS power output (reference):  
35 + 35 W  
(6 ohms at 1 kHz, 10% THD)

Music power output (reference):  
85 + 85 W

##### Other models (CMT-CP333):

The following measured at 230 V AC, 60 Hz  
DIN power output (rated): 30 + 30 W  
(6 ohms at 1 kHz, DIN)  
Continuous RMS power output (reference):  
38 + 38 W  
(6 ohms at 1 kHz, 10% THD)

The following measured at 220 V AC, 60 Hz  
DIN power output (rated): 27 + 27 W  
(6 ohms at 1 kHz, DIN)  
Continuous RMS power output (reference):  
35 + 35 W  
(6 ohms at 1 kHz, 10% THD)

##### Other models (CMT-CP300):

The following measured at 230 V AC, 60 Hz  
DIN power output (rated): 27 + 27 W  
(6 ohms at 1 kHz, DIN)  
Continuous RMS power output (reference):  
32 + 32 W  
(6 ohms at 1 kHz, 10% THD)

The following measured at 220 V AC, 60 Hz  
DIN power output (rated): 23 + 23 W  
(6 ohms at 1 kHz, DIN)  
Continuous RMS power output (reference):  
26 + 26 W  
(6 ohms at 1 kHz, 10% THD)

## Inputs

AUDIO IN MD (VIDEO) (phono jacks):  
Sensitivity 500/250 mV,  
impedance 47 kilohms

## Outputs

CD DIGITAL OUT OPTICAL:  
Optical

PHONES:  
Accepts headphones with an impedance of 8 ohms or more

SPEAKER: 6 ohms

## CD player section

System Compact disc and digital audio system  
Laser Semiconductor laser  
( $\lambda = 780 \text{ nm}$ )  
Emission duration: continuous  
Wavelength 780 - 790 nm  
Frequency response 20 Hz - 20 kHz ( $\pm 0.5 \text{ dB}$ )

## Tape player section

Recording system 4-track 2-channel stereo  
Frequency response 50 - 13,000 Hz ( $\pm 3 \text{ dB}$ ), using a Sony TYPE I cassette  
Wow and flutter  $\pm 0.15\% \text{ W. Peak (IEC)}$   
0.1% W. RMS (NAB)  
 $\pm 0.2\% \text{ W. Peak (DIN)}$

## Specifications (continued)

### Tuner section

FM stereo, FM/AM superheterodyne tuner

### FM tuner section

Tuning range  
North American model: 87.5 - 108.0 MHz  
(100-kHz step)

Other models: 87.5 - 108.0 MHz  
(50-kHz step)

Antenna FM wire antenna  
Antenna terminals 75 ohm unbalanced  
Intermediate frequency 10.7 MHz

### AM tuner section

Tuning range  
North American model: 530 - 1,710 kHz  
(with the tuning interval set at 10 kHz)  
531 - 1,710 kHz  
(with the tuning interval set at 9 kHz)

European model: 531 - 1,602 kHz  
(with the tuning interval set at 9 kHz)

Middle Eastern and Philippine models:  
531 - 1,602 kHz  
(with the tuning interval set at 9 kHz)

Other models: 530 - 1,710 kHz  
(with the tuning interval set at 10 kHz)  
531 - 1,602 kHz  
(with the tuning interval set at 9 kHz)

Antenna AM loop antenna, external antenna terminal  
Intermediate frequency 450 kHz

### Speakers

Speaker system Two-way, bass reflex system

Speaker units 13 cm dia., cone type woofer  
2.5 cm dia., semi-dome-type tweeter

Rated impedance 6 ohms

Dimensions (w/h/d) (CMT-CP333)  
Approx. 170 × 275 × 280 mm

Dimensions (w/h/d) (CMT-CP300)  
Approx. 170 × 275 × 265 mm

Mass Approx. 3.0 kg net per speaker

### General

#### Power requirements

North American model: 120 V AC, 60 Hz  
European model: 230 V AC, 50/60 Hz  
Australian model: 220 - 240 V AC, 50/60 Hz  
Other models: 110 - 120 V or 220 - 240 V AC, 50/60 Hz  
Adjustable with voltage selector

#### Power consumption

European model (CMT-CP333):  
70 W  
0.4 W (at the power saving mode)

European model (CMT-CP300):  
70 W  
0.5 W (at the power saving mode)

Other models: 70 W

Dimensions (w/h/d) Approx. 225 × 273 × 385 mm incl. projecting parts and controls

Mass Approx. 7.3 kg

Supplied accessories Remote commander (1)  
AM loop antenna (1)  
FM wire antenna (1)  
Batteries (2)

Design and specifications are subject to change without notice.



## Free Manuals Download Website

<http://myh66.com>

<http://usermanuals.us>

<http://www.somanuals.com>

<http://www.4manuals.cc>

<http://www.manual-lib.com>

<http://www.404manual.com>

<http://www.luxmanual.com>

<http://aubethermostatmanual.com>

Golf course search by state

<http://golfingnear.com>

Email search by domain

<http://emailbydomain.com>

Auto manuals search

<http://auto.somanuals.com>

TV manuals search

<http://tv.somanuals.com>