

3D Glasses

Instructions
Mode d'emploi
Manual de instrucciones

TDG-BR250/BR200

Lea este manual antes de usar el producto



Caution

Please read these safety instructions to ensure your personal safety and prevent property damage.

<p>Owner's Record The model and serial numbers are located on the product. Record these numbers in the spaces provided below. Refer to them whenever you call upon your Sony dealer regarding this product.</p> <p>Model Name _____</p> <p>Serial No. _____</p>	<p>This device complies with part 15 of the FCC rules. Operation is subject to the following two conditions: (1) This device may not cause harmful interference, and (2) this device must accept any interference received, including interference that may cause undesired operation.</p>
--	--

FCC Related Information

This equipment has been tested and found to comply with the limits for a Class B digital device, pursuant to Part 15 of the FCC Rules. These limits are designed to provide reasonable protection against harmful interference in a residential installation. This equipment generates, uses and can radiate radio frequency energy and, if not installed and used in accordance with the instructions, may cause harmful interference to radio communications. However, there is no guarantee that interference will not occur in a particular installation. If this equipment does cause harmful interference to radio or television reception, which can be determined by turning the equipment off and on, the user is encouraged to try to correct the interference by one or more of the following measures:

- Reorient or relocate the receiving antenna.
- Increase the separation between the equipment and receiver.

Pursuant to FCC regulations, you are cautioned that any changes or modifications not expressly approved in this manual could void your authority to operate this equipment.

For Customers in Canada

This Class B digital apparatus complies with Canadian ICES-003.

Warning

- Do not put the 3D Glasses in a fire.
- Do not disassemble the 3D Glasses.
- Do not use, charge, store, or leave the 3D Glasses near a fire, or in places with a high temperature, e.g., in direct sunlight, or in sun-heated cars.
- Use only the supplied USB cable.
- Do not charge the 3D Glasses with anything other than a Sony 3D TV or recommended USB charging AC power adapter.
- For details on Sony devices compliant with 3D, refer to the operating instructions supplied with the device.
- Do not allow water or foreign material to enter the 3D Glasses.

Precautions for use

- The 3D Glasses are operated by receiving infrared signals from the 3D Sync Transmitter. Mis-operation may occur if:
 - The 3D Glasses do not face the 3D Sync Transmitter
 - If there are objects blocking the path between the 3D Glasses and the 3D Sync Transmitter
 - If there are other infrared communication devices or lighting equipment, residential heating equipment, etc. nearby, this may affect their performance.
- Watch the TV using the 3D Glasses, facing squarely towards the TV.
- 3D effect is inadequate and screen color will shift when lying down or tilting your head.

Safety Precautions

- You should only use this product for watching 3D video images on a compatible Sony television.
- Some people may experience discomfort (such as eye strain, fatigue, or nausea) when using this product. Sony recommends that all viewers take regular breaks while watching 3D video images or playing stereoscopic 3D games. The length and frequency of necessary breaks will vary from person to person. You must decide what works best. If you experience any discomfort, you should stop using this product and watching the 3D video images until the discomfort ends; consult a doctor if you believe necessary. You should also review (i) the instruction manual of your television, as well as any other device or media used with your television and (ii) Sony website for the latest information. The vision of young children (especially those under six years old) is still under development. Consult your doctor (such as a pediatrician or eye doctor) before allowing young children to watch 3D video images or play stereoscopic 3D games. Adults should supervise young children to ensure they follow the recommendations listed above.
- Do not drop or modify the 3D Glasses.
- If the 3D Glasses are broken, keep broken pieces away from your mouth or eyes.
- Be careful not to pinch your fingers in the hinges when bending the temple arms.
- Keep this product out of reach of children, so that they are not mistakenly swallowed.

Maintenance of your Glasses

- Wipe the Glasses gently with a soft cloth.
- Stubborn stains may be removed with a cloth slightly moistened with a solution of mild soap and warm water.
- If using a chemically pretreated cloth, be sure to follow the instructions provided on the package.
- Never use strong solvents such as a thinner, alcohol or benzine for cleaning.

Specifications

Weight (oz. (g))	2.1 (59) (black)/2.2 (61) (white) (TDG-BR250) 2.0 (55) (black)/2.1 (57) (white) (TDG-BR200)
Battery Type	Built-in lithium-ion rechargeable battery
Operating time (Approx.) (hours)	30
Charging time (Approx.) (minutes)	30 (in case of charge from TV's USB terminal) * Quick charge: approx. 3 minutes charge enables approx. 3 hours use.
Dimensions (Approx.) (w × h × d (inches (mm)))	6 7/8 × 1 3/4 × 7 3/8 (174 × 44 × 185) (TDG-BR250)/ 6 5/8 × 1 3/4 × 6 3/8 (167 × 44 × 168) (TDG-BR200)
Operating temperature (°F (°C))	32 ~ 104 (0 ~ 40)
Optional accessories	USB charging AC power adapter AC-U501AD

Design and specifications are subject to change without notice.

Parts and Components

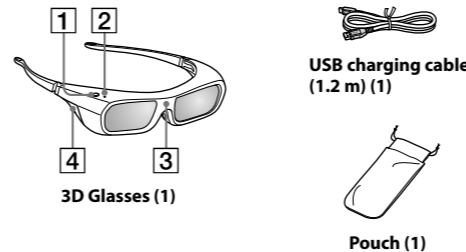

- 1 Power Button**
Power on: Press once
Power off: Hold power button down for 2 seconds (LED flashes three times and turns off)
* Auto power off: More than 5 minutes without IR signal
- 2 LED indicator**
When operating, the indicator lights up green.
 - Flashes once every 2 seconds: Battery operation
 - Flashes three times every 3 seconds: Low battery – Charge the battery
 When charging, the LED indicator lights up yellow. (When charge is completed, the indicator turns off.)

Note
When operating: the indicator lights up green and the battery cannot be charged.
- 3 IR Sensor**
Receiving IR (infrared rays) signals are emitted from the front of the 3D Sync Transmitter. IR's entry angle differs according to distance and/or usage environment.

Note
Please keep the IR Sensor clean.
- 4 Connector for charge**
Charge the battery. When charging, open the cover.

Charging the battery

To prevent battery deterioration, charge the battery at least once every half a year or a year.

- 1 Turn the 3D Glasses power off.
- 2 Turn the TV power on.

- Note**
When the TV is in standby mode, this product cannot be charged.
- 3 Connect the 3D Glasses and the TV with the supplied USB cable.

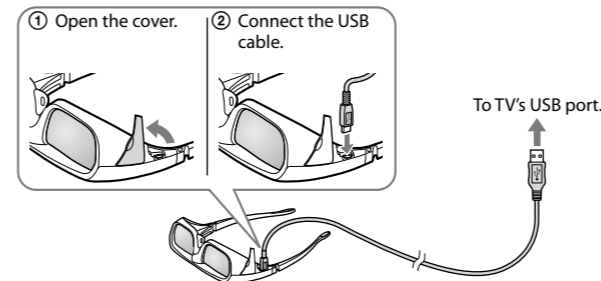

- When connecting this product and the TV with USB cable, this product will start to charge. (When charging, the LED indicator lights up yellow.)
- If you turn the power of this product on when charging the battery, charging will be stopped. (When operating, the indicator lights up green.)
- The 3D Glasses can be charged either by the TV, or the USB charging AC power adapter AC-U501AD (not supplied).

Troubleshooting

In the event of a problem, refer to the TV's instruction manual.
Refer to Sony website for the latest information.
For United States www.sony.com/tvsupport
For Canada www.sony.ca/support

Free Manuals Download Website

<http://myh66.com>

<http://usermanuals.us>

<http://www.somanuals.com>

<http://www.4manuals.cc>

<http://www.manual-lib.com>

<http://www.404manual.com>

<http://www.luxmanual.com>

<http://aubethermostatmanual.com>

Golf course search by state

<http://golfingnear.com>

Email search by domain

<http://emailbydomain.com>

Auto manuals search

<http://auto.somanuals.com>

TV manuals search

<http://tv.somanuals.com>