

USER MANUAL

- CVC-627
- CVC-627B
- CVC-627W



speco technologies

CONTENTS

01

Features

02

Warning & Caution

03

Configuration

06

Accessories

07

How to install

08

Specifications

09

Troubleshooting

11

1. Excellent performance in all light levels
2. Reflective booster increases LED output by 30%
3. IR LEDs effective over 10 meter distance
4. CDS sensor activates IR LEDs only as needed
5. Weatherproof and waterproof for "all-season" operation
6. Constructed of corrosion-free aluminum for long life
7. Adjustable sunshield adds to the cameras versatility
8. Color by day-B/W by night

-Follow the instructions-

Please follow the instructions for safe use.

Information

Read this user guide carefully before any installation for safe operation of product.

**WARNING**

Indicating the possibility of serious injury or death.

**CAUTION**

Indicating the possibility of injury or material loss.

- Please study the instruction manual and keep it for your future reference.



- Do not aim LED light directly on the eyes when LEDs are on.



- Do not use improper power, it could cause fire or electric shock.



- Do not disassemble the camera, it could cause fire, electric shock or other hazards.



- Stop using the camera when you find a malfunction like smoke or unusual heat, it could cause fire or electric shock.



- Please use the camera unit within given temperature and electricity limit.



- Please make sure that installation should be done by qualified service person only.



- Do not disassemble the unit by yourself. When there is problem with the unit please contact service center.





←--- **SUNVISOR**
Fixing Bolt

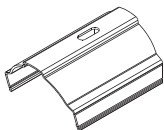

←--- **SUNVISOR**

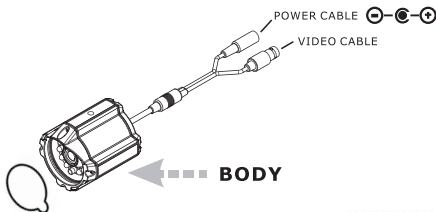

←--- **PROTECTION**
SHEET

BRACKET →---

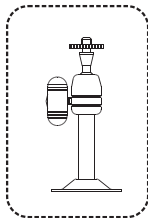

User Manual & Warranty Card

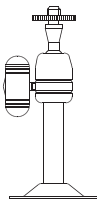

Bracket



Adaptor

1. Attach the mounting bracket to the camera
2. Attach the bracket to the hole below or over the camera tightly

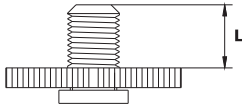

-Screw dimension for the hole-

1/4"-20 UNC(20 THREAD)

L: 4.5mm \pm 0.2mm(ISO standard)

0.197:(ASA standard)

3. If you want to attach the bracket to the hole over the camera, you should do that after removing the screw to fix the sunvisor. And then install the camera on the wall or ceiling
4. Connect the video cable of this camera to the monitor
5. Connect the power cable to the power supply adaptor
 - Power supply should be a regulated DC 12V 500mA.
 - The power should be connected after installing the camera.

SPECIFICATIONS

Dimension 09

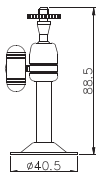
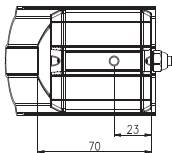
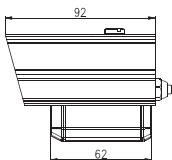
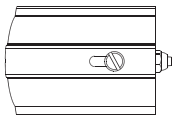
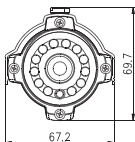

MODEL NO	CVC-627	CVC-627B / CVC-627W
Camera Type	1/4" Color CCD Camera	
Image Sensor	1/4" 270K Color CCD	
Effective Pixel	510(H) x 492(V)PIXEL(NTSC)	
Cell Size	7.2 μ m(H) x 5.6 μ m(V)(NTSC)	
Horizontal Resolution	350 TV-LINE	
TV Type	NTSC	
Sync. Type	Internal	
Scanning System	2:1 Interlace	
Video Output	1Vp-p(Sync,Negative) Termination 75 Ω	
Gamma Characteristic	$\gamma=0.45$ Typ.	
Min. Illumination	1 Lux (LED OFF)	
S/N Ratio	48dB over(AGC OFF)	
Gain Control	Automatic Gain Control	
IRIS	Electronic	
Shutter Speed (Electronic)	1/60 ~ 1/100,000 second	
Test illuminance area	Average test illumination by front view	
Power Supply	Regulated DC 12V	
Consumption Current	Max. 150mA (DC 12V.LED OFF) Max. 330mA (DC 12V.LED ON)	
Operation Temp.	-10 $^{\circ}$ C ~ 50 $^{\circ}$ C	
Preservation Temp.	-20 $^{\circ}$ C ~ 60 $^{\circ}$ C	
LED	IR LED	
LENS	3.6mm fixed focal lens	
Dimension	69.7(W) X 92(H)mm	
Weight	1,200g(with 60FT Cable); 350g(with 6FT Cable)	

Problem	Solution
Nothing appears on the screen	<ul style="list-style-type: none">• Check if the power cord and line connection between the camera and monitor are connected properly
The image on the screen is dim	<ul style="list-style-type: none">• Check whether the window is stained. If dirty, clean the lens with soft and clean cloth
The image on the screen flickers	<ul style="list-style-type: none">• Does the camera face to the sun directly or fluorescent light? Change the camera position
The contrast on the screen is too weak	<ul style="list-style-type: none">• Adjust the contrast feature of the monitor• If the camera is exposed under too strong light, change the camera position

***If you can not solve the problem, please contact an authorized technician**

MEMO

MEMO



200 New Highway
Amityville, NY 11701

Toll Free : 1-800-645-5516

In Metro NY : 631-957-8700

Free Manuals Download Website

<http://myh66.com>

<http://usermanuals.us>

<http://www.somanuals.com>

<http://www.4manuals.cc>

<http://www.manual-lib.com>

<http://www.404manual.com>

<http://www.luxmanual.com>

<http://aubethermostatmanual.com>

Golf course search by state

<http://golfingnear.com>

Email search by domain

<http://emailbydomain.com>

Auto manuals search

<http://auto.somanuals.com>

TV manuals search

<http://tv.somanuals.com>