

# SA.3

PROFESSIONAL DJ MIXER

## OWNER'S MANUAL



# stanton

STANTON MAGNETICS, INC  
information@stantondj.com • 954.689.8833  
www.stantondj.com

# WELCOME!

Thank you for making Stanton your first choice in professional DJ mixers.

Our innovative family of mixers has been developed with input from the professional DJ community. Stanton offers an affordable combination of user-friendly mixers with functional design, rugged construction and professional quality features which had been previously unavailable.

Stanton and your authorized Stanton dealer are dedicated to your complete satisfaction by offering benchmark service and support throughout the long life of your Stanton product.

We appreciate your patronage, and look forward to many years of making music together.

## PLEASE READ CAREFULLY BEFORE USE

FAILURE TO FOLLOW THE INSTRUCTIONS PRINTED BELOW MAY VOID WARRANTY

- Follow all security advice printed on your mixer
- When removing the unit's AC plug from the power source, grasp and pull the plug, NEVER the cord itself!
- Avoid placing your mixer near heat sources, such as power amplifiers.
- When in use, place your mixer on a stable surface, away from vibration. Always use care when carrying your mixer. Impact, or heavy vibration may compromise the unit's mechanical integrity. The manufacturer is not responsible for damage resulting from an impact, or misuse.
- When in use, place your mixer away from sources of hum or noise, such as transformers, or electric motors.
- To prevent overheating, always provide your mixer with adequate ventilation air space.
- Avoid stepping on your mixer's AC cord. Repeated compression of the cord may lead to electrical shorting.
- To avoid damage due to AC voltage peaks, always disconnect your mixer from the power source during electrical storms. If possible connect mixer to a surge protector.
- Your mixer contains no user-serviceable parts. The manufacturer is not responsible for any damage or personal injury resulting from unauthorized user-servicing or modifications. In addition, the warranty will be void if any unauthorized service by the user is detected. Always return your mixer to an authorized Stanton dealer for servicing.

## SA.3 FEATURES



The SA.3 professional scratch mixer has been designed specifically for scratch DJs. The SA.3 is a clean, simple and easy to understand mixer with the features that will help you as a scratch artist.

- 2 channel scratch mixer.
- Curve adjustment and reverse switch for Crossfader and Linefaders.
- User replaceable / upgradeable faders.
- Each channel features gain control, 3 band eq, and pan.
- Headphone mute switch.
- Dual headphone outputs (1/4"/6.3mm and 1/8"/3.5mm).
- Balanced 1/4" and unbalanced RCA master outputs.
- Master mute switch.
- Rotatable 2 Position phono/line switch.
- Mic channel with gain control.
- Microphone mute switch.
- Protekt Panel.
- 2 line and 2 phono inputs.
- Master / Cue switch.
- Cue fader for cueing between programs.

# DESCRIPTION OF FUNCTIONS

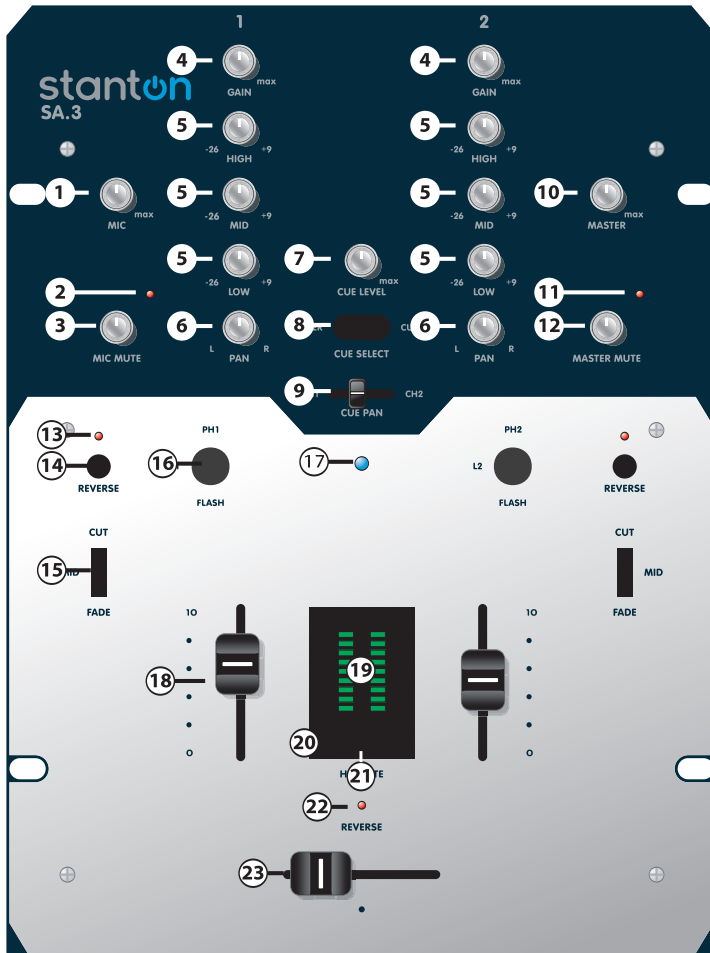

## TOP PANEL

- 1. Microphone level** - Controls the attenuation level of the microphone input. Use the microphone level adjustment to find the right gain for your microphone, then use the microphone mute button (3) to mute the input when not in use.
- 2. Microphone Mute LED** - Indicates when microphone mute button (3) has been engaged.
- 3. Microphone Mute** - Mutes the microphone input.

## MIXER FUNCTIONS

- 4. Input Gains** - Controls the input sensitivity level for each channel. Use the input gain in conjunction with the LED meters (19) to properly set the levels of your input.
- 5. Input Equalizers** - Individual controls for high frequency, mid-range, and low frequency equalization with 9db of boost and 25dB of kill. *Note: Any changes made to EQ settings will change the overall output level of that input.*
- 6. Input Pan** - Controls left / right output balance of each channel.
- 7. Cue Level** - Controls the output level of the headphone amp.
- 8. Master / Cue Switch** - Selects signal to be sent to headphone output. In "CUE" position, the cue pan fader (9) is used to select which input channel is to be monitored. In "MASTER" position the master output is sent directly to the headphones.
- 9. Cue pan fader** - Fades the headphone output from input 1 to input 2 when Master / Cue switch is in "Cue" mode.
- 10. Master Level** - Controls the overall output level of the master output.
- 11. Master Mute Indicator** - LED indicates when Master Mute switch (12) has been engaged.
- 12. Master Mute** - Mutes the master output of the mixer. Use the master mute in situations where you need to mute and unmute the mixer without having to re-adjust your Master Level (10) control.
- 13. Reverse Indicator** - Bi-color (red & green) LED indicates when fader's direction has been reversed (green = normal, red = reversed).
- 14. Reverse Button** - Reverses the direction of the fade on the corresponding fader.
- 15. Line fader Curve Control** - Selects taper of upfader curve between a fast cut, medium curve, and long fade.
- 16. Input Select** - Toggle switch selects the input source between the phono and line inputs located on the back of your mixer.

## MIXER FUNCTIONS

**17. Power Indicator** - Blue LED indicates when power has been switched on.

**18. Line Fader** - The linefader controls the level of each channel to the master outputs.

**19. Level Meter** - LED meter indicates level of each channel. The left LED meter is for channel 1. The right LED meter is for channel 2. Use the Input Gain (4) to adjust the signal to 0dB (yellow LED). The red LED on the meter indicates when the signal is close to clipping and distorting the output of the mixer.

**20. Headphone Mute** - Mutes the headphone output. This feature is very useful for quick cueing during mixing and scratching.

**21. Headphone Mute Indicator** - Indicates when Headphone Mute (20) has been engaged.

**22. Crossfader Reverse Indicator** - Indicates when crossfader reverse has been engaged.

**23. Crossfader** - The crossfader fades between channel 1 and channel 2. The taper (curve) of the crossfader is determined by the crossfader curve control (23). The direction of the curve is determined by the crossfader reverse control (24).

## FRONT PANEL



### FRONT PANEL

**24. Crossfader Reverse** - The crossfader reverse changes the direction of the fade on the crossfader (23).

## FRONT PANEL

**25. Crossfader Curve** - Controls the taper (fade) shape of the crossfader (23). The crossfader curve control continually adjusts the curve from a sharp cut to a long fade.

**26. Headphone Outputs** - 1/4" and 1/8" connector jacks for headphones.

## BACK PANEL



### BACK PANEL

**Power** - Power switch to turn the mixer "ON" or "OFF".

**AC IN:** This is the input connection for the included power supply.

**Master** - Connects to an amplifier, EQ, crossover, or other outboard signal processing. Connect balance connections to the TRS 1/4" connectors. Connect un-balanced connections to the RCA connectors.

**Line** - Line inputs are used to connect line level sources such as CD players, Mini Discs, DATs, samplers, etc.

**Ground** - Connects to turntable ground cable to eliminate electrical hum. Ground cables are usually supplied with turntables.

**Phono** - Connects to left and right RCA cables from turntable.

**Mic** - 1/4" TRS connector for use with microphones.



## REMOVING FACEPLATE

1. Unplug the power supply from the back of the mixer. Verify that the mixer is powered off.



(BACKPANEL VIEW)

2. Remove the 4 screws on the faceplate. Place the 4 screws somewhere safe where they will not be lost.

3. Remove the 3 fader knobs from the line faders and crossfader.

4. The faceplate can now be removed from the top of the mixer.

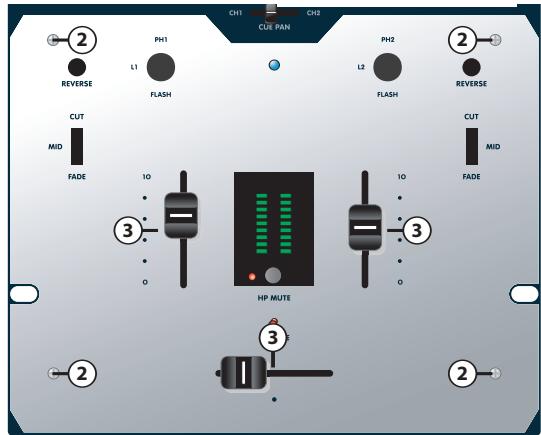

## CLEANING FADERS

1. Make sure the mixer is powered off. Remove the faceplate of the mixer by following the directions above.



2. Remove the fader from the mixer by unscrewing the two outer screws on the fader plate. Do not remove the two inside screws on the fader plate; this will remove the fader from the fader plate.

3. Once fader has been removed from mixer, spray a small amount of contact cleaner into the fader and move the fader back and forth to disperse the cleaner.

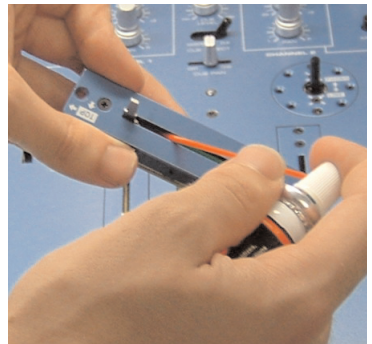

## ROTATING THE TRANSFORM SWITCHES

The input selector (transform) switches on the Stanton SA.3 mixer can be rotated to 8 different positions. Follow the steps below to rotate the transform switch to the position you like.

1. Make sure the mixer is powered off. Remove the faceplate of the mixer.

2. Remove the two outer screws from the transform switch as indicated in diagram. Do not remove the two inner screws. *Removing the two inner screws will detach the switch from the plate.*

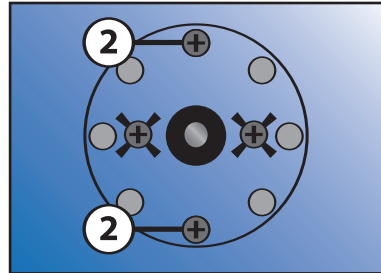

3. Rotate the switch to the position you like. Replace the two outer screws to secure the switch in place.

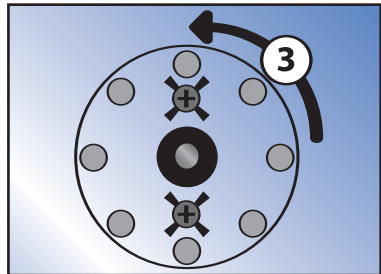

### Replacing the transform switch

1. Follow steps 1 and 2 above. Remove switch from mixer and detach connector from switch.

2. Attach connector for transform switch to replacement switch and replace two outer screws to secure the switch in place.

## REPLACING THE CROSSFADER

The SA.3 is compatible with the CFSA.3, Focus Faders V1/V2 and with Penny and Giles crossfaders. The SA.3 has two different circuits which need to be switched when changing between the faders. To switch the crossfader circuit, follow the instructions below:

1. Follow steps 1 & 2 from the fader cleaning instructions.

2. Remove the fader assembly and disconnect the cable coming from the mixer.



3. The crossfader select switch is located inside the mixer, on the left side of the fader slot. In order to use the CFSA.3, FF1 and Penny & Giles faders, make sure the switch is pressed DOWN. To use the CFF2, make sure the switch is in the UP position.

## TECHNICAL SPECIFICATIONS

Line inputs:	2 (RCA) x 2 channels, -10 dBV /10 kOhm
Phono inputs:	2 (RCA) x 2 channels, -50 dBV / 47 kOhm
Master output:	2 (TRS Balanced/RCA unbalanced), +4 dBu balanced / -10 dBV unbalanced
Headphone output:	1 (1/4 inch), 1 (1/8 inch), greater than 32 Ohm load
Frequency Response:	20 Hz - 20 kHz, +/- 1.5 dB
Tone Control :	Hi +9/-18 dB Mid +9/-25 dB Low +9/-25 dB
S/N Ratio:	Better than 94 dB (ref: max input level)
Noise:	-80 dBV (Line input to any output)
T.H.D	Less than 0.04% (1 kHz)
Dimension(LxWxD):	12.4" x 9.25" x 4.33" in; (315 x 235 x 110mm)
Weight:	6.6 lbs 3 kgs

## REPLACEMENT PARTS

The following user replaceable parts are available from your local Stanton dealer.

<b>CFSA3</b>	Crossfader
<b>LFSA3</b>	Linefader
<b>CF-PG110</b>	Penny & Giles crossfader
<b>CF-F1</b>	Focus Fader V1
<b>CF-F2</b>	Focus Fader V2
<b>PLSA3</b>	Phono / Line switch
<b>3PLSA3</b>	Phono / Line switch (w/Flash)
<b>PPSA3</b>	PROTEKT™ panel
<b>PS-18US</b>	US Power Supply (110v)
<b>PS-18EU</b>	European Power Supply (220v)
<b>PS-18UK</b>	UK only Power Supply (240v)

# WARRANTY

## Stanton Magnetics, Inc. – Warranty Provision – Returns for Repairs or Replacement

### Warranty

Through Stanton's authorized dealers around the World, Stanton, or one of Stanton's authorized distributors outside the U.S., will, without charge, repair or replace, at the sole discretion of the entity responsible for making the repair or providing the replacement, any Stanton merchandise proved defective in material or workmanship for a period of one (1) following the date of original purchase. Exceptions to this warranty are as noted below:

The warranty for mechanical parts which are subject to wear and tear are limited to the earlier to occur of thirty (30) days following the date of original purchase or the following number of cycles: Faders - 15,000; Rotary potentiometers - 10,000; and Switches - 10,000.

Stanton will warrant all replacement parts and repairs for ninety (90) days from the date of original shipment. Repairs made necessary by reason of misuse, alteration, normal wear, or accident are not covered under this warranty.

### Returns

Authorized Stanton dealers are only authorized to sell and distribute merchandise within a specific country. All goods requiring warranty repair or replacement must be returned (freight prepaid if not hand-delivered) to the authorized Stanton dealer from whom the merchandise was purchased and in the same country where the merchandise was purchased. For purposes of purchases made via the Internet, the merchandise must be returned to the authorized Stanton dealer in the country where the authorized Stanton dealer which sold the merchandise to purchaser is located and not the authorized Stanton dealer in the country where the purchaser is located or the country in which the merchandise was received. Any returns to a non-authorized dealer or to an authorized Stanton dealer not in the same country as the merchandise was intended to be sold or as set forth above will void this warranty.

To initiate a warranty repair, you must contact the authorized Stanton dealer from whom you purchased the merchandise, and follow such authorized Stanton dealer's return policy.

Stanton assumes no risk and shall be subject to no liability for damages or loss resulting from the specific use or application made of the merchandise. Stanton's liability for any claim, whether based on breach of contract, negligence, infringement of any rights of any party, or product liability, and relating to the merchandise shall not exceed the price received by Stanton from your purchase of such merchandise. In no event will Stanton be liable for any special, incidental or consequential damages (including loss of use, loss of profit and claims of third parties) however caused, whether by the negligence of Stanton or otherwise. To the extent permitted by law and except as otherwise provided above, Stanton disclaims any express or implied warranties of merchantability or fitness for a particular purpose.

The above warranty provides you with specific legal rights. You may also have additional rights, which are subject to variation from state to state and country to country.

If there is a dispute regarding the warranty of merchandise that does not fall under the warranty conditions stated above, please include a written explanation with the merchandise when returned pursuant to the terms and conditions set forth herein.

Please register your product online at [www.stantondj.com](http://www.stantondj.com) or mail your completed warranty card to:

Stanton Magnetics, Inc, 3000 SW 42 St. Hollywood, Florida 33312.

## Free Manuals Download Website

<http://myh66.com>

<http://usermanuals.us>

<http://www.somanuals.com>

<http://www.4manuals.cc>

<http://www.manual-lib.com>

<http://www.404manual.com>

<http://www.luxmanual.com>

<http://aubethermostatmanual.com>

Golf course search by state

<http://golfingnear.com>

Email search by domain

<http://emailbydomain.com>

Auto manuals search

<http://auto.somanuals.com>

TV manuals search

<http://tv.somanuals.com>