

Pro-Max[®]

TWO-SIDED GRILLS

230V MODELS

CG10, GR10

CG14 & GR14

CG28 & GR28 SERIES

Installation and Operation Instructions

2M-Z8985 Rev.D 11/18/09



35.6 CM X 35.6 CM Grooved Grill



35.6 CM X 71.1 CM Grooved Grill



SAFETY SYMBOL



These symbols are intended to alert the user to the presence of important operating and maintenance instructions in the manual accompanying the appliance.

RETAIN THIS MANUAL FOR FUTURE REFERENCE NOTICE

Using any part other than genuine Star factory supplied parts relieves the manufacturer of all liability.

Star reserves the right to change specifications and product design without notice. Such revisions do not entitle the buyer to corresponding changes, improvements, additions or replacements for previously purchased equipment.

Due to periodic changes in designs, methods, procedures, policies and regulations, the specifications contained in this sheet are subject to change without notice. While Star Manufacturing exercises good faith efforts to provide information that is accurate, we are not responsible for errors or omissions in information provided or conclusions reached as a result of using the specifications. By using the information provided, the user assumes all risks in connection with such use.

MAINTENANCE AND REPAIRS

Contact your local dealer for service or required maintenance. Please record the model number, serial number, voltage and purchase date in the area below and have it ready when you call to ensure a faster service.

Model No. _____

Serial No. _____

Voltage _____

Purchase Date _____

PRODUCT IDENTIFICATION

Star Manufacturing International, Inc. Two Sided Grills
230V Models:

GR10-230V- Smooth Top and Bottom Platens Aluminum, without Timer

GR10T-230V- Smooth Top and Bottom Platens Aluminum, with Timer

GR10I-230V- Smooth Top and Bottom Platens Cast Iron, without Timer

GR10IT-230V- Smooth Top and Bottom Platens Cast Iron, with Timer

CG10I-230V- Grooved Top and Bottom Platens Cast Iron, without Timer

CG10IT-230V-Grooved Top and Bottom Platens Cast Iron, with Timer

GR14-230V- Aluminum Smooth Top and Bottom Platens, without Timer

GR14T-230V- Aluminum Smooth Top and Bottom Platens, with Timer

GR14I-230V- Iron Smooth Top and Bottom Platens, without Timer

GR14IT-230V- Iron Smooth Top and Bottom Platens, with Timer

CG14-230V- Aluminum Grooved Top and Bottom Platens, without Timer

CG14T-230V- Aluminum Grooved Top and Bottom Platens, with Timer

CG14I-230V-Iron Grooved Top and Bottom Platens, without Timer

CG14IT-230V- Iron Grooved Top and Bottom Platens, with Timer

CG28I-230V Grooved Iron Platens without Timers

CG28IT-240V Grooved Iron Platens with 2 Timers

CG28IGT-240V Iron Platens, Grooved Top and Smooth Bottom without Timers

GR28I-240V Smooth Iron Platens without Timers

GR28IT-240V Smooth Iron Platens with 2 Timers

GENERAL INSTALLATION DATA



CAUTION

This equipment is designed and sold for commercial use only by personnel trained and experienced in its operation and is not sold for consumer use in and around the home nor for use directly by the general public in food service locations.

Before using your new equipment, read and understand all the instructions & labels associated with the unit prior to putting it into operation. Make sure all people associated with its use understand the units operation & safety before they use the unit.

All shipping containers should be checked for freight damage both visible and concealed. This unit has been tested and carefully packaged to insure delivery of your unit in perfect condition. If equipment is received in damaged condition, either apparent or concealed, a claim must be made with the delivering carrier.

Concealed damage or loss - if damage or loss is not apparent until after equipment is unpacked, a request for inspection of concealed damage must be made with carrier within 15 days. Be certain to retain all contents plus external and internal packaging materials for inspection. The carrier will make an inspection and will supply necessary claim forms.

VENTILATION AND CLEARANCES

The installation of any components such as a vent hood, grease extractors, and/or fire extinguishing systems, must conform to their applicable nationally recognized installation standards and/or local building codes.

ELECTRICAL CONNECTION



CAUTION

Before making any electrical connection be sure to read data plate which is located at the bottom of the unit.

ELECTRICAL GROUNDING INSTRUCTIONS

This unit is equipped with a CEE-7/VII Cord, use the proper (grounding) plug that provides proper protection against shock hazard and must be plugged directly into a properly grounded 3-prong receptacle. For your protection we recommend that a qualified electrician be consulted in regards to any electrical concerns or installations. He/she should be familiar with electrical installations and all electric codes. Proper connections and power supply are essential for efficient performance.



CAUTION

DO NOT CUT OR REMOVE THIS PLUG OR GROUNDING PRONG FROM THE PLUG.



CAUTION

CONNECT/PLUG UNIT INTO DEDICATED A.C LINE ONLY SPECIFIED ON THE DATA PLATE OF THE UNIT.

ELECTRICAL SPECIFICATIONS

| Model No. | Volts | Rated Wattage | Amps | NEMA Plug |
|-----------|-------|---------------|------|-----------|
| GR 10 | 230 | 1653 | 7.2 | CEE-7/VII |
| GR 10I | 230 | 1653 | 7.2 | CEE-7/VII |
| CG 10I | 230 | 1653 | 7.2 | CEE-7/VII |
| GR 14 | 230 | 1653 | 7.2 | CEE-7/VII |
| GR 14I | 230 | 3306 | 14.2 | CEE-7/VII |
| CG 14 | 230 | 1653 | 7.2 | CEE-7/VII |
| CG 14I | 230 | 3306 | 14.2 | CEE-7/VII |
| CG 28I | 230 | 6612 | 28.7 | CEE-7/VII |
| GR 28I | 230 | 6612 | 28.7 | CEE-7/VII |

INITIAL START UP

Level unit using the adjustable feet under the unit (approximately 1/2" adjustment).

Before using the unit for the first time, clean and heat for approximately 30 minutes. The grill may emit a small amount of smoke as the cooking surfaces reach 300-350°F (148-176°C). Do not be alarmed, as the smoke is caused by oils associated with the manufacturing process and will stop when the grill reaches 400°F (204°C). This will take approximately 30 minutes. Brush off any debris from the grilling surfaces. Allow grill to cool prior to placing it in its permanent position.

SEASONING THE COOKING SURFACES

FIRST TIME SEASONING

Follow your company/corporate guidelines for seasoning cooking surfaces. or

1. Bring the grill to 300°F and leave it on while doing the next three steps.
2. Brush the cooking surfaces with a release agent. If using an aerosol agent, first apply into a cup and then brush onto cooking surface.
3. Let sit for 20 minutes, and then wipe clean using a warm damp cloth.

DAILY SEASONING



The grill should not require much seasoning while in use. In most cases, brush a light coating of the baking release agent in the morning and occasionally throughout the day will be enough to prevent any sticking. It is not necessary to spray before grilling each item.

SETTING THE TEMPERATURE

The thermostat control knob is used to set the temperature to your requirements. The maximum set point is 550°F (288°C), the minimum set point is 175°F (79°C). See Knob Settings.

SETTING THE TIMER (TIMER MODELS ONLY) (9 MIN. 59 SEC. MAX)

The timer may be factory pre-set. If changes are required follow these simple steps:

1. To increase time, press and hold the (UP) button. The Start/Stop button  can now be used to increase the cooking time.
2. To decrease time, press and hold the (DOWN) button. The Start/Stop button  can now be used to decrease cooking time.

KNOB SETTING

| Knob Position | Approx. Temp |
|---------------|---------------|
| 1-2 | 175°F / 79°C |
| 3 | 200°F / 93°C |
| 4 | 250°F / 121°C |
| 5 | 300°F / 148°C |
| 6 | 350°F / 176°C |
| 7 | 400°F / 204°C |
| 8 | 450°F / 232°C |
| 9 | 500°F / 260°C |
| 10 | 550°F / 287°C |

ON/OFF ROCKER SWITCH (TIMER MODELS ONLY)

The switch turns the unit on and off. The switch has three positions:



With the switch in this position, both top and bottom platens will heat.



With the switch in this position, neither platen will heat.



With the switch in this position only bottom platen will heat.

DAILY OPERATION

Always allow 10-20 minutes of preheat time before loading the unit with product. Failure to allow sufficient preheat time will result in unsatisfactory cooking of the first load.

Check the power cord to insure that it is plugged into a proper outlet.

Check that the switch and thermostat control are turned on.

Set the unit's ON/OFF rocker switch to desired position.

Set the thermostat control knob to desired temperature.

OPERATING HINTS AND SAFETY

Disconnect power to the unit with the switch at the end of each day of operation.

Do not leave the unit in operation without an attendant.

Turn thermostat down to 200°F (93°C) during idle periods. It will take only a few minutes to regain operating temperature.

Use spatula to push excess grease into grease drawer after each load of food is cooked. This will reduce smoking of hot grease and carbonizing.

Do not leave the unit at high temperature when not in use or during idle periods. This will cause food particles and grease film to carbonize.

"Season" cooking surfaces with non-salted vegetable oil to reduce product sticking.

MONTHLY LUBRICATION/INSPECTION

Apply two (2) drops of non-toxic mineral or vegetable oil to counter balance shoulder rivets and plastic spacers.

Check and clean brass rollers to make sure they are rolling and not sliding on the cam surfaces of the counterbalance.

Check the bolts, screws and nuts, tighten if necessary.

CLEANING

Begin cleaning procedure by using the operating procedures within your organization, or follow the steps below:

1. If particles adhere to the cooking surface during the day, scrape them off with a spatula.

NOTE: It is best not to let food cook onto the grill, as food build-up on the grill will increase sticking and smoking. In addition, carbon may build up on the grill surface and reduce the cooking efficiency.

CARBON BUILDUP: A black matter that forms on or near the cooking surface. Generally this is releasing agents that has cooked itself to the surface. After a period of time, without carbon cleaning this material may start flaking off. When that happens, follow the "Carbon Cleaning" procedures.

2. At the end of the day, wipe down all surfaces with a warm, damp cloth and mild detergent, then dry.



CAUTION

DO NOT IMMERSE OR LET THE UNIT STAND IN WATER.

DO NOT HOSE DOWN THE UNIT OR THE TABLE/COUNTER IF THE UNIT IS ON THE TABLE/COUNTER.

KEEP AWAY FROM RUNNING WATER.

CLEANING CON'T



CAUTION

DO NOT USE SHARP OBJECTS TO REMOVE CARBON BUILD-UP.

BEFORE CLEANING MAKE SURE POWER IS TURNED OFF, UNIT IS UNPLUGGED AND IS NOT TOO HOT.

While holding top lid with one hand, apply only cleaners which are safe for aluminum and iron surfaces. Wipe with clean sponge or towel until unit is clean.

DO NOT SPLASH FRONT CONTROL PANEL!

DO NOT SPLASH FLEX CONDUIT CONNECTING TOP AND BOTTOM OF THE UNIT.

Remove and empty to clean grease catcher drawer as required using mild detergent and water.



WARNING

Do not use ice or cold water to clean the cooking surfaces when the unit is hot. The surfaces are cast aluminum or cast iron and may crack or deform under the shock of rapid temperature change.

CARBON CLEANING

When carbon build up occurs, use a carbon removal agent according to the instructions provided with the cleaner. When this process is complete, you must re-season the grill according to your company/ corporate guidelines, or the seasoning instructions in this manual.

OPERATION TROUBLESHOOTING

- 1. Unit not heating.**
 - A. Check if unit is plugged in correct receptacle.
 - B. Check incoming power line.
 - C. Check that the switch is in correct position.
 - D. Check that thermostat is set to proper temperature.
- 2. Top platen not heating.**
 - A. Check that the rocker switch is in correct position.
- 3. Counter balance roller not rolling.**
 - A. Clean rollers.

If unit still does not operate contact the factory or one of its representatives or a local service company for service or required maintenance.

INTERNATIONAL ONE (1) YEAR EQUIPMENT WARRANTY

All workmanship and materials in “STAR” products are warranted for a period of one year from the date shipped from the factory or one year from the date shown on the proof of purchase of the end-user when purchased through an authorized “STAR” dealer/distributor in a commercial foodservice location.

“STAR’s” obligation under this warranty is limited to the replacement of the defective part(s) only without charge. This warranty is void if damage occurs from improper installation, misuse or abuse, disassembly or tampering of unit for any purpose other than repair by a qualified service agent, wrong voltage, incorrect or fluctuating voltage conditions, wrong gas, improper gas or gas conditions, operated contrary to the installation and operating instructions, operated in an application for which the unit is not suited, or if the unit is not maintained and/or cleaned in a suitable manner.

Any expense in connection with installation, or any cost of making adjustments on a unit to conform to electric or gas service at the point of installation, are not covered by this warranty.

- * The warranty period for the JetStar series six (6) ounce popcorn machines is two (2) years.
- * The warranty period for the Chrome-Max Griddles is five (5) years on the griddle surface. See detailed warranty provided with unit.
- * The warranty period for Teflon/Dura-Tec coatings is one year under normal use and reasonable care. This warranty does not apply if damage occurs to Teflon/Dura-Tec coatings from improper cleaning, maintenance, use of metallic utensils, or abrasive cleaners. This warranty does not apply to the “non-stick” properties of such materials.
- * This warranty is not valid on Conveyor Ovens unless a “start-up/check-out has been performed by a Factory Authorized Technician.

In order to make a claim under this warranty; a warranty report must be filed with Star Manufacturing International Inc. in St. Louis, Missouri, U.S.A. by the dealer/distributor through which product was purchased. All details, including serial number and model number of the defective unit, must be included. Failure to file a claim within a 120 Day time period may result in the claim being refused.

“STAR” may forego the necessity of returning the part for inspection dependent upon the expense involved. However, “STAR” requires defective parts to be held in the claimant’s possession for a period of ninety (90) days for possible inspection by a “STAR” representative or designated inspector .

The foregoing warranty is lieu of any and all other warranties, expressed or implied, and constitutes the entire warranty.

PARTS WARRANTY

Parts that are sold for out-of-warranty repair are warranted for a period of ninety days. The part only is warranted; no labor.

SERVICES NOT COVERED BY WARRANTY

1. Labor
2. Mileage and/or travel time
3. Installation and/or adjustment of equipment
4. Operation contrary to the installation and operating instructions
5. Cleaning of equipment
6. Seasoning of griddle plates
7. Voltage conversions/adjustments
8. Gas conversions
9. Pilot light conversion/adjustments
10. Thermostat calibration/adjustments
11. Resetting of circuit breakers or safety controls
12. Replacement of bulbs/lamps
13. Replacement of fuses
14. Damages due to improper installation
15. Damages from abuse or misuse
16. Damage created by acts of God, Acts of War, or Civil Disturbance

MATERIAL - FINISH - PART NO. SK- 1706

MODEL NO. GR/CG10I-120V GR/CG14-120V
 TITLE WIRE DIAGRAM STD 120V 1800W UL
 CHANGES LTR DATE CHANGE DR

STAR MFG. INTERNATIONAL, INC.
 10 SUNNEN DRIVE ST. LOUIS, MO 63143

DR. TS CK. DATE 7-1-99
 LIMITS UNLESS OTHERWISE NOTED
 FRACTIONS ± 1/64 DECIMALS ± .005

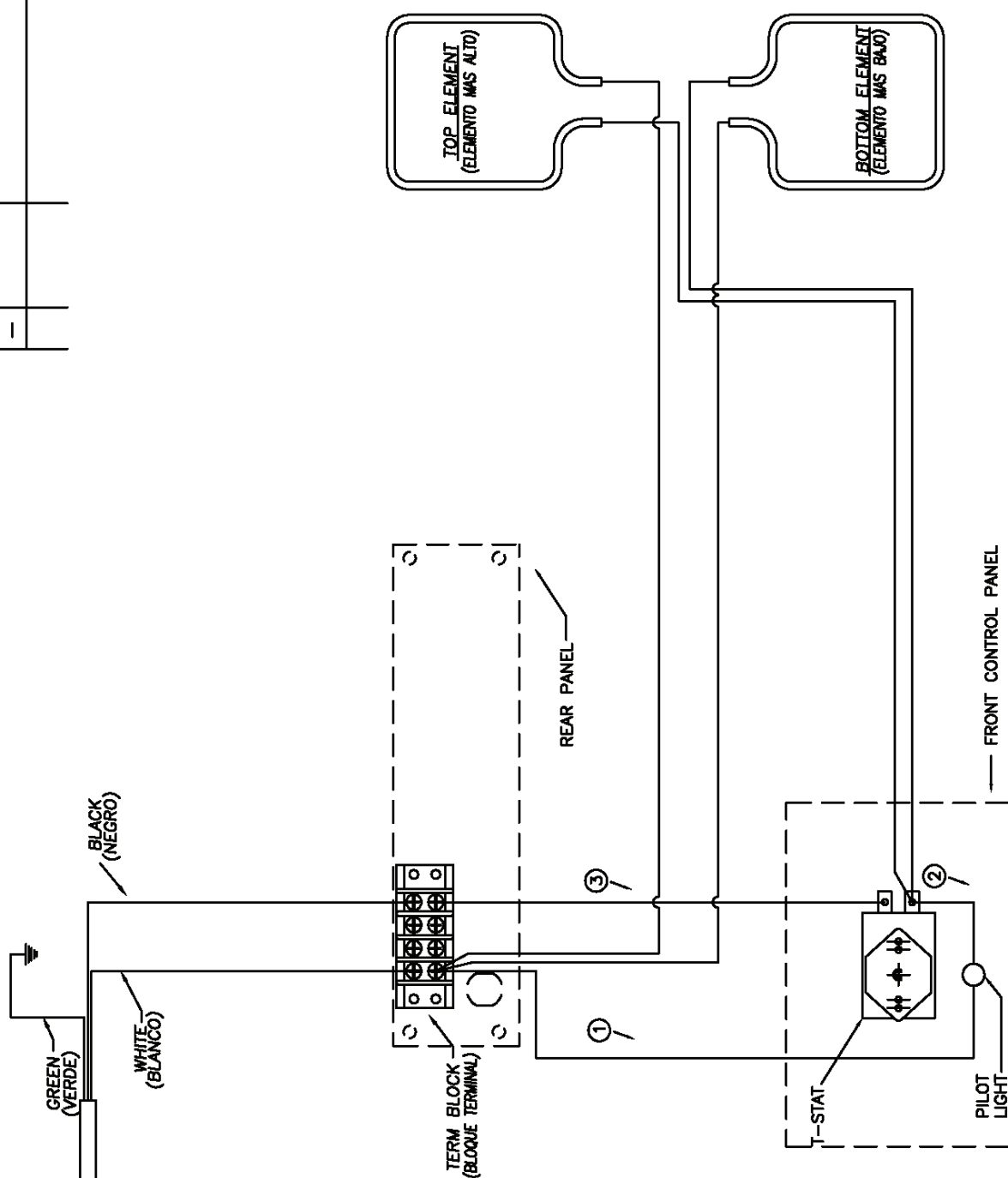

| WIRE NO. (HILO NO.) | PART NO. (PARTE NO.) | QTY. (CANTIDAD) |
|------------------------|-------------------------|--------------------|
| 1 | D9-GR0103 | 1 |
| 2 | D9-GR0104 | 1 |
| 3 | D9-GR0105 | 1 |

| | | | | | | | |
|-------------------------------|-----|--------------------------------|--------|---------------|-----|----------|--------|
| MATERIAL | | FINISH | | MODEL NO. | | PART NO. | |
| - | | - | | GR/CG101-240V | | SK- 1707 | |
| DR. TS | CK. | DATE | 7-1-99 | TITLE | | | |
| LIMITS UNLESS OTHERWISE NOTED | | WIRE DIAGRAM STD 240V 1800W UL | | | | | |
| FRACTIONS ± 1/64 | | DECIMALS ± .005 | | CHANGES | LTR | DATE | CHANGE |
| | | | | | | | DR |
| | | | | | | | - |
| | | | | | | | |

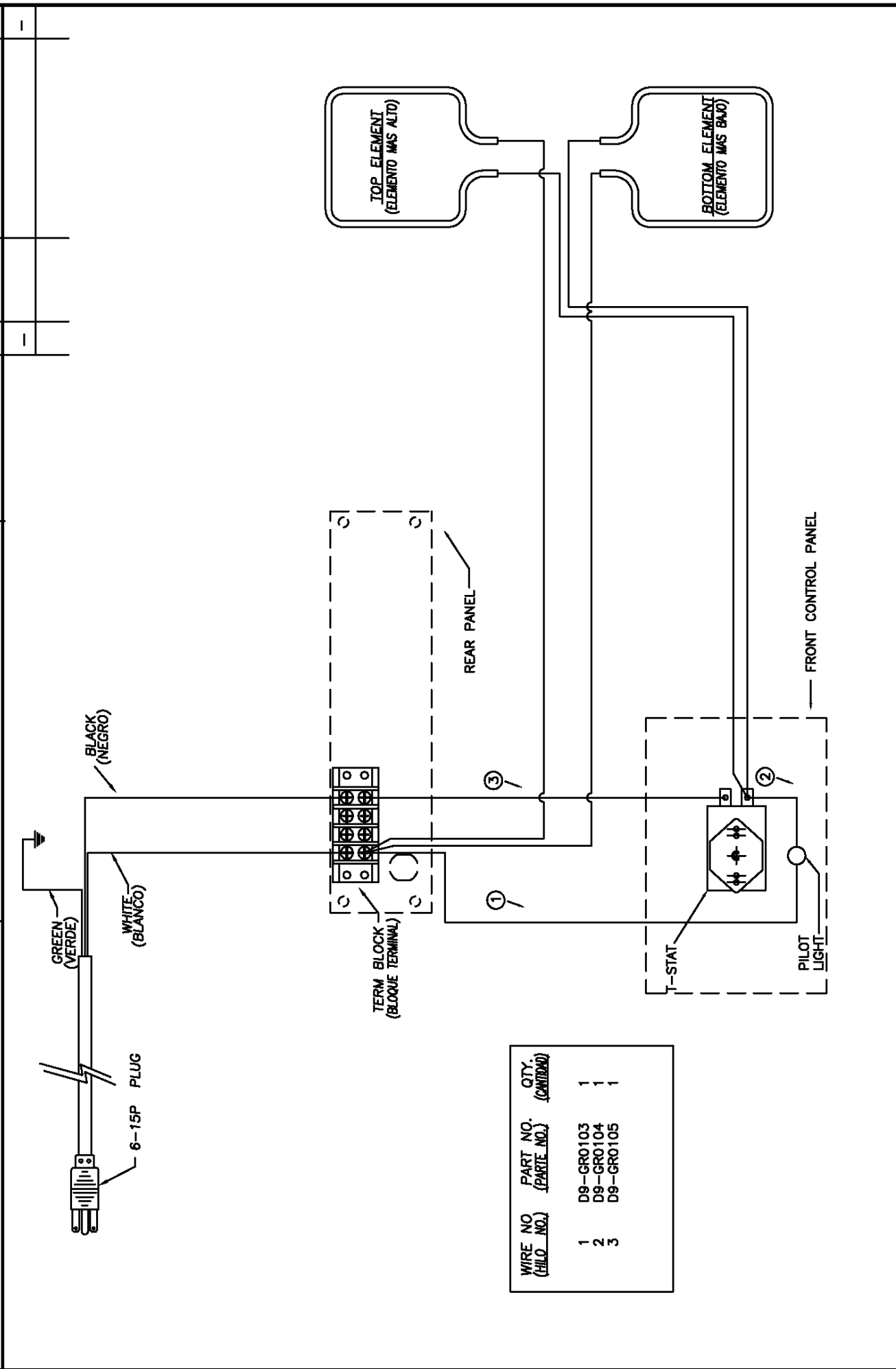

| WIRE NO. (HILO NO.) | PART NO. (PARTE NO.) | QTY. (CANTIDAD) |
|------------------------|-------------------------|--------------------|
| 1 | D9-GR0103 | 1 |
| 2 | D9-GR0104 | 1 |
| 3 | D9-GR0105 | 1 |

| | | | | | | | |
|-------------------------------|-----|--------------------------------|--------|---------------|-----|----------|--------|
| MATERIAL | | FINISH | | MODEL NO. | | PART NO. | |
| - | | - | | GR/CG10I-240V | | SK- 1708 | |
| DR. TS | CK. | DATE | 7-1-99 | TITLE | | | |
| LIMITS UNLESS OTHERWISE NOTED | | WIRE DIAGRAM STD 240V 3600W UL | | | | | |
| FRACTIONS ± 1/64 | | DECIMALS ± .005 | | CHANGES | LTR | DATE | CHANGE |
| | | | | | | | DR |
| | | | | | | | - |

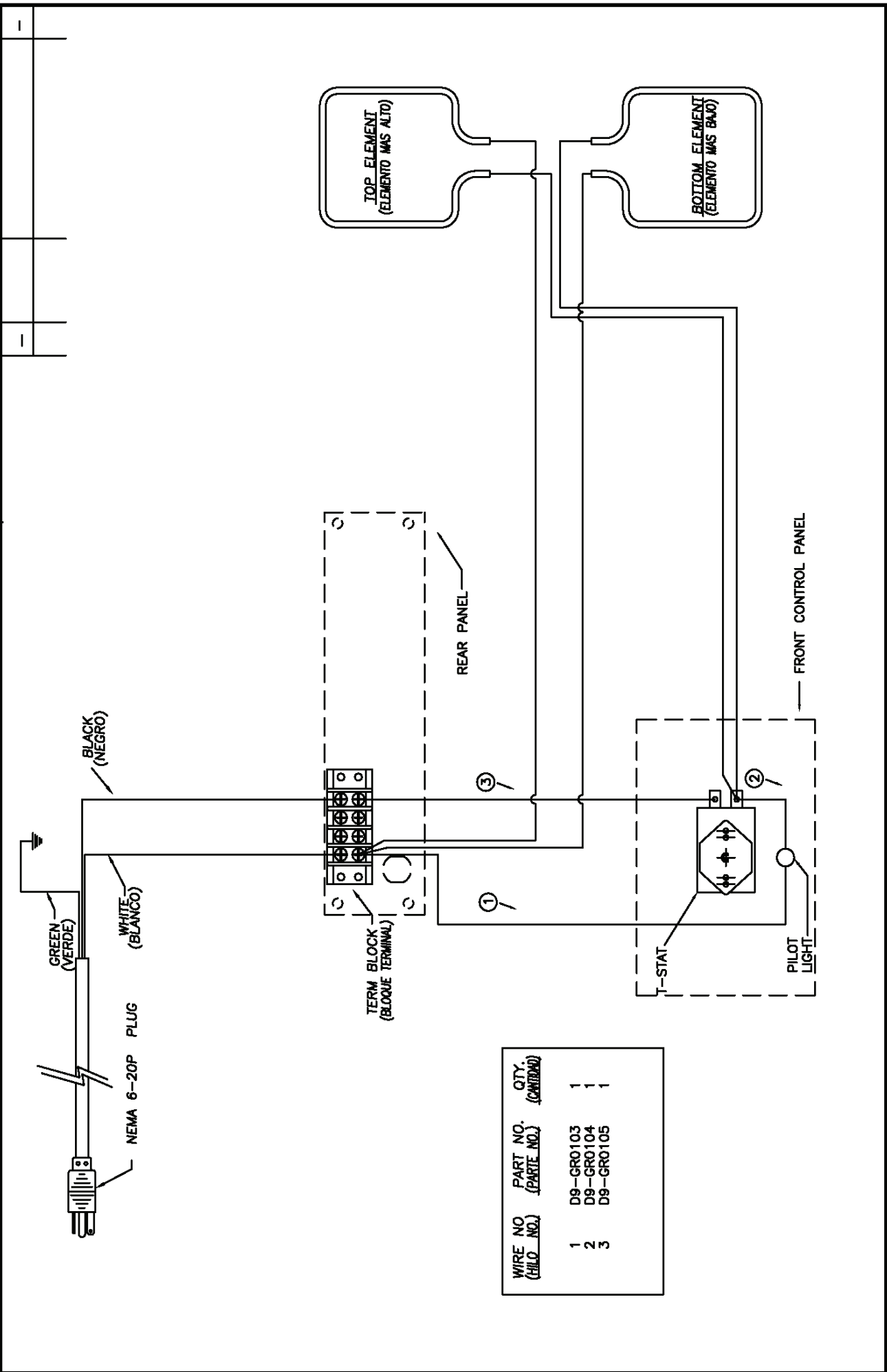

| WIRE NO (CHILD NO.) | PART NO. (PARTE NO.) | QTY. (CANTIDAD) |
|------------------------|-------------------------|--------------------|
| 1 | D9-GR0103 | 1 |
| 2 | D9-GR0104 | 1 |
| 3 | D9-GR0105 | 1 |

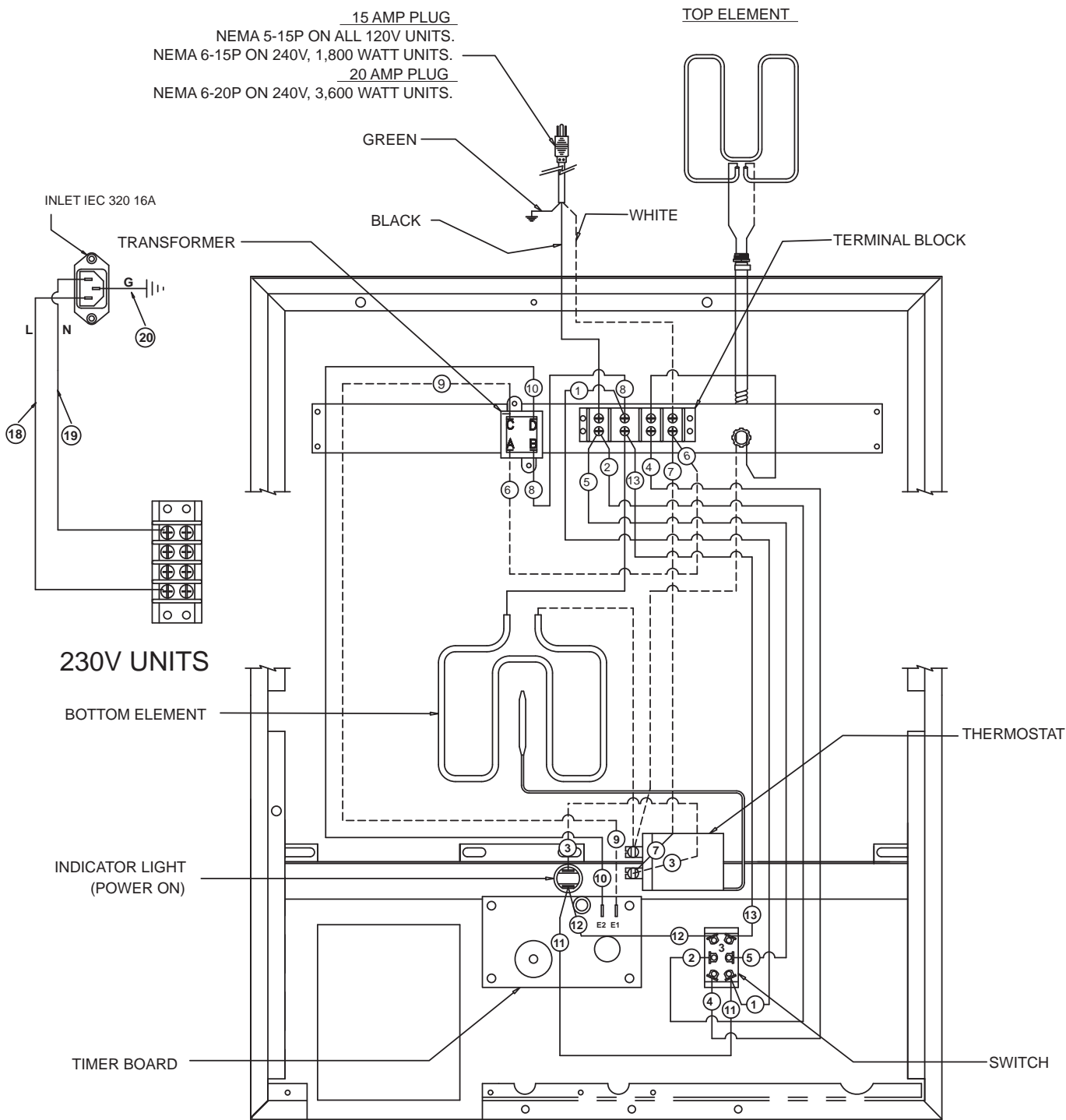

FOR REFERENCE
 WIRING DIAGRAM IS SHOWN AS UNIT IS ASSEMBLED
 WITH THE BOTTOM PLATE REMOVED. ITEMS ARE IN
 GENERAL LOCATION BUT MAY BE RELOCATED OR SCALED
 FOR CLARITY.

**MODEL: CG/GR, 10/14, 120V/230/240V,
 WITH TIMER**

THIS DRAWING CONTAINS INFORMATION CONFIDENTIAL TO STAR MFG. INT'L. INC.
 NO REPRODUCTION OR DISCLOSURE OF ITS CONTENTS IS PERMITTED.



STAR MANUFACTURING INTERNATIONAL INC.

SK2001

Rev A

8/10/2004

| | | | |
|---|--|--|----------------------------|
| MATERIAL | FINISH | MODEL NO. GR/CG28IT-240V CG28ITGT-240V | PART NO. SK-1709 |
| DR. T&K. | DATE 7-05-99 | TITLE WIRE DIAGRAM 240V 7200W UL W/TIMER | |
| LIMITS UNLESS OTHERWISE NOTED FRACTIONS 1/64 DECIMALS .005 ± | STAR MFG. INTERNATIONAL, INC. 10 SUNNEN DRIVE ST. LOUIS, MO 63143 | | |

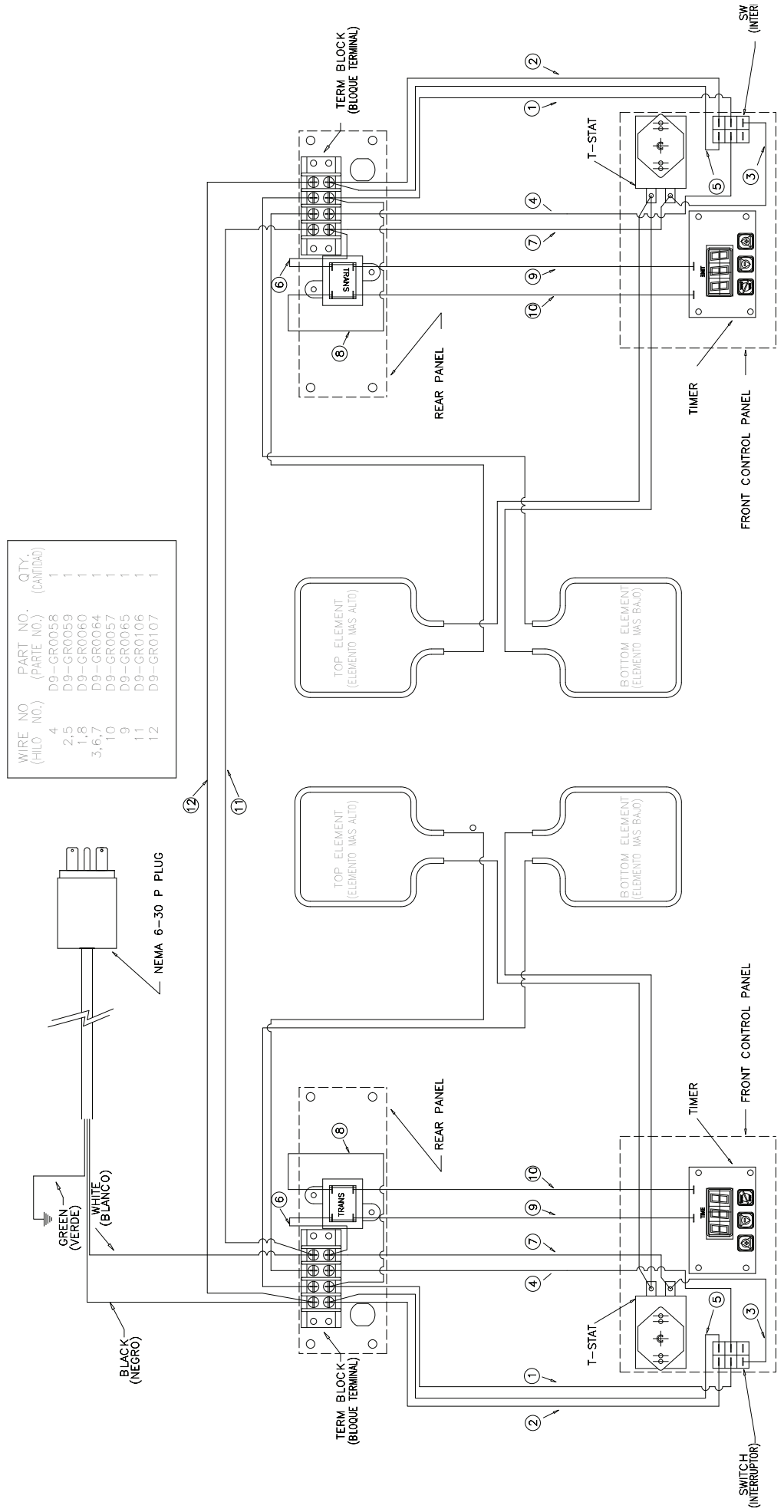

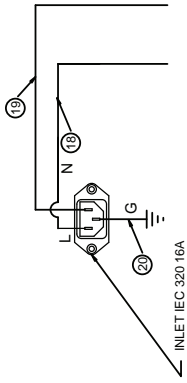

230V UNITS

| WIRE NO. (HILO NO.) | PART NO. (PARTE NO.) | QTY. (CANTIDAD) |
|---------------------|----------------------|-----------------|
| 4 | D9-GR0058 | 1 |
| 2.5 | D9-GR0069 | 1 |
| 1.8 | D9-GR0060 | 1 |
| 3.6.7 | D9-GR0064 | 1 |
| 10 | D9-GR0057 | 1 |
| 9 | D9-GR0065 | 1 |
| 18 | D9-GR0250 | 2 |
| 19 | D9-GR0251 | 2 |
| 20 | D9-GR0252 | 2 |

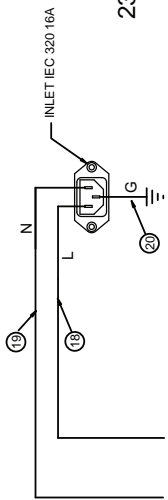

240V UNITS

| WIRE NO. (HILO NO.) | PART NO. (PARTE NO.) | QTY. (CANTIDAD) |
|---------------------|----------------------|-----------------|
| 1 | D9-GR0103 | 1 |
| 2 | D9-GR0104 | 1 |
| 3 | D9-GR0105 | 1 |
| 14 | D9-GR0106 | 1 |
| 15 | D9-GR0107 | 1 |

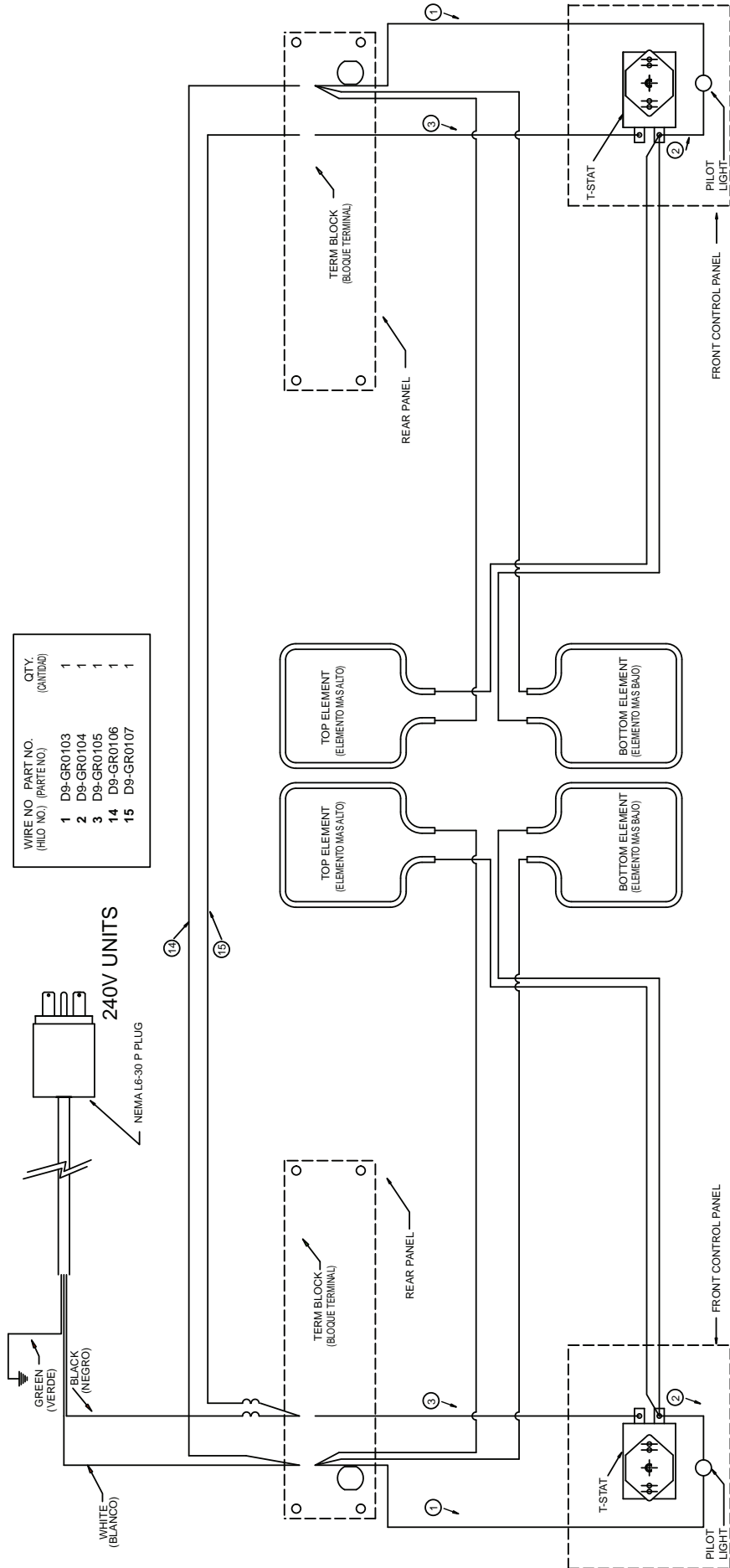

STAR MANUFACTURING INTERNATIONAL INC.

SK1710 Rev B 8/09/2004

MODEL: GR-CG28I-230/240V

THIS DRAWING CONTAINS INFORMATION CONFIDENTIAL TO STAR MFG. INTL. INC.
NO REPRODUCTION OR DISCLOSURE OF ITS CONTENTS IS PERMITTED.

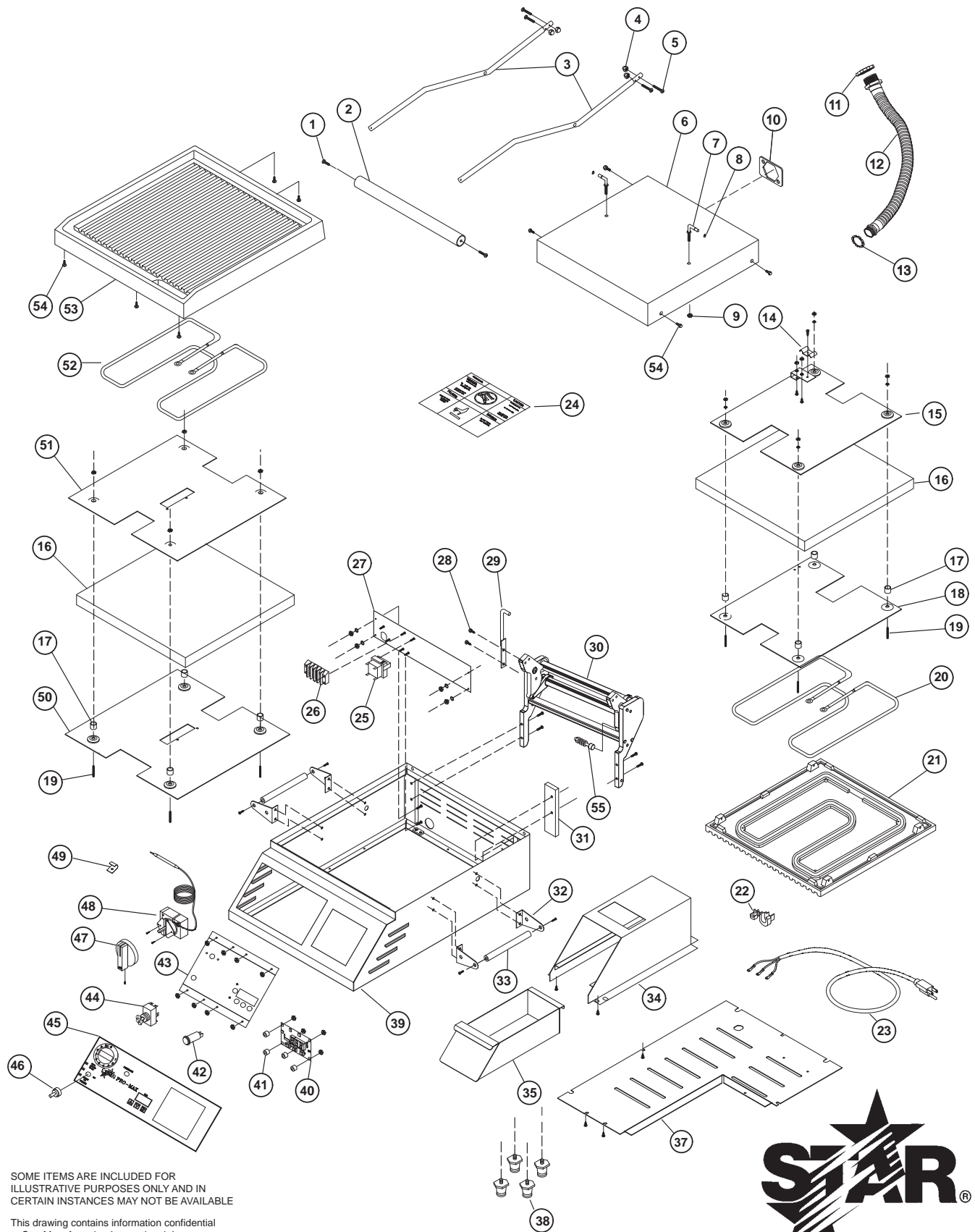

SOME ITEMS ARE INCLUDED FOR ILLUSTRATIVE PURPOSES ONLY AND IN CERTAIN INSTANCES MAY NOT BE AVAILABLE

This drawing contains information confidential to Star Manufacturing International, Inc. No reproduction or disclosure of its contents is permitted.

MODEL GR10I,CG10I,
GR14,GR14I,CG14,CG14I,CG14IGT



STAR MANUFACTURING INTERNATIONAL, INC.

SK1687

REV. C

10/13/05

PARTS LIST

November 18, 2009, Rev D

MODEL 10' TWO SIDED GRILLS

| Key Number | Part Number | Number Per Unit | Description | Model |
|------------|------------------|-----------------|---|--|
| 1 | 2C-Z2992 | 2 | SCREW, HANDLE | |
| 2 | 2V-Z2990 | 1 | HANDLE - 10" | |
| 3 | 2B-Z2988 | 2 | ARM - 10" | |
| 4 | 2C-08-07-0040 | 4 | NUT | |
| 4 | 2C-08-07-0262 | 4 | WASHER | |
| 5 | 2C-Z2992 | 4 | SCREW, ARM TO BRACKET | |
| 6 | D9-Z2038 | 1 | HOUSING-TOP-10" | |
| 7 | 2C-Z3200 | 2 | PIN - TOP HOUSING | |
| 8 | 2C-Z2855 | 2 | RETAINER RING | |
| 9 | 2C-08-07-0040 | 2 | 1/4" NUT, USE PART NUMBER 2C-Z2820 | |
| 10 | 24-Z3827 | 1 | CONDUIT KEEPER PLATE | |
| 11 | 2C-Z3780 | 2 | CONDUIT RETAINER | |
| 12 | 2E-Z2898 | 1 | CONDUIT ASSY. - PTFE | |
| 13 | 2E-Z3768 | 1 | CONDUIT LOCKNUT | |
| 14 | D9-04-GR-0166 | 1 | WIRE MOUNT | |
| 15 | D9-GR0084 | 1 | TOP RETAINING PLATE AY/10 | |
| 16 | D9-Z2908 | 2 | INSULATION - 10" | |
| 17 | 2A-Z6604 | 8 | SPACER - INSULATED PLATE | |
| 18 | D9-Z2772 | 1 | TOP ELEMENT/INS. PLATE/10 | |
| 19 | 2C-08-07-0285 | 8 | SCREW, ELEMENT RET. PLATE | |
| 20 | PS-Z1978 | 1 | TOP ELEMENT, HEATING, 800W/120 | GR10I, GR10IT, CG10I, CG10IT, GR10, GR10T |
| | PS-Z2019 | 1 | TOP ELEMENT, HEATING, 800W/240V | GR10I, GR10IT, CG10I, CG10IT, GR10, GR10T |
| 21 | PS-GR0348 | 1 | KIT, 2F-Z1928 CSTN, SM. TOP,ALUM.-10" | GR10, GR10T |
| | PS-GR0349 | 1 | KIT, 2F-Z1932 CSTN, SM. TOP, IRON-10" | GR10I, GR10IT |
| | PS-GR0347 | 1 | KIT, 2F-Z1934 CASTING, GR. TOP, IRON-10" | CG10I, CG10IT |
| 22 | 2K-Y3240 | 1 | BUSHING 90 SR 17-2 | GR10, GR10T, GR10I, GR10IT, CG10I, CG10IT, (120V MODELS), GR10, GR10T, GR10I, GR10IT, CG10I,CG10IT (240V MODELS) |
| 23 | 2E-Z2770 | 1 | CORD, POWER, 14-3, 6-15P | GR10T, GR10, GR10I, GR10IT, CG10I, CG10IT, (240V MODELS) |
| | 2E-Z2935 | 1 | CORD SET 14/3 NEMA 5-15P | GR10T, GR10, GR10I, GR10IT, CG10I, CG10IT, (120V MODELS) |
| | 2E-Z4119 | 1 | CORD, POWER, 12/3 5-20P | 120VC MODELS |
| 24 | 2M-Z2620 | 1 | LABEL CAUTION, BI-LINGUAL | |
| 25 | 2E-05-07-0350 | 1 | TRANSFORMER 230V/10V 6VA | 240V MODELS |
| | 2E-05-07-0351 | 1 | TRANSFORMER 115/10V 6VA | 120V MODELS |
| 26 | 2E-Z2894 | 1 | TERMINAL BLOCK | |
| 27 | D9-GR0053 | 1 | REAR LINER ASSY. - 10"/BOT | |
| 28 | 2C-1512 | 2 | SCREW - PIN ASSY | |
| 29 | 2V-Z3252 | 1 | PIN ASSY - TOP HOUSING STOP | |
| 30 | 2R-Z2907 | 1 | COUNTERBALANCE -10"-IRON | |
| | 2R-Z3333 | 1 | COUNTERBALANCE -10"-ALUM. | |
| 31 | D9-GR0032 | 2 | TORQUE BOX ASSY. | |
| 32 | D9-Z3071 | 4 | BRACKET-HANDLE | |
| 33 | 2V-Z3072 | 2 | HANDLE - SIDE | |
| 34 | D9-GR0034 | 1 | GREASE CABINET ASSY. | |
| 35 | D9-GR0517 | 1 | GREASE DRAWER ASSY | |
| 37 | D9-GR0246 | 1 | BASE BOTTOM - 10" | 230V MODELS |
| 38 | 2A-Z1485 | 4 | FOOT, 1" ADJUSTABLE | |
| 39 | D9-GR0062 | 1 | BODY ASSY. - 10" | |
| 40 | 2J-Z1836 | 1 | TIMER CONTROL | CG10T, CG10IT, GR10T, GR10IT |

**IMPORTANT: WHEN ORDERING, SPECIFY VOLTAGE OR TYPE DESIRED
INCLUDE MODEL AND SERIAL NUMBER**

PAGE 1
OF 2

Some items are included for illustrative purposes only and in certain instances may not be available.



Star Manufacturing International, Inc.

PARTS LIST

November 18, 2009, Rev D

MODEL **10' TWO SIDED GRILLS**

| Key Number | Part Number | Number Per Unit | Description | Model |
|------------|------------------|-----------------|---|--|
| 41 | 2K-Z1971 | 4 | SPACER | CG10T, CG10IT, GR10T, GR10IT |
| 42 | 2J-Y6689 | 1 | PILOT LIGHT, 120V | GR10, GR10I, CG10I (120V MODELS) |
| | 2J-Z2329 | 1 | PILOT LIGHT, 240V | GR10, GR10I, CG10I (240V MODELS) |
| 43 | D9-GR0051 | 1 | FACEPLATE ASSY. - 10" w/TIMER | GR10T, GR10IT, CG10IT |
| | D9-GR0109 | 1 | FACEPLATE ASSY. - 10" NO TIMER | GR10, GR10I, GR10I, CG10I, CG10I |
| 44 | 2E-Z6863 | 1 | SWITCH 3 POS | CG10T, CG10IT, GR10T, GR10IT |
| | PS-GR0223 | 1 | SWITCH | CG10IT-120V W/SERIAL NUMBERS BELOW CGA24279 CG10IT-240V W/SERIAL NUMBERS BELOW CGA20294 GR10IT-120V W/SERIAL NUMBERS BELOW GRA27109 CG10TJD-240V W/SERIAL NUMBERS BELOW CGA29997 GR10T-240V W/SERIAL NUMBERS BELOW GRA03390 |
| 45 | 2M-Z6881 | 1 | OVERLAY - 10" w/TIMER | GR10T, GR10IT, CG10IT |
| | 2M-Z3051 | 1 | OVERLAY - 10" NO TIMER | GR10, GR10I, CG10I |
| 46 | 2I-05-07-0013 | 1 | RUBBER BOOT, SWITCH | |
| 47 | 2R-Z1854 | 1 | KNOB-CONTROL | |
| 48 | 2T-6447 | 1 | THERMOSTAT 118V-236V | |
| 49 | 2A-Z3026 | 1 | HALF CLIP | |
| 50 | D9-Z2774 | 1 | BTM. INSULATION RET. PLT. 10" | |
| 51 | D9-Z2773 | 1 | BTM ELEMENT RET. PLATE 10" | |
| 52 | 2N-Z1979 | 1 | BTM ELEMENT, HEATING, 1000W/120 | GR10I, GR10IT, CG10I, CG10IT, GR10, GR10T |
| 52 | 2N-Z2020 | 1 | BTM ELEMENT, HEATING, 1000W/240 | GR10I, GR10IT, CG10I, CG10IT, GR10, GR10T |
| 53 | PS-GR0359 | 1 | KIT, 2F-Z1929 CSTG, SM.BOT., ALUM.-10" | GR10, GR10T |
| | PS-GR0360 | 1 | KIT, 2F-Z1933 CSTG, SM. BOT., IRON-10" | GR10I, GR10IT |
| | PS-GR0358 | 1 | KIT, 2F-Z1935 CSTG, GR. BOT., IRON-10" | CG10I, CG10IT |
| 54 | 2C-Z5883 | 8 | SCREW 10-24X1/2 FZA | |
| 55 | PS-GR134 | 2 | KIT, ROLLER BEARING KIT | |

**IMPORTANT: WHEN ORDERING, SPECIFY VOLTAGE OR TYPE DESIRED
INCLUDE MODEL AND SERIAL NUMBER**

PAGE 2
OF 2

Some items are included for illustrative purposes only and in certain instances may not be available.



Star Manufacturing International, Inc.

PARTS LIST

November 18, 2009, Rev D

MODEL 14' TWO SIDED GRILLS

| Key Number | Part Number | Number Per Unit | Description | Model |
|------------|------------------|-----------------|---|---|
| 1 | 2C-Z2992 | 2 | SCREW, HANDLE | |
| 2 | 2V-Z2989 | 1 | HANDLE - 14" | |
| | 2V-Z3413 | 1 | HANDLE - 14" S.S. | GR14, GR14T SER. # GRC00112 - 00138, GRC00778 - 00858, GRC00864 - 01256 |
| 3 | 2B-Z2987 | 2 | ARM - 14" | |
| | 2B-Z3336 | 2 | ARM | GR14SN |
| 4 | 2C-08-07-0040 | 4 | NUT | |
| | 2C-08-07-0262 | 4 | WASHER | |
| 5 | 2C-Z2992 | 4 | SCREW, ARM TO BRACKET | |
| 6 | D9-Z2036 | 1 | HOUSING-TOP-14" | |
| 7 | 2C-Z3200 | 2 | PIN - TOP HOUSING | |
| 8 | 2C-Z2955 | 2 | RETAINER RING | |
| 9 | 2C-08-07-0040 | 2 | 1/4" NUT, USE PART NUMBER 2C-Z2820 | |
| 10 | 2A-Z3827 | 1 | CONDUIT KEEPER PLATE | |
| 11 | 2C-Z3780 | 2 | CONDUIT RETAINER | |
| 12 | 2E-Z2898 | 1 | CONDUIT ASSY. - PTFE | |
| 13 | 2E-Z3768 | 1 | CONDUIT LOCKNUT | |
| 14 | D9-04-GR-0166 | 1 | WIRE MOUNT | |
| 15 | D9-GR0079 | 1 | TOP RETAINING PLATE AY/14 | |
| 16 | D9-Z2888 | 2 | INSULATION - 14" | |
| 17 | 2A-Z6604 | 8 | SPACER - INSULATED PLATE | |
| 18 | D9-Z2075 | 1 | TOP ELEMENT/INS. PLATE/14 | |
| 19 | 2C-08-07-0285 | 8 | SCREW, ELEMENT RET. PLATE | |
| 20 | PS-Z1980 | 1 | TOP ELEMENT, HEATING, 800W/120 | CG14, CG14T, GR14, GR14T, CG14IT-120V |
| | 2N-Z2021 | 1 | TOP ELEMENT, HEATING, 800W/240V | CG14, CG14T, GR14, GR14T |
| | PS-Z2391 | 1 | TOP ELEMENT, HEATING, 1800W/240 | GR14I, GR14IT, CG14IGT, CG14ITGT, CG14I, CG14IT |
| 21 | PS-GR0350 | 1 | KIT, 2F-Z7786 CSTG, SM. TOP, ALUM.-14" | GR14, GR14T |
| | PS-GR0351 | 1 | KIT, 2F-Z1946 CSTG, GR. TOP, ALUM.-14" | CG14, CG14T |
| | PS-GR0352 | 1 | KIT, 2F-Z1948 CSTG, SM. TOP, IRON-14" | GR14I, GR14IT |
| | PS-GR0353 | 1 | KIT, 2F-Z1950 CSTG, GR. TOP, IRON-14" | CG14IGT, CG14ITGT |
| 22 | 2K-3485 | 1 | BUSHING-HEYCO #SR-9P-2 | GR14I, GR14IT, CG14IGT, CG14ITGT, CG14I, CG14IT (240V MODELS) |
| | 2K-Y2968 | 1 | BUSHING 7W-2 | CG14IT-120V |
| | 2K-Y6764 | 1 | BUSHING | CG14IT-120VC (CANADIAN) |
| | 2K-Y3240 | 1 | BUSHING | CG14, CG14FT, CG14T, GR14, GR14SN, GR14T, (120V & 120VC) |
| 23 | 2E-Z2905 | 1 | CORD SJTO 12/2 NEMA 6-20P | GR14I, GR14IT, CG14IGT, CG14ITGT, CG14I, CG14IT (240V MODELS) |
| | 2E-Z2935 | 1 | CORD SET 14/3 NEMA 5-15P | 120V MODELS |
| | 2E-Z4119 | 1 | CORD, POWER 12/3 5-20P | 120VC (CANADIAN) MODELS |
| 24 | 2M-Z2620 | 1 | LABEL CAUTION, BI-LINGUAL | |
| 25 | 2E-05-07-0350 | 1 | TRANSFORMER 230V/10V 6VA | 240V MODELS |
| | 2E-05-07-0351 | 1 | TRANSFORMER 115/10V 6VA | 120V MODELS |
| 26 | 2E-Z2894 | 1 | TERMINAL BLOCK | |
| 27 | D9-GR0054 | 1 | REAR LINER ASSY. - 14"/BOT | CG14, GR14, CG14T, GR14T |
| | D9-GR0080 | 1 | REAR LINER ASSY. - 14"/REAR | CG14I, GR14I, CG14IGT, CG14IT, GR14IT, CG14ITGT |
| | D9-GR0201 | 1 | REAR LINER ASSY. | CG14IT (120V) |
| 28 | 2C-1512 | 2 | SCREW - PIN ASSY | |
| 29 | 2V-Z3252 | 1 | PIN ASSY - TOP HOUSING STOP | |
| 30 | 2R-Z2896 | 1 | COUNTERBALANCE -14"-IRON | |
| | 2R-Z2897 | 1 | COUNTERBALANCE -14"-ALUM. | |

**IMPORTANT: WHEN ORDERING, SPECIFY VOLTAGE OR TYPE DESIRED
INCLUDE MODEL AND SERIAL NUMBER**

PAGE 1
OF 2

Some items are included for illustrative purposes only and in certain instances may not be available.



Star Manufacturing International, Inc.

PARTS LIST

November 18, 2009, Rev D

MODEL 14' TWO SIDED GRILLS

| Key Number | Part Number | Number Per Unit | Description | Model |
|------------|------------------|-----------------|--|--|
| 31 | D9-GR0032 | 2 | TORQUE BOX ASSY. | |
| 32 | D9-Z3071 | 4 | BRACKET-HANDLE | |
| 33 | 2V-Z3072 | 2 | HANDLE - SIDE | |
| 34 | D9-GR0034 | 1 | GREASE CABINET ASSY. | |
| 35 | D9-GR0517 | 1 | GREASE DRAWER ASSY | |
| 37 | D9-GR0247 | 1 | BASE BOTTOM - 14" | 230V MODELS |
| 38 | 2A-Z0314 | 4 | FOOT, 4" | GR14I, GR14IT, CG14I, CG14IT, CG14IGT, CG14ITGT |
| | 2A-Z1485 | 4 | FOOT, 1" ADJUSTABLE | |
| 39 | D9-GR0061 | 1 | BODY ASSY. - 14" | |
| | D9-GR0184 | 1 | BODY ASSY | GR14SN |
| 40 | 2J-Z1836 | 1 | TIMER CONTROL | CG14T, CG14IT, CG14IGT, GR14T, GR14IT |
| 41 | 2K-Z1971 | 4 | SPACER | CG14T, CG14IT, CG14IGT, GR14T, GR14IT |
| 42 | 2J-Y6689 | 1 | PILOT LIGHT, 120V | CG14, GR14 (120V MODELS) |
| | 2J-Z2329 | 1 | PILOT LIGHT, 240V | GR14I, CG14IGT, CG14I, CG14, GR14 (240V MODELS) |
| 43 | D9-GR0108 | 1 | FACEPLATE ASSY. - 14" NO TIMER | GR14I, CG14IGT, CG14I, CG14, GR14 |
| | D9-GR0178 | 1 | FACEPLATE ASSY. - 14" 2 TIMERS | CG14-2T |
| | D9-GR0210 | 1 | FACEPLATE ASSY. - 14" w/TIMER | GR14IT, CG14ITGT, CG14IT, CG14T, GR14T |
| 44 | 2E-Z6863 | 1 | SWITCH 3 POS | CG14T, CG14IT, CG14IGT, GR14T, GR14IT |
| | PS-GR0224 | 1 | SWITCH | CG14T-120V W/SERIAL NUMBERS BELOW CGC25308 CG14IT-120V W/SERIAL NUMBERS BELOW CGC24701 GR14T-120V W/SERIAL NUMBERS BELOW GRC23789 CG14IT-240V W/SERIAL NUMBERS BELOW CGC24559 |
| 45 | 2M-Z6870 | 1 | OVERLAY - 14" w/TIMER | GR14IT, CG14ITGT, CG14IT, CG14T, GR14T |
| | 2M-Z3050 | 1 | OVERLAY - 14" NO TIMER | GR14I, CG14IGT, CG14I, CG14, GR14 |
| | 2M-Z3816 | 1 | OVERLAY - 14" w/2 MANUAL TIMERS | CG14-2T |
| 46 | 2I-05-07-0013 | 1 | RUBBER BOOT, SWITCH | |
| 47 | 2R-Z1854 | 1 | KNOB-CONTROL | |
| 48 | 2T-6447 | 1 | THERMOSTAT 118V-236V | |
| 49 | 2A-Z3026 | 1 | HALF CLIP | |
| 50 | D9-Z8082 | 1 | BTM. INSULATION RET. PLT. 14" | |
| 51 | D9-Z8082 | 1 | BTM ELEMENT RET. PLATE 14" | |
| 52 | 2N-Z1981 | 1 | BTM ELEMENT, HEATING, 1000W/120 | CG14, CG14T, GR14, GR14T, CG14IT-120V |
| | 2N-Z2022 | 1 | BTM ELEMENT, HEATING, 1000W/240 | CG14, CG14T, GR14, GR14T |
| | 2N-Z2392 | 1 | BTM ELEMENT, HEATING, 1800W/240V | GR14I, GR14IT, CG14IGT, CG14ITGT, CG14I, CG14IT |
| 53 | PS-GR0361 | 1 | KIT, 2F-Z1945 CSTG, SM. BOT., ALUM.-14" | GR14, GR14T |
| | PS-GR0362 | 1 | KIT, 2F-Z1947 CSTG, GR. BOT., ALUM.-14" | CG14, CG14T |
| | PS-GR0363 | 1 | KIT, 2F-Z1949 CSTG, SM. BOT., IRON-14" | GR14I, GR14IT, CG14IGT, CG14ITGT |
| | PS-GR0364 | 1 | KIT, 2F-Z1951 CSTG, GR. BOT., IRON-14" | CG14I, CG14IT |
| 54 | 2C-Z5883 | 8 | SCREW 10-24X1/2 FZA | |
| 55 | PS-GR134 | 2 | ROLLER BEARING KIT | |
| NI | 2C-08-WB-0008 | 2 | NUT-TIMER (NOT SHOWN) | CG14-2T |
| NI | 2C-09-WB-0005 | 2 | BEZEL (NOT SHOWN) | CG14-2T |
| NI | 2P-09-WB-0007 | 2 | TIMER BELL (NOT SHOWN) | CG14-2T |
| NI | 2P-Z2911 | 1 | PLUG DOUBLE D .75x.625 | CG14I, GR14I, CG14IGT, CG14IT, GR14IT, CG14ITGT |
| NI | 2R-09-WB-0006 | 2 | KNOB-BLACK (NOT SHOWN) | CG14-2T |
| NI | 2V-Z3027 | 2 | CROSS SUPPORT (NOT SHOWN) | GR14I, GR14IT, CG14I, CG14IT, CG14IGT, CG14ITGT |
| NI | D9-Z3028 | 1 | SIDE SUPPORT (NOT SHOWN) | GR14I, GR14IT, CG14I, CG14IT, CG14IGT, CG14ITGT |
| NI | D9-Z3029 | 1 | PART SUPPORT (NOT SHOWN) | GR14I, GR14IT, CG14I, CG14IT, CG14IGT, CG14ITGT |

**IMPORTANT: WHEN ORDERING, SPECIFY VOLTAGE OR TYPE DESIRED
INCLUDE MODEL AND SERIAL NUMBER**

PAGE 2
OF 2

Some items are included for illustrative purposes only and in certain instances may not be available.



Star Manufacturing International, Inc.

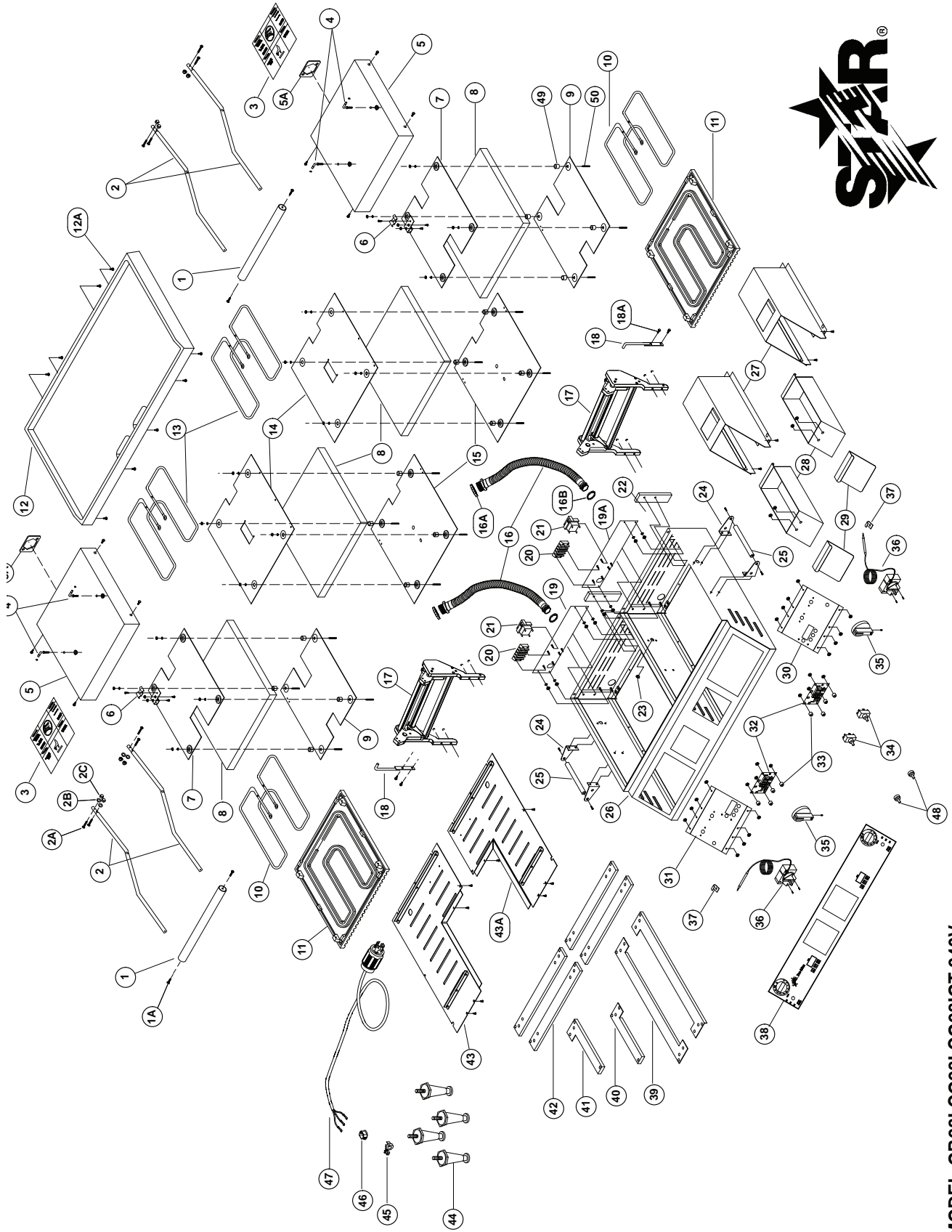

STAR MANUFACTURING INTERNATIONAL INC.
 SK1700 Rev B 05/06/05

MODEL: GR281, CG281, CG281GT-240V
 THIS DRAWING CONTAINS INFORMATION CONFIDENTIAL TO STAR MFG. INTL. INC.
 NO REPRODUCTION OR DISCLOSURE OF ITS CONTENTS IS PERMITTED.

PARTS LIST

November 18, 2009, Rev D

MODEL 28' TWO SIDED GRILLS

| Key Number | Part Number | Number Per Unit | Description | Model |
|------------|------------------|-----------------|---|----------------------------------|
| 1 | 2M-Z2989 | 2 | HANDLE, 14" | |
| 1A | 2C-Z2992 | 4 | BOLT 1/4" 20X1 PHP STL NP | |
| 2 | 2B-Z2987 | 4 | ARM, 14" | |
| 2A | 2C-Z2992 | 8 | BOLT 1/4" 20X1 PHP STL NP | |
| 2B | 2C-08-07-0262 | 8 | WASHER 1/4" INT STL NP | |
| 2C | 2C-08-07-0040 | 8 | NUT 1/4"-20 ACHD STL NP | |
| 3 | 2M-Z2620 | 2 | LABEL, CAUTION | |
| 4 | 2C-Z2820 | 4 | PIN, TOP HOUSING | |
| 5 | D9-Z2306 | 2 | TOP HOUSING 14" | |
| 5A | 2A-Z3827 | 2 | CONDUIT STAMPING PLATE | |
| 6 | D9-04-GR-0166 | 2 | WIRE MOUNT | |
| 7 | D9-GR0079 | 2 | TOP RETAINING PLATE 14" | |
| 8 | D9-Z2888 | 4 | INSULATION 14" | |
| 9 | D9-Z2075 | 2 | TOP ELEMENT PLATE 14" | |
| 10 | PS-Z2391 | 2 | TOP ELEMENT, 1800W | |
| 11 | PS-GR0353 | 2 | KIT, 2F-Z1950 TOP CASTING - GROOVED | CG28IGT, CG28ITGT, CG28I, CG28IT |
| | PS-GR0353 | 1 | KIT, 2F-Z1950 TOP CASTING - GROOVED | GR28ITGS |
| | PS-GR0352 | 2 | KIT, 2F-Z1948 TOP CASTING - SMOOTH | GR28I, GR28IT, |
| | PS-GR0352 | 1 | KIT, 2F-Z1948 TOP CASTING - SMOOTH | GR28ITGS |
| 12 | PS-GR0365 | 1 | KIT, 2F-Z1962 BOTTOM CASTING - SMOOTH | GR28I, GR28IT, CG28IGT, CG28ITGT |
| | PS-GR0366 | 1 | KIT, 2F-Z1963 BOTTOM CASTING - GROOVED | GR28ITGS |
| 12 A | 2c-08-07-0117 | 8 | SCREW 10-24X3/4 FZA | CG28I, CG28IT |
| 13 | 2N-Z2392 | 2 | ELEMENT, BOTTOM 1800W | |
| 14 | D9-Z2618 | 2 | BOTTOM ELEMENT RET. PLATE | |
| 15 | D9-Z2619 | 2 | BOTTOM INSULATION RET. PLATE | |
| 16 | 2E-Z2898 | 2 | CONDUIT ASSY PTFE | |
| 16A | 2C-Z3780 | 4 | CONDUIT RETAINER | |
| 16B | 2E-Z3768 | 4 | CONDUIT LOCKNUT | |
| 17 | 2R-Z2896 | 2 | COUNTER BALANCE | |
| 18 | 2V-Z3079 | 2 | PIN ASSY - TOP HOUSING STOP | |
| 18A | 2C-1512 | 4 | SCREW 10-24X3/8 RH | |
| 19 | D9-GR0180 | 1 | REAR LINER ASSY - REAR CORD SET | 240V |
| | D9-GR0317 | 1 | REAR LINER ASSY - REAR CORD SET | 240VC |
| 19A | D9-GR0054 | 1 | REAR LINER ASSY - BOTTOM CORD SET | |
| 20 | 2E-Z2894 | 2 | TERMINAL BLOCK | |
| 21 | 2E-05-07-0350 | 2 | TRANSFORMER 230V//10V;6VA | |
| 22 | D9-GR0032 | 4 | TORQUE BOX ASSY | |
| 23 | 2K-Y1139 | 1 | BUSHING, HEYCO | |
| 24 | D9-Z3071 | 4 | HANDLE BRACKET | |
| 25 | 2V-Z3072 | 2 | SIDE HANDLE | |
| 26 | D9-GR0098 | 1 | BODY ASSY 28" | |
| 27 | D9-GR0034 | 2 | GREASE CABINET ASSY | |
| 28 | D9-GR0517 | 2 | GREASE DRAWER ASSY | |

**IMPORTANT: WHEN ORDERING, SPECIFY VOLTAGE OR TYPE DESIRED
INCLUDE MODEL AND SERIAL NUMBER**

PAGE 1
OF 2

Some items are included for illustrative purposes only and in certain instances may not be available.



Star Manufacturing International, Inc.

PARTS LIST

November 18, 2009, Rev D

MODEL **28' TWO SIDED GRILLS**

| Key Number | Part Number | Number Per Unit | Description | Model |
|------------|---------------|-----------------|----------------------------------|---|
| 30 | D9-GR0114 | 1 | FACE PLATE - RIGHT w/TIMER | |
| | D9-GR0118 | 1 | FACE PLATE - RIGHT w/PILOT LIGHT | |
| 31 | D9-GR0099 | 1 | FACE PLATE - LEFT w/TIMER | |
| | D9-GR0119 | 1 | FACE PLATE - LEFT w/PILOT LIGHT | |
| 32 | 2J-Z1836 | 2 | TIMER CONTROL | |
| 33 | 2K-Z1971 | 8 | SPACER | |
| 34 | 2E-Z6863 | 2 | SWITCH, 3 POSITION, | CG28IT(serial no. less than CGB29481 use PS-GR0225) CG28ITGT (serial no. less than CGB25137 use PS-GR0225) |
| | PS-GR0225 | 1 | SWITCH KIT | |
| 35 | 2R-Z1854 | 2 | KNOB - THERMOSTAT | |
| 36 | 2T-6447 | 2 | THERMOSTAT | |
| 37 | 2A-Z3026 | 2 | HALF CLIP | |
| 38 | 2M-Z3045 | 1 | OVERLAY w/TIMER | |
| | 2M-Z3088 | 1 | OVERLAY w/PILOT LIGHT | |
| 39 | D9-Z3028 | 2 | SIDE LEG SUPPORT | |
| 40 | D9-Z3030 | 1 | LEG SUPPORT L.H. | |
| 41 | D9-Z3029 | 1 | LEG SUPPORT R.H. | |
| 42 | 2V-Z3027 | 4 | LEG SUPPORT - CROSS | |
| 43 | D9-Z2610 | 1 | BASE PLATE ASSY. 14" | |
| 43A | D9-Z2956 | 1 | BASE PLATE ASSY. 28" | |
| 44 | 2A-Z0314 | 4 | LEG, 4" DIE CAST | |
| 45 | 2K-3485 | 1 | BUSHING, HEYCO | 240V |
| 46 | 2P-Z2911 | 2 | PLUG, DOUBLE "D" | |
| 47 | 2E-Z2922 | 1 | CORD, SJTO 10/3 w/L6-30P PLUG | 240V |
| | 2E-Z10865 | 1 | CORDSET, 50AMP | 240VC |
| 48 | 2I-05-07-0013 | 2 | SWITCH BOOT | |
| 49 | 2A-Z6604 | 16 | SPACER - INSULATED PLATE | |
| 50 | 2C-08-07-0285 | 8 | SCREW 10-24 X 3/4 X 3/8 | |
| | 2J-Z2329 | 2 | PILOT LIGHT 240V (NOT SHOWN) | GR28I, CG28I, CG28IGT, GR28ITGS |

**IMPORTANT: WHEN ORDERING, SPECIFY VOLTAGE OR TYPE DESIRED
INCLUDE MODEL AND SERIAL NUMBER**

PAGE 2
OF 2

Some items are included for illustrative purposes only and in certain instances may not be available.



Star Manufacturing International, Inc.

STAR MANUFACTURING GROUP
Star - Holman - Lang - Wells - Bloomfield - Toastmaster
10 Sunnen Drive, St. Louis, MO 63143 U.S.A.
(800) 807-9054 (314) 781-2777
Parts & Service (800) 807-9054
www.star-mfg.com

Free Manuals Download Website

<http://myh66.com>

<http://usermanuals.us>

<http://www.somanuals.com>

<http://www.4manuals.cc>

<http://www.manual-lib.com>

<http://www.404manual.com>

<http://www.luxmanual.com>

<http://aubethermostatmanual.com>

Golf course search by state

<http://golfingnear.com>

Email search by domain

<http://emailbydomain.com>

Auto manuals search

<http://auto.somanuals.com>

TV manuals search

<http://tv.somanuals.com>