



by **TAYLOR**®

# Hand Blender with Whisk & Cup Instruction Manual



Item # AB-1051-BL  
120V ~ 60Hz 180W

Thank you for your purchase of The Biggest Loser™ Hand Blender with Whisk & Cup.  
Please READ this instruction manual carefully before use.

# SAVE THESE INSTRUCTIONS

## TABLE OF CONTENTS

---

Important Safeguards.....	3
Special Instructions.....	4
Introduction.....	4
Descriptive Diagram.....	4
Using your Hand Blender.....	5
Cleaning and Maintenance.....	6
Troubleshooting.....	6
Warranty.....	6

# IMPORTANT SAFEGUARDS

When using electrical appliances, basic safety precautions should always be followed, including the following:

1. READ ALL INSTRUCTIONS COMPLETELY BEFORE USING.
2. To protect against the risk of electrical shock do not immerse or rinse cord, plugs or this appliance in water or any other liquid.
3. Only the detachable blending wand, whisk and cup are designed to be immersed in liquid. Never submerge any other portion of this appliance into liquid. **If the Hand Blender accidentally falls into water or any other liquid, unplug it immediately.** Do not reach into the liquid to remove the blender until the unit is unplugged.
4. This appliance should not be used by children and care should be taken when used near children.
5. Unplug from outlet when not in use, before adding or removing parts and before cleaning.
6. Avoid all contact with moving parts. Keep hands and utensils out of your mixing container and away from the cutting blade while blending to prevent the possibility of severe injury to persons or damage to the unit. A scraper may be used but must be used only when the unit is not running.
7. Do not operate any appliance with a damaged cord or plug or after the appliance malfunctions, or is dropped or has been damaged in any manner. Return the appliance to Taylor® (see warranty) for examination, repair or adjustment. Do not attempt to repair or replace any parts yourself.
8. Do not use attachments that are not supplied for this appliance by Taylor®. The use of attachments not recommended or sold by Taylor may cause fire, electric shock or injury.
9. Do not use outdoors.
10. Do not let cord hang over edge of table or counter, or touch hot surfaces including the stove.
11. Blades are sharp; handle very carefully at all times, especially when cleaning.
12. When mixing liquids, especially hot liquids, use a tall container or make small quantities at a time to reduce spillage.
13. Be certain the wand or whisk is securely locked in place before operating the appliance.
14. Do not leave the appliance unattended during use.
15. To disconnect, be sure the unit is off, then remove the plug from the wall outlet by grasping the plug and pulling. Never unplug the appliance by pulling on the cord.
16. Make sure the motor stops completely and the electrical cord is unplugged before disassembling or cleaning.
17. Ensure the unit is completely assembled before using.
18. Do not place this appliance near a hot gas or electric burner or in an oven.
19. Do not use this appliance for other than its intended home use.
20. Remove the detachable wand or whisk before cleaning.
21. Never operate the hand blender in an empty container without a mixture.
22. **IMPORTANT:** With heavy mixtures, do not use the hand blender for longer than 30 seconds at a time. After 30 seconds, shut the hand blender off and allow to cool for 1 ½ minutes before using again to prevent overheating.

## SAVE THESE INSTRUCTIONS

## **SPECIAL INSTRUCTIONS**

This appliance is for **HOUSEHOLD USE ONLY**.

- This appliance has a polarized plug (one blade is wider than the other). To reduce the risk of electrical shock, this plug will fit in a polarized outlet only one way. If the plug does not fit fully in the outlet, reverse the plug. If it still does not fit, contact a qualified electrician. Do not modify the plug in any way.
- Make sure the voltage in your outlet is the same as the voltage indicated on the appliance. This appliance is for a 120 –Volt AC electrical outlet only.
- The length of the cord used on this appliance was selected to reduce the hazards of becoming tangled in or tripping over a long cord. For safety, it is not recommended to use an electrical extension cord with this appliance.
- Do not immerse base of unit, plug or cord in water or other liquids.
- Use with wall receptacle only.
- Do not attempt to service this unit yourself.

## **INTRODUCTION**

Now you can learn how to prepare and enjoy great tasting, healthy meals in minutes using your The Biggest Loser™ Hand Blender with Whisk & Cup by Taylor®. You will learn how to make the delicious and easy recipes that cut out calories, but leave in all the taste. The blender and recipes are great tools to get you on track. There are over 125 more healthy and delicious recipes that you can find in the Biggest Loser Cookbook. When you start eating right, you may feel better, have more energy and feel empowered. For more information on NBC's The Biggest Loser, or to join The Biggest Loser Club, please visit the official Biggest Loser web site at [www.nbc.com/The\\_Biggest\\_Loser.com](http://www.nbc.com/The_Biggest_Loser.com) or [www.biggestloserclub.com](http://www.biggestloserclub.com)

## **DESCRIPTIVE DIAGRAM**

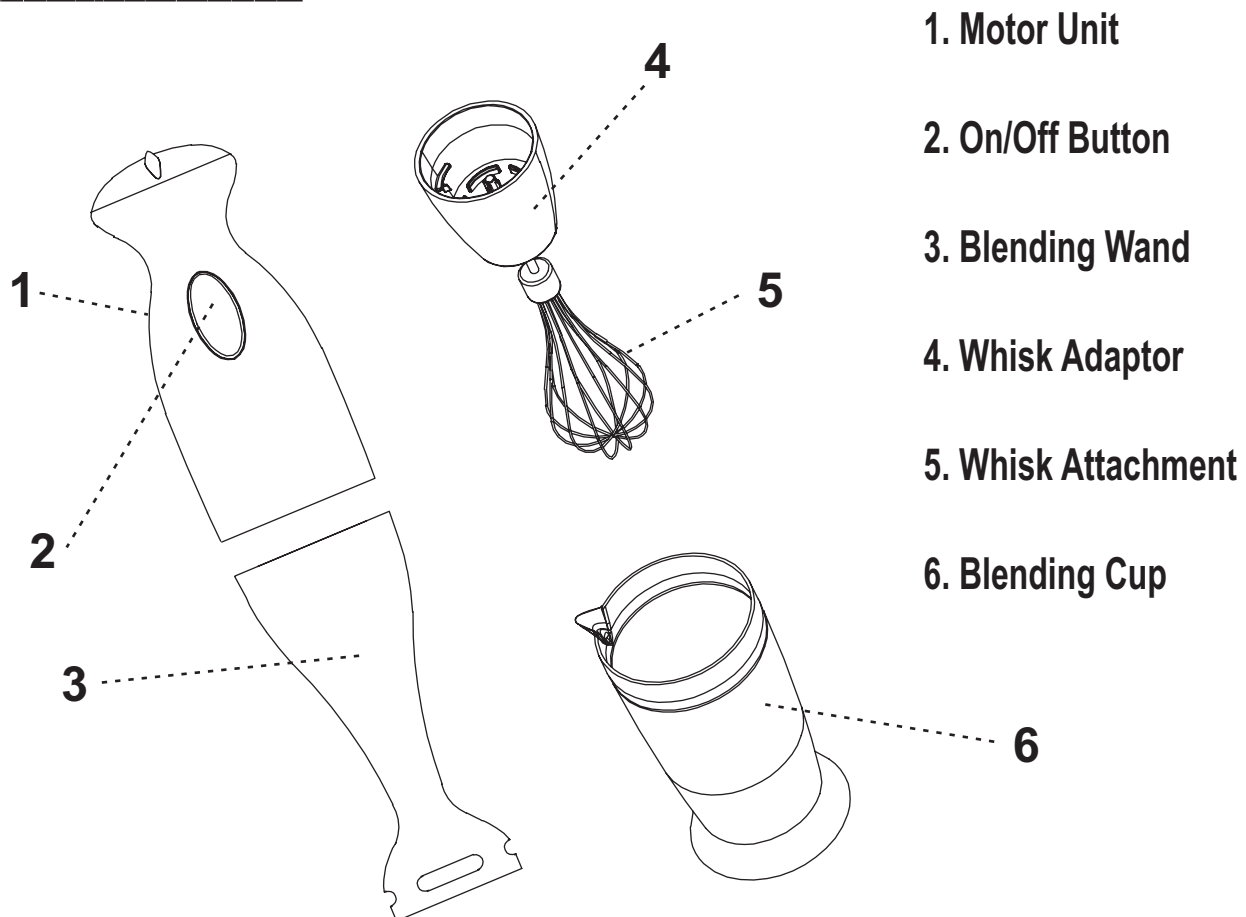

## **USING YOUR HAND BLENDER**

### **BEFORE FIRST USE**

- Make sure the voltage in your outlet is the same as the voltage indicated on the appliance. This appliance is for a 120 –Volt AC electrical outlet only.
- Remove any bags, labels or stickers from the appliance.
- Clean the motor unit with a damp soft cloth
- Wash all of the removable parts – blending wand, whisk adaptor, whisk attachment and cup using a sponge, warm water and mild dish detergent. Rinse and dry carefully.
- **NOTE: do not immerse the motor unit in water when cleaning**

### **How to use your Hand Blender**

1. This appliance is best for blending liquids, including soups, gravies, lattes, salad dressings, powdered drink mixes and sauces. It may also be used to combine dry ingredients or to emulsify. This blade stirs while adding a minimum of air to the mixture.
2. Wash and dry all components thoroughly as stated above.
3. Assemble with either the blending wand or whisk.
  - To assemble with the blending wand, be sure the unit is unplugged. Match up the small arrow on the wand to the unlock symbol on the motor unit. Turn clockwise until the arrow aligns with the lock symbol on the motor unit and you hear it click into place. To remove blending wand, turn counter-clockwise.
  - To assemble with the whisk, be sure the unit is unplugged. Place the stem of the whisk into the hole on the whisk adaptor until you hear it click into place. Place the whisk adaptor onto the motor unit and turn clockwise until you hear it click into place. To remove whisk and adaptor, turn the adaptor counter-clockwise and remove from the base unit. Gently pull the whisk from the adaptor until it is released.
  - Always be sure that the appliance is properly assembled before using. Blender blades are extremely sharp; never touch the cutting edge of blades.
4. Add ingredients into the blending mug or other container that is tall enough to avoid splashing. Add ingredients a little at a time to ensure proper blending and to prevent overflow. Never fill container more than  $\frac{3}{4}$  full; the action of the blade and immersing the wand or whisk into the container will cause ingredients to rise in the container. Make large recipes in multiple batches.
5. Unless the recipe states differently, pour liquid ingredients into the blending container before solid ingredients. The liquid will help the processing time go faster.
6. Plug the appliance into the power outlet.
7. Dip the blending wand or whisk as deeply as possible into the mug, but only up to within one inch of the connection to motor unit; then switch on the unit by holding the on/off button on the front panel. To avoid splashing, do not turn the unit on until the blade or whisk is beneath the surface of the mixture and do not pull the blender out of the mixture while it is running.
8. Work through the ingredients with a gentle up and down motion. When blending is complete, release the on/off button and unplug the unit from the outlet.
9. Detach the blending wand or whisk after unplugging the unit.
10. When using the hand blender continuously, it is recommended to stop and let the machine rest for 5 minutes to prevent overheating.
11. When finished, remember to wash and dry all parts as described above.

### **Blending Tips**

- Liquid should not come closer than within an inch of where the wand or whisk attaches to the motor unit.
- Do not immerse the motor unit in liquid or water.
- Do not let the blender stand in a hot pot on the stove while not in use.
- Do not put fruit pits, bones or other hard ingredients into the blending mixture, as these are liable to damage the blades.
- Do not fill the container too full. The level of the mixture will rise when immersing the wand or whisk as well as when blending and can splash or overflow the container. If you are blending large amounts, separate into smaller batches to blend.
- Adding liquids that are warm, not cold, facilitates blending solids with liquids.
- When recipes call for ice, use crushed ice, not cubed ice.
- The gentle up-and-down motion described above will mix the ingredients most uniformly and give you the best result.
- To whip air into a mixture, hold the blade just under the surface of the mixture. Be careful not to raise the blade above the surface and cause splashing.
- To make soup creamy in texture, use the Hand Blender to puree solid ingredients to the desired consistency using a gentle up-and-down motion right in your saucepan.
- When blending butter, remove the butter from the refrigerator and let it come to room temperature for best results.

## **CLEANING AND MAINTENANCE**

After each use and before cleaning, unplug the appliance from outlet and allow the unit to stop. **DO NOT ATTEMPT TO CLEAN WHILE THE MOTOR IS RUNNING OR THE COMPONENTS ARE STILL MOVING.**

**CAUTION: NEVER IMMERSE THE MOTOR UNIT, CORD OR PLUG IN WATER. NEVER TOUCH THE BLADE ITSELF. ALWAYS UNPLUG BEFORE CLEANING.**

- Clean the motor unit with a damp soft cloth or sponge and dry thoroughly.
- Never use excess water, treated cloths, harsh cleaning agents, or sprays.
- Wash all of the removable parts – blending wand, whisk, whisk adaptor and blending mug using a sponge, warm water and mild dish detergent. Rinse and dry carefully. Do not wash in an automatic dishwasher. Use caution when handling the blending wand, as the cutting blade is sharp. Do not touch the blade itself.
- Remove the blending wand or whisk from the motor unit. Wash the detachable parts under running water, being careful not to allow water to enter the hollow shaft of the blending wand. Dry thoroughly.
- Reassemble and store in a dry place, unplugged and away from the reach of children.

## **IMPORTANT NOTES:**

- Do not wash any components in an automatic dishwasher.
- Do not use harsh or abrasive cleaners or solvents.
- To store, place all components back into the box and store in a cool, dry place away from the reach of children.

## **TROUBLESHOOTING**

**The Hand Blender will not operate.**

- Has a household fuse blown, or has a circuit breaker tripped?
- Is the power supply cord properly seated in the unit and the outlet?
- Has the cord been damaged in some way? If so, **DO NOT USE THE APPLIANCE.** Contact Customer Service for replacement information.

**Liquid is spilling, splashing or overflowing the container or saucepan.**

- You may be blending too much liquid. Divide the mixture into smaller batches.
- You may have started the blender before submerging the blade into the mixture.
- You may have accidentally raised the blade or whisk above the surface of the mixture during blending.

## **WARRANTY INFORMATION**

Taylor® warrants this product to be free from defects in material or workmanship for one (1) year for the original purchaser from date of retail purchase. It does not cover damages or wear resulting from accident, misuse, abuse, commercial use, or unauthorized adjustment and/or repair. If service is required, do not return to retailer. Should this product require service (or replacement at our option), please contact Taylor Customer Service at:

**1-800-289-0944**

There are no expressed warranties except as listed above. This warranty gives you specific legal rights, and you may have other rights which vary from state to state.

If you need replacement parts

• Use only Taylor specified parts. These specified parts will fit right and work right because they are made with the same precision used to build every new Taylor appliance.

Keep this book and your sales slip together for future reference. You must provide proof of purchase for warranty purposes.

For additional product information, or warranty information in Canada or elsewhere outside the USA, please contact us through [www.taylorusa.com](http://www.taylorusa.com)

Taylor® is a registered trademark of Taylor Precision Products and its affiliated companies. All rights reserved. Made to our exact specifications in China.

*[www.taylorusa.com](http://www.taylorusa.com)*

© 2009 The Biggest Loser is a registered trademark of NBC Studios, Inc., & Reveille LLC. All Rights Reserved.

## Free Manuals Download Website

<http://myh66.com>

<http://usermanuals.us>

<http://www.somanuals.com>

<http://www.4manuals.cc>

<http://www.manual-lib.com>

<http://www.404manual.com>

<http://www.luxmanual.com>

<http://aubethermostatmanual.com>

Golf course search by state

<http://golfingnear.com>

Email search by domain

<http://emailbydomain.com>

Auto manuals search

<http://auto.somanuals.com>

TV manuals search

<http://tv.somanuals.com>