

TAYLOR®

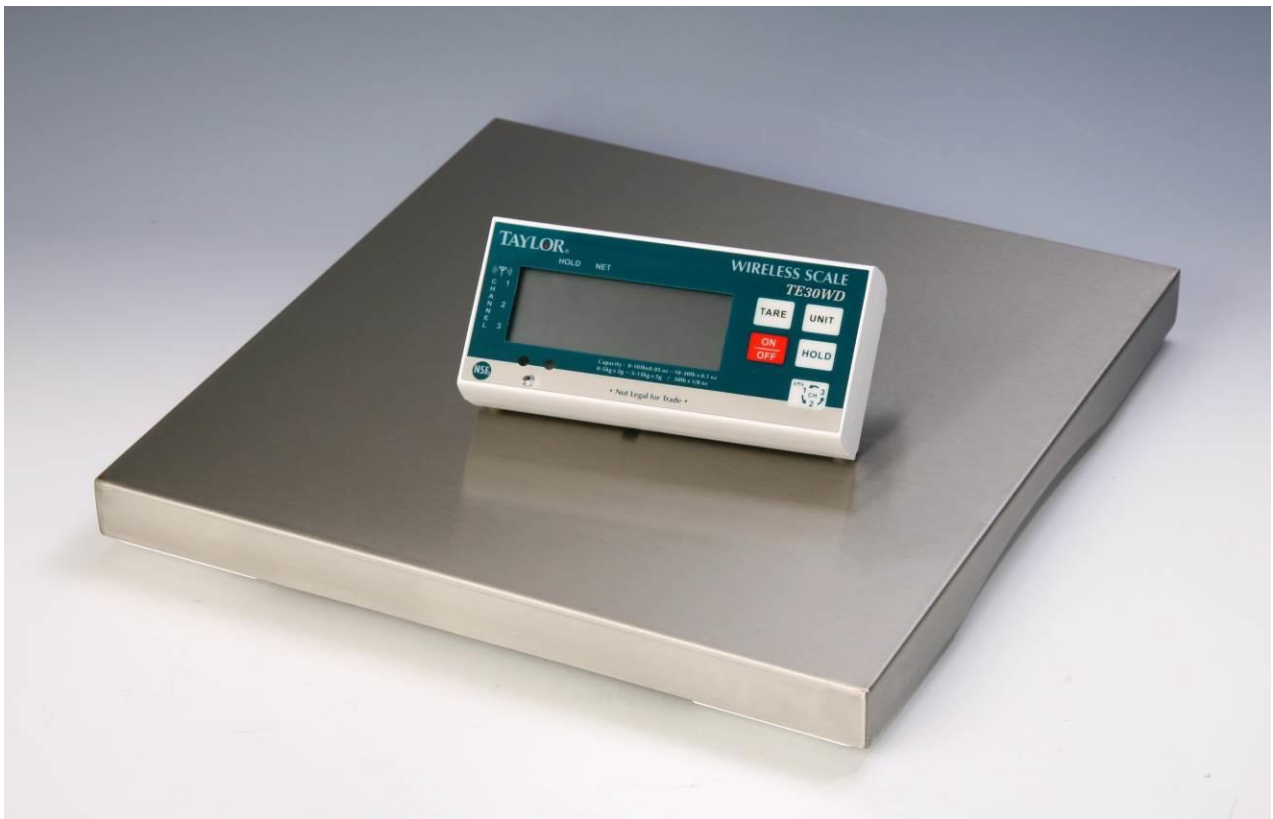

TE30WD Wireless Scale INSTRUCTION MANUAL

TABLE OF CONTENTS :

<u>TABLE OF CONTENTS.....</u>	<u>1</u>
<u>SPECIFICATIONS.....</u>	<u>2</u>
<u>DISPLAY.....</u>	<u>3</u>
<u>BUTTON DESCRIPTION.....</u>	<u>3</u>
<u>PREPARING SCALE FOR WEIGHING.....</u>	<u>4</u>
<u>CHANGING THE WIRELESS DISPLAY'S CHANNEL.....</u>	<u>5</u>
<u>SELECTING SCALE PLATFORM'S CHANNEL.....</u>	<u>6</u>
<u>USING THE TARE FUNCTION.....</u>	<u>7</u>
<u>ACTIVATING/DEACTIVATING TOUCHLESS TARE FEATURE.....</u>	<u>8</u>
<u>FUNCTION SETTINGS.....</u>	<u>8</u>
<u>TABLE-TOP STAND AND WALL MOUNTS.....</u>	<u>9</u>
<u>POWER SOURCES.....</u>	<u>10</u>
<u>ERROR MESSAGES.....</u>	<u>11</u>
<u>FEDERAL COMMUNICATIONS COMMISSION (FCC) STATEMENT.....</u>	<u>12</u>
<u>PRECAUTIONS.....</u>	<u>13</u>
<u>WARRANTY AND CUSTOMER SERVICE INFORMATION.....</u>	<u>14</u>







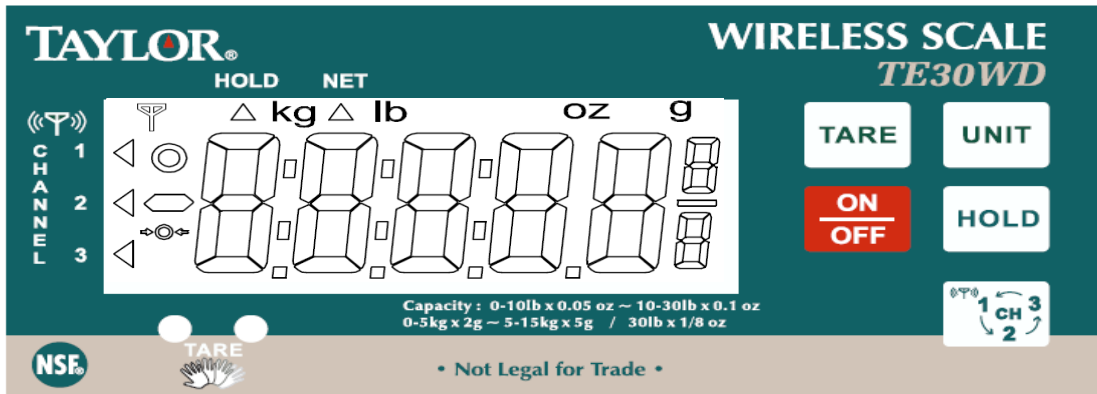



SPECIFICATIONS

	Model TE30WD
Capacity	0-10 lb x 0.05 oz/10-30 lb x 0.1 oz 0-5 kg x 0.002 kg (2 g)/5-15 kg x 0.005 kg (5 g) 30 lb x 1/8 oz
Weight Unit	lb:oz (decimals)/lb:oz (fractions)/kg
LCD Readout	1" LCD readout
Dimensions	14" x 14" x 1.6"
Buttons	ON/OFF, HOLD, Unit, Tare, Channel
Power Supply	<ul style="list-style-type: none"> ➤ 10-AA batteries (6 for base, 4 for remote, not included.) ➤ 2 120V AC adapters 1 for base, 1 for remote (included)
Operation Temperature	32°F / 104°F (0°C / 40°C)

DISPLAY



BUTTON DESCRIPTION

	Press to turn the scale ON or OFF.
	Press to 'Tare' (zero) the weight of any item while weighing.
	Press to 'Hold' the weight on the screen.
	Press to switch between lb:oz and kg units of measurement.
	Press to reset the scale to zero (TARE function) if the scale does not show zero automatically.
	Icon flashes when scale is ready for a weighing.
	Stability display: If the display shows 'o', the weight is stable on the scale. If the display shows 'o', the weight is unstable.
	The 'Hold' weighing function is active.
kg ↔ lb:oz	Indicates the Weighing unit [kg ↔ lb:oz].
	Stored 'Tare' value.
	Touch-free taring field.
- / o on base	On (-) / Off (o) switch for scale base.

PREPARING SCALE FOR WEIGHING

Before Weighing

1. Please select the scale's channel to match the wireless display. (The scale's channel indicator is located on the scale's base; please remove the rubber stopper to access the channel indicator.) For example: If the wireless display is using Channel-1, select Channel-1 for the scale. (Please see Page 6 for instructions for selecting platform channels.)
2. Press the ON/OFF button to turn on the scale.
3. Please make sure that the distance between the scale base and the wireless display is within 30 feet (10 meters).

Note: If the scale's channel is not same as the wireless display, '88888' will appear on the display. Set the scale and wireless display to the same channel.

Weighing

1. Press the ON/OFF button to turn on the scale.
2. '88888' appears on the screen, then '0' and '📡' will flash. The scale is ready for weighing.

***NOTE-** If the "88888" display does not show '01, press the





button to change the wireless display's channel to match the scale's channel. For example: If the scale's channel is set to Channel-1, please select Channel-1 for the wireless display also.

CHANGING THE WIRELESS DISPLAY'S CHANNEL



Press the  button to select the wireless display channel.

Channel numbers (1, 2, 3) are shown on the left hand side of the display. When a channel is selected, a triangle icon points to the selected channel. For example- If Channel-1 is selected, the triangle icon points to '1'.



Channel 1	
Channel 2	
Channel 3	

SELECTING THE SCALE PLATFORM'S CHANNEL

To select the scale platform's channel, first turn off the scale base and wireless display units. Then use the dip switch, which is located on the bottom of the scale under the rubber stopper. The dip switch has four pins marked '1, 2, 3, 4' (Pin-4 is not active; only 3 channels are available for use.) To select a channel, move the pin toward the 'ON' mark (pictured below). For example- To select Channel-1 for the scale, move Pin-1 towards the 'ON' mark. Turn on the scale base first, then the wireless display for use.

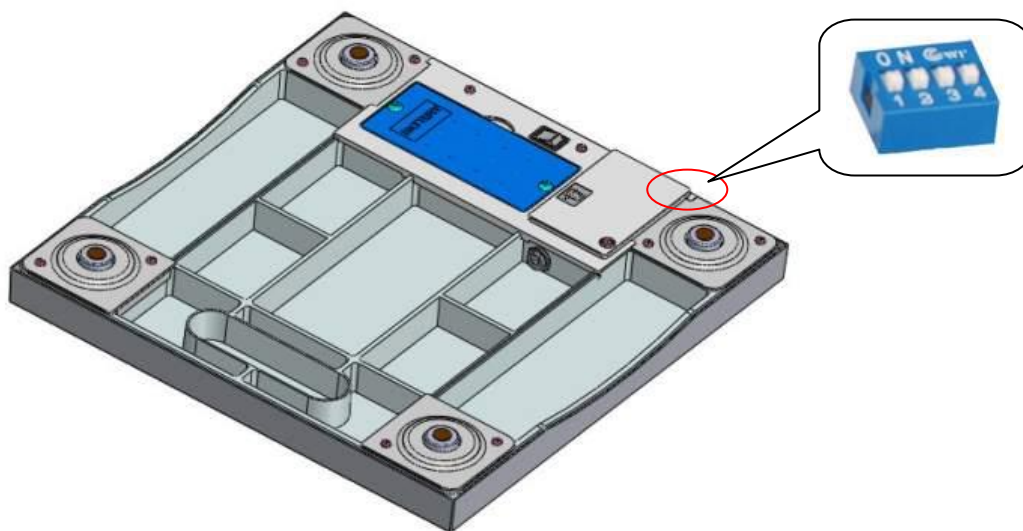
The dip switch is on the bottom of the scale platform under the rubber stopper.

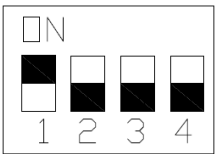
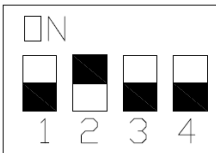

Channel 1	
Channel 2	
Channel 3	

USING THE TARE FUNCTION

The Tare Function allows the user to zero the scale to cancel out the weight of a container, thus giving the weight of the item being weighed.

- Press the ON/OFF button to turn on the scale.
- Place the container on the scale platform.
- Press the 'TARE' button after the weight stabilizes and stable sign displays.
- The display will reset to '0'.
- Place the item to be weighed on the platform (without removing the 'tared' container).

OR

Touch Free Tare Function: This scale is equipped with 'Photo eye mechanism' for a touch free 'TARE' function. Simply pass your hand over the 'Photo eye' sensor and the scale will tare the weight.

- Place the container to be tared on the scale platform.
- Pass your hand over the  sign on the indicator.
- The display will reset to '0'.
- Place the next item to be weighed on the scale platform.

To reset the 'TARE' to zero, remove the tared container from the platform and press the 'TARE' button, or pass your hand

over the  sign.

ACTIVATING/ DEACTIVATING TOUCH LESS TARE FEATURE

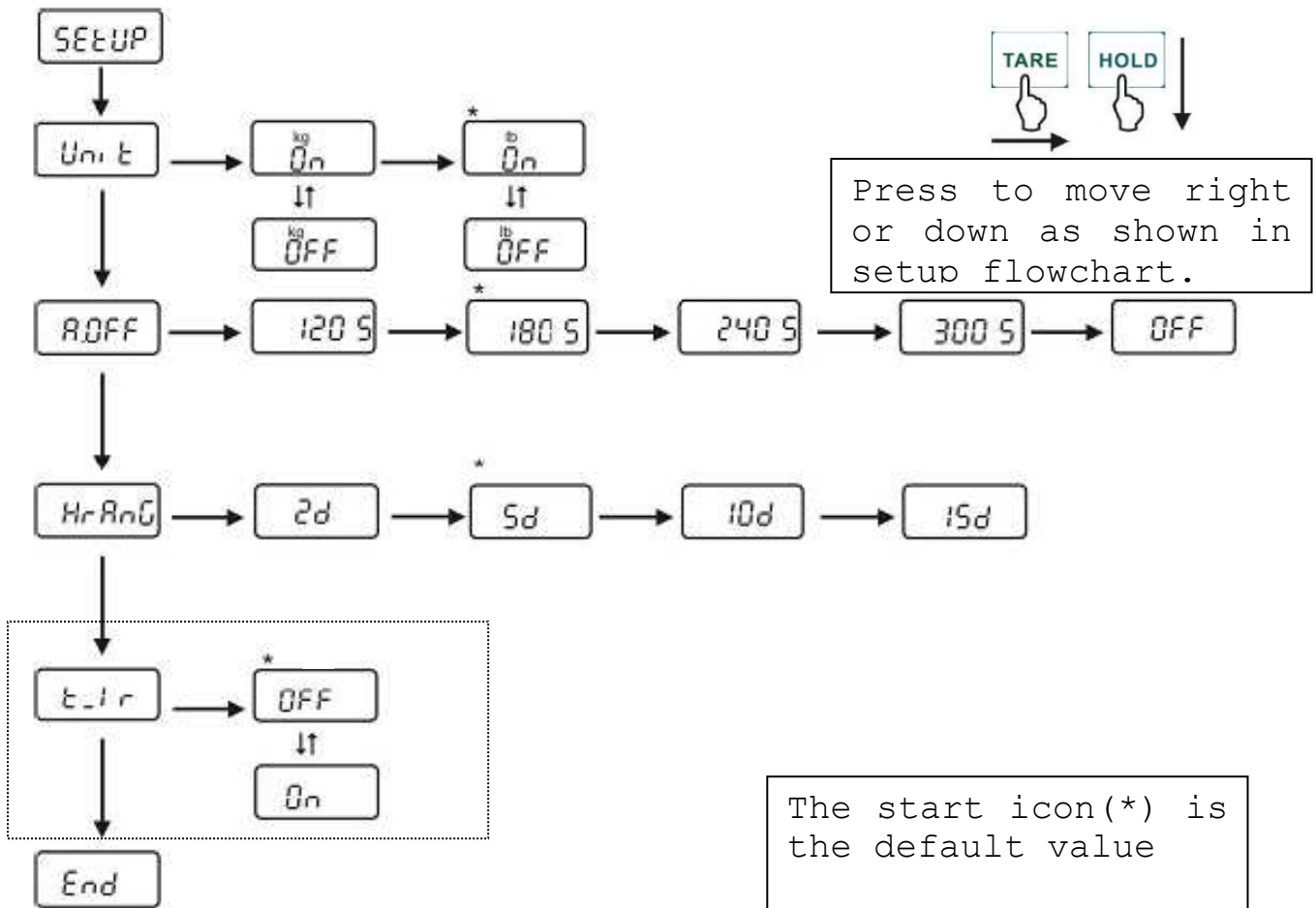

FUNCTION SETTINGS

Function	Description	Default
Unit	(Units): lb , kg	lb
R.OFF	(Auto off Time): 120 sec/ 180 sec/ 240 sec/ 300 sec/ OFF	180 S
HrRnG	(Hold range): 2d/ 5d/ 10d/ 15d	5d
t.l.r	(Touch less feature): on , off	On
End	To confirm the settings and end the procedure	

TABLE-TOP STAND AND WALL MOUNTS

You may stand the scale platform on a table.
Adjust the angle of the wireless display for easy viewing.
Table top display:

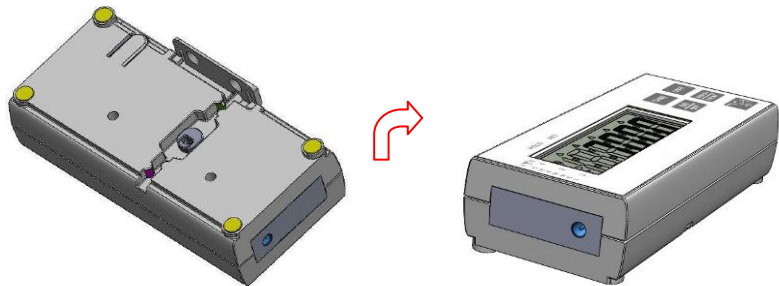

Wall display:

The wireless display may be mounted to a wall. Use the mounting material included.

1. Screw the screws to the wall as shown.
2. Push the wireless display onto the well.

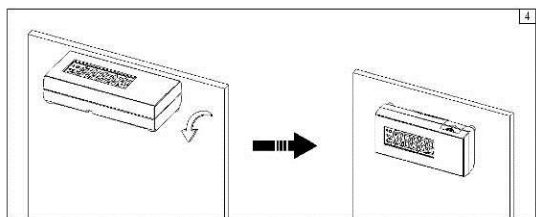
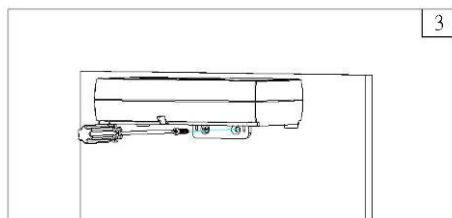
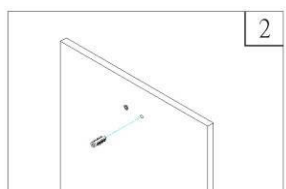
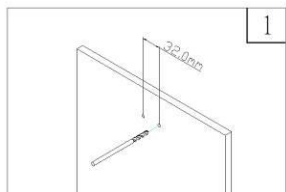
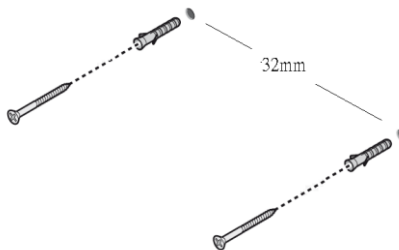

POWER SOURCES

If **.Lo** displays on the LCD, please use the included Taylor adapters or replace the batteries. Insert an adapter into the bottom of the wireless display and the scale base.

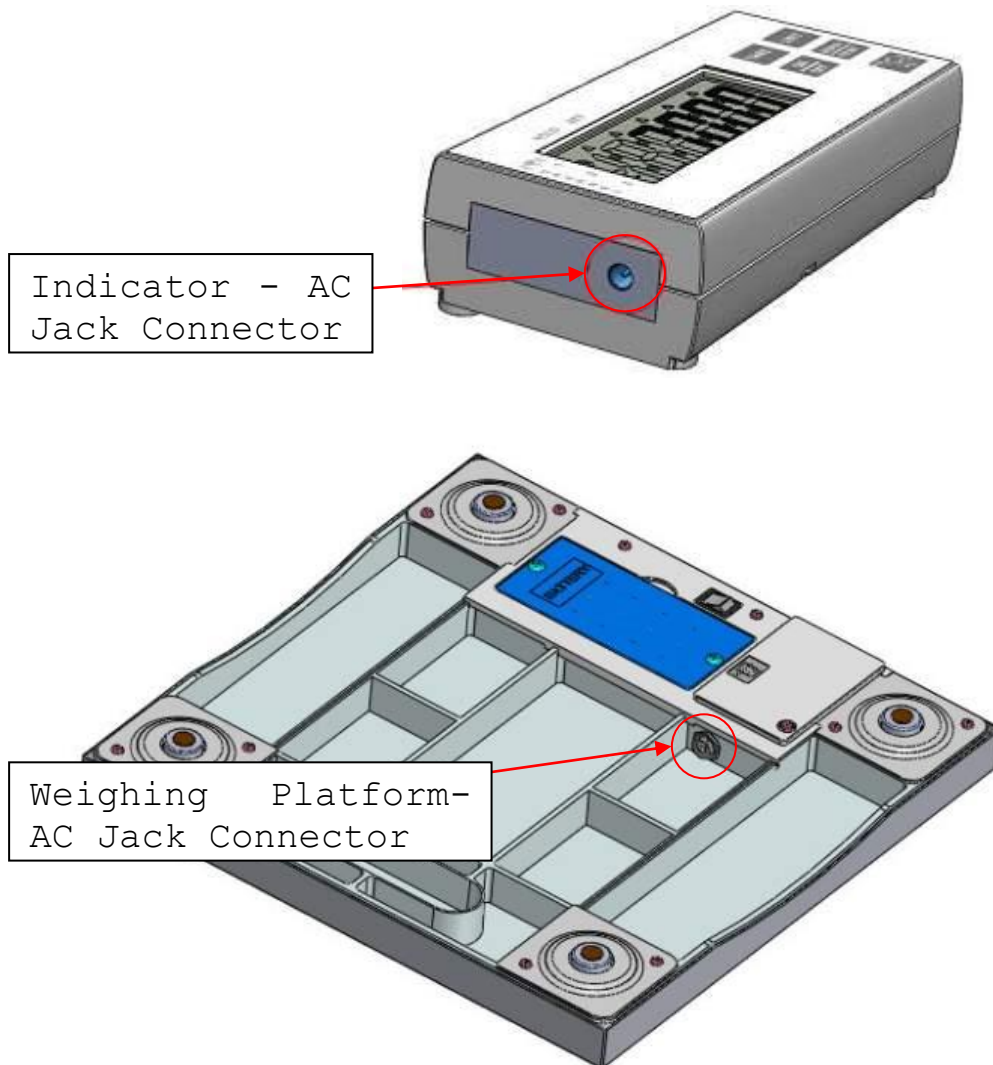

This scale's weighing platform and wireless display require separate electric power. Before using the scale, please make sure that both the scale base and wireless display have batteries correctly installed or both adapters correctly plugged in.

The scale base uses 6 AAA batteries and the wireless display uses 4 AAA batteries (batteries not included), or the units use a 120V AC adapter each (2 adapters included).

ERROR MESSAGES

Message	Description
Lo	Low battery indicator for wireless display: This warning indicates the batteries for the wireless display are low. Please replace all the batteries or use the AC adapter for operation.
Lo d	Low battery indicator for scale base: This warning indicates the batteries for the scale base are low. Please replace all batteries or use the AC adapter for operation.
ErrE	EEPROM error for wireless display: The programming for the wireless display has an error. Please contact customer service.
ErrEd	EEPROM error for scale base: The programming for the scale base has an error. Please contact customer service.
Err	Overload or counting error (too high): The weight or count capacity is over the limit. Please reduce the weight/count and try again.
ErrL	Overload or counting error (too low): The weight or count capacity is under the limit. Please increase the weight/count capacity and try again.

Transmission Collision

Signals from other household devices, such as doorbells, home security systems and entry controls, may interfere. This is normal and does not affect the general performance of this product. The transmission will resume once the interference recedes.

Note: This equipment has been tested and found to comply with the limits for a Class B digital device, pursuant to Part 15 of the FCC Rules. These limits are designed to provide reasonable protection against harmful interference in a residential installation. This equipment generates, uses and can radiate radio frequency energy and, if not installed and used in accordance with the instructions, may cause harmful interference to radio communications. However, there is no guarantee that interference will not occur in a particular installation. If this equipment does cause harmful interference to radio or television reception, which can be determined by turning the equipment off and on, the user is encouraged to try to correct the interference by one or more of the following measures:

--Reorient or relocate the receiving antenna.

--Increase the separation between the equipment and receiver.

Modifications not authorized by the manufacturer may void users authority to operate this device.

FCC ID: YKFRF2500

Precautions

This scale is engineered to give you years of satisfactory service if you handle it carefully. Here are a few precautions:

1. Always read instructions thoroughly to ensure that you have the full benefit of all the unit's features.
2. DO NOT immerse units in water, as doing so will cause damage to internal components and void the warranty. If you spill liquid on it, dry it immediately with a soft, lint-free cloth.
3. DO NOT clean the units with an abrasive or corrosive material. This may scratch the plastic parts and corrode the electronic circuits.
4. DO NOT subject the units to excessive force, shock, dust, temperature or humidity. This may result in malfunction, shorter electronic life span, damaged batteries or adapters and distorted parts.
5. DO NOT operate or store the scale or display in high temperature or humidity conditions. The heat or moisture may interfere with the scale's or display's internal components.
6. DO NOT tamper with the unit's internal components. Doing so will invalidate the warranty on the units and may cause damage. The units contains no user-serviceable parts.
7. This scale is an extremely sensitive weighing device. To avoid damage to the units or the batteries/adapters, do not store anything on the scale.
8. Remove the batteries or adapters if the units will not be used for a long period of time.
9. Do not dispose of batteries in fire. Batteries may explode or leak. Do not mix old and new batteries. Do not mix alkaline, standard (Carbon-zinc), or rechargable (Nickel-Cadmium) batteries.

One Year Limited Warranty

Taylor warrants this product to be free from defects in materials or workmanship for one (1) year from date of original purchase. It does not cover damages or wear resulting from accident, misuse, abuse, commercial use, or unauthorized adjustment and/or repair.

If service is required, do not return to distributor. For service, call between 7:30 AM and 4:30 PM, Mountain Standard Time, Monday through Friday. To assist us in servicing you, please have the model number and date of purchase available. Should this product require service (or replacement at our option), please pack the item carefully and return it prepaid, along with receipt showing date of purchase and a note explaining reason for return to:

Taylor Precision Products
2220 Entrada del Sol, Suite A
Las Cruces, New Mexico 88001
Customer Service Phone: 1-800-225-4834
Customer Service Fax: 1-575-526-4347
www.taylorusa.com

There are no expressed warranties except as listed above. This warranty gives you specific legal rights, and you may have other rights which vary from state to state.

For additional product information, or warranty information in Canada or elsewhere outside the USA, please contact us through www.taylorusa.com.

©2011 Taylor Precision Products and its affiliated companies, all rights reserved. Taylor® and Leading the Way in Accuracy® are registered trademarks of Taylor Precision Products and its affiliated companies. All rights reserved.

Made to our exact specifications in China.
Not Legal for Trade.

TE30WD 8.11

Free Manuals Download Website

<http://myh66.com>

<http://usermanuals.us>

<http://www.somanuals.com>

<http://www.4manuals.cc>

<http://www.manual-lib.com>

<http://www.404manual.com>

<http://www.luxmanual.com>

<http://aubethermostatmanual.com>

Golf course search by state

<http://golfingnear.com>

Email search by domain

<http://emailbydomain.com>

Auto manuals search

<http://auto.somanuals.com>

TV manuals search

<http://tv.somanuals.com>