

# TECHNIKA ADVANCED

## User Handbook

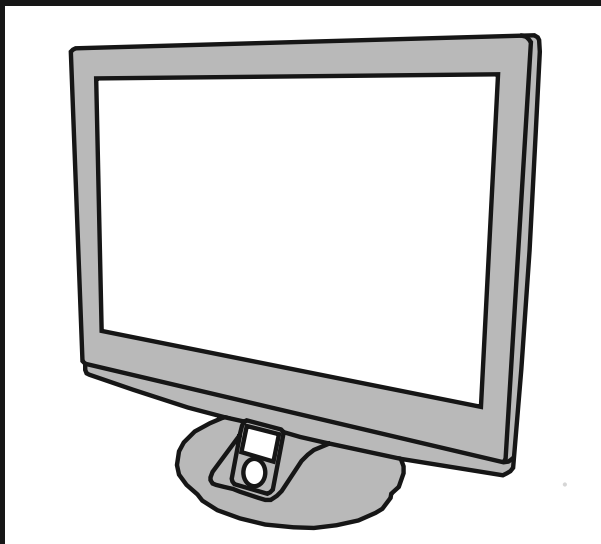

LCD19W-219

19" HD DIGITAL LCD TV/DVD





## Important Guarantee Information.

Congratulations on purchasing this television. We hope you have many years of trouble free enjoyment from your purchase.

Your product is covered under the manufacturers guarantee for 12 months from date of purchase. The guarantee is 'return to manufacturer' and covers the costs of collection, parts & labour and redelivery charges in the event of breakdown caused by mechanical or electrical failure.

In the event of a fault being diagnosed, please refer to the frequently asked questions/troubleshooting section at the rear of this user guide.

If you are still unable to remedy the fault, try resetting the TV to factory settings, (details in this user guide) or contact the helpline.

In the event that a fault is diagnosed, the helpline will arrange to collect the TV from your home or work address, return it to our service centre, repair the item and then return it to you.

If we believe we cannot offer a permanent repair, we will replace the item.

## Sky Media UK LTD – Helpline Information

Telephone **0871 2000 463**

Email: **service@skymediauk.co.uk**

Internet: **www.skymediauk.co.uk**

The telephone opening hours are Monday to Friday 8.30am to 6pm, Saturday 9am – 5pm.

On the web site, you can register your product and guarantee, if you do it within 7 days of purchase, you will also receive an extra **FREE** 3 months warranty, making the warranty 15 months from date of purchase.

You must retain all packaging materials as you will need these in the event of warranty/service support.

If you need to call the helpline, you will need the following information.

Model Number \_\_\_\_\_ (Can be found on rear of TV)

Serial Number \_\_\_\_\_ (Can be found on rear of TV)

Date of purchase \_\_\_\_\_ (Can be found on sales receipt)

# Keep this important information about how to re-tune your TV during the digital TV switchover

## When does switchover happen?



The exact date you switch depends on the transmitter you are served by. To check when you switch, go to Digital UK's postcode checker on [www.digitaluk.co.uk](http://www.digitaluk.co.uk) Check your ITV news service or look at Teletext page 106 to see what TV region you're in.

## Important information regarding the digital TV switchover

Television in the UK is going digital, bringing us all more choice and new services. Starting late 2007 and ending in 2012, television services in the UK will go completely digital, TV region by TV region.

### How the switchover affects your TV equipment.

Your new TV has a digital tuner built in, which means it is ready to receive the Freeview signal by simply connecting it into your aerial socket (you can check if you can get digital TV through your aerial now or whether you will have to wait until the switchover at [www.digitaluk.co.uk](http://www.digitaluk.co.uk))

When the TV switchover happens in your area, there are at least two occasions when you will need to re-tune your TV in order to continue receiving your existing TV channels and also to pick up new ones. Digital UK, the body leading the digital switchover, will advise you when you need to retune during the switchover.

### How to retune.

Retuning your TV is a very quick and simple process. We recommend that you retune every few months to ensure you are receiving the very latest TV and radio channels that are broadcast.

- In digital/freeview mode, on the remote control press 'LCD menu' quickly followed by 8-8-8-8 (so press the number 8 four times)
- You will now enter the 'First time installation' mode. (if you do not, please refer to the section called 'getting started' later in this user guide)



- Simply press 'OK' or 'Enter' on the remote control and your TV will retune.

If you do not retune your TV when advised to do so by Digital UK, you may lose some or all of your channels until you do re-tune.

If you are missing any channels, it may be that they are not available in your area, or that your TV aerial needs upgrading.

For help and support regarding the digital switchover, please contact Digital UK:

Telephone: 08456 50 50 50

Digital UK website: [www.digitaluk.co.uk](http://www.digitaluk.co.uk)

If you require technical or warranty support on this television, please contact the manufacturer helpline, do not contact Digital UK unless your query is regarding the digital switchover.

## WARNINGS

### Caution

This television contains no user serviceable parts. Please refer to the manufacturer or authorised repair agent in the event of malfunction. Do not remove the back cover from the television.

### Warning

To reduce the risk of fire, electric shock or damage to the television, do not expose it to dust, rain or moisture, or place any objects filled with liquids on or near the television.

Do not place the television in a confined space, ensure that nothing can obstruct the ventilation openings at the rear of the television.

Do not place naked flames on or near the television.

Dispose of this television and any components including batteries in an environmentally friendly manner. If in doubt, please contact your local authority for details of recycling.

Your LCD TV should be cleaned using a dry or slightly damp cloth. You should not use an alcohol based cleaner

### Safety

For your safety, this appliance is fitted with a fused moulded 3 pin mains plug. Should the fuse need to be replaced, ensure that any replacement is of the same amperage and approved with the BSI mark. ( )

Never try and replace the mains plug unless you have adequate qualifications and are legally authorised to do so. In the event that a replacement Mains cable is required, contact the manufacturer for a suitable replacement.

Never use the television if it is damaged in any way.

Always place the television on a flat level surface avoiding anywhere which may be subject to strong vibration. Ensure the television is not placed on top of the power cable as the weight of the television may damage the cable and cause a safety hazard.

Never place mobile phones, speakers or any other device which may cause magnetic or radio interference with the television. If interference is apparent, move the device causing the interference away from the television.

### Packaging

Please save the packaging for the television as you will need this in the event of warranty/service repair or support. We are unable to carry out warranty/service if you are unable to package it correctly. The safest way to package your item in the event of warranty/service repair is in its original box/packaging

## WARNINGS

### Screen Burn

A characteristic of LCD TV Panels is that displaying the same image for a long time may cause a permanent after-image to remain on the screen. This is called screen burn.

**Examples of images that you need to be aware of are as follows (this is not an all-inclusive list):**

- **TV Channel Logos:** e.g. Shopping channel logos and pricing displays—especially if they are bright and stationary. Moving or low-contrast graphics are less likely to cause ageing of the screen.
- **Picture-in-Picture and Multi Picture-in-Picture:** Do not view for long periods of time using the Picture-in-Picture or Multi Picture-in-Picture functions.
- **Time Displays**
- **Teletext:** Do not view a stationary page for long periods of time.
- **TV/DVD Menus:** e.g. Listings of DVD disk content.
- **Pause Mode:** Do not leave the TV in pause mode for long periods of time, e.g. When watching DVDs or videos.

**Note:** To prevent screen burn if viewing any of the above for long periods of time, reduce contrast and brightness when viewing. Once burn-in occurs it will never disappear completely.

How do I dispose of this product?

**UK:** Waste electrical products should not be disposed of with household waste. Separate disposal facilities exist. For your nearest facilities, please see [www.recycle-more.co.uk](http://www.recycle-more.co.uk) or instore for details.

**ROI:** Produced after 13th August 2005. Waste electrical products should not be disposed of with household waste. Please recycle where facilities exist. Check with your Local Authority or retailer for recycling advice.







## CONTENTS

- Important Guarantee Information	1
- Digital Switchover information	2 - 3
- Warnings	4 - 5
- Contents	7

### SETTING UP YOUR TV

- What is included in the box	8
- Initial Set Up	9
- Remote control buttons and their functions	10
- TV buttons and their functions	11
- Changing Source	12
- Inputs and Connections	12

### TV MENU OPERATION

- Using the TV menu	13
- <b>Picture Settings Menu</b>	<b>13 - 16</b>
- Picture Mode Presets	13
- Contrast	13
- Brightness	14
- Colour Settings	14
- Tint	15
- Sharpness	15
- Colour Temperature	16
- Dynamic Noise Reduction	16
- <b>Sound Settings Menu</b>	<b>17 - 18</b>
- Volume	17
- Sound Mode Presets	17
- Bass	18
- Treble	18
- Balance	18
- Volume Boost	18
- <b>Tuning Settings Menu</b>	<b>19 - 20</b>
- Adjusting Country	19
- Auto Tuning	19
- Manual Tuning	19
- Program Edit / Channel Position	20
- Common Interface Slot	20
- Timer Settings Menu	21
- Sleep Timer	21
- On Screen Display Timer	21
- <b>General Settings Menu</b>	<b>22 - 23</b>
- On Screen Display Language	22
- Picture Format	22
- Blue Screen	22
- Child Lock / Key Lock	22
- First Time Installation	23
- Reset Television	23

### CHANNEL SERVICES

- Using Electronic Program Guide	24
- Using Digital TV teletext	25
- Using Analogue TV teletext	26

### IPOD OPERATION

- Connect iPod to TV-Dock	27
- Key Buttons	28
- Shuffle & Repeat Songs	29
- Watch Videos from iPod	30
- Browse Photos from iPod	30

### PC OPERATION

- Connecting to a PC	31 - 32
- PC Menu Settings	33 - 34

### DVD MENU OPERATION

- Adjusting Parental Control	35
- Adjusting Language	36
- Adjusting Audio Set Up	37
- Adjusting Digital Set Up	38
- Changing Regions	38

### CONNECTING A GAMES CONSOLE

- Nintendo Wii, PS1, PS2 & Xbox	39
- Xbox 360	39
- PlayStation 3	40

### GENERAL INFORMATION

- Wall Mounting	41
- Using with Sky Digital	42 - 43
- Connecting TVs with iPod Function	44
- Frequently Asked Questions	45
- Technical Specifications	46
- Index	47

If you experience any problems with this Television,  
Please contact the helpline.

**Customer Support/Technical Helpline**  
**Sky Media UK LTD**  
**Telephone: 0871 2000 463**  
**Email: [service@skymediauk.co.uk](mailto:service@skymediauk.co.uk)**

## WHAT IS INCLUDED IN THE BOX

### Accessories

Included with this TV are the following accessories:

#### 1x - User Guide Book



#### 1x - Remote control



#### 1x - RF lead



#### 2x - AAA batteries



#### 1x - Quick Start Guide

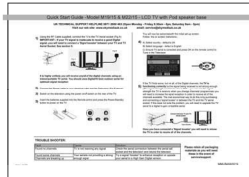

#### 1x - TV

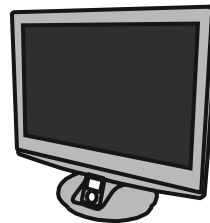

#### 1x - AC Mains lead



#### 4 x iPod Dock inserts to hold your iPod safely in the iPod dock



## GETTING STARTED - INITIAL SET UP

**IMPORTANT - AFTER TUNING DO NOT PRESS ANY BUTTONS FOR 20 SECONDS SO THE CHANNEL INFORMATION CAN BE STORED.**

### TUNING IN

**IMPORTANT — Please ensure the TV has reached room temperature before connecting the power for the first time**

- 1) Connect the mains lead to rear of the TV and the plug to the wall. Switch on the TV at the power switch on the side.
- 2) Connect the RF Cable supplied to the '**RF - In**' on the rear of the TV and connect the other end of the cable to your TV Aerial outlet

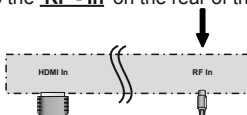

- 3) Install batteries in the remote control and press the red [POWER] button to turn on the TV.



The 'First Time Installation' menu should now appear. If it does not, please press [MENU] 8888 the menu will appear.

- 4) Press [OK] on the remote control whilst 'OK' is highlighted on screen.

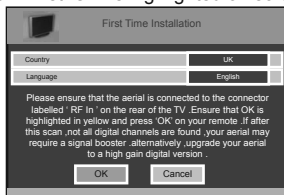

Tuning will now take place.

- 5) After tuning has taken place you will be taken to the program edit screen where you can move the location of channels. Alternatively if it does not find any channels the below screen will appear and you should investigate as to why your TV is not receiving a signal.



**IMPORTANT - WE RECOMMEND YOU CONNECT TV'S WITH BUILT IN DIGITAL/FREEVIEW TO SUITABLE AERIALS. I.E LOFT AERIAL OR OUTDOOR ROOF AERIAL. ALSO, PLEASE CHECK YOU LIVE IN AN AREA THAT CAN RECIEVE DIGITAL/FREEVIEW STATIONS. WE DO NOT RECOMMEND USING WITH INDOOR AERIALS UNLESS YOU ARE IN 100% COVERAGE AREA AND ALSO THAT THE INDOOR AERIAL ISAMPLIFIED/HAS BUILT IN BOOSTER AND IS CAPABLE OF RECIEVING DIGITAL/FREEVIEW. WE RECIEVE MANY CALLS TO OUR HELPLINE FROM CUSTOMERS ADVISING THEY CANNOT RECIEVE DIGITAL/FREEVIEW CHANNELS. OFTEN, SIMPLY CONNECTING A 'BOOSTER' BOX IN BETWEEN THE TV AND THE AERIAL SOCKET SOLVES 95% OF CASES. BOOSTERS/AMPLIFIERS ARE AVAILABLE FOR AROUND £10-£15 FROM MOST RETAILERS**

## REMOTE CONTROL BUTTONS

1

Press to switch on LCD when on standby mode or vice versa

2

Press to mute the sound and press again to restore

**ATV**

Press to change to analogue TV mode

**DVB**

Press to change to digital TV/Freeview mode

**DVD**

Press to change to DVD mode

**iPOD**

Press to change to iPod mode

**NUMBER BUTTONS**

Press 0 – 9 to select a TV channel directly when you are watching TV. The channel will change after 2 seconds.

↶

Return to the previous channel viewed

2

**TEXT** ▶/||

Teletext mode: Press to enter the teletext

DVD/iPOD mode: Press to play or pause

**HOLD** |◀

Teletext mode: Press hold on or off for current page display

DVD/iPOD mode: Press to replay the current action from the previous chapter/track

**REVEAL** ▶

Teletext mode: Press to reveal or hide the hidden words

DVD/iPOD mode: Press to advance forward to the next chapter/track

**INDEX / GO TO**

Teletext mode: Press to request the index page

DVD mode: Press to Go To a specific chapter on a DVD

**SIZE** ■

Teletext mode: Press to change the display size

**SUBPAGE** ◀◀

Teletext mode: Press to enter sub coded page access

DVD/iPOD mode: Press to play a DVD program or iPod track in fast rewind mode

▶▶

DVD/iPOD mode: Press to play a DVD program or iPod track in fast forward mode

||▶

DVD/iPOD mode: Press for slow motion play

**FAV / D.TITLE**

Digital mode: Press to display favourite menu

DVD mode: Press to display the disc menu (if available on DVD disc)

**FAV- / D.MENU**

Digital mode: Press to decrease favourite channel

DVD mode: Press to display the disc menu (if available on DVD disc)

**FAV+ / ZOOM**

Digital mode: Press to increase favourite channel

DVD mode: Press to select the zoom to change picture size

**NICAM /**

Digital mode: Press to select NICAM

DVD mode: Press to eject disc

**SUBTITLE / SUBT.**

Press to switch between the different subtitle languages



**DVB-LANGUAGE / AUDIO**

Digital mode: Press to select the digital language

DVD mode: Press to select DVD audio channels

**EPG / REPEAT**

Digital mode: Press to show the Electronic Program

Guide menu in freeview / digital mode

DVD mode: Press to set repeat

**DVB-INFO / A-B**

Digital mode: Press to display channel information

DVD mode: Press to A-B playback

3

**NAVIGATION BUTTONS** (◀, ▶, ▲, ▼, OK)

Allows you to navigate the on-screen menus and

adjust the system settings to your preference

**MENU**

Press to display OSD menu

**EXIT**

Press to exit OSD menu

4

**SOURCE**

Press to open the source menu

**DISPLAY**

Press to display the source and channel's

information

IPOD MODE: Press to show software version

**iPOD MENU**

Press to open the iPod OSD menu

**PC-AUTO**

Press to automatically set up the screen in PC

mode

**CH+**

Press to increase the channel by one

**CH-**

Press to decrease the channel by one

**VOL+**

Press to increase the volume

**VOL-**

Press to decrease the volume

**LIST**

Press to open the OSD track and song information

in iPod mode

**ASPECT**

Switches the TV between the different picture

formats

**SLEEP**

Activates the sleep mode

5

**PMODE**

Press repeatedly to cycle through the available

video picture modes

**BASS-**

Press to decrease the sub bass

**BASS+**

Press to increase the sub bass

**SMODE**

Press to cycle through the different sound modes

**ANGLE**

Press to select different angle of DVD when available

on disc

**INTRO**

Press to play a short introduction to each chapter

when available on disc

**COLOUR BUTTONS**

For operating digital and analogue teletext

## TV BUTTONS

### TOP PANEL BUTTONS

1	Select the input source
2	Displays Menu/OSD
3	Volume down and menu down
4	Volume up and menu up
5	Program/Channel down and menu down
6	Program/Channel up and menu up
7	Standby ON/OFF

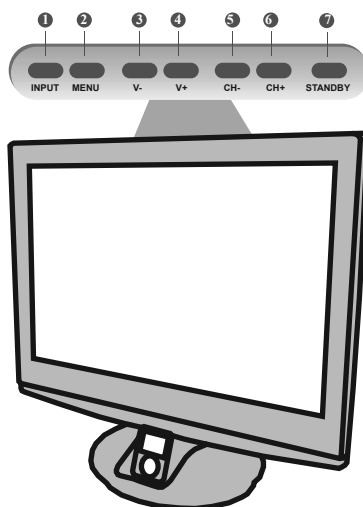

### SIDE PANEL BUTTONS

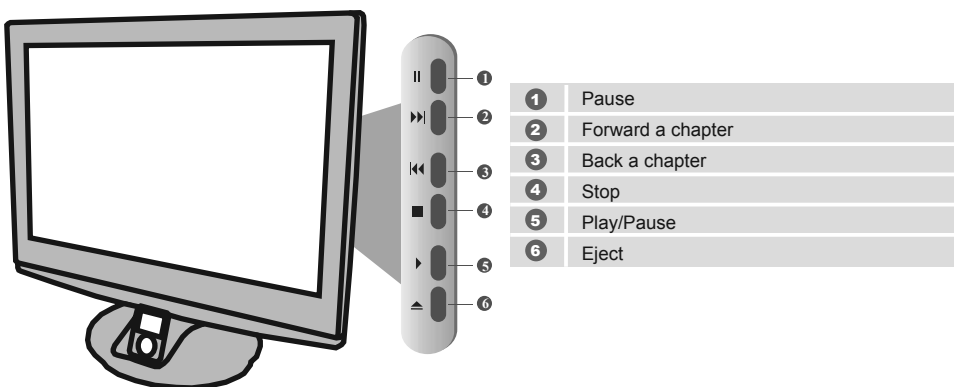

# INPUTS & CONNECTIONS

## REAR CONNECTIONS

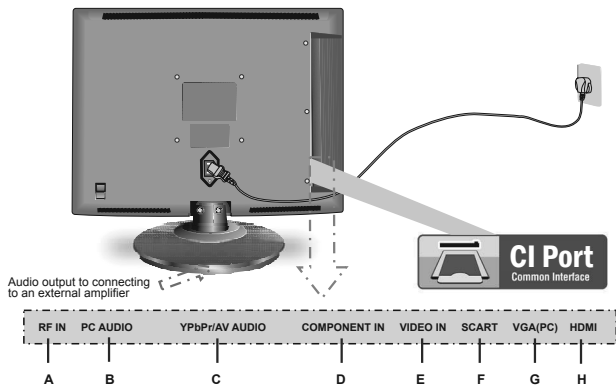

A	RF IN	RF input
B	PC AUDIO	PC Audio input
C	YPbPr/AV AUDIO	Video/Component Audio input
D	COMPONENT IN	Component input
E	VIDEO IN	Video input
F	SCART	Scart input
G	VGA (PC)	VGA-PC Audio input
H	HDMI	HDMI input

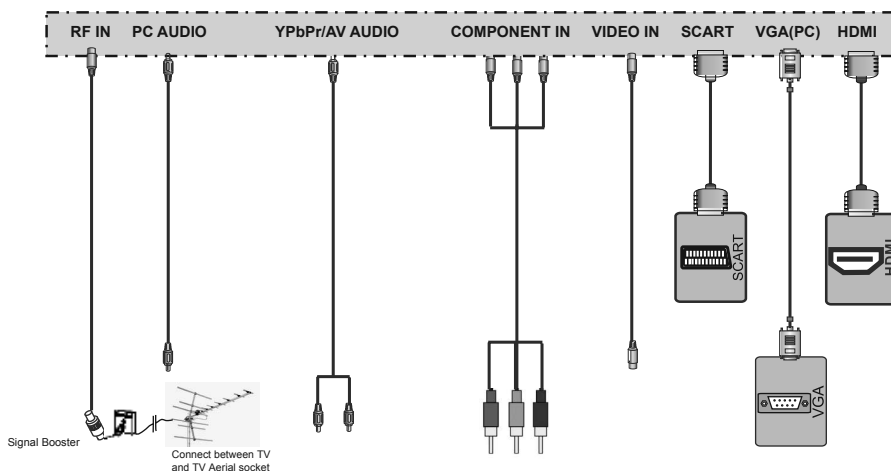

### Choosing Mode/Source

To switch between the different connections is very easy.

- 1) Press [SOURCE] - The following will appear
- 2) Press [V] or [A] to select the input you require.
- 3) Press [OK]

### Connecting HD Ready Devices

There are two options for HD.

- 1) By connecting via HDMI cable (not included) – this provides both HD picture and sound.
- 2) By connecting via Component (YPbPr / Component) cable (not included) – this provides HD picture. Source should be set to YPbPr / Component.

To receive sound you will need to connect your left and right audio to the YPbPr/S-Video Audio, using the 3.5mm to phono cable available separately.

### SOURCE MENU

TV/ANALOGUE  
DIGITAL/FREEVIEW  
IPOD  
HDMI  
SCART  
YPBPR/COMPONENT  
VIDEO  
VGA/PC  
DVD

Scroll  $\uparrow$   $\downarrow$  on the required input source and press OK

## TV MENU OPERATION

To access the OSD menu, press 'MENU' on the remote control. Use the scroll up/down/right/left to navigate through the menus.

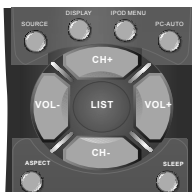

### PICTURE SETTINGS MENU

Lets you adjust picture mode, contrast, brightness, colour, tint and sharpness to enhance the viewing experience.

#### Selecting Picture Mode Presets

Switch between different preset picture options

Standard	All settings are set to 50
Personal	Lets you manually alter all the settings
Movie	Set to enhance when watching a movie
Sport	Set to enhance when watching a sport
Mild	Set to be lighter in colour and less bright
Game	Set to enhance when playing a games console

- 1) Press [MENU] to enter menu
- 2) Press [V] to highlight Picture Mode
- 3) Press [>] to navigate through the various options



- 4) Press [EXIT] to exit

#### Adjusting Contrast (Only available when Picture Mode is set to Personal)

Switch the balance between black and white

- 1) Press [MENU] to enter menu
- 2) Press [V] to highlight Contrast
- 3) Press [>] to increase the contrast or [<] to decrease the contrast

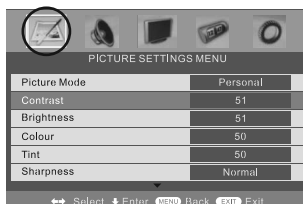

- 4) Press [EXIT] to exit

## TV MENU OPERATION

### PICTURE SETTINGS MENU

**Adjusting Brightness** (Only available when Picture Mode is set to Personal)  
Increase or decrease the brightness of the picture

- 1) Press [MENU] to enter menu
- 2) Press [V] to highlight Brightness
- 3) Press [>] to increase the brightness or [<] to decrease the brightness

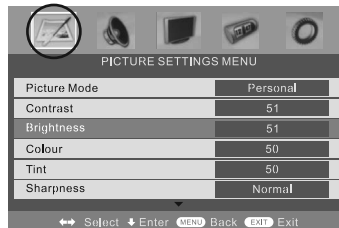

- 4) Press [EXIT] to exit

**Adjusting Colour** (Only available when Picture Mode is set to Personal)  
Increase the colour from black and white to vivid

- 1) Press [MENU] to enter menu
- 2) Press [V] to highlight Colour
- 3) Press [>] to increase the colour or [<] to decrease the colour

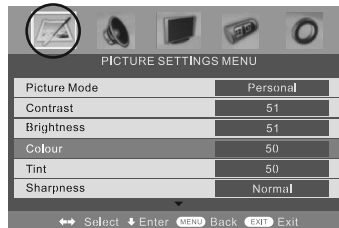

- 4) Press [EXIT] to exit



## TV MENU OPERATION

### PICTURE SETTINGS MENU

#### Adjusting Tint (Only available with NTSC signal)

Lets you increase or decrease the level of tint within the picture

- 1) Press [MENU] to enter menu
- 2) Press [V] to highlight Tint
- 3) Press [>] to increase the tint or [<] to decrease the tint

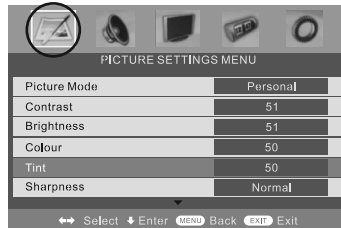

- 4) Press [EXIT] to exit

#### Adjusting Sharpness

You can change the sharpness between the different preset options

Normal	For standard use
Sharp	For pictures with little movement
Sharpest	For pictures with nearly no movement
Soft	For pictures with large amount of movement
Softest	For pictures with lots of movement

- 1) Press [MENU] to enter menu
- 2) Press [V] to highlight Sharpness
- 3) Press [>] to navigate through the various options

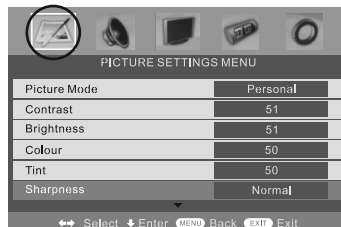

- 4) Press [EXIT] to exit

## TV MENU OPERATION

### PICTURE SETTINGS MENU

#### Adjusting Colour Temperature (Only available with NTSC signal)

There are 3 presets for colour temperature

Normal	Standard setting
Warm	Increased red within the picture
Cold	Increased blue within the picture

- 1) Press [MENU] to enter menu
- 2) Press [V] to highlight Colour Temperature
- 3) Press [>] to navigate through the various options

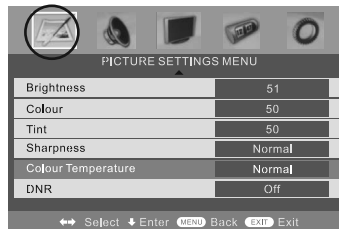

- 4) Press [EXIT] to exit

#### Dynamic Noise Reduction

Reduces the interference in the picture.

- 1) Press [MENU] to enter menu
- 2) Press [V] to highlight DNR
- 3) Press [>] to switch between OFF, LOW, MILD and HIGH.



- 4) Press [EXIT] to exit

## TV MENU OPERATION

### SOUND SETTINGS MENU

#### Adjusting Volume

Lets you adjust the volume of the television

- 1) Press [MENU] to enter menu
- 2) Press [>] to move to Sound Settings Menu
- 3) Press [V] to highlight Volume
- 4) Press [>] to increase the volume or [<] to decrease the volume



- 5) Press [EXIT] to exit

#### Selecting Sound Mode

Switch between different preset sound options

Voice	Emphasises voice over other sounds
Music	Emphasises music over voices
Theatre	Provides liver and full sound for movies
Personal	Selects your personal sound settings

- 1) Press [MENU] to enter menu
- 2) Press [>] to move to Sound Settings Menu
- 3) Press [V] to highlight Sound Mode
- 4) Press [>] to navigate through the various options



- 5) Press [EXIT] to exit

## TV MENU OPERATION

### SOUND SETTINGS MENU

#### Adjusting Bass

To adjust the amount of bass within the sound

- 1) Press [MENU] to enter menu
- 2) Press [>] to move to Sound Settings Menu
- 3) Press [V] to highlight Bass
- 4) Press [>] to increase the bass or [<] to decrease the bass



- 5) Press [EXIT] to exit

#### Adjusting Treble

To adjust the amount of treble within the sound

- 1) Press [MENU] to enter menu
- 2) Press [>] to move to Sound Settings Menu
- 3) Press [V] to highlight Treble
- 4) Press [>] to increase the treble or [<] to decrease the treble



- 5) Press [EXIT] to exit

#### Adjusting Balance

To switch the sound between the left and right speakers

- 1) Press [MENU] to enter menu
- 2) Press [>] to move to Sound Settings Menu
- 3) Press [V] to highlight Balance
- 4) Press [>] to increase the balance or [<] to decrease the balance



- 5) Press [EXIT] to exit

#### Volume Boost

This is to boost the volume level in all modes (except iPod Mode) to bring to a higher level.

- 1) Press [MENU] to enter menu
- 2) Press [>] to move to Sound Settings Menu
- 3) Press [V] to highlight Volume Boost
- 4) Press [>] to switch ON or OFF



- 5) Press [EXIT] to exit

## TV MENU OPERATION

### TUNING SETTINGS MENU (Only Freeview & Analogue TV modes)

#### Adjusting Country

If you are moving country you may wish to change the Country Settings

- 1) Press [MENU] to enter menu
- 2) Press [>] to move to Tuning Settings Menu
- 3) Press [V] to highlight Country
- 4) Press [>] to alter the chosen country



- 5) Press [EXIT] to exit

#### Auto Tuning

Scan for all channels based on the current settings

- 1) Press [MENU] to enter menu
- 2) Press [>] to move to Tuning Settings Menu
- 3) Press [V] to highlight Auto Tuning

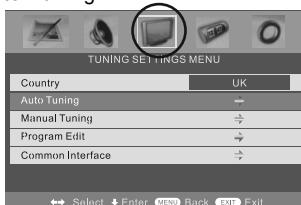

- 4) Press [>] to enter Auto tuning
- 5) Press [OK] to start the tuning
- 6) Press [EXIT] to exit

#### Manual Tuning

You may wish to manual search if you can't find a certain channel or if you wish to connect to a Satellite/Cable box via RF/Aerial connector

- 1) Press [MENU] to enter menu
- 2) Press [>] to move to Tuning Settings Menu
- 3) Press [V] to highlight Manual Tuning
- 4) Press [>] to enter manual tuning
- 4) Press [>] to start the tuning

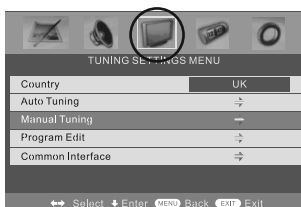

- 5) Press [EXIT] to exit

## TV MENU OPERATION

### TUNING SETTINGS MENU

#### Program Edit / Changing Channel Position (Only Freeview & Analogue TV modes)

You can change the analogue channel position to suit your requirements.

- 1) Press [MENU] to enter menu
- 2) Press [>] to move to Tuning Settings Menu
- 3) Press [V] to highlight Program Edit

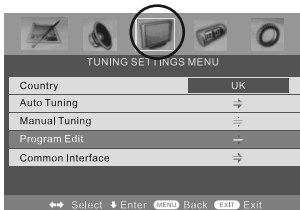

- 4) Press [>] to enter the program edit menu
- 5a) Freeview mode – Press the [Green] button to add the selected channel to your favorite, press it a second time to remove. Press the [Yellow] to delete the channel from the list. **WARNING** – this will remove the channel complete from the TV. Press [Blue] to lock a channel (to do this the Child Lock function must be set “ON”)
- 5b) Analogue TV mode – Press the [>] to select the change you wish to move. Move to the new location and press [OK]



- 6) Press [EXIT] to exit

#### Common Interface Slot (Only in Freeview Mode)

Pay per view services require a “smartcard” to be inserted into the TV. If you subscribe to a pay per view service the provider will issue you with a ‘CAM’ card “smartcard”. The CAM can then be inserted into the COMMON INTERFACE PORT (see page 8). To access the card follow the steps below.

- 1) Press [MENU] to enter menu
- 2) Press [>] to move to Tuning Settings Menu
- 3) Press [V] to highlight Common Interface
- 4) Press [>] to enter the menu



- 5) Press [EXIT] to exit

## TV MENU OPERATION

### TIMER SETTINGS MENU

Lets you adjust the OSD timing and the sleep timer

#### Sleep Timer

Lets you set the sleep timer so the television automatically switches off after a certain amount of time.

- 1) Press [MENU] to enter menu
- 2) Press [>] to move to Timer Settings Menu
- 3) Press [V] to highlight Sleep Timer
- 4) Press [>] to increase the time to the required amount



- 5) Press [EXIT] to exit

#### On Screen Display Timer

Lets you adjust the amount of time the On Screen Menu stays on the screen before disappearing.

- 1) Press [MENU] to enter menu
- 2) Press [>] to move to Timer Settings Menu
- 3) Press [V] to highlight OSD Timer
- 4) Press [>] to increase the time and [<] to reduce the time



- 5) Press [EXIT] to exit

## TV MENU OPERATION

### GENERAL SETTINGS MENU

Lets you adjust the language, picture size, blue screen, add child lock, complete first time installation and reset the television.

#### On Screen Menu Language

Lets you change the on screen menu language.

- 1) Press [MENU] to enter menu
- 2) Press [>] to move to General Settings Menu
- 3) Press [V] to highlight Language
- 4) Press [>] to change the language

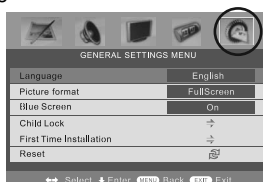

- 5) Press [EXIT] to exit

#### Picture Format

Lets you adjust the picture format

- 1) Press [MENU] to enter menu
- 2) Press [>] to move to General Settings Menu
- 3) Press [V] to highlight Picture Format
- 4) Press [>] to change the picture format

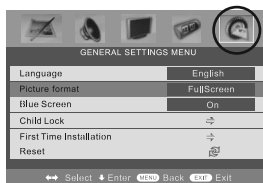

- 5) Press [EXIT] to exit

#### Blue Screen

Changes the background when there is no input between clear and a blue background

- 1) Press [MENU] to enter menu
- 2) Press [>] to move to General Settings Menu
- 3) Press [V] to highlight Blue Screen
- 4) Press [>] to switch between on and off



- 5) Press [EXIT] to exit

#### Child Lock/Key Lock

Allows you to lock certain channels and content so that it can not be viewed by children

- 1) Press [MENU] to enter menu
- 2) Press [>] to move to General Settings Menu

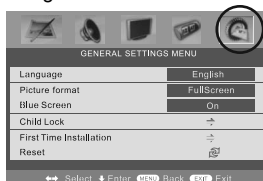

- 3) Press [V] to highlight Child Lock
- 4) To switch on child lock or key lock press [>]



## TV MENU OPERATION

### GENERAL SETTINGS MENU



- 5) To change Pin Code enter menu. Enter the old pin code (Default is blank), then enter the new pin code and enter it again. Press [OK], the pin is now changed

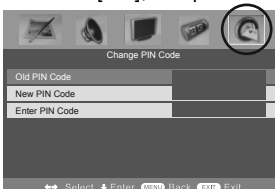

- 6) Press [EXIT] to exit

#### First Time Installation

Allows you to reset the television for first time tuning.

- 1) Press [MENU] to enter menu
- 2) Press [>] to move to General Settings Menu
- 3) Press [V] to highlight First Time Installation
- 4) Press [>] and First time install screen will appear

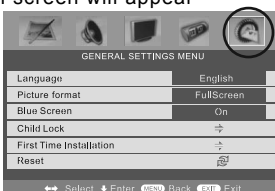

- 5) Press [OK] and tuning will commence.

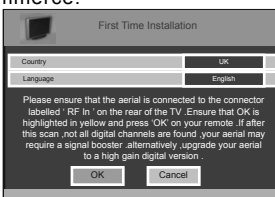

#### Reset Television

You may wish to reset the menus to factory settings e.g. if you have forgotten a changed password

- 1) Press [MENU] to enter menu
- 2) Press [>] to move to General Settings Menu
- 3) Press [V] to highlight Reset
- 4) Press [OK] to reset the television



- 5) Press [EXIT] to exit

## ELECTRONIC PROGRAM GUIDE

### Electronic Program Guide (EPG)

The Electronic Program Guide (EPG) is available in Digital TV mode. It is a 7 day TV guide and provides information about forthcoming programmes (where supported by the broadcasted channel).

You can view the start and end time of all programs and on all channels for the next 7 days.

It is very simple to operate.

1) Press [EPG]. The following menu will appear.

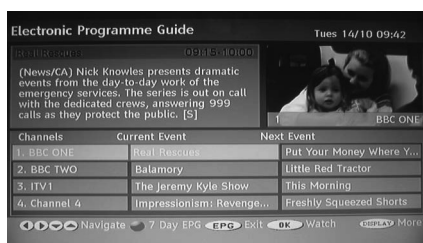

2) Navigate through the now and next menu using the [>], [<], [V] and [^] buttons

3) Press the [BLUE] button to enter the 7 day menu. Reminders can now be added by pressing [OK].



4) Press [EPG] to exit the Electronic Program Guide (EPG).

## DIGITAL TELETEXT

### Digital TV Teletext

With Digital TV (Freeview) there is also digital teletext available on some channels. Simply follow the on screen commands. Here is an example of the BBC digital teletext service.

1) To start digital teletext press RED button.



2) To select the information you require you can scroll using [V] or [^] and press [OK] alternatively you can key the page number for example [3][0][0] followed by [OK]



You can then navigate using the colour buttons (Red, Green, Yellow, Blue), the [V] [^] buttons and numbers.

If you wish to exit at anytime press [TEXT]

## ANALOGUE TV TELETEXT

Teletext is a service offered by some broadcasters.

### Teletext Operation

1) Press [TEXT], after a few seconds teletext page 100 should appear.

Here is an example of BBC1



2) You can now navigate to the page you require in a number of ways:

- Press the page you require using the number buttons i.e. page 302, by pressing [3][0][2]
- Press the colour buttons, these will take you to the page indicated on screen for each colour

3) To exit Teletext press [TEXT] twice at any time

### Other buttons

[SIZE] this increases or decreases the size of the text on screen

[INDEX] some pages are more than one page long this button displays the number of pages

[REVEAL] if there is an answer or something hidden this will display it

[SUBPAGE] displays the sub page if it exists

[HOLD] This stops the pages changing when there are multiple pages

## IPOD OPERATION

### Connect iPod to TV-Dock

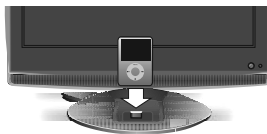

1. Insert your iPod to the TV-dock on the sound base. The TV will detect the insertion of the iPod and automatically switch to iPod mode. You can also manually switch to iPod mode by pressing  button or selecting "iPod" in the source menu.
2. Wait about 3-5 seconds while the screen displays a message "iPod connecting", and then the iPod Menu OSD will appear on the TV screen, and meanwhile the screen of iPod will change to the "OK to Disconnect" picture.

iPod Connecting

IMPORTANT - IF THIS DOESN'T HAPPEN REFER TO PAGE 44

- 3) The below menu will appear (This menu comes from the iPod so it may vary based on your settings on your iPod)

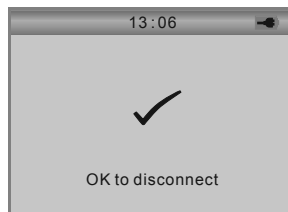
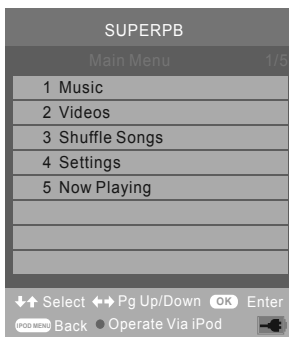

- 4) Press the [RED] button and the menu on the TV will disappear and the iPod Menu will come on



- 5) Using the [^] & [v] you can navigate through the menus and press [OK] to select.



## IPOD OPERATION

### Key Buttons

VOL-	Decrease the volume
VOL+	Increase the volume
BASS-	Decrease the sub bass
BASS+	Increase the sub bass
▶/	Play/pause
▶▶	Next track
◀◀	Back a track
▶▶	Fast forward through current track
◀◀	Rewind through current track
■	Stop



### Recharging for iPod

iPod is automatically recharged when it is inserted to the TV-dock.

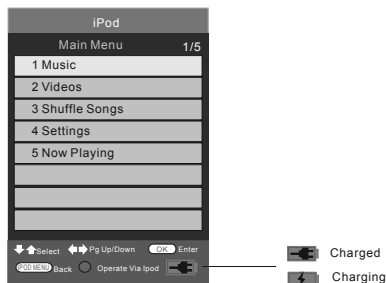

### Operate the iPod via the screen of iPod

Press " " button to switch to the iPod Control Mode. When in iPod control mode, the iPod menu doesn't appear on the TV screen, but the normal picture appears on the screen of iPod. You can operate iPod via the screen of iPod.

#### Note:

- You can directly operate iPod or using remote control.
- TV will display a blue blank screen when in iPod control mode.
- When in iPod control mode, press " " button to switch to TV Control Mode

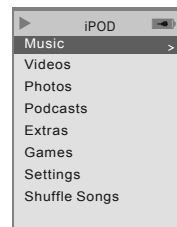

### Set Sleep Timer



The TV won't switch off automatically when the iPod stop playing. However you can set Sleep Timer to turn the TV off after a period of time.

iPod is a trademark of Apple Inc., registered in the U.S. and other countries.

## IPOD OPERATION

### Now Playing Interface

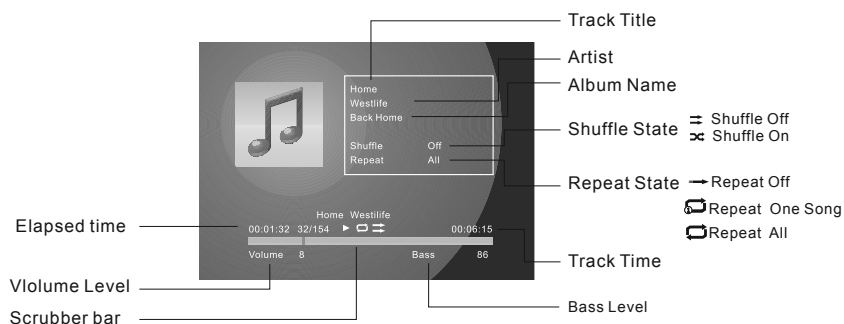

### Shuffle and Repeat Songs

Please note - Both the repeat and shuffle mode will default to the iPod settings on the iPod player

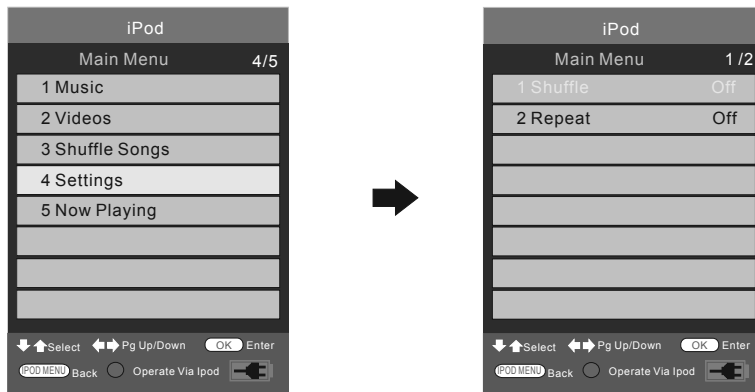

#### Shuffle Off

iPod is set to play in order

#### Shuffle Songs

iPod is set to shuffle all the songs in ipod

#### Shuffle Album

iPod is set to shuffle albums in iPod.

#### Repeat Off

iPod is not set to repeat songs

#### Repeat One

iPod play some song repeatedly

#### Repeat All

iPod repeats songs in current album or list.

iPod is a trademark of Apple Inc., registered in the U.S. and other countries.

## IPOD OPERATION

### Watch Videos from iPod

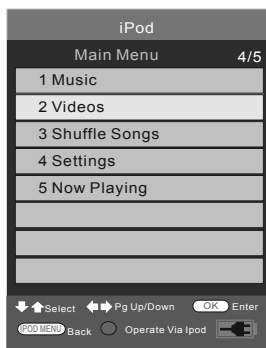

For iPod nano 3Gen, iPod Classic, iPod 5Gen, you can select a video program and play in the iPod Menu OSD.

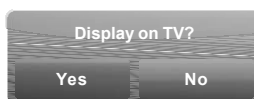

For iPod touch, you can not select videos and play in the iPod Menu OSD, due to the nature of iPod touch. To watch videos, please do as following:

1. Insert the iPod touch to the TV-Dock.
2. Press (Red button) to switch to iPod Control Mode.
3. Tap the screen to select video programs and play.
4. When a dialog pops up and ask: "Display On TV?", Please tap the "Yes".

### Browse Photos from iPod

To browse photos from iPod

1. Press (Red button) to switch to iPod Control Mode
2. For iPod nano 3Gen and iPod Classic, select a photo and press button on the remote control or button on the iPod to start photo slide-show.
3. For iPod photo and iPod 5Gen, you can only press button on the iPod to start photo slide-show.
4. For iPod touch, you can only tap the on the screen to start photo slide-show.

iPod is a trademark of Apple Inc., registered in the U.S. and other countries.



## CONNECTING TO A PC - WINDOWS XP

**IMPORTANT**— Before connecting to a PC you must ensure that the settings of the PC's output are correct for the new LCD Monitor.

You need to do the following with your old monitor connected

- 1) Switch on your PC
- 2) When finished booting up, right click your mouse anywhere on the screen, the below will appear



- 3) left click your mouse on Properties, this screen will appear



- 4) Left click your mouse on Settings, this screen will appear. Check the screen resolution is set to what is show in the technical specifications section. You can adjust the resolution by moving the slider on screen.

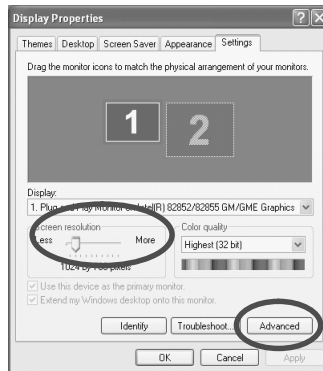

## CONNECTING TO A PC - WINDOWS XP

- 5) Left click your mouse on Advance, this screen will appear, click on tab called 'Monitor'



- 6) Left click on the drop down for Screen refresh rate and select 60 Hertz.  
7) Finally click on Apply, then click Yes and the settings will be saved.  
8) Turn off your PC.  
9) Connect up your LCD TV to your PC and switch on.  
10) Switch on your PC, Windows will automatically Install the LCD TV.

For Windows Vista operating system the process is very similar to the above.  
If you require additional support please contact the helpline.

## PC MENU OPERATION (VGA)

### VGA MENU

#### Auto Configuration of Screen

Lets you automatically configure the television to be used as a computer monitor

- 1) Press [MENU] to enter menu
- 2) Press [>] to select PC settings
- 3) Press [V] to select Auto Sync
- 4) Then press [>] for the TV to automatically configure itself

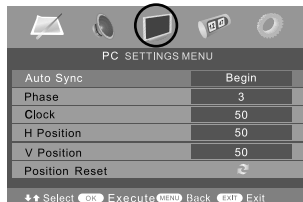

- 5) Press [EXIT] to exit

#### Phase

To adjust delay time of phase in order to reduce the noise of picture

- 1) Press [MENU] to enter menu
- 2) Press [>] to select PC settings
- 3) Press [V] to select Phase
- 4) Then press [>] or [<] to increase or decrease the phase

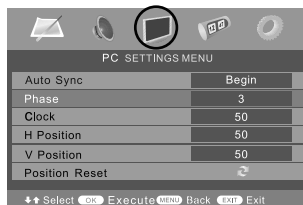

- 5) Press [EXIT] to exit

#### Clock

Alter this in order to reduce the noise within the picture

- 1) Press [MENU] to enter menu
- 2) Press [>] to select PC settings
- 3) Press [V] to select Clock
- 4) Then press [>] or [<] to increase or decrease the clock

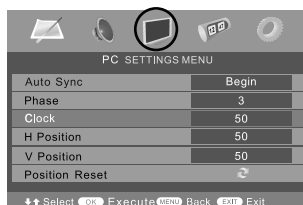

- 5) Press [EXIT] to exit

## PC MENU OPERATION (VGA)

### Horizontal Position

Changes the horizontal position of the picture

- 1) Press [MENU] to enter menu
- 2) Press [>] to select PC settings
- 3) Press [V] to select H-Position
- 4) Then press [>] or [<] to move the picture to left or right



- 5) Press [EXIT] to exit

### Vertical Position

Changes the vertical position of the picture

- 1) Press [MENU] to enter menu
- 2) Press [>] to select PC settings
- 3) Press [V] to select V-Position
- 4) Then press [>] or [<] to move the picture up or down

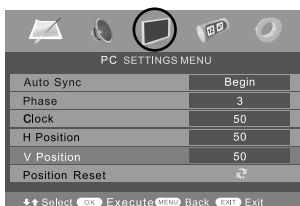

- 5) Press [EXIT] to exit

### Position Reset

To position of the picture to the factory settings

- 1) Press [MENU] to enter menu
- 2) Press [>] to select PC settings
- 3) Press [V] to select Position Reset
- 4) Then press [>] or [<] to move the picture up or down

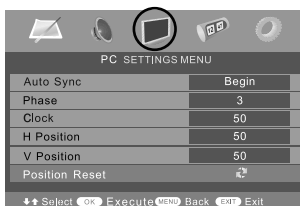

- 5) Press [EXIT] to exit

## DVD MENU OPERATION

### DVD SETTINGS MENU

#### Adjusting Parental Control

You may wish to block certain DVDs being played, for example if you have young children. This can be done via limiting the age rating of the DVD.

- 1) Press [MENU] to enter menu
- 2) Press [>] to move to DVD Setting Menu
- 3) Press [V] to highlight Parental Control



- 4) Press [>] to enter Parental Control

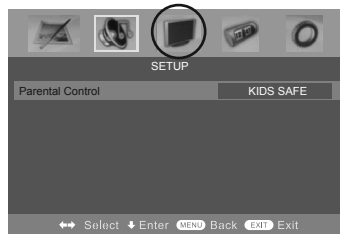

- 5) Press [<] or [>] to change between the different options
- 6) Press [EXIT] to exit

## DVD MENU OPERATION

### Adjusting Language

Lets you adjust the Audio Language, Menu Language, Subtitle Language within DVD mode

- 1) Press [MENU] to enter menu
- 2) Press [>] to move to DVD Setting Menu
- 3) Press [V] to highlight Language



- 4) Press [>] to enter Language



You can now adjust the Audio Language, Menu Language, Subtitle Language within DVD mode

- 5) Press [<] or [>] to change between the different options
- 6) Press [EXIT] to exit

## DVD MENU OPERATION

### Adjusting Audio Set Up

Lets you adjust the Audio Setup within DVD mode

- 1) Press [MENU] to enter menu
- 2) Press [>] to move to DVD Setting Menu
- 3) Press [V] to highlight Audio Setup



- 4) Press [>] to enter Audio Setup



You can now adjust the Audio Output from the Coax connection and the Downmix.

#### Audio Out options:

SPDIF / RAW – Select this option if you are connecting to a Dolby Digital 5.1 surround sounds amplifier via coax cable  
 SPDIF / PCM – Select this option if you are connecting to a Stereo Hi-fi via composite video cable

- 5) Press [<] or [>] to change between the different options
- 6) Press [EXIT] to exit

## DVD MENU OPERATION

### Adjusting Digital Set Up

Lets you adjust the Audio Setup within DVD mode

- 1) Press [MENU] to enter menu
- 2) Press [>] to move to DVD Setting Menu
- 3) Press [V] to highlight Digital Setup

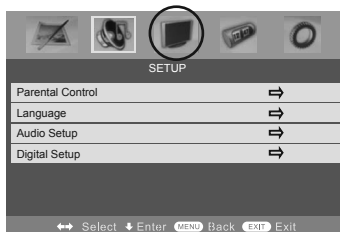

- 4) Press [>] to enter Digital Setup



You can now adjust the Dynamic Range and Balance.

### Dynamic range works only with DVD discs recorded in Dolby digital.

FULL: Set this to listen with the range recorded on the disc.

4/8: Set this to listen with a range equivalent to a normal television.

2/8: Set this to listen with a smaller difference between the maximum and minimum volume.

- 5) Press [<] or [>] to change between the different options
- 6) Press [EXIT] to exit

### Changing Regions

This TV/DVD player is pre-set to play Region 2 DVDs. In the event you wish to use the TV/DVD in another country that uses different region discs, please visit [www.skymediauk.co.uk](http://www.skymediauk.co.uk). Select 'product support', 'DVD region code information'



## CONNECTING A GAMES CONSOLE

The Nintendo Wii, Sony PS1, Sony PS2 and Xbox are supplied with an AV Multi Out plug to AV cable, some versions, depending on model/age are also supplied with SCART to AV adaptor.

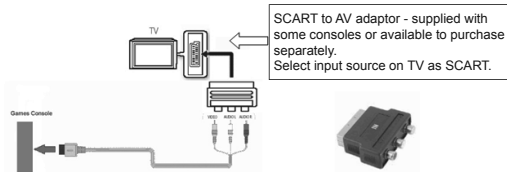

### X-BOX 360

Different models/versions of Xbox 360 come with different types of connecting cables included with the console.

#### Option 1 – With the AV Cable (Yellow, Red & White cables) via Euro/AV Connector (SCART)

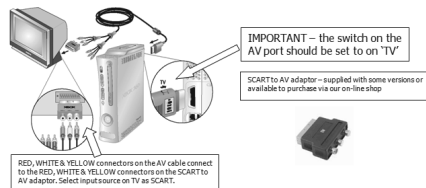

#### Option 2 – With Component/Y Pb Pr Cables (Red, Green, Blue cables for Video/picture) and Audio cables (Red & White cables – for Audio/sound)

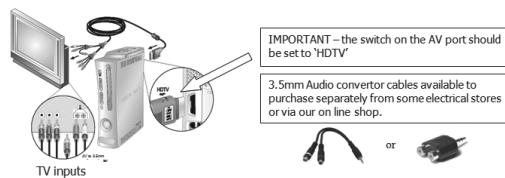

RED, GREEN & BLUE cables connect directly into the RED, GREEN AND BLUE connectors on the TV (where fitted) these provide the video/picture signal to the TV.

RED & WHITE these provide the Sound/Audio. YELLOW is not used when connecting via this method.

#### Option 3 – With the HDMI to HDMI cable

A HDMI cable can output both video and audio and enables you to enjoy digital-quality video and audio with minimal loss of picture quality



## CONNECTING A GAMES CONSOLE

### SONY PS3

Different models/versions of PS3 come with different types of connecting cables included with the console.

The ideal way to connect the PS3 to a TV fitted with a HDMI socket is by using the HDMI connector on the PS3 to the HDMI input on the TV (where fitted). This will give superior sound and picture quality over other connecting methods and is a very quick and simple way to connect the console to the TV.

If your PS3 did not come with HDMI connector or your TV does not have a HDMI socket, please use option 1 below.

#### Option 1 – AV Multi to SCART/AV

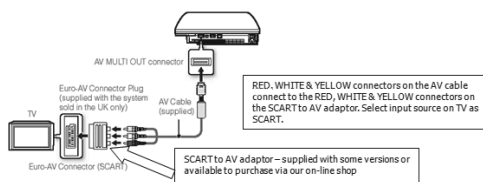

#### Option 2 – With HDMI cable.

A HDMI cable can output both video and audio and enables you to enjoy digital-quality video and audio with minimal loss of picture quality

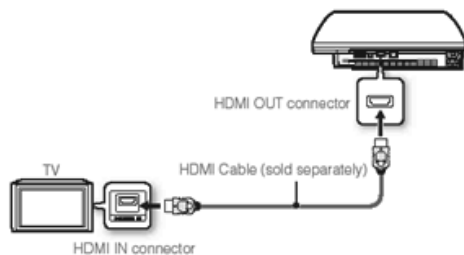

## WALL MOUNTING

**IMPORTANT— BEFORE DRILLING ANY HOLES IN THE WALL ENSURE YOU ARE NOT DRILLING WHERE THERE COULD BE ANY ELECTRIC WIRES, WATER OR GAS PIPES**

THIS TV REQUIRES A VESA 100 WALL MOUNT, OR EQUIVALENT



# 100

To provide improved sound this television has speakers built into the stand of the TV. The stand should therefore not be removed. For best performance the television should be put on a hard flat surface, however if you do wish to wall mount the television this can be done using a full motion wall mount.

### Wall Mounting the TV.

- 1) Remove the four screws highlighted below.
- 2) The wall mount can now be easily attached to the mounting holes on the rear of the TV. These holes are indicated in the picture below



**Important – If wallmounting this TV, only use the screws already provided in the wallmounting holes. Using other screws which are longer could cause irreparable damage to internal part.**

## USING WITH SKY DIGITAL

You may wish to use your TV with Sky Digital.

There are a number of connection options, the best being connecting via SCART cable.

### Connecting via SCART

- 1) Connect the SCART cable from the Sky Digital Box to SCART of the TV
- 2) Press [SOURCE]
- 3) Press [V] or [^] to select SCART
- 4) Press [OK]

The channel your Sky Digital box is displaying will now be shown on the TV.

You may wish to share your Sky Digital signal around the home by using an RF connection. If this TV is to be connected in this way, please follow the below.

### Connecting via RF

Ensure the Sky signal is switched on, before you start the below.

- 1) Connect the RF cable from the RF output socket of the sky/cable box to the 'RF IN' of the TV.
- 2) Switch the TV into analogue TV mode
- 3) Press [MENU] to enter menu.
- 4) Press [>] twice to select Tuning Settings Menu
- 5) Press [V] to select Manual Tuning



- 6) Press [>] to enter Auto tuning
- 7) Press [OK] to start tuning

Once tuning is complete the first channel will appear. Press [CH+] to move through the channel until you find the Sky channel. The channel can be moved to an alternative position if you wish, please refer to the Program Edit section of the manual.

## USING WITH SKY DIGITAL

Manually tune until you locate the Sky channel. If it stops press [>] again and the search will continue. (Often, the frequency required is 847.25 mhz, depending on which model of Sky Set top box)

Once tuned in it will go back to TV

### USING WITH SKY DIGITAL REMOTE CONTROLS (BSKYB) OR UNIVERSAL REMOTE CONTROL

You may wish to use your Sky Digital or a universal remote control to operate some of the functions of this TV. For this you require a 'code' that needs to be programmed into your Sky Digital or universal remote control.

For codes for universal remote controls, please visit our website where you will find the very latest information and codes.

For codes for Sky/Sky+Sky HD, please note that at the point of manufacture, BSkyB have not launched the code required for this model of TV. They are due to launch a new remote control which should include the necessary code to operate the functions of the TV during 2009 (called revision 9). The launch date was not known at the time of printing this manual

Please check our website for updates, alternatively, see below some alternative options of remote controls that are available.



One for All compatible remotes      Sky original remotes

The One for All remote controls shown above will operate all of the functions of the Sky box in the same way the original remote control will, in addition, they will also operate the functions of this model of TV. The One for All versions are available to purchase from the helpline/website. The original Sky remote controls are shown for comparison purposes

If you require any further information, you can contact us:

www.skymediauk.co.uk  
 email - service@skymediauk.co.uk  
 Tel - 0871 2000 463

## CONNECTING TV's WITH IPOD FUNCTION



This TV's with iPod speaker base and iPod function is designed to work with most models of iPods launched into the market.

Below is a list of tested and compatible iPods which will work on this TV. Some functions will operate using the TV's remote control, other functions will operate using the iPod display, depending on the model of iPod. To find out which version of iPod you have, you should check this either on the rear of the iPod, on the packaging for the iPod or on the Apple web site.

For iPhone, the TV functions work best when the iPhone is in 'Flight mode'. This is because the Phone signal reception will interfere with the TV and you will get feedback through the speaker base. The iPhone offers the same functions as per the iPod Touch below.

It is recommended to turn off the Wi-Fi function on any models that feature Wi-Fi as you may also get interference/feedback through the speaker base.

Type	This TV will work operate with the following models											
	iPod											iPod mini
	iPod touch 2nd generation 8GB 16GB 32GB	iPod classic 120GB	iPod touch 1st generation 8GB 16GB 32GB	iPod classic 80GB 160GB	iPod 5th generation (video) 30GB 60GB 80GB	iPod 4th generation (color display) 20GB 30GB 40GB 80GB	iPod 4th generation 20GB 40GB	iPod nano 4th generation (video) 8GB 16GB	iPod nano 3rd generation (video) 4GB 8GB	iPod nano 2nd generation (aluminum) GB 4GB 8GB	iPod nano 1st generation 1GB 2GB 4GB	iPod mini 4GB 8GB
When the iPod is connected to the TV, the TV remote can operate the iPod using the TV screen and can operate these functions												
Playback Music	✓	✓	✓	✓	✓	✓	✓	✓	✓	✓	✓	✓
Playback Video	✓	✓	X	✓	✓	X	X	✓	✓	X	X	X
Video Podcast	✓	✓	X	✓	✓	X	X	✓	✓	X	X	X
Shuffle Play	✓	✓	✓	✓	✓	✓	✓	✓	✓	✓	✓	✓
Photo Slide Show	X	X	X	X	X	X	X	X	X	X	X	X
When the iPod is connected to the TV, the TV remote can operate the iPod using the iPod screen and can operate these functions												
Playback Music	✓	✓	✓	✓	✓	✓	✓	✓	✓	✓	✓	✓
Playback Video	✓	✓	✓	✓	✓	X	X	✓	✓	X	X	X
Video Podcast	✓	✓	✓	✓	✓	X	X	✓	✓	X	X	X
Shuffle Play	X	X	X	X	X	X	X	X	X	X	X	X
Photo Slide Show	✓	✓	✓	✓	✓	✓	✓	✓	✓	X	X	X

Unsure which model/generation of iPod you have? Please call the helpline on 0871 2000 463. (Please have your iPod to hand when calling)  
Mon - Fri 8.30am - 6pm, Saturday 9am - 5pm, Bank Holidays 10am - 5pm. (Except Christmas day)

**In the event that the TV continues to show the 'ipod connecting' screen, this is because your iPod does not feature the latest firmware as released by Apple. In this instance, you need to update your iPod using the Apple software, Apple recommend you do this every few months as they release new firmware to fix any bugs found in previous versions.**

**In order to update your ipod to the correct version approved by apple, please follow the instruction below.**

1. Connect your computer to the Internet (if you have broadband, it's probably already connected).
2. Connect your iPod to your computer.
3. Go to **Start | All Programs | iPod | iPod Updater 20xx-xx-xx** (it'll have the date Apple released it in the title).
4. Run **iPod Updater**.

If you try to update your iPod's firmware and get an error message, its probable that you need to install the latest Apple updater / iTunes software. Visit the Apple website at [www.apple.com/ipod/download](http://www.apple.com/ipod/download)

### Helpline information:

Telephone 0871 2000 463 (Monday – Friday 8.30am – 6pm, Saturday 9am – 5pm)

Email: [service@skymediauk.co.uk](mailto:service@skymediauk.co.uk)

Visit our web site at [www.skymediauk.co.uk](http://www.skymediauk.co.uk)

**IMPORTANT INFORMATION. AS THE SOUND SYSTEM IS BUILT INTO THE STANDBASE, YOU CANNOT REMOVE THE STAND IN THE EVENT THAT YOU WISH TO WALL MOUNT THE TV. IF WALL MOUNTING IS PREFERRED, YOU WILL NEED TO USE A 'CANTILEVER' TYPE WALL MOUNT THAT BRINGS THE TV AWAY FROM THE WALL TO ALLOW SPACE FOR THE STAND BASE.**

## FREQUENTLY ASKED QUESTIONS

Question:	Solution:
I have tuned in Digital TV but I am not receiving any or all of the channels and/or the channels I receive are breaking up	<ol style="list-style-type: none"> <li>1) Check you are in an area that can receive Freeview. Visit <a href="http://www.freeview.co.uk">www.freeview.co.uk</a> or call 08701 111 270.</li> <li>2) Check you have a suitable aerial. Many indoor aerials will say they are digital ready, but you will not get a good signal</li> <li>3) Consider purchasing a signal booster, it is much cheaper than a digital aerial and cures 70% of poor signal problems.</li> <li>4) Failing the above for now use the analogue TV, until the signal becomes stronger in your area.</li> </ol> <p>For best performance we recommend using an outdoor hi-gain digital aerial. If you are receiving some digital stations first try to connect a signal booster in between the TV and TV aerial socket</p>
The sound quality is high pitched?	Go into the sound settings menu as shown earlier in the manual and increase the level of the bass and decrease the treble
I have inserted a disc but it is not playing	<ol style="list-style-type: none"> <li>1) Ensure you have inserted put the disc in facing the correct way forward</li> <li>2) Ensure the disc is clean and is not scratched</li> <li>3) Some copied discs will not play.</li> <li>4) Check the DVD is a region 2 disc – to change the region of the DVD player, refer to section 'Changing Regions'.</li> </ol>
The subtitles are switched on when I am watching a DVD	Each time you press [Subtitles] button you switch between the different languages. Off is one of the options. If you still have subtitle on, access through the DVD disc menu and switch off
I have connected the TV to my VCR via SCART but it is not recording	In addition to connecting via SCART, you should connect the aerial cable from the wall socket to VCR and another aerial cable from the VCR to the TV

If you are still experiencing problems please contact the Helpline  
 Customer Support/Technical Helpline  
 Sky Media UK LTD  
 Telephone: 0871 2000 463  
 Email: [service@skymediauk.co.uk](mailto:service@skymediauk.co.uk)  
 Visit our web site [www.skymediauk.co.uk](http://www.skymediauk.co.uk) for further Trouble shooting  
 and frequently asked questions.

## TECHNICAL SPECIFICATION

Model Name		19" IP D D TV
Panel	Panel Type	LCD Panel
	Size	19 inch/48cm
	Screen Format	16:10
	Resolution	1440 x 900
Systems	TV System	Analogue:BG, DK, I, L/L' Digital: DVB-T
	Colour/Video System	Analogue: PAL, SECAM, NTSC 3.58/4.43(Only video in) Digital: MPEG-2 MP@ML
	Reception Range	Analogue: VHF: E2-E12/UHF: E21-E69/CATV: S1-S20/HYPER: S21-S41 D/K: R1-R12, R21-R69/L: F2-F10, B-Q, F21-F6 9/I: UHF B21-B69 Digital: VHF/UHF
	Sound Output	L/R Satellite Speaker: 4W+4W , Subwoofer: 8W
Input/ Output Jacks	RF Input	75 ohm external terminal for VHD/UHF
	HDMI Input	Video: 480i, 480p, 576i, 576p, 720i, 720p, 1080i Audio: Two channel linear PCM 32, 44.1 and 48kHz, 16, 20 and 24 bits
	PC-RGB Input	D-sub 15pin G: 0.7Vp-p, 75ohms, non Sync on Green B: 0.7Vp-p, 75ohms R: 0.7Vp-p, 75ohms
	SCART	Full SCART
	Composite Video Input	1.0 Vp-p, RAC
	Component/YPbPr Input	RAC. Y: 1.0 Vp-p, 75ohms, 0.3V negative sync, Pb/Cb: 0.7Vp-p, 75ohms, Pr/Cr: 0.7Vp-p, 75ohms.
	Sound Input	Phono jack 1: For CVBS/Component Audio input Phono jack 2: For PC-RGB Audio input 500mV rms, Impedance: 47k ohms
	SPDIF Output	PCM/RAW
	CI Slot	PCMCIA CAM SLOT
	DVD	Region Code
Disc Size		12cm disc only
Compatible Disc Type		DVD, VCD, SVCD, CD, HDCD, MP3, JPEG, CD-R/RW, DVD±R/RW
Power	Power Requirement	AC 110-240V, 50/60Hz
	Input Power Consumption	75W max
	iPod Recharge Current	500mA
	Standby Power	1W
Others	Dimension(with stand)	480mm (W) x 440mm (H) x 225mm (D)
	Mass	5.3Kgs
	Supplied Accessories	Refer to page 8



## INDEX

Analogue TV teletext	26	On Screen Display Language	22
Audio Set Up	37	On Screen Display Timer	21
Auto Tuning	19	Parental Control	35
Balance	18	PC Menu Settings	33 - 34
Bass	18	Photos from iPod	30
Blue Screen	22	Picture Format	22
Brightness	14	Picture Mode Presets	13
Changing Regions	38	PlayStation 3	40
Child Lock / Key Lock	22	Program Edit / Channel Position	20
Colour Settings	14	Remote control buttons and their functions	10
Colour Temperature	16	Reset Television	23
Common Interface Slot	20	Sharpness	15
Connect iPod to TV-Dock	27	Shuffle & Repeat Songs	29
Connecting to a PC	31 - 32	Sky Digital	42 - 43
Connecting TVs with iPod Function	44	Sleep Timer	21
Contrast	13	Sound Mode Presets	17
Country	19	Source	12
Digital Set Up	38	Technical Specifications	46
Digital Switchover information	2 - 3	The TV menu	13
Digital TV teletext	25	Timer Settings Menu	21
Dynamic Noise Reduction	16	Tint	15
Electronic Program Guide	24	Treble	18
First Time Installation	23	TV buttons and their functions	11
Frequently Asked Questions	45	Videos from iPod	30
Guarantee Information	1	Volume	17
Index	47	Volume Boost	18
Initial Set Up	9	Wall Mounting	41
Inputs and Connections	12	Warnings	4 - 5
Language	36	What is included in the box	8
Manual Tuning	19	Xbox 360	39
Nintendo Wii, PS1, PS2 & Xbox	39		





# TECHNIKA ADVANCED

Tesco Stores Ltd, Delamare Road, Cheshunt, Herts, EN8 9SL

## Free Manuals Download Website

<http://myh66.com>

<http://usermanuals.us>

<http://www.somanuals.com>

<http://www.4manuals.cc>

<http://www.manual-lib.com>

<http://www.404manual.com>

<http://www.luxmanual.com>

<http://aubethermostatmanual.com>

Golf course search by state

<http://golfingnear.com>

Email search by domain

<http://emailbydomain.com>

Auto manuals search

<http://auto.somanuals.com>

TV manuals search

<http://tv.somanuals.com>