

vtech[®]

User's Manual

Bouncing Colors Turtle™



© 2009 VTech
Printed in China
91-002389-000-000

Dear Parent,

Ever notice the look on your baby's face when they learn something new through their own discovery? These self-accomplished moments are a parent's greatest reward. To help fulfill them, VTech® created the **Jungle Gym**® series of toys.

These unique interactive learning toys directly respond to what children do naturally – play! Using innovative technology, these toys react to baby's interactions, making each play experience fun and unique as they learn age-appropriate concepts like first words, numbers, shapes, colors and music. More importantly, VTech®'s **Jungle Gym**® toys develop baby's mental and physical abilities by inspiring, engaging and teaching.

At VTech®, we know that a child has the ability to do great things. That's why all of our electronic learning products are uniquely designed to develop a child's mind and allow them to learn to the best of their ability. We thank you for trusting VTech® with the important job of helping your child learn and grow!

Sincerely,

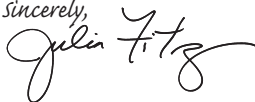

Julia Fitzgerald
Vice President, Marketing
Vtech Electronics, NA

To learn more about the **Jungle Gym**® series and other VTech® toys, visit www.vtechkids.com

INTRODUCTION

Thank you for purchasing the **VTech® Bouncing Colors Turtle™!**

Children will enjoy the **VTech® Bouncing Colors Turtle™** because the more they bounce, the more they'll learn! This active play toy teaches colors and shapes through encouraging phrases, fun sounds and playful melodies. Bouncing develops gross motor skills and balance, while pressing the buttons and spinning the beads strengthen fine motor skills. The fun is always bounciful with this adorable turtle!

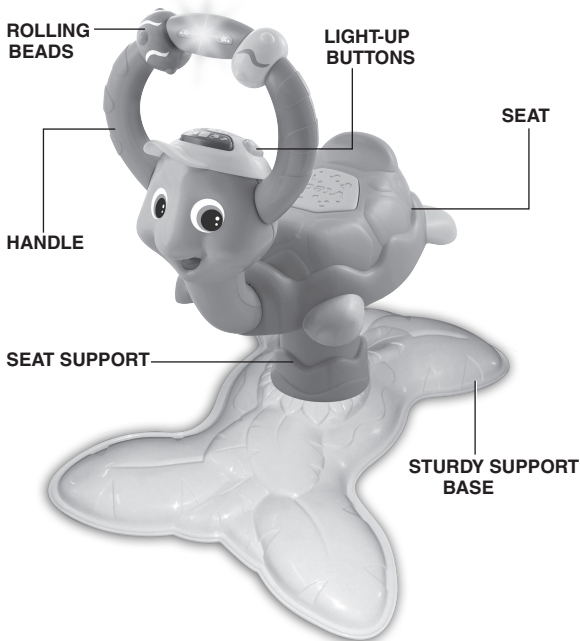

INCLUDED IN THIS PACKAGE

One VTech® Bouncing Colors Turtle™

One electronic turtle head

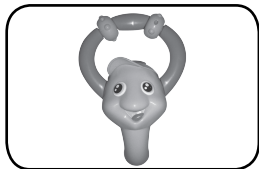

One turtle shell seat



One seat support

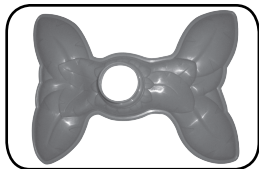

One sturdy support base



One instruction manual

WARNING: All packing materials, such as tape, plastic sheets, wire ties and tags are not part of this toy, and should be discarded for your child's safety.

Included in This Package

GETTING STARTED

BATTERY INSTALLATION

1. Make sure the unit is turned **OFF**.
2. Locate the battery cover on the back of the turtle's head. Use a coin or a screwdriver to loosen the screw.
3. Install 2 new 'AA' (UM-3/LR6) batteries following the diagram inside the battery box. (The use of new alkaline batteries is recommended for maximum performance.)
4. Replace the battery cover and tighten the screw to secure.

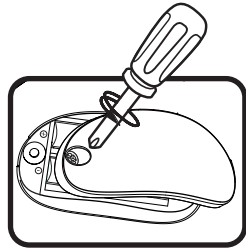

BATTERY NOTICE

- Install batteries correctly observing the polarity (+, -) signs to avoid leakage.
- Do not mix old and new batteries.
- Do not mix batteries of different types: alkaline, standard (carbon-zinc) or rechargeable (nickel-cadmium).
- Remove the batteries from the equipment when the unit will not be used for an extended period of time
- Always remove exhausted batteries from the equipment.
- Do not dispose of batteries in fire.
- Do not attempt to recharge ordinary batteries.
- The supply terminals are not to be short-circuited.
- Only batteries of the same and equivalent type as recommended are to be used.

WE DO NOT RECOMMEND THE USE OF RECHARGEABLE BATTERIES.

With the **VTech® Bouncing Colors Turtle™** safety comes first. To ensure your child's safety, please only assemble this product by an adult.

PRODUCT ASSEMBLY

1. Insert the seat support into the bottom of the turtle shell seat. You will hear a loud 'click' sound, which indicates that the seat support is securely fixed into the seat.

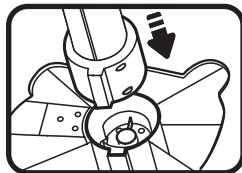

2. Insert the other side of seat support into the recessed slot of the support base. Again, once the seat support is securely in place, you should hear a loud 'click.'

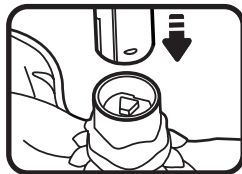

3. Insert the electronic turtle head into the corresponding slot of the turtle shell seat. Once the electronic head is securely in place, you should hear a loud 'click.'

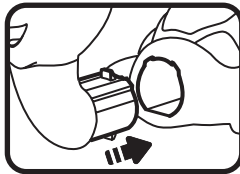



Once the main unit has been assembled, it cannot be disassembled.

**ATTENTION: The maximum weight limit for this product is 42 pounds.
It is not recommended for children older than 36 months.**

PRODUCT FEATURES

1. ON/OFF/MODE SELECTOR SWITCH

To turn the unit **ON**, slide the **ON/OFF/MODE SELECTOR SWITCH** to the **LEARNING MODE** (📖) or the **MUSIC MODE** (🎵) position. To turn the unit **OFF**, slide the **ON/OFF/MODE SELECTOR SWITCH** to the **OFF** (●) position.

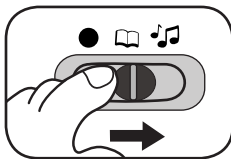

2. AUTOMATIC SHUT-OFF

To preserve battery life, the **VTech® Bouncing Colors Turtle™** will automatically power-down after approximately 20 seconds in Learning Mode or 30 seconds in Music Mode without input. The unit can be turned on again by pressing any button.

ACTIVITIES

1. Slide the **ON/OFF/MODE SELECTOR SWITCH** to turn the unit **ON**. You will hear fun sounds, a song and a phrase. The lights will flash with the sounds.

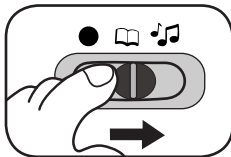



2. Press the **LIGHT-UP BUTTONS** to hear fun sounds, melodies, and phrases. In Learning Mode, pressing the buttons will teach colors and shapes. In Music Mode, pressing buttons will play melodies and fun sounds. When melodies are playing, pressing buttons will add fun sounds and phrases over the music. The lights will flash with the sounds.

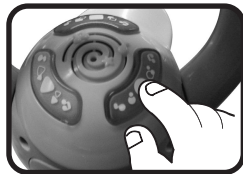

3. Spin the **ROLLING BEADS** to hear funny sounds, melodies and phrases. In Learning Mode, spinning the beads will teach colors. In Music Mode, spinning the beads will activate short tunes and sound effects. The lights will flash with the sounds.

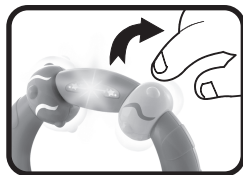

4. Bounce on the **TURTLE SHELL SEAT** to activate games and music. In Learning Mode, you'll be asked to bounce on the seat to find a shape. Keep bouncing until the correct shape button lights up. In Music Mode, bouncing on the seat activates melodies, and songs. Bounce on the turtle seat when a melody is playing to hear fun sounds play over the melody. The lights will flash with the sounds.

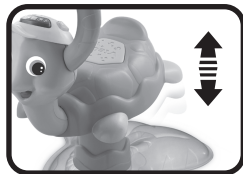



5. If there is no input for approximately 10 seconds, you will hear a song, a phrase, a fun sound or a question. If there continues to be no input after another 10 seconds, you will hear "See you later" and the unit will power down. The unit can be turned on again by pressing any button or rolling the beads.

MELODY LIST:

1. Humpty Dumpty
2. Bingo
3. Pop! Goes the Weasel
4. Hey, Diddle Diddle
5. The Entertainer
6. Sailing, Sailing
7. Polly Wolly Doodle

SUNG SONG 1 LYRICS

Colors paint the world,
Shapes are all around.
Come, let's bounce and play
Bouncing every day!

SUNG SONG 2 LYRICS

Let's bounce, then we'll sing a song.
Bouncing, singing all day long!



CARE & MAINTENANCE

1. Keep the unit clean by wiping it with a slightly damp cloth.
2. Keep the unit out of direct sunlight and away from any direct heat source.
3. Remove the batteries when the unit will not be in use for an extended period of time.
4. Do not drop the unit on hard surfaces and do not expose the unit to moisture or water.

TROUBLESHOOTING

If for some reason the program/activity stops working, please follow these steps:

1. Please turn the unit **OFF**.
2. Interrupt the power supply by removing the batteries.
3. Let the unit stand for a few minutes, then replace the batteries.
4. Turn the unit **ON**. The unit should now be ready to play again.
5. If the product still does not work, replace with an entire set of new batteries.

If the problem persists, please call our Consumer Services Department at 1-800-521-2010 in the U.S. or 1-877-352-8697 in Canada, and a service representative will be happy to help you.

For information on this product's warranty, please call our Consumer Services Department at 1-800-521-2010 in the U.S. or 1-877-352-8697 in Canada.





IMPORTANT NOTE:

Creating and developing **Active Play** products is accompanied by a responsibility that we at **VTech®** take very seriously. We make every effort to ensure the accuracy of the information, which forms the value of our products. However, errors sometimes can occur. It is important for you to know that we stand behind our products and encourage you to call our Consumer Services Department at 1-800-521-2010 in the U.S., or 1-877-352-8697 in Canada, with any problems and/or suggestions that you might have. A service representative will be happy to help you.

Note:

This equipment has been tested and found to comply with the limits for a Class B digital device, pursuant to Part 15 of the FCC Rules. These limits are designed to provide reasonable protection against harmful interference in a residential installation. This equipment generates, uses and can radiate radio frequency energy and, if not installed and used in accordance with the instructions, may cause harmful interference to radio communications. However, there is no guarantee that interference will not occur in a particular installation. If this equipment does cause harmful interference to radio or television reception, which can be determined by turning the equipment off and on, the user is encouraged to try to correct the interference by one or more of the following measures:

- 
- Reorient or relocate the receiving antenna
 - Increase the separation between the equipment and receiver
 - Connect the equipment into an outlet on a circuit different from that to which the receiver is connected
 - Consult the dealer or an experienced radio/TV technician for help

THIS DEVICE COMPLIES WITH PART 15 OF THE FCC RULES. OPERATION IS SUBJECT TO THE FOLLOWING TWO CONDITIONS: (1) THIS DEVICE MAY NOT CAUSE HARMFUL INTERFERENCE, AND (2) THIS DEVICE MUST ACCEPT ANY INTERFERENCE RECEIVED, INCLUDING INTERFERENCE THAT MAY CAUSE UNDESIRE OPERATION.

THIS CLASS B DIGITAL APPARATUS COMPLIES WITH CANADIAN ICES-003.

CET APPAREIL NUMÉRIQUE DE LA CLASSE B EST CONFORME À LA NORME NMB-003 DU CANADA.

Caution: Changes or modifications not expressly approved by the party responsible for compliance could void the user's authority to operate the equipment.

Free Manuals Download Website

<http://myh66.com>

<http://usermanuals.us>

<http://www.somanuals.com>

<http://www.4manuals.cc>

<http://www.manual-lib.com>

<http://www.404manual.com>

<http://www.luxmanual.com>

<http://aubethermostatmanual.com>

Golf course search by state

<http://golfingnear.com>

Email search by domain

<http://emailbydomain.com>

Auto manuals search

<http://auto.somanuals.com>

TV manuals search

<http://tv.somanuals.com>