

vtech®

User's Manual

SWITCH & GO DINOS®

BLISTER THE VELOCIRAPTOR™

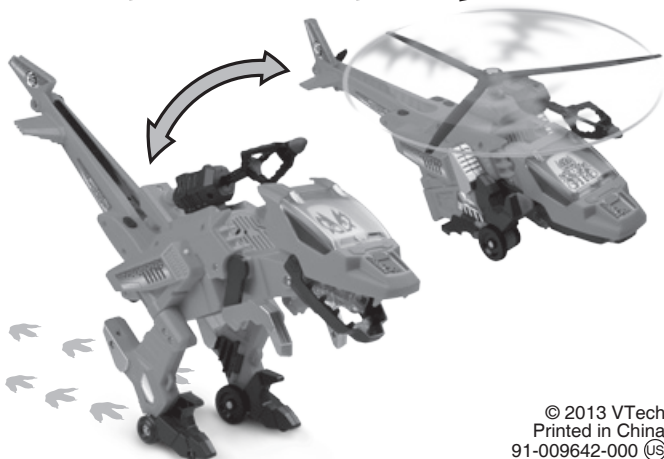

© 2013 VTech
Printed in China
91-009642-000 (US)

Download from www.Somanuals.com. All Manuals Search And Download.



Hi Friend,

You're about to embark on a "dino-mite" adventure with me, **Blister the Velociraptor™**! Just so you know, I've been specially created just for you and am part of the **VTech® Switch & Go Dinos®** crew! **Switch & Go Dinos®** are a special breed of dinosaurs that transform from vehicle to dino in a few easy steps. You're going to love playing with me!

Not only can you help me do some wicked transformations, but you can help me do other cool things, too! Try pushing me on the ground or pressing a button and you'll hear me make awesome sounds! Press another button to hear me talk, and I'll tell you all about my wild life as a dinosaur! Maybe you'll even learn a thing or two.

For more fun, be sure to check out the rest of the **Switch & Go Dinos®** crew (each sold separately)! And remember, with me you're in for some dino switchin', high-flying fun!

Your pal,

Blister the Velociraptor™

INTRODUCTION

My name is **Blister the Velociraptor™**, and I'm looking for a few good dinos to join my squad. But let me warn you – you've got to be at your best to keep up with me! I'm fast and ferocious with sharp, curved claws that make me as tough as any dino.

I make a pretty tough helicopter too! I patrol the skies with my searchlight shining down from above. Once I've got a target in my sights, there's nowhere for it to hide!

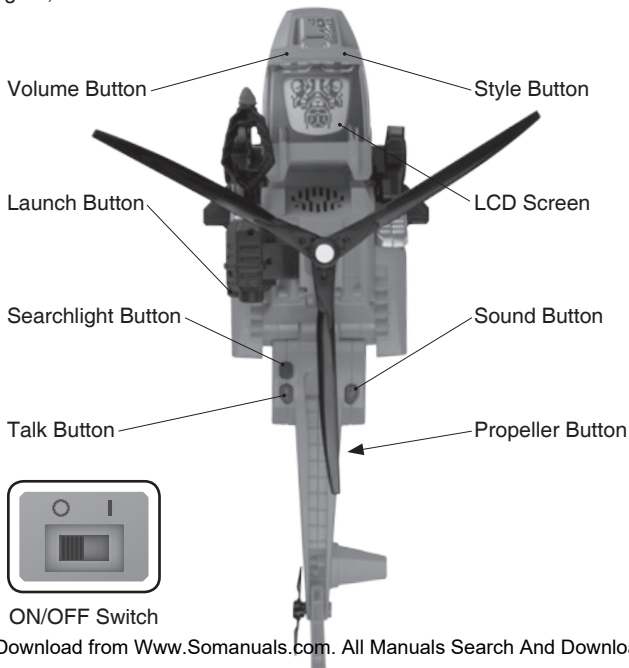

INCLUDED IN THIS PACKAGE

- One VTech® SWITCH & GO DINOS®: Blister the Velociraptor™
- One user's manual

WARNING:

All packing materials, such as tape, plastic sheets, packaging locks and tags are not part of this toy, and should be discarded for your child's safety.

ATTENTION:

Pour la sécurité de votre enfant, débarrassez-vous de tous les produits d'emballage tels que rubans adhésifs, feuilles de plastique, attaches et étiquettes. Ils ne font pas partie du jouet.

NOTE:

Please keep the user's manual as it contains important information.

GETTING STARTED

BATTERY INSTALLATION

1. Make sure the unit is turned **OFF**.
2. Locate the battery cover on the bottom of the unit. Use a screwdriver to loosen the screw.
3. Install 2 new "AA" (LR6/AM-3) batteries into the main unit following the diagram inside the battery box. (The use of new, alkaline batteries is recommended for maximum performance.)
4. Replace the battery cover and tighten the screw to secure.

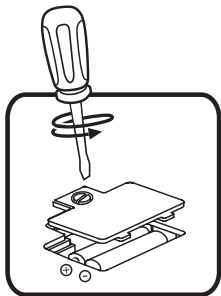

BATTERY NOTICE

- Use new alkaline batteries for maximum performance.
- Use only batteries of the same or equivalent type as recommended.
- Do not mix different types of batteries: alkaline, standard (carbon-zinc) or rechargeable (Ni-Cd, Ni-MH), or new and used batteries.
- Do not use damaged batteries.
- Insert batteries with the correct polarity.
- Do not short-circuit the battery terminals.
- Remove exhausted batteries from the toy.
- Remove batteries during long periods of non-use.
- Do not dispose of batteries in fire.
- Do not charge non-rechargeable batteries.
- Remove rechargeable batteries from the toy before charging (if removable).
- Rechargeable batteries are only to be charged under adult supervision.

PRODUCT FEATURES

1. TURNING THE UNIT ON

Slide the **ON/OFF** Switch to **ON** to turn the unit **ON**.



2. STYLE BUTTON

Press the **Style Button** to choose a pilot or change the dino eyes.



3. VOLUME BUTTON

Press the **Volume Button** to adjust the volume.

There are four levels available: low, medium, high, and mute.



4. TALK BUTTON

Press the **Talk Button** to hear the dino or pilot talk.

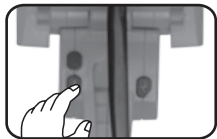

5. SOUND BUTTON

Press the **Sound Button** to hear cool sound effects.

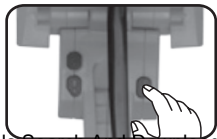

6. SEARCHLIGHT BUTTON

Press the **Searchlight Button** to turn on the searchlight.

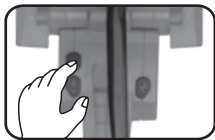

7. LAUNCH BUTTON

Press the **Launch Button** to launch the rocket.



8. PROPELLER BUTTON

Press the **Propeller Button** to spin the propeller.



9. MOTION SENSOR

Move the helicopter through the air to hear fun flying sounds!

10. TURNING THE UNIT OFF/ AUTOMATIC SHUT-OFF

Slide the **ON/OFF** switch to **OFF** or hold the **Talk Button** for a few seconds to turn the unit **OFF**.

To preserve battery life, the unit will automatically power-off after several minutes without input.

HOW TO SWITCH THE HELICOPTER TO A DINO

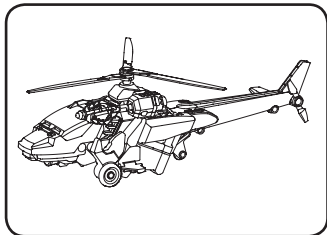

1. Helicopter shape.

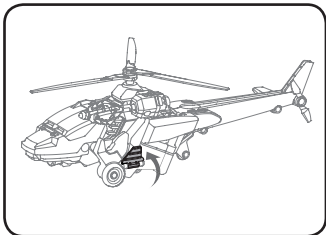

2. Fold the wings up.

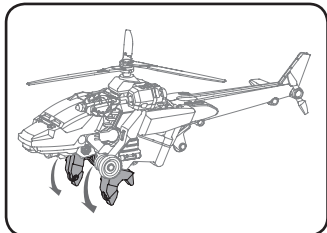

3. Turn the feet down.

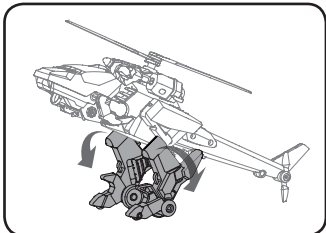

4. Flip the legs down.

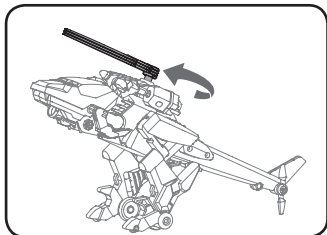

5. Fold up the propeller and turn it forward so that it's facing towards the dino's head.

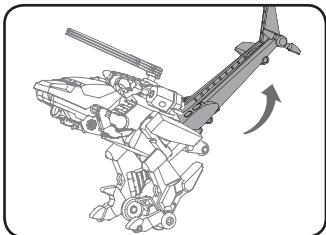

6. Lift the tail up as far as it will go.

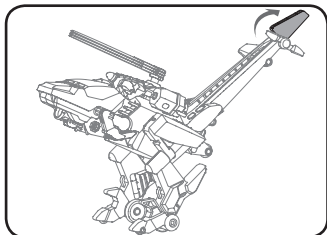

7. Turn the rear wing at the end of the tail back.

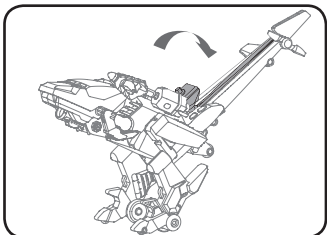

8. Flip the propeller down so that it rests within the tail.

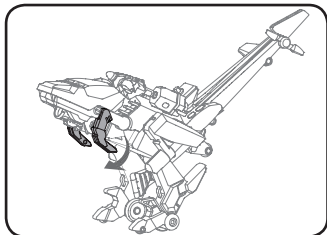

9. Unfold the arms.

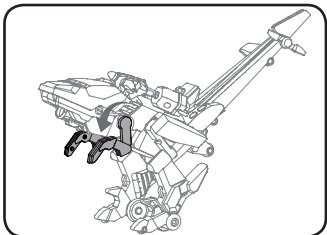

10. Move the arms down.

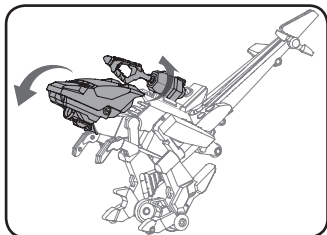

11. Move the head down and the rocket launcher up.

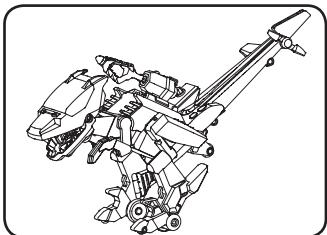

12. Dinosaur shape.

Note: To change the dino back into a helicopter, reverse the order of the steps above.

Download from www.Somanuals.com. All Manuals Search And Download.

CARE & MAINTENANCE

1. Keep the unit clean by wiping it with a slightly damp cloth.
2. Keep the unit out of direct sunlight and away from any direct heat source.
3. Remove the batteries when the unit is not in use for an extended period of time.
4. Do not drop the unit on hard surfaces and do not expose the unit to moisture or water.

TROUBLESHOOTING

If for some reason the unit stops working or malfunctions, please follow these steps:

1. Please turn the unit **OFF**.
2. Interrupt the power supply by removing the batteries.
3. Let the unit stand for a few minutes, then replace the batteries.
4. Turn the unit **ON**. The unit should now be ready to play again.
5. If the product still does not work, replace with a new set of batteries.

If the problem persists, please call our Consumer Services Department at 1-800-521-2010 in the U.S. or 1-877-352-8697 in Canada, and a service representative will be happy to help you.

NOTE:

This equipment has been tested and found to comply with the limits for a Class B digital device, pursuant to Part 15 of the FCC Rules. These limits are designed to provide reasonable protection against harmful interference in a residential installation. This equipment generates, uses and can radiate radio frequency energy and, if not installed and used in accordance with the instructions, may cause harmful interference to radio communications. However, there is no guarantee that interference will not occur in a particular installation. If this equipment does cause harmful interference to radio or television reception, which can be determined by turning the equipment off and on, the user is encouraged to try to correct the interference by one or more of the following measures:

- Reorient or relocate the receiving antenna
- Increase the separation between the equipment and receiver
- Connect the equipment into an outlet on a circuit different from that to which the receiver is connected
- Consult the dealer or an experienced radio/TV technician for help

Caution: changes or modifications not expressly approved by the party responsible for compliance could void the user's authority to operate the equipment.

THIS DEVICE COMPLIES WITH PART 15 OF THE FCC RULES. OPERATION IS SUBJECT TO THE FOLLOWING TWO CONDITIONS: (1) THIS DEVICE MAY NOT CAUSE HARMFUL INTERFERENCE, AND (2) THIS DEVICE MUST ACCEPT ANY INTERFERENCE RECEIVED, INCLUDING INTERFERENCE THAT MAY CAUSE UNDESIRE OPERATION.

THIS CLASS B DIGITAL APPARATUS COMPLIES WITH CANADIAN ICES-003.

CET APPAREIL NUMÉRIQUE DE LA CLASSE B EST CONFORME À LA NORME NMB-003 DU CANADA.



**CLASS 1
LED PRODUCT**

Free Manuals Download Website

<http://myh66.com>

<http://usermanuals.us>

<http://www.somanuals.com>

<http://www.4manuals.cc>

<http://www.manual-lib.com>

<http://www.404manual.com>

<http://www.luxmanual.com>

<http://aubethermostatmanual.com>

Golf course search by state

<http://golfingnear.com>

Email search by domain

<http://emailbydomain.com>

Auto manuals search

<http://auto.somanuals.com>

TV manuals search

<http://tv.somanuals.com>