

vtech[®]

User's Manual

Dance & Discover Jam Band™



© 2014 VTech

Printed in China

91-002948-000 US

Dear Parent,

*Ever notice the look on your baby's face when they learn something new through their own discovery? These self-accomplished moments are a parent's greatest reward. To help fulfill them, VTech® created the **Infant Learning**® series of toys.*

*These unique interactive learning toys directly respond to what children do naturally – play! Using innovative technology, these toys react to baby's interactions, making each play experience fun and unique as they learn age-appropriate concepts like first words, numbers, shapes, colors and music. More importantly, VTech®'s **Infant Learning**® toys develop baby's mental and physical abilities by inspiring, engaging and teaching.*

At VTech®, we know that a child has the ability to do great things. That's why all of our electronic learning products are uniquely designed to develop a child's mind and allow them to learn to the best of their ability. We thank you for trusting VTech® with the important job of helping your child learn and grow!

Sincerely,

Your friends at VTech®

To learn more about VTech® toys, visit www.vtechkids.com

INTRODUCTION

Thank you for purchasing the **VTech® Dance & Discover Jam Band™** learning toy!

Join the monkey's band with the **Dance & Discover Jam Band™** by **VTech®**. This all-in-one band includes a guitar, drum, keyboard and microphone so your child can play, sing and learn. Little hands can grab the microphone and sing along with the music. The playful monkey will dance when guitar is moved.

**ON/OFF/MODE
SELECTOR SWITCH**

DANCING MONKEY

**GUITAR
JOYSTICK**

MICROPHONE

**DRUM
BUTTON**

**FLASHING
LIGHTS**

5 PIANO KEYS

**VOLUME CONTROL
SWITCH**

INCLUDED IN THIS PACKAGE

- One VTech® Dance & Discover Jam Band™ learning toy
- One user's manual

WARNING: All packing materials, such as tape, plastic sheets, packaging locks and tags are not part of this toy, and should be discarded for your child's safety.

ATTENTION: Pour la sécurité de votre enfant, débarrassez-vous de tous les produits d'emballage tels que rubans adhésifs, feuilles de plastique, attaches et étiquettes. Ils ne font pas partie du jouet.

NOTE: Please keep user's manual as it contains important information.

WARNING: Please cut and discard the cords that attach the microphone to the main unit before playing. The cords are not part of this toy and should be discarded for your child's safety.



Unlock the packaging locks:

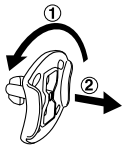

- ① Rotate the packaging locks 90 degrees counter-clockwise.
- ② Pull out the packaging locks.

GETTING STARTED

BATTERY INSTALLATION

1. Make sure the unit is turned **OFF**.
2. Locate the battery cover on the bottom of the unit. Use a screwdriver to loosen

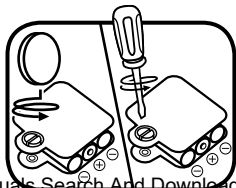

Download from www.Somanuals.com. All Manuals Search And Download.

3. Install 3 new 'AA' (AM-3/LR6) batteries following the diagram inside the battery box. (The use of new alkaline batteries is recommended for maximum performance.)
4. Replace the battery cover and tighten the screw to secure.

BATTERY NOTICE

- Use new alkaline batteries for maximum performance.
- Use only batteries of the same or equivalent type as recommended.
- Do not mix different types of batteries: alkaline, standard (carbon-zinc) or rechargeable (Ni-Cd, Ni-MH), or new and used batteries.
- Do not use damaged batteries.
- Insert batteries with the correct polarity.
- Do not short-circuit the battery terminals.
- Remove exhausted batteries from the toy.
- Remove batteries during long periods of non-use.
- Do not dispose of batteries in fire.
- Do not charge non-rechargeable batteries.
- Remove rechargeable batteries from the toy before charging (if removable).
- Rechargeable batteries are only to be charged under adult supervision.



PRODUCT FEATURES

1. ON/OFF/MODE SELECTOR SWITCH

To turn the unit **ON**, slide the **ON/OFF/MODE SELECTOR SWITCH** to the **LEARNING MODE** (😊) or the **MUSIC MODE** (🎵) position. To turn the unit **OFF**, slide the **ON/OFF/MODE SELECTOR SWITCH** to the **OFF** (●) position.



2. VOLUME CONTROL SWITCH

To adjust the volume, slide the **VOLUME CONTROL SWITCH** to the **HIGH VOLUME** () or the **LOW VOLUME** () position.



3. AUTOMATIC SHUT-OFF

To preserve battery life, The **VTech® Dance & Discover Jam Band™** will automatically power-down after approximately 50 seconds without input. The unit can be turned on again by pressing any button or by moving the guitar.

ACTIVITIES

1. Slide the **on/off/mode selector switch** to turn the unit on. You will hear a fun sound, a song and a phrase. The lights will flash with the sounds.



2. Press the **piano keys** to learn colors, animal names, animal sounds and hear short tunes in the learning mode. You will hear individual piano notes in the music mode. The lights will flash with the sounds.

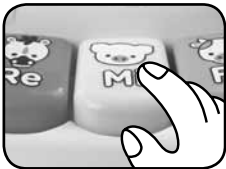

3. Tap the **drum button** to hear fun sounds, phrases and music, depending on the selected mode. The lights will flash with the sounds.



4. Move the **guitar** to see the monkey dance. Depending on the selected mode, you will hear fun sounds, phrases and music. The lights will flash with the sounds.

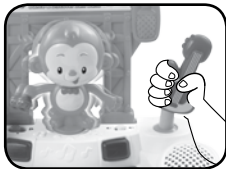

5. Sing into the **microphone** to hear your voice amplified. The lights will flash with the sounds.

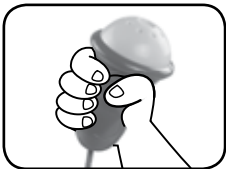

MELODY LIST

1. The Entertainer
2. Pineapple Rag
3. A-Tisket, A-Tasket
4. Yankee Doodle
5. Camptown Races
6. Ding Dong Bell
7. Funiculi, Funicula
8. Aiken Drum
9. Good Night Ladies
10. Take Me Out to the Ball Game
11. Teddy Bears' Picnic
12. Farmer in the Dell
13. Little Bo Peep
14. Aunt Rhody
15. Polly Put the Kettle On

16. I've Been Working on the Railroad
17. Turkey in the Straw
18. Looby Loo
19. Jack and Jill
20. Old King Cole

SUNG SONG LYRICS

SONG 1

Monkey wants to sing with you.
Play the guitar, see what he will do.
Tap the drum or press the keys,
There's so much for you to do!

SONG 2

Tap the drum, with your hand.
Keep to the beat, if you can.
Making music is fun.

SONG 3

Twinkle, twinkle, you're a star,
Shining brightly, yes you are!
Up upon a stage so grand,
Singing out across the land!
Twinkle, twinkle, you're a star,
Shining brightly, yes you are!

SONG 4

Did you ever see a monkey, a monkey, a monkey?
Did you ever see a monkey go this way and that?

SONG 5

Little monkey's dancing on the stage.
Play the guitar, watch him move.

CARE & MAINTENANCE

1. Keep the unit clean by wiping it with a slightly damp cloth.
2. Keep the unit out of direct sunlight and away from any direct heat source.
3. Remove the batteries when the unit will not be in use for an extended period of time.
4. Do not drop the unit on hard surfaces and do not expose the unit to moisture or water.

TROUBLESHOOTING

If for some reason the program/activity stops working or malfunctions, please follow these steps:

1. Please turn the unit **OFF**.
2. Interrupt the power supply by removing the batteries.
3. Let the unit stand for a few minutes, then replace the batteries.
4. Turn the unit **ON**. The unit should now be ready to play again.
5. If the product still does not work, replace with a new set of batteries.

If the problem persists, please call our Consumer Services Department at 1-800-521-2010 in the U.S. or 1-877-352-8697 in Canada, and a service representative will be happy to help you.

For information on this product's warranty, please call **VTech®** at 1-800-521-2010 in the U.S. or 1-877-352-8697 in Canada.

IMPORTANT NOTE:

Creating and developing **Infant Learning** products is accompanied by a responsibility that we at **VTech®** take very seriously. We make every effort to ensure the accuracy of the information, which forms the value of our products. However, errors sometimes can occur. It is important for you to know that we stand behind our products and encourage you to call our Consumer Services Department at 1-800-521-2010 in the U.S. or 1-877-352-8697 in Canada, with any problems and/or suggestions that you might have. A service representative will be happy to help you.

Note:

This equipment has been tested and found to comply with the limits for a Class B digital device, pursuant to Part 15 of the FCC Rules. These limits are designed to provide reasonable protection against harmful interference in a residential installation. This equipment generates, uses and can radiate radio frequency energy and, if not installed and used in accordance with the instructions, may cause harmful interference to radio communications. However, there is no guarantee that interference will not occur in a particular installation. If this equipment does cause harmful interference to radio or television reception, which can be determined by turning the equipment off and on, the user is encouraged to try to correct the interference by one or more of the following measures:

- Reorient or relocate the receiving antenna
- Increase the separation between the equipment and receiver
- Connect the equipment into an outlet on a circuit different from that to which the receiver is connected
- Consult the dealer or an experienced radio/TV technician for help

THIS DEVICE COMPLIES WITH PART 15 OF THE FCC RULES. OPERATION IS SUBJECT TO THE FOLLOWING TWO CONDITIONS: (1) THIS DEVICE MAY NOT CAUSE HARMFUL INTERFERENCE, AND (2) THIS DEVICE MUST ACCEPT ANY INTERFERENCE RECEIVED, INCLUDING INTERFERENCE THAT MAY CAUSE UNDESIRE OPERATION.

CAN ICES-3 (B)/NMB-3(B)

Caution: Changes or modifications not expressly approved by the party responsible for compliance could void the user's authority to operate the equipment.

**CLASS 1
LED PRODUCT**

Free Manuals Download Website

<http://myh66.com>

<http://usermanuals.us>

<http://www.somanuals.com>

<http://www.4manuals.cc>

<http://www.manual-lib.com>

<http://www.404manual.com>

<http://www.luxmanual.com>

<http://aubethermostatmanual.com>

Golf course search by state

<http://golfingnear.com>

Email search by domain

<http://emailbydomain.com>

Auto manuals search

<http://auto.somanuals.com>

TV manuals search

<http://tv.somanuals.com>