

Disney

User's Manual

Teach 'n Lights Phone



Visit the Disney Web site at www.disney.com

© Disney
Based on the "Winnie the Pooh" works,
by A.A. Milne and E.H. Shepard.

vtech®

Downloaded from www.manualssearch.com. All Manuals Search And Download.

Dear Parent,

*At VTech® we know that a child's imagination is a truly wonderful thing and needs to be developed and nurtured. That's why we created the **Winnie the Pooh® electronic learning series™** of interactive learning toys to stimulate children's imaginations, while also teaching vital preschool concepts such as the alphabet, numbers, shapes, colors and objects.*

*Through the use of unique technology and engaging child-directed role-play scenarios, **Winnie the Pooh®** characters magically come to life to guide children through learning activities. These engaging characters foster children's critical reasoning skills, enhance their fine motor skills and engage them in exciting role-play activities for endless hours of learning fun.*

At VTech® we know that a child has the ability to do great things. That's why all of our electronic learning products are uniquely designed to develop a child's mind and allow them to learn to the best of their ability. We thank you for trusting VTech® with the important job of helping your child learn and grow!

Sincerely,

Your Friends at VTech®

*To learn more about **Winnie the Pooh® electronic learning series™** and other VTech® toys, visit*

www.vtech.com

INTRODUCTION

Thank you for purchasing the **VTech® Teach 'n Lights Phone** learning toy! The **VTech® Teach 'n Lights Phone** is an interactive phone that's full of fun! The light-up, easy to press buttons help to develop motor skills, plus with four fun-filled activities, your child will develop basic knowledge and memory skills while having great role-play fun with **Winnie the Pooh** and his friends.

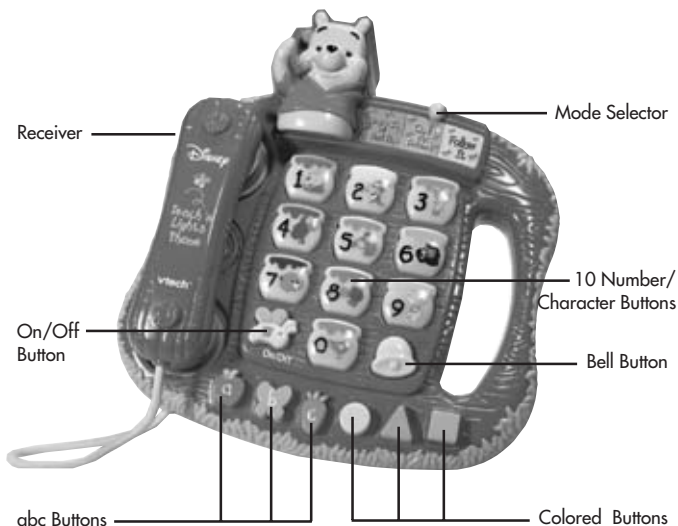

INCLUDED IN THIS PACKAGE

- One VTech® Teach'n Lights Phone learning toy
- One instruction manual

WARNING:

All packing materials such as tape, plastic sheets, wire ties and tags are not part of this toy, and should be discarded for your child's safety.

GETTING STARTED

BATTERY INSTALLATION

1. Make sure the unit is **OFF**.
2. Locate the battery cover at the bottom of the unit. Use a coin or screwdriver to loosen the screw.
3. Install 3 new "AA" (UM-3/LR06) batteries as illustrated. (The use of new, alkaline batteries is recommended for maximum performance.)
4. Replace the battery cover and tighten the screw to secure the battery cover.

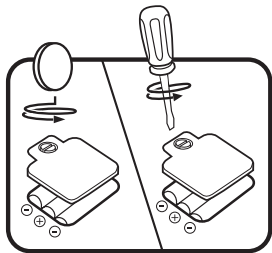

BATTERY NOTICE

- Non-rechargeable batteries are not to be recharged.
- Rechargeable batteries are to be removed from the toy before being charged (if removable).
- Rechargeable batteries are only to be charged under adult supervision (if removable).
- Different types of batteries or new and used batteries are not to be mixed.
- Only batteries of the same or equivalent type as recommended are to be used.

- Batteries are to be inserted with the correct polarity.
- Exhausted batteries are to be removed from the toy.
- The supply terminals are not to be short-circuited.
- The toy is not to be connected to more than recommended number of power supplies.
- Do not dispose of battery in fire.

WE DO NOT RECOMMEND THE USE OF RECHARGEABLE BATTERIES.

PRODUCT FEATURES

ON/OFF BUTTON

1. To begin play, press the **On/Off**  button. **Winnie the Pooh**

On/Off

will greet you and guide you to start the **Learn It** activity.

2. To choose another activity, slide Pooh's hand on the **Mode Selector** to the one you want to play.



3. Press the **On/Off** button again to turn the unit off.

AUTOMATIC SHUT-OFF

To preserve battery life, the **VTech® Teach'n Lights Phone** will automatically turn off after several minutes without input. The unit can be turned on again by pressing the **On/Off** button.

ACTIVITIES

Learn It OR Find It

Learn It
OR
Find It

To select the **Learn It OR Find It** mode slide Pooh's hand on the **Mode Selector**. There are two activities in **Learn It OR Find It** mode.



To enter the **Learn It** mode, the handset must be attached to the phone (on the hook). To enter **Find It** mode, the handset must be detached from the phone (off the hook).



HOOK BUTTON



Learn It mode

Pooh will ask you to press a button to start learning. Press the **Number/Character Buttons** to hear Pooh identify his friends and their numbers.

Press the **abc**    **Buttons** to hear the letters identified and a

related word and fun sound effect. Press the **Colored**    **Buttons** to learn colors and shapes.

Find It mode

Pooh will ask you to find someone or something. Answer by pressing the correct button.

Call My Friend

Call
My
Friend

To select the **Call My Friend** mode slide Pooh's hand on the **Mode Selector**. In this activity, Pooh will ask you to help him call his friends. Answer by pressing the correct **Number/Character Button**. If you do not find the correct answer, after several tries, the light-up button will flash the correct answer.

Download from Www.Somanuals.com. All Manuals Search And Download.

Follow It

Follow
It

To select the **Follow It** mode slide Pooh's hand on the **Mode Selector**.

You will hear Pooh call out 3 names in a row. As each name is called, the corresponding button will light up. You need to listen and watch carefully and then repeat the sequence. If you get it correct, Pooh will add another friend to the sequence which you then need to remember and repeat. See how many you can remember!

CARE & MAINTENANCE

1. Keep the unit clean by wiping it with a slightly damp cloth.
2. Keep the unit out of direct sunlight and away from any direct heat source.
3. Remove the batteries when the unit is not in use for an extended period of time.
4. Do not drop the unit on hard surfaces and do not expose the unit to moisture or water.

TROUBLESHOOTING

If for some reason the program/activity stops working, please follow these steps:

1. Please turn the unit **OFF**.
2. Interrupt the power supply by removing the batteries.
3. Let the unit stand for a few minutes, then replace the batteries.
4. Turn the unit **ON**. The unit should now be ready to play again.
5. If the product still does not work, replace with a new set of batteries.

If the problem persists, please call our Consumer Services Department at 1-800-521-2010 in the U.S. or 1-877-352-8697 in Canada.

Download from www.Somanuals.com. All Manuals Search And Download.

IMPORTANT NOTE:

Creating and developing **Winnie the Pooh** electronic learning products is accompanied by a responsibility that we at **VTech®** take very seriously. We make every effort to ensure the accuracy of the information, which forms the value of our products. However, errors sometimes can occur. It is important for you to know that we stand behind our products and encourage you to call our Consumer Services Department at 1-800-521-2010 in the U.S. or 1-877-352-8697 in Canada.

FCC NOTICE:

This equipment has been tested and found to comply with the limits for a Class B digital device, pursuant to Part 15 of the FCC Rules. These limits are designed to provide reasonable protection against harmful interference in a residential installation. This equipment generates, uses and can radiate radio frequency energy and, if not installed and used in accordance with the instructions, may cause harmful interference to radio communications. However, there is no guarantee that interference will not occur in a particular installation.

If this equipment does cause harmful interference to radio or television reception, which can be determined by turning the equipment off and on, the user is encouraged to try to correct the interference by one or more of the following measures:

- Reorient or relocate the receiving antenna.
- Increase the separation between the equipment and receiver.
- Connect the equipment into an outlet on a circuit different from that to which the receiver is connected.
- Consult the dealer or an experienced radio/TV technician for help.

Note:

This equipment induces a weak magnetic field that may affect watches, television sets or monitors. It is recommended to keep this unit away from metallic materials when playing.

© 2004 VTech

Printed in China

Free Manuals Download Website

<http://myh66.com>

<http://usermanuals.us>

<http://www.somanuals.com>

<http://www.4manuals.cc>

<http://www.manual-lib.com>

<http://www.404manual.com>

<http://www.luxmanual.com>

<http://aubethermostatmanual.com>

Golf course search by state

<http://golfingnear.com>

Email search by domain

<http://emailbydomain.com>

Auto manuals search

<http://auto.somanuals.com>

TV manuals search

<http://tv.somanuals.com>