

# WARING PRO®

## TAILGATER™ BLENDER

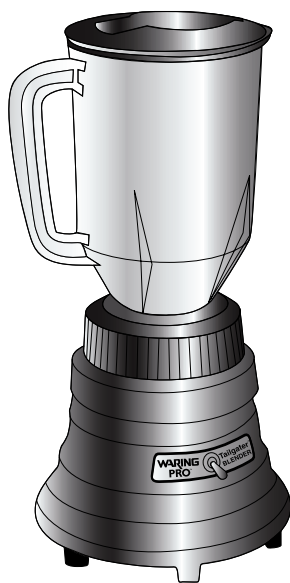

TG15

For your safety and continued enjoyment of this product,  
always read the instruction book carefully before using.

# CONTENTS

Important Safeguards . . . . .	1
Important Hot Blending Instructions . . . . .	3
Operating Instructions . . . . .	3
How To Assemble Containers with Removable Blades . . . . .	4
How To Disassemble and Clean Containers with Removable Blades. . . . .	5
How To Clean Unit Base . . . . .	6
Fuse Replacement. . . . .	6

**IMPORTANT: Always unplug the Waring Pro® Tailgater™ Blender from outlet when disassembling and assembling.**

## IMPORTANT SAFEGUARDS

When using electrical appliances, basic safety precautions should always be followed, including the following.

### READ ALL INSTRUCTIONS.

1. To protect against risk of electrical shock, do not immerse the blender base in water or other liquid.
2. Close supervision is necessary when any appliance is used by or near children.
3. **Unplug from outlet when not in use, before putting on or taking off parts, and before cleaning.**
4. Avoid contact with moving parts.
5. Do not operate the Waring Pro® Blender or any other electrical equipment with a damaged cord or plug, or after the unit malfunctions, or is dropped or damaged in any manner. Return it to the nearest authorized service facility for examination, repair, or adjustment.
6. The use of attachments, including canning jars, not recommended or sold by Waring may cause fire, electric shock, or injury.

7. Do not let cord hang over edge of table or counter, or touch hot surfaces.
8. Keep hands and utensils out of jar while blending, to prevent the possibility of severe personal injury and/or damage to the blender. A rubber spatula may be used, but must be used only when the blender is not running.
9. Blades are very sharp. Handle carefully.
10. To avoid injury, never place blade assembly on the base unless container is properly attached.
11. Always operate blender with cover in place.
12. For blending hot liquids, see “Hot Blending Instructions,” next page.
13. Screw on base collar firmly when assembling container. Injury can result if moving blades accidentally become exposed.
14. Do not leave blender unattended while it is running.

**SAVE THESE INSTRUCTIONS**

# IMPORTANT: HOT BLENDING INSTRUCTIONS

To minimize possibility of being scalded when blending hot ingredients, the following precautions and procedures must be observed:

1. Begin blending with no more than one cup (8 oz.) of ingredients.
2. Before turning blender on, remove the center lid insert. This will allow venting of the rapidly heated and expanding air.
3. Start blending on low speed.
4. While blender is running, up to 1½ cups (12 oz.) of additional liquid can be added. Pour liquid slowly through the opening in the lid.

## OPERATING INSTRUCTIONS

1. When placing the container on the unit base, make sure that the unit is turned off and is at a complete stop. Do not put the container on or take it off while the unit is running. Doing so may damage the drive shaft or blade assembly. For best results, do not fill container above 3-cup level.
2. With the switch in the Off position, plug the blender into a 12-volt cigarette lighter receptacle.
3. The Waring Pro® Tailgater™ Blender is ideal for blending ice drinks. For best results, keep the blades covered with liquid, turn the unit on, remove the lid insert, and feed the ice cubes slowly into the container. **NOTE: Never use containers other than Waring Pro® Blender containers with your unit.**
4. For other blending tasks, put ingredients into container, then put the lid on firmly. Always add liquid ingredients first, unless otherwise specified in recipe. Always hold container with one hand while blending.

# HOW TO ASSEMBLE CONTAINERS WITH REMOVABLE BLADES

Always wash and rinse container prior to initial use.

1. Before starting, make sure that the blender cord is unplugged and that the switch is in the Off position.
2. Refer to Figure 1 on page 5. The following points are important to note when putting together the container assembly:
  - Container gasket must be placed between blade assembly and container.
  - Collar must be threaded properly onto the blender container base, and securely tightened before placing food or liquid in the container.
  - To ensure proper assembly, place the blender container upside down and turn the collar counterclockwise until securely tightened.
3. Place assembled blender jar on unit base so that it is firmly seated and not tilted to one side. Never place the collar or blade assembly on the unit base unless the container has been completely assembled and securely tightened.

# HOW TO DISASSEMBLE AND CLEAN CONTAINERS WITH REMOVABLE BLADES

Always wash and rinse container immediately after use.

1. Be sure the switch is in the Off position.
2. Remove the container assembly from the unit base and empty the contents.
3. To disassemble the Waring Pro® Tailgater™ Blender, turn container collar clockwise.
4. The collar, blade assembly and gasket are dishwasher safe. The plastic container lid and insert must be washed by hand. Allow all parts to air dry.
5. Be certain all components are in the proper position when reassembling blender container and base.

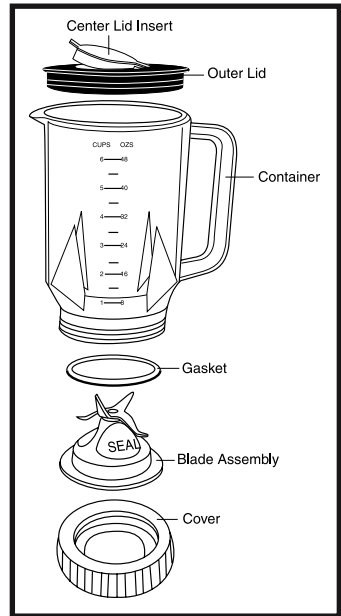

Fig.1

## **HOW TO CLEAN UNIT BASE**

1. To clean the unit base, unplug the power cord. Wipe the exterior surfaces with a soft cloth or sponge dampened with cleaning solution. Rinse with clean water. Do not immerse the base in cleaning solution or water. Wipe the base with dry towel.

## **FUSE REPLACEMENT**

The plug on the blender power cord contains a replaceable cartridge fuse. To gain access to the fuse, push the metal tip of the plug inward as far as it will go, then turn it counterclockwise until it releases. Withdraw the tip, with the fuse attached, by pulling it straight out of the plug body. Replace fuse with one of same size and rating (15 Amperes, 32 Volts, Slow-Blow). Reassemble plug by reversing above procedure.

©2008

Waring Consumer Products  
Division of Conair Corporation  
150 Milford Road  
East Windsor, NJ 08520

[www.waringproducts.com](http://www.waringproducts.com)

Printed in USA  
TG15 Tailgater IB  
08WR204

028340



## Free Manuals Download Website

<http://myh66.com>

<http://usermanuals.us>

<http://www.somanuals.com>

<http://www.4manuals.cc>

<http://www.manual-lib.com>

<http://www.404manual.com>

<http://www.luxmanual.com>

<http://aubethermostatmanual.com>

Golf course search by state

<http://golfingnear.com>

Email search by domain

<http://emailbydomain.com>

Auto manuals search

<http://auto.somanuals.com>

TV manuals search

<http://tv.somanuals.com>