



Instruction Manual

WARNING:
CHOKING HAZARD-SMALL PARTS
NOT FOR CHILDREN UNDER 3 YEARS

MEASURE THE STRING:

Rest the E-Yo on the floor in front of you. Hold the string up to your waist. Tie a slip knot approximately 3 1/2" above your waist.

MAKE A SLIP KNOT:

To make a slip knot, fold over the end of the string about 1". Tie a knot (see illustration 1).

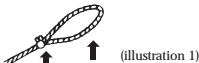

(illustration 1)

Take the string and slip it through the loop (see illustration 2).



(illustration 2)

Put your middle index finger inside the loop you created and pull snugly - don't pull the loop too tight on your finger (see illustration 3).



(illustration 3)

FUNCTIONS:

1. ON/OFF

Press this button to turn on E-Yo. Press and hold this button for 2 seconds to turn OFF E-Yo. E-Yo will shut off automatically after 3 minutes of non-use. After shut off, cumulative data in DISTANCE and COUNT modes will be retained while data in SPEED and TIME modes will be cleared. E-Yo settings will default to the last mode displayed before turning off the E-Yo.

2. MODE IMPORTANT NOTES:

1. Select a mode BEFORE you start spinning E-Yo.
2. To select a mode, press the DISPLAY button and then press the MODE button.

To select a mode of performance, press the DISPLAY button to view the screen and then press the MODE button until you reach the mode you want to measure. For example, if you want to measure the speed of the spinning E-Yo, press DISPLAY then the MODE button until you reach the SPEED mode. Then begin spinning E-Yo. You must select a mode BEFORE you begin spinning E-Yo.



DIGITAL DISPLAY
MODE
RESET
DISPLAY
ON/OFF

DISTANCE Mode:

This mode measures the cumulative distance traveled in miles by the spinning E-Yo. Select the distance to be displayed in either MILES or KILOMETERS, the default is MILES.



SPEED Mode:

This mode measures the speed of the spinning E-Yo. Select the SPEED to be displayed in either scale MPH or scale KPH, the default is scale MPH.



TIME Mode:

This mode measures the sleep time from the time E-Yo begins spinning to the time you press the DISPLAY button. The SLEEP TIME will be displayed in seconds.



COUNT Mode:

This mode measures the cumulative number of times E-Yo was thrown and caught.

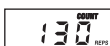

3. DISPLAY

The display will be blank while the E-Yo is spinning or after 10 seconds of non-use.

After E-Yo has stopped spinning, press the DISPLAY button to view the display screen. If the SPEED mode was selected prior to the E-Yo spinning, the speed of the spinning yo-yo will appear on the screen. If the DISTANCE mode was selected prior to the E-Yo spinning, the cumulative distance traveled by the spinning yo-yo will appear on the screen.

If the TIME mode was selected prior to the E-Yo spinning, the sleep time will appear on the screen. If the COUNT mode was selected prior to the E-Yo spinning, the cumulative number of times the yo-yo was thrown and caught will appear on the screen. To clear the readings in the display screen in DISTANCE mode and COUNT mode, press and hold the DISPLAY button for 4 seconds.

4. DIGITAL DISPLAY

The 4-digit screen will record and display the measurement of the mode of performance selected.

5. RESET BUTTON

If the screen becomes erratic, press the RESET button to reset the display.

E-YO TRICKS:

The Basic Spin

Hold E-Yo in the palm of your hand with the string attached to your middle finger. Keep your bent elbow near your body and your hand near your shoulder. With your palm facing up and a quick flick of your wrist, release E-Yo in a downward path. When E-Yo reaches the end of the string, quickly turn over your hand and flick your wrist upward. E-Yo will return to the palm of your hand.

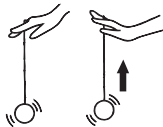

Walk the Dog

Let E-Yo fall gently from the palm of your hand. When E-Yo reaches the end of the string, place E-Yo gently on the ground. Move E-Yo a short distance forward and then flick your wrist quickly to return E-Yo to the palm of your hand.



The Forward Pass

Hold E-Yo behind you with the palm of your hand facing up. As you swing your arm forward, release E-Yo. Keep your elbow straight in front of you and E-Yo will return to your hand.

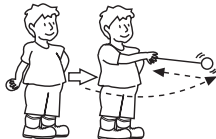

Rocking the Baby

It is best to first practice this trick without spinning E-Yo. Let E-Yo hang its full length. With your free hand, hold the string about 15" down from the top of the string. Now use the thumb and forefinger from your E-Yo hand and grab the string 15" down from your other hand. Your E-Yo hand is at the top and your other hand is at the bottom. Swing E-Yo through the opening. With E-Yo spinning, you must do the trick fast, release the string and flick your wrist up to return E-Yo to the palm of your hand.



Around the World

Toss E-Yo straight in front of you. Move your arm in a large circle. When E-Yo comes back in front of you, flick your wrist and E-Yo will return to the palm of your hand.

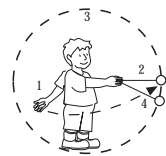

WARNING: Watch carefully as E-Yo makes a circle. Be sure there are no people or objects around you. It is strongly recommended that you do this trick in a wide-open area without obstacles or people.

BATTERY INSTALLATION

WARNING: Battery replacement/installation should be done by an adult. NOTE: Always install the battery correctly according to the positive (+) and negative (-) signs on the battery.

1. Loosen the screws on the front panel of the cabinet.
2. Gently lift the top off.
3. Remove the old battery.
4. Replace the new battery (CR2032) in the exact same position as the old battery. Be careful to follow the correct positive and negative signs on the battery while placing the new battery into the yo-yo.
5. Replace the top and tighten the screws securely.

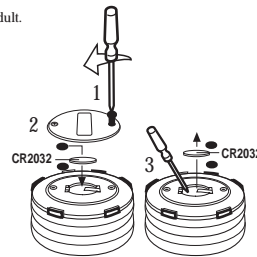

To ensure proper function of this product:

- Battery installation should be done by an adult.
- Non-rechargeable batteries are not to be recharged.
- Rechargeable batteries are to be removed from the toy before being charged (if removable).
- Rechargeable batteries are only to be charged under adult supervision (if removable).
- Only batteries of the same or equivalent type as recommended are to be used.
- Batteries are to be inserted with the correct polarity, following the toy and battery manufacturer's instruction.
- Exhausted or dead batteries are to be removed from the toy.
- The supply terminals are not to be short-circuited.

WARNINGS:

1. Do not hang the string around anyone's neck to avoid being choked.
2. Do not play violently or throw this yo-yo.
3. Keep this yo-yo away from children under the age of 6.
4. Keep other people and objects at a safe distance away.
5. Replace the string before it wears out.

REMOVING/REPLACING THE STRING

DO NOT TWIST OR UNSCREW THE TWO HALVES OF THE YO-YO. DO NOT DISASSEMBLE THE YO-YO. PLEASE READ CAREFULLY TO REPLACE THE STRING WITHOUT TAKING APART THE YO-YO.

Removing the worn string - simply untwist the STRING near the yo-yo until the string opens and makes a large loop. Remove the string from around the yo-yo axle by sliding the untwisted loop over the yo-yo.

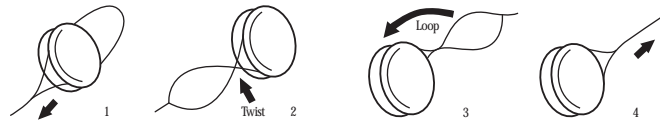

Replacing the new string - untwist the STRING until a large loop forms at the end of the string (1). Slide the large loop over the yo-yo so the string rests on the axle between the two halves of the yo-yo. Twist the STRING once (2) and then slide the loop over the yo-yo AGAIN (3). This method will form a double loop over the axle of the yo-yo. Allow the string to twist back into its original state (4).

90- DAY LIMITED WARRANTY

Tiger Electronics, Ltd. (Tiger) warrants to the original consumer purchaser of this product that the product will be free from defects in materials or workmanship for 90 days from the date of original purchase. This warranty does not cover damages resulting from accident, negligence, improper service or use or other causes not arising out of defects in materials or workmanship.

During this 90-day warranty period, the product will either be repaired or replaced (at Tiger's option) without charge to the purchaser, when returned with proof of the date of purchase to either the dealer or to Tiger.

Products returned to Tiger without proof of the date of purchase or after the 90-day warranty period has expired, but prior to one year from the original date of purchase, will be repaired or replaced (at Tiger's option) for a service fee of U.S. \$6.00. Payments must be by check or money order payable to Tiger Electronics, Ltd.

The foregoing states the purchaser's sole and exclusive remedy for any breach of warranty with respect to the product.

All products returned must be shipped prepaid and insured for loss or damage to:

Tiger Repair Department
1000 N. Butterfield Road, Unit 1023
Vernon Hills, IL 60061, U.S.A.

The product should be carefully packed in the original box or other packing materials sufficient to avoid damage during shipment. Include a complete written description of the defect, a check if product is beyond the 90-day warranty period, and your printed name, address and telephone number.

THIS WARRANTY IS IN LIEU OF ALL OTHER WARRANTIES AND NO OTHER REPRESENTATIONS OR CLAIMS OF ANY NATURE SHALL BE BINDING ON OR OBLIGATE TIGER IN ANY WAY. ANY IMPLIED WARRANTIES APPLICABLE TO THIS PRODUCT, INCLUDING WARRANTIES OF MERCHANTABILITY AND FITNESS FOR A PARTICULAR PURPOSE, ARE LIMITED TO THE NINETY (90) DAY PERIOD DESCRIBED ABOVE. IN NO EVENT WILL TIGER BE LIABLE FOR ANY SPECIAL, INCIDENTAL, OR CONSEQUENTIAL DAMAGES RESULTING FROM POSSESSION, USE, OR MALFUNCTION OF THIS TIGER PRODUCT.

Some states do not allow limitations as to how long an implied warranty lasts and/or exclusions of limitations of incidental or consequential damages, so the above limitations and/or exclusions of liability may not apply to you. This warranty gives you specific rights, and you may have other rights which vary from state to state.

For more information about Tiger Electronics, our products and special promotions, please visit our web site at: www.tigertoys.com

TIGER
ELECTRONICS, LTD.

®. TM, & © 1999 Tiger Electronics, Ltd.
All rights reserved.
980 Woodlands Parkway, Vernon Hills, Illinois 60061, U.S.A.



PRINTED IN CHINA
031220001IWT1-04

Free Manuals Download Website

<http://myh66.com>

<http://usermanuals.us>

<http://www.somanuals.com>

<http://www.4manuals.cc>

<http://www.manual-lib.com>

<http://www.404manual.com>

<http://www.luxmanual.com>

<http://aubethermostatmanual.com>

Golf course search by state

<http://golfingnear.com>

Email search by domain

<http://emailbydomain.com>

Auto manuals search

<http://auto.somanuals.com>

TV manuals search

<http://tv.somanuals.com>