



THANK YOU FOR PURCHASING YOUR TIMEX® WATCH.

EXTENDED WARRANTY

Available in U.S. only. Extend your warranty for an additional 4 years from date of purchase for \$5. You can pay with AMEX, Discover, Visa or MasterCard by calling 1 800-448-4639 during normal business hours. Payment must be made within 30 days of purchase. Name, address, telephone number, purchase date, and 5-digit model number required. You can also mail a check for \$5 to: Timex Extended Warranty, P.O. Box 1676, Dept. EF, Little Rock, AR 72203.

Please read instructions carefully to understand how to operate your Timex® watch. **Your model may not have all of the features described in this booklet. Please refer to below images to determine your model.**

GENERAL OPERATION

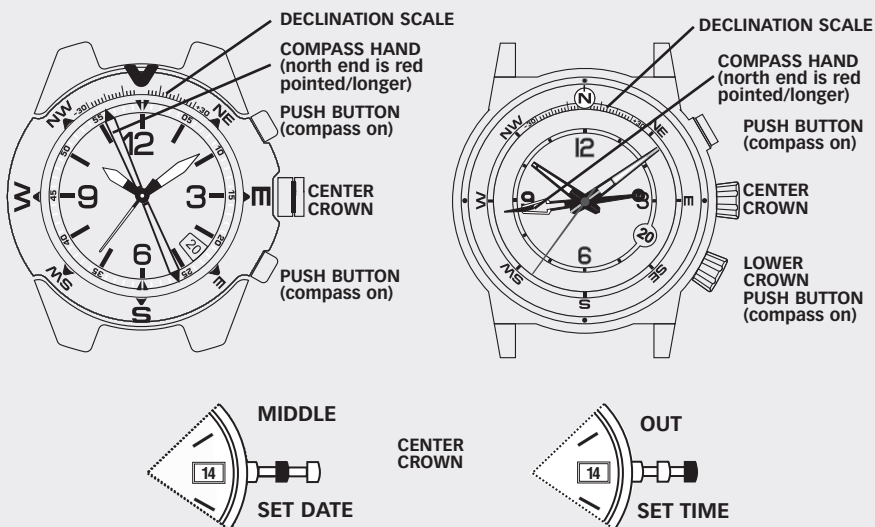

Watch is shipped with guard around CENTER CROWN. Remove guard and push CENTER CROWN in to start. **Compass must be calibrated before using to ensure accuracy and avoid improper headings.** Go to www.timex.com/expedition for help. Watch incorporates magnetic sensor technology of Precision Navigation, Inc., Mountain View, CA.

SET DATE AND TIME

Pull CENTER CROWN to MIDDLE position and turn until correct date appears. After setting date, pull CENTER CROWN all the way out and turn to correct time. Ensure correct AM/PM setting by verifying that date changes at midnight, not noon. Push CENTER CROWN in when done. Adjust date after months with fewer than 31 days.

COMPASS HAND ADJUSTMENT

Pull CENTER CROWN all the way out. Compass hand should point to 12 o'clock. If it does not, press either PUSH BUTTON or LOWER CROWN to move compass hand until it points to 12 o'clock. Hold PUSH BUTTON or LOWER CROWN to move hand fast. Push CENTER CROWN in when done and recalibrate compass.

COMPASS CALIBRATION

Since a compass uses the Earth's magnetic field, you must be aware of large metallic objects, such as vehicles or bridges, or objects that give off electromagnetic radiation, such as TVs or PCs, which could affect the magnetic field around the watch. If compass is calibrated near such objects, it will only work properly in that same location. If compass is calibrated away from such objects, it will not work properly near them. For best results, calibrate in area of intended use.

In calibrating and taking headings, it is important, as with all compasses, to keep compass level. Calibrating or taking a heading when watch is not level can result in large errors. Also avoid areas that may exhibit higher than normal concentrations of hard and soft iron, as they may cause inaccurate headings. Whenever a heading is suspect, recalibrate.

Do not store watch near any source of magnetism, such as computers, appliances, or TVs, as watch can take on a magnetic charge, yielding inaccurate headings.

To calibrate compass, pull CENTER CROWN to MIDDLE position. Press either PUSH BUTTON or LOWER CROWN to begin. Compass hand rotates two revolutions to remind you to rotate watch. Keep watch level or place on level surface (if band interferes, place on inverted cup). Watch may be face down, but protect watch face. While level, **SLOWLY** rotate watch two revolutions, **taking at least 15 seconds per revolution. This is critical in achieving proper calibration.** When done, press either PUSH BUTTON or LOWER CROWN, keeping watch level. Compass hand moves back and forth to acknowledge end of calibration and then moves to current declination angle setting (see DECLINATION ANGLE for more information). If you do not wish to set declination angle, push CENTER CROWN in. Otherwise, to have watch automatically compensate for declination angle, turn compass ring or turn LOWER CROWN until north is at 12 o'clock. Press either PUSH BUTTON or LOWER CROWN to move compass hand east (+) or west (-) to point to your location's declination angle (see table below) using declination scale. Hold PUSH BUTTON or LOWER CROWN to move hand fast. Push CENTER CROWN in when done.

COMPASS OPERATION

Normally, compass is off and compass hand points to 12 o'clock. If compass hand does not point to 12 o'clock when compass is off, compass hand must be adjusted; see COMPASS HAND ADJUSTMENT.

Compass must be calibrated prior to use and calibration should be performed in the area of intended use; see COMPASS CALIBRATION. If compass has not been calibrated since battery replacement, attempting to activate compass causes watch to rotate compass hand once and play melody to remind you to calibrate.

While holding watch level, press either PUSH BUTTON or LOWER CROWN to activate compass. Compass hand moves to point north. If watch is turned, compass hand will continue to move, always pointing north. After 20 seconds, compass will automatically turn off and hand will return to its home position, pointing to 12 o'clock. This conserves battery life. Press either PUSH BUTTON or LOWER CROWN at any time to keep compass on for another 20 seconds. Once compass is activated, there are two typical ways to use it.

Which way am I headed? Hold watch so that 12 o'clock is in direction of your travel. Turn compass ring or LOWER CROWN until compass hand is pointing to north on ring. Your heading is direction on ring at 12 o'clock.

Which way should I go? If you know the direction you want to go (e.g., NE), turn compass ring or LOWER CROWN until that direction appears at 12 o'clock. Then, turn your body until compass hand points to north on compass ring. Go in the direction of 12 o'clock.

NOTE: While compass is on, INDIGLO® night-light may flicker slightly when on. This is normal, as INDIGLO® night-light must be turned off briefly during compass readings to maintain accuracy. Also, sweep second hand will move in two second increments while in compass mode.

DECLINATION ANGLE

A compass hand points to "magnetic north," which may be slightly different from "true north," which is used on maps. This difference, called the "declination angle," which varies around the globe, is typically small and can be ignored in many cases. However, if you wish to compensate for this difference, there are two ways to do so. You can do it manually by turning the compass ring or LOWER CROWN so that compass hand points to your declination angle (see table below) instead of north, using the declination scale on compass ring. Or, you may have the watch automatically compensate by setting your declination angle after compass calibration; see COMPASS CALIBRATION. With proper declination angle set, compass hand will point to true north.

Declination angles for world cities (W is negative and E is positive on declination scale). For more, go to www.timex.com/expedition.

Anchorage20E	London2W	Rio De Janeiro22W
Atlanta4W	Little Rock1E	San Francisco15E
Bombay1W	Livingston, MT13E	Seattle18E
Boston15W	Munich2E	Shanghai5W
Calgary16E	New York City13W	Toronto11W
Chicago3W	Orlando5W	Vancouver18E
Denver9E	Oslo1E	Washington DC11W
Jerusalem4E	Paris1W	Waterbury, CT14W

INDIGLO® NIGHT-LIGHT

Press CROWN to activate light. electroluminescent technology used in the INDIGLO® night-light illuminates entire watch face at night and in low light conditions.

BRACELET ADJUSTMENT

FOLDOVER CLASP BRACELET

Find spring bar that connects bracelet to clasp. Using a pointed tool (Fig. 1), push spring bar in and gently twist bracelet to disengage. Determine wrist size, then insert spring bar in correct bottom hole (Fig. 2). Push down on spring bar, align with top hole and release to lock in place (Fig. 3).

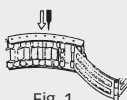

Fig. 1

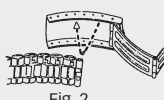

Fig. 2

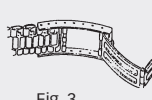
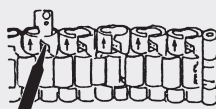

Fig. 3

BRACELET LINK REMOVAL

Removing Links: Place bracelet upright and insert pointed tool in opening of link. Push pin forcefully in direction of arrow until link is detached (pins are designed to be difficult to remove). Repeat until desired number of links are removed.



Reassembly: Rejoin bracelet parts. Push pin back into link in opposite direction of arrow. Press pin down securely into bracelet until it is flush.

SOLID LINK BRACELET

Removing Links: Using a very small screwdriver, remove screws by turning counterclockwise. Repeat until desired number of links are removed. Do not remove links adjacent to clasp.

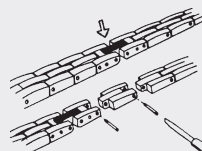

Reassembly: Rejoin bracelet parts and insert screw in end of opening where it was removed. Turn screw clockwise until tight and flush with bracelet.

WATER RESISTANCE

If your watch is water-resistant, meter marking or (∞) is indicated.

Water-Resistance Depth	p.s.i.a.* Water Pressure Below Surface
30m/98ft	60
50m/164ft	86
100m/328ft	160

*pounds per square inch absolute

WARNING: TO MAINTAIN WATER-RESISTANCE, DO NOT PRESS ANY BUTTONS UNDER WATER.

1. Watch is water-resistant only as long as lens, push buttons and case remain intact.
2. Watch is not a diver watch and should not be used for diving.
3. Rinse watch with fresh water after exposure to salt water.

BATTERY

Timex strongly recommends that a retailer or jeweler replace battery. Battery type is on watch back. If present, push/short internal reset switch after replacing battery. Battery life estimates are based on certain assumptions regarding usage; battery life may vary depending on actual usage.

DO NOT DISPOSE OF BATTERY IN FIRE. DO NOT RECHARGE. KEEP LOOSE BATTERIES AWAY FROM CHILDREN.

TIMEX INTERNATIONAL WARRANTY

(U.S. – LIMITED WARRANTY – PLEASE SEE FRONT OF INSTRUCTION BOOKLET FOR TERMS OF EXTENDED WARRANTY OFFER)

Your TIMEX® watch is warranted against manufacturing defects by Timex Group USA, Inc. for a period of ONE YEAR from the original purchase date. Timex and its worldwide affiliates will honor this International Warranty.

Please note that Timex may, at its option, repair your watch by installing new or thoroughly reconditioned and inspected components or replace it with an identical or similar model. **IMPORTANT — PLEASE NOTE THAT THIS WARRANTY DOES NOT COVER DEFECTS OR DAMAGES TO YOUR WATCH:**

- 1) after the warranty period expires;
- 2) if the watch was not originally purchased from an authorized Timex retailer;
- 3) from repair services not performed by Timex;
- 4) from accidents, tampering or abuse; and
- 5) lens or crystal, strap or band, watch case, attachments or battery. Timex may charge you for replacing any of these parts.

THIS WARRANTY AND THE REMEDIES CONTAINED HEREIN ARE EXCLUSIVE AND IN LIEU OF ALL OTHER WARRANTIES, EXPRESS OR IMPLIED, INCLUDING ANY IMPLIED WARRANTY OF MERCHANTABILITY OR FITNESS FOR PARTICULAR PURPOSE. TIMEX IS NOT LIABLE FOR ANY SPECIAL, INCIDENTAL OR CONSEQUENTIAL DAMAGES. Some countries and states do not allow limitations on implied warranties and do not allow exclusions or limitations on damages, so these limitations may not apply to you. This warranty gives you specific legal rights and you may also have other rights which vary from country to country and state to state.

To obtain warranty service, please return your watch to Timex, one of its affiliates or the Timex retailer where the watch was purchased, together with a completed original Watch Repair Coupon or, in the U.S. and Canada only, the completed original Watch Repair Coupon or a written statement identifying your name, address, telephone number and date and place of purchase. Please include the following with your watch to cover postage and handling (this is not a repair charge): a US\$ 8.00 check or money order in the U.S.; a CAN\$7.00 cheque or money order in Canada; and a UK£2.50 cheque or money order in the U.K. In other countries, Timex will charge you for postage and handling. NEVER INCLUDE A SPECIAL WATCHBAND OR ANY OTHER ARTICLE OF PERSONAL VALUE IN YOUR SHIPMENT.

For the U.S., please call 1-800-448-4639 for additional warranty information. For Canada, call 1-800-263-0981. For Brazil, call +55 (11) 5572 9733. For Mexico, call 01-800-01-060-00. For Central America, the Caribbean, Bermuda and the Bahamas, call (501) 370-5775 (U.S.). For Asia, call 852-2815-0091. For the U.K., call 44 020 8687 9620. For Portugal, call 351 212 946 017. For France, call 33 3 81 63 42 00. For Germany, call 49 7 231 494140. For the Middle East and Africa, call 971-4-310850. For other areas, please contact your local Timex retailer or Timex distributor for warranty information. In Canada, the U.S. and in certain other locations, participating Timex retailers can provide you with a postage-paid, pre-addressed Watch Repair Mailer for your convenience in obtaining factory service.

©2008 Timex Group USA, Inc. TIMEX is a registered trademark of Timex Group USA, inc. INDIGLO is a registered trademark of Indiglo Corporation in the US. and other countries.

Free Manuals Download Website

<http://myh66.com>

<http://usermanuals.us>

<http://www.somanuals.com>

<http://www.4manuals.cc>

<http://www.manual-lib.com>

<http://www.404manual.com>

<http://www.luxmanual.com>

<http://aubethermostatmanual.com>

Golf course search by state

<http://golfingnear.com>

Email search by domain

<http://emailbydomain.com>

Auto manuals search

<http://auto.somanuals.com>

TV manuals search

<http://tv.somanuals.com>