

W231 NA 714-095005-01

CE



TIMEX®

Download from [Www.Somanuals.com](http://www.Somanuals.com). All Manuals Search And Download.

English page 1

Français page 21

Español página 47

TIMEX®

TIMEX® WATCHES

Congratulations on purchasing your TIMEX® watch.
Please read these instructions carefully to
understand how to operate your Timex timepiece.
Your watch may not have all of the features
described in this booklet. Please look for your style



For more information and to register your product
please visit:

Timex.com

Download from Www.Somanuals.com. All Manuals Search And Download.

TABLE OF CONTENTS

- 1** Screw-Down Crown
- 2** Water and Shock Resistance
- 4** Automatic Style 1
- 7** Automatic Style 2
- 9** Automatic Style 3
- 11** Automatic Style 4
- 14** Automatic Style 5
- 15** How to Adjust Bracelets
- 17** Warranty

SCREW-DOWN CROWN

Some deep-depth water-resistant watches require the setting crown to be screwed in to secure water-resistance. If your watch case has a protrusion with screw threads, the crown must be screwed in after setting the watch.

To screw in, push the crown firmly against the threaded protrusion and hold in while turning the crown clockwise. Continue to screw in the crown until it is tight. You will need to unscrew the crown (counterclockwise) before pulling it out the next time you want to set your watch.

WATER AND SHOCK RESISTANCE

If your watch is water-resistant, meter marking or () is indicated.

Water-Resistance Depth	p.s.i.a. * Water Pressure Below Surface
50m/164ft	86
100m/328ft	160
200m/656ft	284

*pounds per square inch absolute

WARNING: TO MAINTAIN WATER-RESISTANCE ON ANY WATCH, THE CROWN SHOULD NOT BE PULLED OUT WHEN THE WATCH IS SUBMERGED IN WATER. ADDITIONALLY, PUSHERS ON WATCHES WITH A WATER-RESISTANCE DEPTH RATING OF LESS THAN 200 METERS, SHOULD NOT BE PUSHED WHEN SUBMERGED IN WATER. EITHER OF THESE ACTIONS COULD RESULT IN WATER ENTERING THE WATCH CASE.

1. Watch is water-resistant only as long as crystal, crown and case remain intact.
2. Watch is not a diver watch and should not be used for diving.
3. Screw-in setting crown and case back must be screwed into case to assure water-resistance (see Set Time for Style 1).
4. Rinse watch with fresh water after exposure to salt water.
5. Shock-resistance will be indicated on the watch face or caseback. Watches are designed to pass ISO test for shock-resistance. However, care should be taken to avoid damaging the crystal.

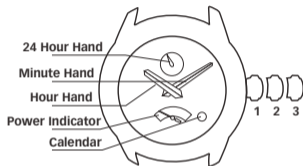
AUTOMATIC STYLE 1**TO SET TIME**

1. Unscrew crown and pull out to position 3. Turn to correct time.
2. Push crown in firmly and screw clockwise to restart.

Watches with date: Note correct time of day (A.M. or P.M.) for proper date function. (Please see illustration above for 24-HR dial.)

Download from Www.Somanuals.com. All Manuals Search And Download.

HOW TO SET "QUICK DATE® FEATURE"**3-Position Crown:**

Unscrew crown until you reach position "2" and turn **counterclockwise** until correct date appears.

NOTE: Date may need to be manually updated at the end of each month by following above procedure (otherwise it will continue to 31 and then roll over to 01 each month).

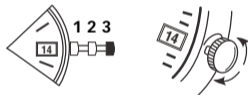
**HOW TO WIND YOUR WATCH**

From crown position 1, turn crown clockwise to wind watch.

POWER RESERVE

The watch is self-winding. If you wear your watch every day, there should be no need to wind it every 24 hours, unless the power reserve shows "LOW".

The maximum power reserve is at least 36 hours. The power reserve indicator shows you how much power remains. You should wind your watch when the indicator hand is near "LOW".

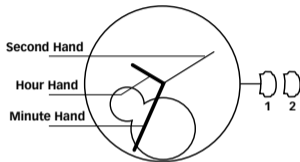
AUTOMATIC STYLE 2**TO SET TIME**

1. Pull crown to position 2 and turn crown to set correct time.
2. Push crown in to restart.

HOW TO WIND YOUR WATCH

From crown position 1, turn crown clockwise to wind.

POWER RESERVE

Once you begin to wear the watch, the movement of your wrist will generate power to keep the watch running.

NOTE: The maximum power reserve is at least 36 hours.

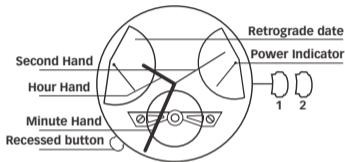
AUTOMATIC STYLE 3**TO SET TIME**

1. Pull crown to position 2 and turn crown to set correct time.
2. Push crown to restart.

TO SET DATE

With a blunt object, press recessed button at 8 o'clock position. Each button press advances date one day.

Note: After the date has reached "31" the hand will fly back down to "1".

HOW TO WIND YOUR WATCH

From crown position 1, turn crown clockwise to wind.

POWER RESERVE

Once you begin to wear the watch, the movement of your wrist will generate power to keep the watch running.

NOTE: The maximum power reserve is at least 36 hours. The power reserve indicator shows you how much power remains. You should wind your watch when the indicator hand is near "LOW".

AUTOMATIC STYLE 4

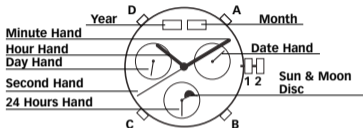

WINDING THE WATCH MANUALLY

The watch can be manually wound by turning the crown in the normal crown position (position 1) 15 to 20 times. The second hand should start to move naturally.

SETTING THE TIME

1. Pull the crown out one click (position 2)
2. Slowly rotate the crown until the hour and minute hands are in the correct position for the current

time. NOTE: AM / PM can be determined from the position of the 24 hour time and the Sun / Moon indicator on the sub-dial at the 6 o'clock position

3. Push the crown in one click, to the normal position (position 1)

SETTING THE DATE AND DAY

NOTE: DO NOT set the Date and Day between 9 PM and 3 AM. Setting the Date and Day during this time period will damage the watch movement

1. Push button B to advance the date hand to the correct day of the month
2. Push button C to advance the date hand to the correct day of the week

SETTING THE MONTH AND YEAR

NOTE: The Month and Year do not automatically advance. You must manually advance these displays at the beginning of each Month and Year.

1. Push button A to advance the Month display to the correct Month
2. Push button D to advance the Year display to the correct Year

NOTE: The Year display will correctly display the year for a maximum of 12 years after the movement was assembled.

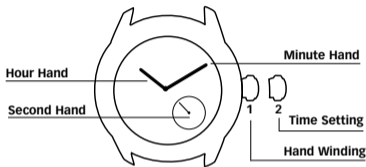
AUTOMATIC STYLE 5**TO SET TIME**

1. Pull crown to position 2 and turn crown to set correct time.
2. Push crown in to restart.

HOW TO WIND YOUR WATCH

From crown position 1, turn crown clockwise to wind.

HOW TO ADJUST BRACELET

(Variations of the following bracelet sections apply to all watch models).

FOLDOVER CLASP BRACELET

1. Find spring bar that connects bracelet to clasp.
2. Using a pointed tool, push in spring bar and gently twist bracelet to disengage.
3. Determine wrist size, then insert spring bar in correct bottom hole.
4. Push down on spring bar, align with top hole and release to lock in place.

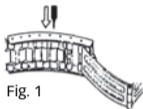

Fig. 1

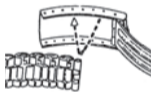

Fig. 2



Fig. 3

BRACELET LINK REMOVAL

REMOVING LINKS:

1. Place bracelet upright and insert pointed tool in opening of link.
2. Push pin forcefully in direction of arrow until link is detached (pins are designed to be difficult to remove).
3. Repeat until desired number of links are removed.



RE-ASSEMBLY:

1. Rejoin bracelet parts.
2. Push pin back into link in opposite direction of arrow.
3. Press pin down securely into bracelet until it is flush.

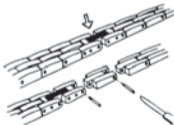

TIMEX INTERNATIONAL WARRANTY

Your TIMEX® watch is warranted against manufacturing defects by Timex Group USA, Inc. for a period of ONE YEAR from the original purchase date. Timex and its worldwide affiliates will honor this International Warranty.

Please note that Timex may, at its option, repair your watch by installing new or thoroughly reconditioned and inspected components or replace it with an identical or similar model. **IMPORTANT — PLEASE NOTE THAT THIS WARRANTY DOES NOT COVER DEFECTS OR DAMAGES TO YOUR WATCH:**

- 1) after the warranty period expires;
- 2) if the watch was not originally purchased from an authorized Timex retailer;
- 3) from repair services not performed by Timex;
- 4) from accidents, tampering or abuse; and
- 5) lens or crystal, strap or band, watch case, attachments or battery. Timex may charge you for replacing any of these parts.

THIS WARRANTY AND THE REMEDIES CONTAINED HEREIN ARE EXCLUSIVE AND IN LIEU OF ALL OTHER WARRANTIES, EXPRESS OR IMPLIED, INCLUDING ANY IMPLIED WARRANTY OF MERCHANTABILITY OR FITNESS FOR PARTICULAR PURPOSE. TIMEX IS NOT LIABLE FOR ANY SPECIAL, INCIDENTAL

OR CONSEQUENTIAL DAMAGES. Some countries and states do not allow limitations on implied warranties and do not allow exclusions or limitations on damages, so these limitations may not apply to you. This warranty gives you specific legal rights and you may also have other rights, which vary from country to country and state to state.

To obtain warranty service, please return your watch to Timex, one of its affiliates or the Timex retailer where the watch was purchased, together with a completed original Watch Repair Coupon or, in the U.S. and Canada only, the completed original Watch Repair Coupon or a written statement identifying your name, address, telephone number and date and place of purchase. Please include the following with your watch to cover postage and handling (this is not a repair charge): a US\$ 8.00 check or money order in the U.S.; a CAN\$7.00 cheque or money order in Canada; and a UK£2.50 cheque or money order in the U.K. In other countries, Timex will charge you for postage and handling. NEVER INCLUDE A SPECIAL WATCHBAND OR ANY OTHER ARTICLE OF PERSONAL VALUE IN YOUR SHIPMENT.

For the U.S., please call 1-800-448-4639 for additional warranty information. For Canada, call 1-800-263-0981. For Brazil, call +55 11 5572 9733. For Mexico, call 01-800-01-060-00. For Central America, the Caribbean,

Bermuda and the Bahamas, call (501) 370-5775 (U.S.). For Asia, call 852-2815-0091. For the U.K., call 44 020 8687 9620. For Portugal, call 351 212 946 017. For France, call 33 3 81 63 42 00. Germany/Austria: +43 662 88921 30. For the Middle East and Africa, call 971-4-310850. For other areas, please contact your local Timex retailer or Timex distributor for warranty information. In Canada, the U.S. and in certain other locations, participating Timex retailers can provide you with a postage-paid, pre-addressed Watch Repair Mailer for your convenience in obtaining factory service.

EXTENDED WARRANTY

Available in U.S. only. Extend your warranty for an additional 4 years from date of purchase for \$5. You can pay with AMEX, Discover, Visa or MasterCard by calling 1 800-448-4639 during normal business hours. Payment must be made within 30 days of purchase. Name, address, telephone number, purchase date, and 5-digit model number required. You can also mail a check for \$5 to: Timex Extended Warranty, P.O. Box 1676, Dept. EF, Little Rock, AR 72203.

© 2009 Timex Group USA, Inc. TIMEX and QUICK DATE are registered trademarks of Timex Group USA, Inc. in the U.S. and other countries.

Free Manuals Download Website

<http://myh66.com>

<http://usermanuals.us>

<http://www.somanuals.com>

<http://www.4manuals.cc>

<http://www.manual-lib.com>

<http://www.404manual.com>

<http://www.luxmanual.com>

<http://aubethermostatmanual.com>

Golf course search by state

<http://golfingnear.com>

Email search by domain

<http://emailbydomain.com>

Auto manuals search

<http://auto.somanuals.com>

TV manuals search

<http://tv.somanuals.com>